



Mobile Computing Cart with monitor Arm



Specifications

- Overall: 18W x 21.5D inches
- Height Range: from 35" to 47"
- Base: 19W x 9.5H x 17D inches
- Material: Steel, Plastic, MDF
- Monitor Size: 15" to 27"
- Pull-Out Shelf: 22.0W x 11.0D inches
- VESA Compatibility: 75x75, 100x100
- Bracket Type: Tilting, Rotating, Panning
- Monitor Weight Capacity: 15.0lbs
- Top Surface WxD: 23.5W x 16.5D inches
- Interior: 23.3W x 2.5H x 15.5D inches



Monitor Size
27"

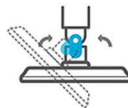

Swivel
+90° to -90°

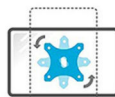

Rotation
+180° to -180°

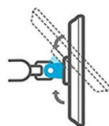

Tilt
+90° to -90°





Description

With a monitor mount and big surface, this medical computer cart makes an efficient mobile workstation that can appeal to many businesses. The wheels allow this trolley to effortlessly move to anywhere and 4 lockable wheels allow you to lock in place as a stationary desk. Easy to maneuver the height-adjustable cart by pressing down on the footpad to raise or lower the surface. Mobile workstations are often found in busy environments such as doctor's offices, labs, and hospitals. Stowaway documents or equipment in the locking drawer for safekeeping while you step away from the desk. Comfortably position a keyboard on the pull-out tray and set up your mouse on either side to accommodate left or right-handed users. Wheel this computer cart into your office for an adjustable and ergonomic way to stay on top of your workload each day.

Features

- The height-adjustable working area is comfortable for sitting or standing users.
- Pull-out keyboard storage and mouse stage can be the left or right side.
- Organizes the cable management in place to have a clear look.
- This model is fitted with wheels for easy movement and 4pcs with the lock while working.
- Help to improve workflow efficiency and upgrade patient care.
- Install a single LCD arm to have the monitor in a better viewing position.
- The monitor can be swiveled, rotated, and tilted.
- Meet with VESA standard 75/100mm.
- Max loading including monitor: Max 2-7kgs.
- The CPU holding size: 52-100mm.
- Install a CPU can (option) be in the front or back.



Optional Drawers

Gives you additional space for your important documents and equipments and keep everything in place while the mobile cart is in motion



Adjustable CPU Holder

Gives you additional space for your important documents and equipments and keep everything in place while the mobile cart is in motion



Key & Lock

Hide sensitive documents out of sight with the locking top drawer that comes with a set of keys.