

**Installation**

**Preparation**

**Components**



# Rover Vans License Plate Relocation Installation Instructions

For Ram ProMaster Rear Door, Driver's Side

**Installation Time:**  
60 - 90 Minutes

## Components

- \* Lay out all components on a clean work surface. \*
- Check to make sure all pieces that are accounted for and undamaged.

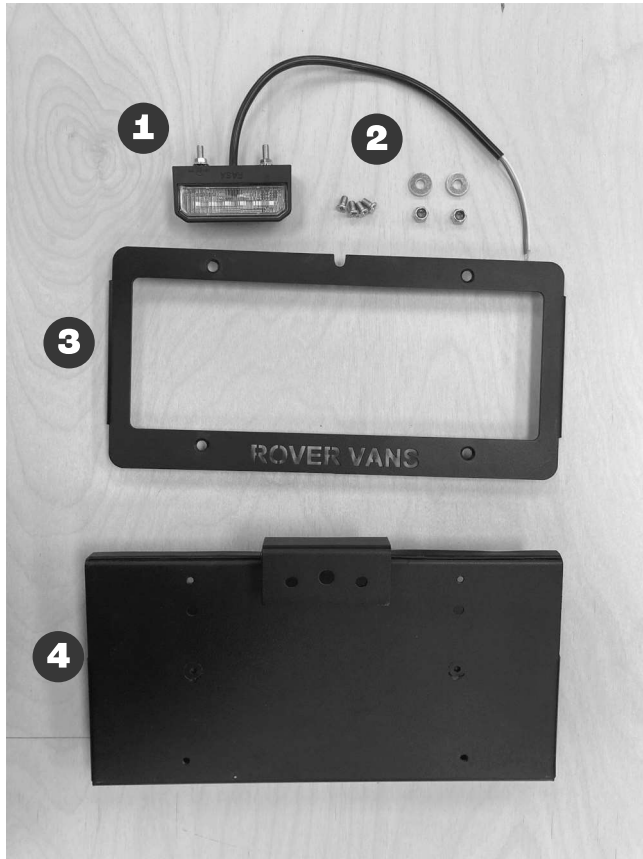

1. Plate Light
2. Hardware
3. Plate Cover
4. Plate Body

## Tools Needed

- Drill with 1/8" and 5/16" bits
- 10mm and 8mm wrenches
- Silicon sealant
- Electrical tape
- Phillips head screwdriver

All wiring modifications should be done by an automotive technician and are solely the responsibility of the user.

Rover Vans does not accept any liability for improper wiring.

# Installation

1

Locate and mark the positions of where to drill the holes for the Plate Body. The holes should be 1 1/4" from the top of the plastic trim, and 9 3/8" and 16 1/4" from where the two rear doors meet.



2

After marking your holes, use a drill and 1/8" drill bit to make holes for the Plate Body. Make sure to not hit any wiring on the inside of the door.

3

Make sure to deburr any holes drilled into the door and cover any raw metal with rust preventative paint.



All wiring modifications should be done by an automotive technician and are solely the responsibility of the user. Rover Vans does not accept any liability for improper wiring.

# Installation

4

Using the welded bolts on the Plate Body, thread the bolts through the newly drilled holes. Next, use the nuts and washers to secure the body to the door.

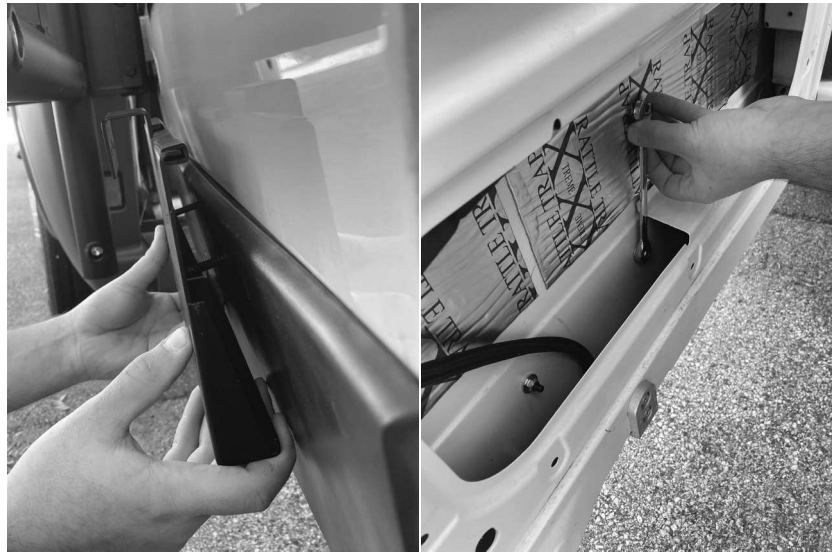

5

Locate the hole towards the top of the Plate Body, and using a 5/16" drill bit, drill a hole in the door using the hole at the top of the Plate Body.



6

After deburring and painting, insert the wire on the Plate Light through the hole you just drilled. Then, insert the bolts coming from the Plate Light into the Plate Body, and secure using nuts on the back.



All wiring modifications should be done by an automotive technician and are solely the responsibility of the user. Rover Vans does not accept any liability for improper wiring.

# Installation



**7**

To prevent water getting into the door, use a silicon sealant around the Plate Light wire.

**8**

Unplug the wiring for the stock license plate light. After pulling off the pin, wire in the new Plate Light. For all ProMasters that have existing license plate lights using non-LED lights, DO NOT disconnect the OEM pin. Rather, tap into the existing wires with our LED lights. Otherwise an error code will appear on the dashboard saying the lights are not working.

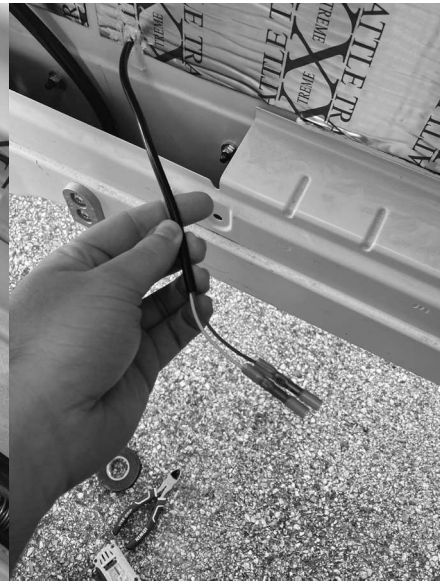

**9**

After wiring in the new Plate Light, be sure to cover the exposed wire with rubber or fabric electrical tape.

## Installation



**10**

Finally, screw on your license plate under the Plate Cover using the phillips head screws.



Now you are ready for adventures with your new License Plate Relocation!