

CORE® 11 PERSON CABIN TENT WITH SCREEN ROOM - 17 x 12

Model No. 40035

Two people are recommended to set up this tent.

Contents & Repair Parts:

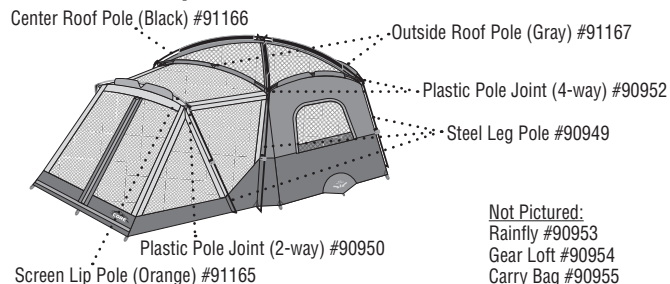

- 1** • Empty contents of bag and confirm all parts are included and undamaged.

NOTE: Do this at home before you leave on your trip.

- Select a smooth level site and lay out your tent.
- Extend tent poles and place in position ready for installation.

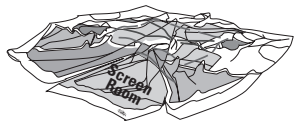

2 Tent Roof Poles

- Slide the BLACK CENTER ROOF POLES into BLACK ROOF SLEEVES. (**Detail 1**)
- Slide GRAY OUTSIDE ROOF POLES into GRAY SLEEVES located at top of roof. (**Detail 1**)
- Insert one end of first BLACK CENTER ROOF POLE into center ribbed end of 4-WAY PLASTIC POLE JOINT. Gently flex pole and insert other end of pole into center ribbed end of 4-WAY PLASTIC POLE JOINT at opposite corner. Repeat for second BLACK CENTER ROOF POLE. Tie FABRIC STRAPS at top of tent around roof poles to secure.
- Insert one end of first GRAY OUTSIDE ROOF POLE into ribbed end of 4-WAY PLASTIC POLE JOINT. Gently flex pole and insert other end of pole into ribbed end of 4-WAY PLASTIC POLE JOINT at opposite corner. Repeat for remaining GRAY OUTSIDE ROOF POLES. (**Detail 2**)

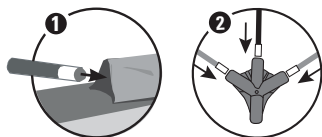

3 Tent Leg Poles & Stake

- Insert LEG POLE into end of 4-WAY PLASTIC POLE JOINT, then secure the other end of the LEG POLE with plastic insert into the PIN-RING at base of tent. (**Details 3 & 4**)
- Repeat step above for the remaining 3 LEG POLES at corners of tent.
- Snap QUICK CLIPS (attached to tent body) onto all 4 corner LEG POLES to shape the tent. (**Detail 5**)

NOTE: You can now easily move your tent to its final position before securing with stakes and setting up the screen room.

- To stake out the tent, drive STAKES through the PIN-RING assemblies on the tent base. (**Detail 6**)

NOTE: Floor of tent should be taut when staked properly.

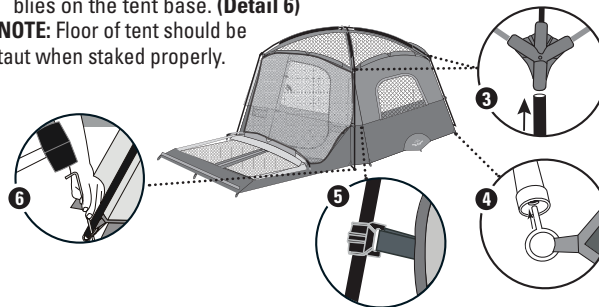

4 Screen Room & Stake

- Slide the ORANGE SCREEN LIP POLE into ORANGE SLEEVE on screen room.
- Place one end the ORANGE SCREEN LIP POLE into the ribbed end of ELBOW CONNECTOR, then insert other end of pole into ribbed end of ELBOW CONNECTOR at opposite side of screen room. (**Detail 7**)
- Insert LEG POLE into end of ELBOW CONNECTOR (**Detail 7**), then secure the other end of the LEG POLE with plastic insert into the PIN-RING at base of tent. (**Detail 4**)
- Repeat step above for the remaining LEG POLE at base of screen room.
- Snap QUICK CLIPS (attached to screen room body) onto all screen room LEG POLES. (**Detail 5**)
- Drive STAKES through the PIN-RING assemblies along the screen room base at the LEG POLES. (**Detail 6**)
- Drive STAKES through the WEB LOOPS at the front of the screen room. (**Detail 8**)

NOTE: Floor of screen room should be taut when staked properly.

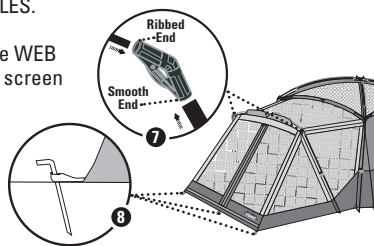

5 Attach Rainfly & Stake Guylines

- Drape RAINFLY over tent and screen room. Connect S-HOOK on elastic cords on the RAINFLY onto METAL D-RING on STEEL LEG POLES. (**Detail 9**)
- Locate HOOK AND LOOP FASTENERS on the underside of the RAINFLY and secure around tent poles. (**Detail 10**)
- To stabilize the tent, unroll the GUYLINES attached to the webbing loops on the RAINFLY. Make a loop at the opposite end of the GUYLINE using the PLASTIC SLIDER and place the loop over the TENT STAKE. Drive the STAKE into the ground to secure. Adjust the PLASTIC SLIDER to tighten the GUYLINE. Repeat for remaining guylines. (**Detail 11**)

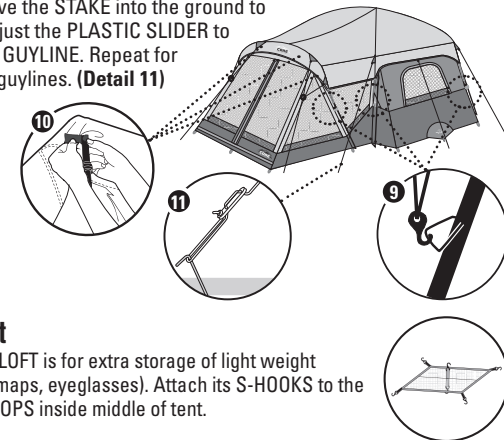

6 Gear Loft

- The GEAR LOFT is for extra storage of light weight items (i.e. maps, eyeglasses). Attach its S-HOOKS to the FABRIC LOOPS inside middle of tent.

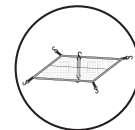

TAKE DOWN INSTRUCTIONS:

- Remove gear loft from inside of tent.
- Remove all stakes from tent and guylines. Store in stake bag.
- Unhook plastic clips on the elastic rainfly strap from the fabric loops on the tent and screen room.
- Unfasten hook-and-loop tabs on the underside of the rainfly from poles.
- Detach the rainfly, fold up and set aside.
- Remove leg poles; then remove screen lip pole from sleeve on screen room and roof poles from sleeves at top & outside of tent.
- Disconnect and fold leg and roof poles; then place in pole storage bag.
- Fold and roll tent to remove excess air.
- Store in carry bag with rainfly, pole storage bag and bag of stakes.

STORING THE TENT

- All stakes, leg and roof poles must be placed in their own storage bags before placing in tent carrying bag to prevent damage to the tent fabric.
- Store in a clean, dry area.

(continued on other side)

FREQUENTLY ASKED QUESTIONS:

- **Are replacement parts available?** Yes, just call Customer Service at 1-888-775-5628 for replacement parts. All parts can be replaced.
- **How do I get everything back in the bag?** The trick is to take your time and remove all the air. Use the weight of the poles to roll the tent on the ground and force air out. The tent components fit in the bag, it's the air that doesn't.
- **What is the air intake?** The air intake is a ground vent, designed to help with air flow throughout the tent, keep the tent cooler in warm weather, and prevent condensation. It can be staked shut in colder weather.
- **What is the wall plug symbol?** That is a port for an electrical cord to access your tent. The electrical cord can be used on a campsite with power or with a generator outside your tent. It closes fully when not in use.
- **Where does the gear loft go?** It hangs at the top of the inside of the tent. There are five hooks sewn onto the gear loft that attach to five loops sewn into the tent.
- **How to clean the tent?** Clean the tent with a soft sponge, a mild soap and tepid water. Be sure to scrub gently and remove all soap. Let dry in sunlight, which also naturally cleans the tent.
- **Can the tent be used in the rain?** Absolutely. The tent and rainfly have a waterproof treatment, and the seams have been sealed with waterproof tape at the factory.
- **How many seasons is this tent?** This is a 2-3 season tent, not recommended for use in severe weather conditions.
- **What are the dimensions of the tent?** The tent is 17' x 12' x 86" (518 cm x 366 cm x 218 cm).

WARNINGS & CAUTIONS:

⚠ WARNING: KEEP ALL FLAME AND HEAT SOURCES AWAY FROM THIS TENT FABRIC

This tent is made of flame-resistant fabric which meets CPAI-84 specifications. **IT IS NOT FIRE-PROOF.** The fabric will burn if left in continuous contact with any flame source. The application of any foreign substance to the product fabric may render the flame-resistant properties ineffective.

DO NOT use fuel burning devices inside or near tent materials.

DO NOT permit children to light matches, operate burning appliances, or handle any flame sources in or near the tent.

- Do not smoke, use matches, candles or open flames of any kind in or near the tent.
- Do not refuel lanterns, stoves or heaters inside tent.
- Do not cook inside tent.
- Do not store flammable liquids inside tent.

⚠ WARNING: Keep clear of overhead power lines.

- Do not set up your tent under trees because of potential lightning strikes or falling tree limbs in inclement weather.
- For best results in windy conditions, position narrow end of tent into the wind.
- Secure with all stakes and guylines provided to prevent property damage or personal injury.
- Under certain conditions (cold weather, high humidity, etc.) condensation will form on the inside of your tent. Condensation is caused by water vapor from your breath, perspiration, or any wet clothing inside the tent. It is NOT LEAKAGE through the tent fabric. It can be minimized by removing wet clothing from your tent and by providing good ventilation through the tent.
- Never store tent, even for a short period of time, without drying it thoroughly and brushing off caked dirt. Do not pack stakes inside your tent. Use a separate storage bag.
- STAKES SHOULD BE REMOVED BY PULLING ON THE STAKE ITSELF. NEVER PULL ON THE TENT TO REMOVE STAKE.
- Do not leave your tent set-up for weeks at a time. Be aware that exposure to ultraviolet rays from the sun can seriously damage material and/or cause it to become discolored.



IMPORTANT:

THE ORIGINAL FIRE RETARDANT AND WATER REPELLENT PROTECTIVE COATINGS MAY BE COMPROMISED IF SPRAYS OR OTHER CHEMICAL TREATMENTS ARE USED ON THE TENT. FABRIC HAS BEEN FACTORY TREATED. IT IS HIGHLY WATER-REPELLANT; HOWEVER, IT IS NOT WATERPROOF. ALL TENTS CAN EXPERIENCE SEAM LEAKAGE DURING WET WEATHER. IF YOU WANT ADDITIONAL MOISTURE PROTECTION, TRY A SEAM SEALING COMPOUND ONLY; STRICTLY FOLLOW THE MANUFACTURER'S DIRECTIONS. IT IS RECOMMENDED THAT YOU SEAL THE TENT DURING THE INITIAL SETUP AS WELL AS PRIOR TO EACH CAMPING SEASON. SEAM SEALER COMPOUNDS CAN BE PURCHASED AT YOUR LOCAL CAMPING PRODUCTS OUTLET. FOR MISSING PARTS CALL 1-888-775-5628.

PLEASE DO NOT RETURN THIS PRODUCT TO THE RETAIL STORE.

1-YEAR LIMITED WARRANTY:

CORE® Equipment and Elevate LLC warrants for a period of 1 (one) year from the original date of purchase, this product against any defects in materials or workmanship. At its discretion, CORE® Equipment may provide replacement parts to original purchaser. Original receipt or proof of purchase as well as proof of defect in the form of a photograph or video is required. CORE® Equipment will not be responsible for shipping costs incurred outside the continental USA. Warranty is valid for the original purchaser one year from the date of purchase and is not transferable.

This Warranty does not cover any product purchased through unauthorized dealers/distributors and/or unauthorized resellers on online auction websites. CORE uses approved and authorized distributors to furnish quality products, and CORE provides warranty coverage only on products purchased from those distributors. If the product was purchased from an unauthorized reseller, this warranty does not apply. Unauthorized resellers may sell products that are used, defective, counterfeit, or which may not be designed for use in that specific country. To determine whether the seller of a CORE® Equipment product is one that has been approved and authorized by Elevate LLC owner of the CORE® Equipment brand, please contact help@coreequipment.com or call customer service at 1-888-775-5628.

This 1-Year Limited Warranty does NOT cover normal wear and tear, abuse or misuse of this product including damage from inclement weather conditions, such as wind, rain, or hail. In case of inclement weather remove all valuables and persons and seek appropriate shelter. Under no circumstances will CORE® Equipment or Elevate LLC be liable or responsible for any incidental or consequential damages. This product is designed and intended for Recreational use only. Prolonged exposure to UV rays will cause any fabric to fade and deteriorate and is NOT covered by this 1-Year Limited Warranty. All replacement products or parts will assume the remaining warranty of the original product. This warranty gives you specific legal rights. You may also have other rights which vary from state to state. To Obtain Warranty Service: Call Toll Free 1-888-775-5628 for warranty service, repair parts, or product questions. Monday - Friday, 8:00 a.m. - 5:00 p.m. Central Time.

Elevate LLC
Overland Park, KS 66221

Made in Bangladesh • Printed in Bangladesh

Revised 03/28/18
(Rev A)