

# CORE™ 10 PERSON STRAIGHT WALL CABIN TENT - 14 x 10

Model No. 40034

Two people are recommended to set up this tent.

## Contents & Repair Parts:

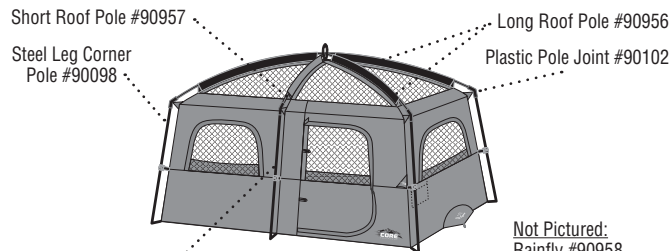

Not Pictured:  
Rainfly #90958  
Gear Loft #90959  
Room Divider #90960  
Carry Bag #90961

- 1** • Empty contents of bag and confirm all parts are included and undamaged.

**NOTE:** Do this at home before you leave on your trip.

- Select a smooth level site and lay out your tent.
- Extend tent poles and place in position ready for installation.

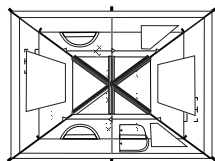

## 2 Roof Poles

- Slide the GRAY CENTER ROOF POLE into GRAY ROOF SLEEVES and through the MESH LOOP; then secure by inserting both pole ends into ribbed end of center ELBOW CONNECTORS. **(Details 1 & 2)**
- Slide BLACK TENT ROOF POLES into BLACK SLEEVES and through the MESH LOOP. Insert one end of first pole into ribbed end of ELBOW CONNECTOR. Gently flex pole and insert other end of pole into ribbed end of elbow connector at opposite corner. Repeat for second Tent Roof Pole. **(Details 1 & 2)**

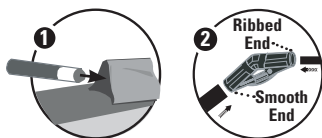

## 3 Leg Poles

- At the back center of tent, place one end of a STEEL MIDDLE LEG POLE with METAL D-RING into the smooth end of ELBOW CONNECTOR, then secure the other end of the LEG POLE onto the PIN-RING at base of tent. **(Detail 2 & 3)**
- Repeat step above for the remaining STEEL MIDDLE LEG POLE with METAL HOOK at the front center of tent.
- At a corner of the tent, place one end of a STEEL LEG CORNER POLE into the smooth end of ELBOW CONNECTOR, then secure the other end into the PIN-RINGS at base of tent. **(Detail 2 & 3)**
- Repeat step above for the remaining 3 corner poles.
- Snap QUICK CLIPS (attached to tent body) onto all STEEL LEG MIDDLE & CORNER LEG POLES to shape the tent. **(Detail 4)**

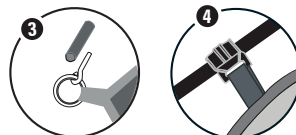

## 4 Stake Tent

- To stake out the tent, drive STAKES through the PIN-RING assemblies on the tent base. **(Detail 5)**
- NOTE:** Floor of tent should be taut when staked properly.

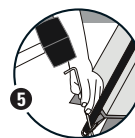

## 5 Attach Rainfly

- Drape RAINFLY over tent. Connect S-HOOK on the RAINFLY into the PIN-RING at the 4 corners of tent. Connect S-HOOK on the RAINFLY into the METAL D-RING at the front and back STEEL LEG MIDDLE POLES. **(Detail 6 & 7)**
- Locate HOOK AND LOOP FASTENERS on the underside of the RAINFLY and secure around tent poles. **(Detail 8)**

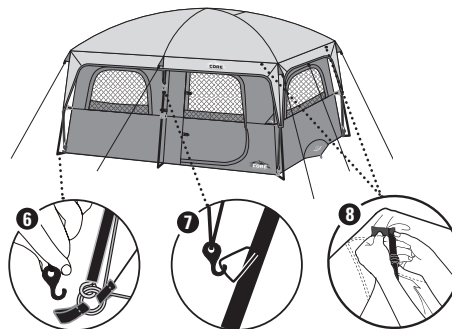

## 6 Stake Guylines

- To stabilize the tent, unroll the GUYLINES attached to the WEB-BING LOOPS on the RAINFLY. Make a loop at the opposite end of the GUYLINE using the PLASTIC SLIDER and place the loop over the tent STAKE. **(Detail 9)**
- Drive the STAKE into the ground to secure.
- Adjust the PLASTIC SLIDER to tighten the GUYLINE. Repeat for each GUYLINE. **(Detail 9)**

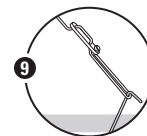

## 7 Install Gear Loft & Divider Curtain

- The GEAR LOFT is for extra storage of light weight items (i.e. maps, eyeglasses). Attach its S-hooks to the fabric loops inside middle of the tent. **(Detail 10)**
- The DIVIDER CURTAIN provides extra privacy in your tent. To install it, attach divider's plastic toggles to corresponding loops on the wall inside the tent. **(Detail 11)**

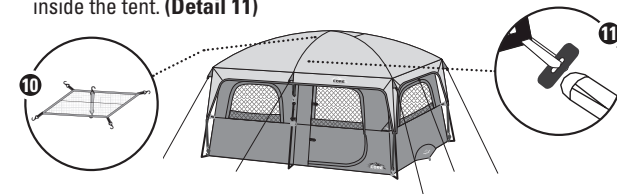

## TAKE DOWN INSTRUCTIONS:

- Remove gear loft and curtain divider from inside of tent.
- Remove all stakes from tent and guylines. Store in stake bag.
- Unhook plastic clip on the elastic rainfly strap from the round loop at corners of the tent.
- Unfasten hook-and-loop tabs on underside of the rainfly from poles.
- Detach the rainfly, fold up and set aside.
- Remove leg poles; then remove roof poles from sleeve at top of tent.
- Disconnect and fold leg and roof poles; then place in pole storage bag.
- Fold and roll tent to remove excess air.
- Store in carry bag with rainfly, divider curtain, pole storage bag and bag of stakes.

## STORING THE TENT

- All stakes, leg and roof poles must be placed in their own storage bags before placing in tent carrying bag to prevent damage to the tent fabric.
- Store in a clean, dry area.

(continued on other side)

## FREQUENTLY ASKED QUESTIONS:

- **Are replacement parts available?** Yes, just call Customer Service at 1-888-774-5840 for replacement parts. All parts can be replaced.
- **How do I get everything back in the bag?** The trick is to take your time and remove all the air. Use the weight of the poles to roll the tent on the ground and force air out. The tent components fit in the bag, it's the air that doesn't.
- **What is the air intake?** The air intake is a ground vent, designed to help with air flow throughout the tent, keep the tent cooler in warm weather, and prevent condensation. It can be staked shut in colder weather.
- **What is the wall plug symbol?** That is a port for an electrical cord to access your tent. The electrical cord can be used on a campsite with power or with a generator outside your tent. It closes fully when not in use.
- **Where does the gear loft go?** It hangs at the top of the inside of the tent. There are five hooks sewn onto the gear loft that attach to five loops sewn into the tent.
- **How to clean the tent?** Clean the tent with a soft sponge, a mild soap and tepid water. Be sure to scrub gently and remove all soap. Let dry in sunlight, which also naturally cleans the tent.
- **Can the tent be used in the rain?** Absolutely. The tent and rainfly have a waterproof treatment, and the seams have been sealed with waterproof tape at the factory.
- **How many seasons is this tent?** This is a 2-3 season tent, not recommended for use in severe weather conditions.
- **What are the dimensions of the tent?** The tent is 14' x 10' x 86" (426 cm x 304 cm x 218 cm).

## WARNINGS & CAUTIONS:

### **⚠ WARNING: KEEP ALL FLAME AND HEAT SOURCES AWAY FROM THIS TENT FABRIC**

This tent is made of flame-resistant fabric which meets CPAI-84 specifications. **IT IS NOT FIRE-PROOF.** The fabric will burn if left in continuous contact with any flame source. The application of any foreign substance to the product fabric may render the flame-resistant properties ineffective.

**DO NOT** use fuel burning devices inside or near tent materials.

**DO NOT** permit children to light matches, operate burning appliances, or handle any flame sources in or near the tent.

- Do not smoke, use matches, candles or open flames of any kind in or near the tent.
- Do not refuel lanterns, stoves or heaters inside tent.
- Do not cook inside tent.
- Do not store flammable liquids inside tent.

### **⚠ WARNING: Keep clear of overhead power lines.**

- Do not set up your tent under trees because of potential lightning strikes or falling tree limbs in inclement weather.
- For best results in windy conditions, position narrow end of tent into the wind.
- Secure with all stakes and guylines provided to prevent property damage or personal injury.
- Under certain conditions (cold weather, high humidity, etc.) condensation will form on the inside of your tent. Condensation is caused by water vapor from your breath, perspiration, or any wet clothing inside the tent. It is NOT LEAKAGE through the tent fabric. It can be minimized by removing wet clothing from your tent and by providing good ventilation through the tent.
- Never store tent, even for a short period of time, without drying it thoroughly and brushing off caked dirt. Do not pack stakes inside your tent. Use a separate storage bag.
- **STAKES SHOULD BE REMOVED BY PULLING ON THE STAKE ITSELF. NEVER PULL ON THE TENT TO REMOVE STAKE.**
- Do not leave your tent set-up for weeks at a time. Be aware that exposure to ultraviolet rays from the sun can seriously damage material and/or cause it to become discolored.



### **IMPORTANT:**

THE ORIGINAL FIRE RETARDENT AND WATER REPELLENT PROTECTIVE COATINGS MAY BE COMPROMISED IF SPRAYS OR OTHER CHEMICAL TREATMENTS ARE USED ON THE TENT. FABRIC HAS BEEN FACTORY TREATED. IT IS HIGHLY WATER-REPELLANT; HOWEVER, IT IS NOT WATERPROOF. ALL TENTS CAN EXPERIENCE SEAM LEAKAGE DURING WET WEATHER. IF YOU WANT ADDITIONAL MOISTURE PROTECTION, TRY A SEAM SEALING COMPOUND ONLY; STRICTLY FOLLOW THE MANUFACTURER'S DIRECTIONS. IT IS RECOMMENDED THAT YOU SEAL THE TENT DURING THE INITIAL SETUP AS WELL AS PRIOR TO EACH CAMPING SEASON. SEAM SEALER COMPOUNDS CAN BE PURCHASED AT YOUR LOCAL CAMPING PRODUCTS OUTLET. FOR MISSING PARTS CALL 1-888-774-5840.

**RETURN THIS PRODUCT TO THE RETAIL STORE.**

## 1-YEAR LIMITED WARRANTY:

Elevate LLC warrants for a period of 1 year from the original date of purchase, this product against any defects in materials or workmanship. At its discretion, Elevate LLC may provide replacement parts to original purchaser. Original receipt or proof of purchase as well as proof of defect is required. Elevate LLC will not be responsible for shipping costs incurred outside the continental USA. Warranty is valid for the original purchaser one year from the date of purchase and is not transferable. This Warranty does not cover any product purchased through non authorized dealers and/or online auction websites.

### **This Warranty Does Not Cover:**

This 1-Year Limited Warranty does NOT cover normal wear and tear, abuse or misuse of this product including damage from inclement weather conditions, such as wind, rain, or hail. In case of inclement weather remove all valuables and persons and seek appropriate tent. Under no circumstances will Elevate LLC be liable or responsible for any incidental or consequential damages.

This product is designed and intended for Recreational use only. Prolonged exposure to UV rays will cause any fabric to fade and deteriorate and is NOT covered by this 1-Year Limited Warranty.

All replacement products or parts will assume the remaining warranty of the original product. This warranty gives you specific legal rights. You may also have other rights which vary from state to state.

### **To Obtain Warranty Service**

Call Toll Free 1-888-774-5840 for warranty service, repair parts, or product questions. Mon-Fri, 8:00 a.m. – 5:00 p.m. Central Time.

**NOTICE: DO NOT RETURN PRODUCT TO RETAIL STORE.**

Elevate LLC  
Overland Park, KS 66221

Made in Bangladesh • Printed in Bangladesh

Now 01/20/17