



INSTALLATION GUIDE

SIMBOOTH 2

TABLE OF CONTENTS

INSTALLATION

Parts list	3-5
Structure assembly	6-10
Floor installation	11-12
Optional (Half-wall, rafter and projector)	13-14



PARTS LIST

WALL PANELS

RIGHT WALL

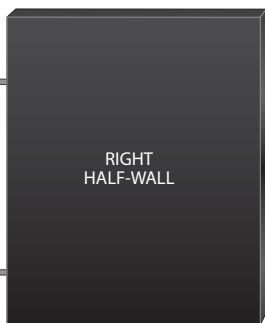
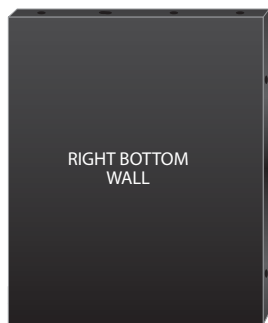
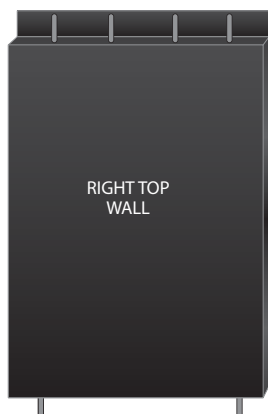

LEFT WALL

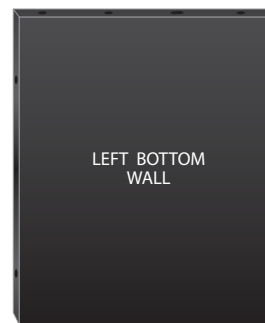
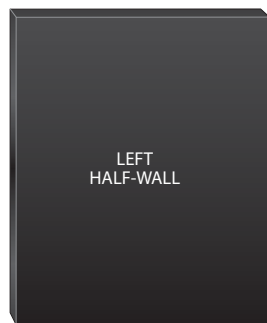
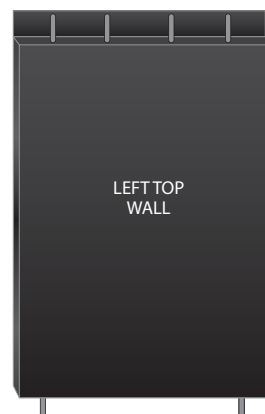

CEILING PANELS

BACK CEILING



FRONT CEILING

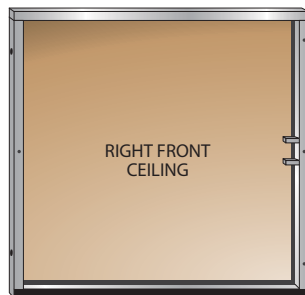
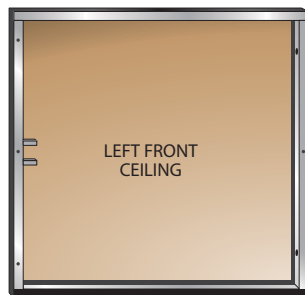

PARTS LIST

FLOOR PANELS

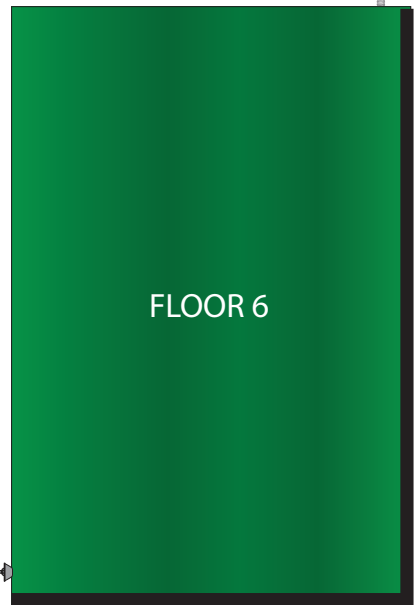
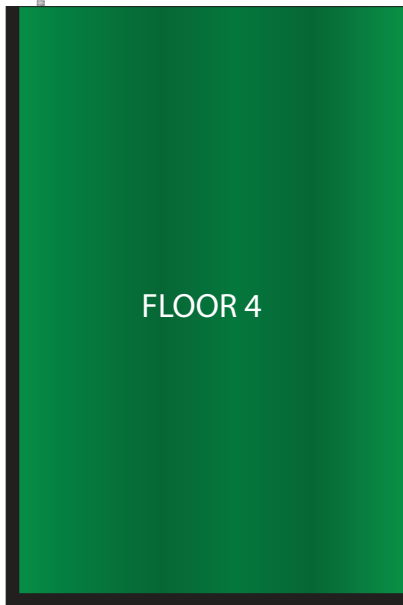
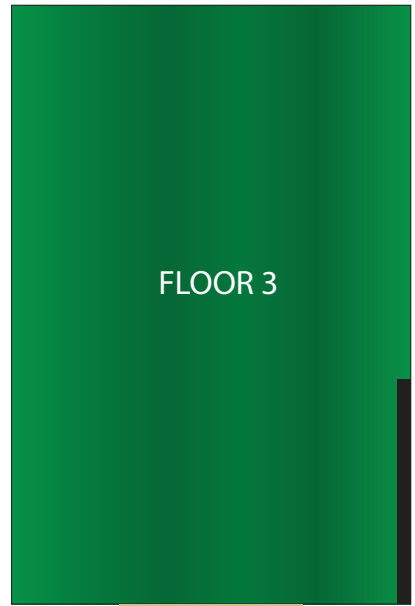
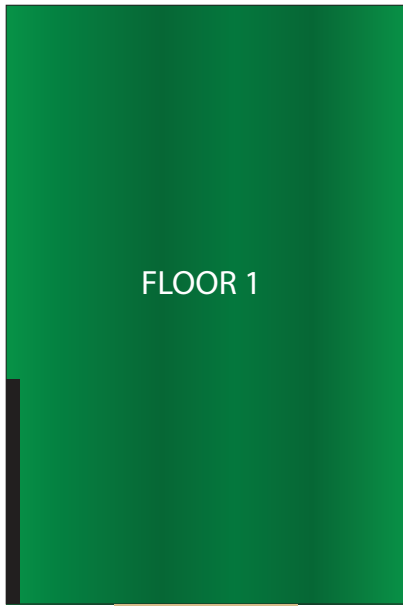

PARTS LIST

ACCESSORIES

HITTING MAT



BOLTS 3-1/2" (12 X)



WASHERS (46 X)



NUTS (34 X)



BLACK IMPACT NETTING



WHITE SCREEN



CEILING TRUSSES (2X)

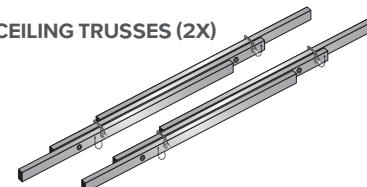

TEES (PACK OF 10)



OPTIONAL

PROJECTOR



PROJECTOR REMOTE



BEFORE STARTING

You will need four people, two ladders, and two 1/2" wrenches.

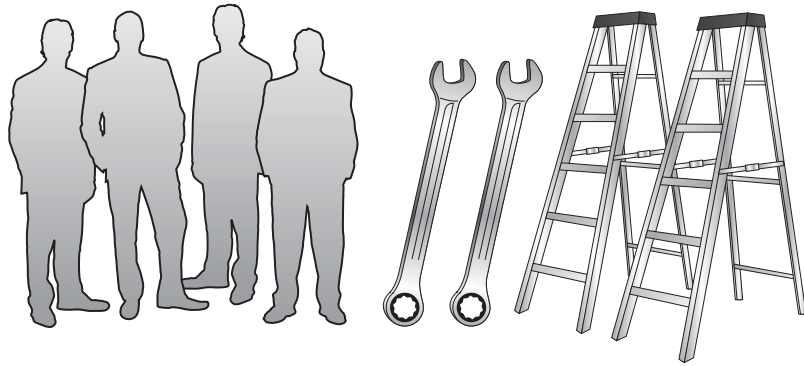

1

Fix the left top wall to the left front ceiling with the nuts.



2

Using the nuts, fix the middle front ceiling to the left front ceiling, then fix right front ceiling to the middle front ceiling.

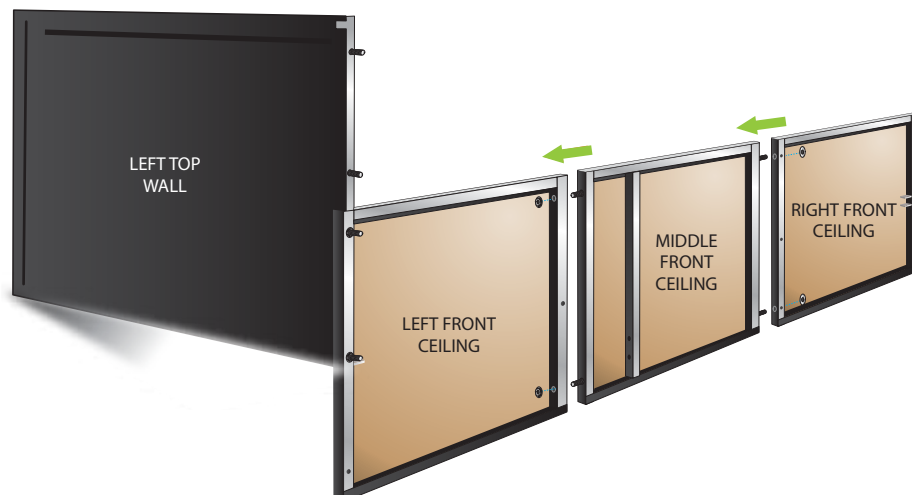

3

Using the nuts, fix the right front ceiling to the right top wall.

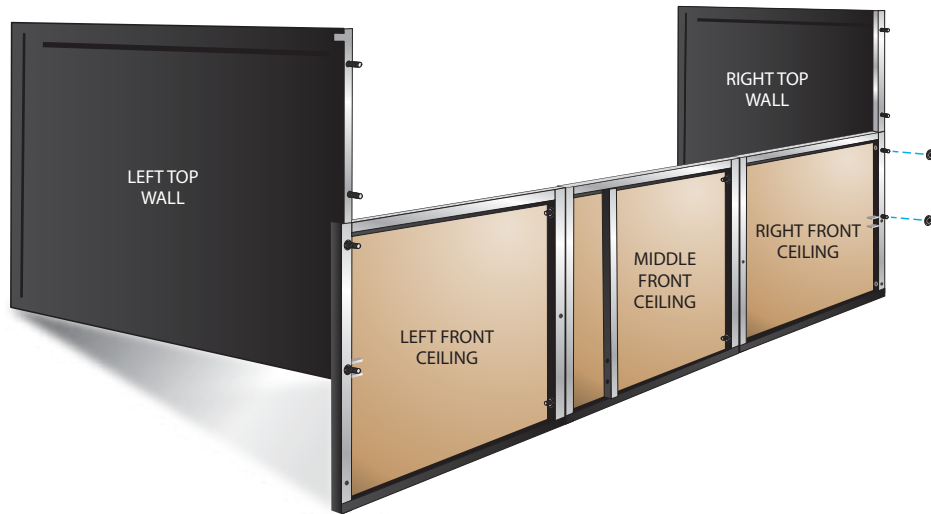

4

Fix both bottom wall panels to the top wall panels with the nuts by removing the bottom wall covers (velcro).

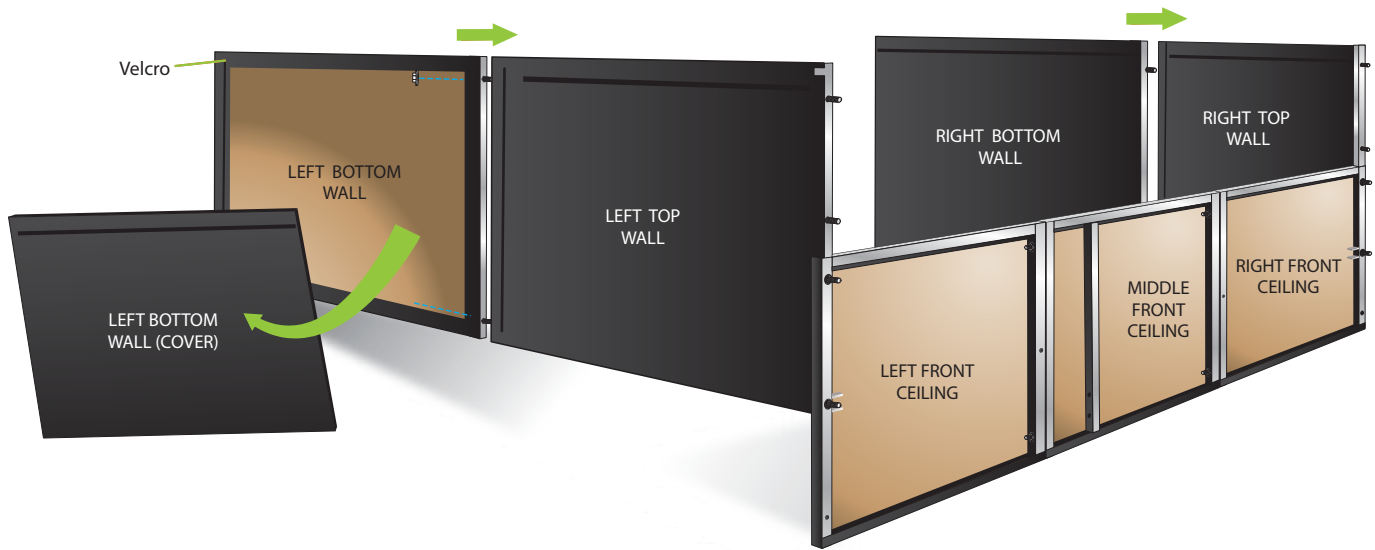

5

Fix the left back ceiling to the left top wall with the nuts.



6

Using the nuts, fix the middle back ceiling to the left back ceiling and fix the right back ceiling to the middle back ceiling. Then, fix the two middle ceilings together.

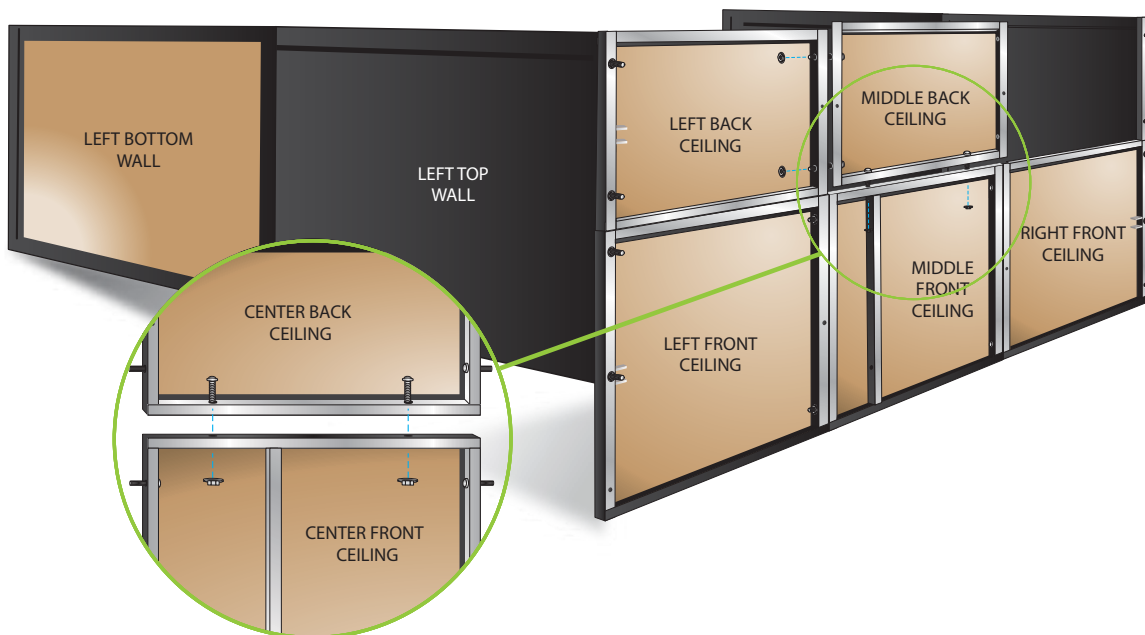

7

Fix the right back ceiling to the right top wall with the nuts.



8

CEILING TRUSS INSTALLATION

Assemble the ceiling trusses with bolts and security pins, then insert them in the back ceiling and the front ceiling.

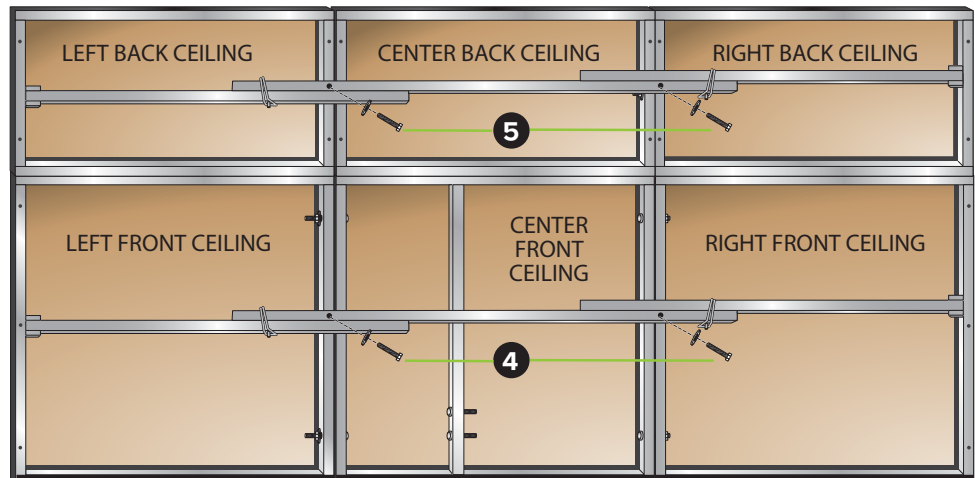
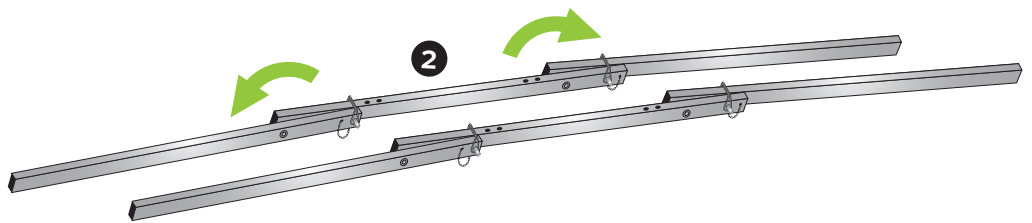
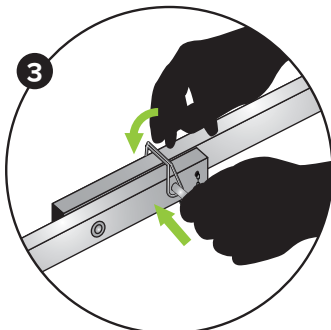
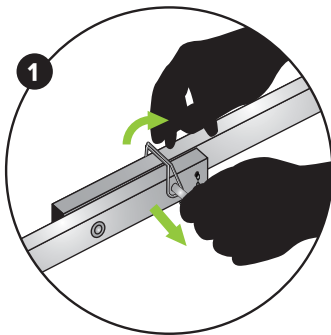

IT IS IMPORTANT TO COMPLETE THIS STEP BEFORE LIFTING THE STRUCTURE.

9

Attach the white screen to the structure.



10

Attach the black impact netting over the white screen. Make sure it is attached to the top velcro on the ceiling panels and that the bottom doesn't rest on the floor.

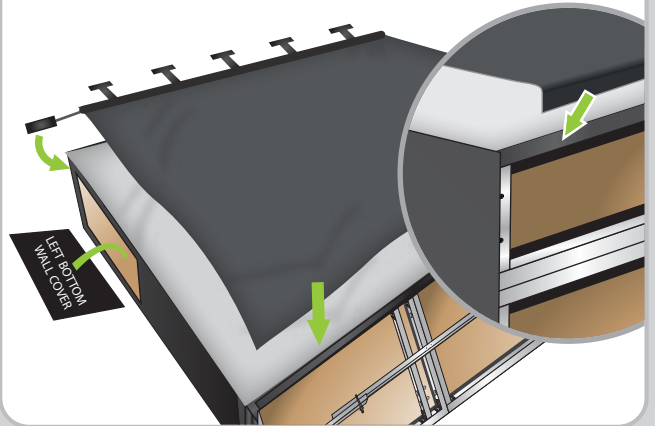

11

Lift the structure with four people.

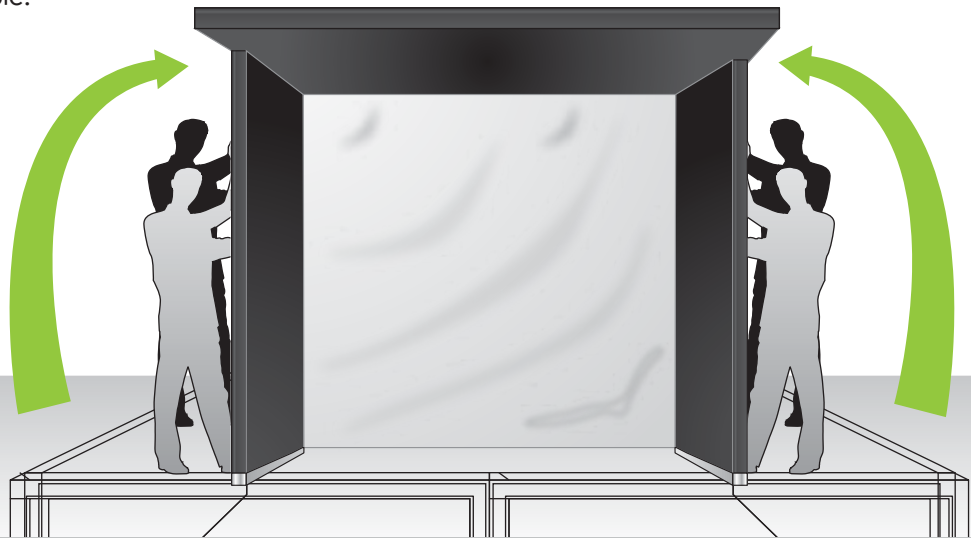

END OF STRUCTURE ASSEMBLY SECTION

1

Install the floor sections in order (1 to 6).

A and **B** you will need bolts washers and nuts. **C** you will need washers and nuts.

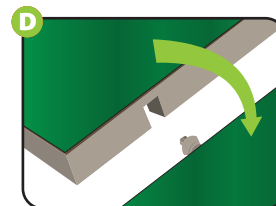
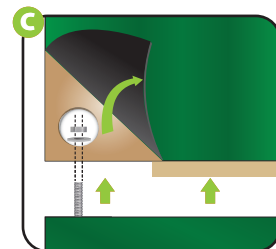
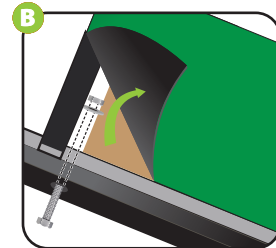
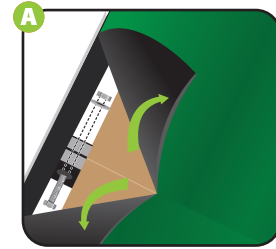
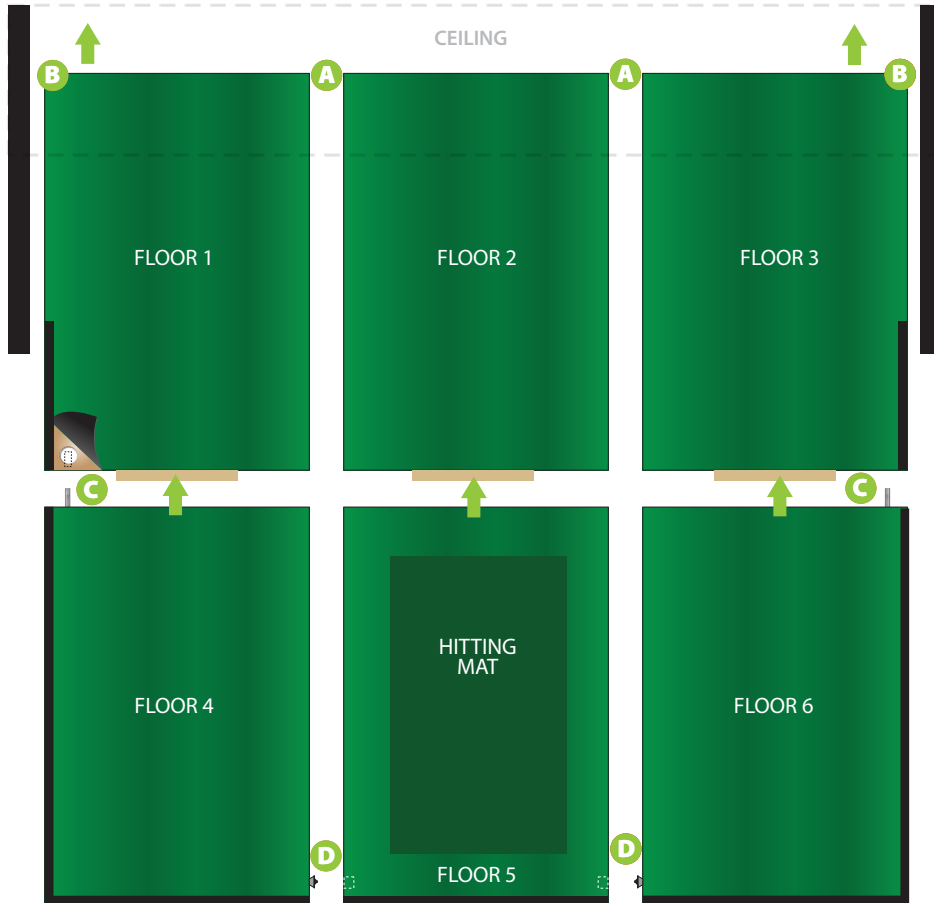

2

Step 1

Lift green carpet.

Step 2

Stretch the white screen behind and under the aluminum bar and reach for it through the space.

Step 3

Fix the screen on half of the velcro on the aluminum bar

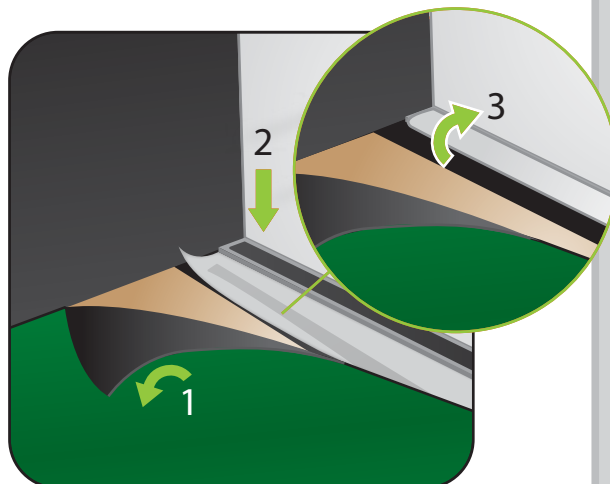

3

Step 1
Lift green carpet.

Step 2
Stretch the white screen behind
and under the aluminum bar
and reach for it through the space.

Step 3
Stick it on the remaining half
of the aluminum bar velcro.

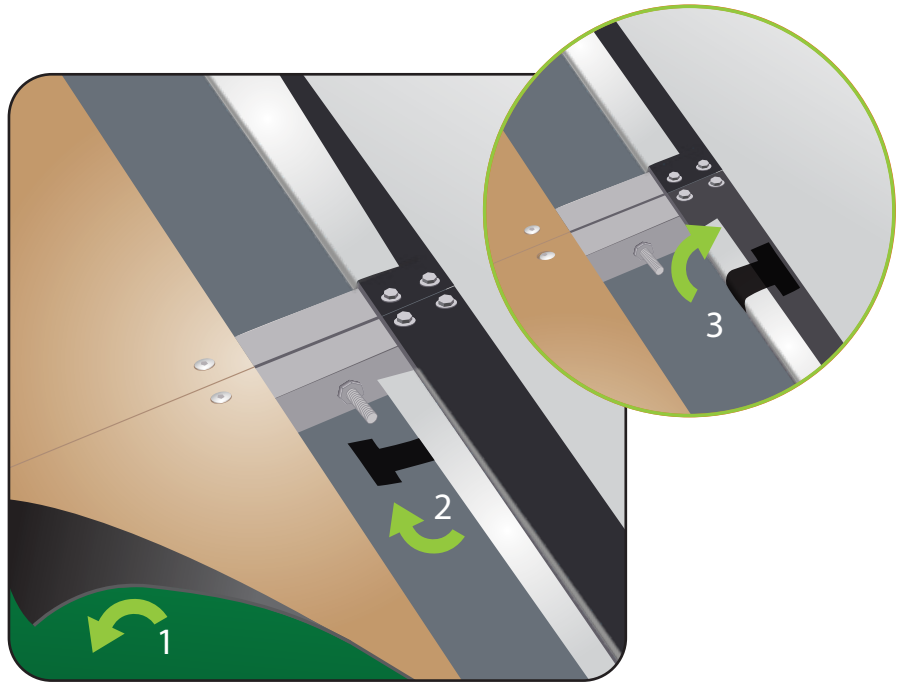

END OF FLOOR INSTALLATION SECTION

1

Fix the half-walls to the structure with washers and nuts. Then, install the removable panel on the bottom walls with the velcro.

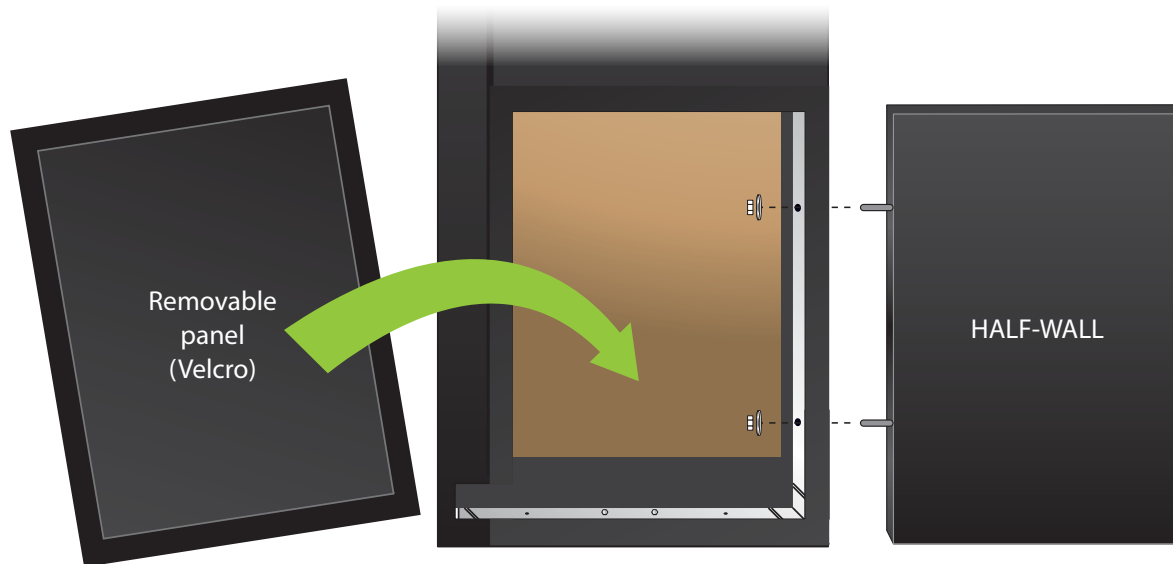

END OF HALF-WALLS INSTALLATION SECTION

1

Attach the projector on the projector mount. Refer to the instruction sheet inside the projector box.

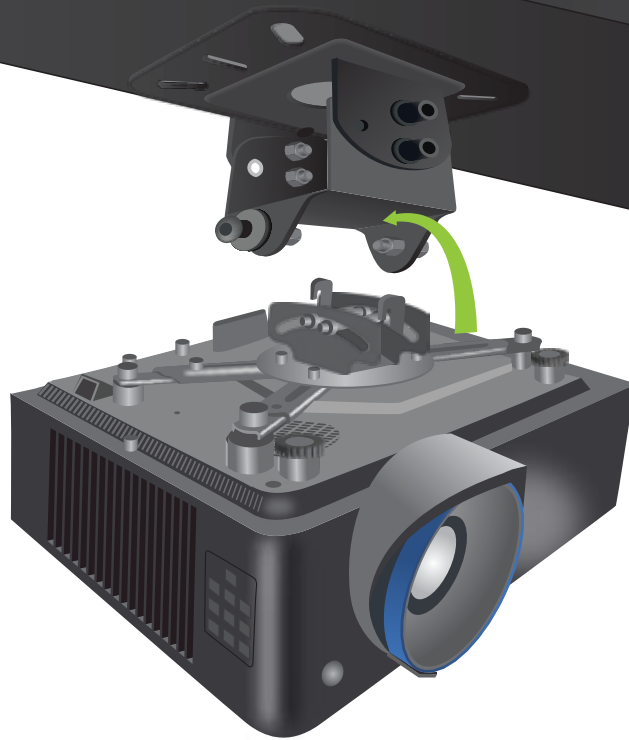

END OF PROJECTOR INSTALLATION SECTION