



Casterland

Wheels — Casters — Glides — Bearings — Handling Equipment

Service and Selection Since 1975

Bearings & Accessories Catalog



CALGARY

EDMONTON

WINNIPEG

PITT MEADOWS

SASKATCHEWAN

Visit our website for our full product listing at www.Casterland.com



Product

Our full line of bearings are manufactured by some of the leading manufacturers in the industry. In addition to the products listed in this catalog, many other products or special order items are available upon request. Please consult our order desk.

Limited Warranty: General Provisions

Casterland warrants to the original purchaser of its product that the product will be free from defects in material and workmanship for a period of 90 days after the date of delivery to the original purchaser.

This limited warranty is not effective with respect to products that are not properly installed or not used in the proper application based on loads, speeds and other factors. This warranty does not apply to products damaged or destroyed as a result of shipping.

Freight Policy

All goods ordered from this catalog are FOB our original purchase point warehouses and shipped via freight collect. Orders over \$500.00 may be eligible for a freight reduction of half the original freight cost to a major centre by a carrier of our choice. Any large orders or O.E.M. customers may be eligible for prepaid orders to a major centre by a carrier of our choice.

Pricing

Prices are subject to change without notice. Casterland makes an effort to hold prices for a minimum of one year, however, occasionally circumstances arise which are beyond our control.

Terms

We accept Visa, MasterCard, Debit, and net 30 days on approved credit. First time orders may be subject to COD terms or a maximum charge amount depending on credit approval.

Hours of Operation

Casterland is open from 8:00am to 5pm weekdays and 10am to 2pm Saturdays. Please call the branch nearest you for applicable hours of operation.

The difference of Precision ball bearings.

The bearing you select for your wheel has a great impact on the overall performance of your equipment.

Precision ball bearings require less maintenance than other bearing styles leading to lower maintenance costs. They are also an excellent method of increasing weight capacity.

The ergonomics of precision bearings also help in reducing injury or fatigue by improving rollability.



Regular Flanged Bearing
(not sealed or machined steel)



Sealed Precision
Flanged Bearings
(sealed)

Visit our website or give any of our locations a call for more information about any of our products or hints and application tips.

<p>Casterland Calgary 2600 Portland St SE Calgary, AB T2G 4M6</p> <p>Tel: 403 243 3553 infocal@casterland.com</p>	<p>Casterland Edmonton 9743 51 Ave NW, Edmonton, AB T6E 4W8</p> <p>Tel: 780 432 5575 infoedm@casterland.com</p>	<p>Casterland Pitt Meadows 950-19800 Lougheed Hwy Pitt Meadows, BC V3Y2W1</p> <p>Tel: 604 543 7744 infobc@casterland.com</p>	<p>Casterland Winnipeg 2875 Century St, Winnipeg, MB R3H 0M3</p> <p>Tel: 204 783 5500 info@casterland.com</p>	<p>Casterland Sask Representative: Dean Fraser</p> <p>Tel: 306 501 3954 dean_f@casterland.com</p>
--	--	---	--	--

ROLLER BEARINGS



Roller bearings with sleeves are generally used in caster wheels, offering the best compromise between capacity, rollability and value in a bearing.

ROLLER BEARINGS

without sleeves



Sleeveless or open cage roller bearings are usually used in lawn and garden applications.

Part Number	Inner Diameter	Outer Diameter	Length
BCRB12125	1/2"	1-1/16"	1-1/8"
BCRB34150	3/4"	1-3/16"	1-3/8"
BCRB34200	3/4"	1-3/16"	1-7/8"
BCRB34250	3/4"	1-3/16"	2-1/2"
BCRB58150	5/8"	1-3/16"	1-3/8"
BCRB58200	5/8"	1-3/16"	1-7/8"
BCRB10200	1"	1-7/16"	2"
BCRB10250	1"	1-15/16"	2-1/2"
BCRB10300	1"	1-15/16"	3"
BCRB10400	1"	1-15/16"	4"
BCRB14250	1-1/4"	1-15/16"	2-1/2"
BCRB14300	1-1/4"	1-15/16"	3"
BCRB142300	1-1/4"	2-7/16"	3"
BCRB142400	1-1/4"	2-7/16"	4"
BCRB142500	1-1/4"	2-7/16"	5"
BCRB152300	1-1/2"	2-7/16"	3"
BCRB152400	1-1/2"	2-7/16"	4"
BCRB152500	1-1/2"	2-7/16"	5"

OD includes sleeve

Part Number	Inner Diameter	Outer Diameter	Length
BCRB58138100	5/8"	1-3/8"	1"
BCRB58138225	5/8"	1-3/8"	2-1/4"
BCRB58138325	5/8"	1-3/8"	3-1/4"
BCRB78138250	7/8"	1-3/8"	2-1/2"
BCRB34138100	3/4"	1-3/8"	1"
BCRB34138150	3/4"	1-3/8"	1-1/2"
BCRB34138225	3/4"	1-3/8"	2-1/4"
BCRB34138250	3/4"	1-3/8"	2-1/2"
BCRB34138275	3/4"	1-3/8"	2 3/4"
BCRB34138300	3/4"	1-3/8"	3"
BCRB34138325	3/4"	1-3/8"	3-1/4"
BCRB34138375	3/4"	1-3/8"	3-3/4"
BCRB10138100	1"	1-3/8"	1"
BCRB10138134	1"	1-3/8"	1-3/4"
BCRB10138150	1"	1-3/8"	1-1/2"
BCRB10138225	1"	1-3/8"	2-1/4"
BCRB10138250	1"	1-3/8"	2-1/2"
BCRB10138325	1"	1-3/8"	3-1/4"

HEAVY DUTY ROLLER BEARINGS

Solid outer sleeve for simplified installation and improved grease retention



Part Number	Inner Diameter	Outer Diameter	Length
BCHRB58150	5/8"	1-3/16"	1-3/8"
BCHRB58178	5/8"	1-3/16"	1-7/8"
BCHRB34150	3/4"	1-3/16"	1-3/8"
BCHRB34178	3/4"	1-3/16"	1-7/8"

OD includes sleeve

STAINLESS STEEL ROLLER BEARINGS

Fully stainless steel version of our standard roller bearing. Provides higher capacity and improved rollability over Delrin bearings with a longer life span.



Part Number	Inner Diameter	Outer Diameter	Length
BCSSRB34150	3/4"	1-3/16"	1-3/8"
BCSSRB34200	3/4"	1-3/16"	2"
BCSSRB10300	1"	1-15/16"	3"

OD includes sleeve

ONE PIECE DELRIN BEARINGS

A one piece insert bearing constructed from Delrin material useful in wet environments.



Part Number	Inner Diameter	Outer Diameter	Length	Part Number	Inner Diameter	Outer Diameter	Length
BCDB12150	1/2"	1-3/16"	1-5/8"	BCDB34200	3/4"	1-3/16"	2-1/8"
BCDB12200	1/2"	1-3/16"	2-1/8"	BCDB10250	1"	1-15/16"	1-1/4"
BCDB58150	5/8"	1-3/16"	1-5/8"	BCDB10300	1"	1-15/16"	1-1/2"
BCDB58200	5/8"	1-3/16"	2-1/8"	BCDB14250	1 1/4"	1-15/16"	1-1/4"
BCDB34150	3/4"	1-3/16"	1-5/8"	BCDB14300	1 1/4"	1-15/16"	1-1/2"

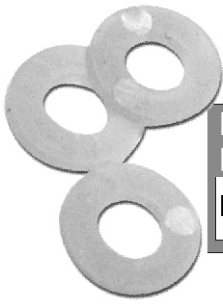

NYLON RETAINER WASHERS

Part Number	Inner Diameter	Outer Diameter
BCNW34136	3/4"	1-3/16"

DOUBLE NYLON RETAINER WASHERS

Part Number	Inner Diameter	Outer Diameter
BCDW58136	5/8"	1-3/16"
BCDW34136	3/4"	1-3/16"



VULCA SEALS



Part Number	Inner Diameter	Outer Diameter
BCVS58136	5/8"	1-3/16"
BCVS34136	3/4"	1-3/16"
BCVS10115	1"	1-15/16"
BCVS14115	1-1/4"	1-15/16"
BCVS14276	1-1/4"	2-7/16"
BCVS15276	1-1/2"	2-7/16"



TOP HATS

(SPACERS FOR PRECISION BALL BEARINGS)

Part Number	Inner Diameter	Outer Diameter	Length
BCTH3858	3/8"	5/8"	3/4"
BCTH1217M	12mm	17mm	1-1/4"

STEEL RETAINER WASHERS



Part Number	Inner Diameter	Outer Diameter
BCRW34136	3/4"	1-3/16"
BCRW10115	1"	1-15/16"
BCRW10176	1"	1-7/16"
BCRW14115	1-1/4"	1-15/16"
BCRW15276	1-1/2"	2-7/16"

STEEL THRUST WASHERS

Part Number	Inner Diameter
BCTW 58TH	5/8"
BCTW 34TH	3/4"
BCTW 10	1"
BCTW 12	1/2"
BCTW 14	1-1/4"
BCTW 15	1-1/2"



STAINLESS STEEL THRUST WASHERS

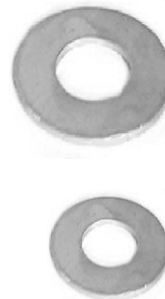

Part Number	Inner Diameter
BCSSTW12	1/2"
BCSSTW34	3/4"
BCSSTW10	1"

Washers and Top Hats - Selection and Installation Guide

Different bearing types require different combinations of washers to ensure proper operation of the wheel. Here is a brief guide:

- Retainer washers are used to "retain" or hold in place Roller Bearings.
- Thrust washers are used in conjunction with Retainer Washers to keep the caster fork legs from compressing against the side of the wheel.
- Double Nylon Washers are a combination of a Retainer Washer and Thrust washer together in one piece.

FLANGED BALL BEARINGS

Part Number	Inner Diameter	Outer Diameter
BCBB76178HEX	7/16"	1-7/8"
BCBB76116	7/16"	1-1/16"
BCBB38136	3/8"	1-3/16"
BCBB12136 L	1/2"	1-3/16"
BCBB12138	1/2"	1-3/8"
BCBB58138	5/8"	1-3/8"
BCBB34138	3/4"	1-3/8"
BCBB10200	1"	2"



FLANGED PRECISION BALL BEARINGS

Part Number	Inner Diameter	Outer Diameter
BCPBF12118	1/2"	1-1/8"
BCPBF12136 L	1/2"	1-3/16"
BCPBF12136 S	1/2"	1-3/16"
BCPBF12138	1/2"	1-3/8"
BCPBF34138	3/4"	1-3/8"
BCPBF58138	5/8"	1-3/8"



PRECISION BALL BEARINGS

Part Number	Inner Diameter	Outer Diameter	Length
Metric Inner Diameter			
BCPBB626 ZZ	6mm	19mm	6mm
BCPBB608 2RS	8mm	22mm	7mm
BCPBB608 2ZZ AB5	8mm	22mm	7mm
BCPBB608 ZZ	8mm	22mm	7mm
BCPBB6200 2RS	10mm	30mm	9mm
BCPBB6000 2RS	10mm	26mm	8mm
BCPBB6201 2RS	12mm	10mm	
BCPBB6002 2RS	15mm	32mm	9mm
BCPBB6202 ZZ	15mm	35mm	11mm
BCPBB6003 2RS	17mm	35mm	10mm
BCPBB6203 2RS	17mm	40mm	12mm
BCPBB6303 2RS	17mm	47mm	14mm
BCPBB6004 2RS	20mm	42mm	12mm
BCPBB6204 2RS	20mm	47mm	14mm
BCPBB6005 2RS	25mm	47mm	12mm
BCPBB6206 2RSC3	25mm	52mm	15mm

Part Number	Inner Diameter	Outer Diameter	Length
Imperial Inner Diameter			
WCRP155013	7/16"	32mm	7mm
WCRP165003	1/2"	27mm	11mm
WCRP265005	7/16"	23mm	10mm
WCRP365007	5/16"	23mm	10mm
BCPBB6201 12 2RS	1/2"	32mm	10mm
BCPBB6202 12 2RS	1/2"	35mm	11mm
BCPBB6203 12 2RS	1/2"	40mm	12mm
BCPBB6202 58 2RS	5/8"	35mm	11mm
BCPBB6203 58 2RS	5/8"	40mm	12mm
BCPBB6004 58 2RS	5/8"	42mm	12mm
BCPBB6004 34 2RS	3/4"	42mm	12mm
BCPBB6203 34 2RS	3/4"	40mm	12mm
BCPBB6204 34 2RS	3/4"	47mm	14mm
BCPBBR12 2RS	3/4"	41mm	10mm
BCPBB6205 1 2RS	1"	52mm	15mm

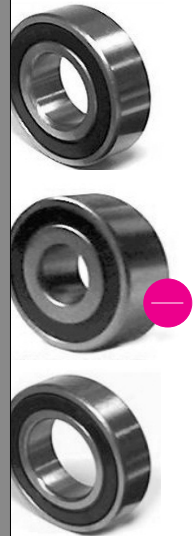

TAPERED ROLLER BEARINGS & RACEWAYS

Bearings		Raceways	
Part Number	Inner Diameter	Part Number	Outer Diameter
TAL44643	1"	TAL44610	1.08"
TAL44649	1.06"		
TAL68149	1.04"	TAL68111	2.05"
TALM11949	0.75"	TALM11910	1.94"
TALM12749	0.9"	TALM12711	1.8"
TALM67048	1.25"	TALM67010	2.32"
TALM48548	1.37"	TALM48510	2.3"
TALM29749	1.5"	TALM29710	2.7"
TALM501349	1.62"	TALM501310	3.1"
TALM603049	1.78"	TALM603011	3.63"

Banded lines indicate which bearing should be paired with which raceway.

ex: The TAL44610 raceway can be paired with either the TAL44643 or TAL44649 bearing.



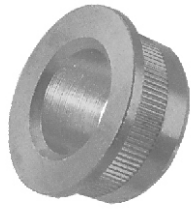

FLANGED BRASS BEARINGS

Part Number	Inner Diameter	Outer Diameter	Length
BCBFB34136	3/4"	1-3/16"	5/8"

FLANGED ROLLER BEARINGS



Part Number	Inner Diameter	Outer Diameter
BCRF58138	5/8"	1-3/8"
BCRF34138	3/4"	1-3/8"



TOY BEARINGS

FLANGED DELRIN BEARINGS



Part Number	Inner Diameter	Outer Diameter
BCDF12118	1/2"	1-1/8"
BCDF38118	3/8"	1-1/8"
BCDF58118	5/8"	1-1/8"
BCDF12136	1/2"	1-3/16"
BCDF58136	5/8"	1-3/16"
BCDF34136	3/4"	1-3/16"
BCDF12138	1/2"	1-3/8"
BCDF58138	5/8"	1-3/8"
BCDF34138	3/4"	1-3/8"
BCDF10138	1"	1-3/8"

Part Number	Inner Diameter	Outer Diameter	Details
MWTBB 12	1/2"	1-1/8"	-
MWTBB 38	3/8"	1-1/8"	-
MWTBB 38 L	3/8"	1-1/8"	3/4" hub length
MWTBB 516 L	5/16"	1-1/8"	3/4" hub length
MWTBB 76STD ER	7/16"	1-1/8"	Extended race

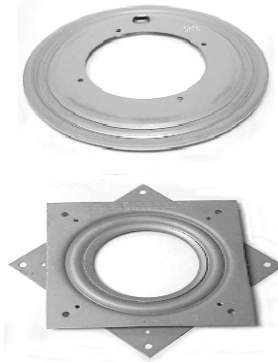

LAZY SUSAN BEARINGS

Part Number	Size	Shape	Weight Capacity
HW3C	3"	Square	200 lbs
HW4C	4"	Square	300 lbs
HW6C	6"	Square	500 lbs
HW9C	9"	Round	750 lbs
HW12C	12"	Round	1000 lbs

BALL TRANSFERS

BCBT 10TS 516S

Part Number	Size	Description	Weight Capacity
BCBT 10	1"	Flanged Mount	75lbs
BCBT 15	1-1/2"	Flanged Mount	250lbs
BCBTN 10	1"	Nylon Ball/Flanged Mount	75lbs
BCBT 10TS38	1"	3/8" x 1" Threaded Stem	75lbs
BCBT 10TS516	1"	5/16" x 1" Threaded Stem	75lbs
BCBT 10TS516S	1"	1-7/32" Outside Diameter	75lbs
BCBTM 30	30 mm	All Carbon Steel Components	770lbs
BCBTM 45	45 mm	All Carbon Steel Components	1325lbs
BCBTSS 10	1"	Stainless Steel Ball Transfer	75lbs
BCBTSS 15	1.5"	Stainless Steel Ball transfer	250lbs



Part Number	Inner Diameter	Outer Diameter	Length
-------------	----------------	----------------	--------

BCSB5612196	5/16"	1/2"	1 9/16"
BCSB5638196	5/16"	3/8"	1 9/16"
BCSB5658111	5/16"	5/8"	1 11/16"
BCSB3812178	3/8"	1/2"	1 7/8"
BCSB3812196	3/8"	1/2"	1 9/16"
BCSB3858111	3/8"	5/8"	1 11/16"
BCSB3858178	3/8"	5/8"	1 7/8"
BCSB1234178	1/2"	3/4"	1 7/8"
BCSB1234276	1/2"	3/4"	2 7/16"
BCSB1258178	1/2"	5/8"	1 7/8"
BCSB1258276	1/2"	5/8"	2 7/16"
BCSB1210300	1/2"	1"	3"
BCSB5834178	5/8"	3/4"	1 7/8"
BCSB5834276	5/8"	3/4"	2 7/16"
BCSB3410300	3/4"	1"	3"
BCSB3410312	3/4"	1"	3 1/2"
BCSB1014312	1"	1 1/4"	3 1/2"
BCSB1014412	1"	1 1/4"	4 1/2"
BCSB1415312	1 1/4"	1 1/2"	3 1/2"
BCSB1415412	2 1/2"	1 1/2"	4 1/2"

Steel Spanner Bushings



Stainless Steel Spanner Bushings



Part Number	Inner Diameter	Outer Diameter	Length
-------------	----------------	----------------	--------

BCSSB3812196	3/8"	1/2"	1-9/16"
BCSSB3815M178	3/8"	15mm	1 7/8"
BCSSB3834178	3/8"	3/4"	1 7/8"
BCSSB3858111	3/8"	5/8"	1 11/16"
BCSSB3858178	3/8"	5/8"	1 7/8"
BCSSB5612M111	5/16"	12mm	1-11/16"
BCSSB5634111	5/16"	3/4"	1-11/16"
BCSSB5658111	5/16"	5/8"	1 11/16"
BCSSB1234178	1/2"	3/4"	1 7/8"
BCSSB1234276	1/2"	3/4"	2 7/16"
BCSSB3410300	3/4"	1"	3"
BCSSB3410312	3/4"	1"	3.5"

Part Number	Inner Diameter	Outer Diameter	Length
-------------	----------------	----------------	--------

BCDSB5612196	5/16"	1/2"	1 9/16"
BCDSB3812158	3/8"	1/2"	1-5/8"
BCDSB3858111	3/8"	5/8"	11/16"
BCDSB1234178	1/2"	3/4"	1-7/8"
BCDSB1234276	1/2"	3/4"	2-7/16"

Delrin

Spanner Bushings



Additional Hardware

STEEL BALL BEARINGS



Part Number	Description
BCBALL 14	1/4"
BCBALL 516	5/16"
BCBALL 38	3/8"
BCBALL 12	1/2"
BCBALL 58	5/8"

Stainless Steel also available

COTTER PINS



Part Number	Description
HWCP 18X112	1/8" x 1-1/2"
HWCP 18X2	1/8" x 2"
HWCP 316X15	3/16" x 1-1/2"
HWCP 532X1	5/32" x 1"

COLD ROLLED STEEL AXLES



Part Number	Width	Length
HWCR516X3	5/16"	3'
HWCR38X3	3/8"	3'
HWCR716X10	7/16"	10"
HWCR716X3	7/16"	3'
HWCR12X10	1/2"	10"
HWCR12X3	1/2"	3'
HWCR58X10	5/8"	10"
HWCR58X3	5/8"	3'
HWCR34X10	3/4"	10"
HWCR34X23	3/4"	23"
HWCR1X10	1"	10"
HWCR1X3	1"	3'

PUSH CAPS

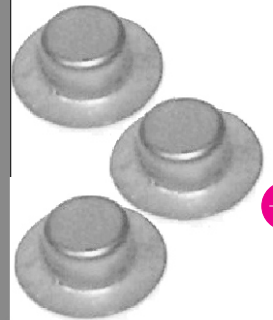

Part Number	Size
HWPC14	1/4"
HWPC516	5/16"
HWPC38	3/8"
HWPC716	7/16"
HWPC12	1/2"
HWPC58	5/8"

CLAMP FASTENERS



Part Number	Description
HWHR 1	Small clamp
HWDH 39	Strike plate for HWHR 9
HWHR 9	Large clamp
HWHS 11	Strike plate for HWDH 11

BROOM HOLDERS

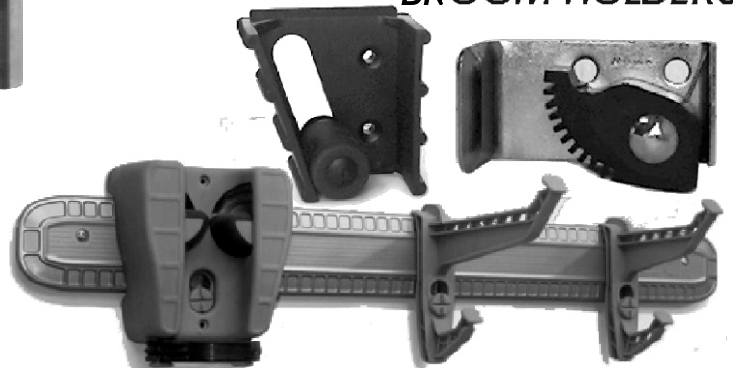

Part Number	Description
HWBH5046	Broom and tool holder
HWBH5047	18" mounting bar
HWBH515 RP	Steel and rubber broom holder
HWBHASG2	Gripit Broom and tool holder
TZSC BAR	Superclamp bar (components sold separately)