

# DF832

## PEC ATTACHMENT

### Assembly Manual

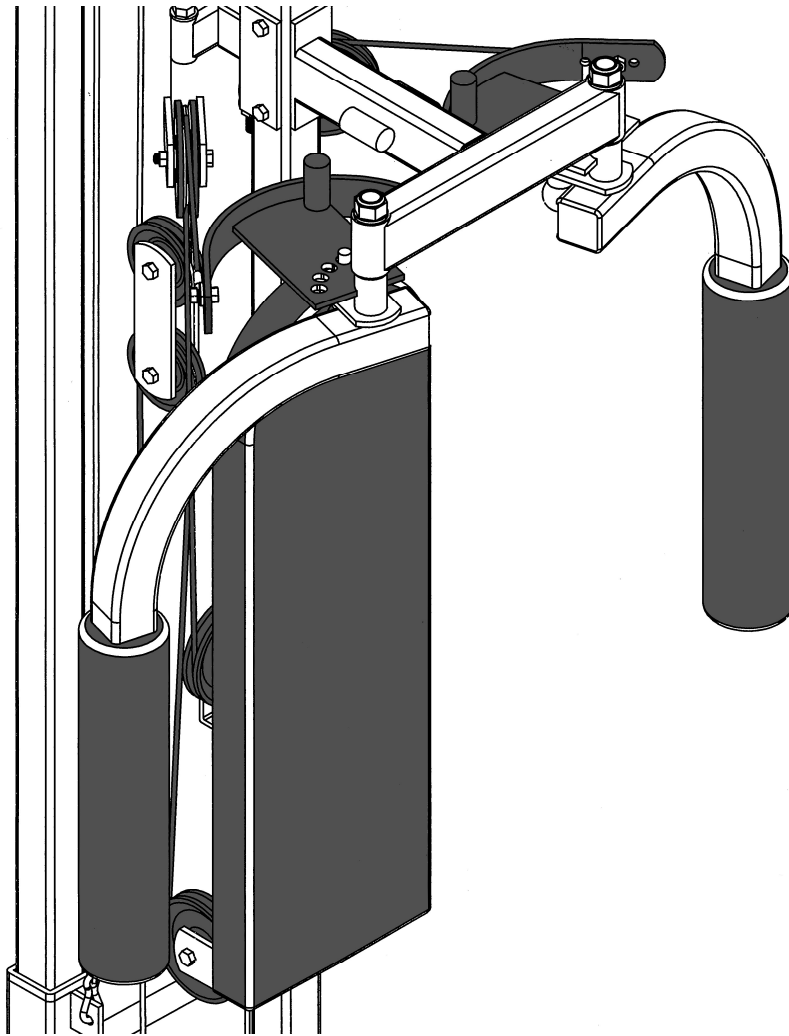

#### ASSEMBLY VIDEOS AVAILABLE

Click on the QR Code below for your model to access the assembly video

DF910- Lat Machine



DF908- Stack Loaded  
Lat Machine



## (888) 258-0533

***FOR YOUR SAFETY READ ALL INSTRUCTIONS CAREFULLY***

\*NOTE IF YOU ARE MISSING HARDWARE OR HAVE ANY FIT UP PROBLEMS PLEASE CONTACT DELTECH FITNESS TOLL FREE (888) 258-0533

# ***BOX CONTENTS***

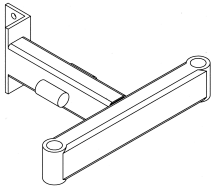

**A**

**ARM MOUNT  
QTY 1**

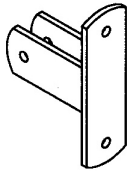

**B**

**FIXED PULLEY  
BRACKET  
QTY 1**

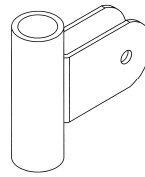

**C**

**SWIVEL PULLEY  
BRACKET  
QTY 2**

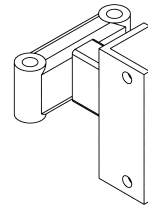

**D**

**SWIVEL PULLEY  
MOUNT BRACKET  
QTY 1**

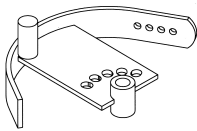

**E**

**RIGHT HAND CAM  
QTY 1**

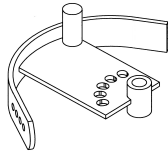

**F**

**LEFT HAND CAM  
QTY 1**

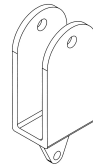

**G**

**FLOATING PULLEY  
BRACKET  
QTY 1**

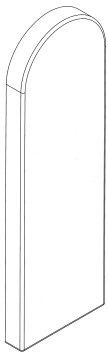

**I**

**BACKREST PAD  
QTY 1**

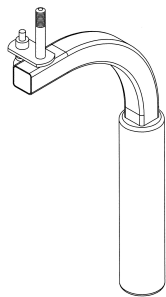

**J**

**RIGHT HAND ARM  
QTY 1**

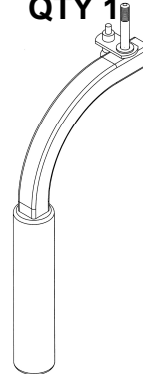

**K**

**LEFT HAND ARM  
QTY 1**

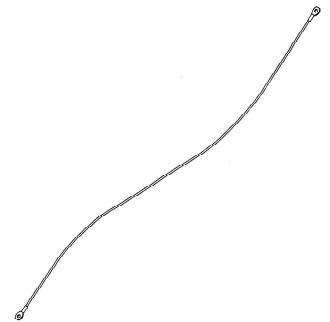

**L**

**CABLE  
QTY 1**



**DF832  
INSTRUCTIONS  
QTY 1**



**DF832  
HARDWARE  
QTY 1**

# ***HARDWARE***

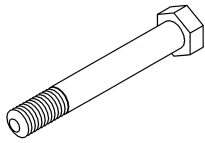

**M**

**M12 x 75MM BOLT  
QTY 2**



**N**

**LARGE BUSHING  
QTY 8**



**O**

**SMALL BUSHING  
QTY 8**



**P**

**3-1/2" PULLEY  
QTY 7**

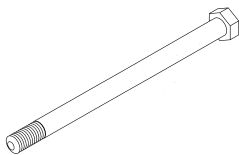

**Q**

**M12 x 170MM  
BOLT  
QTY 2**

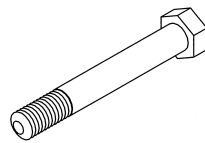

**R**

**M10 x 70MM BOLT  
QTY 4**

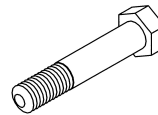

**S**

**M10 x 45MM BOLT  
QTY 4**



**U**

**M10 x 25MM BOLT  
QTY 2**



**V**

**M12 WASHERS  
QTY 8**



**W**

**M10 WASHERS  
QTY 18**



**Y**

**M16 LOCK NUT  
QTY 2**



**Z**

**M12 LOCK NUT  
QTY 4**



**AA**

**M10 LOCK NUT  
QTY 8**

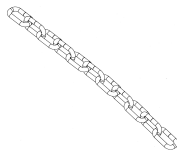

**BB**

**CHAIN  
QTY 1**

**(888) 258-0533**

***FOR YOUR SAFETY READ ALL INSTRUCTIONS CAREFULLY***

\*NOTE IF YOU ARE MISSING HARDWARE OR HAVE ANY FIT UP PROBLEMS PLEASE CONTACT DELTECH FITNESS TOLL FREE (888) 258-0533

## ARM & PULLEY MOUNT INSTALLATION

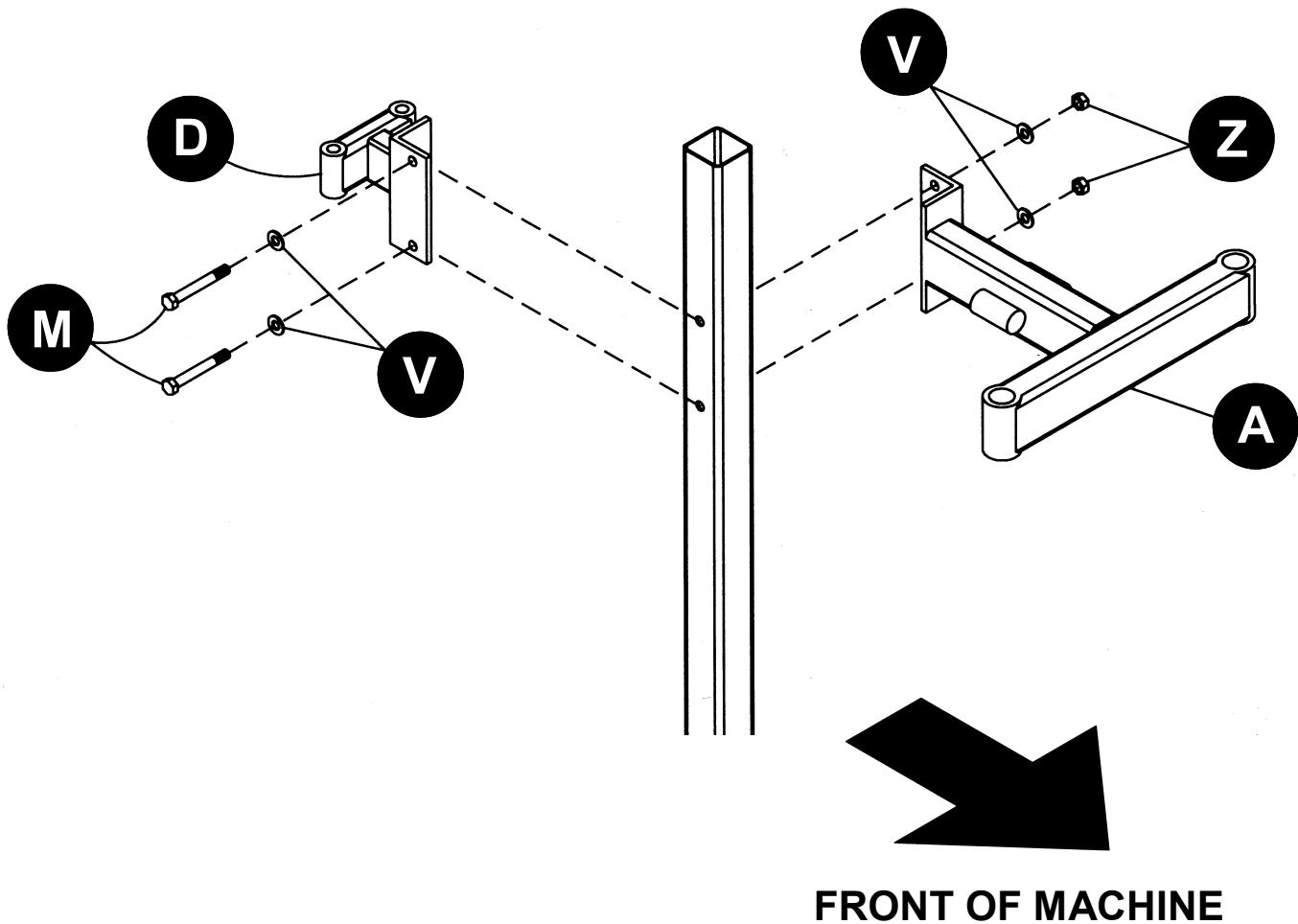

### **TOOLS REQUIRED:** WRENCHES OR METRIC SOCKET SET

ASSEMBLE THE ARM MOUNT (A) AND THE SWIVEL PULLEY MOUNT BRACKET (D) TO THE FRONT SUPPORT OF THE LAT MACHINE USING THE M12 x 75MM BOLTS (M), M12 FLAT WASHERS (V) AND M12 LOCK NUTS (Z)

*NOTE: THE NUTS USED ON THIS PRODUCT ARE LOCK NUTS SO YOU MUST USE A WRENCH TO TIGHTEN THE BOLT. THE BOLT MUST GO THRU THE PLASTIC INSERT IN THE NUT.*

## *CAM & ARM PAD ASSEMBLY*

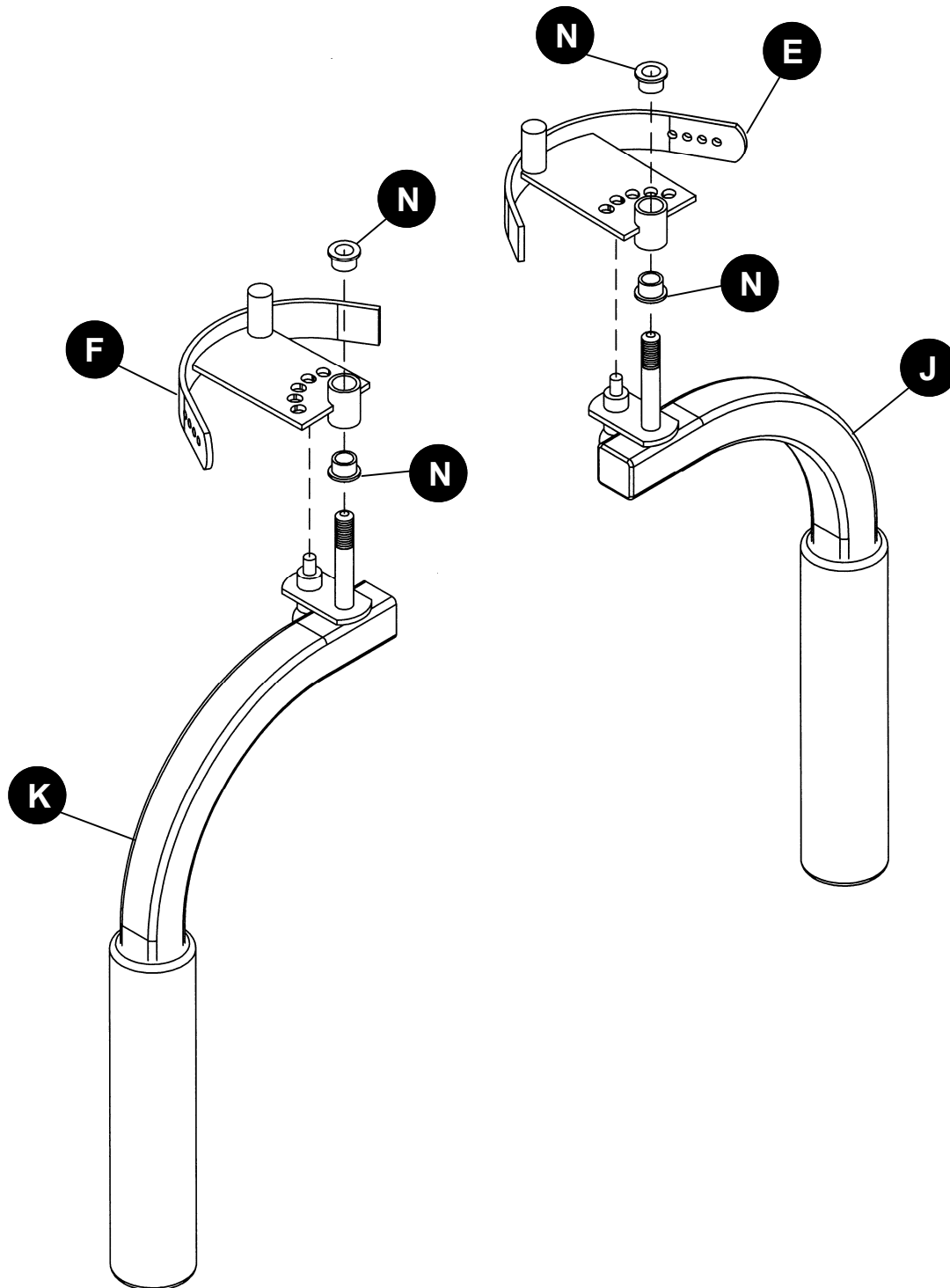

INSTALL THE CAMS (E,F) ON THE ARMS (J,K), INSERTING LARGE BUSHINGS (N) ON EACH END OF THE TUBE. THERE IS A LEFT HAND AND A RIGHT HAND SIDE SO YOU WILL NEED TO LOOK AT THE DIAGRAM TO ENSURE CORRECT INSTALLATION

# ARM INSTALLATION

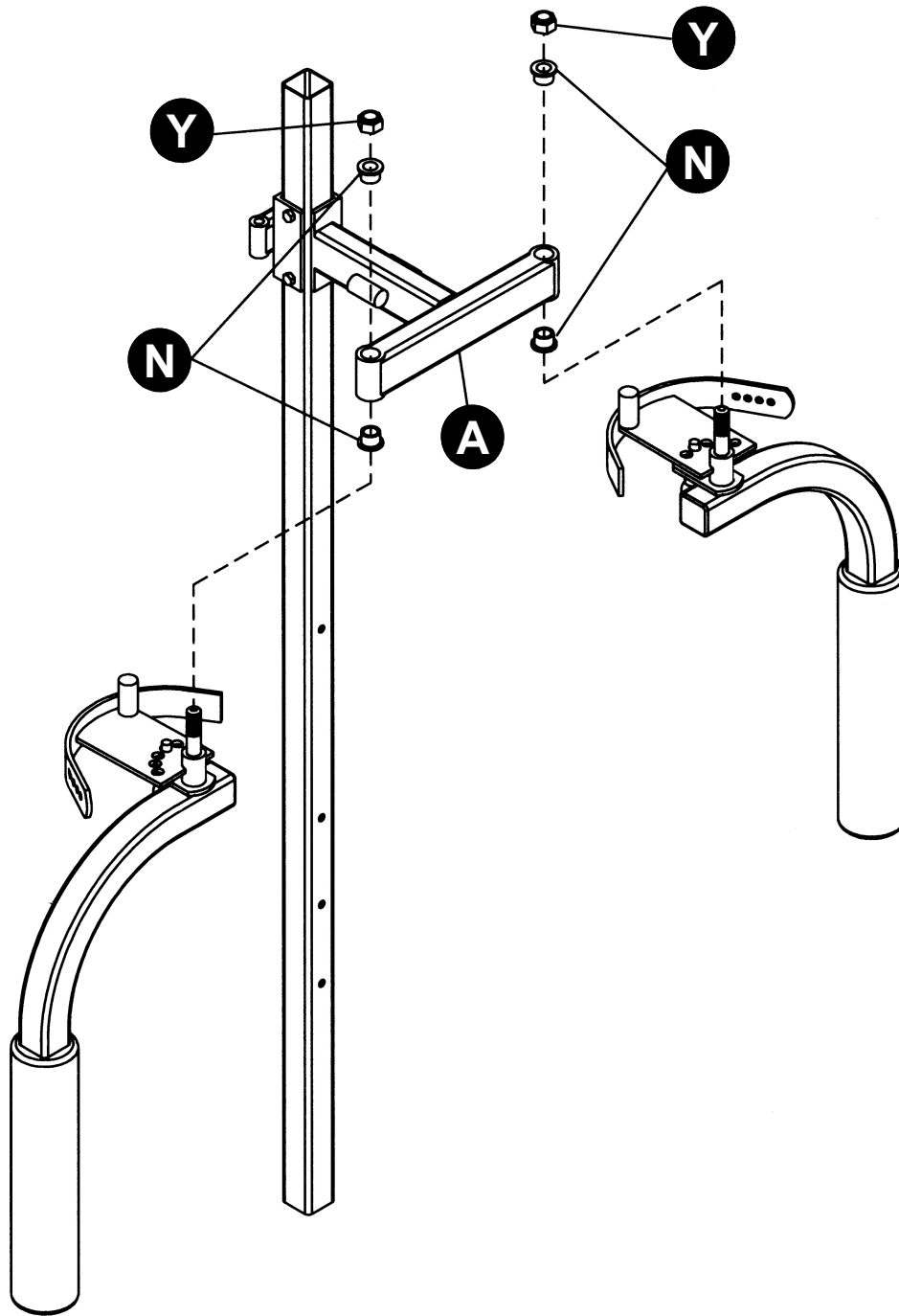

INSERT LARGE BUSHINGS (N) INTO THE ARM MOUNT (A). NOW ASSEMBLE THE WEIGHT ARMS TO THE ARM MOUNT (A) USING THE M19 LOCKNUTS (Y)

## SWIVEL PULLEY ASSEMBLY

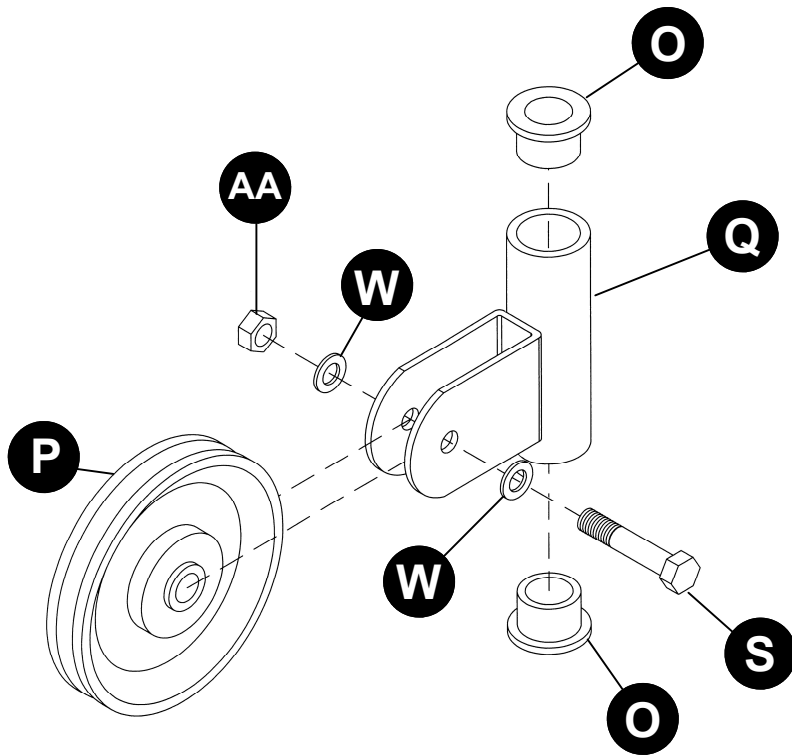

ASSEMBLE THE 3 ½" PULLEY (P) INTO THE SWIVEL PULLEY BRACKET (C) USING THE M10 x 45MM BOLT (S), M10 WASHERS (W), AND M10 LOCKNUT (AA). REPEAT FOR OTHER SWIVEL PULLEY ASSEMBLY. INSTALL SMALL BUSHINGS (O) INTO EACH END OF TUBE.

## SWIVEL PULLEY INSTALLATION

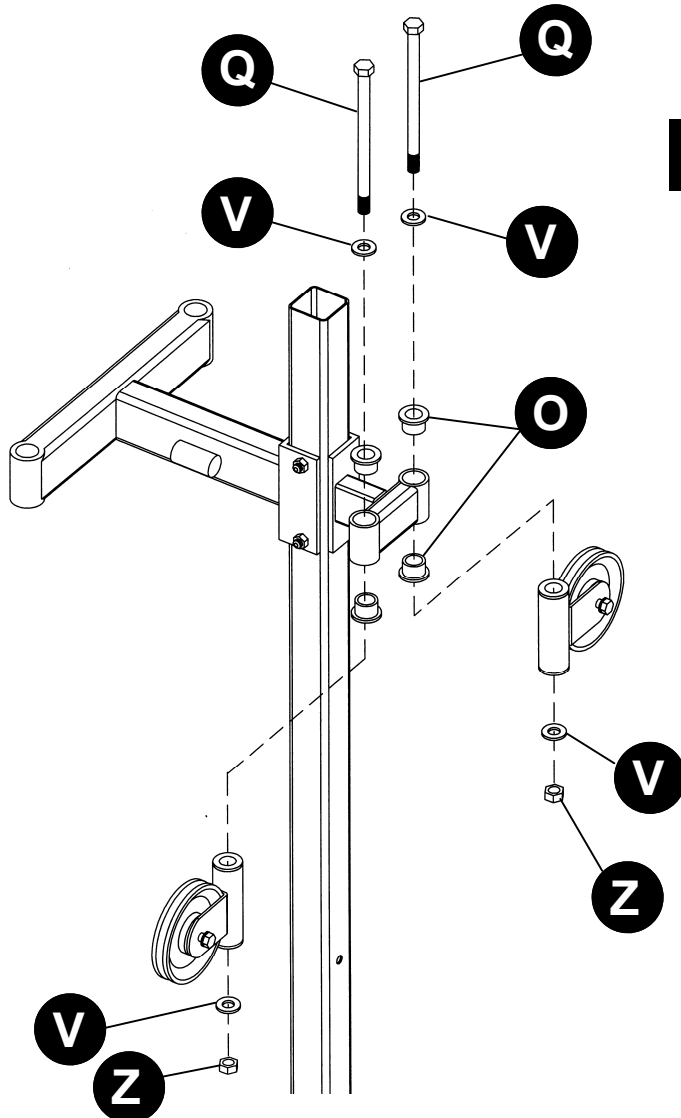

INSTALL THE SWIVEL PULLEY ASSEMBLIES TO THE MOUNT BRACKET USING THE M12 x 170MM BOLTS (Q), M12 WASHERS (V), SMALL BUSHINGS (O), AND M12 LOCKNUTS (Z).

## ***FIXED PULLEY ASSEMBLY***

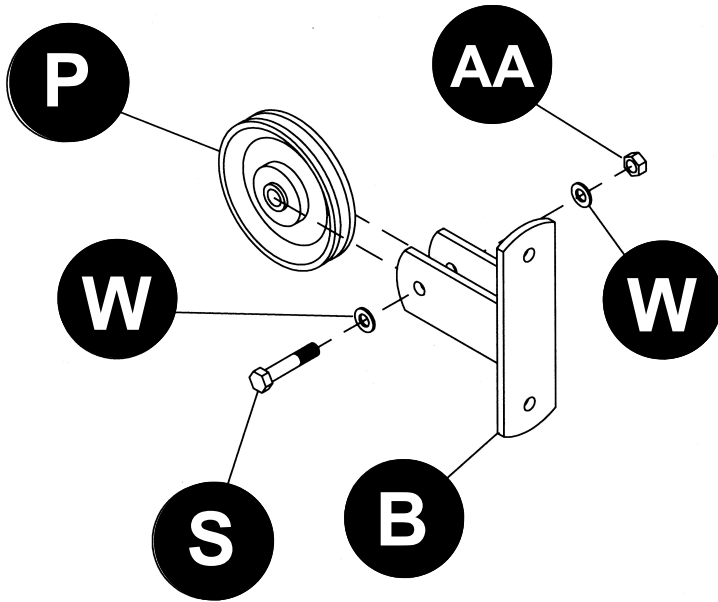

INSTALL THE 3 ½" PULLEY (P) INTO THE FIXED PULLEY BRACKET (B) USING THE M10 x 45MM BOLT (S) M10 WASHERS (W), AND M10 LOCK NUT (AA).

**NOTE: IF INSTALLING ON DF908, USE 4-1/2" PULLEY**

## ***FIXED PULLEY & BACKREST INSTALLATION***

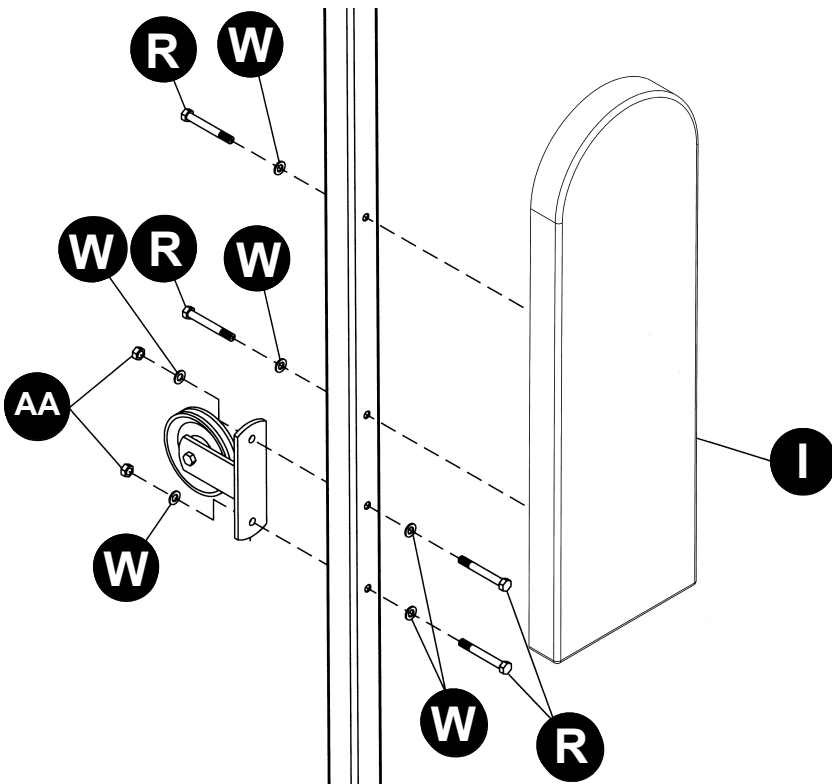

ASSEMBLE THE BACKREST PAD (I) TO THE FRONT SUPPORT OF THE LAT MACHINE USING THE M10 x 70 BOLTS (R) AND THE M10 FLAT WASHERS (X). (THE BOLTS SCREW INTO THREADED INSERTS PRE-INSTALLED IN THE BACK PAD)

NEXT INSTALL THE FIXED PULLEY ASSEMBLY USING THE M10 x 70MM BOLTS (R) M10 FLAT WASHERS (W), AND M10 LOCKNUTS (AA).



## ***FLOATING PULLEY ASSEMBLY***

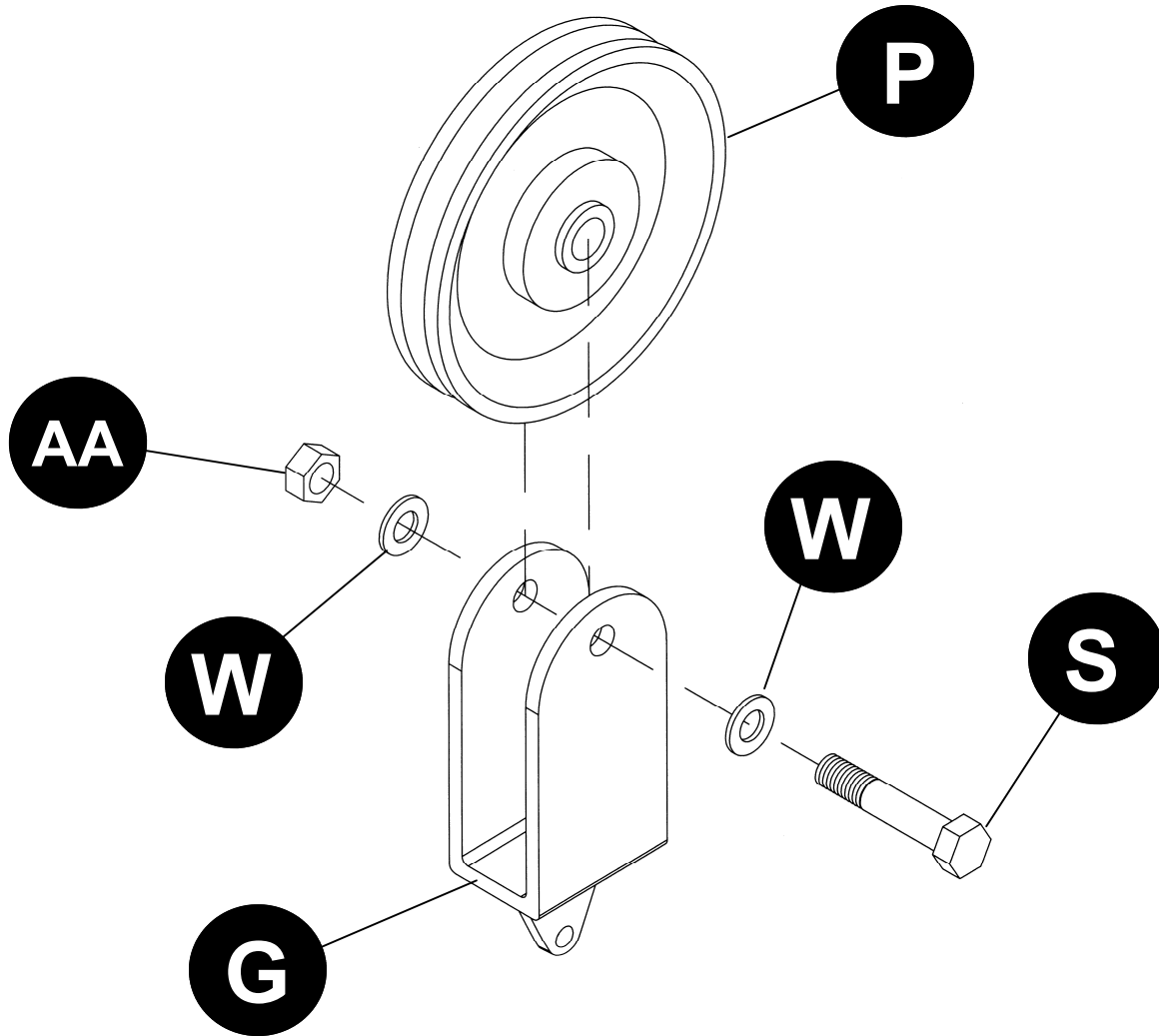

ASSEMBLE THE 3 ½" PULLEY (P) TO THE FLOATING PULLEY BRACKET (G) USING THE M10 x 45MM BOLT (S), M10 WASHERS (W) AND M10 NUT (AA).

# PEC ATTACHMENT CABLE INSTALLATION

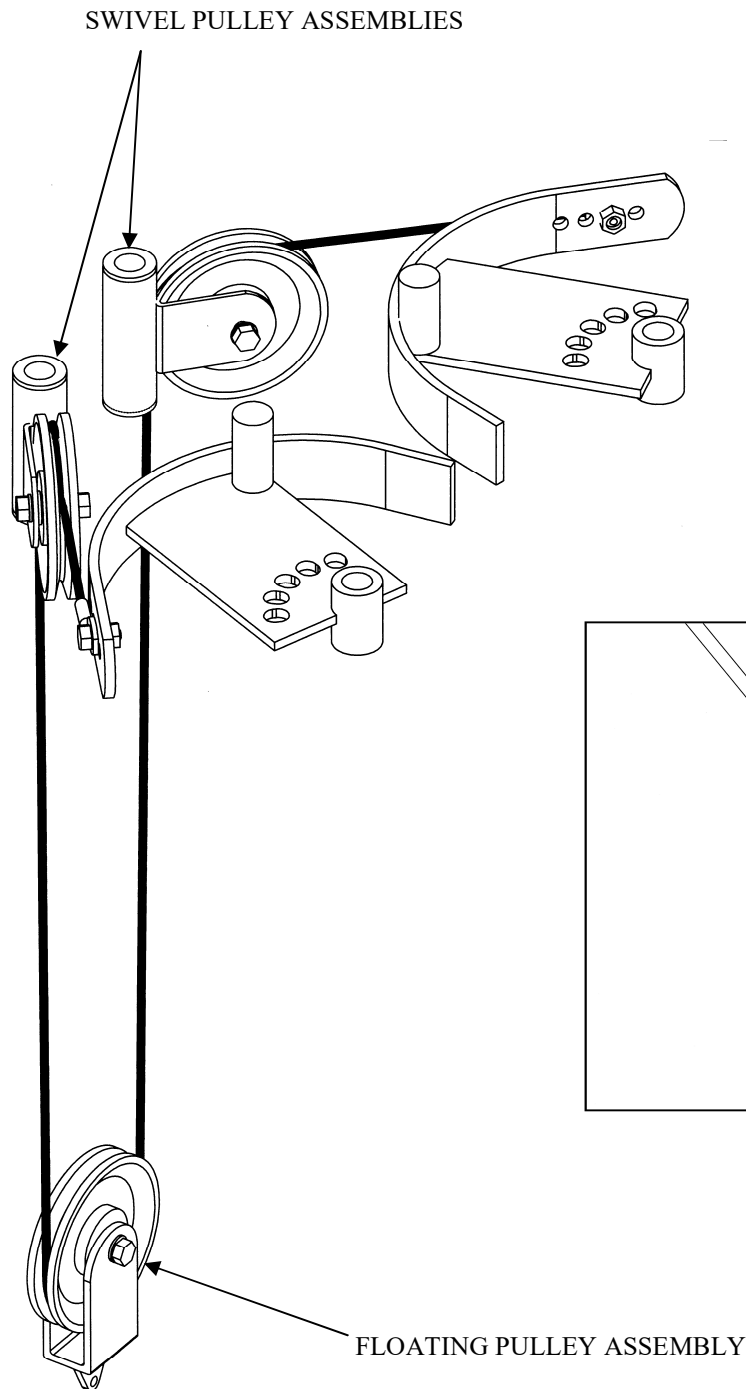

FIGURE A

ATTACH THE PEC CABLE TO THE CAM ON THE LEFT SIDE USING THE M10 x 25MM BOLT (U), M10 WASHERS (W), AND M10 LOCKNUT (AA). (SEE FIGURE A)

**NOTE: THERE ARE ADJUSTMENT HOLES ON EACH CAM TO COMPENSATE FOR CABLE STRETCH AFTER THE MACHINE IS USED FOR A WHILE.**

RUN THE CABLE THROUGH THE LEFT SIDE SWIVEL PULLEY, DOWN THROUGH THE FLOATING PULLEY, UP THROUGH THE RIGHT SIDE SWIVEL PULLEY AND ATTACH TO RIGHT CAM.

TIGHTEN THE BOLTS ON THE SWIVEL PULLEYS.

**INSTRUCTIONS FOR INSTALLING ON  
DF838– STACK LOADED LAT ATTACHMENT**

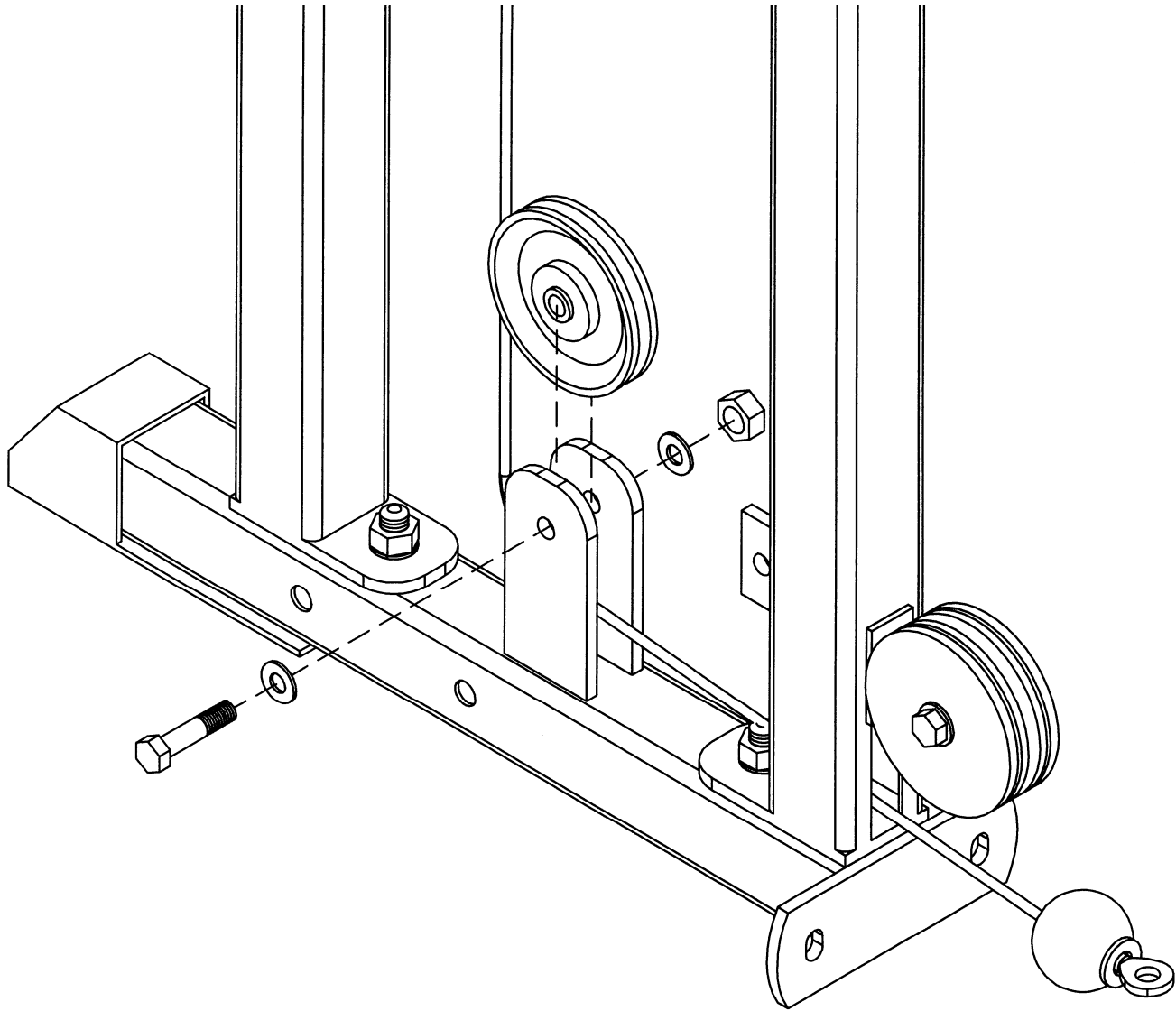

REMOVE THE THE 4-1/2" PULLEY FROM THE CENTER FLANGES OF THE BOTTOM SUPPORT AND REPLACE WITH 3-1/2" PULLEY.

## ***DF838 FLOATING PULLEY ASSEMBLY***

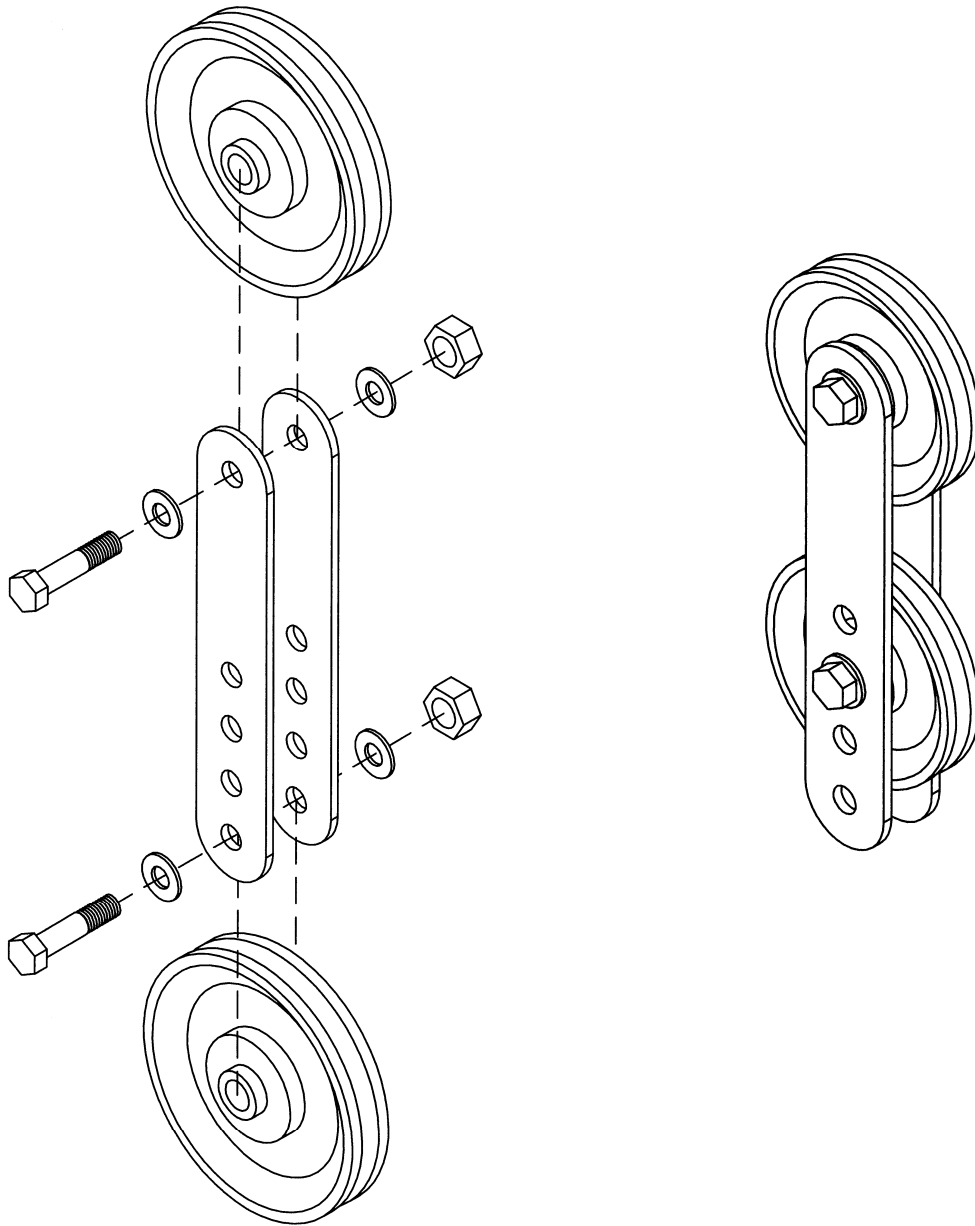

REMOVE THE 4-1/2" PULLEYS FROM THE FLOATING PULLEY ASSEMBLY AND REPLACE WITH 3-1/2" PULLEYS, MAKING SURE TO INSTALL THE LOWER BOLT IN THE HOLE SPECIFIED IN THE DIAGRAM ABOVE.

## DF838 LOWER CABLE INSTALLATION

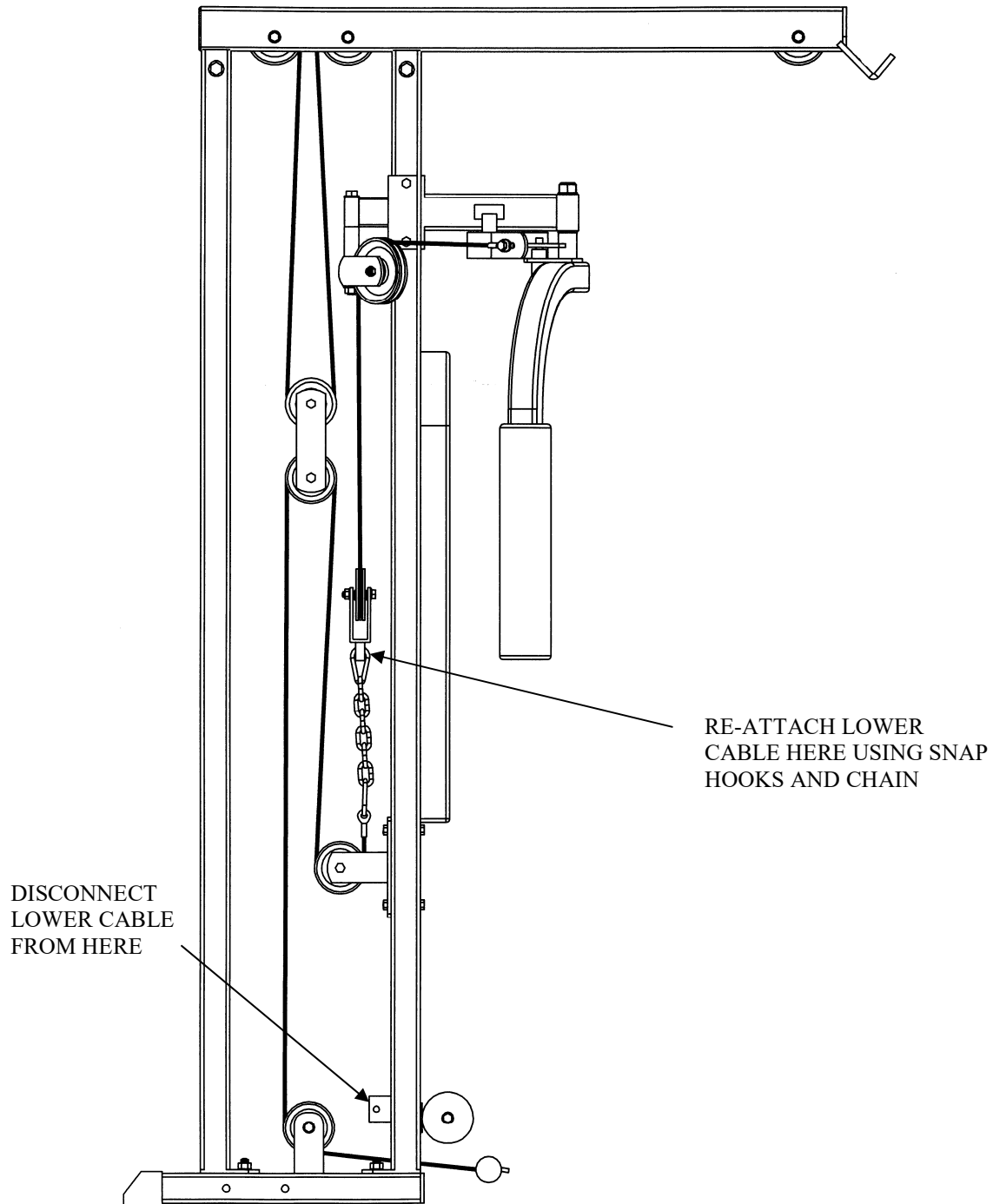

DISCONNECT THE END OF THE LOWER CABLE FROM THE FLANGE ON THE FRONT SUPPORT. RECONNECT IT TO THE FLOATING PULLEY ASSEMBLY ON THE PEC DEC USING THE CHAIN AND SPRING CLIPS PROVIDED.

## ***DF908 FLOATING PULLEY ASSEMBLY***

### **INSTRUCTIONS FOR INSTALLING ON DF908– STACK LOADED LAT MACHINE**

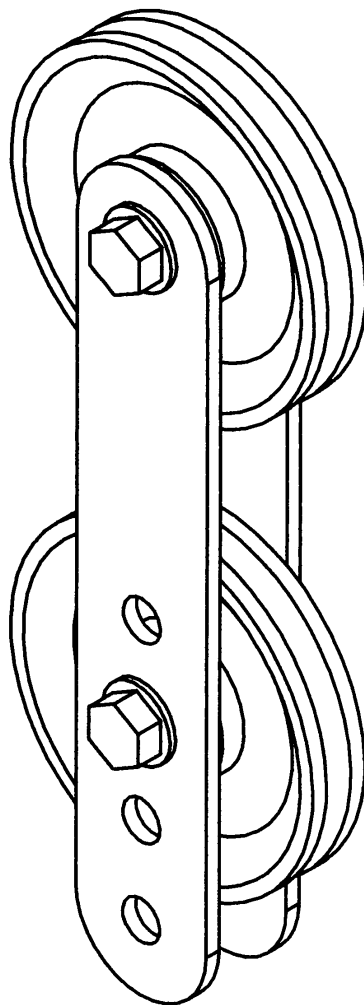

MAKE SURE BOTTOM PULLEY IS MOUNTED AS SHOWN IN DIAGRAM ABOVE.

## DF908 LOWER CABLE INSTALLATION

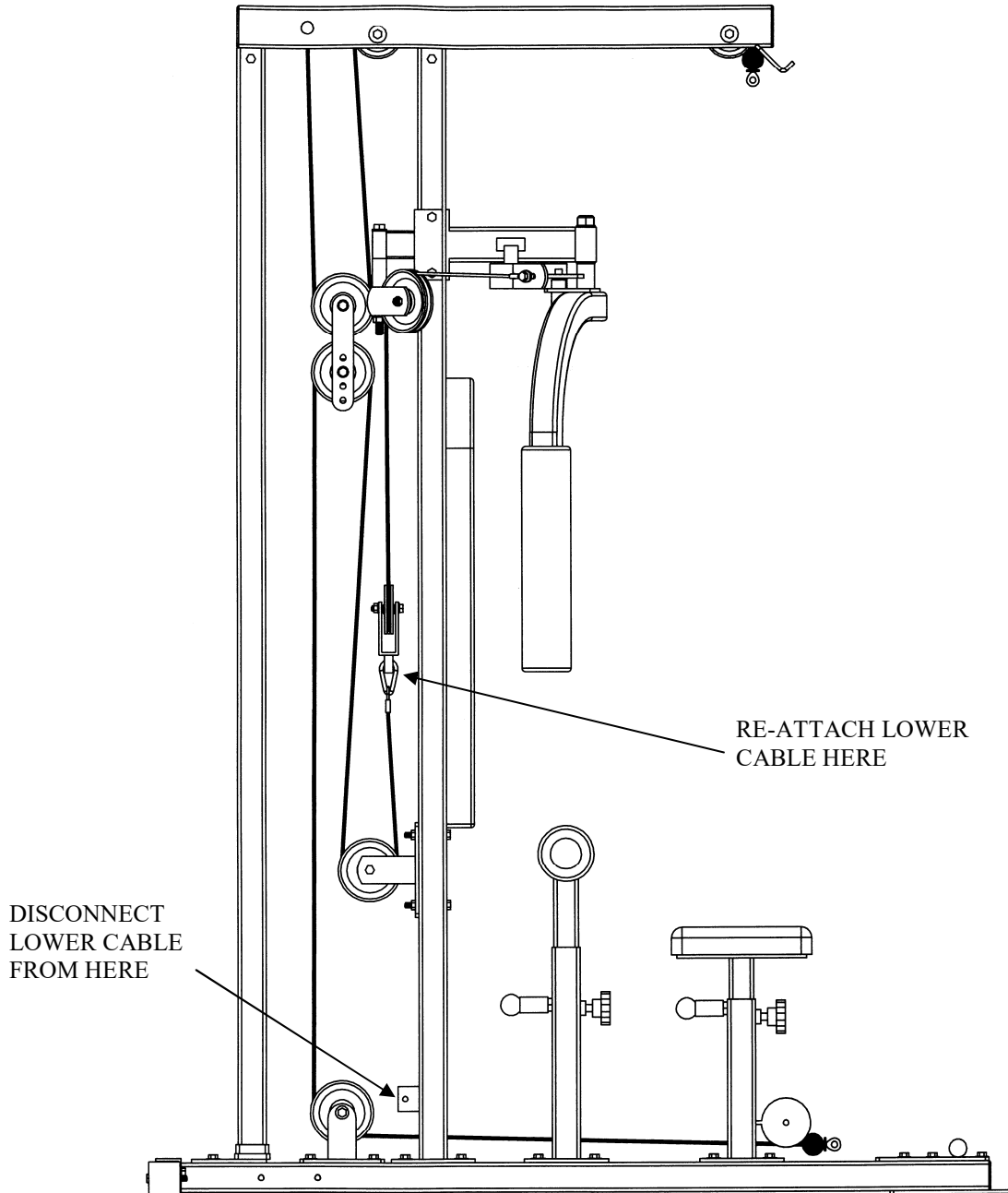

DISCONNECT THE END OF THE LOWER CABLE FROM THE FLANGE ON THE FRONT SUPPORT. RECONNECT IT TO THE FLOATING PULLEY ASSEMBLY ON THE PEC DEC WITH SPRING CLIP.

# ***DF830 FLOATING PULLEY ASSEMBLY***

## **INSTRUCTIONS FOR INSTALLING ON DF830– LAT ATTACHMENT**

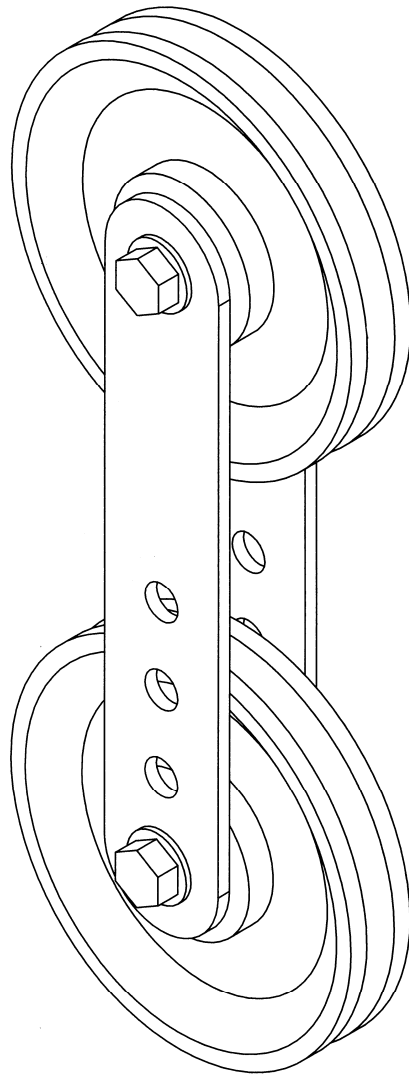

**MAKE SURE BOTTOM PULLEY IS MOUNTED AS SHOWN IN DIAGRAM ABOVE.**



## DF830 LOWER CABLE INSTALLATION

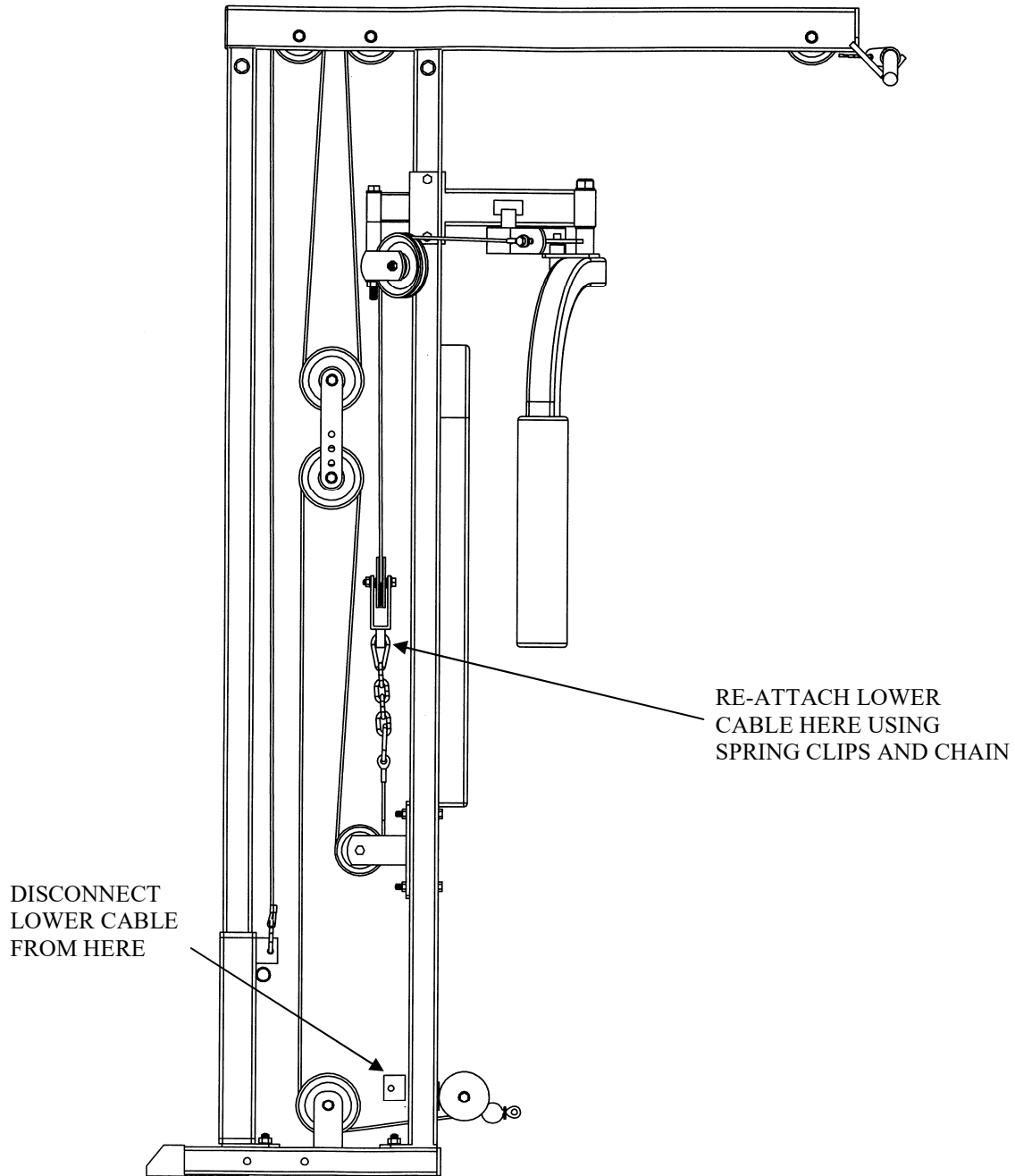

DISCONNECT THE END OF THE LOWER CABLE FROM THE FLANGE ON THE FRONT SUPPORT. RECONNECT IT TO THE FLOATING PULLEY ASSEMBLY ON THE PEC DEC USING THE CHAIN AND SPRING CLIPS PROVIDED.

# ***DF910 FLOATING PULLEY ASSEMBLY***

## **INSTRUCTIONS FOR INSTALLING ON DF910- LAT MACHINE**

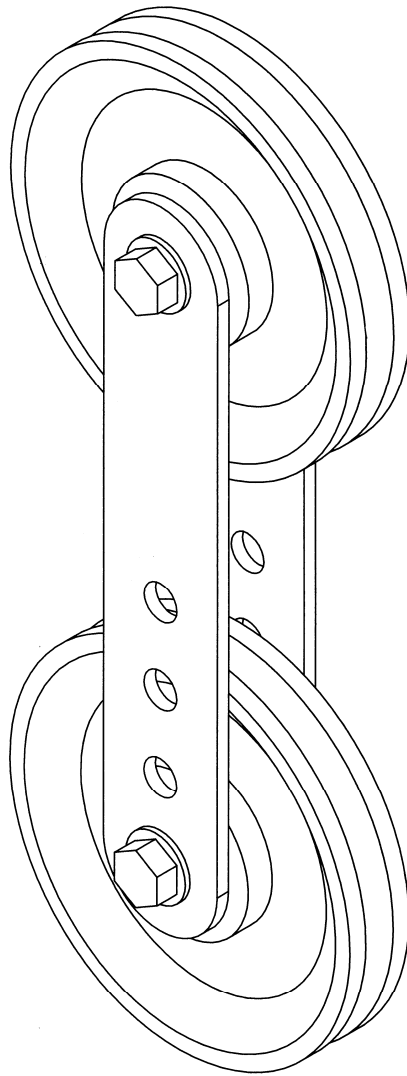

MAKE SURE BOTTOM PULLEY IS MOUNTED AS SHOWN IN DIAGRAM ABOVE.

## DF910 LOWER CABLE INSTALLATION

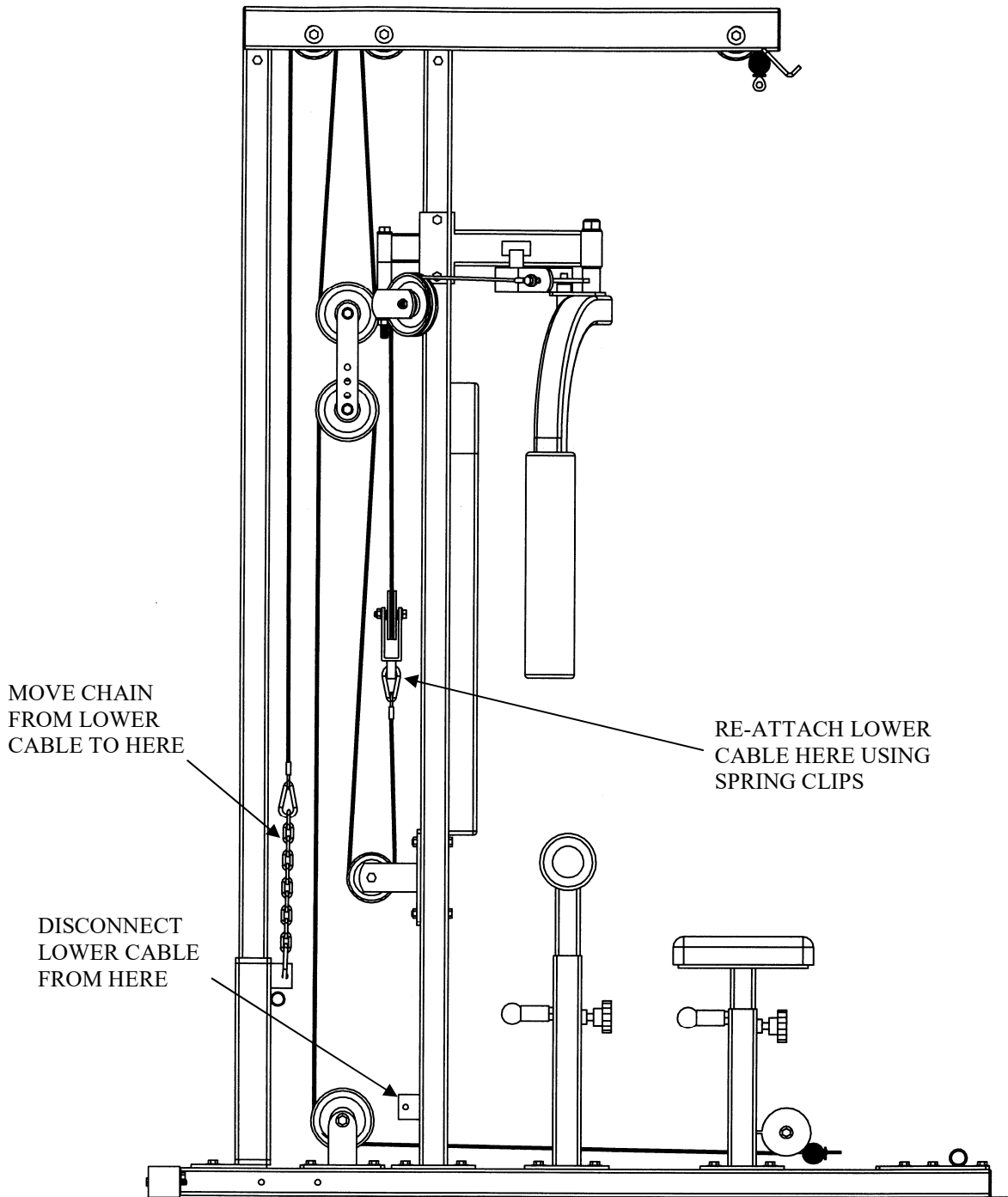

DISCONNECT THE END OF THE LOWER CABLE FROM THE FLANGE ON THE FRONT SUPPORT AND REMOVE CHAIN. RECONNECT IT TO THE FLOATING PULLEY ASSEMBLY ON THE PEC DEC USING SPRING CLIP. MOVE CHAIN TO UPPER CABLE AND CONNECT TO WEIGHT CARRIAGE.

# ***SAFETY NOTICE***

WARNING: THE USER OF THIS WEIGHT EQUIPMENT ASSUMES THE POSSIBILITY OF INJURY BY EXERCISING ON THIS EQUIPMENT. THE POSSIBILITY OF RISK CAN BE REDUCED BY ALWAYS FOLLOWING THESE SIMPLE RULES:

- 1) BEFORE BEGINNING ANY EXERCISE PROGRAM, CONSULT YOUR DOCTOR FOR A COMPLETE PHYSICAL EXAMINATION AND SUGGESTED EXERCISE PROGRAM SPECIFIC FOR YOU.
- 2) STRETCH BEFORE AND AFTER THE EXERCISE PROGRAM. PROPER STRETCHING WILL PREPARE YOUR JOINTS AND MUSCLES FOR EXERCISE AND HELP AVOID INJURIES.
- 3) IF AT ANY TIME YOU SHOULD FEEL FAINT OR DIZZY, NAUSEOUS OR EXPERIENCE ANY OTHER ABNORMAL SYMPTOMS OR DISCOMFORT DISCONTINUE USE AND CONSULT YOUR DOCTOR.
- 4) DO NOT USE THIS EQUIPMENT WITHOUT QUALIFIED SUPERVISION AND PROPER TRAINING. NEVER WORK OUT ALONE- ALWAYS HAVE A PARTNER.
- 5) SECURELY TIGHTEN ALL BOLTS AND REGULARLY CHECK TO ENSURE ALL BOLTS HAVE NOT LOOSENED.
- 6) WEAR GOOD RUBBER SOLE SHOES ONLY. DO NOT USE BARE FOOTED OR WITH SOCKS ONLY.
- 7) DO NOT WEAR LOOSE CLOTHES SUCH AS ROBES, GOWNS, PANTS, LONG SHIRTS OR JEWELRY WHICH COULD BECOME ENTANGLED IN MOVING PARTS.
- 8) DO NOT STAND OR KNEEL ON SEAT. ALWAYS SIT OR LAY SQUARELY CENTERED.
- 9) KEEP HEAD, LIMBS AND BODY PARTS CLEAR OF MOVING PARTS AND WEIGHT PLATES.
- 10) CHILDREN SHOULD NOT USE EXERCISE EQUIPMENT WITHOUT SUPERVISION BECAUSE OF POSSIBILITY OF INJURY FROM IMPROPER USAGE. THIS EQUIPMENT IS INTENDED FOR HOME USE ONLY.
- 11) REPLACEMENT OF WORN OR DEFECTIVE PARTS MUST BE WITH FACTORY AUTHORIZED PARTS. IF OTHER THAN FACTORY AUTHORIZED PARTS OR ASSESSORS ARE USED ALL WARRANTIES AND LIABILITIES BECOME VOID.