

17/64"
through
both

1/2" Dia 3/8"

deep
Front
only

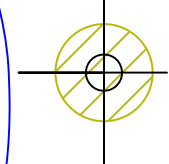

3/16"
through
Back only

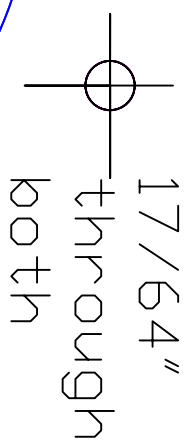

17/64"
through
both

through
front
only

1/2"
through
Front
only

All oval
holes are
through
holes
both
plates

7.6250

9.1250

1/2" Dia 3/8"
deep
both

1/2" Dia 3/8"
deep
both

1/2"
through
Front
only

plates.

plates.
both

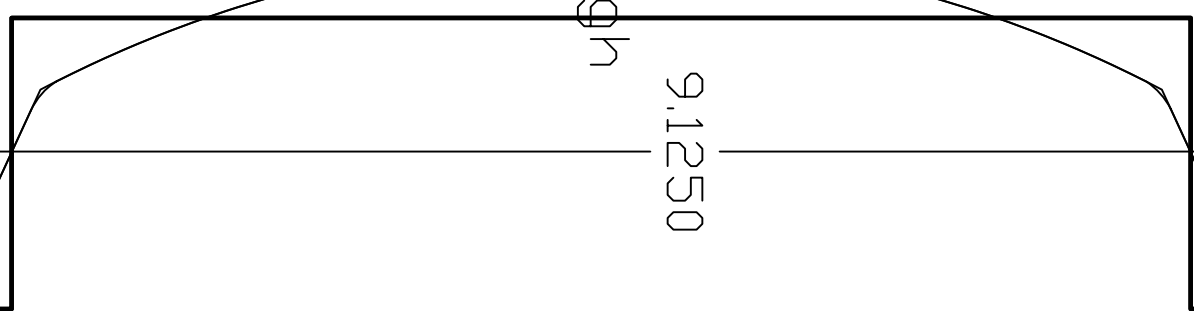
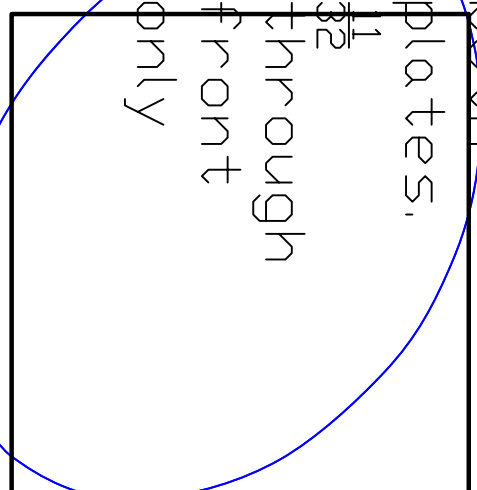
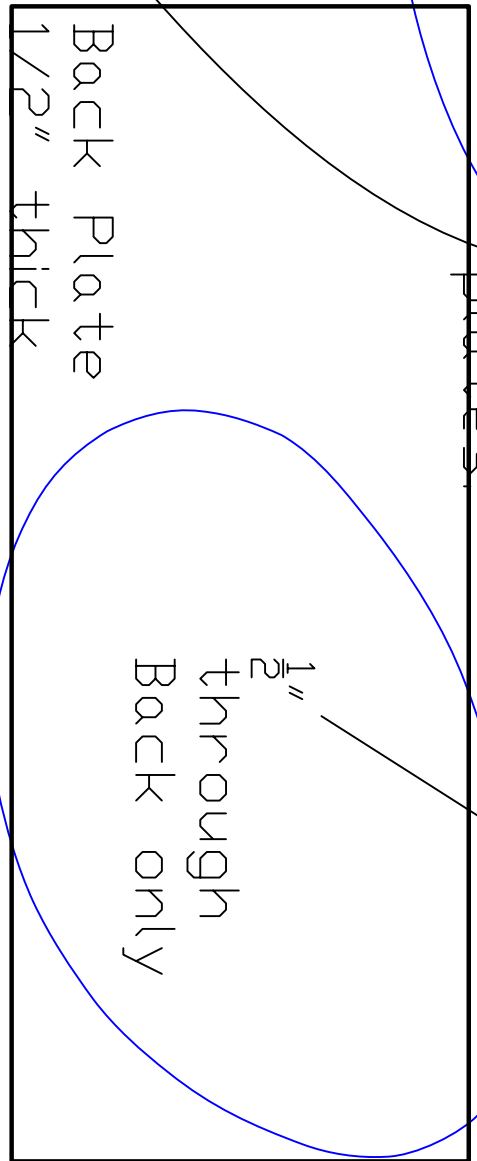

17/64"
through

Front Plate
1/2" thick

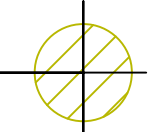

1/2" Dia 3/8"
deep
Back only

17/64"
through
both

both

3/32

$\frac{1}{2}$ "
 $\frac{1}{8}$ "
 $\frac{1}{8}$ "
 $\frac{3}{32}$ "

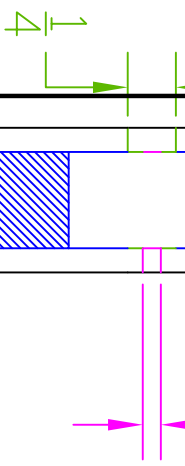

$\frac{17}{64}$ "
 through
 both

$\frac{5}{16}$ " Dia
 Through
 back
 only.

7.6250

$\frac{1}{2}$ " Dia
 $\frac{3}{8}$ "

deep
 Front
 only

$\frac{3}{16}$ "
 through
 Back only

$\frac{1}{5}$ "
 through
 front
 only

$\frac{1}{2}$ "
 through
 Front
 only

All ovc
 holes
 throug
 holes
 both
 plates

$\frac{1}{2}$ " Dia
 $\frac{3}{8}$ "
 deep
 both
 plates.

$\frac{1}{2}$ "
 through
 Back only

Back Plate
 $\frac{1}{2}$ " thick

Front Plate
 $\frac{1}{2}$ " thick

$\frac{1}{2}$ " Dia
 $\frac{3}{8}$ "
 deep
 Back only

$\frac{1}{2}$ " Dia
 $\frac{3}{8}$ "
 deep
 both
 plates.
 $\frac{1}{32}$ "
 through
 front
 only

$\frac{17}{64}$ "
 through
 both

$2\frac{11}{32}$

45°

$\phi\frac{3}{32}$

Escape Lever Bracket
 Part # 28