



Lifestyle Bath

Instructions for use

Serial Number



Kingkraft Ltd, 26D Orgreave Crescent, Dore House Industrial Estate, Sheffield S13 9NQ
phone 0114 2690697 fax 0114 2695145 email info@kingkraft.co.uk web www.kingkraft.co.uk

CONTENTS

- Important Safety Instructions
- General description
- Cleaning the bath
- Warning of scalding
- Warning of trapping
- Important safety and operating instructions
- Cushions and supports
- Whirlpool and other systems
- Installation
- Maintenance
- Record of unit maintenance
- Bath markings
- Guarantee details

IMPORTANT SAFETY INSTRUCTIONS

WARNING: Any person who is incapable of fully helping themselves must NEVER be left alone in the bath even for a short period.

These instructions contain information for all standard versions of the Lifestyle bath. Special design baths manufactured by Kingkraft may differ to those described herein. Please make sure you read all sections of the user manual before use of the bath.

If you have any doubt as to the operation of the bath, please consult Kingkraft as soon as possible for advice.

- Do not stand in the bath at any time
- Kingkraft products are intended for domestic and commercial use only
- Kingkraft baths are intended only for bathing people and adjusting the height for carers requirements
- Do not exceed the maximum load marked in the unit (133kg, 21st) which is also displayed on the bath
- Do not put excessive load on the moving side when it is at its lowest point, when it is moving or when it is at the top –this could damage the mechanism
- Only one person should be in the unit at any one time
- The handset should not be submerged in the water, if it should drop in the water, dry it immediately and do not leave it under the water
- If whirlpool fitted, under no circumstances should bubble bath be used as this will froth excessively
- Check the Lifestyle frequently for damage, especially any cables / wires and the rubber door seal. If you find signs of damage, do not use the bath and contact Kingkraft to arrange a service and/or repair.

Your bath should only be used if any powered equipment on it (e.g whirlpool raise / lower system etc.) is connected to a suitable power supply protected by an earth leakage circuit breaker. Ensure this is tested on a regular basis and if you are any in doubt contact a competent electrician. The bath is made from GRP material and the cushions are made from PVC with filler foam, No naked flames are to be in the vicinity of the bath.

GENERAL DESCRIPTION

The Lifestyle bath is designed primarily as an assisted bathing bath incorporating a unique opening side for easy access and variable height to help carers.

The opening side also allows the Lifestyle bath to be used as a general purpose changing platform.

The base of the bath is set at wheelchair height when the bath is at its lowest level to allow easy transfer from a wheelchair.

Cushioning and positioning sets can be purchased from Kingkraft

The maximum bath and shower temperatures are pre-set and regulated by thermostatic mixer valves, incorporating over temperature shut down protection. As standard a RADA Sense Digital mixer tap is supplied. This can be mounted on the wall or on the bath.

We recommend applying instructions on the wall (Kingkraft can supply laminated versions) so that the instructions are visible for all users and carers.

CLEANING

Certain bath additives may damage the bath, if they contain bleach or other corrosives due to the product the bath is made from. Use only water, normal soaps and approved cleaning agents. Under no circumstances should bleach be used.

We recommend Chemgene which can be purchased from Kingkraft. Regular cleaning routines should be followed.

- Do not use pressurised jets
- Do not steam clean
- If a whirlpool is fitted, we recommend Bronte 6 month whirlpool cleaner which can be purchased through Kingkraft

IMPORTANT INFORMATION

Cleaning and care of the door seal

The Lifestyle door must be cleaned regularly to ensure it seals properly everytime the bath is used. This can be done by opening the door when it is at the top, before it starts to lower, creating a small gap which should be enough to run a cloth between the seal and the door.

Alternatively you can lower the door to its lowest position and then reach up to the flat side of the door with a cloth from underneath and carefully run it over the seal.

Door storage position when not in use

The door must be kept in OPEN position when not in use. This means the door seal should not be kept pressed up against the bath tub whilst not in use, especially for long periods of time. This could lead to permanent deformation / flattening of the rubber seal, causing the bath to not seal properly.

Cleaning the whirlpool (if fitted)

Regular cleaning is recommended for the whirlpool.

- Remove all cushions and supports in the bath
- Rinse any debris from the bath
- Close drain by operating pop-up waste control
- Fill bath with water to a level of 25mm (1") above the whirlpool jets
- Put in the whirlpool cleaner to the guidelines stated on packaging
- Run whirlpool for 20 minutes
- Drain bath
- Fill bath with clean water to measurements as above
- Run whirlpool for 5 minutes
- Drain bath
- Chemgene is also recommend for general cleaning of the bath

RISK OF SCALDING

Although safety devices are fitted to minimise any risk of scalding, users must be aware that these are not fail safe. The temperature of the unit must be independently verified on each occasion it is used-this should be tested ideally with a calibrated thermometer.

Refer to Kingkraft if the water is too hot or too cold and do not use the bath until the problem has been corrected.

WARNING OF TRAPPING

Care must be taken to avoid trapping anything between the moving door side and the bath tub or other objects surrounding the bath.



The Lifestyle has been designed to minimise risk of trapping items during the use of the door mechanism, however users must be aware of any items or parts of the body which could be caught whilst the door is moving, Releasing the buttons on the handset will stop the moving of the bath.

IMPORTANT SAFETY INSTRUCTIONS

HANDSET OPERATING INSTRUCTIONS



DOOR 'OPEN / CLOSE' BUTTONS

BATH 'RAISE / LOWER' BUTTONS

ALWAYS KEEP THE BUTTONS PRESSED UNTIL THE DOOR/BATH STOPS BY ITSELF

PRESS HERE TO **CLOSE** THE DOOR
SIDE

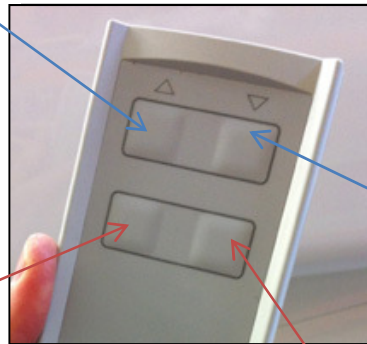

PRESS HERE TO **OPEN** THE DOOR
SIDE

PRESS HERE TO **RAISE** THE BATH

PRESS HERE TO **LOWER** THE BATH

IMPORTANT SAFETY INSTRUCTIONS

DOOR SIDE OPERATION

The door side open / close mechanism has a safety sensor built into the system.

This only comes into effect when water is present in the bath tub.

The sensor can disable the door side from operating when water is in the bath tub.

If the key switch is turned counter clockwise the sensing device is turned on. Once the door is in the closed / fully raised and sealed position, and water is let into the bath, this device will not allow the door to be opened / lowered whilst there is water in the bath tub. The water will need to be completely drained from the bath to allow the door side to open / lower.

KEY SWITCH

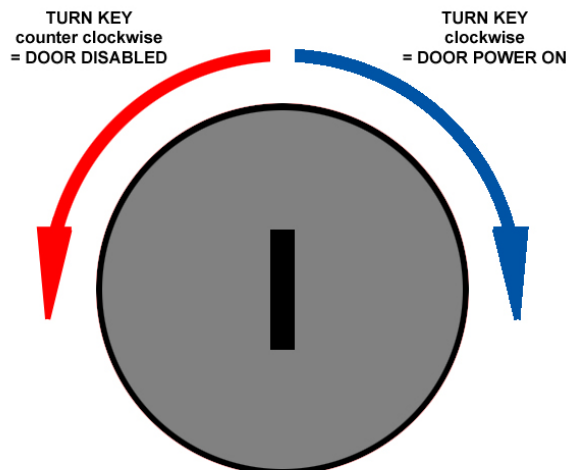

WARNING

If the key switch is turned to the right / clockwise, this bypasses the safety sensor and will allow the door to be opened / lowered, *even if water is in the bath!*

Do NOT press the Door 'Open' / 'Lower' button whilst water is in the bath unless in an emergency.



If pressed the door seal will be released and water will be let out the front of the bath.

This function is provided in case of an emergency and for quick extraction of the bather, allowing the door to be opened whilst water is in the bath **but this will let all water out of the front of the bath!**

When the bath lifting system is moving, the maximum load noise, 1 metre away, does not exceed 65 dBA. Please carefully read the instructions which apply to your model. Maximum work load is 133kg, including water, patient, mattress and other accessories.

The baths power supply is mains supplied.

The Bathing process

Ensure the door is fully closed before filling, no light should be seen between the seal and the bath tub. The water should be turned on as described below and allowed to flow into the bath with the pop-up wastes open to allow the water to flow away. This process should be continued until the water temperature is perceived to be constant. This operation will allow the mixed water temperature to increase to the required level and permit the carer and/or user to check that the maximum temperature is safe prior to use. If the temperature is not comfortable then there may be a fault and Kingkraft should be contacted immediately. Close the waste plugs.

Standard control options

RADA Sense System – Bath fill only

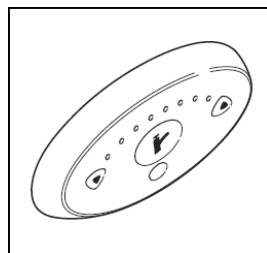

RADA Sense System – Bath/Shower fill

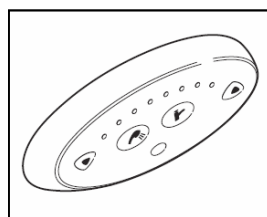

The control panel can be mounted on the wall or the bath tub. Move your hand in front of the 'bath fill' symbol /sensor to start the flow of water. The temperature of the water can be increased by holding/waving a hand in front of the red 'hot' sensor on the right of the control panel. The temperature of the water can also be reduced by holding/waving a hand in front of blue 'cold' sensor on the left of the control panel. Lights will indicate where between the minimum and maximum

temperature the water temperature is currently set. To stop the bath filling, hold / wave a hand in front of the 'bath fill' symbol.

The above bath fill options should be set to a maximum temperature of 43°C when the valve control is fully turned/set at its maximum. Always allow time for the mixed water to run through the systems.

REMEMBER THE TEMPERATURE ON THE BATH MUST BE CHECKED ON EVERY OCCASION BEFORE A PERSON IS PLACED IN THE BATH.

Bath Spout

The Lifestyle bath has a water inlet positioned centrally not he side of the bath. When the bath tap is turned, water comes down the side of the bath behind the polished stainless steel baffle plate.

To use the optional hand shower unit

The control panel can be mounted on the bath tub, a bracket or wall mounted near to the bath. Move your hand in front of the 'shower' symbol/sensor to start the flow of water. The temperature of the water can be increased by holding/waving a hand in front of the red 'hot' sensor on the right of the control panel. The temperature of the water can also be reduced by holding /waving a hand in the front of the blue 'cold' sensor on the left of the control panel. Lights will indicate where between the maximum and minimum temperature of water temperature is currently set. To stop the shower, hold/wave a hand in front of the shower symbol.

The above shower options should be set to a maximum temperature of 39°C when the shower valve control is fully turned on. Always allow time for the mixed water to run through the systems.

BATH CUSHIONS AND SUPPORTS

If supplied, to secure cushions

- Ensure that the bath bottom and mattresses are clean
- Place mattress on bottom of bath
- Run a small amount of water into the bath
- Press the mattress firmly on the bottom of the bath

When removing the mattress for cleaning, take care the each sucker is prised carefully away from the bottom of the bath to avoid tearing.

To ensure that the bathing process is relaxing and enjoyable as possible whilst maintaining bather safety it is important that the correct bather supports is used.

Kingkraft manufacture a range of supports which can be used in the Lifestyle bath.

SOME SUPPORTS ARE ATTACHED TO THE BASE OF THE BATH BY SUCKERS. IN ALL CASES THESE SUCKERS SHOULD BE ATTACHED TO THE BATH ITSELF AND NOT TO ANY OTHER MATTRESS OR SUPPORT.

THE USE OF SUCKERS IS DESIGNED TO ALLOW THE SUPPORT TO BE REMOVED. THIS ALSO MEANS THAT THE SUPPORT MAY MOVE INADVERTANTLY IF SUBJECTED TO SUFFICIENT FORCE BY THE USER. EXTREME CARE IS NEEDED TO ENSURE THE SUPPORTS ARE CORRECTED SPECIFIED IF USED.

THE MATTRESSES AND SUPPORTS WILL ALSO HAVE A TENDANCY TO FLOAT. THE BATHER MUST NEVER BE LEFT UNATTENDED IN THE BATH. IF ANY DOUBT ABOUT THEIR SAFE USE OR THE DEGREE OF SECURE SUPPORT REQUIRED DO NOT ATTEMPT TO USE. PLEASE CONTACT KINGKRAFT FOR ADVICE.

WHIRLPOOL, LIGHTS AND MUSIC (IF FITTED)

It is vital for safety and comfort that the operating, cleaning and disinfection procedures contained in these instructions are followed. Some people with heart and other medical conditions may be at increased risk when using the whirlpool. Lights and music, please seek medical advice before using if unsure.

Please note if the bath is installed in a 'multi-user' environment, strict regulations will have to be followed to keep the system regularly cleaned and tested. Kingkraft can not be held responsible if these are not adhered to.

To fill the bath:

Fit the plug into the waste fitting or operate the pop-up waste mechanism. Turn open the bath filling tap and fill the bath until the water level is at least 25mm (1") above all the outlet jets in the side of the bath.

To start the whirlpool pump:

Press down the on/off control button

To vary the amount of turbulence in the bath, turn the control button on the bath either clockwise to increase or anti-clockwise to decrease.



Adjusting the eye ball jets:

Can be adjusted by placing a finger in the jet hole and turning it to the desired position

Switch off:

Press the on/off button

Whirlpool pump protection

Should the whirlpool system be accidentally operated at any time with insufficient water, the dry run protection unit will automatically switch the pump off. The whirlpool system can only then be started when there is sufficient water in the bath. The whirlpool will automatically shut off after 20 minutes. You may restart if required. Always have regard to the users medical condition and state of health when using the whirlpool.

Note: Normal bubble baths will froth excessively with whirlpools and can pose a major safety risk to the user and potentially cause damage to surrounding fittings.

Please refer to cleaning instructions on how to keep your whirlpool clean.

LIGHTS

Your bath may also be fitted with lights to help create a sensory experience whilst bathing. Below are instructions on how to use. There may be risk to some users with the lights, please check with medical experts before using if unsure.

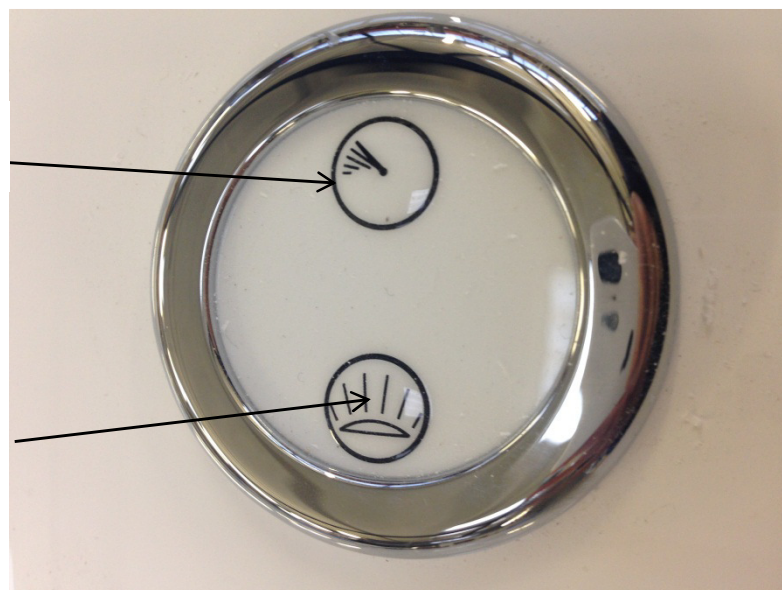

Change sequence of lights

Press to turn on / off

MUSIC

Your music is connected via Bluetooth via your Smart Phone or Tablet or a device that has Bluetooth connections, you will find the below mounted on your bath so you can adjust the volume whilst bathing.



To turn on:

On your music source, turn on Bluetooth and adjust the volume to mid range.

Ensure your electric supply to your bath is turned on, the control knob will flash blue (as shown in picture) as it searches for your device. Use your device to search for 'bath sound®' and pair with it. You will have 90 seconds to do this before your 'bath sound®' goes to standby mode. When paired successfully the control knob light will stay on permanently.

To turn off:

At the end of listening to your music, un-pair the two devices or switch off your Bluetooth device.

INSTALLATION

Your kingkraft bath should only be installed by competent installers. However if you have to move or re-install your bath for any reasons, please take care to read the requirements given in our installation guide, Kingkraft can carry out this work, contact us for further advice.

THE UNIT MUST NOT BE CONNECTED VIA A PLUG AND A SOCKET

The power supply to the bath must be wired into the supply via an isolator, which supplies only the bath. Full instructions are given in our installation guide and these must be adhered to. Please contact Kingkraft for further advice.

MAINTENANCE

If your bath is not going up and down but making a beeping noise, firstly check that the power supply has not been turned off to the bath. If the power supply is turned on, try the below.

This Initialisation Procedure is regarding the lifting mechanism on the following products:

Kingkraft Variable Height Lifestyle Bath

If the bath will not respond to the pressing of the raise or lower buttons on the handset / membrane switch, and you can hear a beeping sound coming from the bath, you will have to follow this initialisation sequence to re-set the bath.

Failure of the mains power to the bath, or running the bath off the back-up battery only could lead to the synchronisation of the lifting columns becoming compromised, causing the system to stop working until it is reset.

Initialisation Procedure

- Press both up and down button at the same time for at least 5 seconds. This will activate the new manual mode. The buzzer will beep.
- After the 5 seconds the beep will change to a shorter / different kind of beep. Release the up and down button and then press the down button only (this has to be done within 5 seconds. If not the beep will stop and you have start all over again from point 1)
- During pressing the down buttons all columns will drive inwards. The beep will be continuous as long as the columns are driving inwards. Columns have to be driven all the way down after which the beep will stop. The system is then initialized and ready for use.

We recommend an annual service on all Kingkraft products. If any faults are found in the unit, contact Kingkraft immediately.

Contact Kingkraft for a quote on servicing your Lifestyle bath

Below is a table to help you keep record of when Kingkraft have attended. However we will always send a reminder letter when the service is due.

Date	Work carried out	Kingkraft engineer

Notes:

BATH MARKINGS

The following are examples markings possibly found on the Lifestyle bath:

Made in the UK - Date:

This appliance must be earthed.
Regular Inspection / Service recommended
Do not clean with bleach based products

Supply Rating: 230V ~ 50 Hz
Maximum Load: 130Kgs (21St)
Serial Number:



Kingkraft
TAILOR-MADE FOR ASSISTED LIVING

26D Orgreave Crescent,
Dore House Ind. Estate, Sheffield, S13 9NQ
Tel: 0114 269 0697 Fax: 0114 269 5145

This sticker will display your unique serial number for your bath, make sure you make a note of your serial number for future reference.

GUARENTEE DETAILS

The Lifestyle and its accessories are guaranteed in the UK for a period of 12 months from the date of delivery against defects arising from faulty material, inferior workmanship or construction. The result of incorrect handling of the bath shall not be covered by any guarantee. In line with the company's policy of continual product improvements, we reserve the right to carry out improvements to the specification without notice.

WEEE (Waste Electrical and Electronic Equipment Regulations 2006)

The aim of this Directive is to minimise the impact of electrical and electronic equipment on the environment when products become waste. All electrical components on this product must be disposed of in accordance to the WEEE 2006 regulations, either through reuse, recovery, recycling or environmentally sound disposal.

If this Kingkraft product is at the end of its life or electrical parts are replaced during its life-cycle by people other than Kingkraft Engineers, please contact Kingkraft to discuss arrangements regarding the disposal of any of the electrical equipment.