

Johnson's

CABINETS

www.JohnsonsCabinets.com

Orders@JohnsonsCabinets.com

(574)-218-7098



ProKitchen
Professional Design Software

Our full catalog is available on ProKitchen Professional Design Software. Ask your rep for Johnson's Cabinets.



The number one RTA cabinet in the industry. Proudly made in Elkhart, Indiana.

Johnson's **CABINETS**

“Spec Book”

We offer top-quality ready-to-assemble cabinets with excellent customer service.

Our cabinets use an easy RTA assembly method, using tools you already own.

Each box is carefully packed with high-quality materials, including a full-color picture, barcode, and QR code.

Our cabinets are proudly made in the USA with 1/2" box construction, hardwood doors, and face frames.

They feature high-grade soft-close hinges and full-extension drawer slides for durability and functionality.

Plywood box cabinets have undermount soft-close drawer guides, while particle board box cabinets have side-mount guides.

Choose from Maple, Hickory, or Cherry wood species in various finishes including White, Grey, Navy, Provincial, and Espresso.

Unfinished options are also available for all three wood species for personalized preferences.

Johnson's CABINETS

“Standard Wall Cabinets”

Description and use of the part number system used by Johnsons Cabinets:

The letters indicate the type of cabinet (W = wall cabinet - B = base cabinet etc.)

The first number indicates the width (W930 = 9” wide cabinet)

The second number indicates the height (W930 = 30” high cabinet)



Wall 12” Deep Single Door Cabinets

W930	W936	W942
W1230	W1236	W1242
W1530	W1536	W1542
W1830	W1836	W1842
W2130	W2136	W2142
W2430	W2436	W2442



On double door cabinets you have the option of ordering with or without a center style on some cabinets. BUTT means there is no center style to divide the cabinet.

Wall 12” Deep Double Door Cabinets

W3012.BUTT	W3018.BUTT	W3024.BUTT
W3612.BUTT	W3618.BUTT	W3624.BUTT
W2430.BUTT	W2442.BUTT	W2436.BUTT
W2730.BUTT	W2742.BUTT	W2736.BUTT
W3030	W3042	W3036
W3030.BUTT	W3042.BUTT	W3036.BUTT
W3330	W3342	W3336
W3330.BUTT	W3342.BUTT	W3336.BUTT
W3630	W3642	W3636
W3630.BUTT	W3642.BUTT	W3636.BUTT

Wall 24” Deep Double Door Cabinets

W3612.24.BUTT
W3618.24.BUTT
W3624.24.BUTT



Johnson's **CABINETS**

“Wall Corner Cabinets”



Wall Diagonal Corner Cabinets

WDC2430

WDC2436

WDC2442

The blind wall cabinet is able to move up to 3” away from the wall and can be flipped to do either a right or left blind cabinet.



Wall Blind Corner Cabinets

WBLC3930.BUTT

WBLC4230.BUTT

WBLC3936.BUTT

WBLC4236.BUTT

WBLC3942.BUTT

WBLC4242.BUTT



Wall Microwave Shelf Cabinet (no doors)

WMICSH3018.ND

Johnson's CABINETS

“Standard Base Cabinets”

On single door base cabinets, the letter at the end specifies which side the door will be hinged.



Base Full Height Single Door Cabinets

B9.FH.R	B15.FH.R	B21.FH.R
B9.FH.L	B15.FH.L	B21.FH.L
B12.FH.R	B18.FH.R	B24.FH.R
B12.FH.L	B18.FH.L	B24.FH.L



Base Full Height Double Door Cabinets

B24.FH.BUTT	B30.FH.BUTT	B36.FH.BUTT
B27.FH.BUTT	B33.FH.BUTT	



Base Single Door Cabinets

B12.R	B18.R	B24.R
B12.L	B18.L	B24.L
B15.R	B21.R	
B15.L	B21.L	



Base Double Door Cabinets

B24.BUTT	B30.BUTT	B36.BUTT
B27.BUTT	B33.BUTT	

Base Sink Cabinets

BS30.BUTT
BS33.BUTT
BS36.BUTT



Base Farmhouse Sink Cabinets

BFHS36.BUTT

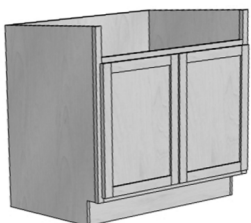

Johnson's **CABINETS**

“Other Base Cabinets”



Base 3 Drawer Cabinets

B12.3D B21.3D B36.3D
B15.3D B24.3D
B18.3D B30.3D



Base 4 Drawer Cabinets

B18.4D
B24.4D

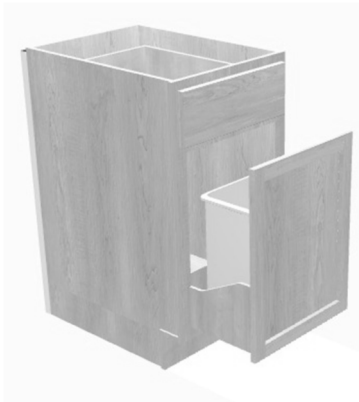

Base Waste Basket Cabinets

BWB18

Johnson's **CABINETS**

“Base Corner Cabinets”

Base Lazy Susan Cabinets

BLZS3030.18



This cabinet will fill the space of a 36 X 36 cabinet. It is designed to be held off the wall 6” on both sides. It has a wooden lazy susan spinner.

Base Easy Reach Corner Cabinets

BEZRC36

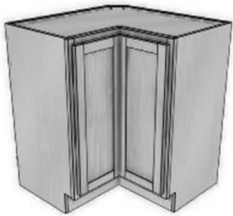

This cabinet has 2 adjustable shelves. One going in each direction to allow multiple different configurations for optimal storage space.



Base Blind Cabinets

BBL39

BBL42

This cabinet can be used as a right or left. It is built to allow up to 3” of movement away from the wall. Doors and drawer can be moved to either side to allow the same cabinet to be used as a right or left corner.

Johnson's CABINETS

"Tall Pantry Cabinets"



Our pantries come in 2 pieces. The bottom section is always 54" tall and the top sections are different heights to make the size of pantry needed.

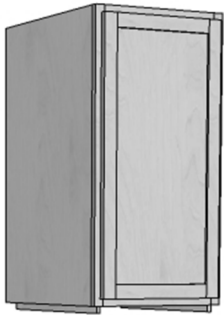

Tall Pantry Upper Cabinets

T1830.24.R
T1830.24.L
T1836.24.R
T1836.24.L
T1842.24.R
T1842.24.L

T2430.24.R
T2430.24.L
T2436.24.R
T2436.24.L
T2442.24.R
T2442.24.L

T2430.24.BUTT
T2436.24.BUTT
T2442.24.BUTT



Tall Pantry Base Cabinets

T1854.24.R
T1854.24.L
T2454.24.R
T2454.24.L
T2454.24.BUTT

Johnson's CABINETS

"Vanity Cabinets"



Vanity 3 Drawer Cabinets

VB1234.21.3D
VB1534.21.3D
VB1834.21.3D
VB2134.21.3D
VB2434.21.3D

We offer our standard vanities in 2 heights (31 1/2" & 34 1/2") and 2 depths (18" & 21") The part number indicates width, height and depth. We also offer these with a full back or an open back. The open back (NB) cabinets have a 4 1/2" stringer across the top in the back so that you can still fasten the countertop and fasten to the wall. This option saves you from cutting out the back for plumbing that is coming through the wall.

Vanity Sink Base 2 Door Cabinets



VSB24.31.18	VSB24.31.18.NB	VSB24.34.18	VSB24.34.18.NB
VSB30.31.18	VSB30.31.18.NB	VSB30.34.18	VSB30.34.18.NB
VSB36.31.18	VSB36.31.18.NB	VSB36.34.18	VSB36.34.18.NB
VSB24.31.21	VSB24.31.21.NB	VSB24.34.21	VSB24.34.21.NB
VSB30.31.21	VSB30.31.21.NB	VSB30.34.21	VSB30.34.21.NB
VSB36.31.21	VSB36.31.21.NB	VSB36.34.21	VSB36.34.21.NB
VSB42.31.21	VSB42.31.21.NB	VSB42.34.21	VSB42.34.21.NB

Vanity Sink Base 3 Door Cabinets



VSB48.31.18	VSB48.34.18
VSB48.31.18.NB	VSB48.34.18.NB
VSB48.31.21	VSB48.34.21
VSB48.31.21.NB	VSB48.34.21.NB



Vanity Sink Base 4 Door Cabinets

VSB60.31.21	VSB60.34.21
VSB60.31.21.NB	VSB60.34.21.NB

Johnson's

CABINETS

"Accessories"

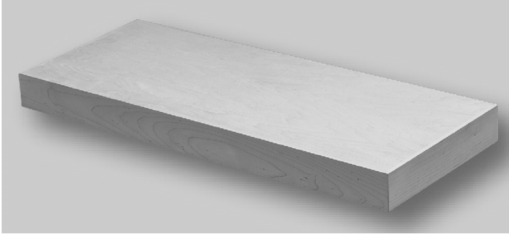

FS12.8
 FS16.8
 FS24.12
 FS30.12
 FS36.12
 FS42.12

Floating Shelves

Our floating shelves feature a very strong wooden mounting system that is easy to mount to the wall. It has been tested at 50lbs. They come in 2 depths - 8" for the smaller 2 sizes and 12" for the rest.



Wall Skin

WSK12.12
 WSK12.18
 WSK12.24
 WSK12.30
 WSK12.36
 WSK12.42

Base skin code:

U = universal (no toe kick notch)
 R = notched for right side of cabinet
 L = notched for left side of cabinet

Tall Skin

TSK2484.U
 TSK2484.R
 TSK2484.L
 TSK2490.U
 TSK2490.R
 TSK2490.L
 TSK2496.U
 TSK2496.R
 TSK2496.L

Base Skin

BSK2434.U
 BSK2434.R
 BSK2434.L

Skins (panels)

SK4896
 SK3696
 SK2496



Toe Kicks

TK-96
 TK-60
 TK-36



Fillers

WF330 TF696
 WF336 TF396
 WF342 BF330
 WF630



Valance

V548
 V572

We offer straight valances that can be cut to whatever length you desire. They feature a rounded edge profile on the one side.

Johnson's CABINETS "Accessories"

Trim Molding Accessories

CRMS3.96
SM96
SHM96
QR96
ICCM96
OCM96
CRMS3.48
SM48
SHM48
QR48
ICCM48
OCM48

Trim description:

CRM = crown molding
SM = scribe molding
QR = quarter round
ICCM = inside corner
OCM = outside corner
SHM = shoe molding

Our cabinets come standard with 1/2" shelves but can be upgraded to 3/4" by using the following:

Wall 3/4 Thick Shelf Kit Upgrade

W12.2SK
W15.2SK
W18.2SK
W21.2SK
W24.2SK
W27.2SK
W30.2SK
W33.2SK
W36.2SK
WBC39.2SK
WBC42.2SK
WDC24.2SK

Base Cabinet 3/4 Shelf Kit

B12.1SK
B15.1SK
B18.1SK
B21.1SK
B24.1SK
B27.1SK
B30.1SK
B33.1SK
B36.1SK
BBC39.1SK
BBC42.1SK
BERC36.2SK

Replacement Hinges

Replacement Drawer Guide Clips Pairs
Replacement Drawer Guide Backmounts Pairs
Replacement Drawer Guides

BW.RH
BW.RH.1.FO
BW.RDG 24
BW.RDG 21
BW.RDG 18
BW.RDG.Clips
BW.RDG.BM

Rollout trays are a great way to utilize space more effectively. Our kits can be installed at any time into any of our base cabinets and pantry cabinets.

Rollout Trays STD

ROT12.24
ROT15.24
ROT18.24
ROT21.24
ROT24.24
ROT27.24
ROT30.24
ROT33.24
ROT36.24

Standard rollout trays are 2 1/2" high and come with side mount epoxy drawer glides.

Rollout Trays Deluxe

ROTDLX12.24
ROTDLX15.24
ROTDLX18.24
ROTDLX21.24
ROTDLX24.24
ROTDLX27.24
ROTDLX30.24
ROTDLX33.24
ROTDLX36.24

Deluxe rollout trays are 4" high and come with under-mount soft close drawer glides.