

auto electrical parts

Technical Information Sheet

Part No. 0-485-75

Momentary on, push button horn switch, single pole with screw terminals. 5 amps at 12 volts dc rating. Replaces SPB160.



Technical Drawing (not to scale)

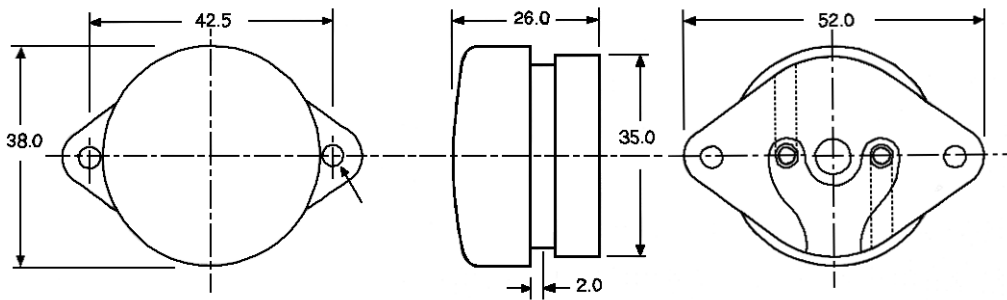

Specification

Type	Single pole momentary on/off push switch
DC inductive rating	5 amps @ 12 volts
Terminals	Brass, 2 x 2.85mm slot head screws
Weight	40g
Dimensions	l 52 x w 26 x h 38mm

The information contained in this document is correct to the best of our knowledge at the time of printing. However, specifications may change at any time without notice.