

auto electrical parts

Technical Information Sheet

Part No. 0-420-74

A compact 24 volt HID Xenon work lamp with black plastic body and a glass lens on a four hole fixing bracket. Supplied with Xenon bulb and power pack. I 110 x w 118 x h 99mm

Additional information

Lead length lamp to power pack 450mm. Bracket allows for tilt through ~140° and 360° rotation.



Technical Drawing (not to scale)

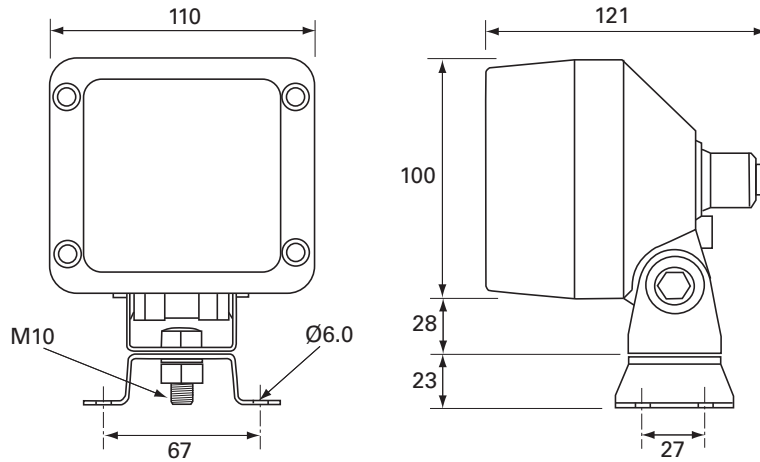

Specification

Type	HID work lamp
Voltage	16-32 volt dc
Current	3.5 amp nominal (8.5 amp max)
Bulb	Xenon D2S 35w 4300K
Lens	Hardened glass
Housing	PA6 plastic
Temperature range	-40°C to 105°C
Weight	1.45g (including power pack)
Dimensions	I 110 x w 121 x h 151mm (including bracket)
Protection	IP64

The information contained in this document is correct to the best of our knowledge at the time of printing. However, specifications may change at any time without notice.