



Bucket

INTRODUCTION |||

Bucket is as bucket shape structure, used for excavating, transporting of soil, sand, and other loose materials. Mainly composed of shovel blade assembly, arc plate, side plate assembly, hinge assembly and other parts.

CLASSIFICATION |||

- 1.By working mode: front shovel and backhoe.
- 2.According to the working condition: mud bucket, earthwork bucket, strengthening bucket, rock bucket, etc.

PARAMETERS |||

	Unit	
Bucket capacity	m ³	0.02–7.3m ³

Tilt Bucket

INTRODUCTION |||

Tilting bucket can be left and right tilting Angle, more convenient operation, higher efficiency. It is mainly used for slope plane dressing and large capacity dredging and cleaning of river and ditch.

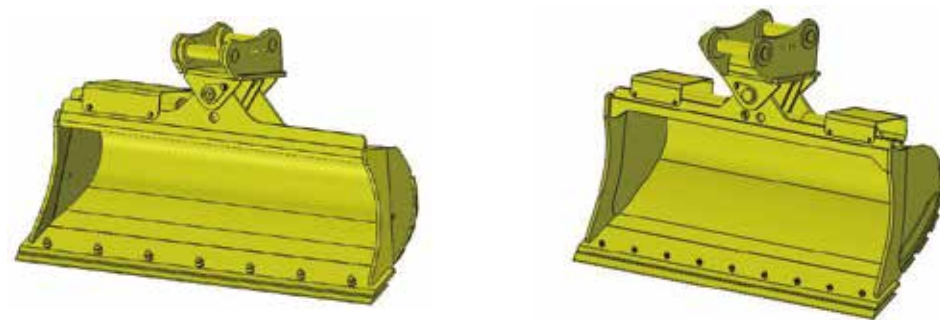

CLASSIFICATION |||

Single cylinder tilting bucket

Double cylinder tilting bucket

PARAMETERS |||

	Unit	
Bucket width	m	0.9-2m



Thumb Bucket

INTRODUCTION

Thumb bucket is a multi-functional tool developed on the basis of digging bucket, which can be dug and clamped. It is multi-functional and convenient to operate. It is suitable for stone loading and unloading truck, strip material grabbing and block material lifting

CLASSIFICATION

Stationary

Mechanical

Hydraulic

PARAMETERS

	Unit	
Bucket capacity	m ³	0.02–7.3m ³