



# Cruiser

## User Manual



**CYCLE TORCH**

# Thank you for purchasing one of our products!

We are truly honored to be able to serve you and provide you with the best Experience possible. If you've enjoyed our product, we would sincerely appreciate your honest feedback.



*If for any reason you are not satisfied, please contact us as soon as possible at [hello@cycletorch.com](mailto:hello@cycletorch.com) , so that we can help you to solve any issues!*

To ensure maximum experience and safety, familiarize yourself with ALL aspects of your new lights and battery systems:

<b>1.</b>	<b>Safety Precaution</b>	<b>3</b>
<b>2.</b>	<b>How to Install</b>	<b>4</b>
<b>3.</b>	<b>How to Charge</b>	<b>5</b>
<b>4.</b>	<b>Switching Lighting Modes</b>	
	Cruiser Headlight	<b>6</b>
	Bolt Tail Light	<b>7</b>
<b>5.</b>	<b>Model Specifications</b>	<b>8</b>
<b>6.</b>	<b>Warranty, Support, and Customer Service</b>	<b>9</b>

# Safety Precaution

- 1 Never look directly into bike light;
- 2 Avoid directing the light beam into the eyes of another person;
- 3 Do not place it within children's reach;
- 4 Before your trip, please make sure that the light is firmly mounted to the handlebar, it lights up, and the light is not blocked by baggage;
- 5 This product is water-resistant under normal daily use and can be used in the rain. However, do not intentionally submerge it in water.



***Failure to follow these cautions may expose you to risks, can cause damage to the light system and will void the warranty!***

A lighting system can make riding safer and more visible, but the lights are no substitute for common sense. Ride within your capability with consideration for the riding environment.

This product contains components that must be recycled per EU Directive 2002/96/EC and may not be disposed of as unsorted municipal waste!

# How to Install

## CRUISER HEADLIGHT



Fix the light to the handlebar's point where you would like to attach the Cruiser;



Hold the light with one hand, and with another hand, secure it with the rubber strap across the handlebar;



For further details, click the link and watch the **video**:  
[▶ cycletorch.com/pages/videos](https://cycletorch.com/pages/videos)

## BOLT TAIL LIGHT



Attach the rubber strap to one end of the light bracket;



Hold the light with one hand and with another hand secure it with the rubber strap across the seatpost;



For further details, click the link and watch the **video**:  
[▶ cycletorch.com/pages/videos](https://cycletorch.com/pages/videos)

# How to Charge

## CRUISER HEADLIGHT

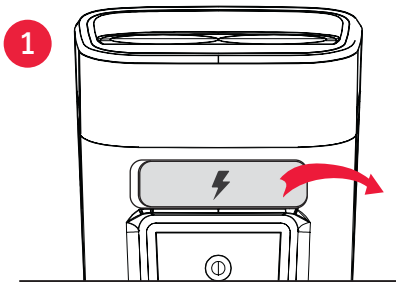

Remove the rubber cap at the bottom of the light;

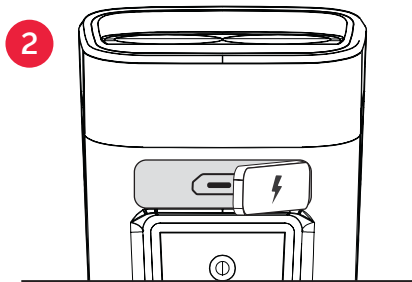

Connect the light to your PC, or a 5V **max 2A** USB battery charger with the USB cable. A LED indicator lights up **red** signaling the charging has started.

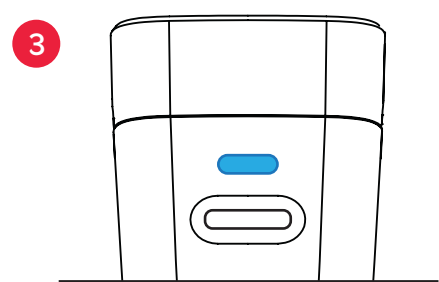

When the LED indicator turns **blue**, charging is complete. Remove the USB cable.

## BOLT TAIL LIGHT

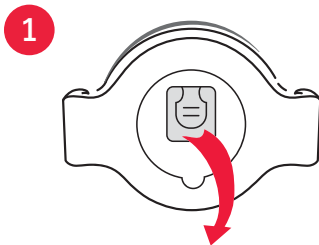

Remove the rubber cap at the bottom of Bolt;

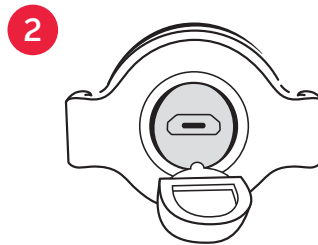

Connect the Tail Bolt to your PC or a 5V max 2A USB battery charger with the USB cable. The lens lights up **red** when the charging starts;

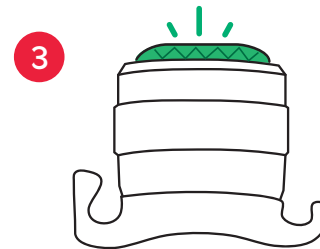

When the lens lights up **green** - charging is complete. Remove the USB cable;

**Charging time:** 2 hours

## TIPS AND TRICKS:

- When your PC is in sleep state, the light cannot be charged;
- Flashing light of the power button shows that a charging error has occurred. Remove and reinsert the USB cable, then begin the recharge process again;
- The battery charges to about 80% after approximately 2 hours;
- Charging and lighting times are approximate values and will vary by environmental and user conditions.



**WARNING**

*The cable (or other accessories) supplied with the Cycle Torch bike lights **MUST** be used only to charge the Cycle Torch bike lights. The Manufacture or/and the Seller are not responsible for any damage caused by using the supplied accessories with devices other than Cycle Torch bike lights.*

## CRUISER HEADLIGHT

# Switching lighting modes

## OPERATION MODES

The initial short press of the Power Button will turn ON the light in High mode. Each additional short press of the power button switches the light from one mode to the next in the following order:

- 1 High
- 2 Medium
- 3 Low
- 4 Flash
- 5 Pulse

Operating modes:	High	Medium	Low	Flash	Pulse
Run time (in hours)	2	4	20	40	40
Power (in lumens)	200	100	20	200	200



## TURNING OFF CRUISER

Press and hold the button for one to three seconds.

## CHECKING BATTERY LEVEL

When CRUISER is turned OFF, press the button for 3 seconds and release. The light will flash from 1 to 10 times indicating the battery level remaining (10 flashes indicate - 100% charge, 9 flashes - 90%, 8 flashes - 80%, 7 flashes - 70%).

## LOW BATTERY LEVEL

CRUISER will automatically turn OFF when the battery level is too low. This system protects the battery from damage, but since it draws a small amount of current, it can drain the battery beyond the minimum voltage for the battery.



*It is strongly recommended to recharge Cruiser when there is less than 20% load (see: check the battery charge level). Do not wait until the light goes completely out as this will greatly reduce the number of charge cycles that the battery can be used and can render the battery unusable.*

*Charge your bike light every 2-3 months when stored or not in use to prevent battery degradation.*

## BOLT TAIL LIGHT

# Switching lighting modes

## OPERATION MODES

The initial two short presses (or single press for earlier models) of the power button will turn on the light on High mode. Each additional short press of the button switches the light from one mode to the next, in the following order:

- 1 High
- 2 Slow flashing
- 3 Quick flashing
- 4 Pulse
- 5 Off



Operation/  
Power button

Operating modes:	High	Slow flashing	Quick flashing	Pulse
Run time (in hours)	5	15-20	10-15	10-15
Power (in lumens)	10	10	10	10

## TURNING OFF

Press & Hold of the power button will shut down the Tail Bolt.

## RUNNING TIME:

5 – 20 hours, depending on the use mode.

## LOW BATTERY LEVEL

The Tail Bolt will automatically turn off when the battery level is too low. This system protects the battery from damage, but since it draws a small amount of current, it can drain the battery beyond the minimum voltage of the battery. That's why it's not recommended to turn ON the lights after the programmed shutdown.



*Do not wait until the Tail Bolt goes completely out as this will greatly reduce the number of charge cycles that the battery can be used and can render the battery unusable. It is highly recommended to recharge periodically the Tail Bolt.*

*Charge your bike light every 2-3 months when stored or not in use to prevent battery degradation.*

# Model Specifications

## CRUISER HEADLIGHT

- **Model range:** CRUISER rechargeable bike light,
- **Brightness:** 200 LM
- **Water-resistant grade:** IP65
- **Light source:** 2 x 3535 ultra-bright LED
- **LED lifespan:** 50,000 hours
- **Low power consumption**
- **Battery:** rechargeable lithium-polymer / 1500 mAh / 3.7V
- **Charge time:** 4 ~ 10 hours
- **Low power warning:** red light warning (blue fluorescent ring changes to red)
- **Battery running time:**
  - 120 minutes in High mode
  - 240 minutes in Medium mode
  - 1200 minutes in Low mode
  - 2400 minutes in Flash mode
  - 2400 minutes in Flash mode
- **Material:** high-quality nylon plastic (ABS)
- **Finish:** Black silicone
- **Weight:** 102 g

## BOLT TAIL LIGHT

- **Model range:** Tail Bolt
- **Brightness:** 10 lm
- **Water-resistant grade:** IP65
- **Light source:** 3535 ultra-bright LED
- **LED lifespan:** 50,000 hours
- **Battery:** lithium-polymer rechargeable
- **Charge time:** 2 ~ 4 hours
- **Battery running time:**
  - 300 minutes in High mode
  - 900 ~ 1200 minutes in Slow flashing mode
  - 600 ~ 900 minutes in Quick flashing
  - 600 ~ 900 minutes in Pulse mode
- **Material:** high-quality aluminum and top-class nylon plastic (ABS)
- **Finish:** black
- **Included accessories:**
  - Silicone strap which fits all standard seat posts;
  - Micro USB charging cable.
- **Weight:** 30 g



# Warranty, Support, and Customer Service

To register your product please go to <https://cycletorch.com> and follow the steps.

Our product quality is controlled strictly in accordance within the standards of **Cycle Torch** quality certification program.

To ensure that all users enjoy the product, we offer **one year warranty** within one year from purchase date, under normal use, the consumer will be provided **free warranty service** for any quality-related problems!



*When requesting warranty service, customer should present Amazon Order ID or numbers provided by online retailers.*

## WARRANTY SERVICE EXCLUSIONS:

- ① Any damages that are caused by other than normal use, including, but not limited to physical damages.
- ② Any user modification, repairs, or disassembly of the product without factory authorization.
- ③ Missing warranty Registration.

*For further information concerning warranty conditions or for any additional issues, please e-mail us at:*

[hello@cycletorch.com](mailto:hello@cycletorch.com)