



Instructions for the JCS Wildlife Smart Ultimate Bluebird House

Placing the Smart Bluebird House: It is best to place your nesting box with the portal facing east, preferably toward an open field or lightly wooded area. Multiple boxes may be mounted about 50 feet apart. The ideal height when mounting a bluebird box is between 4 and 6 feet from the ground. It is best to mount the nesting box between late September and mid-February, before nesting season begins. The earlier you mount the box the better, as this allows more time for the birds to scout it out.

This nesting box has been designed to hang from a post or tree; or it can be mounted to a pole with additional hardware. Since a Wi-Fi signal is required to operate the camera, please keep this in mind when choosing a location. When hanging from a post or tree, simply attach the included hanger bracket to the back of the house using the two smaller screws and the pre-drilled holes (see Fig.1). The larger hole in the hanger should stick up from the back of the house above the roof. Drill the longer screw into the mounting surface then hang the nest box from this screw.

If you wish to mount your nest box from a pole, there are pilot holes pre-drilled in the bottom of the house that will line up with both our Universal Pole Kit and Denali Squirrel Proof Pole System brackets (see Fig.2). Pole options with mounting brackets and squirrel baffles can be found on our website at www.jcswildlife.com.

Maintaining the Smart Bluebird House: It's a good practice to clean your nest box after each family of bluebirds fledge the house. This can be accomplished by opening the side door marked "CLEAN" (see Fig.3). Sweep out any debris, and if necessary, scrub the interior using a natural birdhouse cleaner or by mixing a solution of 10 parts water to 1 part bleach. October is generally the best month to perform a thorough cleaning as most birds are finished raising families by this time. **Note:** Please ensure the nest box is empty of all inhabitants prior to cleaning!

Smart Camera: The Smart Ultimate Bluebird House features a Wi-Fi camera with motion detection. When a bird goes into the nest box, its motion triggers the camera to take a picture. The picture is then sent to your smart phone via the Bird Lover app. The camera itself sits inside a poly lumber housing in the top of the nest box, directly under the roof. The camera can be accessed by removing one screw and tilting the roof up and to the side (see Fig.4). The power switch is located on top of the camera underneath a protective cover. The outlet for the solar battery charging cable is just behind the power switch. The camera battery can also be charged by removing it from the house and using a standard USB-C cable plugged into a computer or power outlet. To remove the camera, simply unplug the solar charging cord, grasp the camera and pull it out of the housing. To reinstall, simply repeat these steps in reverse order. Please be sure to reinsert the screw in the top left corner of the front panel to secure the roof in place. A micro-SD card (not included) can be installed in the smart camera in order to save captured images. The Bird Lover app also offers Cloud storage options (paid subscription required). Detailed instructions for syncing the camera to your smart device and navigating the Bird Lover app can be found within the app itself.

Solar Panel: The included solar panel plugs into the camera via a cable that runs from the camera under the roof of the nest box, out the ventilation gap located under the roof on the right side of the house and into the solar panel (see Fig.5). The cord is 9.8 feet (3 meters) long, making it possible to mount the solar panel a fair distance from the birdhouse if desired. For example, if you place your house in the shade, you could mount the solar panel in a sunny location up to 9 feet away. Additionally, if you place the house on a pole, the solar panel could be mounted to the back of the nest box using the supplied hardware (see Fig.6). The solar panel comes with a versatile mounting bracket that allows you to secure it to just about any flat surface. The panel itself attaches to the mount with a pivoting head that can be rotated to an ideal angle to catch the sun. As with any solar powered device, the efficiency of the charge is based on the amount of sunlight it can absorb. Per our research, solar panels used in the US (Northern Hemisphere) are best positioned facing more to the south to achieve optimal efficiency. Additionally, the solar panel may require cleaning from time to time. The flatter it is positioned, the more likely birds will be tempted to use it as a perch. We recommend using a soft-bristled brush and water to clean the solar panel should the need arise.

*****UPDATE 01/22/2024*** We are now including a set of three ½” screws with the solar panel to use when attaching the panel to the Smart Hopper Feeder or Smart Ultimate Bluebird House. These screws will not poke through to the inside of the feeder or house. They can be found in the solar panel box, stuck in the foam packaging material next to the factory hardware kit under the panel.**

Features of the Smart Bluebird House:

- Integrated motion detection Wi-Fi smart camera allows you to see the birds entering, exiting and living in the house on your smart device.
- Bird Lover app is simple to install and use on your smart phone.
- Included solar panel provides automatic charging for the camera battery.
- Solar panel is extremely versatile, offering many mounting location options up to 9' from the house!
- Camera is removable for corded recharging if desired.
- Ventilation, drainage holes and gaps are in place to promote proper circulation and ensure a healthy environment for the inhabitants.
- Grooves, or kerfs, are cut into the inside front of the house below the entrance portal to assist the birds when exiting the nesting box.
- A metal riser is included so that the nest can be built off the floor for better circulation and hygiene.
- The portal / predator guard has been designed to be the perfect size for bluebirds.
- New tilting roof design provides easy access to the camera and cables by removing one screw.
- House is constructed with recycled poly-lumber which will not crack or fade in the elements.
- Fully assembled and partially made in Southern IN, USA.

Additional Items to Note:

- The camera used in the Smart Bluebird House relies on a Wi-Fi signal. To function properly, it must operate within the parameters of your home Wi-Fi system.
- The camera is installed in the nest box for shipping. You will need to remove it from the housing to power it on. Also, please do not forget to peel off the protective film covering the lens.
- The Bird Lover app can be downloaded from both the Google Play Store and Apple's App Store. JCS Wildlife did not design the app, nor do we administer it. Please feel free to contact our Customer Service team should questions arise; but please know that we can only provide minimal support for the app itself.
- Detailed smart camera and solar panel technical specifications can be found on a separate page in these instructions.

Questions or Comments? Please call JCs Wildlife at 812-867-2800 for assistance.

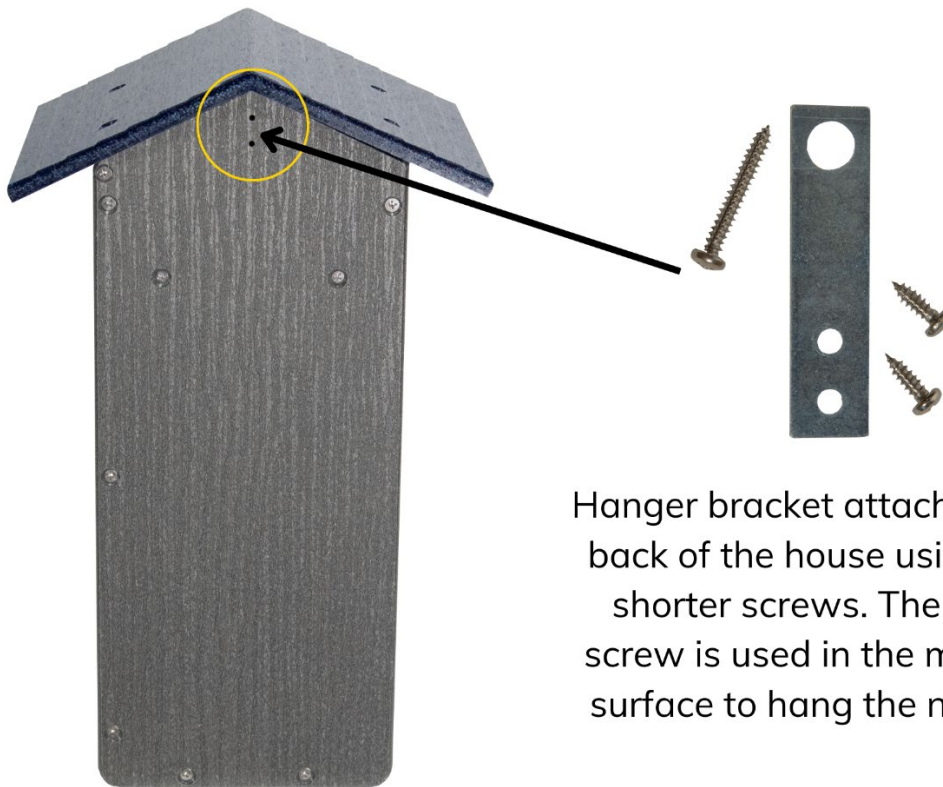

Hanger bracket attaches to the back of the house using the 2 shorter screws. The longer screw is used in the mounting surface to hang the nest box.

Fig.1

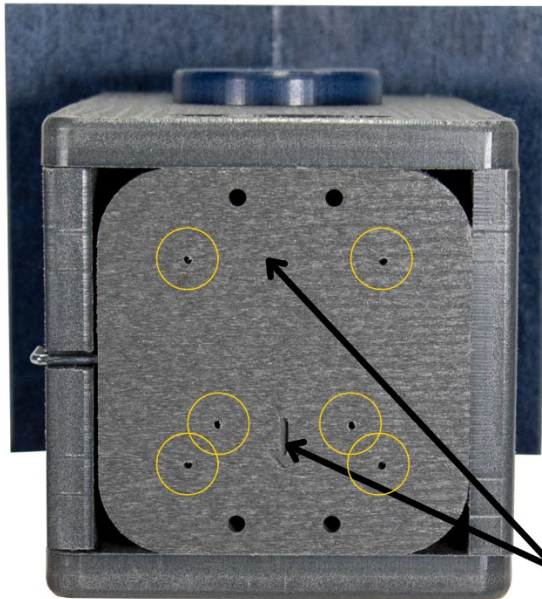

The Ultimate Bluebird House can be easily pole mounted to our Universal Pole Kit (UPK) or Denali Squirrel Proof Pole System.



A JCS Wildlife universal mounting bracket can be affixed to the bottom of the house using the pre-drilled holes.

Fig. 2



To clean and maintain the birdhouse, simply rotate the lever at the bottom of the door marked "CLEAN" to its down position. The door can then be lifted up to access the interior. When finished, close the door and rotate the lever back into the locked position (facing up).

Fig.3

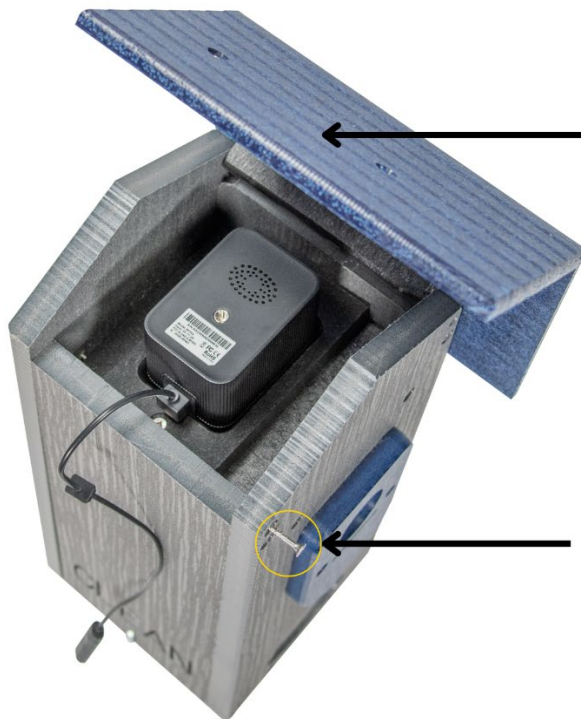

Hinged roof will tilt fully to one side, providing easy access to the Wi-Fi camera.

Remove this screw to access the camera which is housed in a receptacle under the roof.

Fig.4

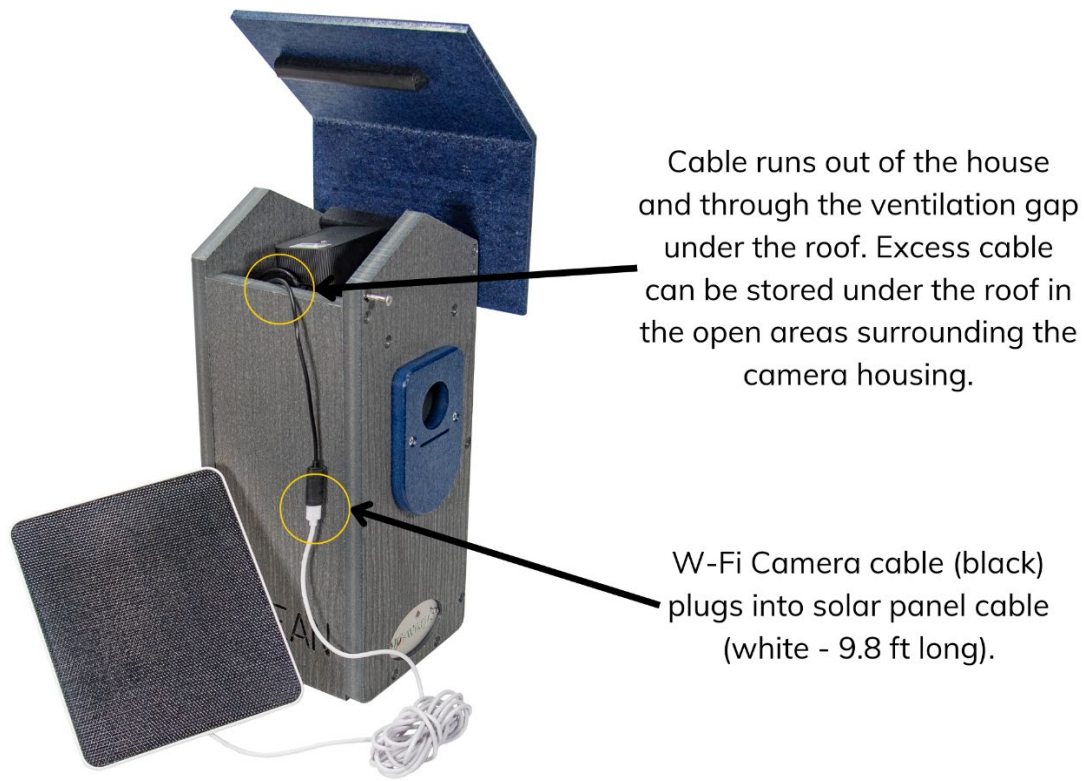

Fig.5

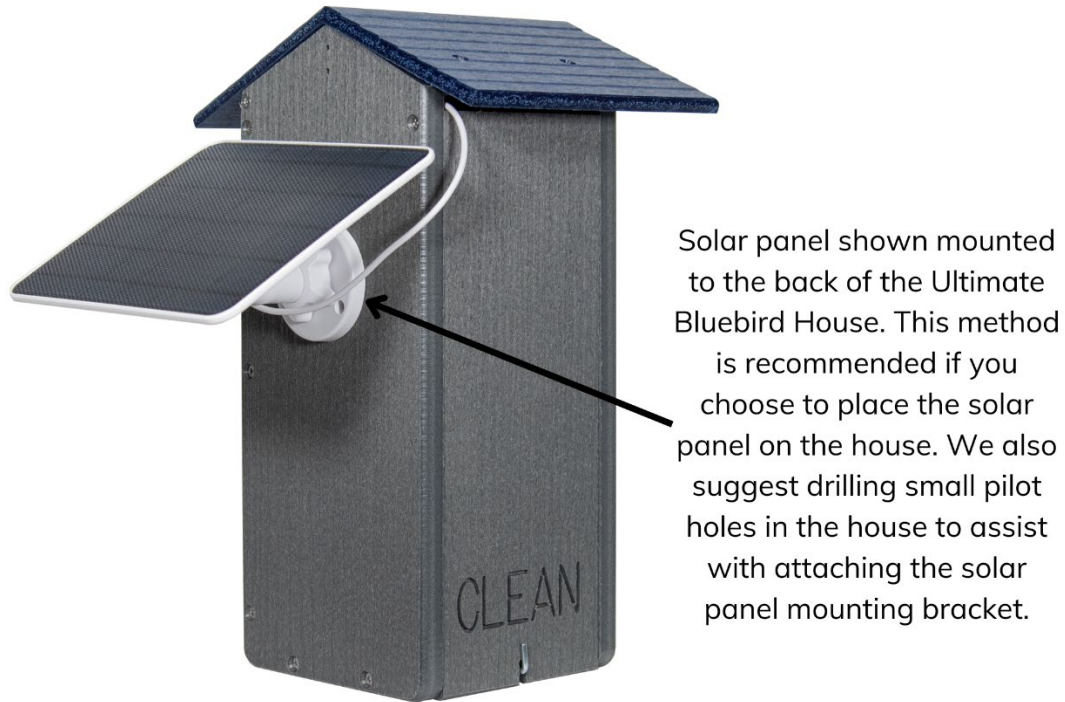
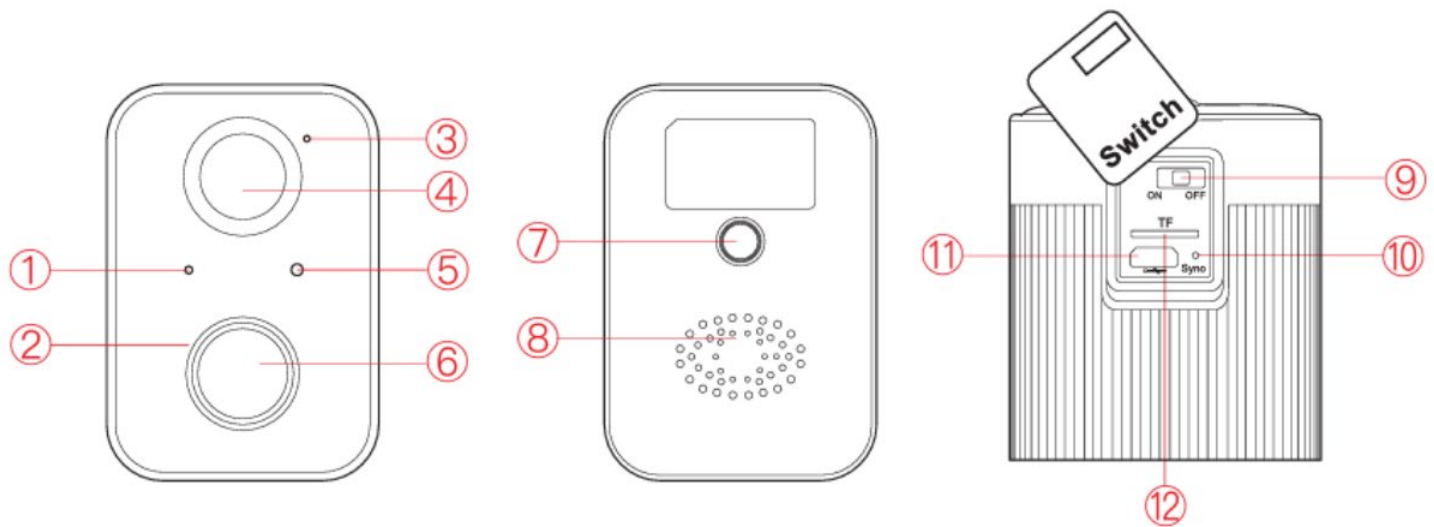

Fig.6

Smart Camera Specifications



- | | | |
|------------------|---------------------------|-----------------------------|
| 1) Status LED | 5) Light sensor | 9) Power ON/OFF |
| 2) Infrared LED | 6) Camera lens | 10) Sync / Reset |
| 3) Microphone | 7) Threaded mounting hole | 11) Charging port |
| 4) Motion Sensor | 8) Speaker | 12) TF / micro-SD card slot |

- Status Led Indicator:**
- 1) Boot up – Red light is ON
 - 2) Waiting for network settings – Red light fast blinking
 - 3) Network connecting – Green light fast blinking
 - 4) Network connected – Green light is ON
 - 5) Abnormal status – Red light slow blinking
 - 6) Updating firmware – Yellow light is ON
 - 7) Charging status – White light is ON while charging, OFF when fully charged

Detection: Dual-Action Motion and Accelerometer

Power: 5,200 mAh Rechargeable Lithium Ion Battery

Performance: 2 Megapixel Photo and 1080P HD Live Stream Video

Operating Temperature: -5F to 120F (-20.5C to 48.5C)

Connectivity: 802.11b/g/n Wi-Fi connection @ 2.4 GHz plus Bluetooth

Field of View: 130 Degrees

Weather Resistant: Yes

Microphone: Built-In Waterproof

Solar Panel



Surface: 8.75" X 6.75"

Depth: 0.25"

Cord: 9.8 ft (3 meters)

Mounting screws included

Panel pivots

USB-C plug

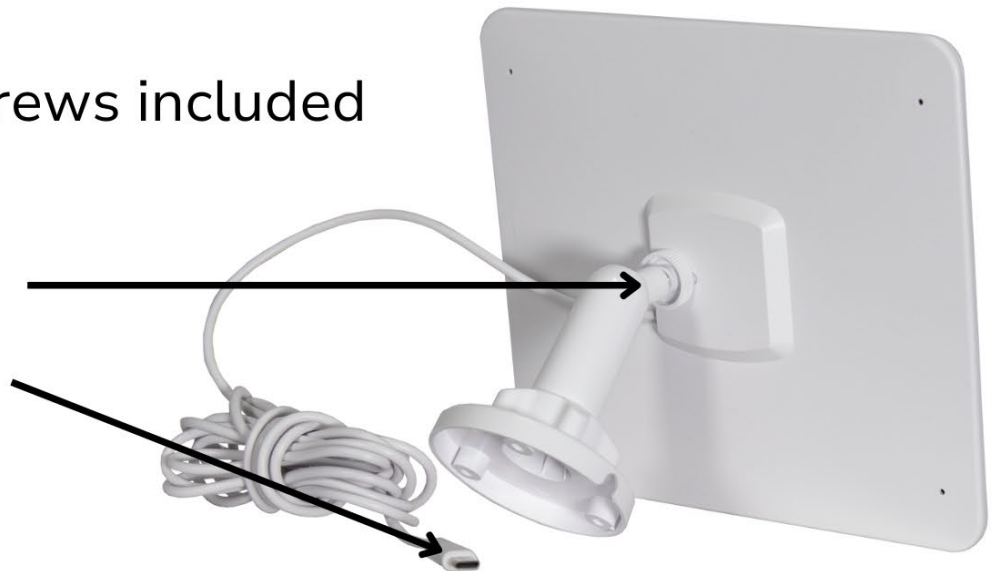

IPCE	19%
Working voltage(Vmp)	6V±5%
Working current(Imp)	400mA±5%
Open Circuit Voltage(VOC)	7.2V±5%
Short-circuit current (ISC)	480mA±5%

Bird Lover App



Download or scan the QR code to your smart device and install the Bird Lover app for either Android or IOS. Once downloaded, the app will ask you to register your device. Enter your email or phone number, then select the country you live in. You will receive a text or email with a registration code. Input the registration code on the app and create a password.

Bird Lover App

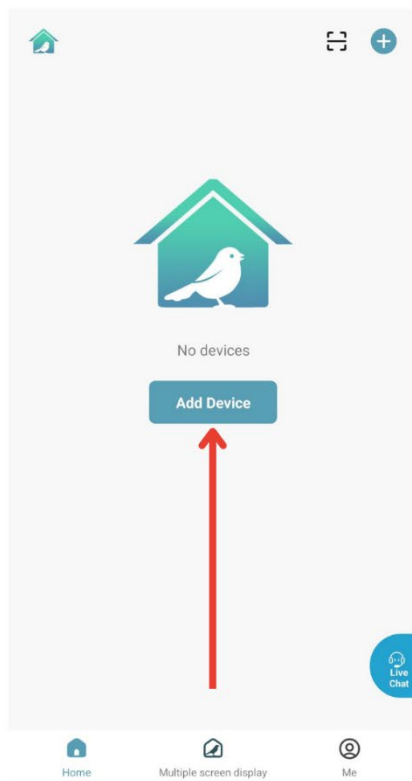

App Screen 1

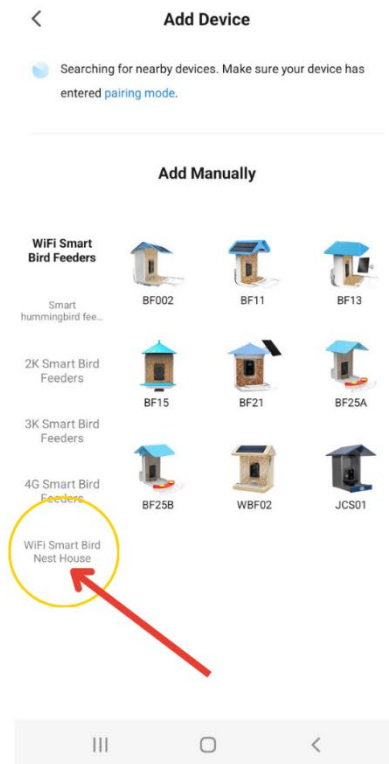

App Screen 2

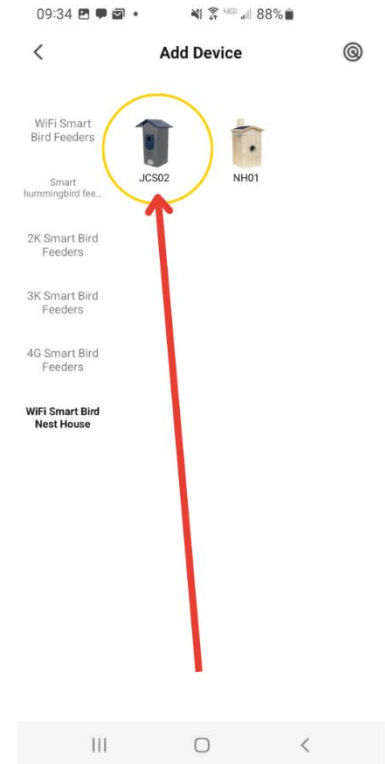

App Screen 3

To properly pair the camera to your smart device, please ensure the camera is powered ON and Bluetooth has been enabled on your phone. When opening the Bird Lover app on your phone for the first time, it will prompt you to “Add Device” (see App Screen 1 above). From the list displayed on the left, choose “WiFi Smart Bird Nest House” (see App Screen 2 above). This will send you to a third screen where you will choose the “JCS02” icon from the menu (see App Screen 3 above).

Once you have successfully paired your phone and the camera, your smart bird watching can begin!

Keep in mind that the app offers Cloud storage for your captured Smart Bluebird House images. Available plan options and pricing can be found on the app.

Bird Lover App - User Interface

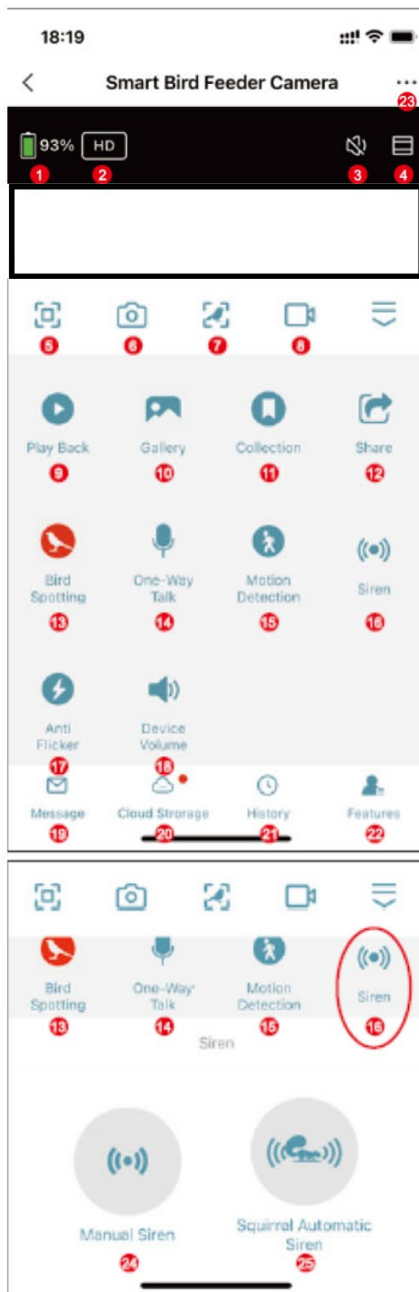

- 1 . Remaining Battery Capacity
- 2 . Quality Adjustment: You can choose HD or SD
- 3 . Voice Switch
- 4 . Zoom in the Screen for Camera
- 5 . Screen Horizontal and Vertical Adjustment
- 6 . Take Photo
- 7 . Bird Recognition
- 8 . Shot Videos
- 9 . Playback of Previous
10. View Photos or Videos Took
11. Check Out the Bird Collection
12. Share the Device
13. Bird Spotting (Switch On/Off Bird Detection Only)
14. Take to the Camera
15. Motion Detection (Click to Turn On/Off)
16. Siren
17. Anti Flicker
18. Device Volume
19. Notification for Motion Detection
20. Cloud Storage Service
21. History of Bird Identification
22. Back to the Main Page
23. Setting
24. Manual Siren
25. Squirrel Automatic Siren

**SCAN
HERE!**



We want to make sure you get the most enjoyment as possible from your new Smart Series Feeder or Birdhouse!

An instruction packet is included in the box. You can also scan the QR-code on the left to access the most up-to-date information on your purchase.

Scroll down to view the FAQ section where we address actual customer inquiries and offer our own advice.