



Instructions for the JCS Wildlife EZ-Fill Smart Feeder

Hanging the EZ-Fill Smart Feeder: This feeder has been designed to hang from a post or tree; or it can be mounted to a pole with additional hardware. Since a Wi-Fi signal is required to operate the camera, please keep this in mind when choosing a location. When hanging from a post or tree, simply attach the included hanger bracket to the back of the feeder using the two smaller screws and the pre-drilled holes (see Fig.1). The larger hole in the hanger should stick up from the back of the feeder above the roof. Drill the longer screw into the mounting surface then hang the feeder from this screw. The other longer screw can be used to secure the lower part of the feeder to prevent it from swinging on the hanger. Drill it into the lower hole (see Fig.1) from the front side of the feeder and into the mounting surface, securing the feeder in place. Please note: The acrylic seed shield must be removed for this step.

If you wish to mount your feeder from a pole, there are pilot holes pre-drilled in the bottom of the feeder that will line up with our universal pole kit bracket. Pole options with mounting brackets and squirrel baffles can be found on our website at www.jcswildlife.com.

Using the EZ-Fill Smart Feeder: One of the advantages of using a hopper-type feeder is that almost any songbird will enjoy snacking from it. The list of potential visitors includes Northern Cardinals, House Finch, Goldfinch, Chickadees, Wrens, Bluebirds, Titmice, Downy Woodpeckers and more. Another advantage is that almost any type of loose bird seed (other than Nyjer/thistle) can be used in it. Black oil sunflower, safflower, millet, shelled peanuts, to name a few.

To fill the feeder, rotate the roof locking lever towards the back and tilt the roof forward (see Fig.2). This allows EZ access to the seed hopper. Then simply pour in the bird seed. The acrylic seed shield will keep the seed in place as the notches at the bottom allow it to pour out into the seed tray. After filling, tilt the roof back down and rotate the locking lever back into place. The roof will also tilt fully forward into a vertical position. This not only provides greater access, but it also allows the removal of the acrylic seed shield. To remove the shield, slide it up and out of the rails. Please note: The shield fits tightly in place, taking some effort to remove and replace it.

Smart Camera: The EZ-Fill Smart Feeder features a Wi-Fi camera with motion detection. When a bird lands on the feeder, its motion triggers the camera to take a picture. The picture is then sent to your smart phone via the Bird Lover app. The camera itself is housed in a box which is integrated into the feeder acrylic seed shield. The power switch is located on top of the camera underneath a protective cover. The outlet for the solar battery charging cable is just behind the power switch. The camera battery can also be charged by removing it from the feeder and using a standard USB-C cable plugged into a computer or power outlet. To remove the camera, rotate or tilt it towards you to unplug the solar panel cable. Rotate it further until you can access the back of the camera. Remove the thumb screw, then remove the camera. To reinstall, simply repeat these steps in reverse order (see Fig.3). A micro-SD card (not included) can be installed in the smart camera in order to save captured images. The Bird Lover app also offers Cloud storage options (paid subscription required). Detailed instructions for syncing the camera to your smart device and navigating the Bird Lover app can be found within the app itself.

Solar Panel: The included solar panel plugs into the feeder via an outlet located under the roof on the right side of the feeder (see Fig.4). The cord is 9.8 feet (3 meters) long, making it possible to mount the solar panel a fair distance from the feeder if desired. For example, if you place your feeder in the shade, you could mount the solar panel in a sunny location up to 9 feet away. Additionally, if you place the feeder on a pole, the solar panel could be mounted to the back of the feeder using the supplied hardware. The solar panel comes with a versatile mounting bracket that allows you to secure it to just about any flat surface. The panel itself attaches to the mount with a pivoting head that can be rotated to an ideal angle to catch the sun. As with any solar powered device, the efficiency of the charge is based on the amount of sunlight it can absorb. Per our research, solar panels used in the US (Northern Hemisphere) are best positioned facing more to the south to achieve optimal efficiency. Additionally, the solar panel may require cleaning from time to time. The flatter it is positioned, the more likely birds will be tempted to use it as a perch. We recommend using a soft-bristled brush and water to clean the solar panel should the need arise.

*****UPDATE 01/22/2024*** We are now including a set of three ½” screws with the solar panel to use when attaching the panel to the Smart Hopper Feeder or Smart Ultimate Bluebird House. These screws will not poke through to the inside of the feeder or house. They can be found in the solar panel box, stuck in the foam packaging material next to the factory hardware kit under the panel.**

Features of EZ-Fill Smart Feeder:

- New tilting roof design!
- Integrated motion detection Wi-Fi smart camera allows you to see the birds visiting the feeder on your smart device.
- Bird Lover app is simple to install and use on your device.
- Included solar panel provides automatic charging for the camera battery.
- Solar panel is extremely versatile, offering many mounting location options up to 9' from the feeder!
- Camera is removable for corded recharging if desired.
- Feeder can be hung or pole mounted.
- Hopper will hold up to 4 lbs of bird seed (dependent upon seed type).
- Feeder base has drain holes and is tilted downward to help prevent water from pooling.
- Clear acrylic insert lets you easily keep track of how much seed is left in the feeder.
- Tilting roof and removable acrylic seed shield make for easy filling and cleaning.
- Seed ramp can be removed for cleaning if necessary.
- Feeder is constructed with recycled poly-lumber which will not crack or fade in the elements.
- Fully assembled and partially made in Southern IN, USA.

Additional Items to Note:

- The camera used in the EZ-Fill Smart Camera relies on a Wi-Fi signal. To function properly, it must operate within the parameters of your home Wi-Fi system.
- The camera is installed in the feeder for shipping. You will need to power it on and peel off the protective film covering the lens prior to using.
- The Bird Lover app can be downloaded from both the Google Play Store and Apple's App Store. JCS Wildlife did not design the app, nor do we administer it. Please feel free to contact our Customer Service team should questions arise; but please know that we can only provide minimal support for the app itself.
- Detailed smart camera technical specifications can be found on a separate page in these instructions.

Questions or Comments? Please call JCs Wildlife at 812-867-2800 for assistance.

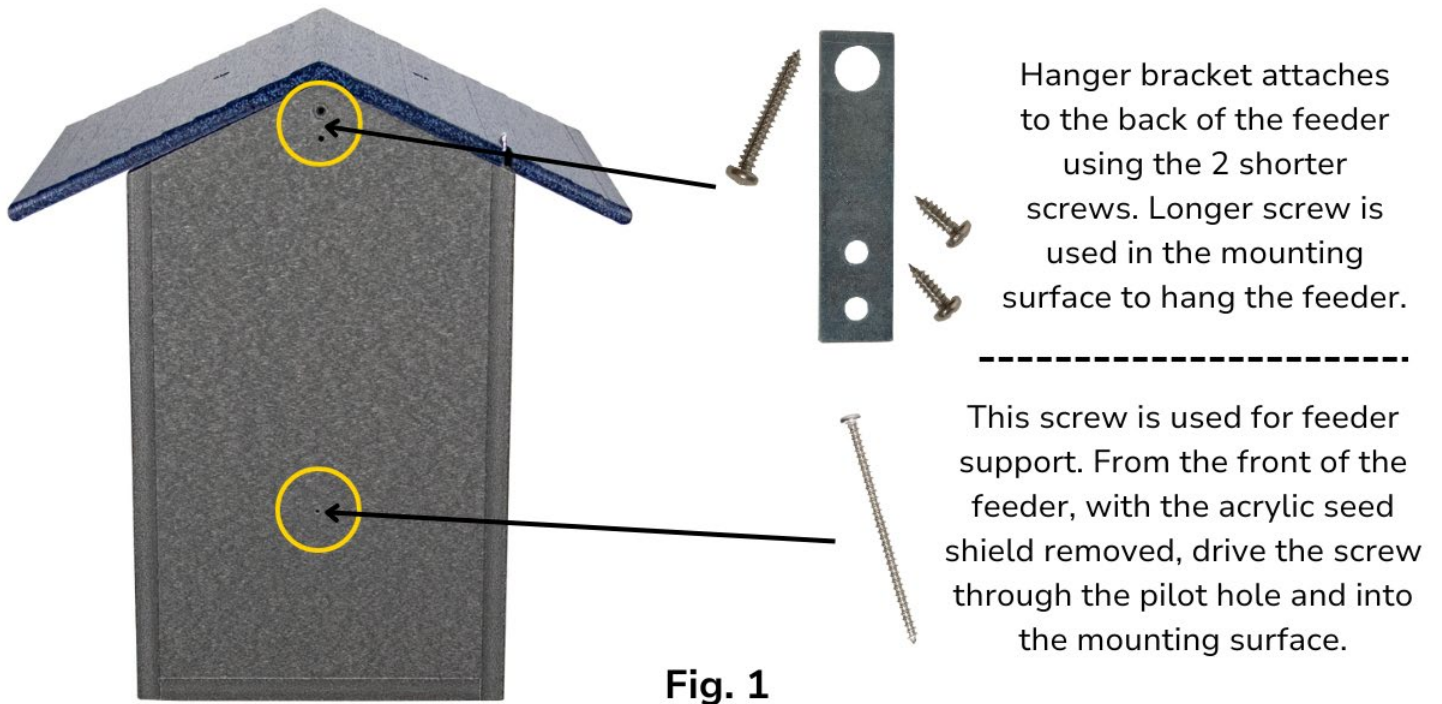

Roof in closed and locked position.



Rotate roof locking lever to the back to allow roof to hinge forward and open.



Roof hinges fully open to allow removal of the acrylic seed shield, which also houses the camera.

Fig. 2

Smart Camera Specifications

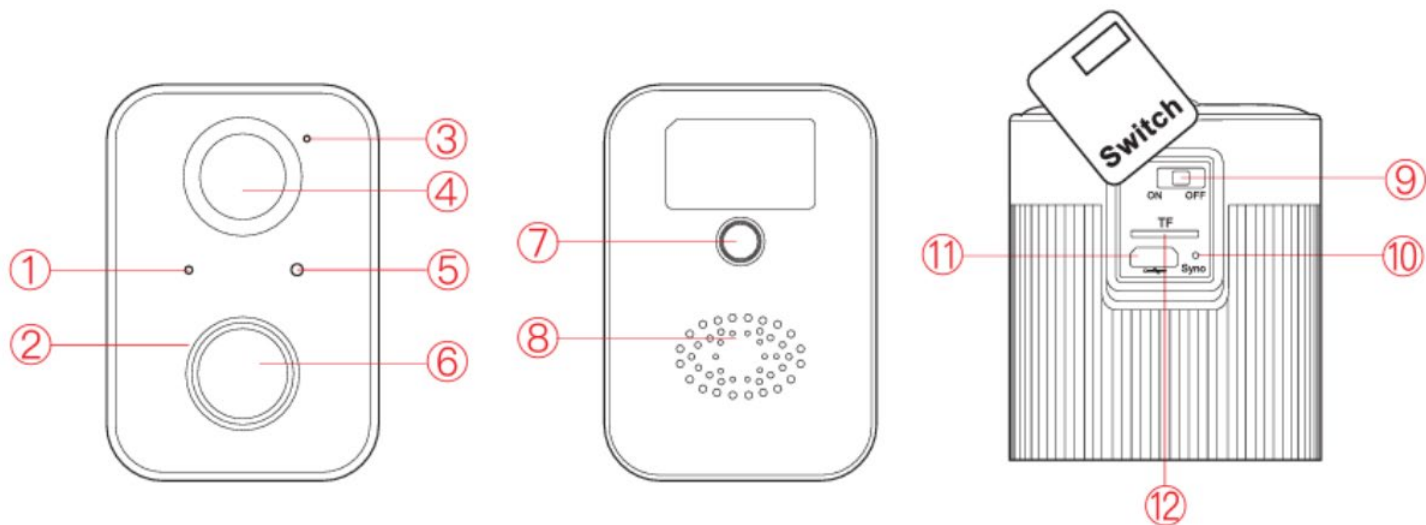

- | | | |
|------------------|---------------------------|-----------------------------|
| 1) Status LED | 5) Light sensor | 9) Power ON/OFF |
| 2) Infrared LED | 6) Camera lens | 10) Sync / Reset |
| 3) Microphone | 7) Threaded mounting hole | 11) Charging port |
| 4) Motion Sensor | 8) Speaker | 12) TF / micro-SD card slot |

- Status Led Indicator:**
- 1) Boot up – Red light is ON
 - 2) Waiting for network settings – Red light fast blinking
 - 3) Network connecting – Green light fast blinking
 - 4) Network connected – Green light is ON
 - 5) Abnormal status – Red light slow blinking
 - 6) Updating firmware – Yellow light is ON
 - 7) Charging status – White light is ON while charging, OFF when fully charged

Detection: Dual-Action Motion and Accelerometer
 Power: 5,200 mAh Rechargeable Lithium Ion Battery
 Performance: 2 Megapixel Photo and 1080P HD Live Stream Video
 Operating Temperature: -5F to 120F (-20.5C to 48.5C)
 Connectivity: 802.11b/g/n Wi-Fi connection @ 2.4 GHz plus Bluetooth
 Field of View: 130 Degrees
 Weather Resistant: Yes
 Microphone: Built-In Waterproof

Smart Camera Removal



Step 1: Rotate or tilt camera towards you in the housing until you can access the solar panel charging cable. Unplug the cable from the top of the camera.



Step 2: Tilt the camera further forward until you can see the thumb screw on the back. Remove the thumb screw to free the camera from the housing.



Camera fully removed from the feeder. At this point the camera can be charged by attaching a USB-C cable to the outlet on top and plugging into a computer or AC wall outlet.

Fig. 3

Solar Panel Cord Outlet

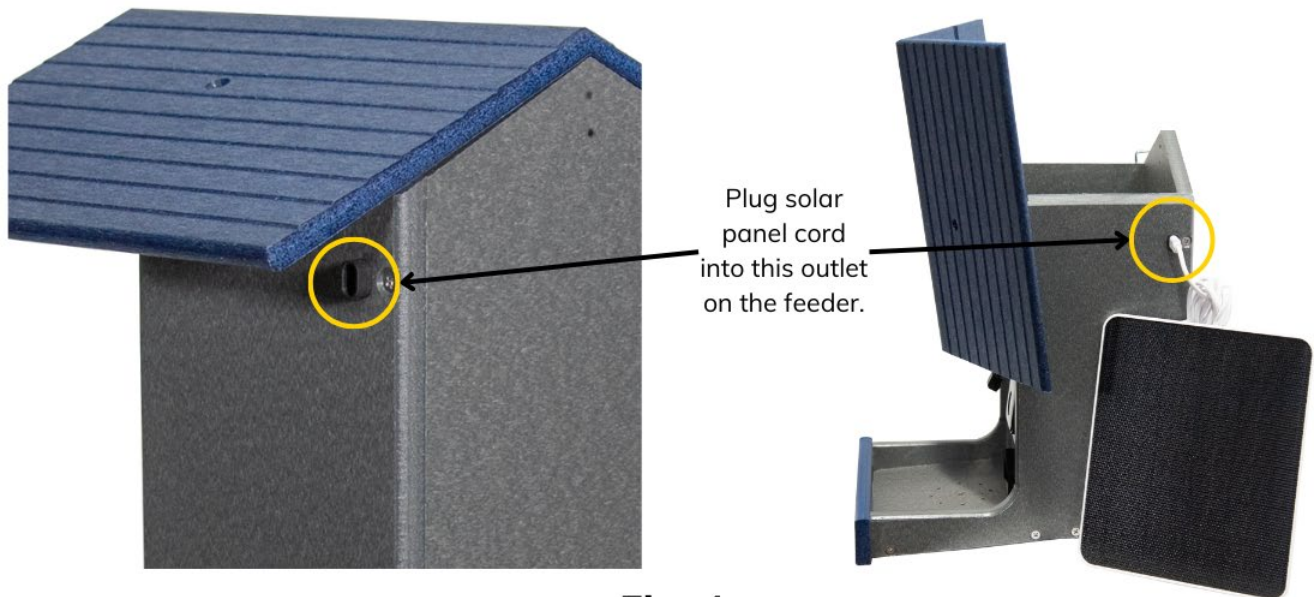

Fig. 4

Solar Panel



Surface: 8.75" X 6.75"

Depth: 0.25"

Cord: 9.8 ft (3 meters)

Mounting screws included

Panel pivots

USB-C plug

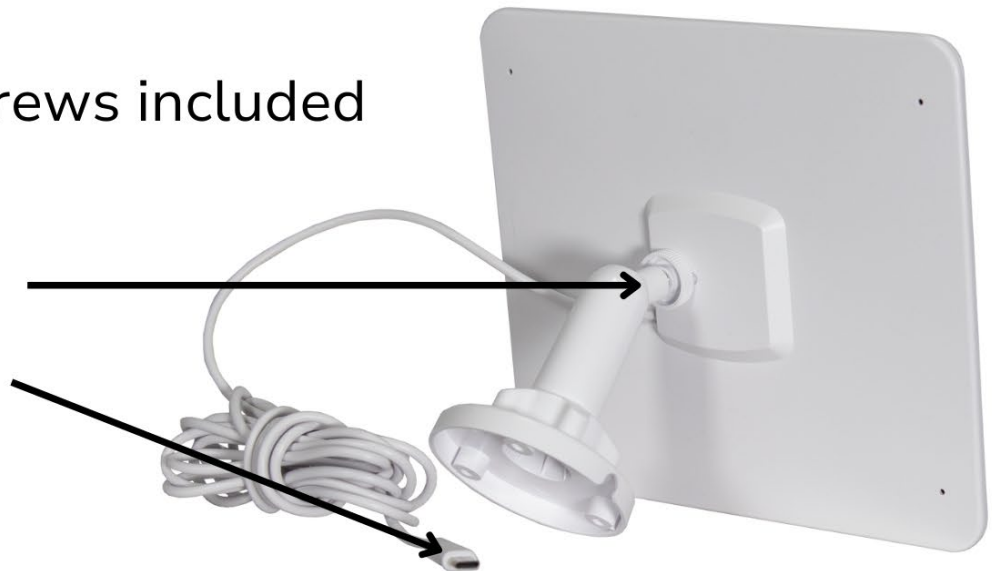

IPCE	19%
Working voltage(Vmp)	6V±5%
Working current(Imp)	400mA±5%
Open Circuit Voltage(VOC)	7.2V±5%
Short-circuit current (ISC)	480mA±5%

Bird Lover App



Download or scan the QR code to your smart device and install the Bird Lover app for either Android or IOS. Once downloaded, the app will ask you to register your device. Enter your email or phone number, then select the country you live in. You will receive a text or email with a registration code. Input the registration code on the app and create a password.

Bird Lover App

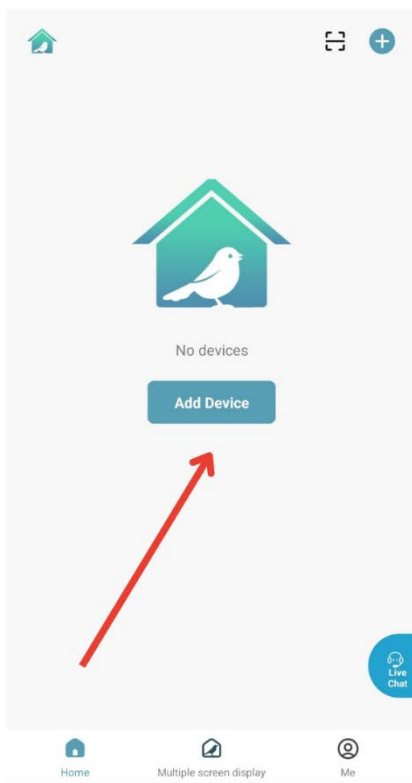

App Screen 1



App Screen 2

To properly pair the camera to your smart device, please ensure the camera is powered ON and Bluetooth has been enabled on your phone. When opening the Bird Lover app on your phone for the first time, it will prompt you to “Add Device” (see App Screen 1 above). After clicking on the “Add Device” button, it will take you to a menu. Choose the JCS01 icon under the WiFi Smart Bird Feeders category (see App Screen 2 above).

Once you have successfully paired your phone and the camera, your smart bird watching can begin!

Keep in mind that the app offers Cloud storage for your captured Smart Feeder images. Available plan options and pricing can be found on the app.

Bird Lover App - User Interface

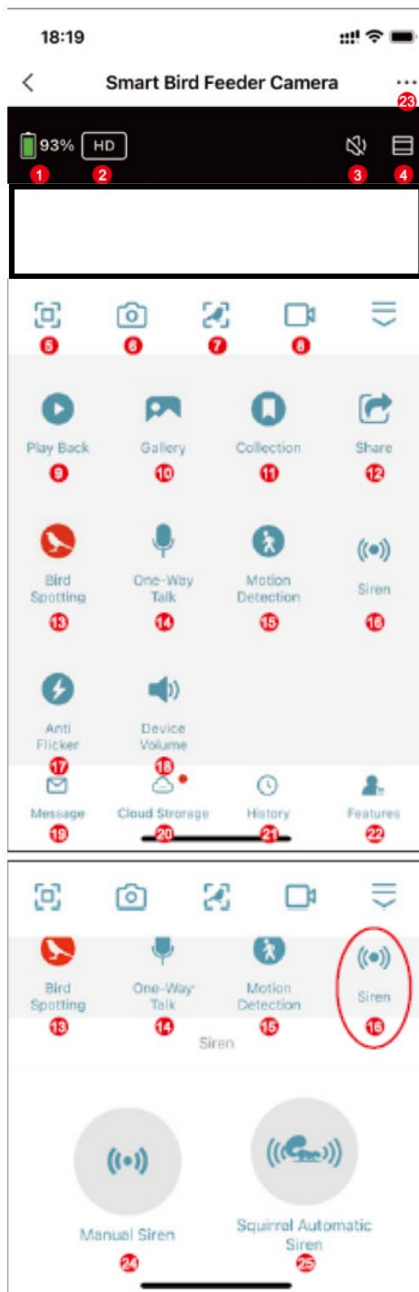

- 1 . Remaining Battery Capacity
- 2 . Quality Adjustment: You can choose HD or SD
- 3 . Voice Switch
- 4 . Zoom in the Screen for Camera
- 5 . Screen Horizontal and Vertical Adjustment
- 6 . Take Photo
- 7 . Bird Recognition
- 8 . Shot Videos
- 9 . Playback of Previous
10. View Photos or Videos Took
11. Check Out the Bird Collection
12. Share the Device
13. Bird Spotting (Switch On/Off Bird Detection Only)
14. Take to the Camera
15. Motion Detection (Click to Turn On/Off)
16. Siren
17. Anti Flicker
18. Device Volume
19. Notification for Motion Detection
20. Cloud Storage Service
21. History of Bird Identification
22. Back to the Main Page
23. Setting
24. Manual Siren
25. Squirrel Automatic Siren

**SCAN
HERE!**



We want to make sure you get the most enjoyment as possible from your new Smart Series Feeder or Birdhouse!

An instruction packet is included in the box. You can also scan the QR-code on the left to access the most up-to-date information on your purchase.

Scroll down to view the FAQ section where we address actual customer inquiries and offer our own advice.