

TORQUE-HUB[®]

Planetary Final Drives

FRAME MOUNT HOLES
(W7CA) .795-.765 (20,19-19,43) THRU
TYP. (12) HOLE EQ. SPACED
ON 10.500 (266,70) DIA. B.C.
OR
(W7C1) 3/4-16 UNF-2B THREADED
HOLES (12) HOLE EQ. SPACED
ON 10.500 (266,70) DIA. B.C.

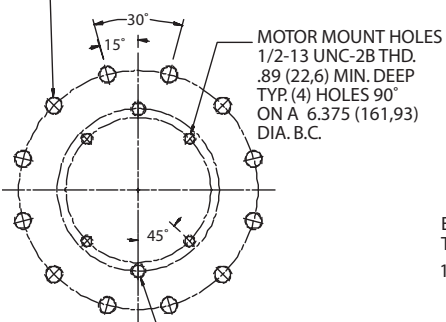

MOTOR MOUNT HOLES
5/8-11 UNC-2B THD.
1.10 (27,9) MIN. FULL THD.
TYP. (2) HOLES 180° APART
ON 7.125 (180,98) DIA. B.C.

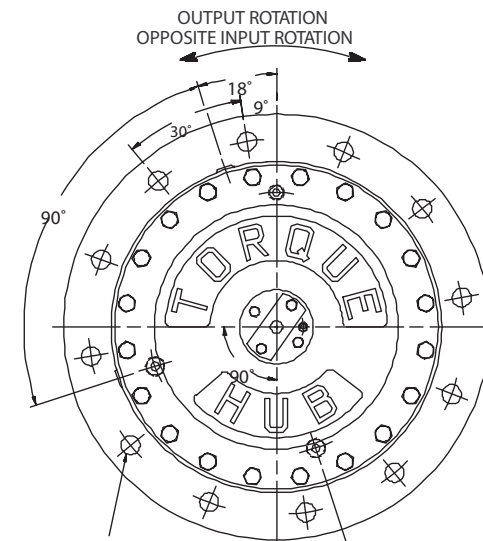
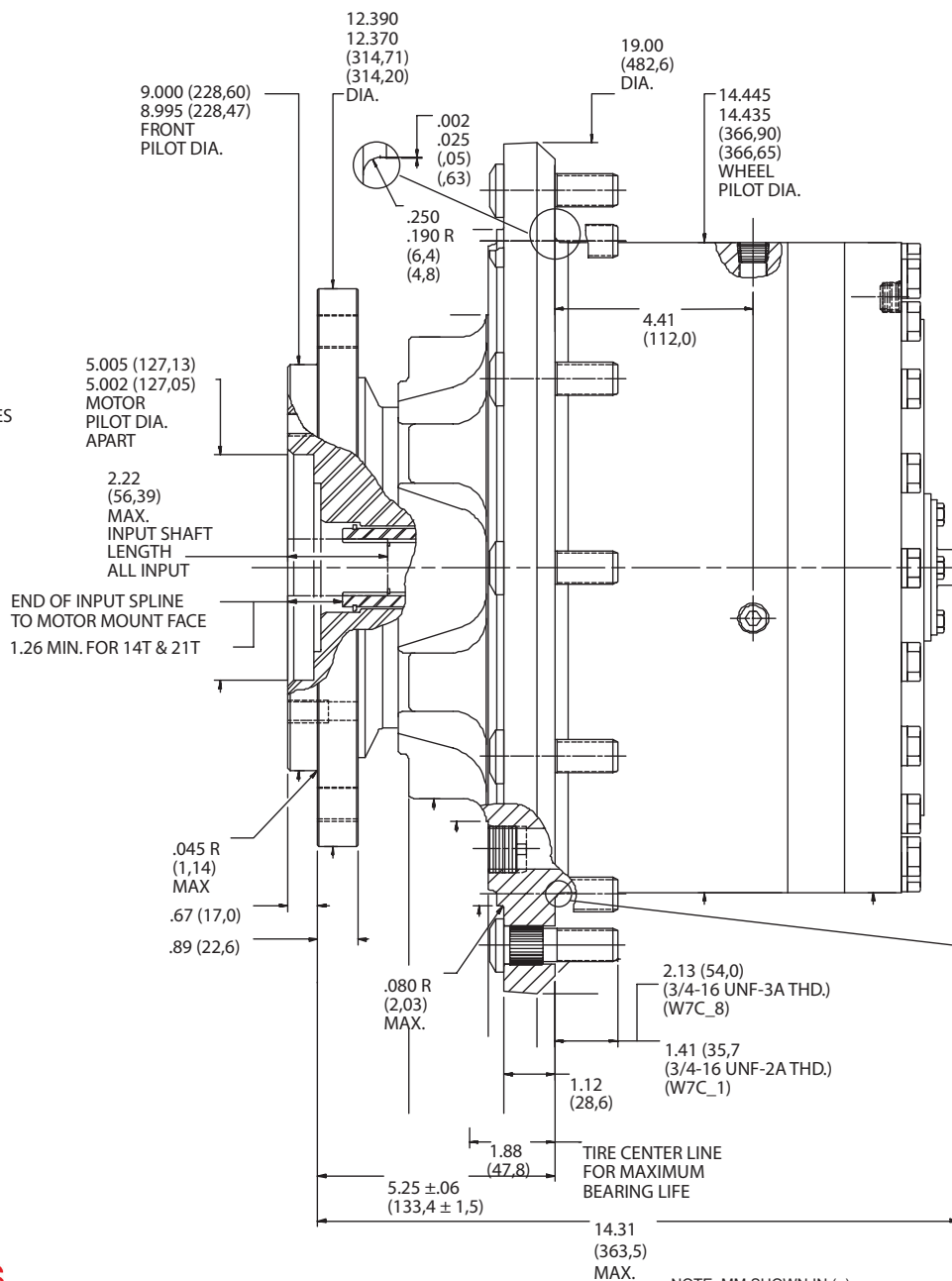

WHEEL MOUNT HOLES
.852-.849 (21.64-21.55)
DIA. THRU
(12) HOLES EQ. SPACED
ON 16.750 (425,45)
DIA. B.C.

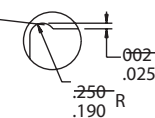

oerlikon
fairfield drive systems

Catalog prints are representative of the units.
Before final design request a certified print from Fairfield.

--- NOTE: MM-SHOWN IN ()
MOTOR CAVITY DIMENSIONS VARY WITH MODEL

--- OTHER MODELS ALSO AVAILABLE
FAIRFIELD BRAKE AVAILABLE

W7C

Performance Data

Continuous	Intermittent	Peak
75,000 lb-in	150,000 lb-in	200,000 lb-in
6,250 lb-ft	12,500 lb-ft	16,666.7 lb-ft
8,468 Nm	16,936 Nm	22,600 Nm
864 kg-m	1,728 kg-m	2,300 kg-m

For ultimate torque and horsepower capacities, contact a Torque-Hub® representative.

Speed Limitations

Input Speed: 3,000 RPM Maximum Intermittent

Weight

Approximately 440 lbs (198 kg)

Note: Specific models will change weights.

W7C Model Formula

Oil

Fill to half full with 90 weight gear lube with EP additive on most applications.

Approximate Volume 90 oz. (2,663 cm³)

Note: Oil level and type will vary with specific model and application.

Conditions of Bearing Curve

Life = 3,000 hours B-10

Speed = 100 RPM output

To adjust for loads and speeds other than shown on curve:

$$\text{Adjusted Life (hrs)} = 3,000 \left(\frac{100 \text{ RPM}}{\text{Speed (Adjusted)}} \right)^x \left(\frac{\text{Load (Curve)}}{\text{Load (Adjusted)}} \right)^{10/3}$$

Bearing Curve

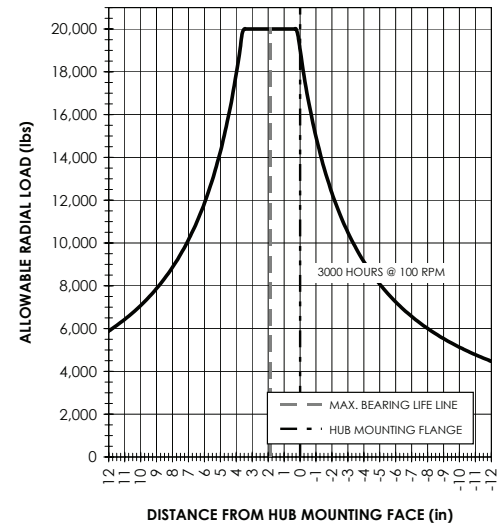

W 7 C1 8 Z 4 26

W – Torque-Hub® Wheel Drive

7 – Series

Spindle				Hub	
Motor Mount	Flange Mounting Dia.	Motor B.C.	Frame B.C.	Mounting Dia.	Flange B.C.
C1	SAE "C" 12.390 12.370	(4) 1/2-13 6.375 B.C.	(12) 3/4-16 10.500 B.C.	14.445 14.435	(12) .852/.849 16.750 B.C.

S.A.E. "B" Pilot also available. Please contact Fairfield.

æerlikon
fairfield

Fairfield Manufacturing Company, Inc.

First in Custom Gears and Drive Systems

www.fairfieldmfg.com

Studs

0 – Not Included

1 – 3/4 - 16 by 2.53 in. (use with .852/.849 flange hole on cast iron hub)

8 – 3/4 - 16 by 3.25 in. (use with .852/.849 flange hole on cast iron hub)

Options

0 – Blank

Z – Seal Boot

Reduction

26 – 26.4:1

44 – 44.2:1

58 – 57.8:1

72 – 71.5:1

94 – 93.7:1

Input

3 – 13T, 16/32 Spline

4 – 14T, 12/24 Spline

7 – 21T, 16/32 Spline

Special Features

A – Positive Engage

X – Anti-disengage

Z – Blank