

# ABS M4 Kit Clubsport

www.bosch-motorsport.com



- ▶ Suitable for front-wheel, rear-wheel and four-wheel drive vehicles
- ▶ Generic wiring harness to fit all engine bay and front foot well locations for the hydraulic module
- ▶ Same ABS hardware as standard ABS M4 Kit

The ABS M4 kit is developed for the operation in front-, rear- or 4-wheel drive vehicles. A generic wiring harness is included in the kit. This enables us to provide the kit with a significantly reduced price in comparison to the standard ABS M4 kit with individual loom.

The ABS M4 is specifically adapted for motorsport use. Individual car parameters like e.g. vehicle weight, vehicle track, wheel weights, wheel circumferences, wheel base or number of increments can be calibrated with software free of charge. Please contact your Bosch Motorsport dealer for further information.

## Technical Specifications

### Mechanical Data

#### Hydraulic unit with attached ECU

Vibration damped circuit board
38 pin connector
2 hydraulic valves per wheel
2 brake circuits (front and rear)
2 hydraulic accumulators 3 cm <sup>3</sup> /each

Standard fittings	2 x master cylinders M12 x 1 4 x brake cylinders M10 x 1
Size	125 x 80.3 x 129.6 mm
Weight	1,850 g
Operating temperature	-30 to 130°C
Max. shock	50 g less than 6 ms

### Electrical Data

Supply voltage	8 to 16 V, max. 26 V for 5 min
Max. peak voltage	35 V for 200 ms
Power consumption	8 W stand-by, 230 W in operation

### Inputs

4 active wheel speed DF11
Brake pressure (front brake circuit)
Longitudinal acceleration
Lateral acceleration
Yaw rate

Brake light switch

- 12 position function switch:
- 9 maps preconfigured
  - 2 maps programmable
  - 1 switch position for ABS function OFF

### Outputs

ABS warning light (MIL)

Wheel speed on CAN etc.: see manual

### Optional Accessories

Communication interface MSA Box II F 02U V00 327-03

Quad wheel speed signal splitter, 2 motorsport connectors F 02U V00 203-03

Data logger C 50 F 02U V01 164-04

Display DDU 7 F 02U V02 010-01

### Communication

CAN interface via MSA Box II

### Content of Kit

Hydraulic unit with attached ECU

Pressure sensor

Yaw/acceleration sensor

12 position function switch

4 wheel speed sensors DF11S (partly, see Ordering Information)

ABS warning light

Generic wiring harness

Vibrations damping boards

### Communication

Hydraulikaggregat  
Halteplatte  
Drehschalter

### Ordering Information

#### ABS M4 Kit Clubsport

1 MBaud, DF11S (recommended)  
Order number **F 02U V01 289-49**

#### ABS M4 Kit Clubsport

500 kBaud, DF11S  
Order number **F 02U V01 289-48**

#### ABS M4 Kit Clubsport

1 MBaud, for DF11i (wheel speed sensors not included)  
Order number **F 02U V00 543-13**

#### ABS M4 Kit Clubsport

500 kBaud, for DF11i (wheel speed sensors not included)

Order number **F 02U V00 543-12**

Dimensions

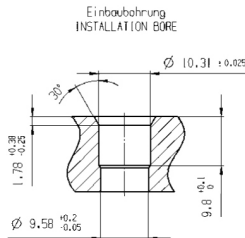
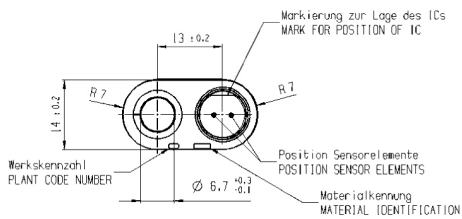
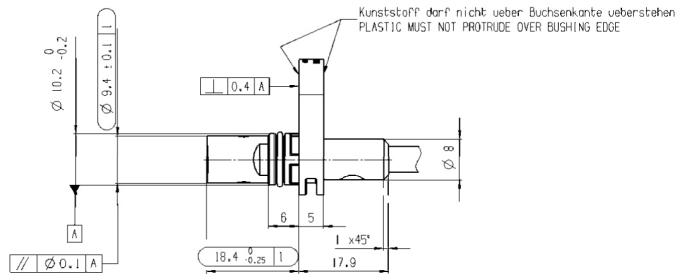
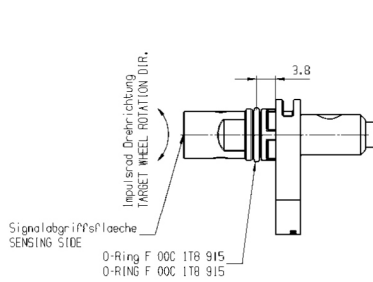
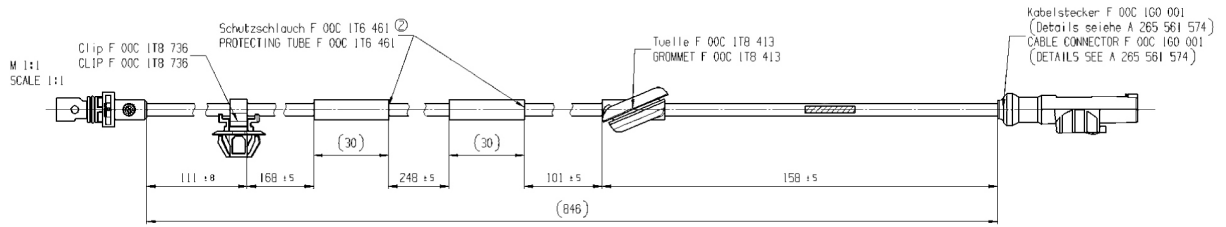

Material/MATERIAL

Gehäuse: Polyamid waerme-  
stabilisiert  
HOUSING: POLYAMIDE HEAT  
STABILIZED

Leitung: Mantelleitung zweiadrig  
Aussen ∅ : 5,0 ± 0,3  
Mantelisolierung: Polyurethan-  
Elastomer 95: 5 Shore A.  
CABLE: MOLDED CABLE COVER  
TWO CORES, D<sub>c</sub> : 5,0 ± 0,3  
COVER INSULATION: POLY-  
URETHANE ELASTOMER 95: 5  
SHORE A.

Buchse: Stahl  
BUSHING: STEEL

Wheel Speed Sensor

Represented by:

**Europe:**  
Bosch Engineering GmbH  
Motorsport  
Robert-Bosch-Allee 1  
74232 Abstatt  
Germany  
Tel.: +49 7062 911 9101  
Fax: +49 7062 911 79104  
motorsport@bosch.com  
www.bosch-motorsport.de

**North America:**  
Bosch Engineering North America  
Motorsport  
38000 Hills Tech Drive  
Farmington Hills, MI 48331-3417  
United States of America  
Tel.: +1 248 876 2977  
Fax: +1 248 876 7373  
motorsport@bosch.com  
www.bosch-motorsport.com

**Latin America:**  
Robert Bosch Ltda  
Motorsport  
Av Juscelino Kubitschek de  
Oliveira 11800  
Zip code 81460-900  
Curitiba - Parana  
Brasil  
Tel.: +55 41 3341 2057  
Fax: +55 41 3341 2779

**Asia-Pacific:**  
Bosch Engineering Japan K.K.  
Motorsport  
18F Queen's Tower C, 2-3-5 Minato Mirai  
Nishi-ku, Yokohama-shi  
Kanagawa 220-6218  
Japan  
Tel.: +81 45 650 5610  
Fax: +81 45 650 5611  
www.bosch-motorsport.jp

**Australia, New Zealand and South Africa:**  
Robert Bosch Pty. Ltd  
Motorsport  
1555 Centre Road  
Clayton, Victoria, 3168  
Australia  
Tel.: +61 (3) 9541 3901  
motor.sport@au.bosch.com