

SENTRY

Compressed Air Monitoring and Alarm System

Features:

- ▶ Detects Upset Conditions in Compressed Air System
- ▶ Constantly Monitors Pressure and Dew Point
- ▶ Strobe Lamp and Pulsing Audible Alarms for Low Pressure or High Dew Point Detection
- ▶ Displays Dew Point and Pressure
- ▶ NIST Traceable, field-replaceable Smart Sensor Tip
- ▶ Alarm Relay Output and 4-20mA Outputs
- ▶ Plug n' Play Operation

Model SENTRY turn key system features a Smart Multi-Sense Probe that continuously monitors the DewPoint and Pressure of the compressed air system.

Model SENTRY delivers the **Edgetech Instruments Advantage**: an engineered solution tailored to detect compressor or dryer failures and system pressure leaks.

Model SENTRY features a strobe lamp and pulsing horn whenever a low pressure or high dew point alarm is detected.

Model SENTRY is plug n' play for out of box installation. Factory programmed with high dew point and low pressure set points. Either condition triggers an alarm condition.

Model SENTRY provides a local display of the measured pressure and dew point of the compressed air system.

Model SENTRY provides 4-20mA analog outputs (1) each for measured pressure and dew point.

Model SENTRY provides an alarm relay contact for low pressure/ high dew point.

Model SENTRY measures systems up to 400 PSIG (28 BAR)



Applications:

- ▶ Compressed Air Headers
- ▶ Point of Use Compressed Air
- ▶ Dry Air Systems for Critical Process
- ▶ Monitor Dryers in Fluidized Beds
- ▶ Monitor Instrument Air Systems
- ▶ Pharmaceutical Packaging
- ▶ Laboratories / Clean Rooms
- ▶ Sensitive Product Storage
- ▶ Monitor Purge Delivery Systems

Technical Specifications

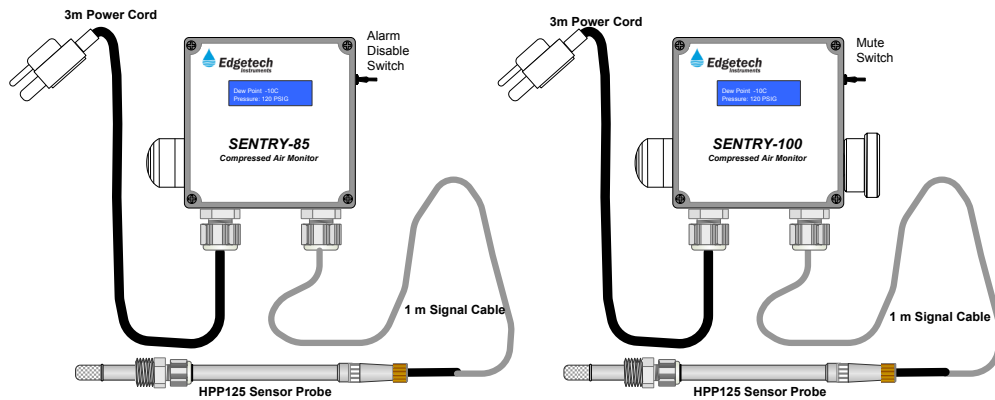

Models:

SENTRY 85: Provides Strobe Lamp and 85dB pulsing Audible Alarm when High Dew Point or Low Pressure condition exists

SENTRY 100: Provides Strobe Lamp and 100dB pulsing Audible Alarm when High Dew Point or Low Pressure condition exists

Measuring Range (HPP125 Sensor Probe)

Standard Dew Point: -40°C to $+95^{\circ}\text{C}$ (-40°F to 203°F)

LDP Dew Point: -60°C to $+95^{\circ}\text{C}$ (-76°F to 203°F)

Pressure: Up to 400psig (0 to 27.6bar)

Accuracy

Dew Point: $+1^{\circ}\text{C}$ for -10°C to 95°C DP and $+2^{\circ}\text{C}$ for -60°C to -10°C

Pressure: ± 1 mbar @ 25°C (600 to 1200 mbar) / ± 5 mbar (-40°C to $+125^{\circ}\text{C}$)

General

Enclosure: IP65 Water Resistant/ Dust Tight, approximately 5"(127mm) x 5" (127mm) x 4" H (102mm)

Weight: 3 Lbs. (1.4 kg)

Display: 2 Line LCD display of Pressure and Pressure Dew Point, LED Backlit

Smart Sensor Probe is connected to SENTRY control module via 1 meter long signal cable, quick connect

Operating Temperature: 32° to 122°F (0° to 50°C)

Sample Connection: 1/2" Male NPT Pipe Fitting; optional 3/4" or 1" Male NPT Pipe Fitting

Sample Pressure: Up to 400psig (27.6 bar)

Power & Outputs

Power: 90-230 VAC $\pm 10\%$, 50-400Hz, 3 meter length power cord provided

Analog Outputs: (2) 4-20 mA outputs

Pressure of compressed air at sensor probe, PSIA

Pressure Dew Point, calculated for 1 ATM

Relay Alarm, 1 Form C, 3A @250 VAC ; Alarm mode = Low Pressure or High Dew Point.

Accessories:

CAM: Sample chamber for probe; Provides sample flow to sensor probe and includes a ball valve to isolate the probe from the pressurized source during service

3/4 inch NPT Female pipe threaded port to compressed air system take-off point