

ENGLAON

Smart Outdoor TV



USER'S MANUAL

Safety Information

IMPORTANT SAFETY INSTRUCTIONS

Read these instructions.
Keep these instructions.
Heed all warnings.
Follow all instructions.
Do not use this apparatus near water.
Clean only with dry cloth.
Do not block any ventilation openings. Install in accordance with the manufacturer's instructions.
Do not install near any heat sources such as radiators, heat registers, stoves, or other apparatus (including amplifiers) that produce heat.
Do not defeat the safety purpose of the polarized or grounding plug. A polarized plug has two blades with one wider than the other. A grounding plug has two blades and a third grounding prong. The wide blade or the third prong is provided for your safety. If the provided plug does not fit into your outlet, consult an electrician for replacement of the obsolete outlet.
Protect the power cord from being walked on or pinched particularly at the plugs, convenience receptacles, and at the point where they exit from the apparatus.
Only use attachments/accessories specified by the manufacturer.
Use only with the cart, stand, tripod, bracket, or table specified by the manufacturer, or sold with the apparatus. When a cart or rack is used, use caution when moving the cart/apparatus combination to avoid injury from tip-over.



Unplug the apparatus during lightning storms or when unused for long periods of time.

Refer all servicing to qualified personnel. Servicing is required when the apparatus has been damaged in any way, such as power supply cord or plug is damaged, liquid has been spilled or objects have fallen into the apparatus has been exposed to rain or moisture, does not operate normally, or has been dropped.

CAUTION: These servicing instructions are for use by qualified service personnel only. To reduce the risk of electric shock, do not perform any servicing other than that contained in the operating instructions unless you are qualified to do so.

WARNING : To reduce the risk of fire or electric shock, do not expose this apparatus to rain or moisture. The apparatus shall not be exposed to dripping or splashing and that objects filled with liquids, such as vases, shall not be placed on apparatus.

WARNING: The mains plug is used as disconnect device, the disconnect device shall remain readily operable.



- This lightning flash with arrowhead symbol within an equilateral triangle is intended to alert the user to the presence of non-insulated "dangerous voltage" within the product's enclosure that may be of sufficient magnitude to constitute a risk of electric shock.

- Warning: To reduce the risk of electric shock, do not remove cover (or back) as there are no user-serviceable parts inside. Refer servicing to qualified personnel.
- The exclamation point within an equilateral triangle is intended to alert the user to the presence of important operating and maintenance instructions in the literature accompanying the appliance.

Apparatus with class I construction shall be connected to a mains socket outlet with a protective earthing connection.

Content

TV Specification	3-4
Installation	5-7
Overview of back panel	8
Accessories	9
Remote Control Unit	10-11
Boot Wizard	12-16
Inputs	17
Main Menu	
Channel bar	18
Channel settings	19-22
Power	23
Record bar	23-24
Program	25
Settings	25
Network settings	26
Accounts & sign in	26
Apps	27
Device Preferences	27
FileManager	28
Photo	29
Music	29-30
Movie	30
Troubleshooting	31

TV Specification

1500cd/m²

43"

Screen size	43"
Display Type	TFT LED
Resolution	3840 X 2160
Aspect Ratio	16:9
Alimentation	AC 100-240V 50/60Hz
Audio Output	L/R 40W X 2
Dimensions(With stand)	996.8 x 584.4 x 93.5MM

55"

Screen size	55"
Display Type	TFT LED
Resolution	3840 X 2160
Aspect Ratio	16:9
Alimentation	AC 100-240V 50/60Hz
Audio Output	L/R 40W X 2
Dimensions(With stand)	1264.6 x 735.4 x 93.5MM

65"

Screen size	65"
Display Type	TFT LED
Resolution	3840 X 2160
Aspect Ratio	16:9
Alimentation	AC 100-240V 50/60Hz
Audio Output	L/R 40W X 2
Dimensions(With stand)	1502.9 x 879.9 x 131.6MM

Installation

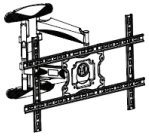

Full Motion Cantilever Mount
For screen sizes: 40"-75"
Max capacity: 45.5kg/100lbs
VESA: 300x200 ~ 600x400mm

Tools required

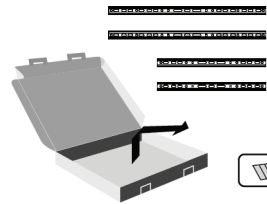

Accessories

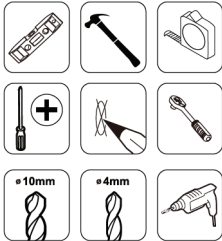

- | | | | |
|----------|-----------------|----------|------------------|
| A | (M4x25)-4pcs | H | (M15x5x1.5)-4pcs |
| B | (M5x25)-4pcs | I | (M8)-8pcs |
| C | (M6x25)-4pcs | J | (M8x10)-8pcs |
| D | (M8x25)-4pcs | K | (M6)-1pcs |
| E | (M10x60)-5pcs | L | (M10)-1pcs |
| F | (M7x70)-5pcs | M | (M12)-1pcs |
| G | (M15x8x10)-4pcs | | |

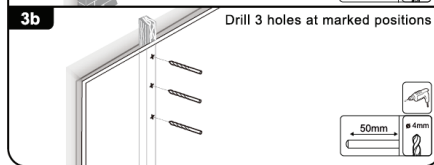
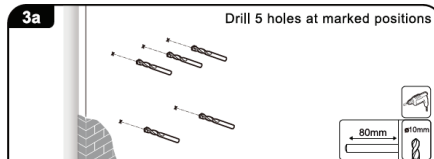
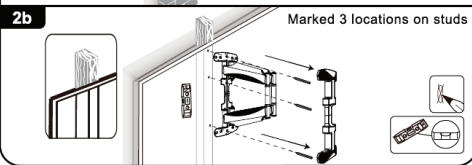
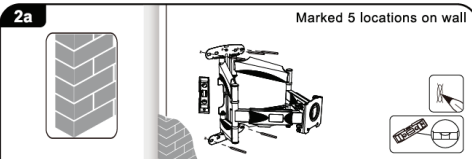
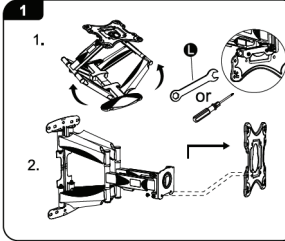

Installation

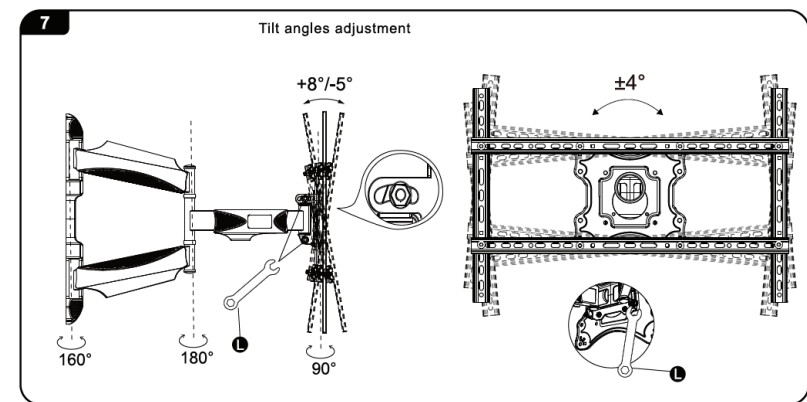
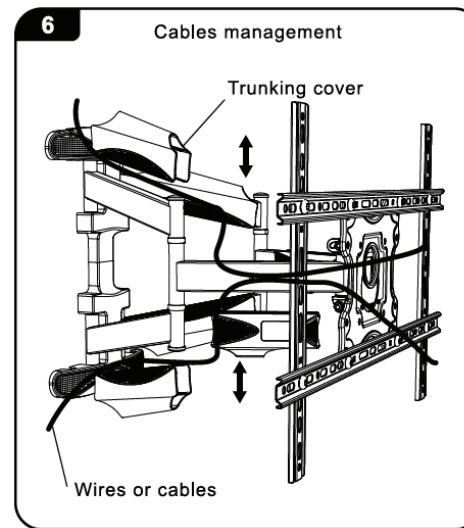
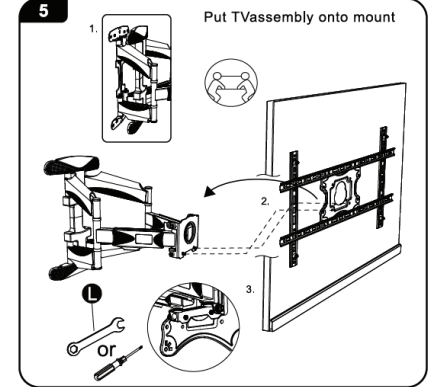
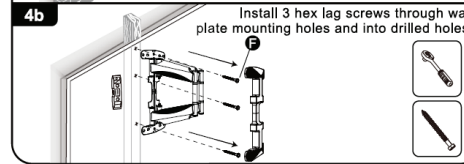
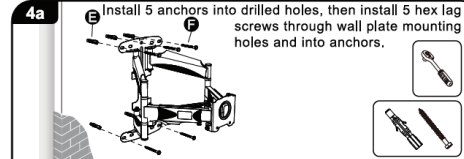

Overview of back panel

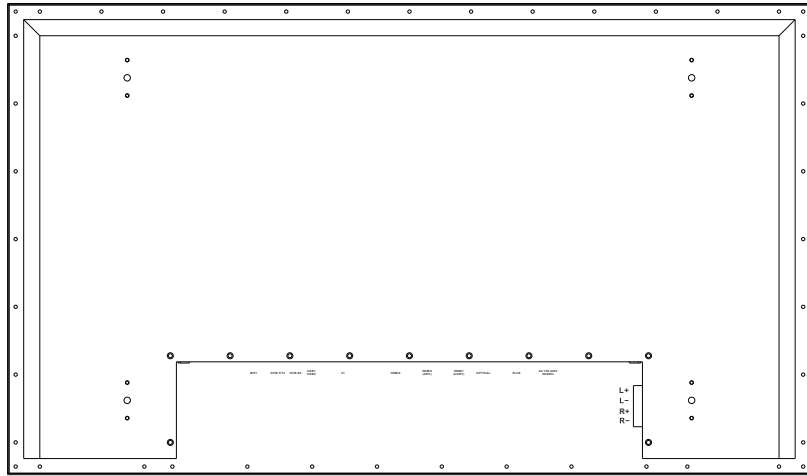

- | | | |
|--|--|---|
| <ol style="list-style-type: none"> 1. WIFI
Connect for Wifi. 2. DVB-T2
Connected to external antenna to receive the ATV/DTV program in ATV/DTV mode. 3. DVB-S2
Connected to external SATELLITE to receive. 4. USB 1/2
Connect media stick for content. 5. CI SLOT
Use to insert the CI card. | <ol style="list-style-type: none"> 6. HDMI3
Connect for HDMI. 7. HDMI2(ARC)
Connect for HDMI. 8. HDMI1(UART)
Connect for HDMI. 9. OPTICAL
Connect for OPTICAL. 10. RJ45
Ethernet connection. 11. AC 100-240V 50/60Hz 12. AUDIO OUT
Speaker terminals then connect to pair of passive speakers. | <div style="border: 1px solid black; padding: 2px;">L+</div> <div style="border: 1px solid black; padding: 2px;">L-</div> <div style="border: 1px solid black; padding: 2px;">R+</div> <div style="border: 1px solid black; padding: 2px;">R-</div> |
|--|--|---|

Accessories

Please make sure the following items are included with your LED TV.
If any items are missing, contact your dealer.

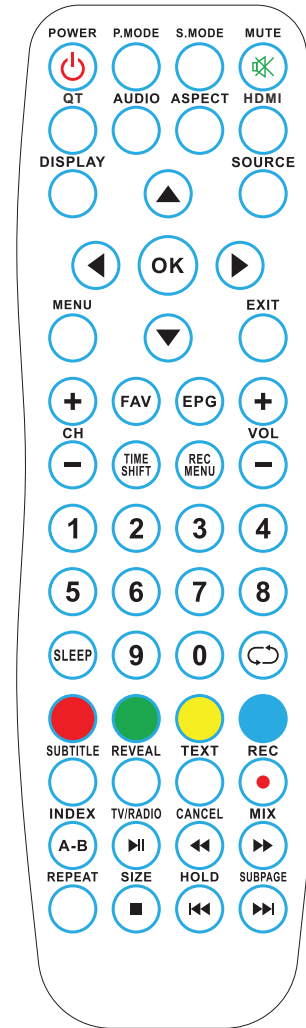

Remote Control

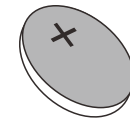

Battery (CR2032)

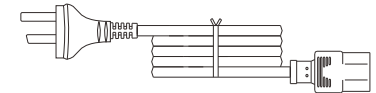

Mains lead

Remote Control Unit

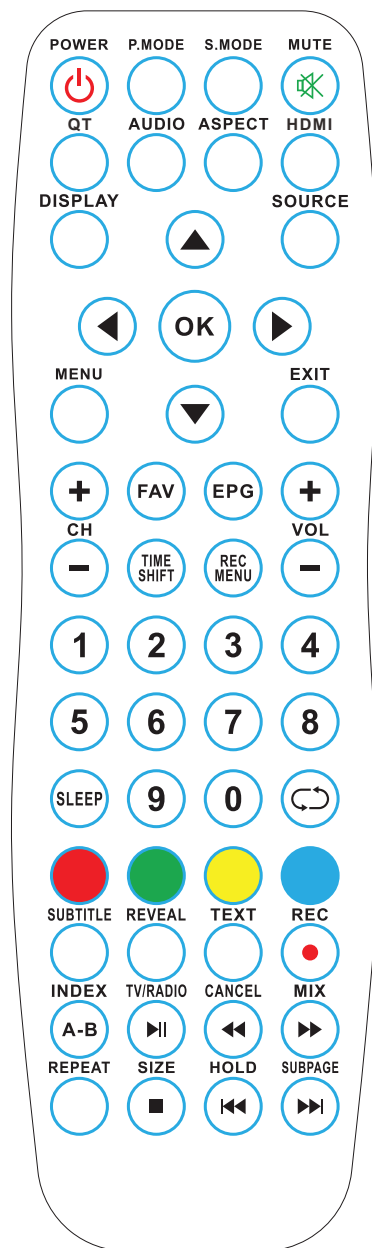

No.	Button	Description
1	POWER	Set your TV to power on or standby mode.
2	P.MODE	Select the picture mode.
3	S.MODE	Select the sound mode.
4	MUTE	Press to mute the sound. Press again to regain sound.
5	QT	Quick Tune. Quick TV Channel Autotune Button.
6	AUDIO	Press to display the language of the audio in DTV.
7	ASPECT	Press this button to select the aspect of screen.
8	HDMI	Press this button to select the HDMI.
9	DISPLAY	Press this button to display the information on current input.
10	SOURCE	Press this button to display the input source.
11	MENU	Allows you to navigate on the screen menus (OSD).
12	EXIT	Exit from the current menu or sub-menu. Press twice to enter HOME.
13	◀▶ ▲▼	Allows you to navigate the on-screen menus and adjust the system settings to your preference.
14	FAV	Selects favorite channels.
15	EPG	Press to display EPG (Electronic Program information).
16	TIME SHIFT	Press to switch to TIME SHIFT mode.
17	REC.MENU	Press to switch to REC.MENU immediately (DTV only).
18	CH+/-	Press these two buttons to change channels up/down.
19	VOL+/-	Press these two buttons to increase/decrease the volume.
20	0-9	Press 0-9 to select a TV channel directly. The channel will change after 2 seconds. Applicable for enter page number in TELETEXT mode.
21	SLEEP	Set the time for the TV to turn off automatically.
22	↺	Return to the previously viewed program.
23	R (DELETE)	Delete function button.
24	G (RENAME)	Rename function button.
25	Y (MOVE)	Move function button.
26	B (SKIP)	Skip function button. Open and close the mouse.
27	SUBTITLE	Press to select the subtitle language.
28	REVEAL	Shows hidden words or pages by Teletext.
29	TEXT	Switch on/off of Teletext window.
30	REC/●	Press to record the program immediately.
31	INDEX	Returns to Index page by Teletext.
32	CANCEL	Switches the Teletext window to the background; only the current page is not visible.
33	MIX	Sets the transparency of Teletext window.
34	REPEAT	DVD: Repeat mode selection.
35	SIZE	Zoom In or Out of the Teletext window.
36	HOLD	Holds on the current Teletext page.
37	SUBPAGE	Displays a subpage of upper Teletext options.

Boot Wizard

The following language selection menu is displayed when the system is turned on for the first time.

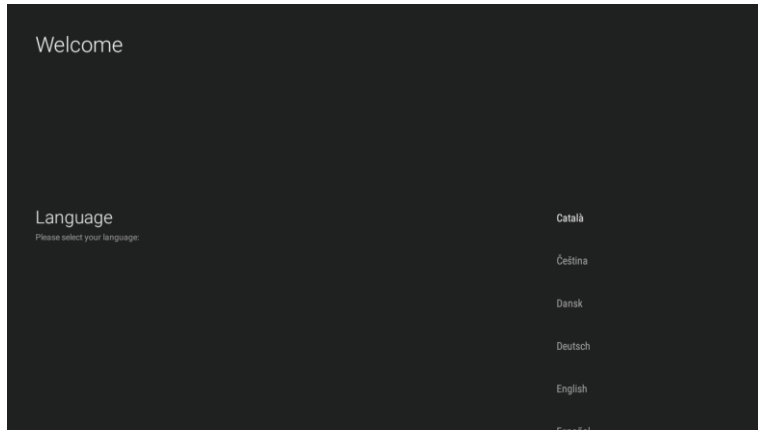

Enter the country selection interface.

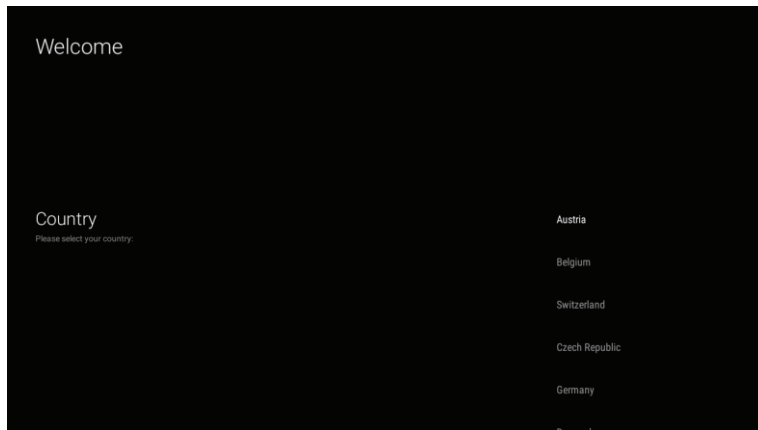

The following interface is displayed after country selection.

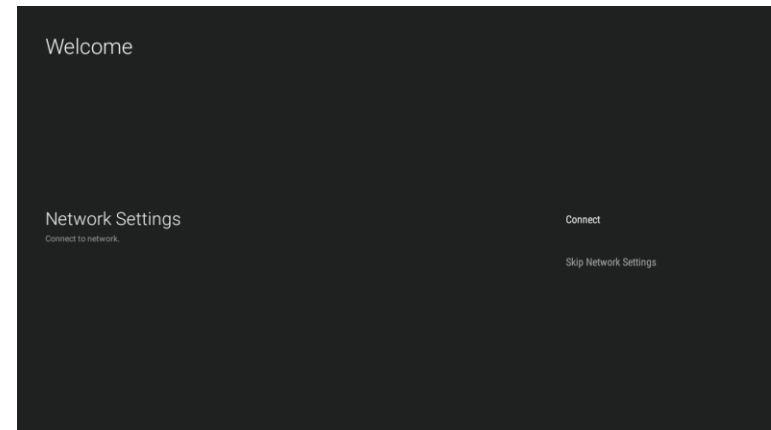

Choose "Connect" to set network.

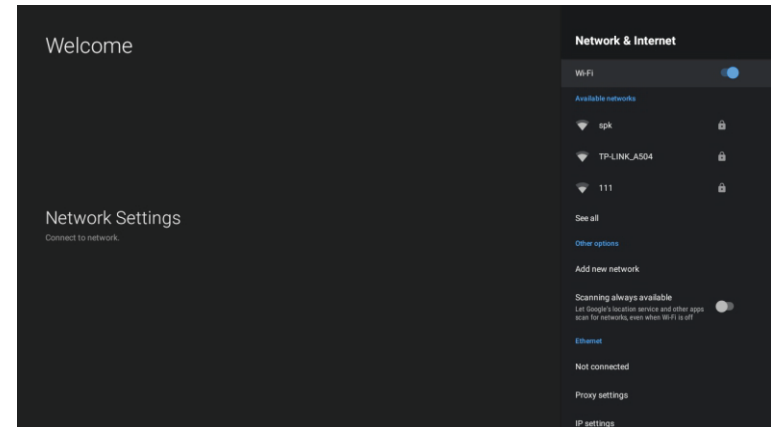

Enter the password setting interface after network setting or choosing "Skip Network Settings".

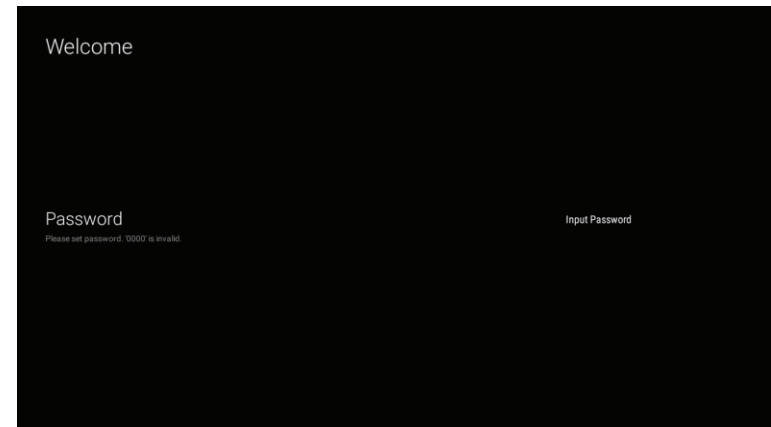

Enter the password input interface.

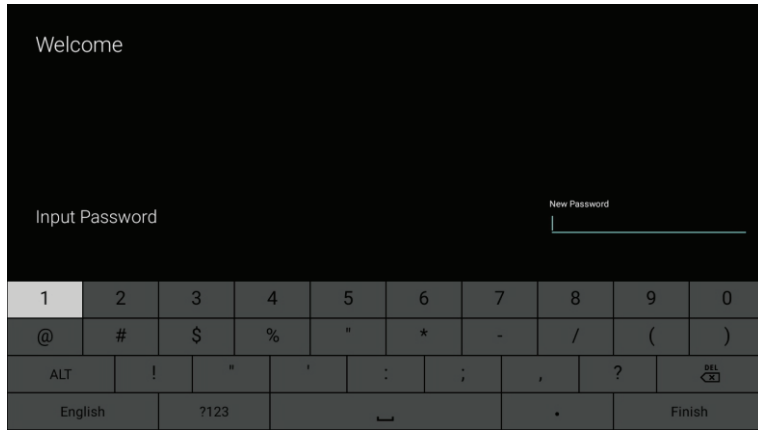

Enter the confirmation password interface. The user needs to enter the password again for confirmation.

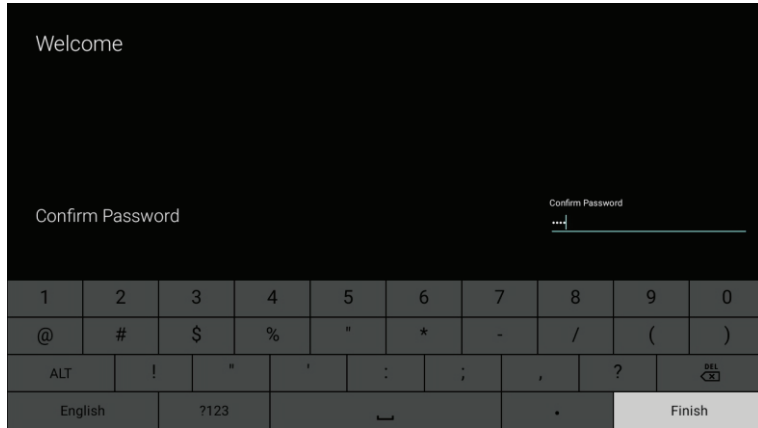

Enter the TV mode selection interface.

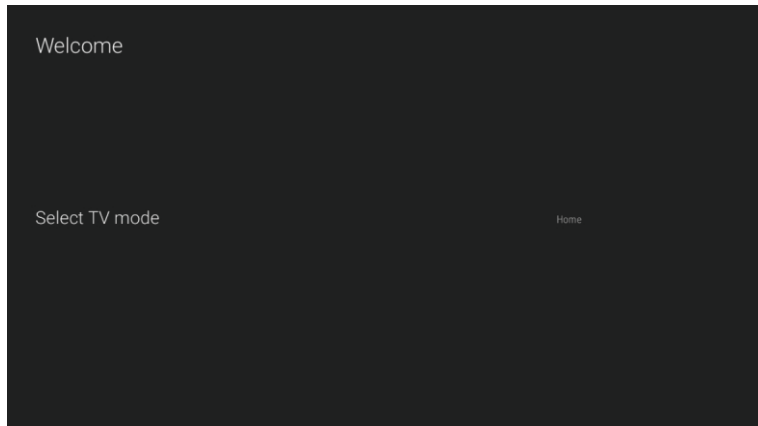

Enter the search type selection interface.

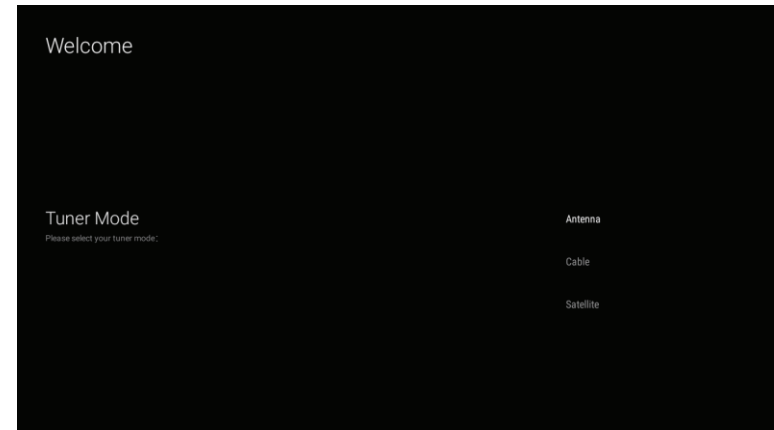

Enter the channel scan selection interface.

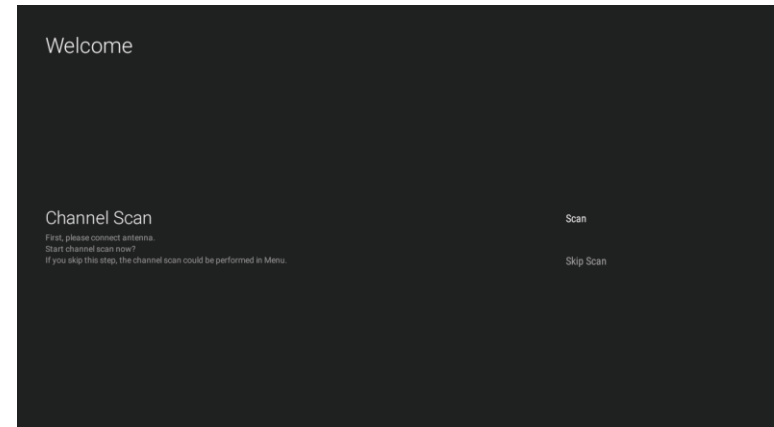

Enter the search interface after choosing "Scan".

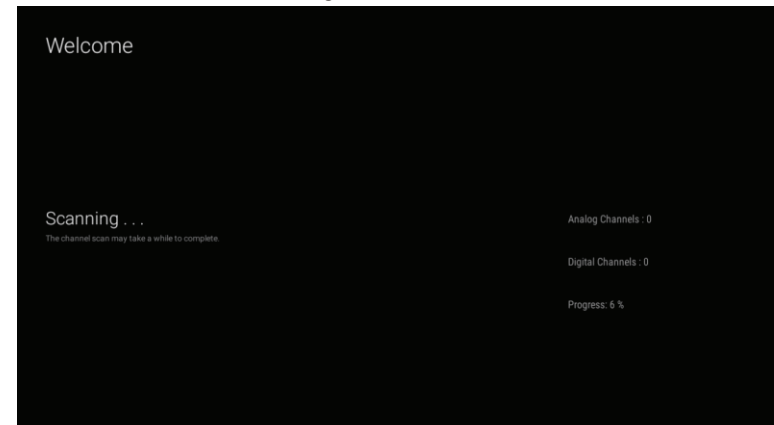

The boot wizard is set up.

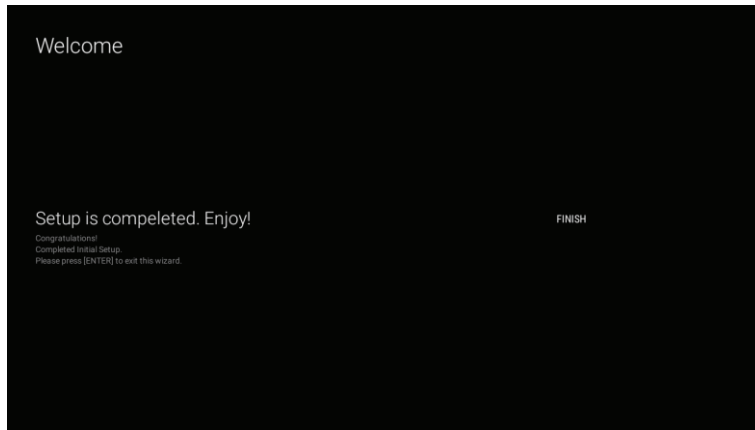

Enter the disclaimer interface, click accept to enter the TV interface.

If the TV mode is selected as home, you can enter the home interface after completing the wizard:

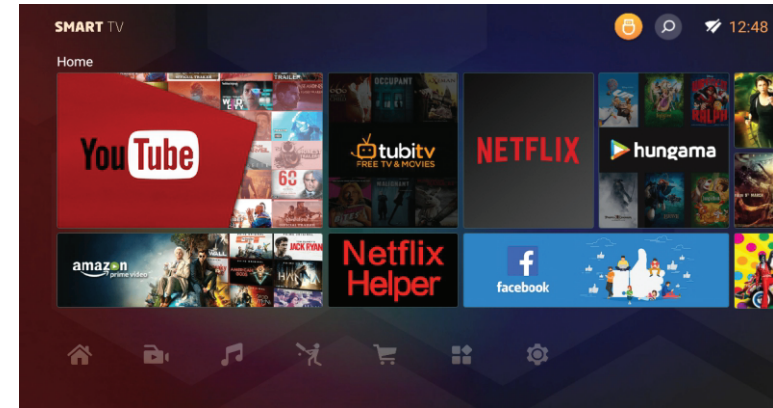

Otherwise, it will enter the play program interface:

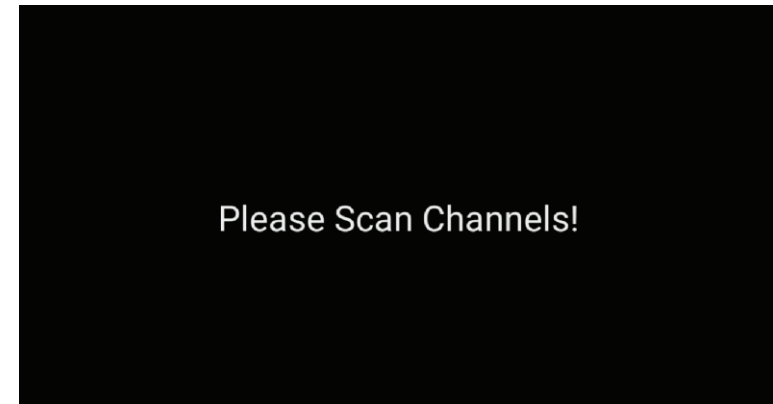

Inputs

Press the [SOURCE] key to display the input source menu.

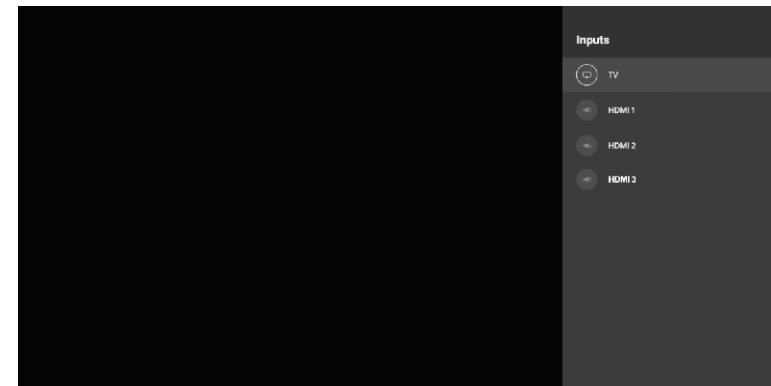

Press up/down key to select input source, then press OK button to enter.

Main Menu

Press the [MENU] key to display the main menu. The main menu is divided into three columns, channel bar, toolbar, and Record bar.

Channel bar

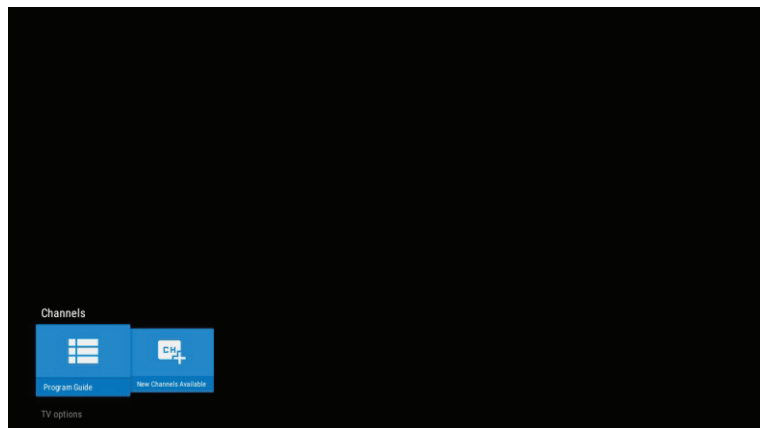

Program guide allows users to view program list information, including viewing detailed information such as channel programs and filtering operations on programs. New channels Available for users to search for channels.

Tool bar

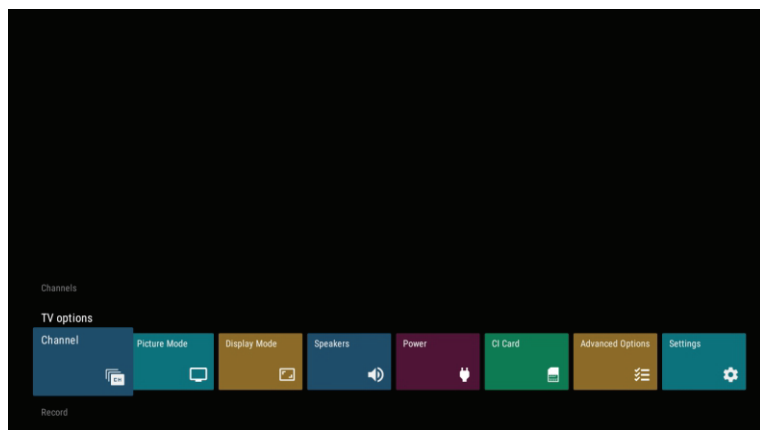

Channel settings

Click the Channel option to enter the channel interface, as shown below:

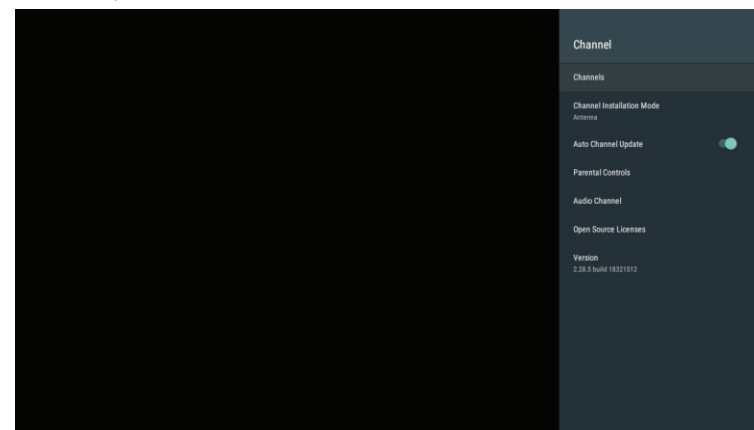

Channels

The Channels option mainly provides the user's channel configuration and channel program list information.

Channel Installation Mode

Antenna/Cable/Preferred Satellite/General Satellite Allows the user to select a channel mode.

Auto Channel Update

On->Off.

Parental Controls

Allows users to encrypt some channels.

Audio Language

English/German/...Select the audio language.

Audio Language 2nd

English/German/...Select the second audio language.

Open Source Licenses

Press OK button display Licenses information.

Version

The version information.

Clicking on Channels will jump to the following interface:

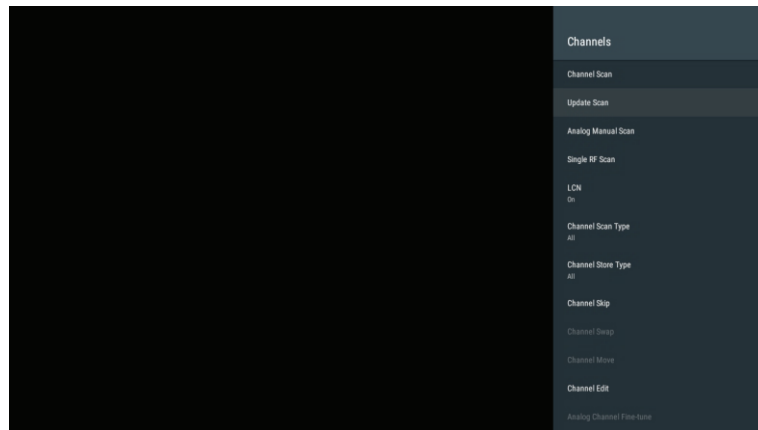

Channel Scan

Press Ok button to scan channels.

Update Scan

Press Ok button to scan channels.

Analog Manual Scan

Tuning the Analogue channel by you.

Single RF Scan

Scan Single RF channels.(Digital Only).

LCN

Off/On/Default.

Channel Scan Type

All/Only Encrypted Channels/Only Free Channels.

Channel Store Type

All/Only Digital Channels/Only Radio Channels.

Channel Skip

The selected programme will be skipped in channel list.

Channel Swap

Swap the selected two programme sin channel list.

Channel Move

Move the selected programme in channel list.

Channel Edit

Edit the programme tuned.

Analog Channel Fine-tune

Clear Channel List

The channel list will be empty.

Clicking on Channel Scan will jump to the following interface:

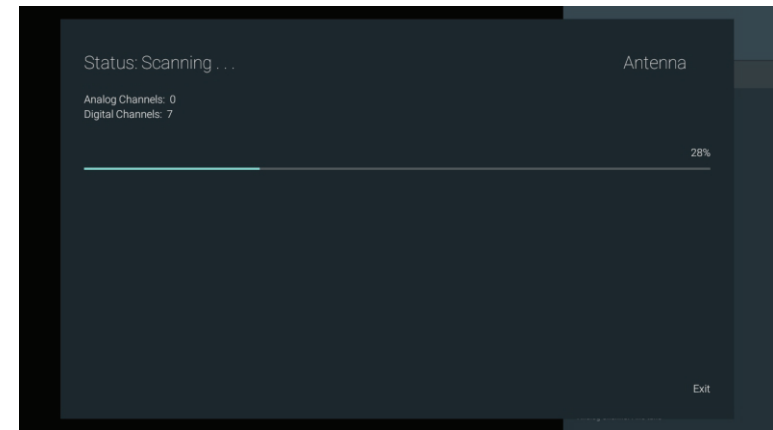

Status

Scanning.../Scan Cancelled (press Exit button)/Scan Completed.

Analog Channels

Show the numbers of Analog Channels .

Digital Channels

Show the numbers of Digital Channels.

Clicking on Analog Manual Scan will jump to the following interface:

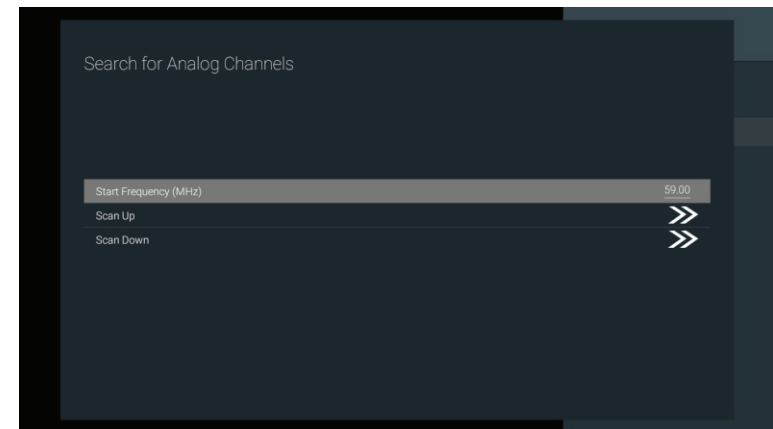

Start Frequency(MHZ)

Set the start frequency.

Scan up

Scan Frequency higher than the Start Frequency.

Stan Down

Scan Frequency lower than the Start Frequency.

Clicking on Parental Controls and inputting the correct PIN will jump to the following interface:

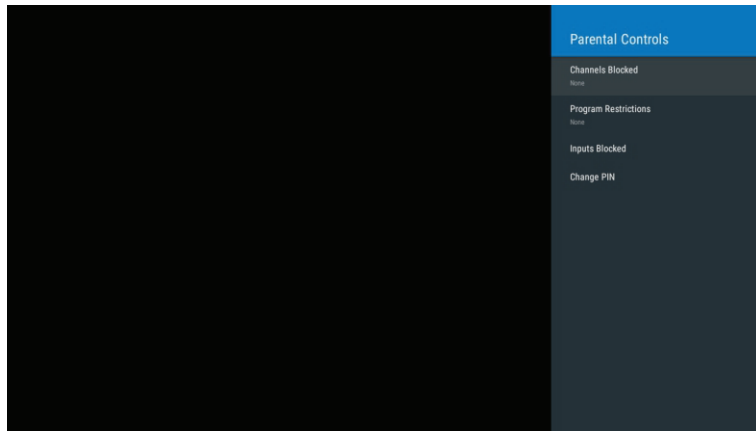

Channels Blocked

Block the selected programme. If select "Block All" will block all programmes.

Program Restrictions

Inputs Blocked

TV/Composite/HDMI1/HDMI2, Block the selected input source.

Change PIN

First enter the current PIN, then enter the new PIN, at last confirm your PIN.

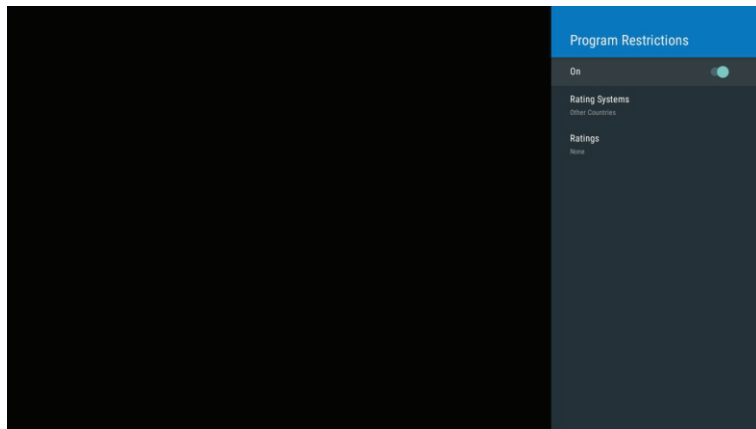

Power

Clicking on Power will jump to the following interface:

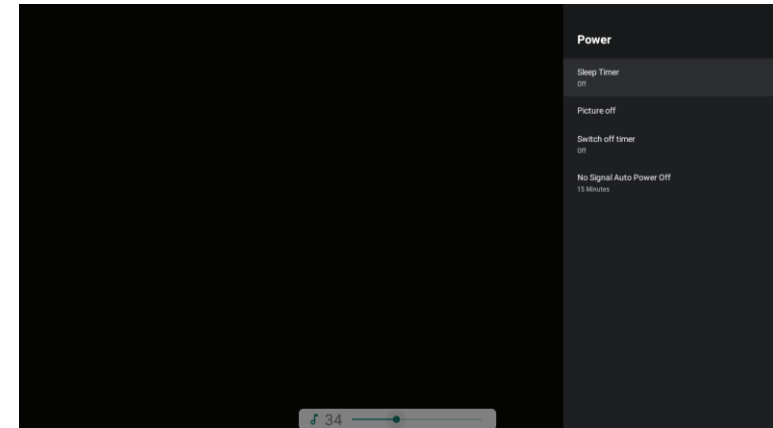

Sleep Timer

Off/10Minutes/20Minutes/30Minutes/40Minutes/50Minutes/60Minutes/90Minutes/120Minutes, Select the time you want TV close automatically.

Picture off

Press OK button picture will disappear, then press any key picture will display again.

Switch off timer

Off/30Minutes/60Minutes/90Minutes/120Minutes/150Minutes/180Minutes/210Minutes/240Minutes.

No Signal Auto Power Off

Off/5Minutes/10Minutes/15Minutes/30Minutes/60Minutes, Select the time you want TV close automatically when no signal.

Advanced Options

Clicking on Advanced Options will jump to the following interface:

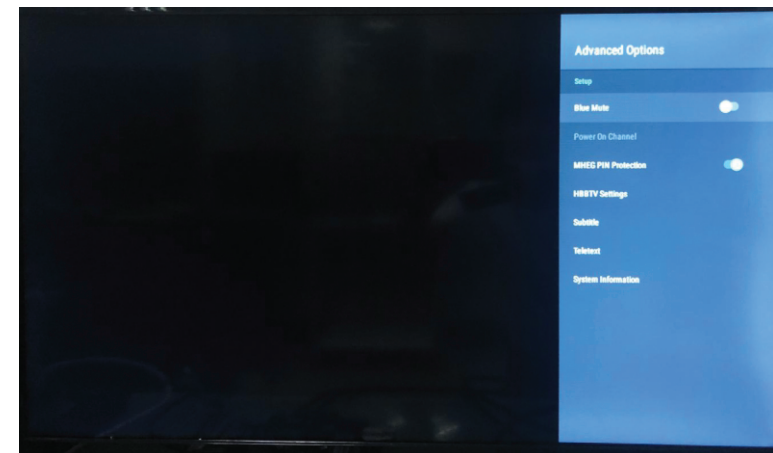

Clicking on Subtitle will jump to the following interface:

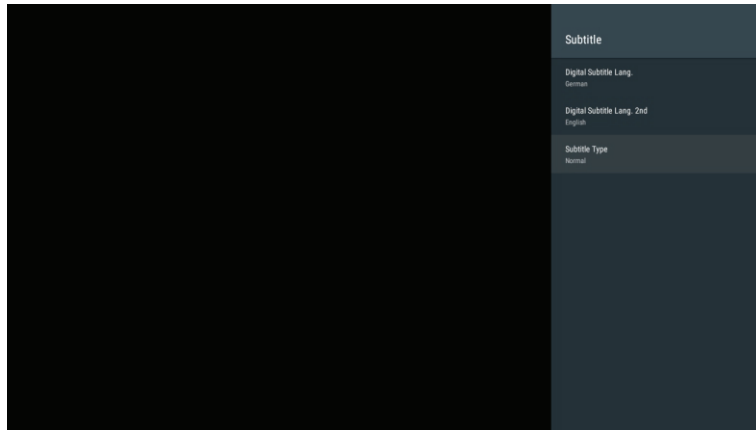

Digital Subtitle Lang

English/French/...Select the subtitle language.

Digital Subtitle Lang.2nd

English/French/...Select the the second subtitle language.

Subtitle Type

Normal/Hearing Impaired Select Subtitle Type.

Clicking on Teletext will jump to the following interface:

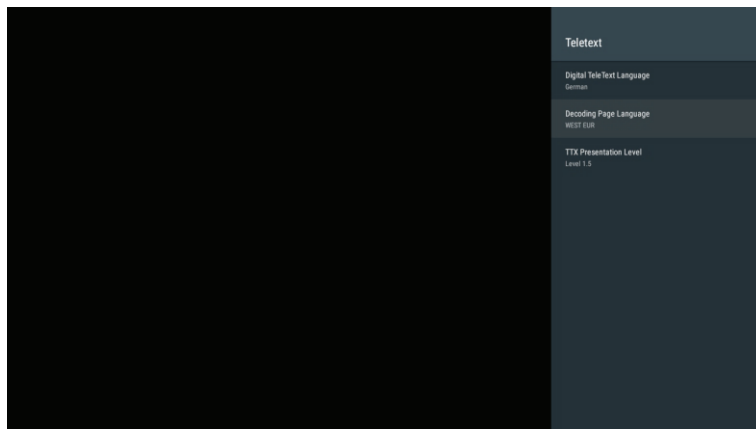

Digital Teletext Language

English/French/...Select the Teletext language.

Decoding Page Language

WEST EUR/EAST EUR/...Select the the decoding page language.

TTX Presentation Level

Level 1.5.

Record bar



Record List

Look over and manage user's burned file list.

Device Info

Look over device details.

Schedule List

Timetable list for viewing, adding and deleting users.

Time Shift Mode

Time shift switch, users need to turn on time shift mode to use time shift function.

Settings

Click the settings icon on the home page and the settings page will appear, as shown below:

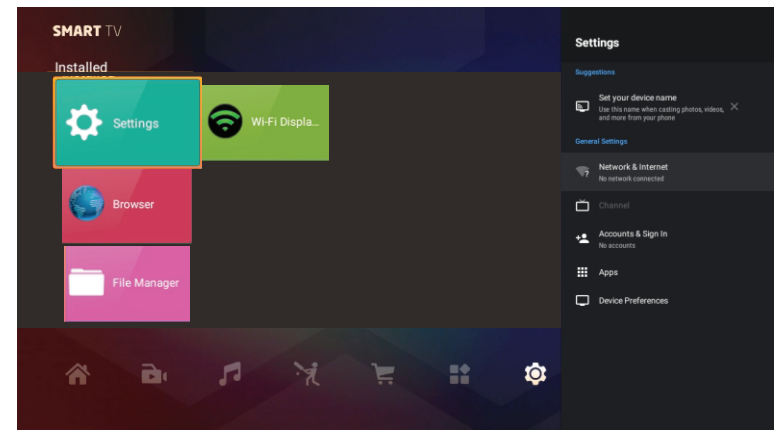

Network settings

Click the network & Internet option to enter the network settings page as shown below:

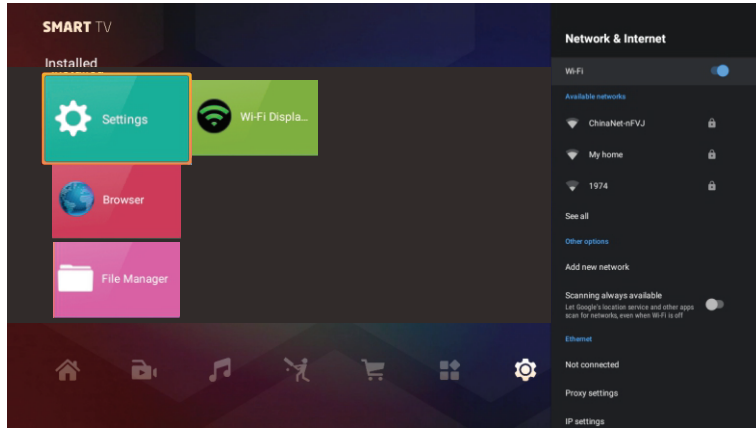

Accounts & sign in

Click the "Accounts & sign in" option will jump to the following interface: Users can set your account(add email address) and sign in.

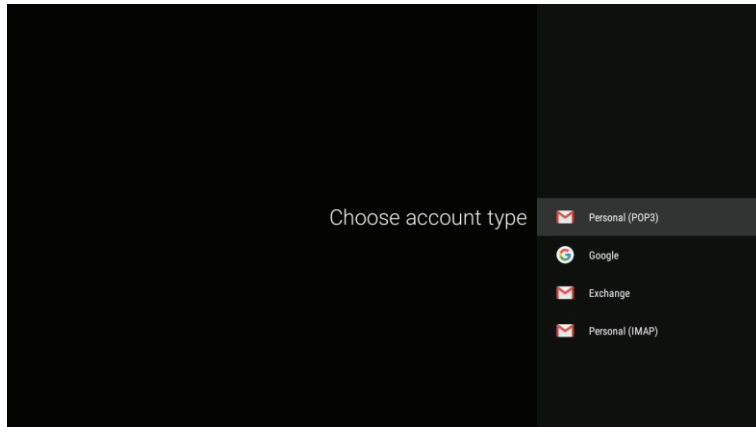

Apps

Click the "Apps" option will jump to the following interface:

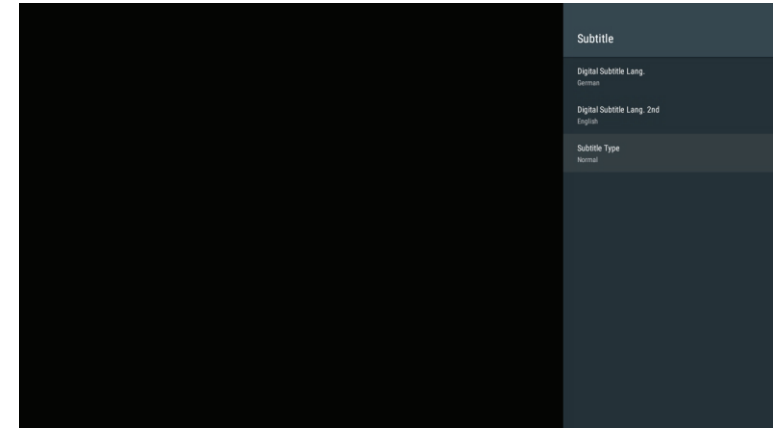

Device Preferences

Click the "Device Preferences" option will jump to the following interface:

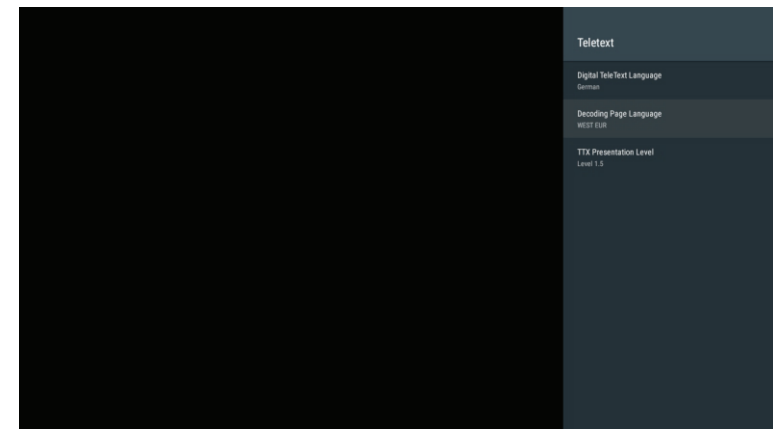

FileManager

Click the usb icon in the upper right corner of the home page to enter the file manager page. As shown below:

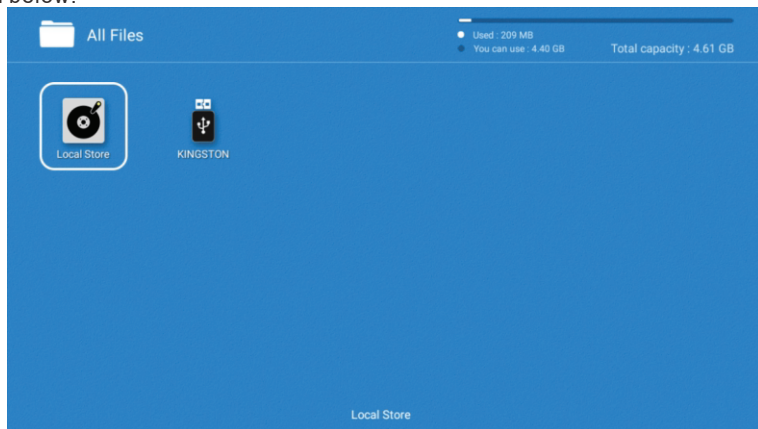

Click the corresponding drive letter to view the contents of the file in the USB, and select the file to view or play. As shown below:

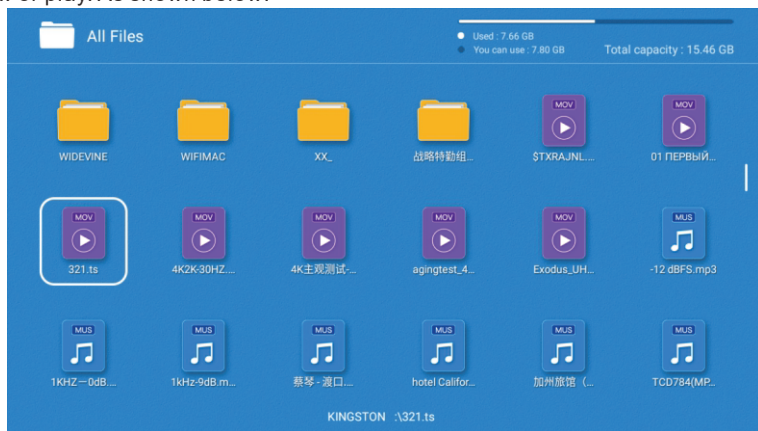

Photo

Click the picture to enter the picture playback interface as shown below, press the left and right keys to move the cursor, and perform different operations according to the prompts. The functions of the icons on the right side of the interface from top to bottom are: picture information, zoom out, zoom in, playlist.









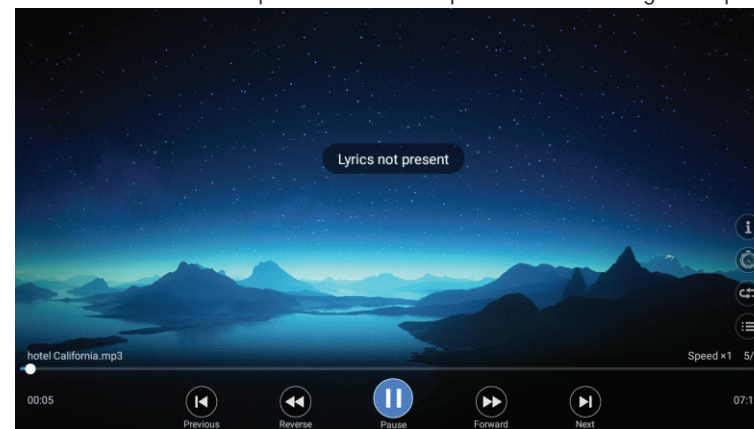

- Image Information
- enlarge
- Zoom out
- Zoom in
- Playlist
- Rotate 90 degrees counterclockwise
- Previous picture
- Play or pause
- Next picture
- Rotate 90 degrees clockwise

Music

Click the music file to enter the music playback interface as shown below. Press the left and right keys to move the cursor and perform different operations according to the prompts.









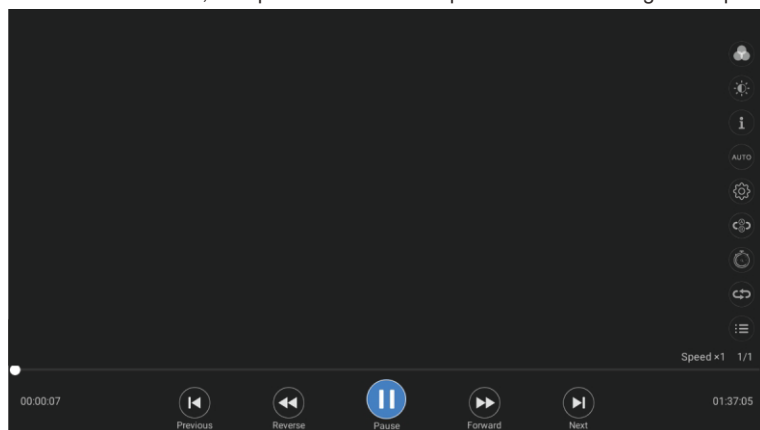





-  Previous song
-  Rewind
-  Play or pause
-  Fast forward
-  Next song
-  Music Information
-  Set the time begin to play
-  Set the play mode: Random play/All cycle/List play once/Single cycle
-  Playlist

Movie

Click the video file to enter the video playback interface as shown below, press the left and right keys to move the cursor, and perform different operations according to the prompts.



-  Previous movie
-  Rewind
-  Play or pause
-  Fast forward
-  Next movie
-  Picture Setting
-  Video Information
-  Aspect Ratio : 4:3/16:9/Auto
-  Breakpoint play/Subtitle/Sound track setting
-  Segment repeat playback setting
-  Set the time begin to play
-  Set the play mode: Random play/All cycle/List play once/Single cycle
-  Playlist

Troubleshooting

Area	Problem	No	Potential Cause	Solution
Power	No red standby light on TV		Power supply not receiving/giving power	Check connection between power lead and PSU - green light should be visible on PSU
	Standby light stuck on red		Remote not emitting signal	Try new battery in the remote
	Standby light green; no picture		Power supply not receiving/giving power	Check connection between power lead and PSU - green light should be solid on PSU
Signal/ Input	DTV - No signal	1	Not tuned in with channels	Auto-tune using DTV Auto-search in menu
		2	Aerial problem	Try TV on another aerial in different location - if picks up channels, likely an issue with the location of the bathroom aerial
	DTV - Inteferece on screen		Caused by equipment around the the aerial	Move aerial to different position away from any power cabling
	HDMI - No signal	1	No signal received from source	Check connection on TV and source
		2	Source emitting 4K signal	Scale down resolution from source to 1920x1080 (1080p)
	USB - Media cannot be played		File format not compatible	Change file format and attempt to play
	Wifi - no connection		Too far from router	Wifi extender
Smart screen not moving with buttons		Stuck in mouse mode	Press blue button on remote to toggle mouse mode off to use menu	
Audio	No sound - Speakers	1	Mute	Try mute button on remote
		2	Sound trying to route to external speakers	Disconnect audio out/earphone port
	No sound - external speakers		No signal bewteen TV and external speakers	Check audio connection at either end