

Pendant Cylinder Installation

SHT-10113

lusalighting.com

For your safety, read and understand these instructions completely before starting installation.

The electrical product contained herein is designed to meet the requirements of UL 1598 and the current NFP regulations as published in the National Electrical Code (NEC). Specific modifications and revisions in your area may differ from this standard. Compliance with local building and electrical codes must be confirmed before installation.

WARNING - To prevent wiring damage or abrasion, do not pinch or damage exposed wiring during installation. Keep away from edges of sheet metal or other sharp objects.

WARNING - Risk of fire or electric shock. Installation of this product requires a person familiar with the construction and operation of the luminaire's electrical system and the hazard involved. If not qualified, do not attempt installation. Contact a qualified electrician.

WARNING - Risk of fire or electric shock. Install this kit only in the luminaires that have the construction features shown in the photographs and / or drawings. Do not make or alter any open holes in an enclosure of wiring or electrical components during kit installation.

WARNING - Risk of fire or electric shock. Do not alter, relocate or remove wiring, lamp holders, power supply, or any other electrical component.

BEFORE YOU INSTALL - Power must be turned off prior to installation. Failure to do so may cause electric shock, which may result in injury or death. Ensure that electrical connection is in accordance with local and NEC standards and that wiring is 120VAC.

Pendant Cylinder Installation CP3DWH

1. To adjust pendant length, loosen the cordgrip hex nut (A) on the bracket, adjust cord (B) to the desired length, then retighten nut. Trim excess wire if necessary.

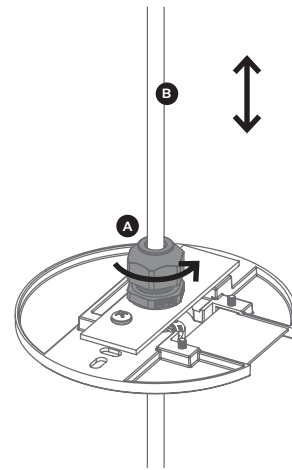

2. Connect the electrical supply wires to the pendant cord in accordance with local and NEC standards.

3. Separate the canopy (C) from the bracket (D). The canopy is magnetically attached.

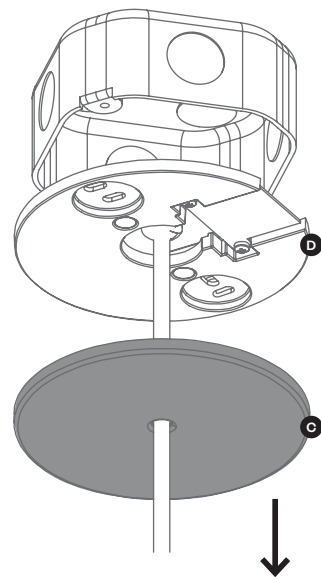

4. Mount the bracket to the junction box using two screws (not included).

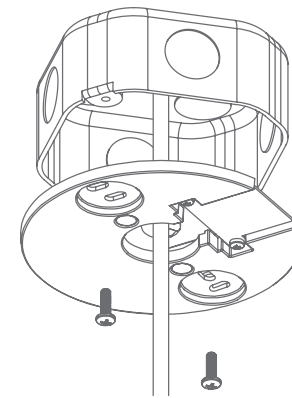

5. Reattach the canopy to the bracket.

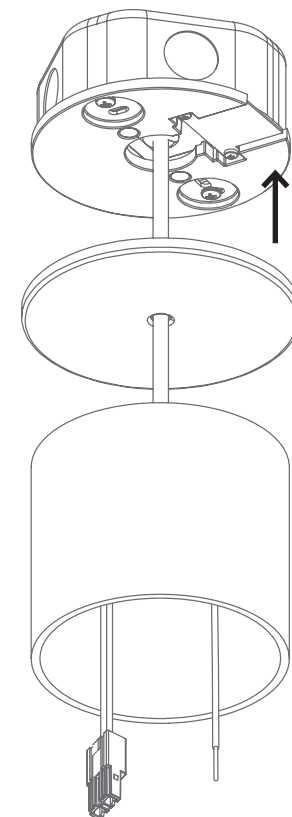

6. Set the Brightness Switch to your desired setting:

☀️ **Soft Light:** 350 lm (5W)

☀️ **7-9 ft Ceiling:** 750 lm (9W)

☀️ **9-12 ft Ceiling:** 950 lm (12W)

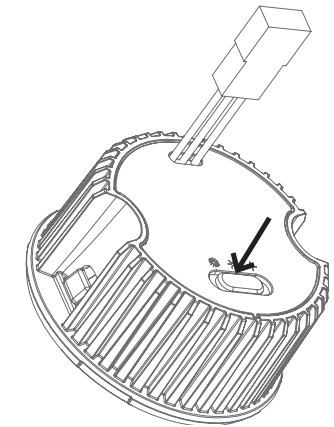

7. Secure the trim to the module, applying pressure until the clips snap into position.

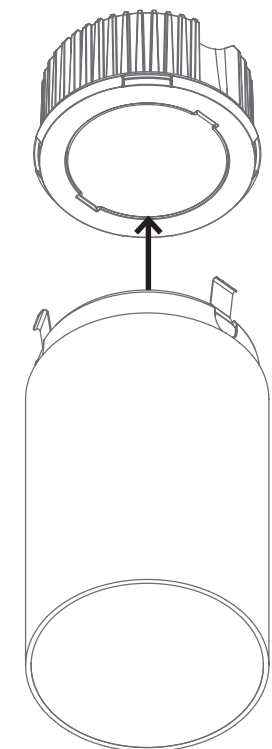

8. Attach the module ground wire to the ground wire in the cylinder.

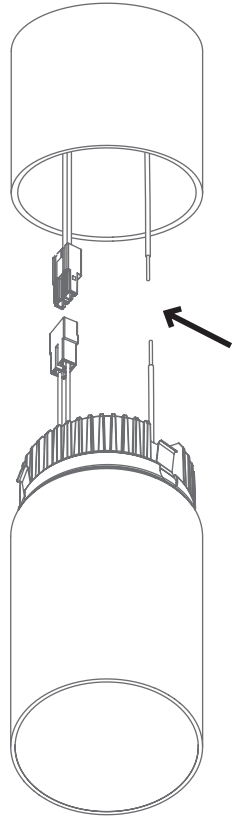

10. Insert the trim and attached module into the cylinder.

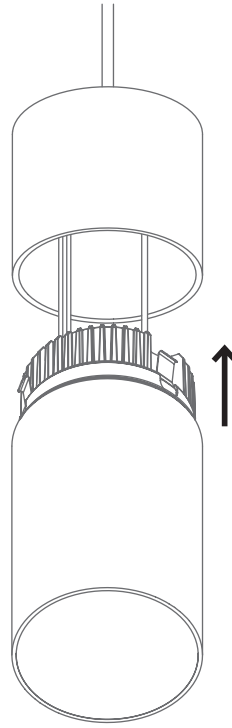

9. Connect the module power connector.

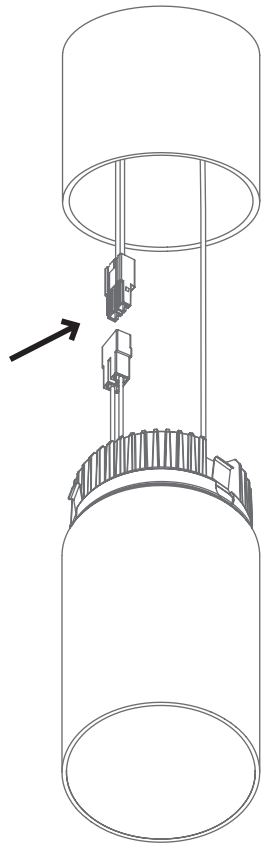

11. Press trim fully into cylinder, ensuring a secure fit.

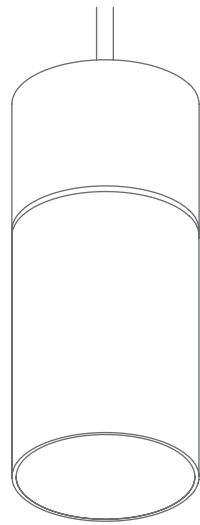

Good light. Good life.