



**OWNERS MANUAL VERIPUREVPC5000**

REVISED 4/13/2020

# THANK YOU FOR CHOOSING VERIPURE®

PLEASE TAKE A FEW MOMENTS TO FILL IN THE INFORMATION BELOW, SAVE THIS MANUAL AS A CONVENIENT INFORMATION SOURCE FOR YOUR VERIPURE® SYSTEM.

<b>Date of Purchase:</b>	
<b>Purchased From:</b>	
<b>Phone Number:</b>	
<b>Serial Number:</b>	
<b>Installed By:</b>	
<b>Dealer Name:</b>	
<b>Dealer Phone</b>	



2425 HUTSON ROAD  
GREEN BAY WI, 54303  
(920) 613-6771  
[www.veripure.com](http://www.veripure.com)

## PERFORMANCE DATA SHEET

Model VPC5000 & Model VP5000



This system has been tested by WQA according to NSF/ANSI 42 and 53 for the reduction of the substances listed below. The concentration of the indicated substances in water entering the system was reduced to a concentration less than or equal to the permissible limit for water leaving the system, as specified in NSF/ANSI 42 and 53. While testing was performed under standard laboratory conditions, actual performance may vary. Do not use with water that is microbiologically unsafe or of unknown quality without adequate disinfection before or after the system. Systems certified for cyst reduction may be used on disinfected waters that may contain filterable cysts.

### Stage One — Filtration Process:

The VeriPure Maintenance Kit- Consists of a two filter configuration that is a proprietary design of VeriPure, Inc. The first filter is a sediment filter that greatly reduces suspended and particulate matter from the incoming water source. The second filter (a carbon block filter for cyst removal, lead and chlorine reduction) greatly reduces free chlorine and cysts from the water source to disinfect and improve the taste and odor of the water.

### Carbon Block Filter Data

Parameter	Reduction Requirement	Max Permissible Water Concentration
Chlorine	>=50%	
Cyst	>=99.95%	
Lead		0.01 mg/L

### Operating Specifications:

**Capacity:** 1,250 Gallons Lead Reduction

**Flow Rate:** 0.50 to 1.0 GPM

**Minimum Pressure:** 50 PSI

**Maximum Pressure:** 125 PSI

**Temperature:** 35-90 F (2-32 C)

## IMPORTANT SAFEGUARDS AND PRECAUTIONS

- INSTALL YOUR VERIPURE® SYSTEM IN COMPLIANCE WITH STATE AND LOCAL LAWS AND REGULATIONS FOR PLUMBING AND ELECTRICAL CODES. **AS WITH ANY WATER DEVICE, PLEASE CHECK YOUR SYSTEM FOR LEAKS ON A REGULAR BASIS. CONTACT A PLUMBER IMMEDIATELY**
- VERIPURE® PERFORMANCE IS BASED UPON INPUT WATER WHICH MEETS MINIMUM EPA NATIONAL PRIMARY AND SECONDARY DRINKING WATER STANDARDS.
- SEE [WWW.EPA.GOV/DWSTANDARDSREGULATIONS](http://WWW.EPA.GOV/DWSTANDARDSREGULATIONS)
- **YOUR VERIPURE® SYSTEM IS DESIGNED TO BE USED ONLY WITH ALREADY DEEMED POTABLE WATER BY YOUR LOCAL WATER UTILITY**

**ATTENTION:** THIS UNIT IS DESIGNED FOR TREATMENT OF COLD WATER ONLY.

- **READ INSTRUCTIONS-** ALL SAFETY AND OPERATING INSTRUCTIONS SHOULD BE READ BEFORE THE UNIT IS OPERATED.
- **RETAIN INSTRUCTIONS-** SAFETY AND OPERATING INSTRUCTIONS SHOULD BE KEPT IN AN ACCESSIBLE LOCATION FOR FUTURE REFERENCE.
- **FOLLOW INSTRUCTIONS-** ALL INSTRUCTIONS SHOULD BE FOLLOWED FOR MAINTAINING AND OPERATING YOUR VERIPURE® SYSTEM PROPERLY.
- **MAINTENANCE PRECUATIONS-** ALWAYS TURN OFF THE WATER SUPPLY AT THE SINK OR WATER SOURCE AND UNPLUG POWER JACK FROM THE VERIPURE® SYSTEM BEFORE PERFORMING ANY MAINTENANCE.
- **ACCESSORIES-** DO NOT USE ANY ACCESSORIES, INCLUDING FILTER CARTRIDGES THAT ARE NOT RECOMMENDED BY VERIPURE®
- **WATER AND MOISTURE-** DO NOT ALLOW MOISTURE TO CONTACT ANY INTERNAL OR EXTERNAL ELECTRONIC COMPONENTS. SHOULD A LEAK OCCUR, IMMEDIATELY SHUT OFF THE WATER SUPPLY AND CONTACT YOUR DEALER OR DISTRIBUTOR FOR SERVICE.
- **POWER SOURCES-** YOUR VERIPURE® SYSTEM SHOULD ONLY BE OPERATED FROM THE TYPE OF POWER SOURCE INDICATED ON YOUR AC ADAPTER. IF YOU ARE NOT CERTAIN OF THE TYPE OF POWER SUPPLY TO THE OUTLET PLEASE CONSULT YOUR VERIPURE® DEALER OR POWER COMPANY. ALTERNATIVE POWER SUPPLY ADAPTERS FOR VOLTAGES FOUND IN MANY COUNTRIES OUTSIDE THE UNITED STATES ARE AVAILABLE THROUGH YOUR DEALER ON SPECIAL ORDER. YOUR VERIPURE® SYSTEM MAY ALSO BE OPERATED WITH A BATTERY PACK OR GENERTOR.
- **POWER CORD PROTECTION-** VERIPURE® RECCOMENDS THAT POWER SUPPLY CORDS SHOULD BE ROUTED SO THAT THEY ARE NOT LIKELY TO BE WALKED ON OR PINCHED BY ITEMS PLACED UPON OR AGAINST THEM.

## **HOW YOUR VERIPURE® SYSTEM WORKS**

YOUR PATENTED VERIPURE® SYSTEM HAS BEEN DESIGNED TO USE TWO STAGES OF PRIMARY FILTRATION AND LOW LEVEL OZONE TECHNOLOGY®. OPERATIONAL MAINTENANCE AND REPLACEMENT REQUIREMENTS ARE ESSENTIAL FOR THE VERIPURE® SYSTEM TO PERFORM TO SPECIFICATIONS. CONTACT YOUR LOCAL DEALER OR DISTRIBUTOR FOR REPLACEMENT FILTERS AND PARTS, OR CONTACT VERIPURE FOR THE DEALER NEAREST YOU. THE VERIPURE® SYSTEM IS RECCOMENDED TO BE CONNECTED TO MUNICIPAL WATER SOURCES.

## **FOOD & SURFACES**

### **GENERAL RECOMENDATIONS FOR USING OZONATED WATER ARE AS FOLLOWS-**

- PLACE ITEM OR ITEMS TO BE WASHED UNDER A STEADY STREAM OF VERIPURE® WATER AND RINSE.
- FOOD PREPARATION: IT IS RECOMMENDED ITEMS BE RINSED FOR 3 MINUTES WITH VERIPURE® WATER.
- FOOD ITEMS: PLACE IN A BOWL, COLANDER OR STRAINER. RINSE WITH VERIPURE® WATER.

## **STORING WATER**

- SELECT A CONTAINER THAT IS FOOD GRADE QUALITY, SUCH AS GLASS OR STAINLESS STEEL. THOROUGHLY RINSE THE CONTAINER WITH VERIPURE® WATER AT LEAST TWICE. FILL THE CONTAINER TO WITHIN ONE TO TWO INCHES FROM THE TOP AND REPLACE CAP.
- STORE WATER IN REFRIGERATOR AND MAKE CERTAIN THE CAP IS REPLACED AFTER EVERY USE.
- WHEN WATER IS FRESHLY OZONATED YOU MAY INITIALLY BE ABLE TO DETECT A SLIGHT HINT OF OZONE. PEOPLE VARY IN THEIR SENSITIVITY TO OZONE. ANY HINT OF THE OZONE TASTE WILL DISAPPEAR WITHIN A SHORT PERIOD OF TIME. YOUR SYSTEM PRODUCES MINIMAL WASTE WHILE PRESERVING MINERALS IN YOUR WATER.

**IMPORTANT NOTE:** VERIPURE® PERFORMANCE IS BASED UPON INPUT WATER WHICH MEETS MINIMUM EPA NATIONAL PRIMARY AND SECONDARY DRINKING WATER STANDARDS. SEE [WWW.EPA.GOV/  
DWSTANDARDSREGULATIONS](http://WWW.EPA.GOV/DWSTANDARDSREGULATIONS)

**CAUTION: IF IRON OR MAGANESE IS PRESENT IN THE WATER SOURCE IN CONCENTRATIONS EXCEEDING .1PPM, PRE-TREATMENT FOR THESE SUBSTANCES MAY BE REQUIRED.**

## A LOOK AT YOUR VERIPURE® SYSTEM

UNIT DIMENSIONS: 11.5" L X 7" W X 5.5" H    9.0LBS (4.05KG)

IT IS IMPORTANT TO BE FAMILIAR WITH CERTAIN COMPONENTS OF YOUR VERIPURE® SYSTEM FOR MAINTENANCE PURPOSES.

### DIAGRAM 1

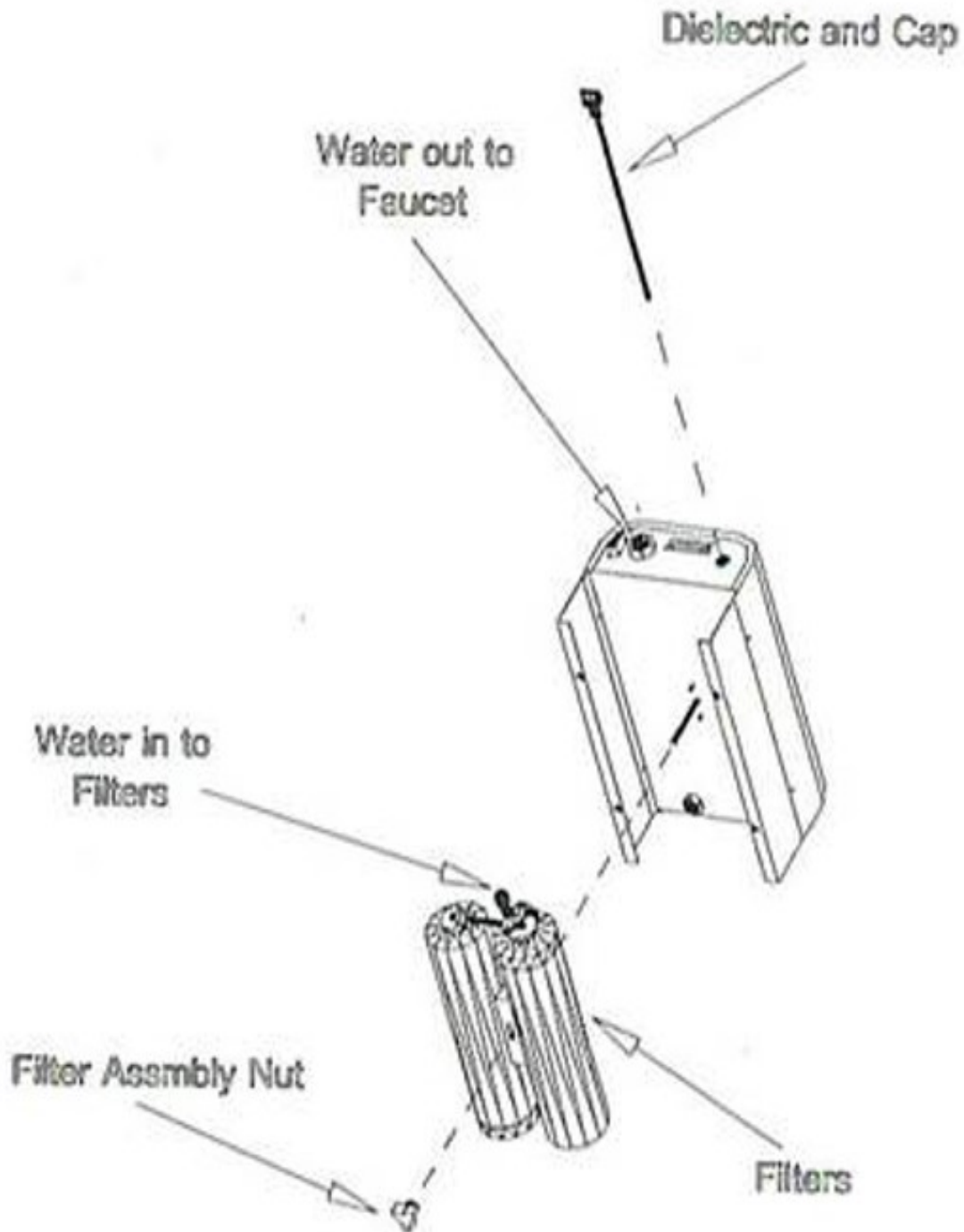

## INSTALLATION INSTRUCTIONS

### BEFORE INSTALLING

1. YOUR VERIPURE® SYSTEM **IS DESIGNED TO BE USED WITH COLD WATER ONLY.**
2. **NEVER RUN WARM OR HOT WATER** THROUGH YOUR VERIPURE® SYSTEM AS HOT WATER CAN DAMAGE THE CARBON BLOCK FILTER.
3. **WATER TEMPERATURES** ABOVE 90° F CANNOT CONTAIN DISSOLVED OZONE; THUS ELIMINATING DISINFECTION. WATER TEMPS APPROACHING 85° F REQUIRE LONGER PERIODS OF CONTACT TIME FOR DISINFECTION PURPOSES.
4. **FOR OPTIMAL PERFORMANCE** , LIMIT YOUR VERIPURE® SYSTEM TO 70 PSI OF WATER PRESSURE. VERIPURE® RECOMMENDS A MINIMUM WATER PRESSURE OF 50 PSI. LOW WATER PRESSURE WILL CAUSE YOUR VERIPURE® SYSTEM TO PRODUCE A LOWER QUANTITY OF FILTERED AND OZONATED WATER.
5. **POWER REQUIREMENTS** ARE 120 VAC 60 HZ. USE AC ADAPTER PROVIDED WITH YOUR SYSTEM.

NOTE: VERIPURE® UNITS ARE DESIGNED TO BE UNDER CONTINUAL WATER PRESSURE WHEN INSTALLED AND NOT IN USE, THE ON/OFF VALVE AND OR FAUCET SHOULD BE ON THE OUTLET OF THE VERIPURE AT OR BETWEEN THE POU AND VERIPURE® UNIT. THIS ENSURES PROPER FUNCTION ON THE VERIPURE® .

◆ VPC5000 INSTALLATION INSTRUCTIONS BEGIN ON NEXT PAGE (PAGE 8)

## INSTALLATION INSTRUCTIONS(VPC5000)

### **\*COMMERCIAL/COUNTER-TOP MODEL\***

Due to variance in plumbing and power outlets; we recommend that a plumber and or electrician install your VeriPure® System by following these installation instructions. If you choose to install the unit yourself please call (920) 613-6771 for assistance.

Installation of the VeriPure® System must conform to state and local plumbing and electrical codes, laws, regulations and the instructions provided with your VeriPure® System. Failure to install as instructed will void the warranty.

Please check your VeriPure® System to be certain all items listed below are included.

- QTY 1 AC ADAPTER (POWER SUPPLY) WITH OUTLET PLUG
- QTY 1 DIVERTER VALVE ASSEMBLY
- QTY 1 FAUCET ADAPTERS (QTY 3)
- QTY 1 MOUNTING PLATE
- QTY 1 HEX WRENCH
- QTY 1 SPANNER TOOL
- QTY 1 COLD WATER ONLY LABEL
- QTY 4 RUBBER FEET
- QTY 1 OWNERS MANUAL





## VPC5000 WALL MOUNT INSTALLATION STEPS

**Step 1:** Please inspect your VeriPure® System Glass Dielectric Tube at this time. Locate the knob on your VeriPure® System. Rotate 1/4 turn counter clockwise and **PULL STRAIGHT OUT VERY CAREFULLY** as to prevent breaking. Inspect the dielectric for any cracks or breakage that may have occurred in shipping. If none are found, then replace dielectric. When replacing dielectric, rotate 1/4 turn clockwise to lock in place.

**Step 2:** Locate the power outlet for the power supply.

**Step 3:** Locate the best area for hanging the VeriPure® System. Directly above the faucet or slightly to the left. Attach the diverter valve to the faucet, **CAUTION: DO NOT OVERTIGHTEN**. Stretch out the hoses to get an approximate location for the VeriPure® System.

**Step 4:** Mount screws for the VeriPure® System by using the provided screws and mounting plate.

**Step 5:** Locate the 1/4" filter inlet fitting on your VeriPure® System. Remove the 3/8" red locking clip also located on your VeriPure® System on the 3/8" outlet fitting.

**Step 6:** Mount your VeriPure® System onto the mounting screws previously installed and tighten screws.

**Step 7:** Insert the 1/4" stem adapter fitting at the end of the hose into the 1/4" filter inlet fitting on your VeriPure® System.

**Step 8:** Insert the other end of the 3/8" tubing into the 3/8" outlet fitting located on your VeriPure® System. Replace the 3/8" red locking clip.

**Step 9:** Thread the power supply into the power jack located on your VeriPure® System. Plug the power supply into the electrical outlet.

SCREW ON EACH END OF MOUNTING PLATE USED TO FASTEN VERIPURE® SYSTEM TO PLATE

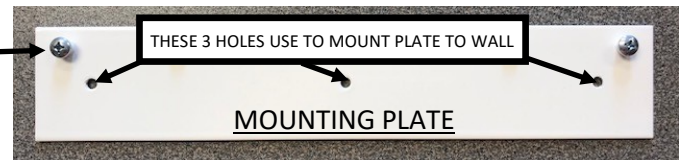

WALL MOUNTED EXAMPLE

POWER PLUGGED INTO POWERJACK



## VPC5000 COUNTER TOP INSTALLATION INSTRUCTIONS

Your VeriPure® System offers the option of quick counter top installation.

**Caution:** Please be aware that your VeriPure® System **CANNOT BE SUBMERGED IN WATER**. Extra care should be taken when choosing the counter top location for your VeriPure® System so that it will not get wet or accidentally knocked into a sink or water basin.

**Step 1:** Place your VeriPure® System on a counter on the left side of your sink. There are only two possible orientations for the VeriPure® System to sit on a counter top (see photos on page 11).

**Step 2:** Remove the 3/8" clip from the 3/8 outlet on the Veripure® System.

**Step 3:** Insert the 3/8 tube into the VeriPure® System outlet until fully seated, Replace red 3/8" locking clip

**Step 4:** Insert the 1/4" stem adapter fitting into the filter cartridge.

**Step 5:** Position the handle of the diverter valve in your preferred location and then hand tighten the diverter valve collar.

**Step 6:** Connect power cord to the VeriPure System and plug into wall outlet.

**Step 7:** To operate your VeriPure System turn on your faucet, **COLD WATER ONLY** and turn the diverter valve handle. Your VeriPure System will automatically turn on as water flows through it (verified by green unit on light on LED readout). Flush the filters for 10 minutes as directed and check for leaks.

Note: See Flushing Instructions Below.

## FLUSHING INSTRUCTIONS

- TURN ON THE WATER SUPPLY AND **FLUSH NEW CARTIDGES FOR 10 MINUTES**, RUNNING WATER THROUGH THE SYSTEM
- NEW FILTER ASSEMBLIES MAY CONTAIN "CARBON FINES" AND THE WATER MAY BRIEFLY APPEAR GRAY, BUT WILL QUICKLY DISAPPEAR ONCE FLUSHED.
- **IMPORTANT**— CHECK THAT ALL WATER LINES ARE SECURE AND FIRMLY SEATED WITH NO EVIDENCE OF WATER LEAKAGE. IF A LEAK IS DETECTED, SHUT OFF WATER SUPPLY AND DISCONNECT LINES AND VISUALLY CHECK FOR ANY DEFECTS AT THE END OF LINES. INSERT LINES BACK IN UNTIL FULLY SEATED AND TURN WATER SUPPLY BACK ON. RECHECK FOR ANY LEAKS.

## VPC5000 COUNTER TOP INSTALLATION EXAMPLES

### DIELECTRIC UP POSTION

USE ONLY IF SYSTEM WILL BE LEFT OF SINK



### FILTER SIDE DOWN POSITION



## INSTALLATION OF RUBBER PADS

- IF UNIT IS HUNG ON WALL USING THE MOUNTING PLATE ONLY 2 PADS ARE REQUIRED THAT MOUNT ON BOTTOM SIDE OF UNIT TO REST AGAINST THE WALL.
- IF THE UNIT IS PLACED IN THE FILTER DOWN POSITION/ DIELECTRIC UP POSITION 4 PADS ARE REQUIRED. PLACE THESE PADS APPROXIMATELY 1.5 INCHES FROM THE END OF EACH CORNER FOR FILTER DOWN POSITION. FOR DIELECTRIC UP POSITION THE TOP SIDE OF BOTTOM (SIDE THAT REST AGAINST WALL) WILL RECEIVE 2 PADS WHILE THE OTHER TWO ARE PLACED ON THE BOTTOM SIDE OF THE COVER (SIDE THAT THE UNIT IS RESTING ON).

**PAD PLACED ON BOTTOM 1.5 INCHES FROM CORNER END.**



**PAD PLACED ON CORNER OF COVER FOR DIELECTRIC UP POSITION**



## MAINTAINING YOUR VERIPURE® SYSTEM

When performing maintenance as recommended, you should enjoy years of excellent performance from your VeriPure® System. The LED indicator lights will confirm that your VeriPure® System is working properly or if your system is malfunctioning.



**INSTALLED VERIPURE®**

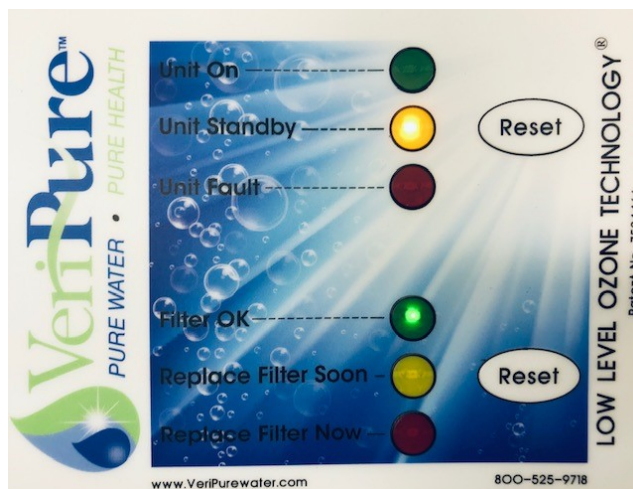

**LED READOUT**

There are two maintenance requirements for your VeriPure® System:

1. Change the filter cartridge assembly when indicated by the LED readout on your VeriPure® System.
2. Replace the Dielectric tube whenever you change your filters (included in your maintenance kit).
3. Refer to Maintenance Kit supplied by VeriPure, LLC on page 13.

**CAUTION: REMOVE DIELECTRIC TUBE CAREFULLY AS STRAIGHT AS POSSIBLE TO PREVENT BREAKAGE.**

Please Reference Part# **VERIVPC5000MAINTKIT**

- Replacement Maintenance Kits contain a two-stage filter cartridge assembly and one thermoplastic-capped borosilicate glass dielectric tube. Please follow replacement guidelines as referenced above.



## **CHANGING THE FILTERS (VPC5000)**

### **\*COMMERCIAL/COUNTER-TOP MODEL\***

### **PREPARATION**

1. Shut off water supply to the unit.
2. Unplug your VeriPure® System unit from electrical connection before changing filter cartridges. **\*THIS STEP IS IMPORTANT, IN ORDER TO RESET YOUR VERIPURE UNIT.**
3. Disconnect the input and output fittings on your VeriPure® System using spanner tool provided in maintenance kit (Refer to Diagram 1)

NOTE: To remove waterlines at the unit, you must first remove red locking clips. Next press each collar inward toward the unit using spanner tool, pulling hose simultaneously.

CAUTION: If you do not depress collar(s) before pulling hose(s), you can damage unit fittings. See Warranty Specifications.

### **TO REMOVE THE FILTER CARTRIDGES**

1. Place a towel/absorbent cloth on counter or work surface.
2. Remove unit from wall mounting plate by loosening screws. If unit is wall mounted, lift up and pull out from mounting plate.
3. Place unit face down on towel.
4. Unscrew the locking bolt in the center of the cartridge assembly (Refer to Diagram 1).
5. Using spanner tool, depress collar inward toward unit and pull filter assembly up.
6. Remove filter assembly by tipping and sliding.
7. Dispose of the used filter assembly.

**(CONTINUED ON PAGE 14)**

## **CHANGING THE FILTERS (VPC5000) (CONTINUED)**

### **\*COMMERCIAL/COUNTER-TOP MODEL\***

#### **TO INSTALL FILTER CARTRIDGES**

1. Slide assembly into unit housing matching the filter outlet to unit inlet and press firmly.
2. Be sure the filter assembly is seated on guide pins (Refer to Diagram 1)
3. Replace locking bolt and turn finger tight.

#### **RETURNING UNIT TO USE**

1. If wall mounted, line up mounting guide holes to guide bolts on mounting plate. Allow unit to seat into place, checking stability before releasing unit from your grip. Tighten screw on mounting plate.
2. Reconnect water lines by popping line into fitting until seat feels firm.
3. Replace red locking clip on larger line assembly.
4. Plug unit back in **AND PRESS FILTER RESET BUTTON.**
5. Follow **FLUSHING INSTRUCTIONS** on page 16.

## CHANGING THE DIELECTRIC TUBE \*(VP5000&VPC5000)

**CAUTION:** The Dielectric Tube is glass and is fragile. Dielectric tubes are not designed for bending or to sustain impact.



**Dielectric Tube**

1. Make sure your VeriPure® unit remains unplugged.
2. Locate the Dielectric. (Refer to Diagram 1) page 5.
3. Rotate the Dielectric cap one quarter (1/4) turn **counterclockwise**, to unlock the Dielectric. You will feel a click.
4. **Slowly** remove the Dielectric tube from the VeriPure® housing by sliding the Dielectric out, IN A STRAIGHT LINE, until the Dielectric tube is completely separated from the VeriPure® housing.
5. The old Dielectric tube should be immediately discarded of into the trash/garbage. **DO NOT TOUCH THE GLASS BECAUSE STAINING FROM NITROGEN BY-PRODUCTS CAN STAIN THE SKIN.**
6. Carefully slide new Dielectric tube in place until the cap is flush with the VeriPure® Housing.
7. Rotate the Dielectric cap one quarter (1/4) turn clockwise until it locks in place.



**PROPER DIELECTRIC POSTION WHEN  
INSERTING OR REMOVING.**

## FLUSHING INSTRUCTIONS

1. Turn on the water supply and **FLUSH NEW FILTER CARTRIGES FOR 5 MINUTES**, running water through the system.
2. New filter assemblies may contain "Carbon Fines" and the water may briefly appear gray ,but will quickly disappear once flushed.
3. **IMPORTANT - CHECK THAT ALL WATER LINES ARE SECURE AND FIRMLY SEATED WITH NO EVIDENCE OF WATER LEAKAGE.** If a water leak is detected, REPEAT 'Returning Unit to use', Steps 2-4.

## TROUBLE SHOOTING GUIDE

At VeriPure<sup>®</sup>, Inc. we expect your VeriPure<sup>®</sup> System to function properly for years as long as you perform the maintenance according to the prescribed schedule. However, the following table will help to identify any problem which may occur.

**\*\*NOTE:** The service technicians at VeriPure<sup>®</sup> are trained to address any undefined issues. Please call (920)613-6771 should you not be able to diagnose any problem.

**TROUBLE SHOOTING CHART LOCATED ON PAGE 17**



## TROUBLE SHOOTING CHART

<u>PROBLEM</u>	<u>POSSIBLE CAUSE</u>	<u>SOLUTION</u>
<b>NO OZONE</b>	NO POWER TO SYSTEM PLUG	CHECK POWER SUPPLY CORD IS SEATED INTO VERIPURE SYSTEM AND WALL OUTLET.
		RESET ANY GFI OUTLET RESET BUTTONS IN THE AREA.
		CHECK IN-HOME ELECTRICAL BREAKER.
	FILTER LIFE IS EXPIRED AND FILTER IS LIMITING WATER PRESSURE TO FLOW SWITCH.	CHANGE YOUR SYSTEM FILTERS
	WET GLASS DIELECTRIC	<b>*CAREFULLY*</b> REMOVE THE GLASS DIELECTRIC AND INSPECT FOR MOISTURE. IF WET, CONTACT VERIPURE 2425 Hutson Road Green Bay, WI 54303 920.613.6771
	DROP IN HOUSE OR MUNICIPAL WATER PRESSURE.	LOW WATER PRESSURE WILL NOT ALLOW YOUR SYSTEM OZONATION COMPONENTS TO TURN ON. REGAIN INCOMING WATER PRESSURE TO MINIMUM OF 50 PSI. CONTACT YOUR PLUMBER OR MUNICIPALITY.
<b>DROP IN OR NO WATER FLOW</b>	PLUGGED FILTER	CHANGE YOUR SYSTEM FILTERS.
	DROP IN HOUSE OR MUNICIPAL WATER PRESSURE.	CONTACT YOUR PLUMBER OR MUNICIPALITY.
<b>SYSTEM LIGHTS NOT ON</b>	NO POWER TO SYSTEM PLUG.	CHECK POWER SUPPLY CORD IS SEATED INTO VERIPURE SYSTEM AND WALL OUTLET.
		RESET ANY GFI OUTLET RESET BUTTONS IN THE AREA.
		CHECK IN-HOME ELECTRICAL BREAKER.
<b>PANEL INDICATION LIGHTS HAVE NOT RETURNED TO STANDBY</b>	MAY HAVE NOT UNPLUGGED POWER WHEN CHANGING FILTER/GLASS DIELECTRIC TUBE.	UNPLUG YOUR SYSTEM, WAIT 10 SECONDS PLUG BACK IN AND PRESS THE RESET BUTTON ON YOUR FRONT PANEL.

## COMMON QUESTIONS ABOUT OZONE

### HOW DOES THE VERIPURE® SYSTEM TREAT WATER FOR DRINKING?

VeriPure® provides a three-layered system. The first two levels of filtration are followed by injecting powerful ozone gas as a final stage disinfectant which ensures flavorful and safe water.

1. As water passes through the first sediment filter dirt, rust and other particulates from the water are removed.
2. Water is then filtered a second time when it passes through a carbon block filter which reduces cysts, chlorine, organics and other impurities.
3. In the final stage, ozone is injected into water via the dielectric tube.

### HOW MUCH OZONE IS INJECTED INTO THE WATER?

The VeriPure® patented process creates Low Level Ozone Technology®. The ozone level in the water at one half (1/2) gallon per minute is approximately 0.4 parts per million.

### IS THE OZONE SAFE TO DRINK?

Yes. Due to our patented Low Level Ozone Technology®, the ozone turns back into oxygen very quickly. To give an idea of how much ozone is in the water, 0.40 parts per million is the equivalent to one inch in 64 miles. The ozone in the water is within the guidelines for ozone established by the FDA Bottled Water Regulations. Ozone was first discovered in 1840 and has been used to treat municipal drinking water since 1905.

### DOES THE OZONE AFFECT THE TASTE OF THE WATER?

Initially, there is a slight aroma of ozone. This dissipates after a short period of time, approximately 20 seconds.

### IS THE OZONE GAS RELEASED INTO THE AIR BY VERIPURE® TREATED WATER HARMFUL?

No. Your VeriPure® System employs Low Level Ozone Technology® which is harmless. Ozone is classified as an irritating gas only in high concentrations. The EPA has established strict guidelines limiting 0.1 parts per million in the air for eight hours of continuous exposure. Only a small portion of the ozone in the treated water is released momentarily into the air. If all the ozone in one gallon of water were released into one cubic foot of air, the level would amount to 0.03 parts per million and it would revert to oxygen within a few minutes.

### WHAT IF MY WATER DOESN'T TASTE GOOD?

If your water suddenly has a bad taste, the problem could be the filter cartridge(s) are spent. Changing the filter may take care of taste. Refer to "Filter change" Instructions in this manual or contact your dealer or distributor.

### IF I WANT TO REDUCE THE 'POPPING' WHEN I INITIALLY TURN ON MY VERIPURE® FAUCET, WHAT CAN I DO?

After you have the faucet running, gradually decrease the flow to totally shut the faucet off( watching for the water stream to become clear and void of bubbles). What this will do, is decrease the ozone in the water stream to virtually nothing. So the next time you turn on the faucet, there will be no pressure in the line from previous use.

## LIMITED WARRANTY

Badger-VeriPure, LLC warrants to the original purchaser of the VeriPure® System products that such equipment is free from defects in materials and workmanship.

If within one (1) year from the date of purchase, any product purchased from Badger-VeriPure, LLC shall prove to be defective in materials or workmanship, the Badger-VeriPure, LLC product shall be repaired or replaced, at Badger-VeriPure's sole discretion and expense.

**This warranty shall not apply to:**

- a. Product that has been damaged by improper installation.
- b. Product that has been improperly used or maintained.
- c. Product subjected to temperatures below 35 or over 120<sup>0</sup>F.
- d. Product operated in water pressures exceeding 90 psi.
- e. Product damaged after delivery.
- f. Product that has not been properly maintained.

VeriPure® Maintenance Kits are specifically not covered under this warranty.

Requests for service under this warranty shall be made by contacting our customer service team at [info@veripure.com](mailto:info@veripure.com) in a timely manner following discovery of the claimed defect. Any claim under this warranty must be made within 30 days following the expiration of the one year warranty.

Badger-VeriPure, LLC reserves the right to improve designs or change specifications at any time without any contingent obligation to owners of products previously sold.

Badger-VeriPure, LLC shall not be liable for any consequential, incidental or contingent damages. The foregoing warranties are exclusive and in lieu of all other express warranties. Implied warranties, including but not limited to the implied warranties of merchantability and fitness for a particular purpose, shall not exceed beyond the duration of this applicable express warranty provided herein. It is acknowledged that select states do not permit exclusive or limitations of incidental or consequential damages or limitations on the duration of an implied warranty, so the above limitations or exclusions may not apply to you. This warranty extends to your specific legal rights and you may also have other rights which vary from state to state.



2425 HUTSON ROAD  
GREEN BAY WI, 54303  
(920) 613-6771  
[www.veripure.com](http://www.veripure.com)