



X.G30

At NEXX, we do not just engineer helmets, we tech emotions.

We believe in the heat of passion - parts of life getting new blood.

HELMETS FOR LIFE is our motto, beyond the protection, past excellence, that any motorcyclist regardless of age or style lives the moment they wear NEXX.

在NEXX,我们不仅设计头盔,我们还巧妙地表达情感。我们相信激情澎湃可以赋予生命新鲜的血液。“生命之头盔”是我们的座右铭,超强防护,成就卓越,所有摩托车骑手,无论年龄或风格,都会感受到被NEXX产品呵护的时光。

CONTENT

目录

- | | |
|---|---|
| 03. INSTRUCTION MANUAL
使用说明 | 04. PARTS DESCRIPTION
部件说明 |
| 07. HOW TO INSTALL THE PEAK
如何安装帽檐 | 08. HOW TO FASTEN THE DOUBLE-D RING BUCKLE
如何扣上D形双环扣 |
| 09. HOW TO REMOVE THE VISOR
如何取下遮阳板 | 10. HOW TO PLACE THE VISOR
如何更换遮阳板 |
| 11. HOW TO CLEAN THE VISOR
如何清洁遮阳板 | 12. HOW TO USE THE INNER SUN VISOR
如何使用内遮阳板 |
| 13. HOW TO REMOVE DE INNER SUN VISOR
如何卸下内侧遮阳板 | 14. HOW TO PLACE THE INNER SUN VISOR
如何放置内遮阳板 |
| 15. LINING SPECIFICATIONS
内衬规格 | 16. HOW TO REMOVE THE INNER LINING
如何取下内衬 |
| 17. HOW TO PLACE THE INNER LINING
如何放置内衬 | 19. SIZE CHART
尺寸表 |
| 20. ACCESSORIES
配件 | 21. HELMET CARE
头盔护理 |

INSTRUCTION MANUAL

使用说明

EN Please read this manual very carefully before wearing your helmet and keep it in a safe place. For a correct use and for your safety, please pay attention to following instructions. The main function of the helmet is to protect your head in case of impact. This helmet is made to absorb some of the energy of a blow by partial destruction of its component parts and, even though damage may not be apparent, any helmet which has suffered an impact in an accident or received a similarly severe blow or other abuse should be replaced. To maintain the full efficiency of this helmet, there must be no alteration to the structure of the helmet or it's component parts.

CN 请在佩戴本头盔前仔细阅读本说明书并妥善保管。为了确保正确使用和您的安全，请注意以下说明。本头盔的主要功能是保护您的头部，以免受到撞击。这款头盔是通过部分破坏其组件的方式来吸收一些冲击能量，即使损坏可能不明显，对于在事故中受到过撞击或类似严重冲击或其它破坏的头盔，都应该予以更换。为了使本头盔保持全部效用，不得对头盔的结构或其组件进行任何改动

PARTS DESCRIPTION
部件说明

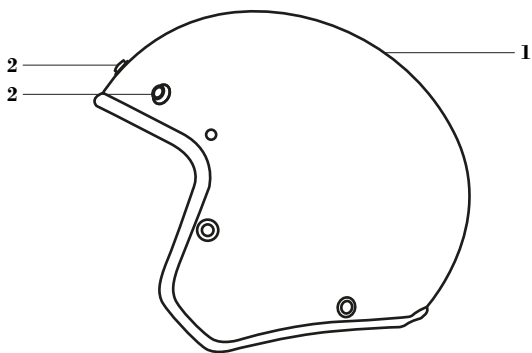

VERSION A
A 款

1 - Shell / 外壳

2 - Peak Assembly Points / 帽檐装配点

PARTS DESCRIPTION
部件说明

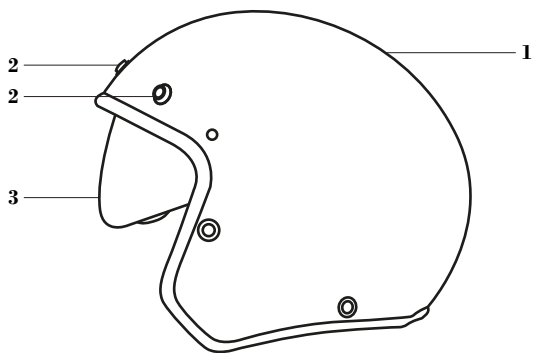

VERSION B
B 款

-
- 1 - Shell / 外壳
 - 2 - Peak Assembly Points / 帽檐装配点
 - 3 - Sun Visor / 遮阳板

PARTS DESCRIPTION
部件说明

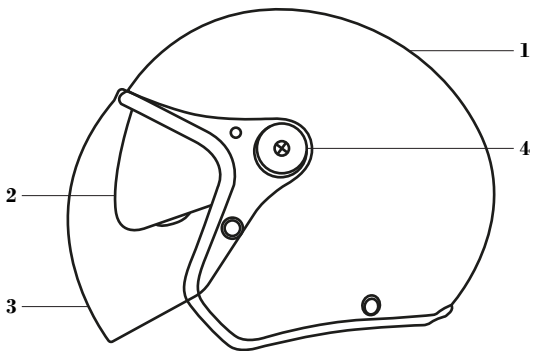

VERSION C
C 款

-
- 1 - Shell / 外壳
 - 2 - Sun Visor / 遮阳板
 - 3 - Shield/Visor / 面罩/面甲
 - 4 - Shield/Visor Mechanism / 面罩/面甲机构

HOW TO INSTALL THE PEAK 如何安装帽檐

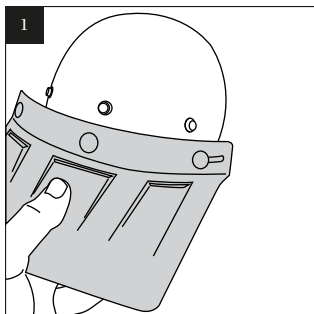

ALIGN WITH THE ASSEMBLY POINTS
对齐安装点

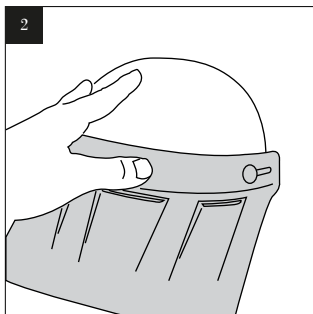

SNAP THE CENTER POINT
扣上中心点

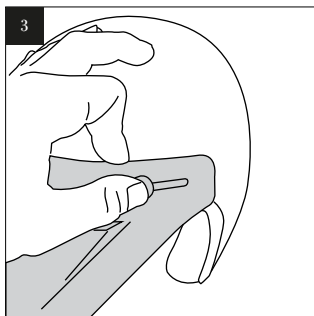

SNAP THE SIDE POINTS IN BOTH SIDES
扣上两边的侧边点

HOW TO FASTEN THE DOUBLE-D RING BUCKLE 如何扣上D形双环扣

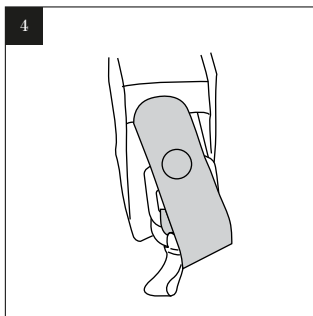
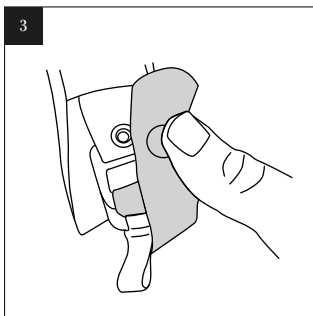
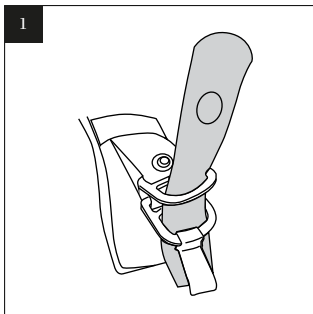

HOW TO REMOVE THE VISOR
如何取下遮阳板

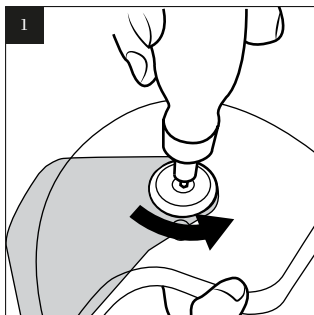

UNSCREW ON BOTH SIDES
拧开两侧螺丝

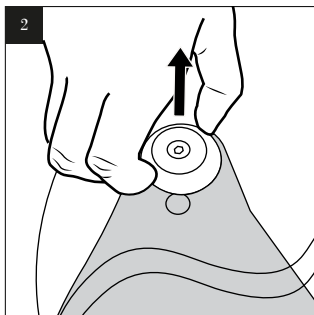

PULL FROM BOTH SIDES
从两侧拉

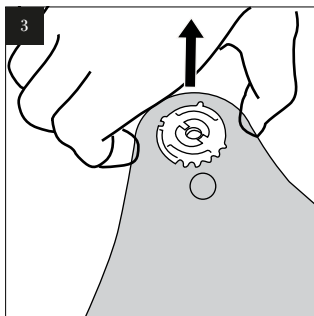

PULL FROM BOTH SIDES
从两侧拉

HOW TO PLACE THE VISOR
如何更换遮阳板

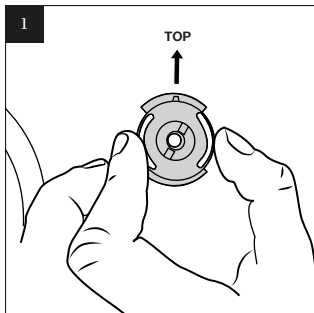

BOTH SIDES
两侧

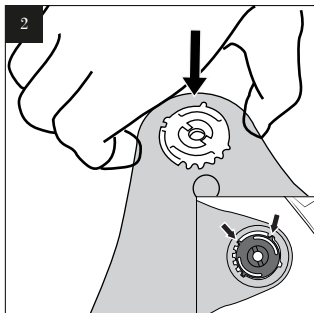

SNAP ON BOTH SIDES
两侧卡紧

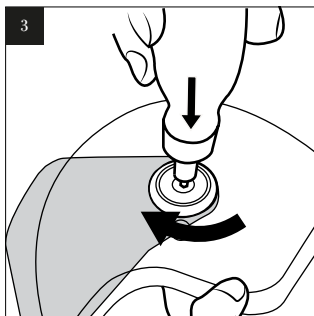

POSITION AND SCREW ON BOTH SIDES
两侧固定并拧紧

HOW TO CLEAN THE VISOR 如何清洁遮阳板

EN

To clean the visor without affecting its characteristics should be used only soapy water (preferably distilled) and a soft cloth. If the helmet is deeply dirty (ex. Insect remains) can add a little liquid from the dish to water. Remove the visor from the helmet before carrying a deeper cleaning. Never use objects to clean the helmet that may damage/scratch the visor. Always store the helmet in a dry place and protected from light, preferably in the bag provided by NEXX HELMETS.

CN

为了清洁面甲而不影响其特性，只应使用肥皂水（最好是蒸馏水配制的）和软布来清洁。如果头盔很脏（如有昆虫残骸），可以在水里加一点洗洁精。在进行更深入的清洁之前，应将面甲从头盔上取下。不得使用可能破坏/划伤面甲的物品来清洁头盔。始终将头盔存放于干燥避光的地方，最好是放在NEXX HELMETS公司提供的袋子里。

HOW TO USE THE INNER SUN VISOR
如何使用内遮阳板

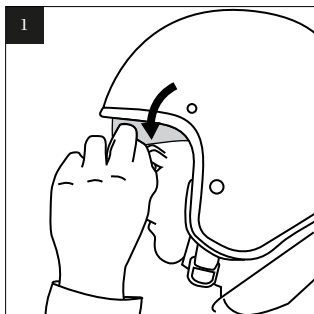

PULL DOWN TO OPEN
下拉打开

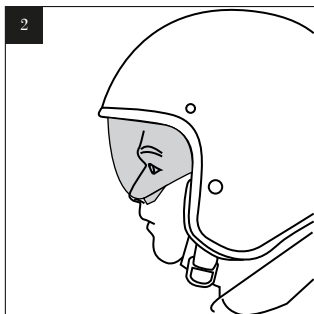

FULL OPEN POSITION
全开位置

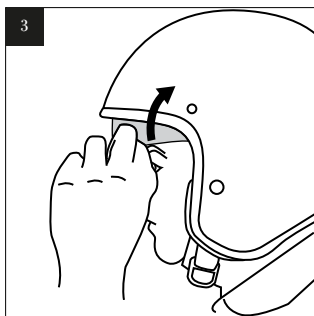

PULL UP TO CLOSE
上拉关闭

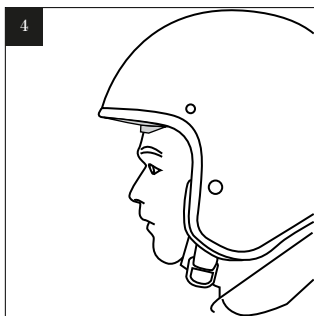

FULL CLOSE POSITION
全关位置

HOW TO REMOVE DE INNER SUN VISOR
如何卸下内侧遮阳板

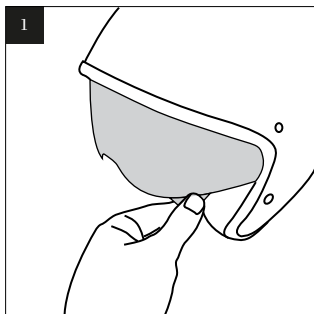

1
POSITION FULLY OPEN
全开位置

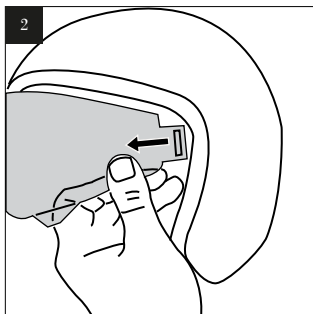

2
PULL FROM BOTH SIDES
从两侧拉

HOW TO PLACE THE INNER SUN VISOR

如何放置内遮阳板

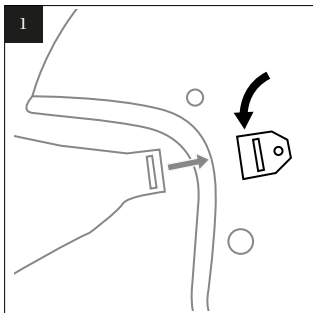

1
CHECK THE MECHANISM POSITION ON BOTH SIDES
检查两侧锁扣位置

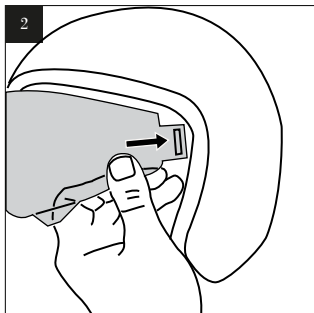

2
INSTALL IN THE SLOT ON BOTH SIDES
安装在两侧的插槽中

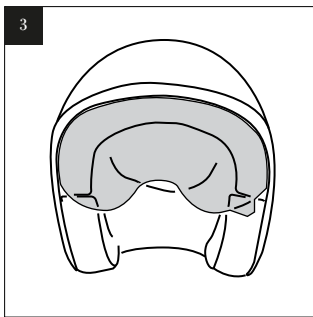

3
READY TO USE
即时可用

LINING SPECIFICATIONS

内衬规格

- EN** The lining of the helmet has the following characteristics:
- Removable (only some models),
 - Anti-allergy
 - Anti-sweat
- This lining can be removed and washable, as shown in the picture (only some models).
If for some reason this lining is damage it can be easily replaced (only some models).

- CN** 头盔内衬具有以下特点：
- 可拆卸（仅限部分型号）。
 - 抗过敏
 - 防结露

如图所示，此内衬可拆下，可水洗（仅限部分型号）。

如果由于某种原因导致内衬损坏，可轻松更换内衬（仅限部分型号）。

干



drip dry
滴干



do not wring
请勿拧干



do not tumble dry
请勿通过翻滚方式弄



do not iron
请勿用熨斗熨



hand wash
手洗



do not bleach
请勿漂白

HOW TO REMOVE THE INNER LINING
如何取下内衬

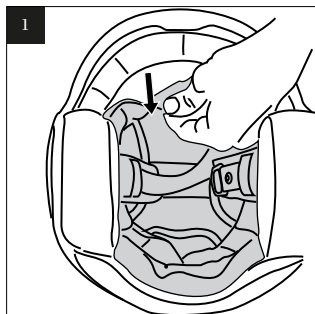

PULL THE FRONT ZONE
将前半部分拉出来

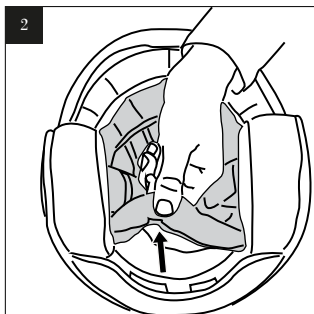

PULL THE BACK ZONE
将后半部分拉出来

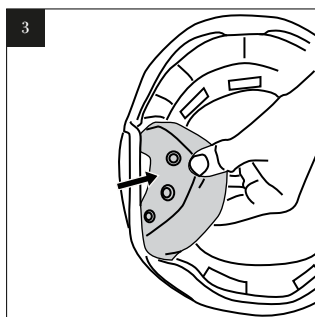

PULL FROM BOTH SIDES
从两侧拉

HOW TO PLACE THE INNER LINING 如何放置内衬

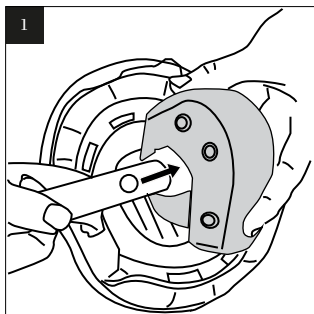

1
PASS THE BUCKLE AT THE OPENING
在开口处穿过搭扣

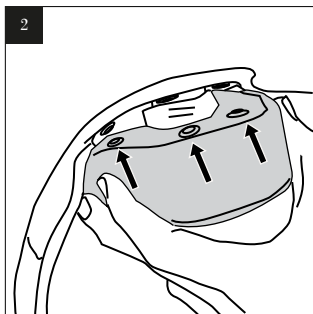

2
ALIGN THE ASSEMBLY POINTS
对齐装配点

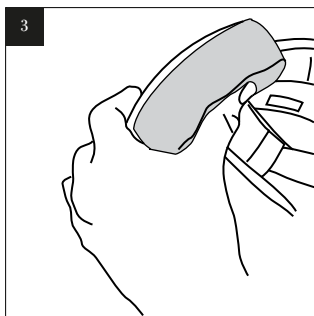

3
SNAP ALL THE POINTS
卡住所有装配点

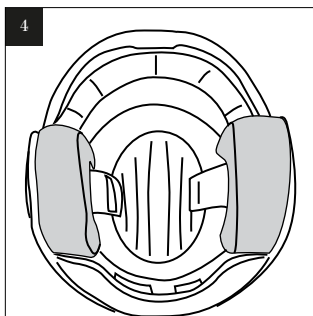

4
REPEAT THE STEPS IN BOTH SIDES
两侧均重复上述步骤

HOW TO PLACE THE INNER LINING
如何放置内衬

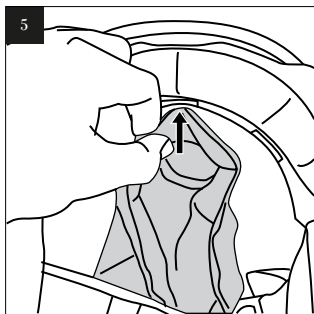

ALIGN THE FRONT WITH THE CENTRAL SEAM
将前半部分与中心接缝对齐

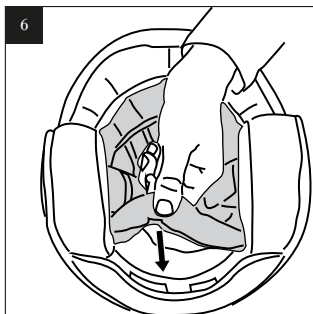

CENTER AND PUSH THE BACK
居中并将后半部分推进去

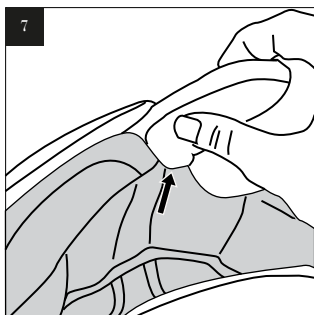

ON BOTH SIDES, PLACE UNDER THE SIDE PART
两侧均放在侧面下方

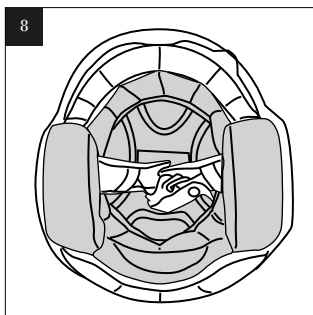

THE INNER LINING IS CORRECTLY POSITIONED
将内衬正确放置

SIZE CHART
尺寸表

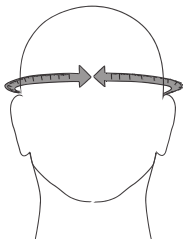

SHELL SIZE 外壳尺寸	HELMET SIZE 头盔尺码	HEAD SIZE 头围	
		CM	IN
	XS	53/54	20,9/21,3
	S	55/56	21,4/22,1
	M	57/58	22,2/22,9
	L	59/60	22,9/23,6
	XL	61/62	23,6/24,4
	XXL	63/64	24,4/25,2

EN Wrap the flexible measuring tape around your head.

CN 用软尺包围头部进行测量。

ACCESSORIES

配件

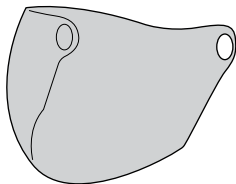

BUBBLE VISOR
泡泡形遮阳板

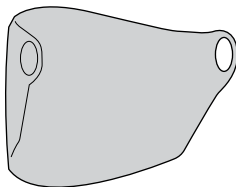

FLAT VISOR
平遮阳板

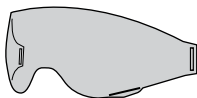

SUN VISOR
遮阳板

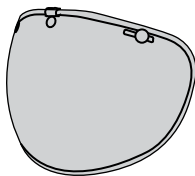

MINI BUBBLE VISOR
迷你泡泡形遮阳板



LONG PEAK
长帽檐

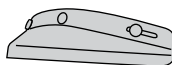
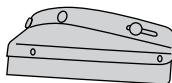

SHORT PEAK
短帽檐

HELMET CARE

头盔护理

- EN Light colors with matte finish require extra care as they are naturally more exposed to dust, fumes, compounds or other types of impurities.
THIS IS NOT COVERED UNDER WARRANTY!
Neon colors will fade when subjected to prolonged UV rays exposure.
THIS IS NOT COVERED UNDER WARRANTY!
We are not liable for any damage, loss or detriment resulting from faulty assembly of any accessory.

- CN - 带有哑光表面的浅色组件需要格外小心，因为它们必然更容易受到灰尘、烟雾、化合物或其他类型杂质的影响。这种情况不属于保修范围！霓虹灯如长时间暴露在紫外线下会褪色。这种情况不属于保修范围！我们不对因任何附件安装错误而导致的任何损坏、损失或伤害负责。



- EN Do not expose the helmet to any type of liquid solvent;

- CN - 不可让头盔接触任何类型的液体溶剂；



- EN The helmet should be handled with care. Leaving it drops can damage the painting as well as reduce their characteristics of protection.
THIS NOT COVERED UNDER WARRANTY!

- CN - 应小心对待头盔。摔落头盔可损坏喷漆并降低其保护性能。这种情况不属于保修范围！



- EN Keep the helmet in a safe place (not hang on the mirror of motorcycle or other support than can damage the lining). Do not carry your helmet on the biker or in the arm while driving.

- CN - 将头盔放置于安全处（不可悬挂在摩托车后视镜上或其它可损坏内衬的支座上）。在驾驶摩托车时不得将头盔带在身上或抱在怀里。

HELMET CARE

头盔护理



EN Always use the helmet in the proper position, using the buckle to adjust to the head;

CN - 使用头盔时，始终佩戴于恰当的部位，使用锁扣调整在头部的位置



EN In order to maintain trouble free operation of the visor, it is advisable to periodically lubricate the mechanisms and rubber parts around the visor with silicone oil. The application may be made with a brush or with the help of a cotton swab.

Apply sparingly and remove the excess with a dry clean cloth. This proper care will maintain the softness of the rubber seal and will dramatically increase the durability of the visor fixing mechanism.

CN - 为了保持面甲无故障发挥作用，建议定期用硅油润滑面甲周围的机构和橡胶部件。可用刷子或棉签上油。少量涂抹，然后用干净的干布擦掉多余硅油。这种适当的保养可保持橡胶密封件的柔软性并将大大增加面甲固定机构的耐久性。

EN This high quality helmet is made with the most advanced European technology. The helmets are technologically advanced for the motorcycle rider's protections, which are made for motorcycle riding only. This helmet specifications is subject to change without notice.

CN 这款高质量头盔采用最先进的欧洲技术制造而成。

头盔在保护摩托车骑手方面具有技术先进性，

仅针对摩托车骑行而制。这款头盔的技术规范如有更改，恕不另行通知。

HELMETS FOR LIFE



Nexxpro Fábrica de Capacetes S. A.
Zona industrial de Amoreira da Gândara,
lote nº113780-024 Amoreira da Gândara,
Anadia - PORTUGAL