

L A U R A H A M M E T T  
L I V I N G



MILLER PENDANT

Contemporary Lighting Collection

# MILLER PENDANT

Contemporary Lighting Collection

## Range Description

Featuring rich metalwork and meticulously chosen materials, our range of pendants offer intricate details and exquisite quality. Textural interest is paramount, allowing the beauty of materials to shine through, creating pendants destined to illuminate your space with timeless beauty.

## Product Description

The unique, biomorphic shape of this modern pendant is expertly crafted from one piece of rich alabaster, taking the reflective mood of a shaded light but encapsulating in a very solid design, with its gently undulating curves creating a sculptural aesthetic. The double layer elevates this stunning centrepiece, allowing different qualities of light to radiate upwards through the double cup, casting an ambient pool of light. Floating in place on an antique brass stem, the quiet splendour of the Miller Pendant is guaranteed to add dramatic appeal.

Available in 2 sizes.

## Dimensions

### Size 1

Dia 800mm  
Overall height 550mm

### Size 2

Dia 800mm  
Overall height 650mm

## Materials & construction

Alabaster, Bronze

## Care instructions

Wipe clean with a soft, dry cloth. Avoid harsh chemicals as they may damage the finish.



---

## Finishes

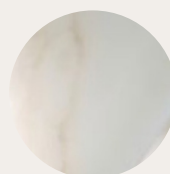

Alabaster



Bronze

# MILLER PENDANT

Contemporary Lighting Collection

Size 1



Size 2



# LIGHTING INSTALLATION GUIDE

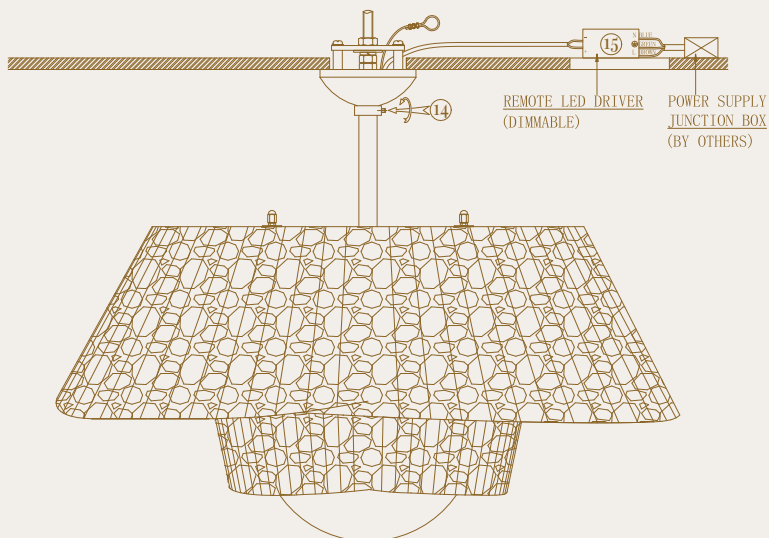
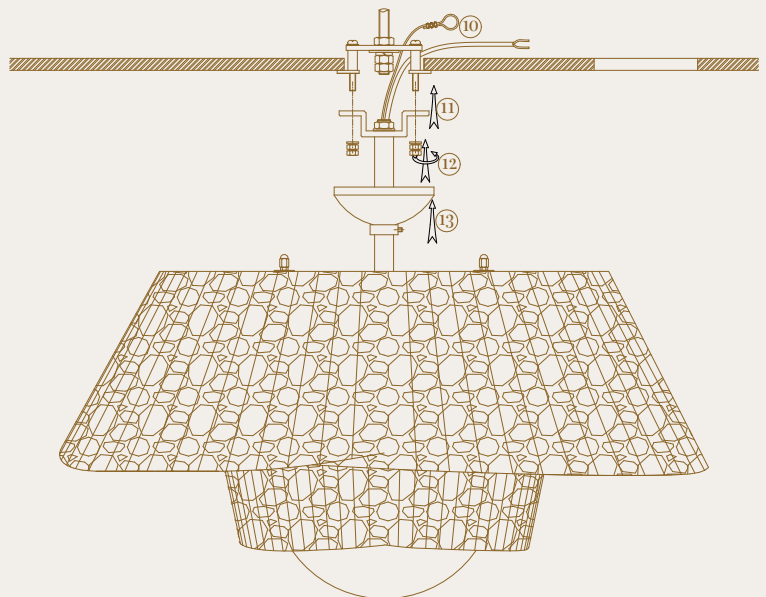
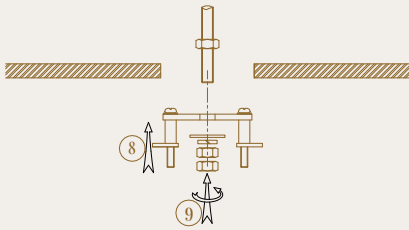
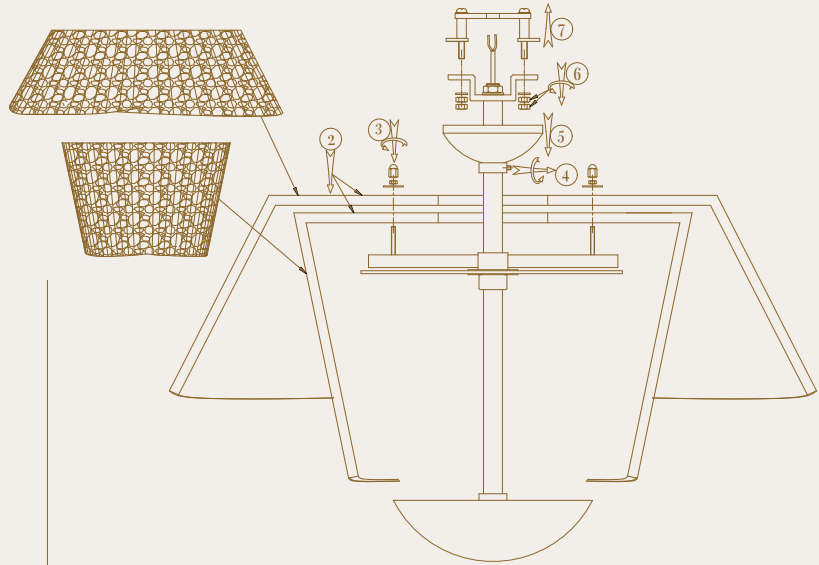
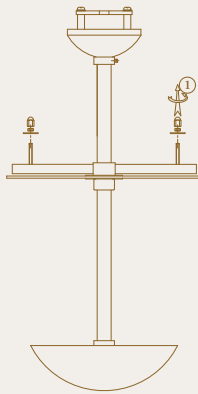

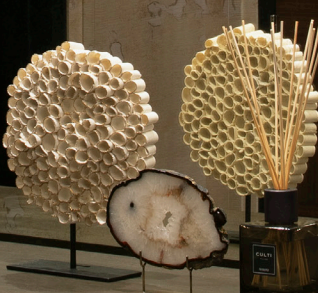



Laura Hammett Living is a luxury homeware brand founded by Laura Hammett, Creative Director of the eponymous London-based interior, architecture and design studio, founded in 2008. Emerging from over 20 years of interior design expertise and a lifelong passion for creating beautiful homes, Laura Hammett Living was officially launched in 2023 and offers a carefully crafted range of custom-made furniture, lighting, case goods and accessories, each embodying Laura's refined aesthetic.

Both the Contemporary & Modern Heritage collections are a testament to Laura's passion fusing timeless design with heritage quality. Every item in the collection is thoughtfully designed by Laura and exemplifies her exceptional eye for detail, enduring quality and commitment to craftsmanship and timeless design.



[www.laurahammettliving.com](http://www.laurahammettliving.com)  
[hello@laurahammettliving.com](mailto:hello@laurahammettliving.com)