

# *Mustek* energy

## Mustek Limited Group

---

 322 15<sup>th</sup> Road Randjespark Midrand  
South Africa

 +2711 237 1000

 +2711 314 1801

 [www.mustek.co.za](http://www.mustek.co.za)

# Mustek Energy

## PRODUCT OVERVIEW

The product applies to diversified loads because its digital design, pure sine wave output and excellent overcurrent protection can withstand the loads with a large starting current; the product is provided with independent solar three-stage charge management to improve charge efficiency of its battery and realize a longer life; the product provides universal 5VDC USB output port and 12VDC output to be widely applied to small solar power generation occasions including families, schools, street monitoring, forest monitoring, industrial and mining enterprises, frontier defense, sea islands, pasturing areas, etc.



## MAIN FEATURES

- Pure sine wave output;
- Mains mode/battery mode can be set;
- AVR voltage regulator function;
- Utility power charging function + solar charging function;
- LCD+LED display device parameters;
- 5VDC-USB output, 12VDC port output;
- Inverter overcharge, discharge protection, protect battery life;
- Built-in power frequency ring transformer, low no-load loss inverter stability;
- Overcharge protection, discharge protection, overload protection, short circuit protection and other alarms



### Solar system connection

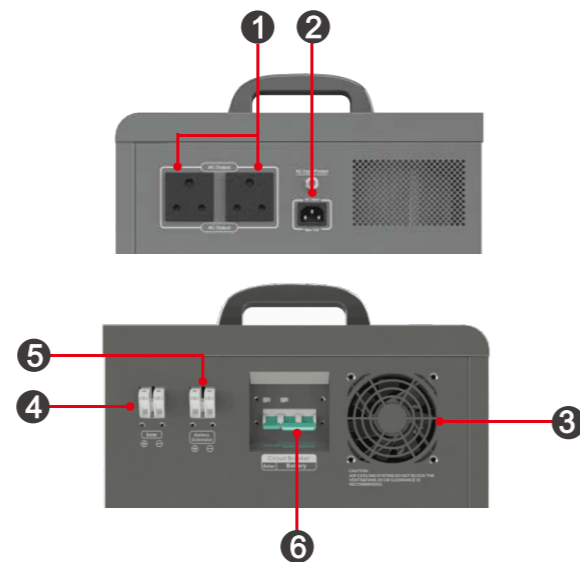
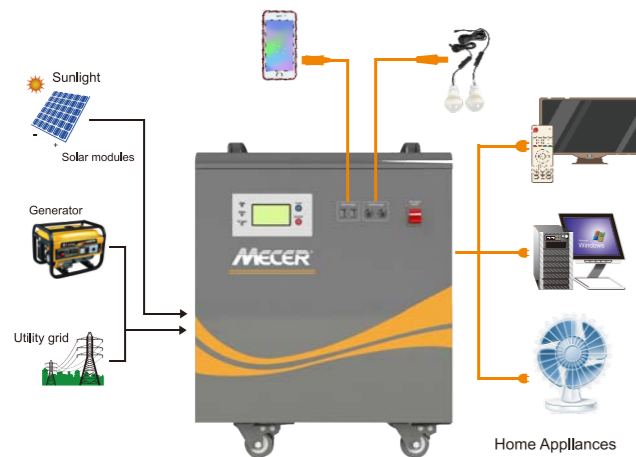

## TECHNICAL INDEXES

Model:	SOL-I-BB-M1	SOL-I-BB-M2
Inverter		
Battery voltage	12V	24V
In-built battery specification	100AH/12Vx1	100AH/12Vx2
Battery Type	Lead Acid (Gel)	
Rated power	1000W	2000W
Output voltage	220VAC	
Output frequency	50/60Hz	
Output waveform	Pure Sine Wave	
Input voltage range	145-275VAC	170-275VAC
Input frequency	45-65Hz	
Solar input		
Maximum photovoltaic voltage	≤25V	≤100V
PV input range voltage	10-25V	35-100V
Rated charge current	PWM 30A	MPPT 30A
Maximum PV Input Power (Wp)	360Wp	800Wp
Overcharge protection voltage	14.2V	29V
Overcharge recovery voltage	14.0V	-
Float charge voltage	13.8V	27.6V
DC output		
High-voltage protection	16V	32V
High voltage recovery	15.2V	29V
Low voltage recovery	13V	26V
Low voltage protection	11.3V	22.6V
5VDC USB output port	2 units/MAX 2A	
12VDC output port	2DC ports/MAX 2A	
Starting temperature of the exhaust fan	> 45°C	
Ambient temperature for operation	-20 - +50°C	
Ambient temperature for storage	-25 - +55°C	
Operation/storage conditions	0-90% (no condensation)	
External dimensions: DxWxH (mm)	419x274x494	434x394x558
Packing dimension: DxWxH (mm)	510x350x510	535x485x600
Net Weight (kg)	46	87
Gross Weight (kg)	48.3	92

## Product Information

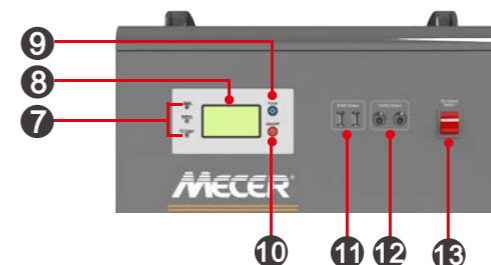

- 1. AC Output
- 2. AC Input
- 3. Smart Cooling Fan
- 4. Solar PV Input
- 5. Battery Extension
- 6. Battery Switch
- 7. LED Indicator
- 8. LCD Display
- 9. Function Buttons
- 10. ON/OFF Buttons
- 11. 5VDC Output
- 12. 12VDC Output
- 13. DC Output Switch