

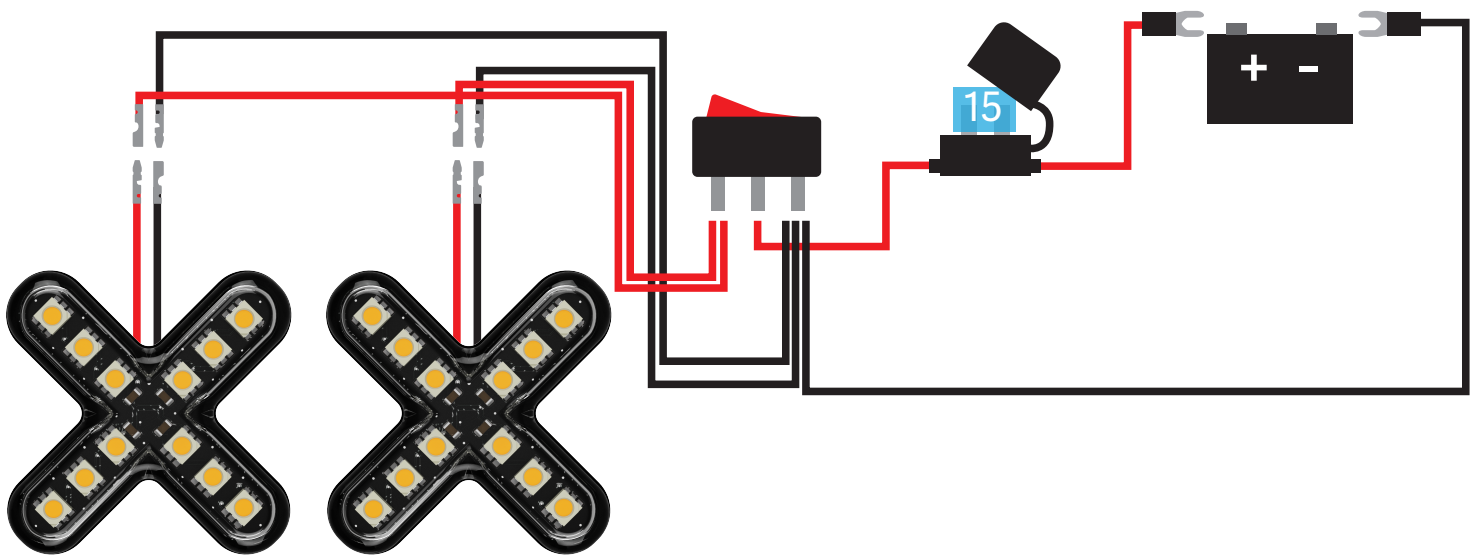

ROX Light Wiring Guide

Thank you for purchasing the Mox Motors™ ROX Accessory Light. The below instructions provide an example of how to wire your new lights. If you require other help or suggestions please feel free to reach out to us at www.moxmotors.com or via Instagram.

Our ROX lights run at standard vehicle voltages of 12.4V but are capable of handling a range of 5V-30V. Output will vary depending on the voltage range provided, they are optimized for 12V ~0.250A (+/- 0.05A). All lights should be wired in parallel. If you use a switch like in the below example setup make sure it is capable of handling the total current of all the lights in your use case. Each light has a threaded back for using a standard M5 x 0.8 bolt to mount to your desired location. Please make sure not to over tighten the bolts to prevent stripping out the threads.

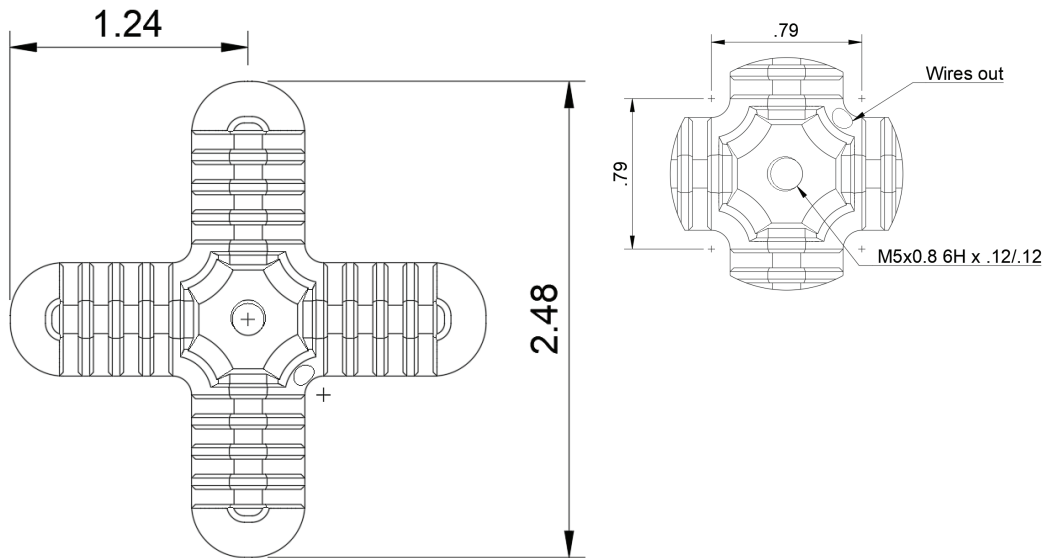

Determine how many ROX lights you are wiring, this will determine the wire gauge and fuse size for inline fuses. For example a standard 14 AWG wire is limited to around 15 amps. Make sure not to overload your wiring.