

CHILD INFORMATION
(KEEP WITH CAR SEAT AT ALL TIMES IN CASE OF EMERGENCY)

NAME:

.....

DATE OF BIRTH (DD/MM/YYYY):

.....

ADDRESS:

.....

.....

ALLERGIES/MEDICAL CONDITIONS:

.....

.....

EMERGENCY CONTACT 2:

NAME:

.....

PHONE NUMBER:

.....

EMERGENCY CONTACT 2:

NAME:

.....

PHONE NUMBER:

.....

COZY **N** SAFE®

INSTRUCTION FOR USE

Congratulations on your purchase of the child seat. Please read this instruction manual carefully before use. If you have any questions concerning the use of this child seat, please do not hesitate to contact us.

CHILD RESTRAINT EST226

EZFIX



GROUP I,II,III

SUITABLE FOR CHILDREN

9 months to 12 years old

9~36KG

www.cozynsafe.com

Cozy N Safe
Oxford Street, Wolverhampton,
West Midlands, WV14 7DP, UK
Tel: +44 (0) 1902 494905
Email: enq@cozynsafe.com

Contents

1. Vital information-READ NOW.....	4-5
2.Safety instruction.....	6
3.Using safety seat in this way.....	6
4.Parts and interior equipment.....	7
5.Scope of application for children.....	8
6.Steps of backrest and base assembly.....	9-10
7.Using the buckle.....	10
8.How to place the safety seat in the vehicle	11
9.Adjusting the harness.....	11
10.How to use the Ezfix Guides	12
11. 9-25kg Installation with 5-point harness	
11.1 Installing the safety group I (Installation 1)	13-16
11.2 Installing the safety group I (Installation 2)	17-21
11.3. Installing the safety group II	21-27
12.Installing the safety group II,III	27-30
13.Unlock Ezfix.....	30
14.Removing the cover.....	31-34
15.Maintenance and cleaning	
17.1 Daily maintenance.....	34
17.2 Washing instruction.....	34
16.List of approved cars.....	35-38

PRODUCT DESCRIPTION

GROUP	METHOD OF INSTALLATION	TYPE
I,II 9-25KG 5-point harness	EZFIX +TOP TETHER	UNIVERSAL
	3-point safety belt+ EZFIX +TOP TETHER	SEMI- UNIVERSAL
I,II,III 9-36KG	3-point safety belt	UNIVERSAL
II,III 15-36KG	3-point safety belt+ EZFIX	SEMI-UNIVERSAL

Notice regarding Universal category (Group I II III)

1. This is a “Universal” child restraint. It is approved to Regulation No. 44, 04 series of amendments, for general use in vehicles and it will fit most, but not all, car seats.
2. A correct fit is likely if the vehicle manufacturer has declared in the vehicle handbook that the vehicle is capable of accepting a “Universal” child restraint for this age group.
3. This child restraint has been classified as “Universal” under more stringent conditions than those which applied to earlier designs which do not carry this notice.
4. If in doubt, consult either the child restraint manufacturer or the retailer.

Notice regarding Semi-universal category (Group II III)

This child restraint is classified for "(Restricted/Semi-universal)" use and is suitable for fixing into the seat positions of the following cars:

CAR	FRONT	REAR	
Refer to vehicle list	Outer	Centre	
	Yes	Yes	NO

Seat positions in other cars may also be suitable to accept this child restraint. If in doubt, consult either the child restraint manufacturer or the retailer.

Only suitable if the approved vehicles are fitted with 3 point with retractor safety-belts, approved to UN/ECE Regulation No. 16 or other equivalent standards.

Notice regarding Universal ISOFIX child restraint system (in Group I)

1. This is an ISOFIX CHILD RESTRAINT SYSTEM. It is approved to Regulation No. 44, 04 series of amendments for general use in vehicles fitted with ISOFIX anchorages systems.
2. It will fit vehicles with positions approved as ISOFIX positions (as detailed in the vehicle handbook), depending on the category of the child seat and of the fixture.
3. The mass group and the ISOFIX size class for which this device is intended is: Group I, B1

1. Vital information-READ NOW

For your child's safety, please read these instructions carefully before use and keep them for future reference. Failure to follow the instructions contained in this manual could result in serious injury to your child.

1. This child safety seat can only be used with the harness for children 9kg to 25 kg in weight (group I : 9 - 18kg ; group II:15-25 kg ; group II,III:15-36 kg).
2. This instruction manual must be kept in the allocated space on the car seat for its life period.
3. Do not use this child safety seat at home. It has not been designed for home use and should only be used in your car.
4. Never leave your child unattended in the child restraint system even for a short time.
5. The child safety seat should be changed when it has been subject to violent stresses in an accident.
6. This child restraint should be securely belted in the vehicle even when not in use. In a crash or sudden stop, an unsecured child safety seat may injure other occupants.
7. Always make sure that any straps holding the seat restraint to the vehicle are be tight, any straps restraining the child should be adjusted to the child's body, and check that the straps are not twisted.
8. **IMPORTANT!** Ensure that any lap straps are worn low down, so that the pelvis is firmly engaged.
9. Do not use any load bearing contact points other than those described in the instructions and marked on the child restraint, when in doubt, please contact the child restraint manufacturer.
10. Any luggage or other objects liable to cause injuries in the event of a collision should be properly secured.
11. The rigid items and plastic parts of a child restraint must be so located and installed that they are not liable, during everyday use of the vehicle to become trapped by a moveable seat or in the door of a vehicle.

12. Your child should always be fastened in the car seat to prevent injury.
13. It is dangerous to make any alterations or additions to the device without the approval of the competent authority. It is dangerous to not closely follow the installation instructions provided by the child restraint manufacturer.
14. This child safety seat is designed for children from 9 to 36 kg. Never overload the child safety seat with more than one child or with other loads.
15. The child restraint must not be used without the cover.
16. The seat cover should not be replaced with any other than the one recommended by the manufacturer, because the cover constitutes an integral part of the restraint performance.
17. Before you adjust any movable or adjustable parts of your child safety seat, you must remove your baby from the child safety seat.
18. The child safety seat should be kept away from sunlight if the seat is not provided with a textile cover, otherwise it might become too hot for the child's skin.
19. Never use a second-hand product, as you can never be certain what has happened to it.
20. **Notice:** Do not use in any configuration not shown in the instructions.
21. Please identify unsatisfactory position of the adult safety belt buckle relative to the correct point of the child safety seat, if in doubt, please contact the child seat manufacturer.
22. Please also read the car manufacturer's handbook before use.
23. **Important!** Before using the EZFIX child restraint system, please ensure you read the manual or vehicle manufacturer handbook regarding the EZFIX / ISOFIX points.

2. Safety instruction

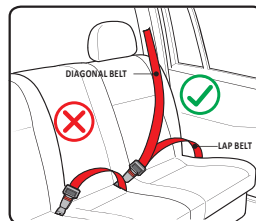

Only suitable if the approved vehicles are fitted with 3 point safety-belts, approved to UN/ECE Regulation No.16 or other equivalent standards.

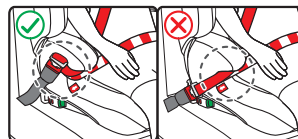

NOTICE: If the buckle strap of car seat is too long, the child restraint system can not be installed firmly. It is very dangerous. If any doubt, please consult the child restraint system manufacturer.

3. Using safety seat in this way

Forward facing traffic direction	Correct
Back facing traffic direction	Error
Vehicle is only fitted with 2-point safety belt	Error
Vehicle is fitted with 3-point safety belt	Correct
Seat beside the driver	Error
Rear seat	Correct
Rear middle seats Three-point Belt	Correct

3.1 Please carefully implement the Country Traffic Safety Regulations

- Do not install the child safety seat on the front seat with an airbag.
- Please read the instruction manual carefully on how to use the airbag.

NOTICE

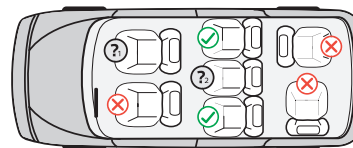



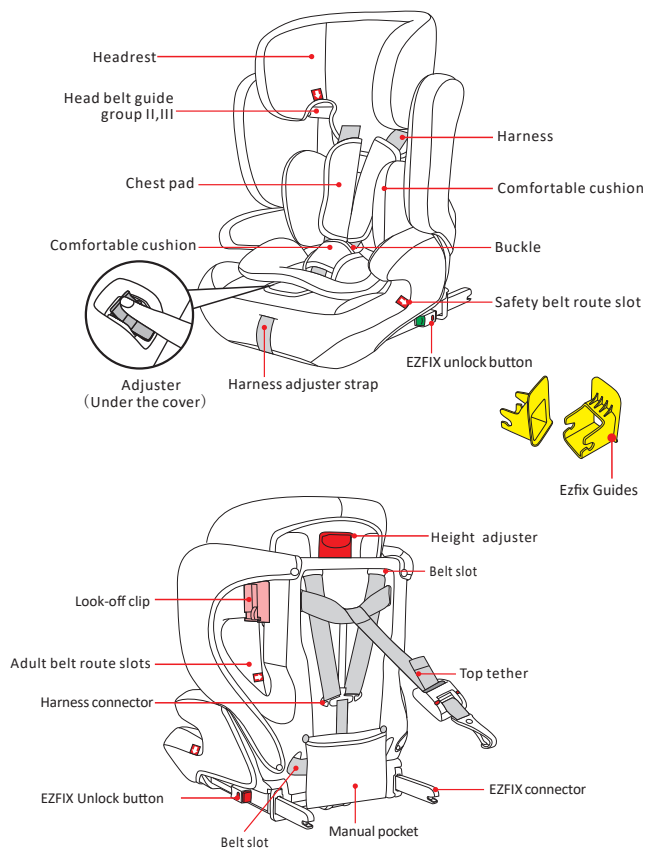

- ✓ You can install in this position
- ✗ Unable to install in this position
- ❓ Do not install the child safety seat in the front seat with air bag.
- ❓ Only with the three point safety belt in this location.

4. Parts and interior equipment



 : Safety belt routing label

5. Scope of application for children

<p>GROUP I</p> <p>Suitable for children who's weight is 9-18kgs, approximately 9 months - 4 years old.</p>	 <p>Installation 1: Ezfix+top tether Securing the child: 5-point harness</p>
<p>GROUP II</p> <p>Suitable for children who's weight is 15-25kgs, approximately 3 - 7 years old.</p>	 <p>Installation 2: 3-point safety belt Securing the child: 5-point harness</p>
<p>GROUP II,III</p> <p>Suitable for children who's weight is 15-36kgs, approximately 4 - 12 years old.</p>	 <p>Installation 1: 3-point safety belt + Ezfix Securing the child: 3-point safety belt</p>
	 <p>Installation 2: 3-point safety belt Securing the child: 3-point safety belt</p>

6. Steps of backrest and base assembly

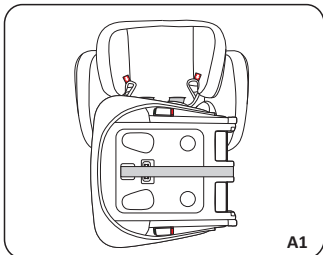

Step 1: Slide the seat out of the box

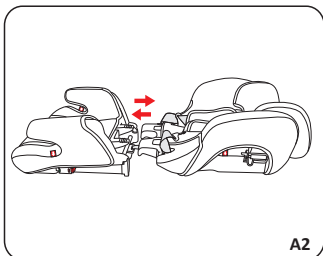

Step 2: Align the base and backrest in a straight line.

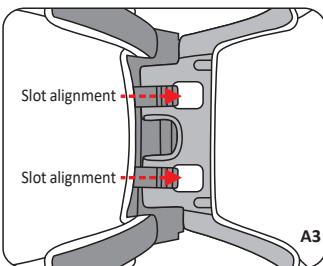

Step 3: Place the backrest hooks inside the base securely.

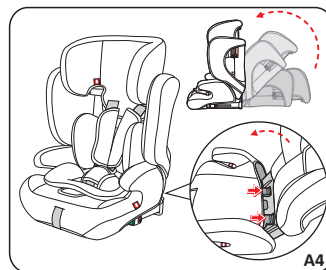

Step 4: Gently keep pressure on hooks as you lift the backrest up.

WARNING: DO NOT FORCE MAY CAUSE DAMAGE.

7. Using the buckle

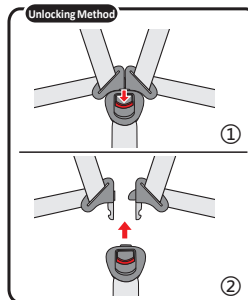
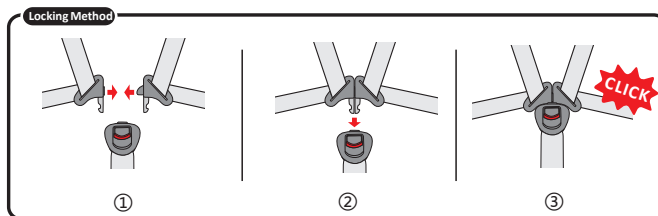

Locking Method :
Align the left and right buckle tongues so that they form one tongue and insert into the buckle until you hear a "Click".

Unlocking Method :
Press the red button of the buckle downwards, the two metal sections will pop up.

8. How to place the safety seat in the vehicle

⚠ Note: In order to keep safe, please put the restraint system on the back seat, and ensure that the backrest is placed as close as possible to the car seat.



9. Adjusting the harness

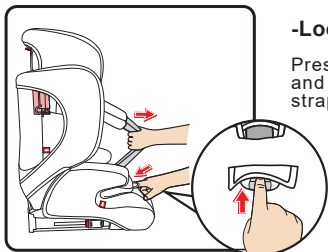

-Loosening the shoulder harness

Press the adjuster button under the cover and at the same time pull both shoulder straps forward.

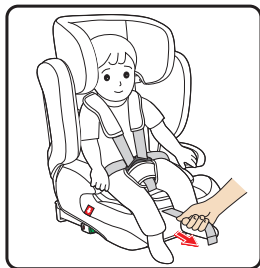

-Tightening the harness

Pull the adjuster strap until the harness is fully tightened.

10. How to use the Ezfix guides

In order to lock the Ezfix connector to the steel point successfully, please use the Ezfix guides.

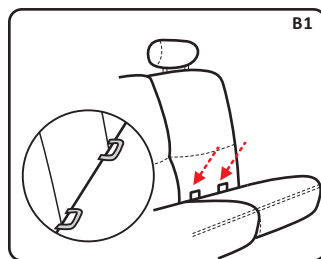

Step 1: Locate the Ezfix connection points in the car.

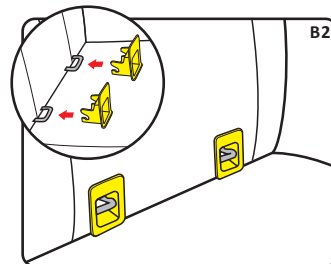

Step 2: Insert the Ezfix guides into the Ezfix connection points.

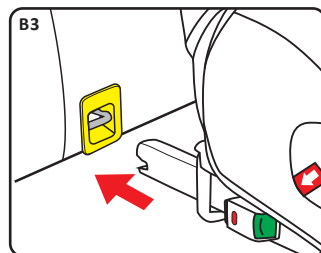

Step 3: Push the child seat in the direction above (B3) and insert the Ezfix connectors into the Ezfix guides (B3, B4). Check that the Ezfix locking system turns green to ensure that it is locked and make sure that the child seat is firmly connected (B4).

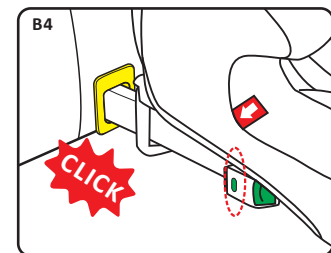

11. 9-25kg Installation with 5-point harness

11.1 Installing the safety group I (Installation 1)

This is suitable for children weighing 9 - 18kg, approximately 9 months to 4 years old.

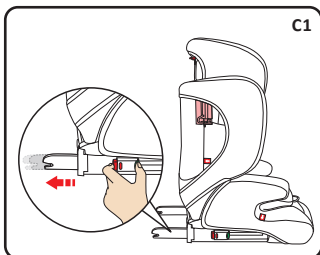

C1



a1. Install the baby car seat

Installation: Ezfix+top tether
Securing the child: 5-point harness

Step 1: Press both buttons and push out the Ezfix connector

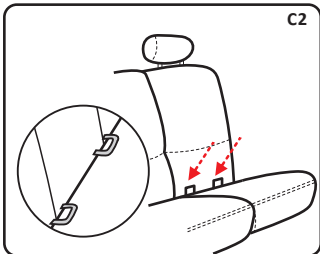

C2

Step 2: Locate Ezfix connection points in the car.

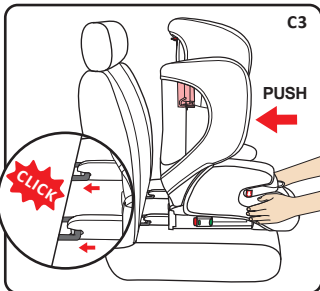

C3

Step 3: Push the child seat in the direction illustrated and insert the Ezfix connectors into the Ezfix guides (C3)

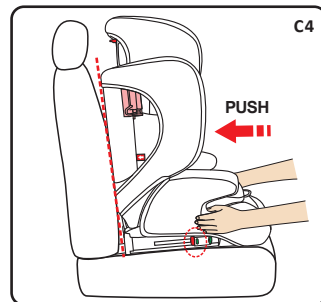

C4

Step 4: Ensure that the Ezfix turns to green and make sure child seat is firmly connected (C4).

NOTICE: Child safety seat must be against the car seat firmly.

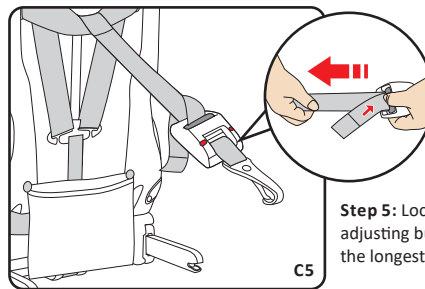
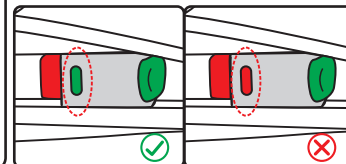

C5

Step 5: Locate the top tether and press the adjusting button. Adjust the top tether belt to the longest it can go (C5).

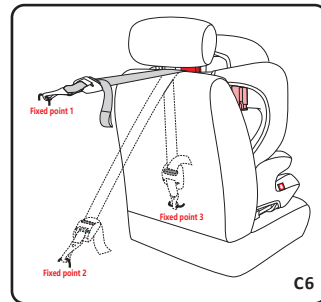

C6

Step 6: Connect top tether with the fixing point on the car (C6).

NOTICE: Please consult your vehicle handbook as not all top tether points are located in the same area. The most common fixed points are illustrated in C6.

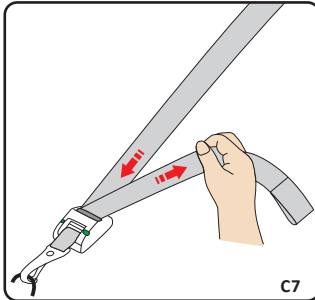

Step 7: Pull the belt of the top tether until the adjuster shows green(C7).
⚠ Notice: Top tether is only for group I and group II.

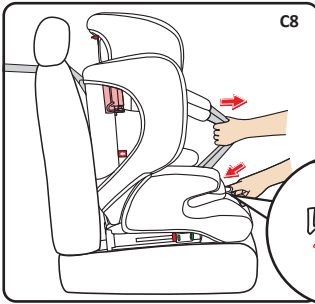
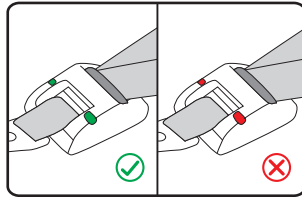

a2. Securing the child in the safety car seat.
Step 1. Loosen the harness(C8)

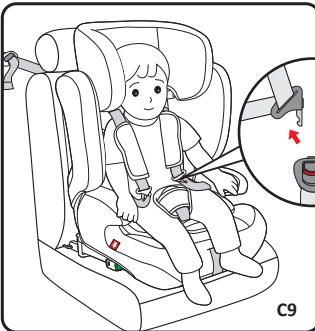

Step 2: Release the buckle, and put the child into the safety car seat(C9).

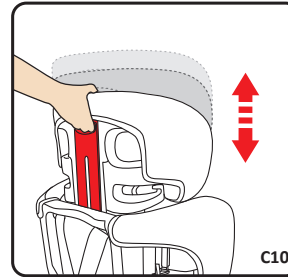

Step 3: Pull the height adjuster to adjust the height of the harness and the headrest according to the child's height(C10).

⚠ Note! The height for the harness is adjusted by lifting the headrest(C10).

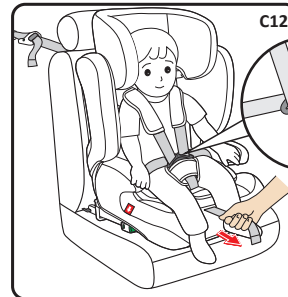
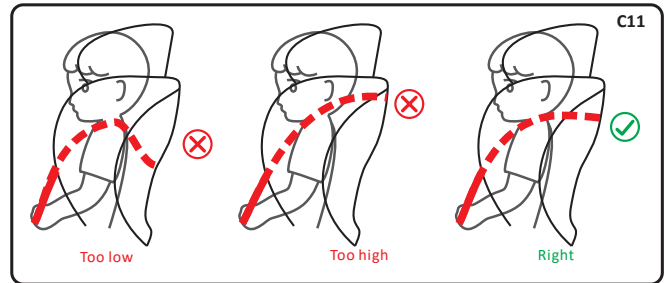

Step 4. Align the left and right buckle tongues so that they form one tongue and insert into the buckle until you hear a "Click"(C12).

Step 5: Pull the shoulder straps upwards to remove the slack from the lap sections of the harness then pull the adjuster strap until the harness is fully tightened(C12).

11.2 Installing in safety group I (Installation 2)

This is suitable for children of weight 9-18kg, 9 months - 4 years approximately.

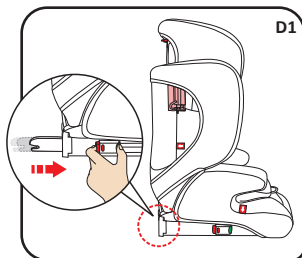

D1

b1. Install the baby car seat

Installation: 3-point safety belt
Securing the child: 5-point harness

Step 1: Retract the Ezifix back into the booster seat (D1).

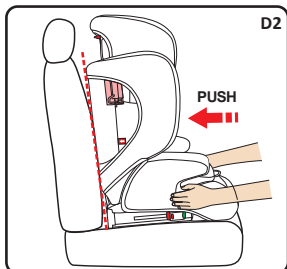

D2

Step 2: Put the Child safety seat against the car seat (D2)

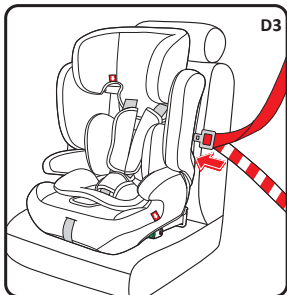

D3

Step 3: Pull out the diagonal belt together with lap belt and pass them through the belt route slot of backrest (D3).

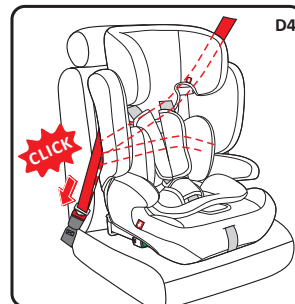

D4

Step 4: Insert the belt into the buckle and you will hear an audible "Click" (D4).

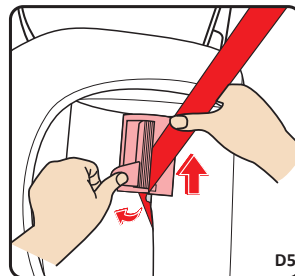

D5

Step 5: Clip the diagonal belt into the locking clip. (D5, D6, D7).

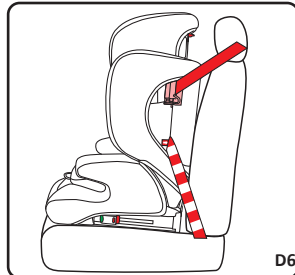

D6

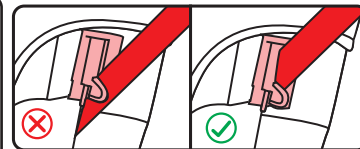

⚠ Note! Please refer to the following picture, to ensure to clip the safety belt into the locking clip in the correct way. (D6, D7).

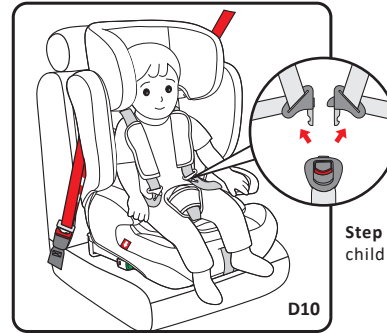
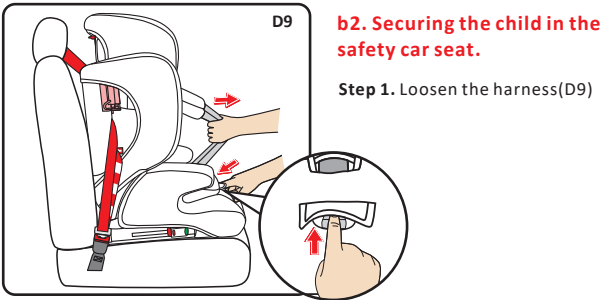
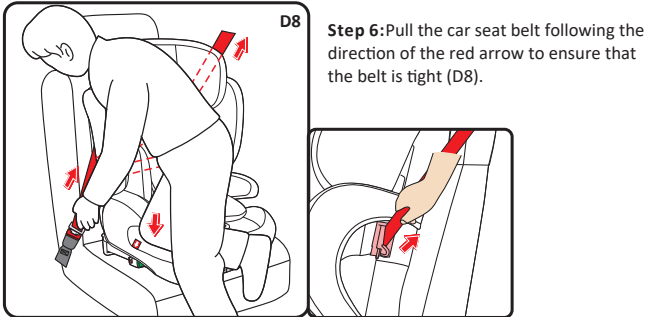
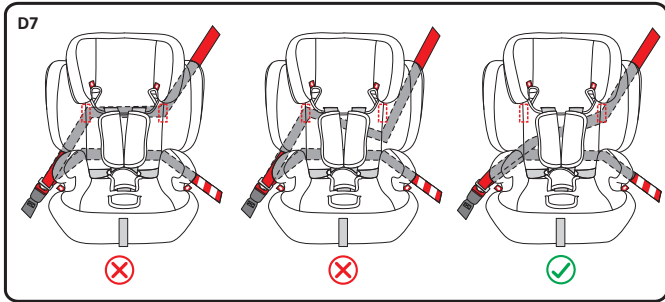

Step 2: Release the buckle, and put the child into the safety car seat (D10).

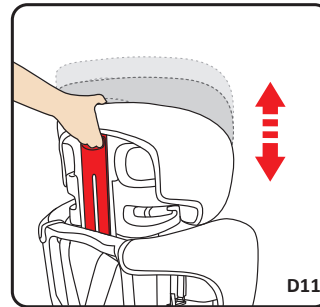

Step 3: Pull the height adjuster to adjust the height of the harness and the headrest according to the child's height (D11).

⚠ Note! The height for the harness is adjusted by lifting the headrest (D12).

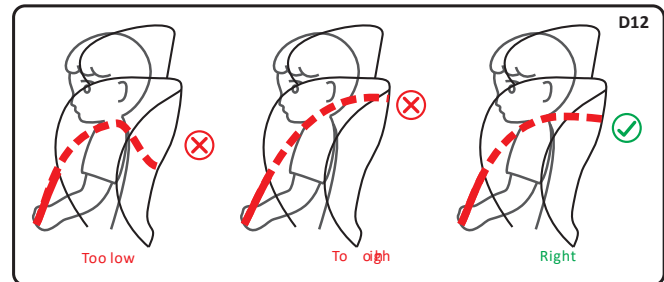



Step 4. Align the left and right buckle tongues to one tongue and insert into the buckle until you hear a “Click”(D13).

Step 5: Pull the shoulder straps upwards to remove the slack from the lap sections of the harness then pull the adjuster strap until the harness is fully tightened(D13).

11.3. Installing in safety group II

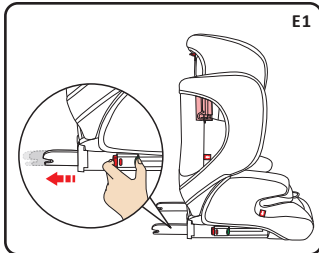

This is suitable for children of weight 15-25kg, 3-7 years approximately.

c1. Install the baby car seat

Installation: Ezfix+top tether
+3-point safety belt
Securing the child: 5-point harness

Step 1: Press both button and push out the Ezfix connector

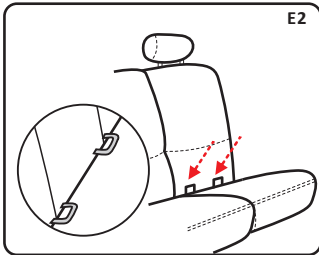

Step 2: Locate the Ezfix connection points in the vehicle.

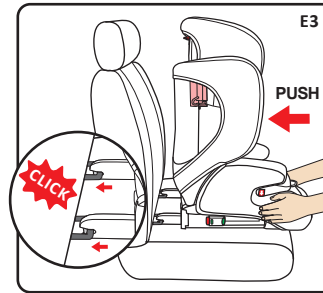

Step 3: Push child seat following the direction illustrated, until the Ezfix connectors are completely locked with the connection points of the vehicle (E3)

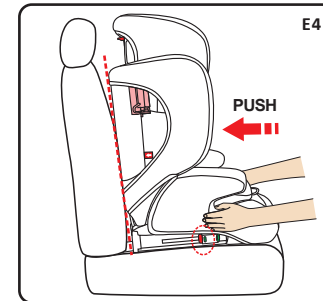

Step 4: Check to ensure that the Ezfix locking system turns to green and make sure child seat is firmly connected(E4).

NOTICE: Child safety seat must be firmly against the vehicle seat.

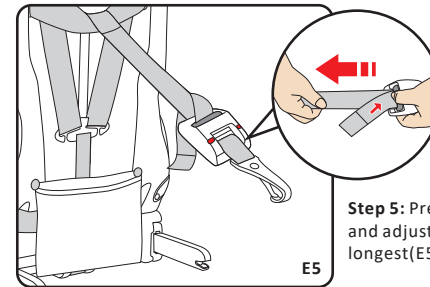
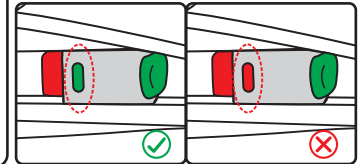

Step 5: Press the adjusting button and adjust the belt of top tether to the longest(E5).

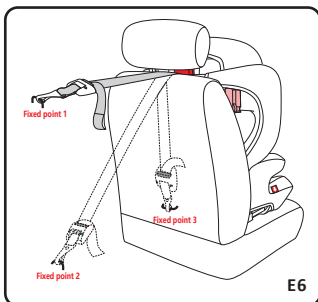

Step 6: Connect top tether with the fixing point on the car(E6).
Notice: Please consult your vehicle handbook as not all top tether points are located in the same area. The most common fixed points are illustrated in E6.

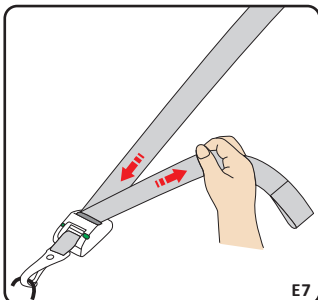

Step 7: Pull the belt of top tether until the adjuster shows green(E7).
▲ Notice: Top tether is only for group I and group II.

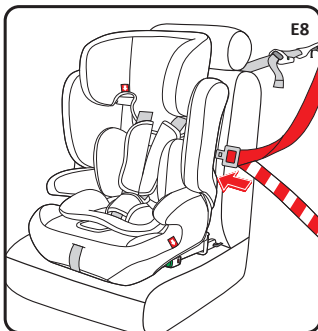
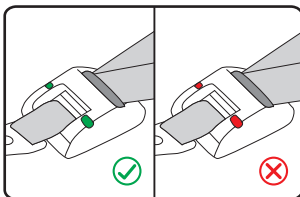

Step 8: Pull out the diagonal belt together with lap belt and pass them through the belt route slot of backrest (E8).

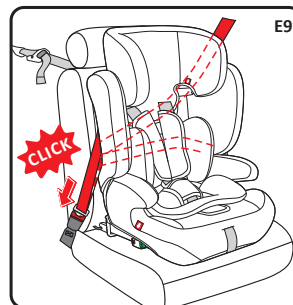

Step 9: Insert the belt into the buckle and you will hear an audible "Click" (E9).

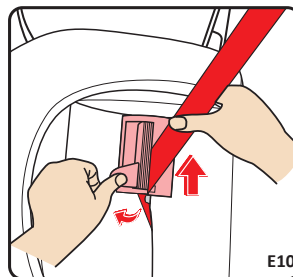

Step 10: Clip the diagonal belt into the locking clip.(E10,E11,E12).

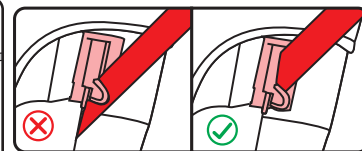
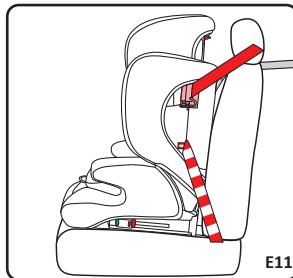

▲ Note! Please refer to the following picture, to ensure to clip the safety belt into the locking clip in the correct way. (E10, E11).

E12

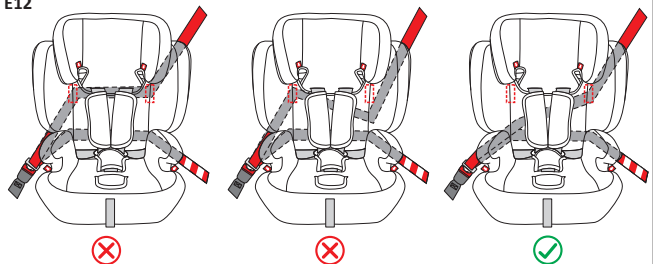

E13

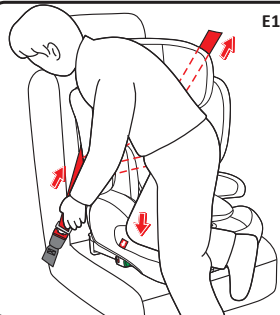

Step 11: Pull the car seat belt following the direction of the red arrow to ensure that the belt is tight (E13).

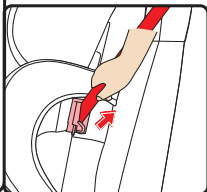

E14

c2. Securing the child in the safety car seat.

Step 1: Loosen the harness (E14)

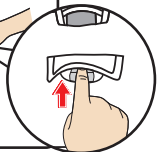
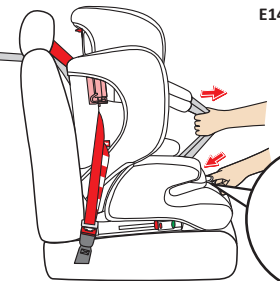

E15

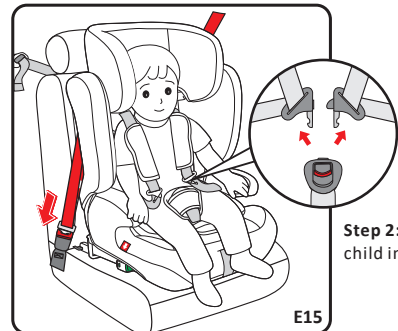

Step 2: Release the buckle, and put the child into the safety car seat (E15).

E16

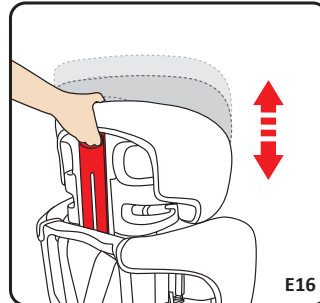

Step 3: Pull the height adjuster to adjust the height of the harness and the headrest according to the child's height (E16).

▲ Note! The height for the harness is adjusted by lifting the headrest (E17).

E17

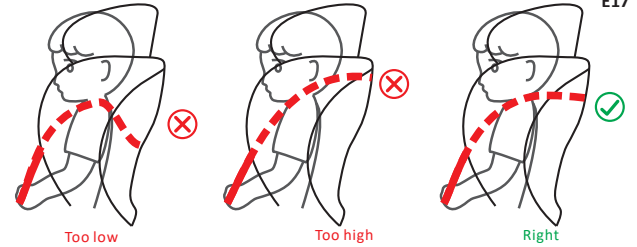

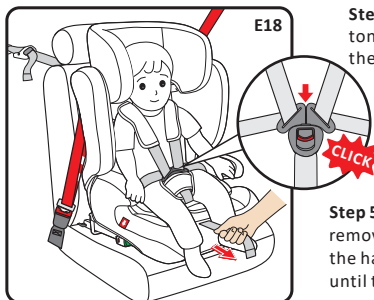

Step 4. Align the left and right buckle tongues to one tongue and insert into the buckle until you hear a “Click”(E18).

Step 5: Pull the shoulder straps upwards to remove the slack from the lap sections of the harness then pull the adjuster strap until the harness is fully tightened(E18).

12. Installing in safety group II, III

This is suitable for children of weight 15-36kg, 4-12 years approximately.
Group II,III installation can choose to use EZFIX or not.

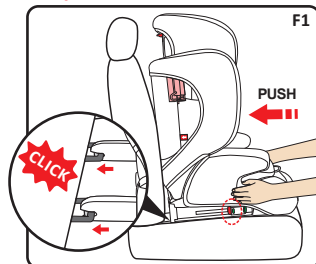

1.Using EZFIX:

Connect EZFIX with anchorage point on the vehicle seat(F1)

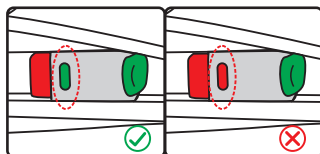

2.Not using EZFIX

Hide EZFIX in the booster. Put the seat against the car seat(F2)

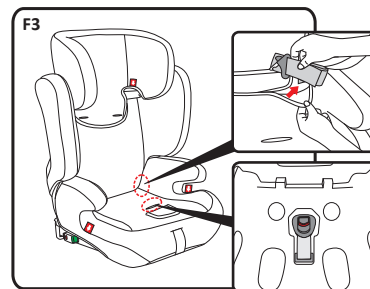
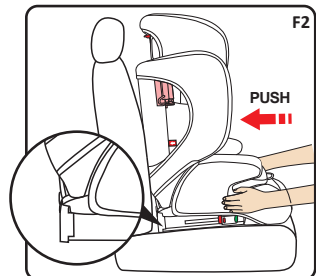

Securing the child

Step 1:Follow the part 14 (see picture H1~H9)routine to remove car seat pad.

NOTICE 1:Fold the strap of both sides and hide under the booster cover

NOTICE 2:Place the buckle in the booster(under the cover).

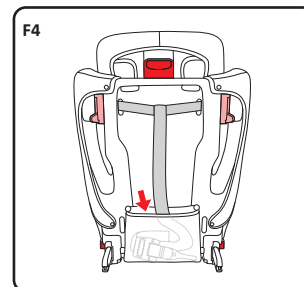

NOTICE 3:No need to take off the top tether. Put the top tether in the bag(F4).

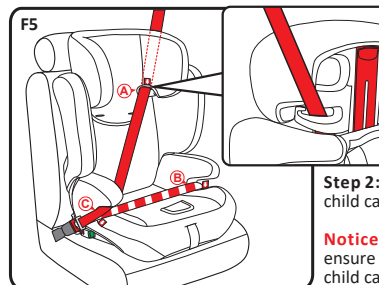

Step 2:Follow the F5 routine to install the child car seat.

Notice 4: When not using the child car seat, ensure that it is kept in a safe place. When the child car seat is in the car but not being used please ensure that it is firmly installed.

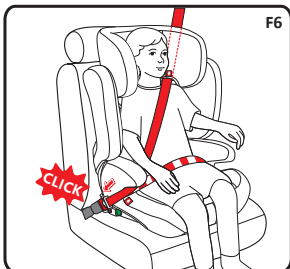

Step 3: Put the child in the seat and follow F5 routine.

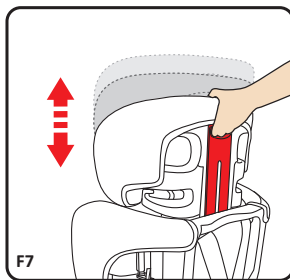

Step 4: Use the height adjuster to adjust the height of the headrest according to the child's height. The gap between head belt guide and child is 2 finger width. The harness straps should be level with or just above the child's shoulders (F7,F8).

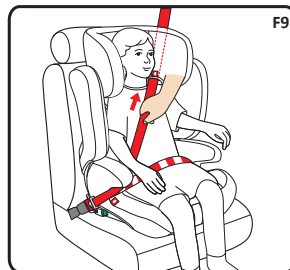
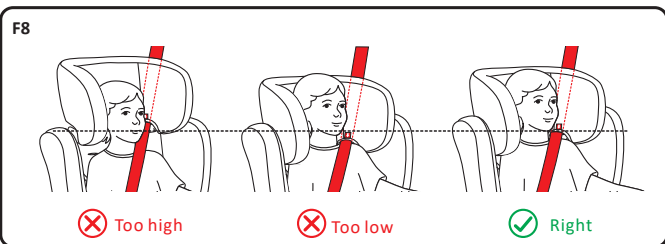

Step 5: Fasten car seat belt and make sure, it is tight (F9).

Important: Ensure that any lap straps are worn low down, so that the pelvis is firmly engaged.

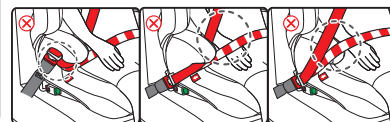

The belt buckle is too high

hand is caught

Belt is wrong and hand is caught

13. Unlock EZFIX

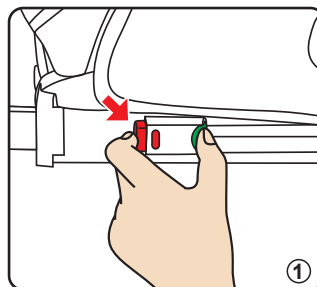

Press the red button to release the Ezfix connector and take away the seat

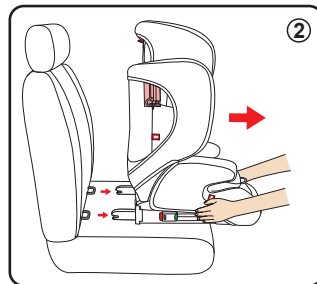

14. Removing the cover

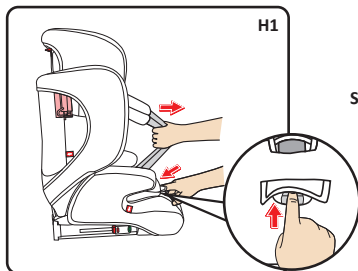

Step 1: Loosen the harness(H1)

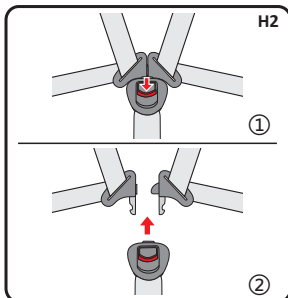

Step 2: Release the buckle

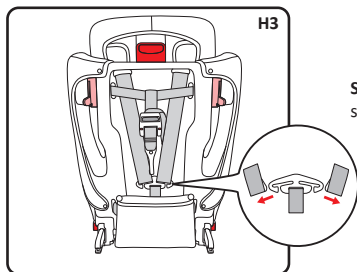

Step 3: Slide both of the harness straps off the harness connector.

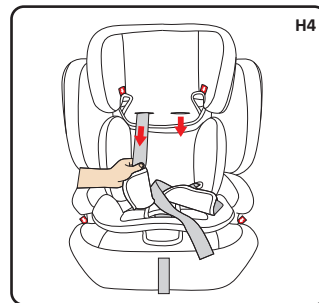

Step 4: Pull out the shoulder belt .

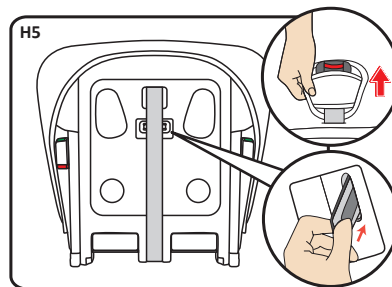

Step 5: Pull out the harness from the slot under the safety car seat.

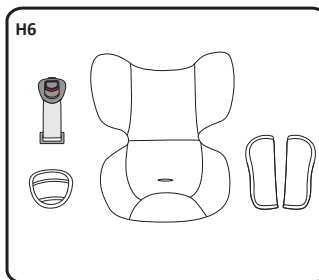

Step 6: Keep the removed cushion and accessories well in a safe place.

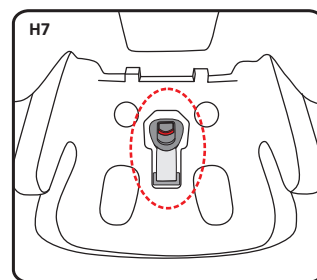

Step 7: Place the buckle in the booster (under the cover).

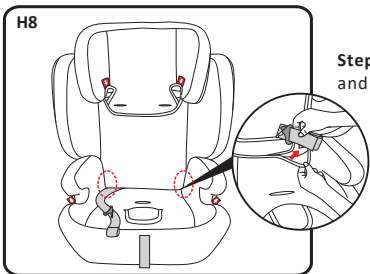

Step 8: Fold the strap of both sides and hide under the booster cover

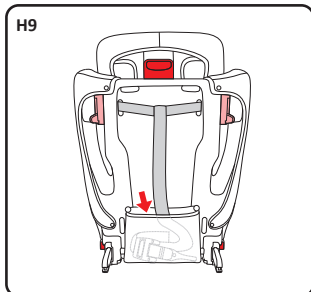

Step 9: Put the top tether in the bag

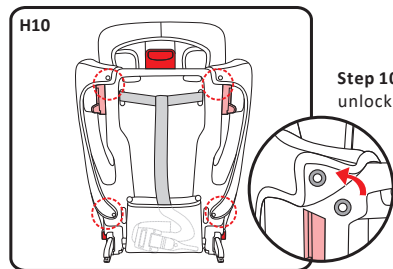

Step 10: Turn the seat to the back and unlock the snap fastener.

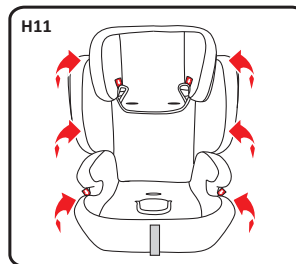

Step 11: Pull in all directions to remove the cover (H11).

Follow in reverse order and repeat the procedure to put on the put the fabric cover back on

15. Maintenance and cleaning

15.1 Daily maintenance

1. Periodically check the child car seat on a daily basis. In the event of an accident the child car seat should be replaced immediately.
2. Please keep this child seat in a dry and ventilated place to avoid damp and mold.
3. If the child seat becomes dusty, clean the seat belt and the plastic pieces by swiping them with a damp sponge and allow them to dry naturally.
4. If food or drink are accidentally dropped into the buckle, disassemble the seat belt from the child seat and rinse thoroughly with warm water. Leave it to dry naturally.
5. For cleaning the entire child seat fabric cover, please refer to the 15.2 washing instructions.

15.2 Washing instruction

Never use any solvent, chemical detergent or lubricant on any part of your child seat.

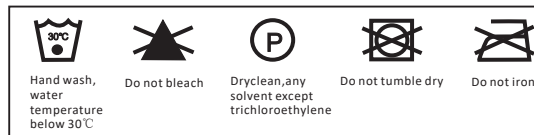

16. List of approved cars

The following vehicle list is only for reference. If your vehicle does not in the list, before using, please consult with the retailer or manufacturer.

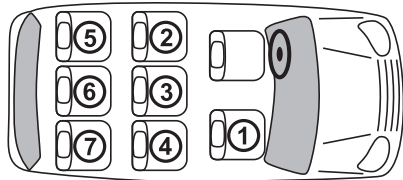

Saloon



Estate



Convertible



Hatchback



MPV



Coupe



No. of doors



No. of seat



Before you purchase the vehicle, check that it is equipped with the appropriate anchorages



Year of manufacture









































Maximum body height

②④ Approved seats

ALFA ROMEO		*
156 Sportwagon / Crosswagon Qd	1997 2007	②④
159 Sportwagon	2005 2011	① 137m ②④
Giulietta 940	2010	① 137m ②④
GT Sportcoupe	2004 2010	① 137m ②④
MiTo	2008	① 137m ① ②④
BMW		*
1(E87/E82/E81) 3+5	2005	②④
1(E82)	2007	②④
1(E88)	2008	① ②④
3(E90)	2005	②④
3(E92)	2005	②④
3	08/05	②④
5(F10)	2010	②④
5(F11) Touring	2010	②④
5 GT	10/09	②④
7(E65) (Facelift 2005)	2001 2008	②④
7(F01)	2008	②④
Mini Club Man	2007	②④
Mini Countryman 4	2010	②④
Mini Countryman 5	2010	④
X1	10/09	②④
X5	2006	②④
X6	2008	① 135m ②④
Z4	2002	ISOFIX ①
DACIA		*
Duster	2010	②④
Lodgy	2012	②③④

Logan	2004	②④
Sandero	2008	②④
Sandero Stepway	2009	②④
Sandero Live 2	2012	②④
FORD		*
B-MAX	2012	②④
C-MAX	2011	②④
C-MAX	2003 2010	②④
Fiesta(MK7) 3+5	2008	① 137m ②④
Fiesta	2012	① 137m ②④
Focus	2011	②④
Focus	2004 2010	① 137m ②④
Focus Turnier	2008 2010	②④
Kuga	2013	②④
Mondeo Turnier	2007	②④
Ranger	2011	②④
S-Max(Facelift 2010)	2006	②③④
Tourneo Connect	2002 2013	②④
Transit Custom	2012	②③⑥
HYUNDAI		*
Accent 3+5	2000 2005	②④
Coupe	1999 2002	②④
Elantra 5	2000 2006	②④
Getz	2002 2009	②④
H 1	2007	②④
i 10	2008	②④
i 20	2008	②④
ix20	2010	②④

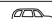
i 30 	2007 2012	②④	3 BK	2009 2013	②④
i 35	2009	②④	5  7	2005 2010	②④
i 40	2011	②④	5 CW	2010	②④
Matrix	2001 2010	②④	6 	2002 2007	 137m ②④
KIA *			6 	2008 2012	 137m ②④
Carens	2006 2013	②④	CX 7	2006 2009	②④
Carnival	2005	②④⑤⑦	CX 7	2009	②④
Ceed 	2006 2012	②④	MX5  5	1998 2005	①
Ceed 	2012	②④	MPV  6+7	1999 2005	②④
Cerato	2004 2008	②④	Premacy	1999 2005	②④
Opirus	2003 2010	②④	RX 8	2003 2012	②④
Magentis	2001 2005	②④	MERCEDES-BENZ *		
Picanto	2004 2011	②④	A	05/05	②④
Rio	2005 2011	②④	B (Facelift 2008)	06/05	②④
Rio	2011	②④	C (Facelift 2004) 	2000 2007	②④
Soul	2008	②④	C (W204) 	2007	②④
LEXUS *			C (S204) 	2007	②④
GS	1997 2005	 137m ②④	C (204)	03/11	②④
IS	1998 2005	 137m ②④	E (W212;S212) 	2009	②④
IS	2005 2013	 137m ②④	E (C207) 	2009	②④
RX	2003 2009	②④	GLK	2008	②④
MAZDA *			ML (W164)	07/05	②④
2 DY	2003 2007	②④	R (W251/V251)	12/05	②④⑤⑦
2 DE	2007	②④	SKODA *		
2	2013	②④	Citigo	2011	 137m ②④
3 BL	2003 2009	②④	Fabia I 	1999 2007	②④

Fabia I 	1999 2007	②④	IQ	2009	②④
Fabia II 	2007	②④	Land Cruiser	2002 2009	②④
Felicia 	1994 2001	②④	Land Cruiser	2009	②④
Octavia I 	2000 2010	①②④	Previa/Estima	2000 2006	②④
Octavia II 	2004 2012	①②④	Previa/Estima	2006	②④
Octavia III 	2013	①②④	Prius	2003 2009	②④
Octavia Scout 	2007 2012	②④	Prius(+Facelift)	2009	②④
Rapid	2012	②④	RAV 4	2000 2006	②④
Roomster(+Facelift)	2006	②④	RAV 4	2006 2013	②④
Superb I	2001 2008	②④	Urban Cruiser	2009	②④
Superb II 	2008	②④	VOLVO *		
Yeti	2009	②④	C 30	2006 2012	 137m ②④
SUBARU *			C 70	2005 2013	②④
Forester	2008 2013	②④	XC 70	2003	②④
Impreza 	2007 2012	②④	S 40/V 40	1995 2004	②④
Legacy 	2003 2009	②④	S 40/V 40	2004 2012	②④
Outback	2003 2009	②④	S 60	2000 2009	②④
Outback	2009	②④	S 60	2010	②④
Trezia	2011	②④	S 80	1998 2006	②④
TOYOTA *			S 80 (+Facelift)	2006	②④
Auris	2007 2012	②④	V 50	2004 2007	②④
Auris Hybrid	2010	②④	V 50	2007 2012	②④
Avensis(T25) 	2003 2009	②④	V 60	2010	 137m ②④
Avensis(T27) 	2009	②④	V 70 	2000 2007	②④
Corolla 	1997 2002	②④	V 70  / XC70 (+Facelift)	2007	②④
Corolla 	2002 2009	②④	XC 60	2008	②④
Corolla 	2006	②④			