

COZY **N** SAFE<sup>®</sup>  
Without Compromise...

APOLLO i-Size

CHILD INFORMATION  
(KEEP WITH CAR SEAT AT ALL TIMES IN CASE OF EMERGENCY)

NAME:

.....

DATE OF BIRTH (DD/MM/YYYY):

.....

ADDRESS:

.....

.....

.....

ALLERGIES/MEDICAL CONDITIONS:

.....

.....

.....

EMERGENCY CONTACT 1:

NAME:

.....

PHONE NUMBER:

.....

EMERGENCY CONTACT 2:

NAME:

.....

PHONE NUMBER:

.....

[www.cozynsafe.com](http://www.cozynsafe.com)

Cozy N Safe  
Oxford Street, Wolverhampton, West Midlands, WV14 7DP, UK  
Tel: +44 (0) 1902 494905 | Email: [enq@cozynsafe.com](mailto:enq@cozynsafe.com)

● 40cm-150cm

COZY **N** SAFE<sup>®</sup>  
Without Compromise...



APOLLO i-Size

EST - 06  
Instruction Manual

1. Warning .....	01
2. Components .....	02
3. Use in the vehicle .....	03
4. Preparatory works.....	04-10
4.1 Adjusting buckle	
4.2 Adjusting harness	
4.3 Adjusting headrest	
4.4 Adjusting recline positions	
4.5 Rotating seat	
4.6 Adjusting ISOFIX	
4.7 Adjusting Top tether	
4.8 Remove and install harness	
4.9 Install and remove side impact shield	
5. Installation .....	11-14
5.1 40-105cm (born to approx. 4 Years, ≤ 18 kg)	
5.2 76-105cm (15 months to approx. 4 years, ≤ 18 kg)	
5.3 100-150cm (approx. 3 years to 12 years)	
6. Cleaning .....	14
7. Customer service .....	15

## For using as i-Size category Enhanced Child Restraint System

### Notice:

This is an i-Size Enhanced Child Restraint System. It is approved according to UN Regulation No 129, for use in, i- Size compatible vehicle seating positions as indicated by vehicle manufacturers in the vehicle users' manual. If in doubt, consult either the Enhanced Child Restraint

## For using as i-Size booster seat category Enhanced Child Restraint System

### Notice:

This is a i-Size booster seat Enhanced Child Restraint System. It is approved according to UN Regulation No 129, for use primarily in " i-Size seating positions" as indicated by vehicle manufacturers in the vehicle user 's manual. If in doubt, consult either the Enhanced Child Restraint

- The rigid items and plastic parts of an Enhanced Child Restraint System shall be located and installed so that they are not liable to become trapped by a movable seat or in a door of the vehicle during everyday use of the vehicle;
- Any straps holding the restraint to the vehicle should be tight, that any straps restraining the child should be adjusted to the child's body, and that straps should not be twisted;
- Ensure that any lap strap is worn low down, so that the pelvis is firmly engaged, shall be stressed.
- The device should be replaced when it has been subject to violent stresses in an accident;
- It is dangerous of making any alterations or additions to the device without the approval of the Type Approval Authority, and a danger of not following closely the installation instructions provided by the child restraint manufacturer;
- When the chair is not provided with a textile cover, the chair should be kept away from sunlight otherwise it may be too hot for the child's skin;
- Children are not left in their Enhanced Child Restraint System unattended;
- Any luggage or other objects liable to cause injuries in the event of a collision shall be properly secured.
- The Enhanced Child Restraint System shall not be used without the cover;
- The Enhanced Child Restraint System cover should not be replaced with any other than the one recommended by the manufacturer, because the cover constitutes an integral part of the restraint performance.
- Retain the instructions on the child restraint for its life period.
- For an "i-Size Enhanced Child Restraint System", the user shall also be referred to the vehicle manufacturer's handbook."

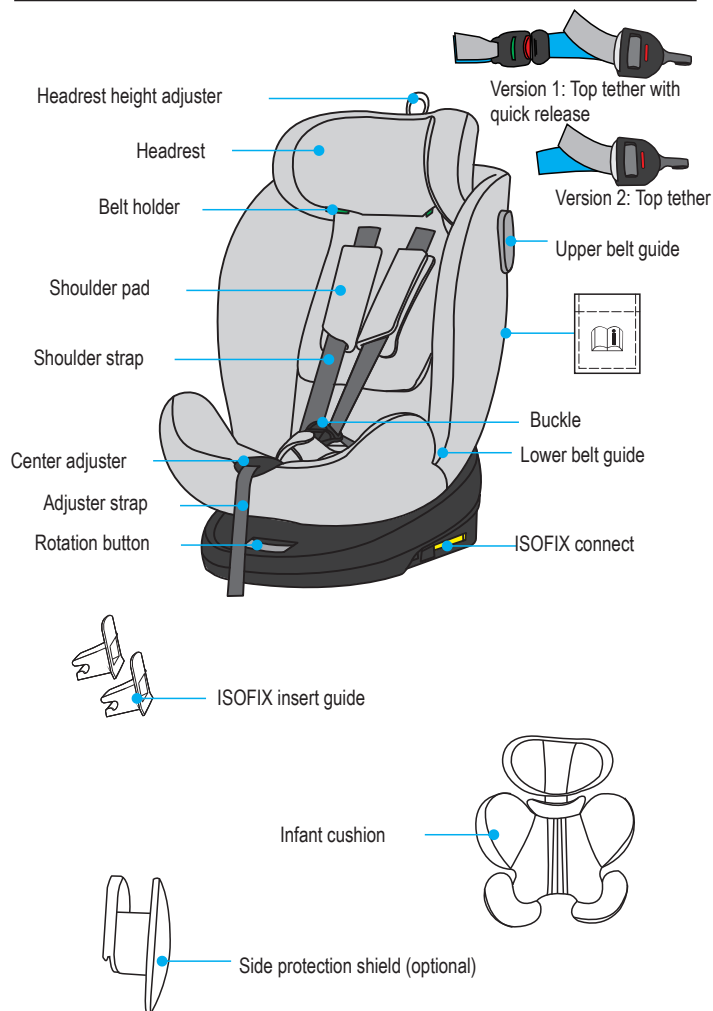

## 2.COMPONENTS



## 3.USEINTHEVEHICLE

Please observe the instructions for using children's restraining systems in the operating instructions of your vehicle. During use, be sure to observe any restrictions relating to airbags. Please refer to the operating instructions for your vehicle for information about vehicle seats which are certified for the use of children's restraining systems according to ECE R16.

This is an i-Size Enhanced Child Restraint System. It is approved to Regulation UN R129/03, for use in i-Size compatible vehicle seating positions as indicated by vehicle manufacturers in the vehicle users' manual. If your vehicle does not have an i-Size seating position, please check the vehicle type list that is included.

 <p>40-105cm ≤18kg</p> <p>Facing backwards (against the direction of travel)</p>	 <p>76-150cm older than 15 months</p> <p>Facing forwards (in the direction of travel)</p>
--	--

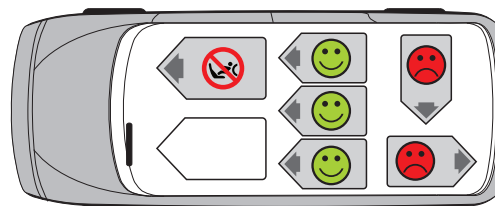

"IMPORTANT – DO NOT USE FORWARD FACING BEFORE THE CHILD'S AGE EXCEEDS 15 MONTHS (Refer to instructions)".

DO NOT place rear-facing child seat on front seat with active airbag, DEATH OR SERIOUS INJURY can occur.

## 4. PREPARATORY WORKS

### 4.1 Adjusting buckle

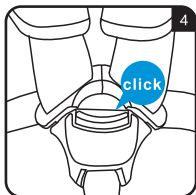
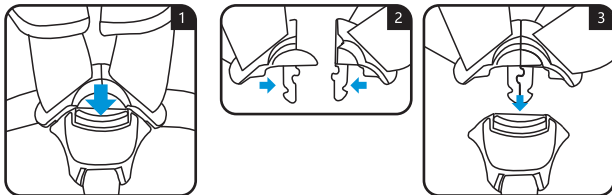

#### Open buckle

Press red button until buckle latches come out from the buckle.(fig.1)

#### Lock buckle

Guide the two buckle latches together (fig.2), putting them into the harness buckle house (fig.3). Buckle locked when sounds click (fig.4).

**Notice:** buckle can not lock only by putting one latch.

### 4.1 Adjusting harness

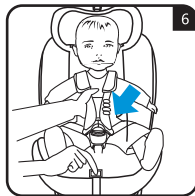
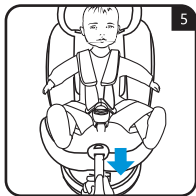

#### Tighten harness

Pull the adjuster strap until the harness lies flat and is close against your child's body (fig.5).

**Notice:** Make sure the space between the child and the shoulder harness is about the thickness of one hand.

#### Loosen harness

Press the center adjuster and at the same time pull both shoulder belts forwards.(fig.6) Do not pull on the shoulder pads

## 4. PREPARATORY WORKS

### 4.3 Adjusting headrest

**Important !** A correctly adjusted headrest ensures optimal protection for your child in the safety seat.

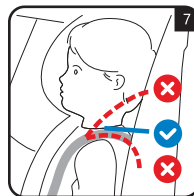

When installed by 5-point harness, the headrest must be adjusted so that the shoulder belts are at the same level as your child's shoulders.(fig.7)

**CAUTION!** The shoulder belts must not run behind the back of the child or at ear height or above the ears.

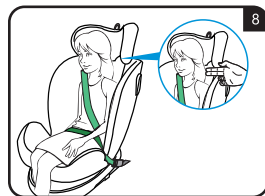

When installed by 3-point vehicle belt, The headrest must be adjusted so that there is a space two fingers wide between the headrest and your child's shoulders. Make sure the diagonal seat belt section is on child's shoulder but not on neck. (fig.8)- (fig.4).

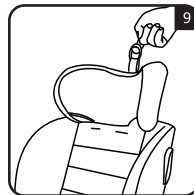

First loosen harness. Pull up the headrest height adjuster at the same time move headrest to shoulder height in accordance with the size of the child.(fig.9)

### 4.4 Adjusting recline positions

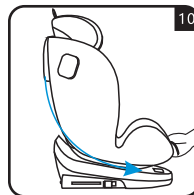

Seat has five recline positions.

For rearward facing, only use most reclined position. For forward facing, can use all five positions. Except most upright position, other positions may not fit in all approved vehicles.

Pull Recline lever at the same time incline seat to intend position.(fig.10)

## 4. PREPARATORY WORKS

### 4.5 Rotating seat



40-105cm  
(born to approx. 4 Years,  
≤ 18 kg)



76-150cm (15 months  
to approx. 12 years)

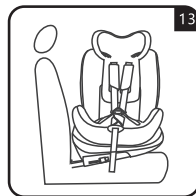

#### Lateral facing

For child sit convenience  
Forbidden to use when driving

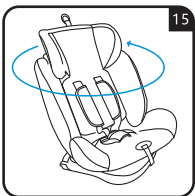
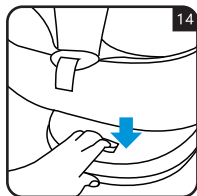

Pull rotation button at the  
same time rotate seat to  
intend direction.  
(fig.14,15)



When seat rotates to intend direction, rotation  
button will bounce and make click sound. Then  
try to rotate seat to make sure seat is locked.  
(fig.16)

## 4. PREPARATORY WORKS

### 4.6 Adjusting ISOFIX

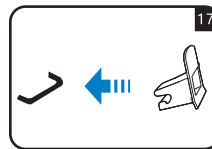

If your vehicle is not equipped with the ISOFIX insert guides  
as standard, clip the two insert guides which are included  
with the seat. with  
the cut-out facing upwards onto the two ISOFIX  
attachment points of your vehicle.

TIP: The ISOFIX attachment points are located between the  
surface and the backrest of the vehicle seat.  
Look for this symbol in your vehicle.



#### 4.6.1 ISOFIX installation

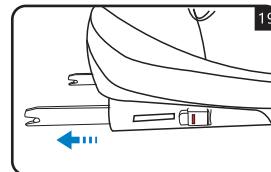
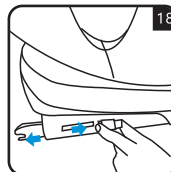

On both sides of the  
seat squeeze the  
ISOFIX button and pull  
out ISOFIX connectors  
in longest  
position.(fig.18,19)

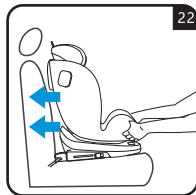
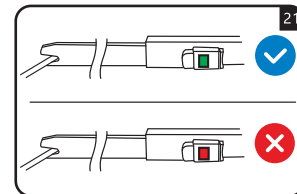
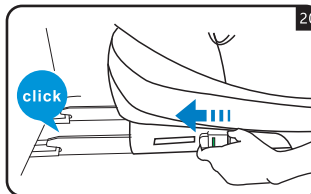

Slide the two ISOFIX connectors firmly into the  
insert guides until the ISOFIX connectors engage  
with a clicking noise on both sides. The ISOFIX  
button must turn green on both sides. (fig.20,21)

**CAUTION!** The ISOFIX connectors are only  
correctly engaged if both of the ISOFIX buttons  
are green

Push the child seat towards the backrest applying firm, even pressure  
on both sides. Shake the child safety seat to make sure it is safely  
attached and re-check the green safety buttons to make sure that both  
of them are completely green.(fig.22)

## 4. PREPARATORY WORKS

### 4.6.2 Remove ISOFIX

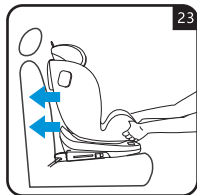

Push the child seat towards the backrest applying firm. (fig.23)

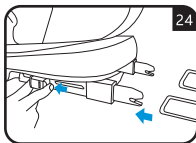

At the same time squeeze ISOFIX button and pull back ISOFIX connectors. (fig.24) position. (fig.18,19)

### 4.7 Adjusting Top tether

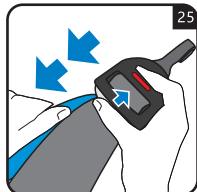

Take the top tether and if required, lengthen the belt by pressing the top tether brake button to release the strap, pulling to adjust as necessary. (fig.25)

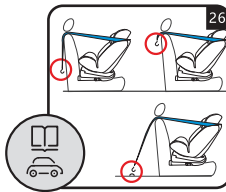

Attach the top tether hook to the top tether anchorage point which is recommended in the owner's manual of your car. (fig.26;27) Look for this symbol in your vehicle

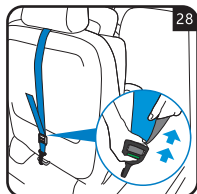
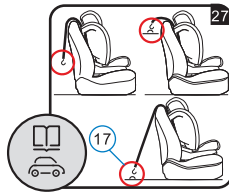

To tension the top tether, remove any slack by pulling on the free end of strap until it is suitably tightened. The top tether will be properly tightened when the tension indicator turns completely green. (fig.28)

## 4. PREPARATORY WORKS

version 1 : top tether with quick release

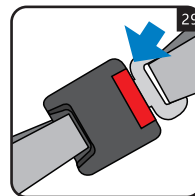

Pressing the top tether quick release button to release top tether when rotating forward facing installation to lateral.

**CAUTION!** Make sure the top tether quick release locked again after rotating back to forward facing.

Version 2: top tether  
Ignore fig.29

### 4.8 Remove and install harness

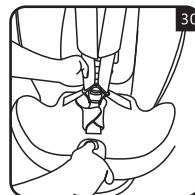

Loosen the 5-point harness on the child seat as far as possible. Then open the buckle, pulling to adjust as necessary. (fig.25)

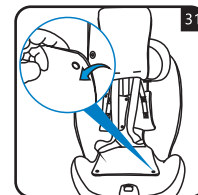

Loosen the press studs on the backrest and fold the upper half of the cover upwards and the lower half downwards.

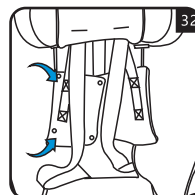

Open the two shoulder pads by the Velcro fasteners on the side. Push the Velcro strip of the two opened shoulder pads under the backrest cover and attach it to the fleece strip provided.

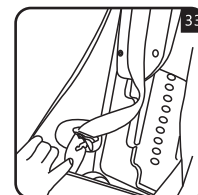

Insert the buckle tongues in the recess provided on the inside of the backrest.

## 4. PREPARATORY WORKS

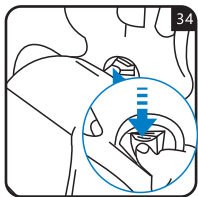

Open seat cover and fold the cover forwards, pull the harness buckle out of the cover.

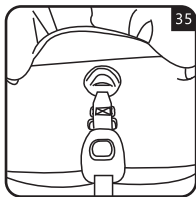

Stow the harness buckle in the recess provided in the cover.

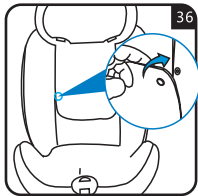

Re-fitting the harness: Simply follow the steps in the opposite order. Make sure the belt is not twisted.

Close the two press studs and recovery seat cover.

### 4.9 Install and remove side impact shield

This seat has been tested and approved to offer optimum side protection without side impact shield.

The side impact shield is optional for extra side protection.

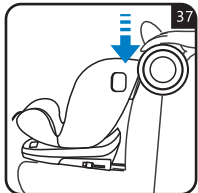

The side impact shield should install at the side which close to vehicle door.

Install: Insert side impact shield from top along the slots on Upper belt guide until full engaged.

Remove: pull up side impact shield along the slots on the upper belt guide.

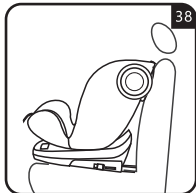

## 5. INSTALLATION

### 5.1 40-105cm, facing backwards (born to approx. 4 Years, ≤ 18 kg)

Notice: The infant cushion protects your child. It needs to be used up to size of 75 cm.

**DO NOT place rear-facing child seat on front seat with active airbag, DEATH OR SERIOUS INJURY can occur.**

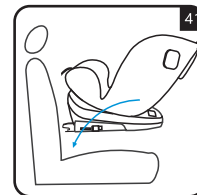
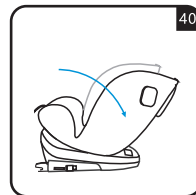
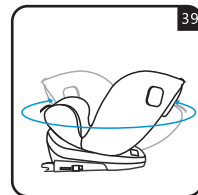

Rotate seat to rearward facing (see section 4.5), adjust seat in most reclined position (see section 4.4). Place seat in the direction facing opposite to the travel. (fig. 39, 40, 41)

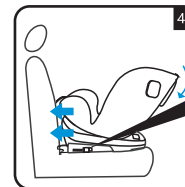

Install ISOFIX connectors (see section 4.6) (fig. 42) harness buckle out of the cover.

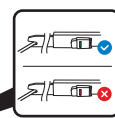

Guide top tether along one sides and insert upper belt guide, then attach top tether hook to anchorage point. (see section 4.7) (fig. 43)



Have your child sit down in the child seat. Adjust headrest in proper height (see section 4.3), adjust harness and lock buckle (see section 4.1), and tighten harness. (see section 4.2) (fig. 44)

## 5. INSTALLATION

5.2 76-105cm (15 months to approx. 4 years, ≤ 18 kg)

**"IMPORTANT – DO NOT USE FORWARD FACING BEFORE THE CHILD'S AGE EXCEEDS 15 MONTHS".**

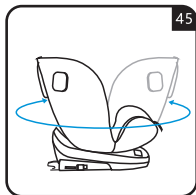

Rotate seat to forward facing (see section 4.5). Place seat in the direction facing to the travel. (fig.45,46)

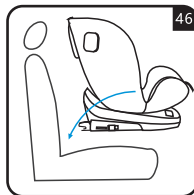

Install ISOFIX connectors (see section 4.6) (fig. 47)

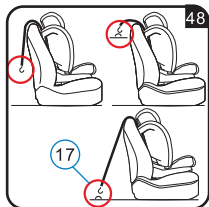
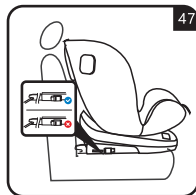

Attach top tether hook to anchorage point. (see section 4.7) (fig.48)

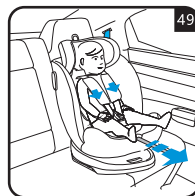

Have your child sit down in the child seat. Adjust headrest in proper height (see section 4.3), adjust harness and lock buckle (see section 4.1), and tighten harness. (see section 4.2) (fig. 49)

## 5. INSTALLATION

5.3 100-150cm (approx. 3 years to 12 years)

**Remove harness when use for child stature 100-150cm. see section 4.8**

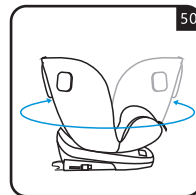

Rotate seat to forward facing (see section 4.5). Place seat in the direction facing to the travel. (fig.50,51)

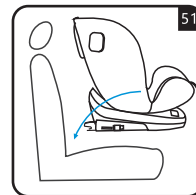

There are two options to install :  
 •Only use vehicle 3 point belt or  
 •Use vehicle 3 point belt + Isofix connectors.

**CAUTION! Both options do not use top tether.**

Install ISOFIX connectors (see section 4.6) (fig.52)

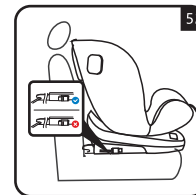

Have your child sit down in the child seat. Adjust headrest in proper height (see section 4.3). Pull out the vehicle seat belt and guide it in front of your child to the vehicle seat buckle. Engage the buckle tongue in the vehicle seat buckle. (fig.55)

**Caution! The vehicle seat belt buckle must not be positioned in the lower belt guide**



Place the diagonal seat belt section and lap belt section on the side of the vehicle seat belt buckle in the lower belt guide. (fig.56)



Place the lap belt section on the other side of the childseat in the lower belt guide.(fig.57)

**Caution! The lap belt section must lie as low as possible over your child's hips on both sides**



## 5. INSTALLATION

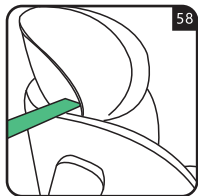

For child stature 100-150cm installation, this seat also can use vehicle belt only, it has been tested and homologated also. If you want only use vehicle belt installation, just skip the ISOFIX connector relative content.

Guide the diagonal seat belt section into the Belt holder and it is not twisted. (fig.58) content.

## 6. Cleaning

The cover can be removed and washed. Please observe the instructions on the washing label of the cover.

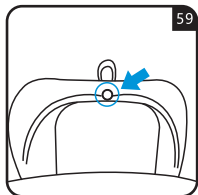

Loosen the press studs at the back of the headrest and remove the cover of headrest.

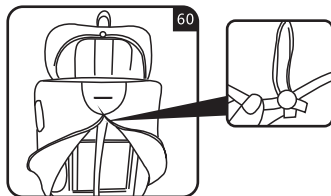

Loosen the press studs and unzip at the back of seat cover. Pull forward and remove seat cover.

Re-fitting Simply follow the steps in the opposite order

## 7. CUSTOMER SERVICE

### 7. Customer service

We guarantee its products against any manufacturer defect for a period of 2 years, start from the day of purchase.

1. The warranty does not cover defects or failures caused by inappropriate use or non-compliance with the installation and maintenance safety standards described in the instruction guides provided with the products.

2. The warranty shall be automatically considered void if the article acquired has been repaired or if an attempt has been made to repair it by an individual that is not authorized by our company.