

Ultra portable, lightweight  
solar cooker



 [gosun.co/manuals](https://gosun.co/manuals)

Manual de usuario en Espanol

Manuel d'utilisation en Français

Gebruikershandleiding auf Deutsch

日本語のユーザーマニュアル

中文用户手册



# Table of Contents

Important Safety Info .....	2
General Safety Information .....	3
Parts List .....	4
<b>Operating Instructions – Cooking</b>	
Open Stove .....	5
Mount (Optional) .....	6
Orient to Sun .....	7
The GoSun Dial .....	8
Insert Food .....	9
Cook Food .....	10
Cook Times .....	11
Cooking Tips .....	12
<b>Operating Instructions – Boiling</b>	
Heat Liquids .....	13
The Stabilizer .....	14
Orient to Sun .....	15
Cleanup .....	16
<b>Additional Product Info</b>	
Tube Removal .....	17–18
Maintenance .....	19
How it Works .....	20
Product Specifications .....	21
Liability Release .....	22
Warranty .....	23–25
Contact Us .....	26

# Danger

## Avoid Thermal Shock

- ✓ Don't preheat stove
- ✓ Don't place cold food inside hot tube

## Contents Hot

- ✓ Handle stove contents with extreme care.

## Avoid Overheating

- ✓ Do not leave empty stove open and in the sun
- ✓ Do not leave stove with heating element on

## Avoid Risk of Fire

- ✓ Do not cover cooker with, or operate cooker near flammable items
- ✓ Do not stack anything on or above the cooker when in operation

# General Safety

- ✓ Do not put plastic paper or non-edible items inside the GoSun Stove.
- ✓ This device is not intended for use near or by young children or cognitively impaired persons without supervision.
- ✓ Do not attempt to seal or pressurize the Tube.
- ✓ Keep Tube free of food debris, grit and sand.
- ✓ When removing a broken evacuated Tube, the resulting fragments are very sharp. Use caution and only handle shards wearing the appropriate protective gloves to avoid cuts.
- ✓ Fragile: Do not drop the Tube and be sure to protect it from impacts, scratches and other sources of stress.
- ✓ Be sure Kickstand is securely locked in place before loading Tube with Cooking Tray.
- ✓ Do not leave device deployed in the Sun unattended.
- ✓ Device not intended for commercial use.
- ✓ Clean the Cooking Tray after every use, clean the Tube when needed and only after it has cooled down.
- ✓ Use GoSun Stove Implements only with your stove.
- ✓ In windy environments, be sure to check the product's stability when in boiling mode.
- ✓ Use caution when pouring hot liquids from Tube.

# Parts List

Front View:

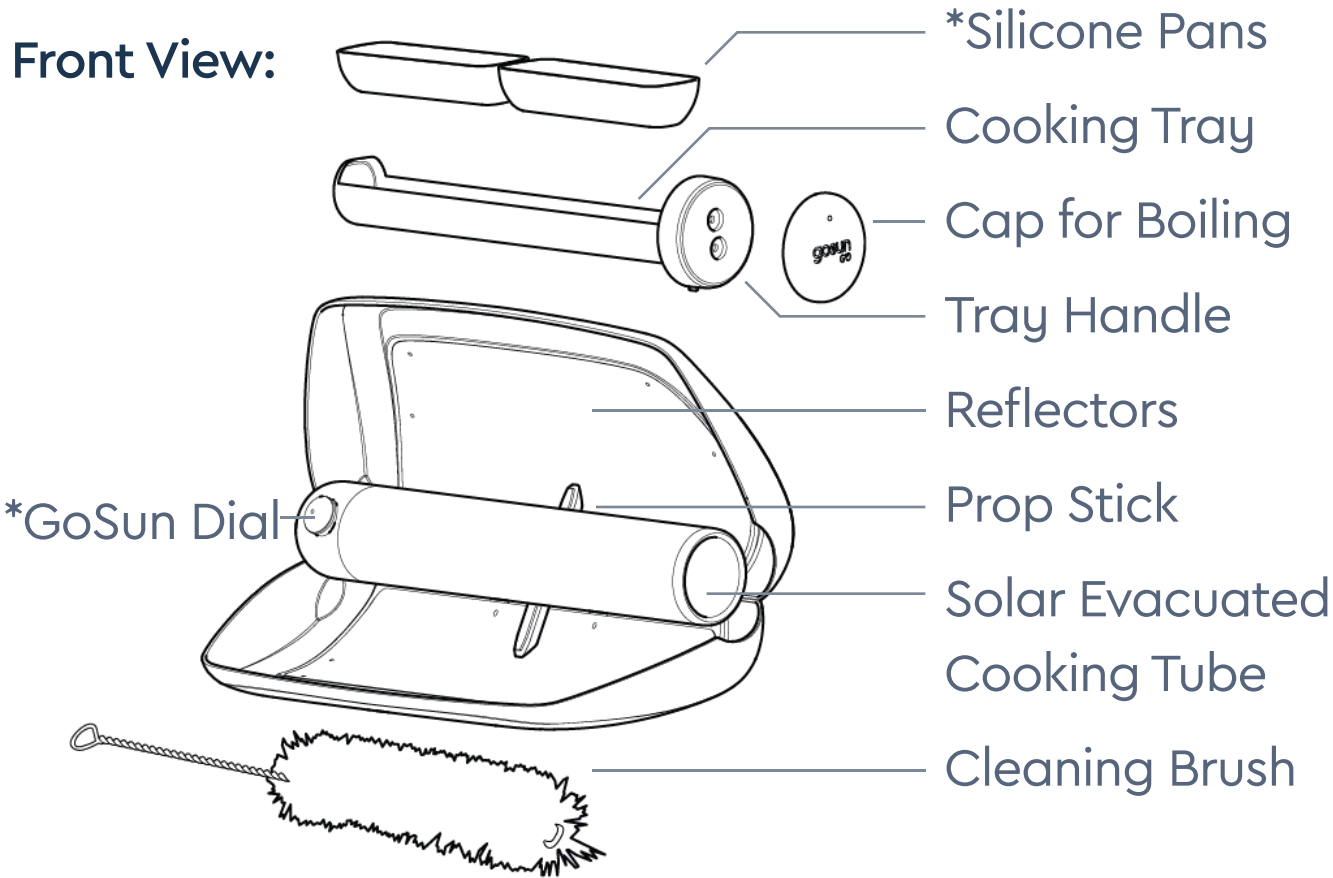

Back View:

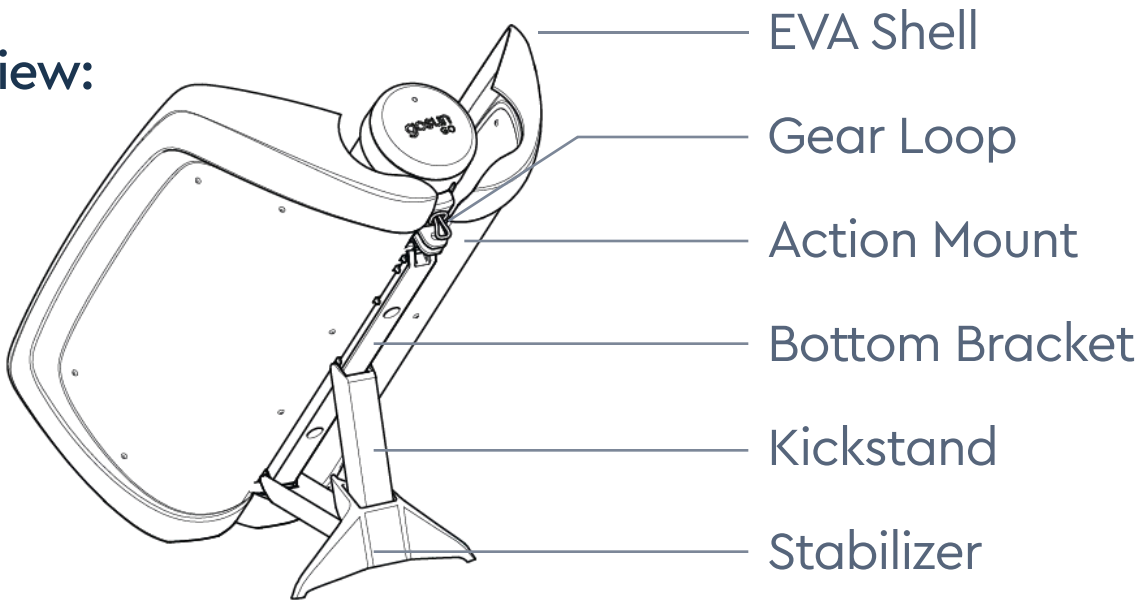

# 01. Open Stove

1. First Use: Remove from packaging
2. Hold the unit in one hand and use the other to unzip the product. Be sure to fully unzip to avoid putting excessive pressure on the zipper pull when in use
3. Peel off protective plastic film on reflectors
4. Locate the Prop Stick directly underneath the center of the Tube
5. Rotate the Prop Stick 90° to hold reflectors open
6. Place GoSun Go on flat surface or securely fasten to mount

## Unzip + Open

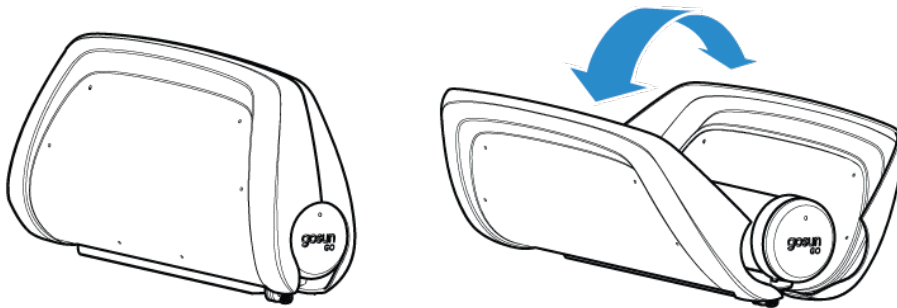

## Rotate Prop Stick

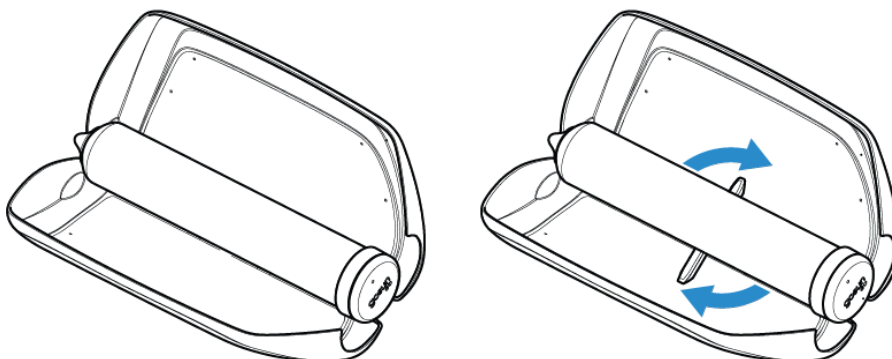

## 02. Mount (Optional)

1. Only use mounting accessories capable of handling the weight and torque of the GoSun Go loaded with food
2. Locate Action Mount underneath the mouth end of the Tube
3. Connect Action Mount to tripod mount adapter (mount adapter and accessories not included)
4. Be sure to tighten securely
5. Orient to Sun (see following page)

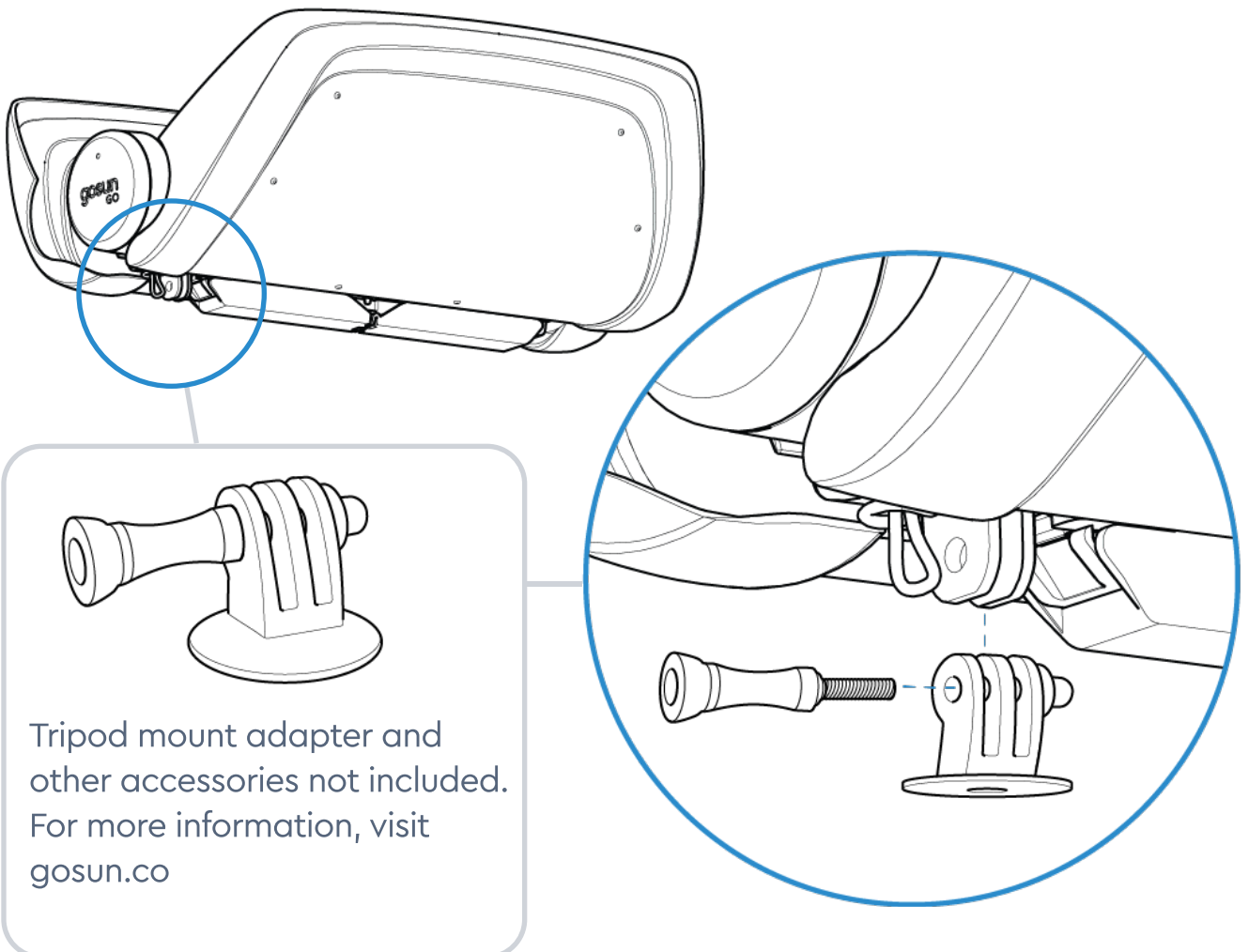

## 03. Orient to Sun

1. Adjust the Kickstand to rotate the GoSun Go until the reflectors are facing perpendicular to the Sun.
2. Rotate the GoSun Go until the GoSun Dial's shadow (only available with pro pack) and solar glare are directly in the center ring of the target below.

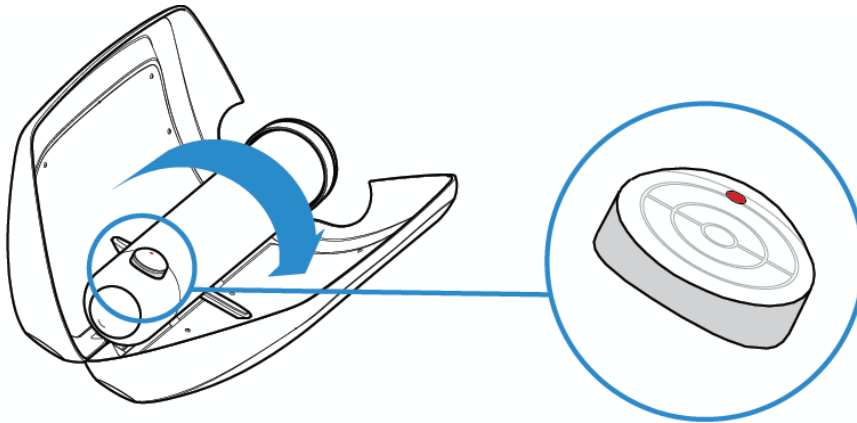

The GoSun Go only has to be readjusted every hour or so as the Sun moves through the sky

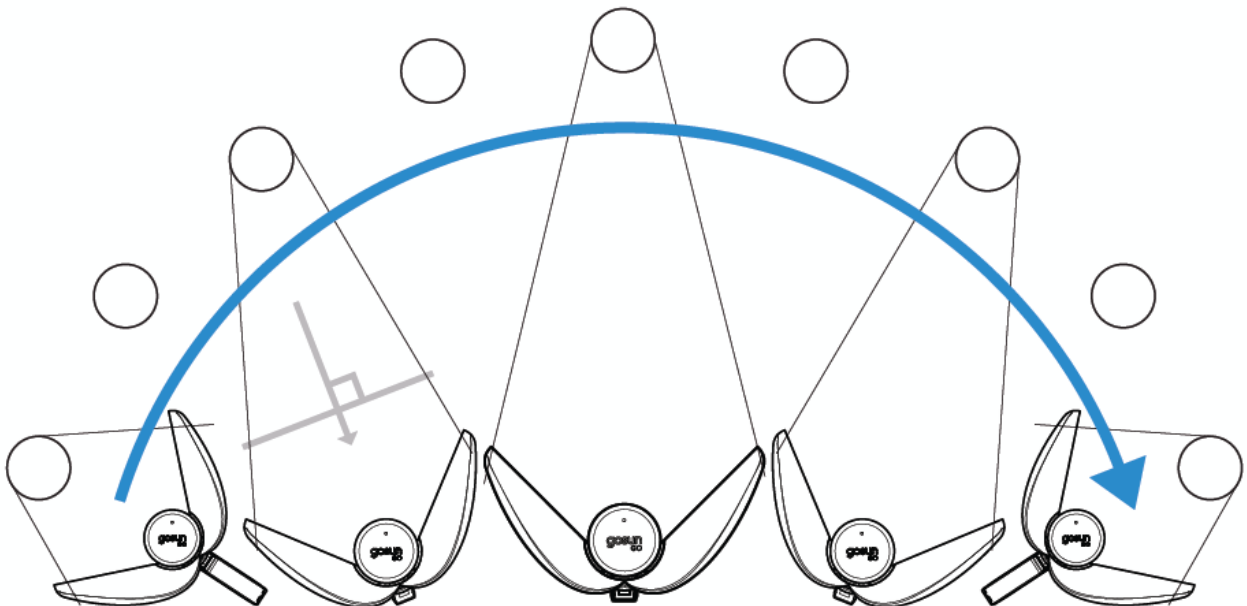

# The GoSun Dial

(only available with pro pack)

When properly aligned, both the dome's glare and the dot's shadow will be in the center of the target.

## Off-Angle:

Glare

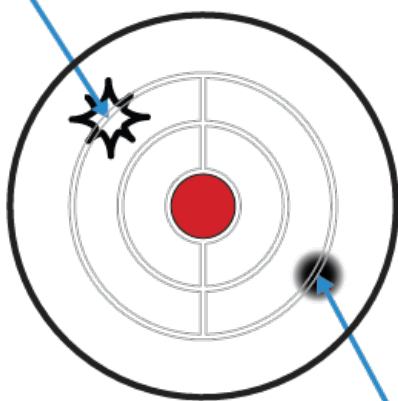

Shadow

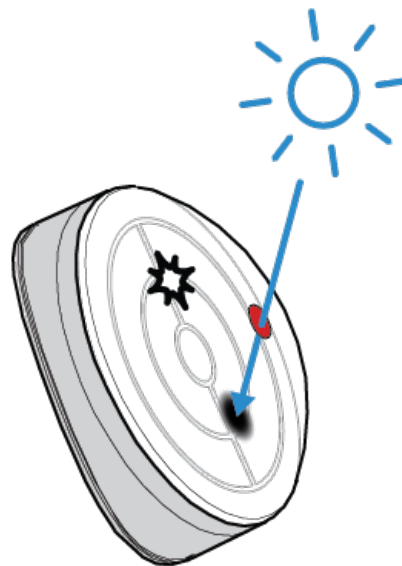

## Aligned:

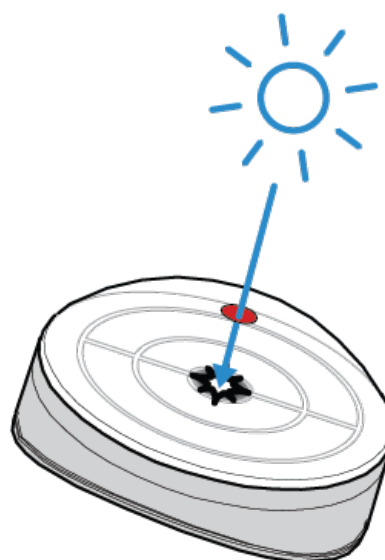
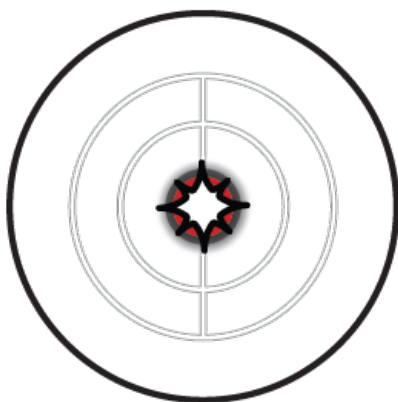

For more information, visit the Accessories page on [gosun.co](http://gosun.co)

## 04. Insert Food

1. Fill up the Cooking Tray (A) or Silicone Pans (B) with food.
2. Do not allow the cooker to preheat in the Sun more than 10 minutes before placing food inside to avoid thermal shock.
3. Insert cooking tray until the Tray Handle seals with the mouth of the Tube
4. Ensure the Tray remains facing upwards throughout use.

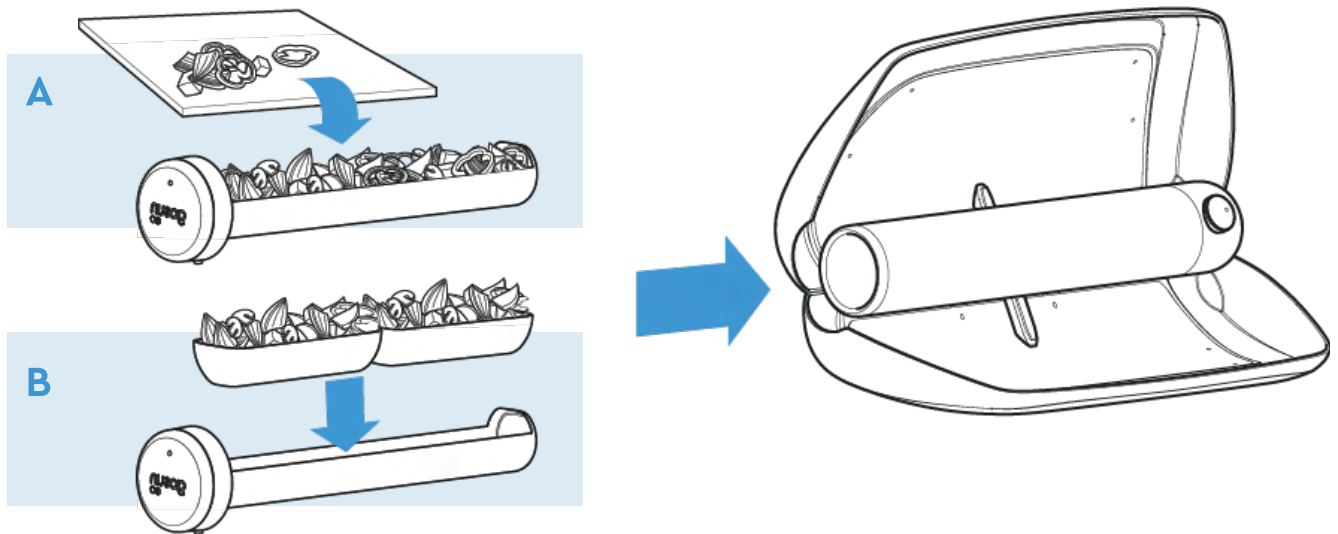

### Warning

**Do not insert cold food into a hot Tube.** It can cause excess stress on the Tube, known as Thermal Shock, which may weaken it or cause it to shatter.

**Do not overload the Cooking Tray.** Many foods expand when heated and can get stuck inside Tube.

**Do not force the Cooking Tray in the Tube.** It may break the Tube or be difficult to remove.

## 05. Cook Food

1. Let the Sun do its magic (see "Cook Times").
2. To reduce the temperature or slow cooking times, simply pull the device out the Sun's direct path or close the reflectors.
3. Enjoy solar cooked food!

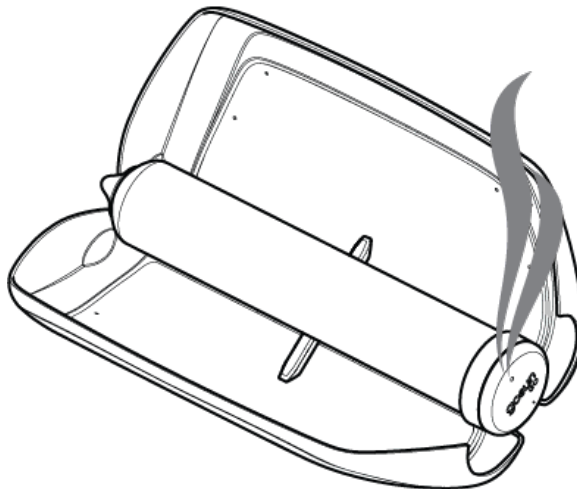

### Warning

**Hot Contents.** Any item placed inside cooking tube can be extremely hot and cause severe burns.

**Use Caution** when handling the device and implements.

The GoSun Go can reach temperatures of up to 550°F (287°C), and will begin heating up as soon as it is exposed to sunlight. Because of the vacuum insulator, you cannot be burned by touching any exterior part of the GoSun Go. However, inner components can be extremely hot and must be handled with care.

## 06. Cook Times

	Full Sun	Med. Sun	Low Sun
Pre-Cooked Meals	15 min	35 min	1 hour
Steamed Veggies	20 min	35 min	1 hour
Seafood	20 min	50 min	1.5 hours
Baked Goods	25 min	1 hour	1.5 hours
Casseroles	35 min	1.2 hours	1.5 hours
Grains	45 min	1.3 hours	2 hours
Root Veggies	50 min	1.4 hours	2 hours
Meats	55 min	1.5 hours	2.5 hours
Soups, Hot Water	1 hour	1.5 hours	2.7 hours

The GoSun Stove's performance is unaffected by ambient temperatures and wind, cooking meals in frigid temperatures just as well as in hot weather. High humidity, pollution, and diffuse light (generally overcast or "thick" air) can significantly impact cooking times due to light scattering. In humid climates the GoSun Stove will be most efficient in the spring and fall. It will not work in the shade.

## 07. Cooking Tips

- Applying aluminum foil, oil or butter to the Cooking Tray before adding food helps to prevent sticking.
- Heat is generally distributed evenly to food in the Tube but foods at the end of the Tray (away from Handle) tend to cook faster than foods near the Tube's opening.
- Baked foods typically expand considerably (more than twice the uncooked volume), so start with small quantities and work up to the full tube size.
- The GoSun Go tends to trap a large amount of moisture from cooking food and can be used to easily steam vegetables. For a crispier meal, allow the steam to escape by keeping the Tray slightly open. Drain fluids periodically.
- Sausages that curl when heated should be cut in half to prevent them from getting stuck.

### Other Resources:

- [gosun.co](http://gosun.co)
- [www.facebook.com/groups/gosun/](https://www.facebook.com/groups/gosun/)  
Log on and join other GoSun enthusiasts to learn and share recipes and cooking tips

## 08. Heat Liquids

1. Rotate Prop Stick to ensure that reflectors remain open.
2. Fill Tube with desired liquid. Fill to just under the top line of inner coating.
3. Remove Silicone Cap from Tray Handle
4. Place Silicone Cap onto the mouth of the Tube
5. Place or mount, orienting towards the Sun (p. 16)

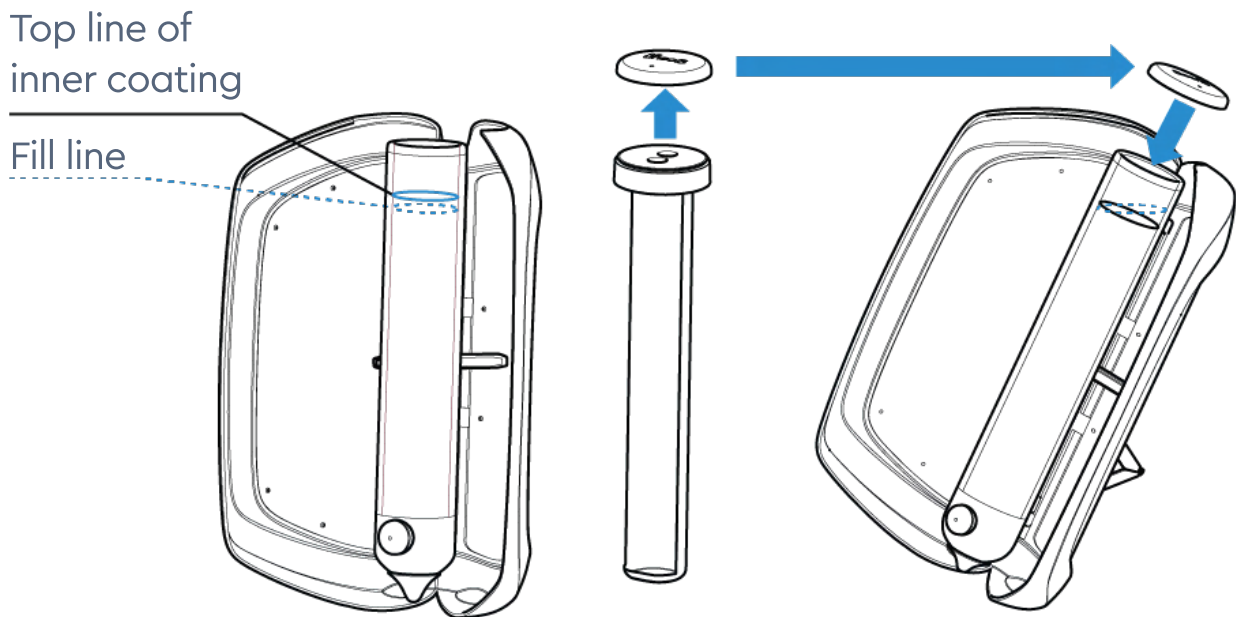

### Warning

**Always Fill to Fill Line.** Under-filling causes the Tube to heat unevenly and creates the risk of flash steam when pouring. **Use Caution When Pouring Hot Liquids.** Pouring too quickly may cause hot liquids to rapidly pour out of Tube, increasing risk of burn-related injury.

# The Stabilizer

The Action Stand increases stability and minimizes risk of breakage and spilling hot liquids.

## Other Resources:

Secure the Kickstand to the final angle setting and clip Stabilizer over Kickstand

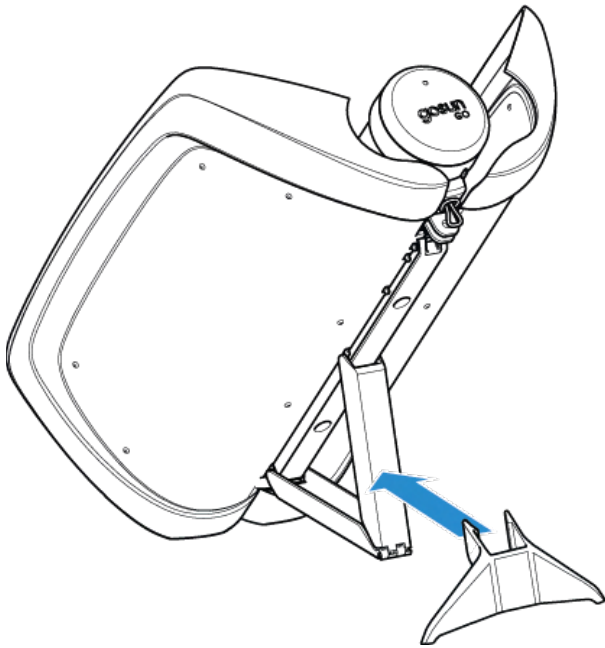

## Remove:

Pull clips back and pull the Stabilizer away from the unit

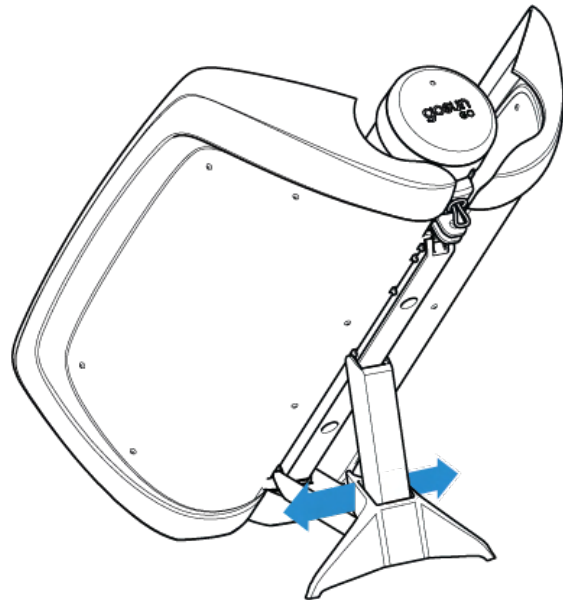

### Warning

**Use Stabilizer in windy conditions or on uneven surfaces.**

The Stabilizer increases stability and minimizes risk of spilling hot liquids.

## 09. Orient to Sun

1. Secure the Kickstand to the most acute angle setting and place or mount the GoSun Go so that it stands vertically.
2. Rotate the GoSun Go until the GoSun Dial's (only available with pro) solar glare aligns on the vertical line.



The GoSun Go only has to be readjusted every hour or so as the Sun moves through the sky

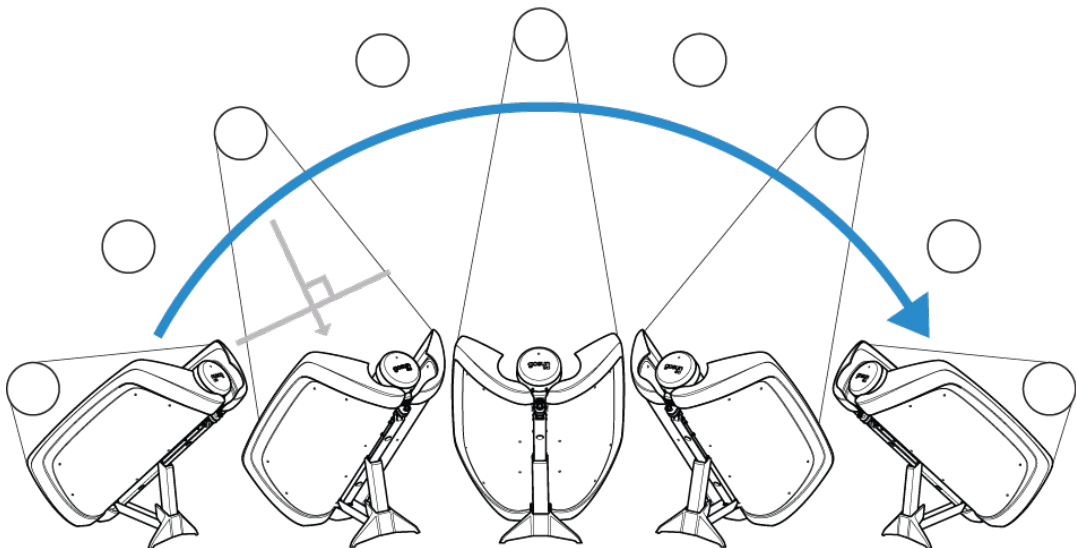

# 10. Cleanup

1. Allow the device to completely cool down out of the Sun — this can take over an hour.
2. Locate cleaning brush included in the package.
3. Fill the Tube with about 0.5 liters or 8 oz of water and a squirt of dish soap.
4. Hold unit upside down over sink. Insert cleaning brush in cool Tube and twist while plunging up and down.
5. Rinse tray and tube as needed with water (tube must be cool).

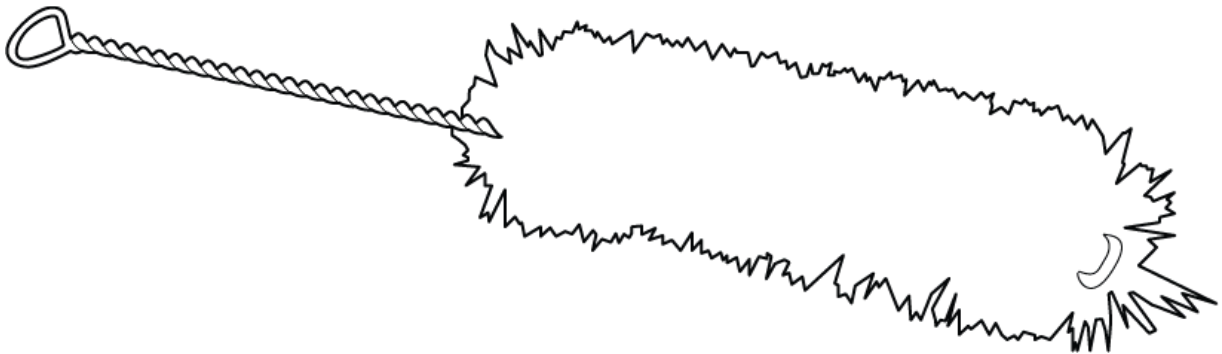

## Warning

Do not use harsh abrasives, caustic cleaners or oven cleaners on this device.

# Tube Removal

For repairing purposes, the tube can be removed from the rest of the device with the following procedures:

1. Firmly grasp the Tube in one hand. Keep one hand on the Tube throughout removal process
2. Orient the product so that the Bottom Bracket faces up
3. Secure the Kickstand to the most acute angle setting
4. Locate Tube release hex bolts on the under side of Bottom Bracket
5. Remove hex bolts using an Allen key (Figure A)
6. Locate clip directly underneath the tail (closed) end of the tube on the interior of product (Figure B)
7. With a firm grasp on the Tube, release the clip
8. Remove Bottom Bracket (Figure C)
9. Remove Tube from EVA Shell (Figure D)
10. Reverse steps to reassemble



## **Warning**

**Wear protective gloves when handling broken tube to avoid risk of injury**

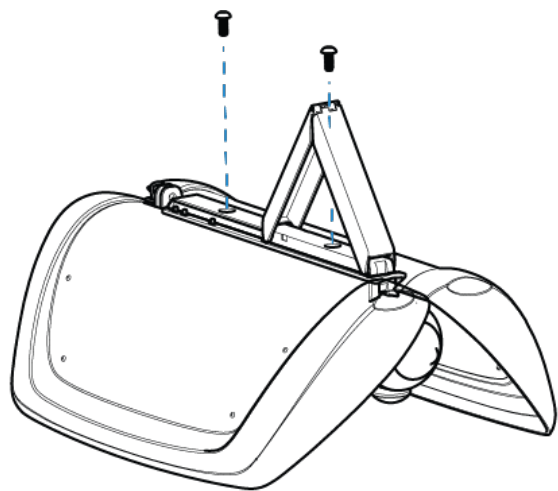
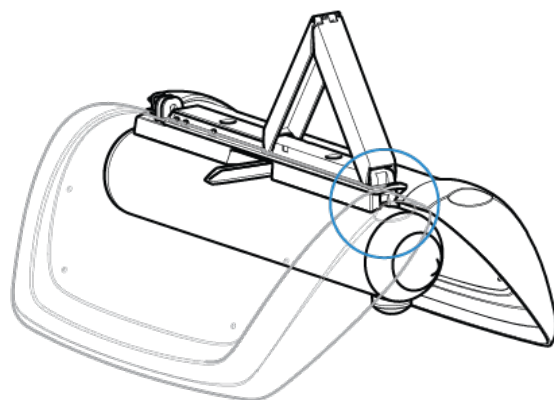
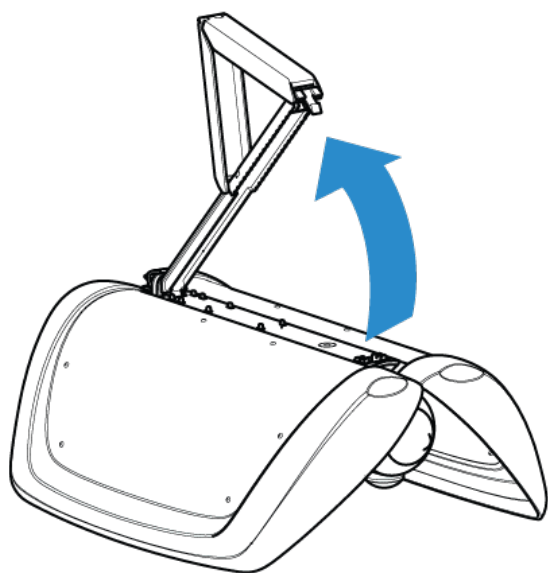
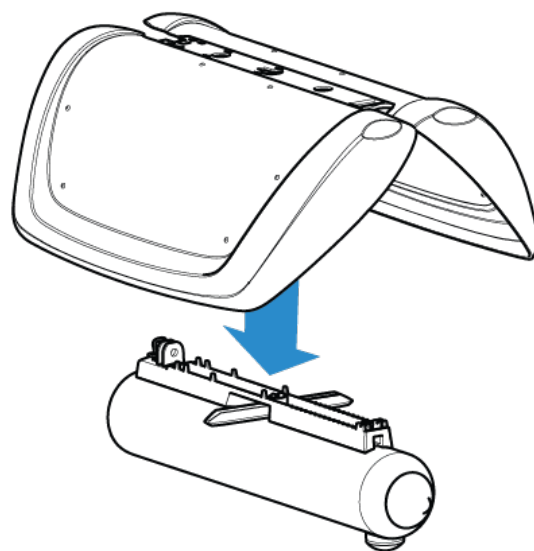
**A****B****C****D**

# Maintenance

1. Clean the cooking Tray after every use, clean the Tube when needed and only after it has cooled down.
2. The stainless steel Cooking Tray can easily be cleaned by hand; it can also be cleaned by placing the entire tray (including the Handle) into the dishwasher.
3. It is recommended that you clean the inside of the glass Tube occasionally to prevent build-up of grease or food matter, which can affect the flavor of food.
4. Keep surfaces of Tube and Reflectors clean with glass cleaner or mild soap.
5. If the GoSun Cooking Tray becomes deformed after extensive use and becomes noticeably harder to insert into the tube, it can be remedied by squeezing the tray by hand.
6. If the evacuated tube breaks, it can be removed and replaced by following the "Tube Removal" Section on the following page. The GoSun Go uses the best evacuated tubes available on the market, however if they are damaged, a barium layer will oxidize and a white film will appear on the inside of the outer Tube, indicating that the Tube should be replaced.

# How it Works

## Outer Space in a Tube

At the heart of the GoSun is the evacuated glass tube. It's not only a superior absorber of light, but also a fantastic insulator.

## External Coatings

-  **Aluminum Nitride**  
Catching and Absorbing Light
-  **Stainless Steel**  
Conducting Heat
-  **Copper**  
Trapping Infrared Radiation

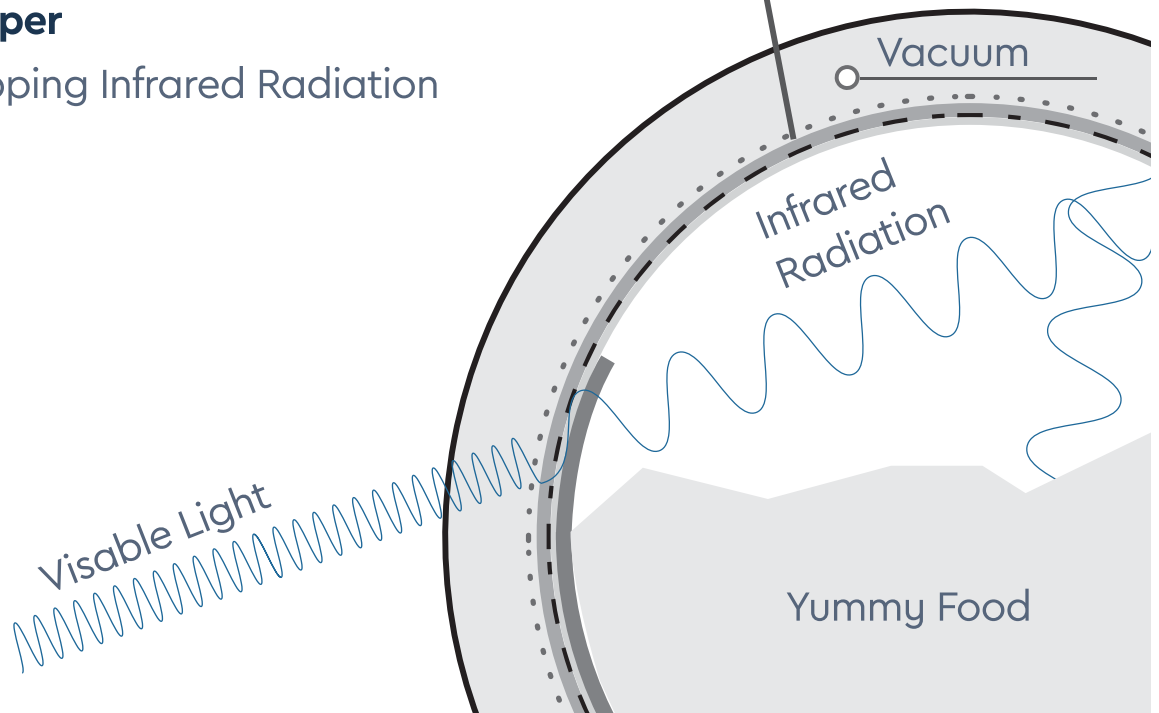
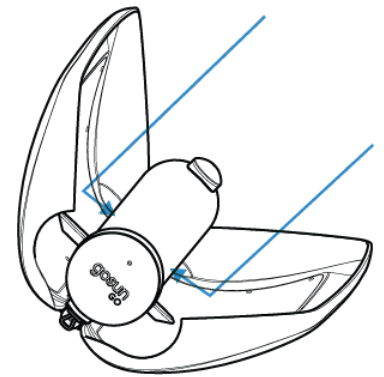

# Specifications

- **Cooking Capacity:** 12.5 fl oz (370 mL)
- **Boiling Capacity:** 13.5 fl oz (400 mL)
- **Dry Weight:** 2 lbs (0.9 kg)
- **Unit Size:** Length: 14.17" (36 cm), Height: 7" (17.78 cm), Width: 3.15" (8cm)
- **Maximum Temperature** 550 °F (288 °C)
- **Working Temperature** 200 °F (93 °C) – 450 °F (232 °C)
- **Mounting Capability** Mountable with any three-finger mounting accessory.

# Liability Release

By using the GoSun Go, the Purchaser and User acknowledges that cooking is an activity that puts you at some amount of risk. The Purchaser and User also acknowledge that it is critical to have read and understood the entire contents of the User's Manual. GoSun is not liable for damage or injury caused by misuse, abuse, or results from failure to implement the proper safety precautions.

The Purchaser and User will thus release of the rights to sue for injuries or death resulting from the purchased, donated, loaned, rented, modified, or repaired equipment received from GoSun.

Purchaser and Users also understands that GoSun, and its employees, owners, officers, or agents (hereinafter "Released Parties"), shall not be held liable or responsible in any way for injury, death, or other damages to the User or his/her family, heirs, or assigns which may occur as a result of the sold, donated, loaned, repaired, or modified equipment, or as a result of product defect, wear and tear, or the negligence of any party, including the Released Parties, whether passive or active.

# Warranty

**To activate your warranty, register at:**  
**[gosun.co/register](https://gosun.co/register)**

The GoSun Go evacuated tube is made of glass — It uses the same tough borosilicate glass as Pyrex, but it can break. All purchases are backed with a One-Year Limited Tube Warranty on the evacuated tube.

We're ensuring your satisfaction with a No-Questions-Asked-Policy; if you break the tube for any reason, we will cover the one-time cost of a new tube. You will have to cover a nominal shipping and handling fee. You will be required to provide some information, but you will not have to return the damaged tube. To claim your warranty, read the Warranty Policy below and send an email to [support@gosun.co](mailto:support@gosun.co) and follow instructions provided. Please direct your warranty inquiries either to your local retailer or to GoSun at [support@gosun.co](mailto:support@gosun.co). The rest of the package is guaranteed from manufacturing defects by a One-Year Limited Warranty. This does not cover damage caused by normal wear and tear, accident, improper care or cleaning, non-standard usage or negligence. Any replacements or exchanges will be at the discretion of GoSun Stove, based on the type of product sent in and the availability of replacement parts. Typically, most issues can be resolved with a little guidance or a replacement part.

## Warranty Policy

GoSun, Inc. extends this Limited Warranty to the original end-use purchaser of GoSun products\* or the person receiving a Product as a gift, provided that the GoSun Stove Product was purchased from an Authorized Dealer as defined below. The Limited Warranty does not extend to any other person or transferee. Statutory or common law may provide additional rights or remedies that vary from state to state, and country to country, which are not affected by this Limited Warranty.

## Definitions

"Authorized Dealer" means any distributor, reseller or retailer that was duly authorized by GoSun at the time of the sale to sell authentic GoSun products in the jurisdiction where it sold the Product, and that sold the Product in new, unused condition in its original packaging.

"Fraud or Misrepresentation" means misrepresenting any fact related to a warranty claim to GoSun, including the nature of the defect, whether the Product was purchased from an Authorized Dealer, and the authenticity of the Product. "Intended Use" means use of the Product (a) for food preparation, (b) for private (as opposed to commercial) purposes, (c) in conformity with all applicable local, state or federal law, code or regulations, (d) in accordance with GoSun recommendations and/or instructions in the materials and documentation that accompany the Product.

## Scope of One-Year Limited Tube Warranty

Evacuated tube failures claimed, submitted, reviewed and approved by GoSun, within one year of original purchase, will convert into a One-Time Tube Credit to the purchaser. The One-Time Tube Credit is then applied to a replacement tube to be sent directly to the purchaser's address of choice. This Credit for may not be used toward any other GoSun products such as GoSun Apparel and accessories. Note that GoSun regularly changes the models, and styles of its Products and cannot guarantee the availability of an exact replacement for any Product. The Purchaser will be responsible for the cost of shipping and handling fees to receive their replacement tube. The exact cost for shipping and handling will be covered during the warranty claim process.

## Scope of One-Year Limited Warranty

GoSun provides a One-Year Limited Warranty against Manufacturing Defects. If a Product contained a Manufacturing Defect when it was purchased from an Authorized Dealer, GoSun, at its sole discretion, will (i) repair, (ii) replace, or (iii) provide a Warranty Credit for the Product on the GoSun online store. The amount of the Warranty Credit shall be equal to the purchase price of the Product paid to the Authorized Dealer. GoSun reserves the right to inspect any Product subject to a warranty claim to determine, at its sole discretion, whether the claimed defect is a Manufacturing Defect or otherwise. GOSUN DOES NOT ASSUME ANY LIABILITY FOR ANY INCIDENTAL, CONSEQUENTIAL OR INDIRECT DAMAGES UNDER THIS LIMITED WARRANTY.

# Terms and Conditions

By submitting this warranty request, you agree to the following Terms and Conditions:

- In the case of Fraud or Misrepresentation, GoSun reserves the right to deny all warranty coverage or claims.
- Risk of Loss- GoSun is not responsible for any Product that is lost in shipping and not actually received by GoSun. To avoid unnecessary delays and minimize the possibility of a lost Product, we strongly suggest that you use the return label provided to you by GoSun's online warranty system to send your Product to GoSun. No warranty will be provided for any Product not actually received by GoSun.
- GoSun reserves the right to determine, at its sole discretion, whether a defect is a manufacturing defect and what type of credit or replacement shall be issued, if any.
- All warranty Products sent to GoSun will not be returned to you for any reason. Defective Products may be subject to engineering analysis and recycling, as part of our continued commitment to improving the quality of our products and the environment.

## Choice of Law / Jurisdiction

This Limited Warranty and any disputes arising out of or in connection with this Limited Warranty ("Disputes") shall be governed by the laws of the State of Ohio, USA, excluding conflicts of law principles and excluding the Convention for the International Sale of Goods. The courts located in the State of Ohio, USA shall have exclusive jurisdiction over any Disputes.

## Other Rights

THIS LIMITED WARRANTY GIVES YOU SPECIFIC LEGAL RIGHTS, AND YOU MAY ALSO HAVE OTHER RIGHTS, WHICH VARY FROM STATE TO STATE AND JURISDICTION TO JURISDICTION, AND WHICH SHALL NOT BE AFFECTED BY THIS LIMITED WARRANTY. THIS WARRANTY EXTENDS ONLY TO YOU AND CANNOT BE TRANSFERRED OR ASSIGNED. If any provision of this Limited Warranty is unlawful, void or unenforceable, that provision shall be deemed severable and shall not affect any remaining provisions. In case of any inconsistency between the English and other versions of this Limited Warranty, the English version shall prevail.

## Refunds and Exchanges

All refunds and exchanges are handled through your retailer or distributor.

# Need help?

 +1 888.868.6154

 [support@gosun.co](mailto:support@gosun.co)

 [gosun.co/help-center](https://gosun.co/help-center)



@gosun



Patent pending in USA & other countries.  
Copyright © 2021 GoSun Inc. All rights reserved

 +1 888.868.6154

 [support@gosun.co](mailto:support@gosun.co)