

Portable, battery-powered  
solar water filter & pump



 [gosun.co/manuals](https://gosun.co/manuals)

Manual de usuario en Espanol

Manuel d'utilisation en Français

Gebruikershandleiding auf Deutsch

日本語のユーザーマニュアル

中文用 手册



# Table of Contents

Best Practices	3
Warnings and Limitations	4
Parts List	5
Available Accessories	6
Storage Case	7
Filter	8–9
Usage modes	
A – Filter only (sucking)	10
B – Filter only (bottle or bag)	11
C – Pump and filter water	12–13
D – Pump water without filter	14–15
E – Using faucet / sink / shower	16–17
F – Make hot water with GoSun Fusion	18–19
G – Make hot water with submersible heater	20–21
Maintenance	22–23
Powerbank	24–25
Troubleshooting	26–27
Warranty	28

# Best practices when traveling abroad.

When traveling abroad, there are greater risks of illness from the water born diseases like Giardia, cysts, viruses and bacteria. These harmful microorganisms are often present in food and water.

To minimize the risk of contracting any water-born illness, we suggest that you:

- ✓ Consult with your physician, state health department, or clinic 4–6 weeks before departing. While traveling...
- ✓ Make sure all of your food is fully cooked.
- ✓ Choose noncooked foods (nuts, fruits, etc) which have intact shells or skins, and clean hands before peeling.
- ✓ Wash hands with soap and water often, especially before eating.
- ✓ Ensure that all the water you drink is microbiologically filtered by your GoSun filter.

There is no guarantee that you won't become sick while traveling. However, you can make sure that your drinking water is microbiologically safe with your GoSun filter.

# Warnings & Limitations

Read before use

## Water Filter

- ✓ Can only filter tap water or fresh water from natural water sources like rivers and lakes. Not appropriate for use on saltwater, drinks, or chemical sources.
- ✓ To avoid damaging the filter cartridge, do not filter water outside the temperature range of 35°F (2°C) – 131°F (55°C).
- ✓ Please clean or replace the polypropylene filter disc if it becomes dirty, to prevent bacteria growth.
- ✓ If the flow rate significantly drops, replace filter cartridge immediately.
- ✓ Flush filter cartridge with clean (or filtered) water after using. Drain well, then air-dry. Do not store filter cartridge in humid place where bacteria or mold may grow. Ensure that all the water you drink is microbiologically filtered by your GoSun filter.
- ✓ Don't expose the water filter cartridge to sunlight for too long. High temperature and long UV exposure can damage filter materials.

## Water Pump

- ✓ USB Pump is not waterproof. Do not submerge in water.
- ✓ Do not run air through the pump for a long time. Doing so may cause the motor to overheat and degrade.
- ✓ Do not pump without using mesh pre-filter on Intake Hose.



(this page is intentionally blank)

# Parts

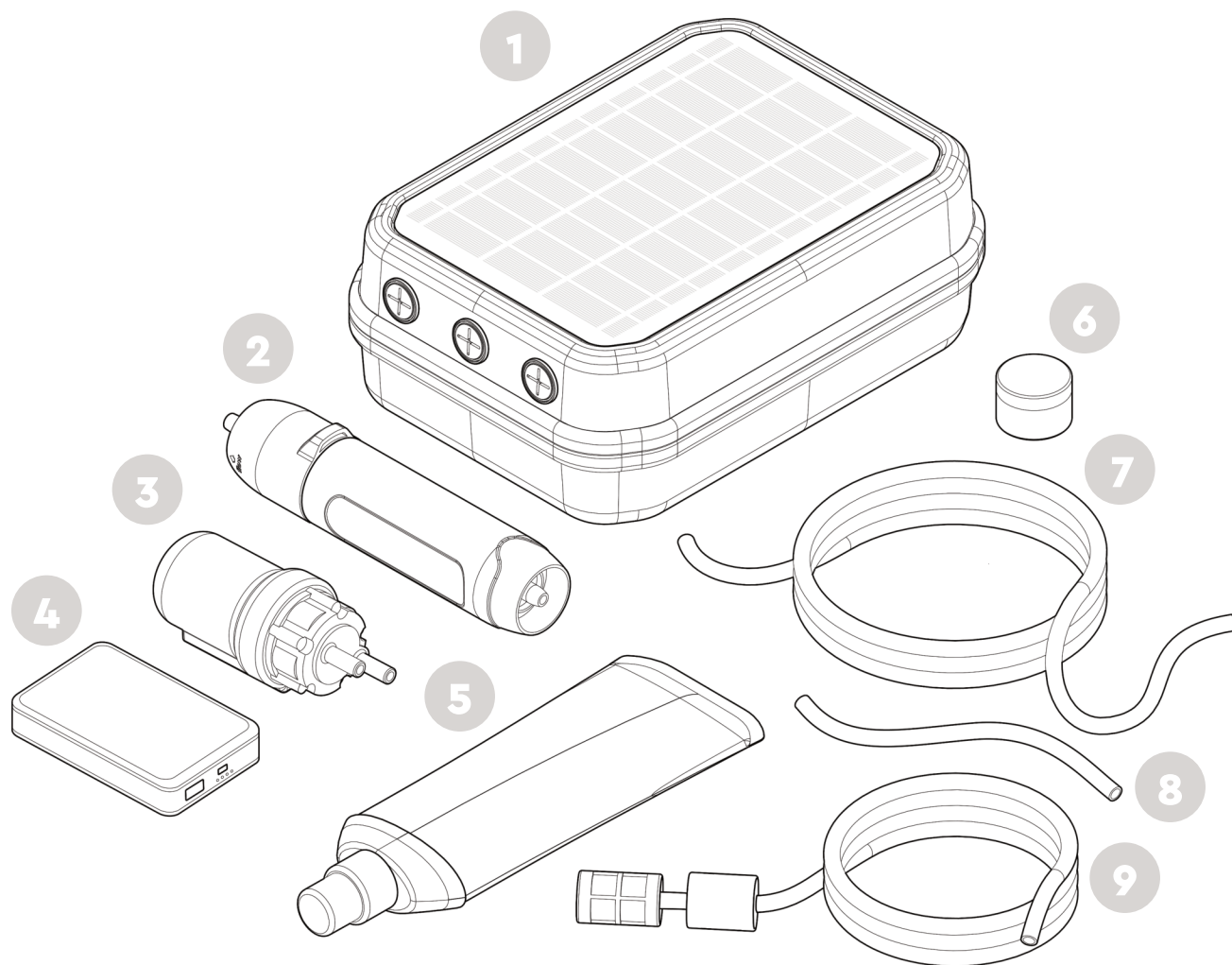

- 1 Storage Case
- 2 Water Filter
- 3 Water Pump

- 4 Powerbank
- 5 Water Pouch
- 6 Extra Filters

- 7 Long Hose
- 8 Short Hose
- 9 Intake Hose

# Available Accessories

① Portable Sink Basin

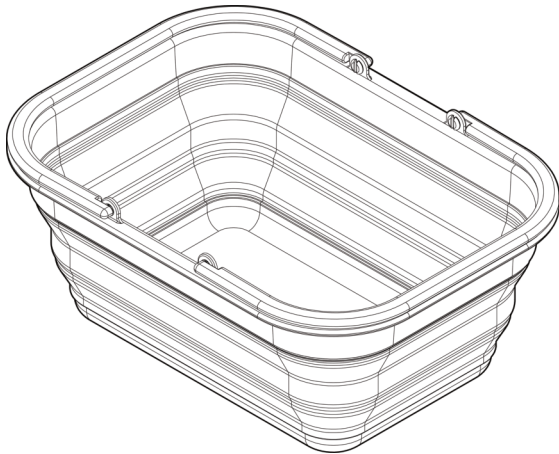

② Faucet / Shower

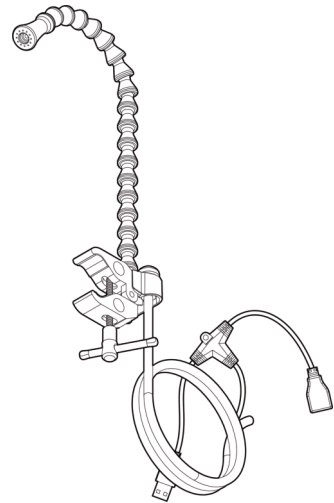

③ GoSun Thermo

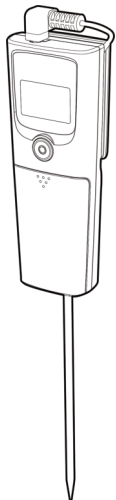

⑤ Submersible heater

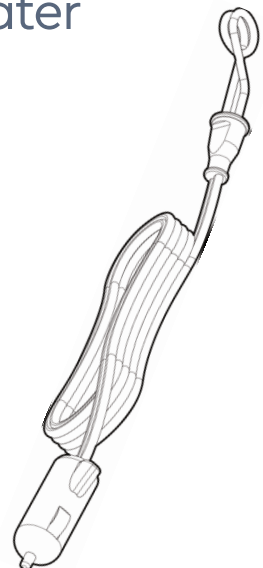

④ Powerbank

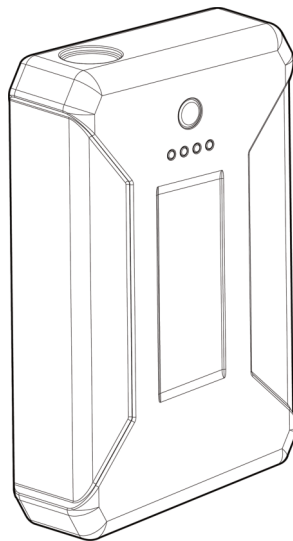

# Storage Case

## How to position parts in Storage Case

1. The Pump, Filter and Powerbank get stored in the Top half of the Storage Case (the half with the solar panel)
2. To secure a part, open the velcro strap. Place the part down onto the rubber pad and firmly close the velcro strap.
3. Position each part in the Case as shown below.

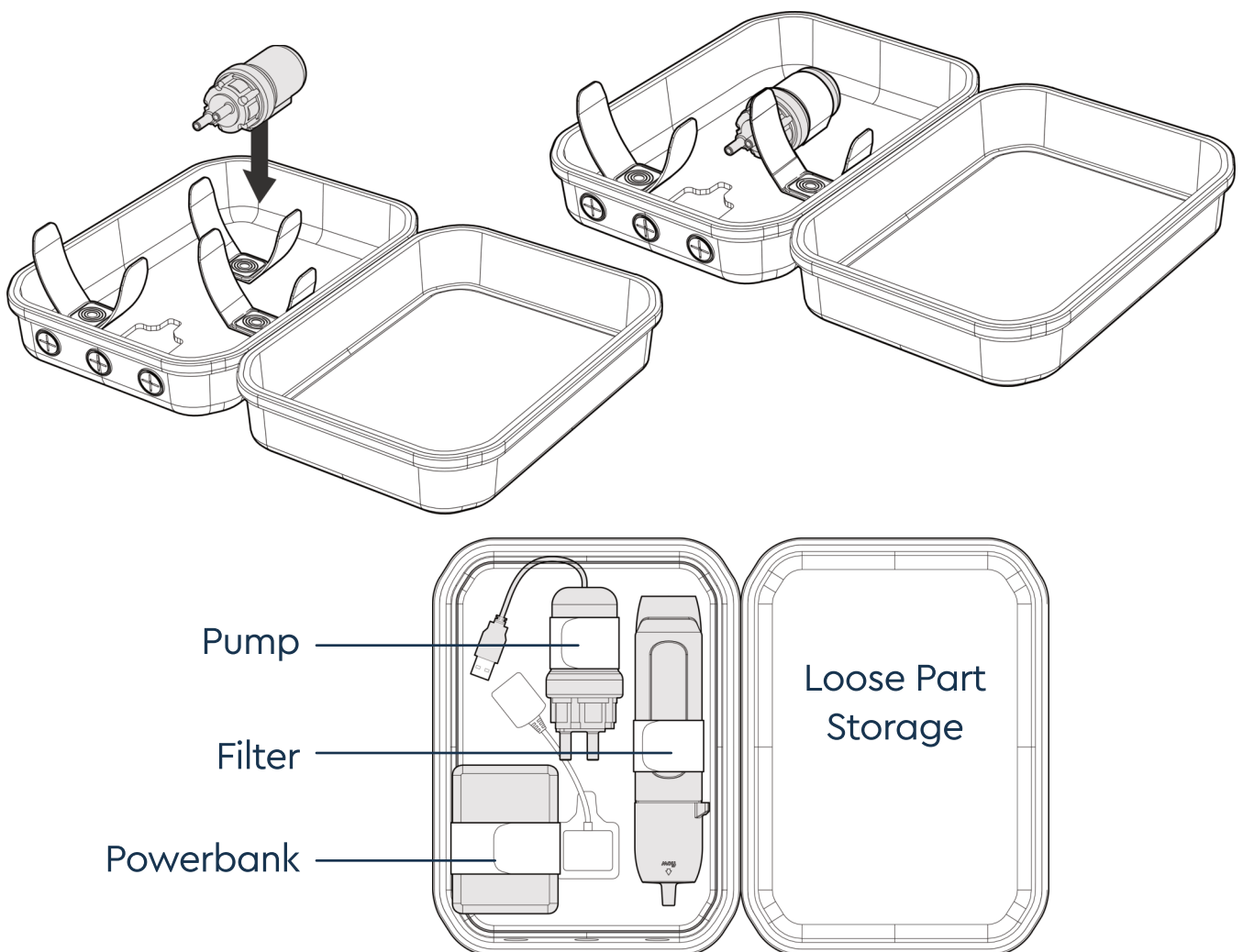

# Filter Parts

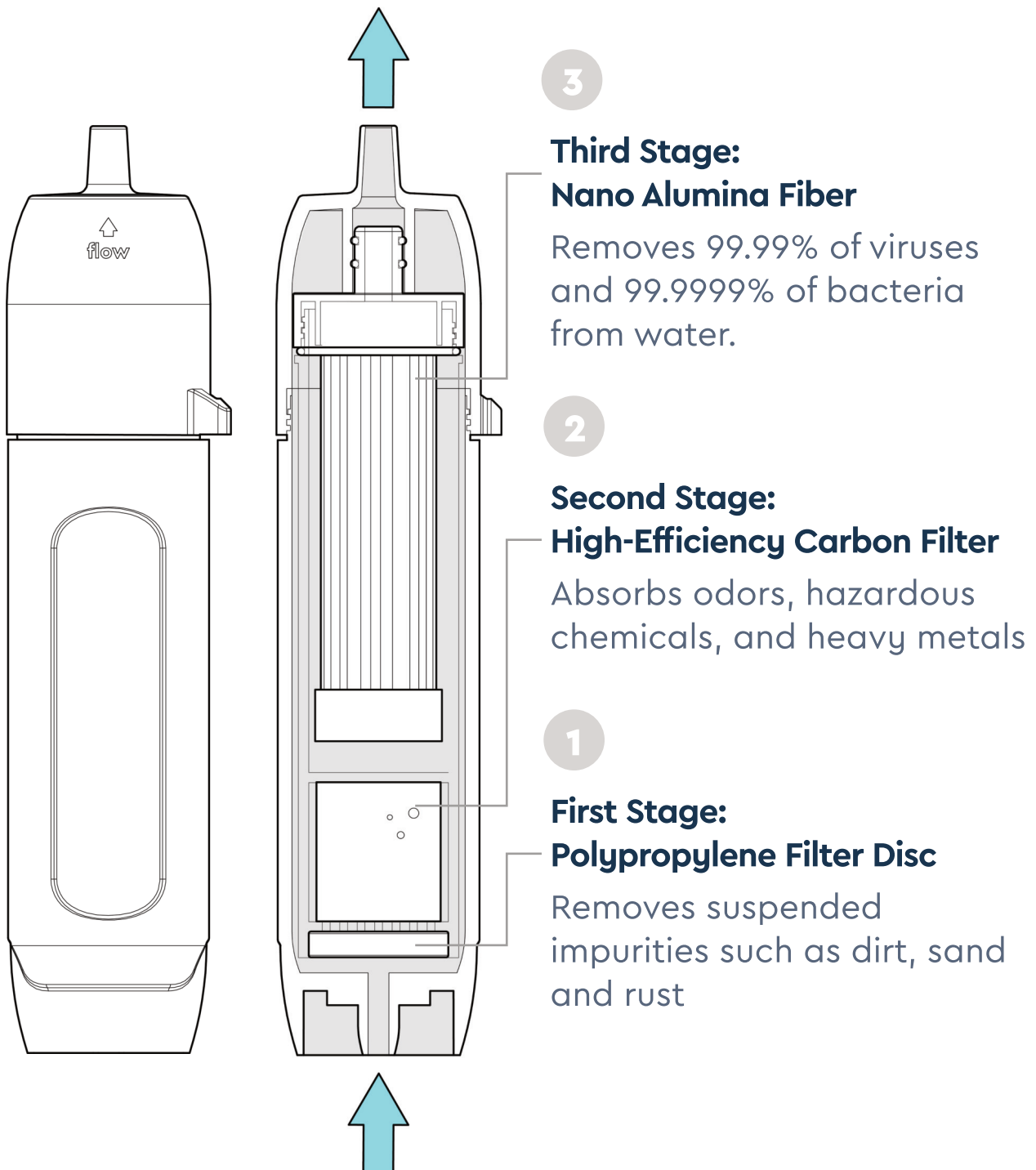

# Filter Replacement

## When to replace your filter

**There are a few situations that would indicate it is time to replace your filter cartridge:**

1. The flow rate through the filter is reduced to roughly one half the original flow rate (please make sure the intake hose pre-filter, and sediment filter disk are not dirty/clogged before replacing the main filter cartridge).
  - ▶ The filter is becoming clogged and is past its useful life. The filter is still functioning, but the flow rate is reduced to the point where the pump is under additional strain.
2. If filtering chlorinated water, and the water still maintains a strong chlorine taste.
  - ▶ The activated carbon filter has been consumed and the filter cartridge should be replaced.
3. Water coming from the filter is not clear.
  - ▶ The Alumina filter element has likely been physically damaged and must be replaced. Please note: The filter cannot remove some substances, like the pigment in brewed tea, even when fully functional.

(this page is intentionally blank)

# Mode A

## Filter only (sucking)

1. Open Storage Case
2. Remove the Filter from the case.
3. Attach the intake hose with the pre-filter screen to the input of the filter. Place the intake hose screen into the water.
4. Suck to filter water
5. (Optional) – The filter input can be placed directly in the water without the intake hose and screen if needed.

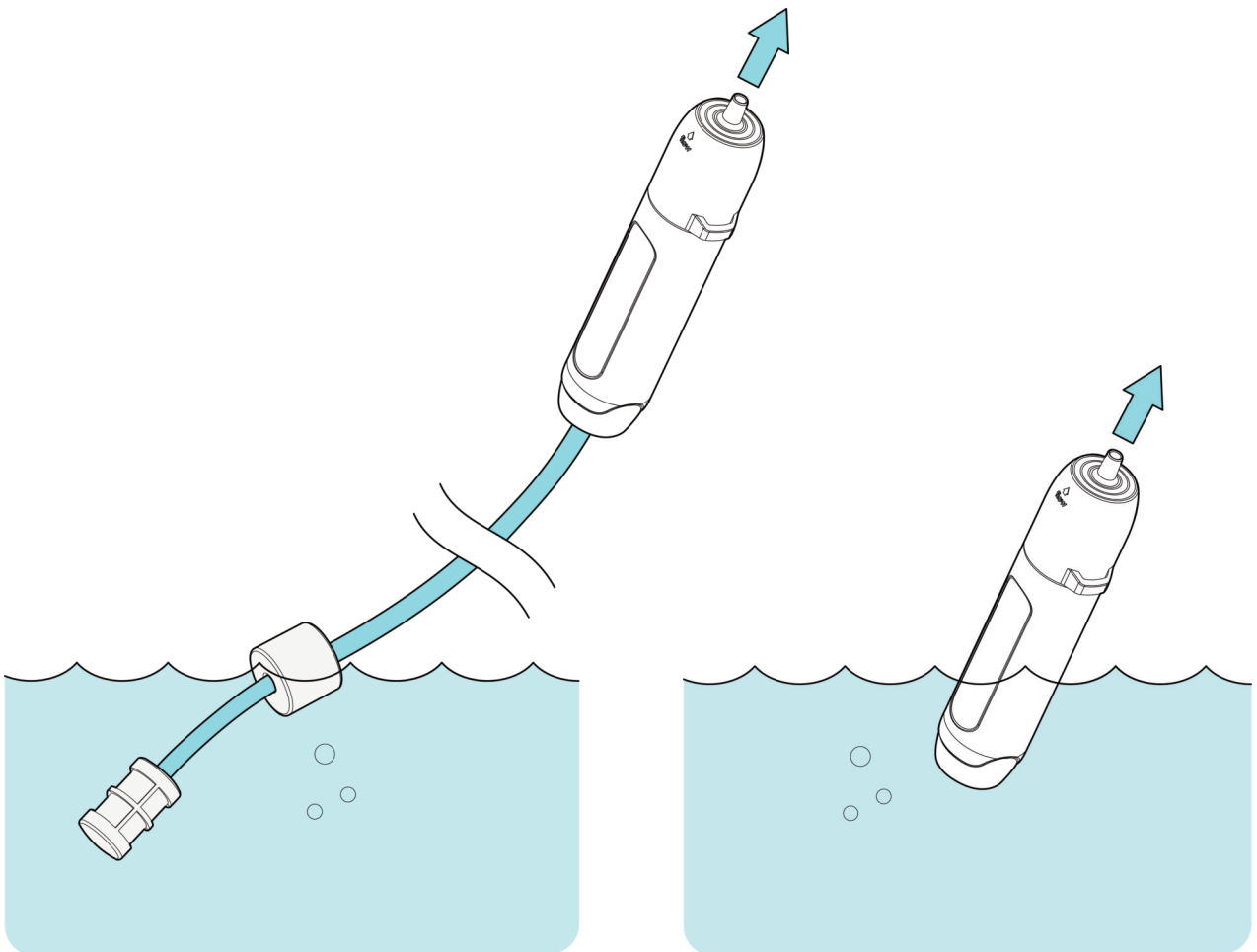



# Mode B

## Filter only (bottle or bag)

1. Open Storage Case
2. Remove the Filter from the case.
3. Attach the included foldable water bag, or other standard 20 Oz or 2 liter plastic drink bottle that has been filled with unfiltered fresh water to the filter input. The bottle or bag should thread on by rotating the bottle clockwise.
4. Squeeze the bottle or bag as needed to filter the water.

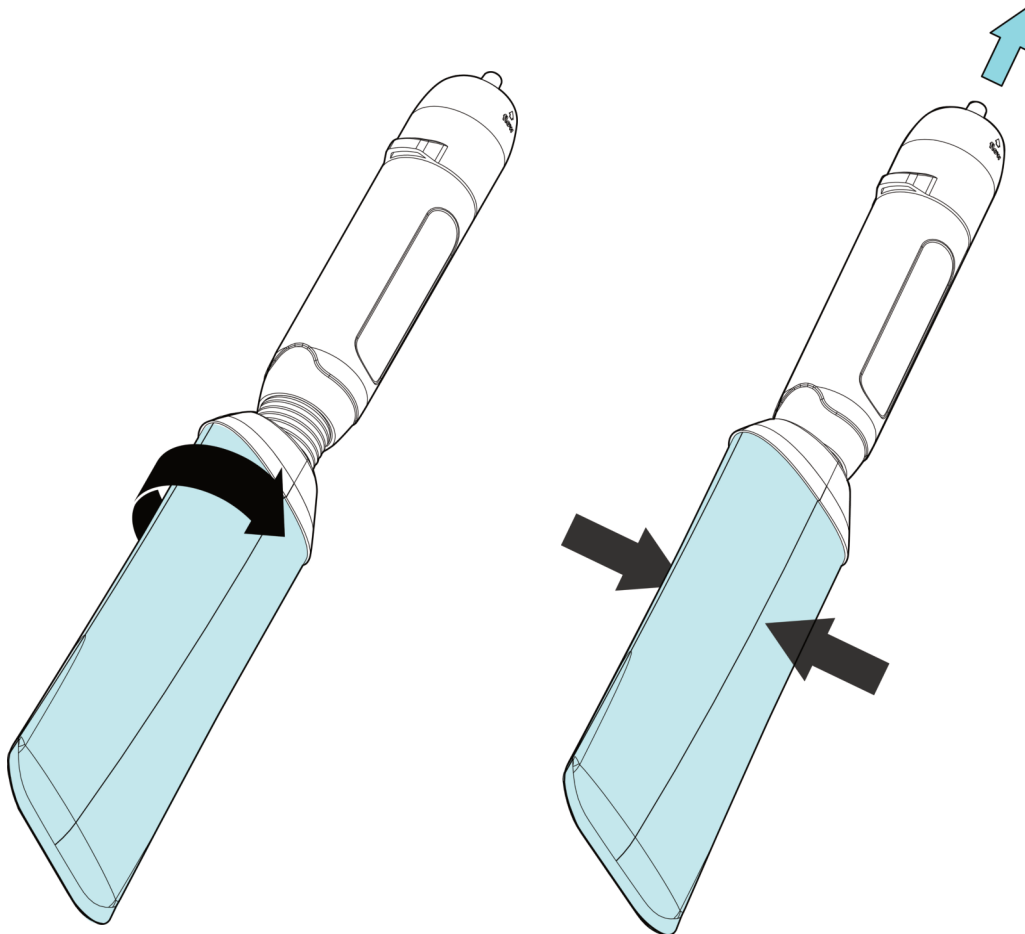

# Mode C

## Pump and filter water

1. Open Storage Case
2. Locate the three hoses – Short, Long and Intake
3. Insert end of intake hose through the Left port and connect to the Intake side of Pump
4. Attach one end of the Short hose to the Outtake side of Pump, and the other end to the Intake side of the Filter
5. Insert one end of the Long hose through the Right port and connect to the Outtake side of the Filter

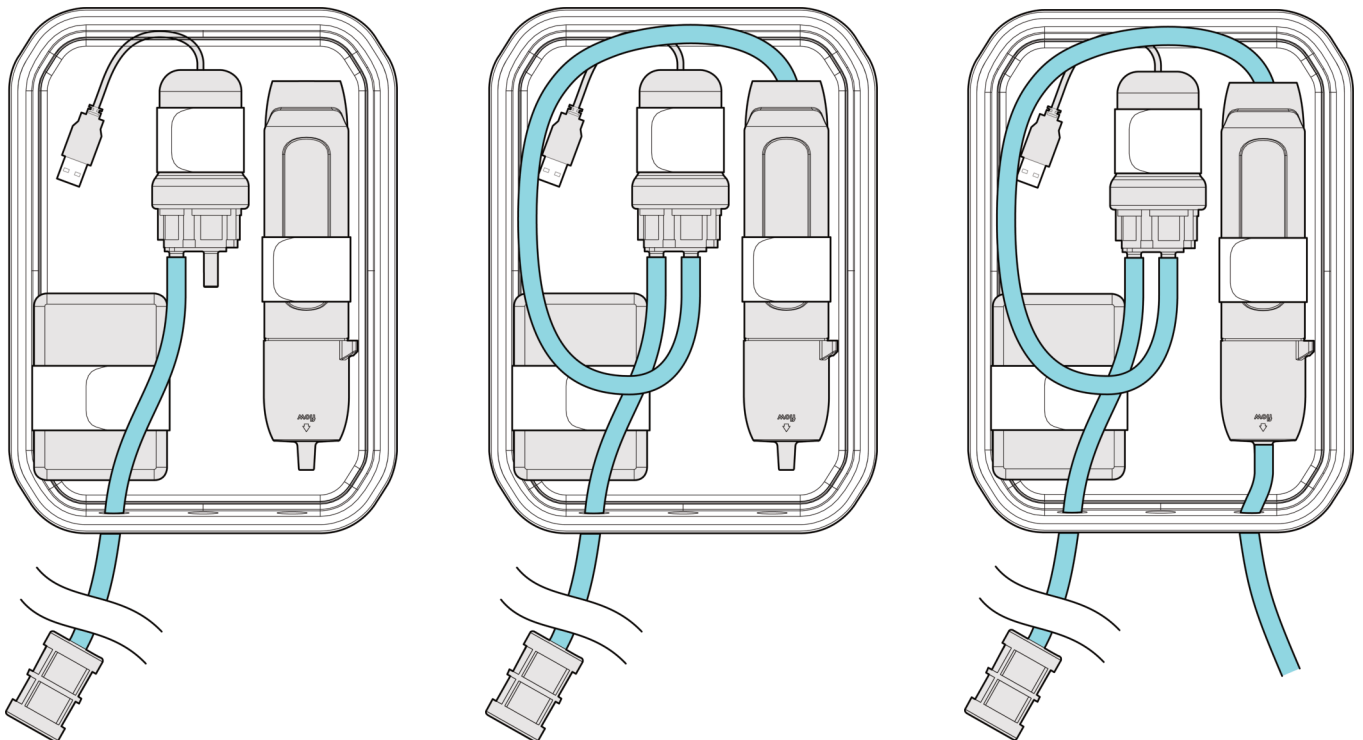

6. Locate freshwater source (not salt water), and place the Intake screen into it. For optimal performance, please ensure that the screen is suspended fully in the water. You may need to adjust the float to achieve this.
7. Place the loose end of the Long hose into your desired collection vessel
8. Plug Pump USB cable into the Solar Panel or Powerbank and enjoy fresh, filtered water!

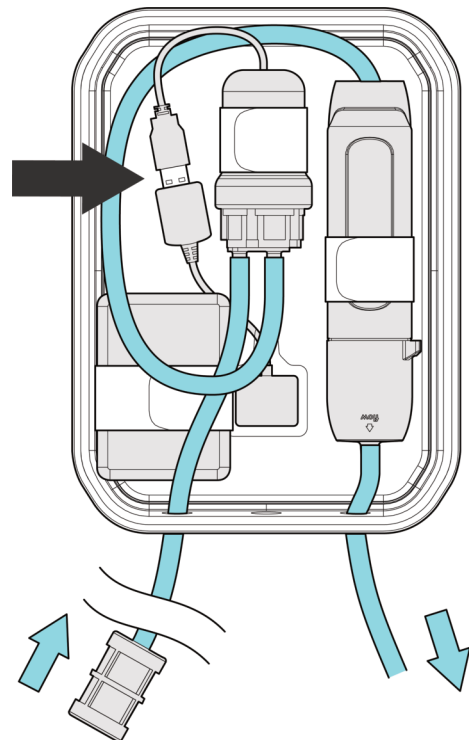
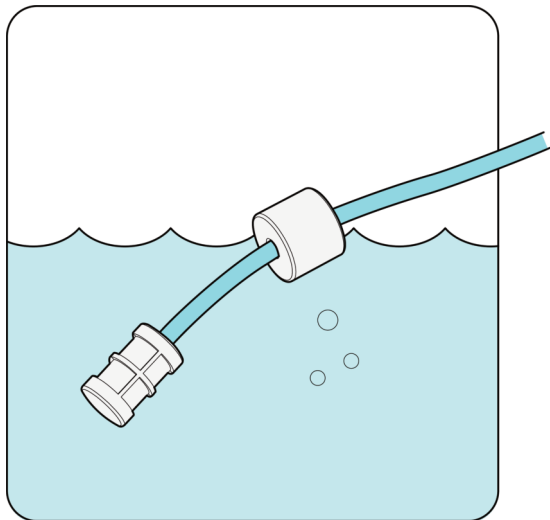

# Mode D

## Pump water without the filter

1. Open Storage Case
2. Locate the two hoses – Long and Intake
3. Insert end of intake hose through the Left port and connect to the Intake side of Pump
4. Insert end of the Long hose through the Right port and connect to the Outtake side of the Pump
5. Locate water source, and place the Intake screen into it. For optimal performance, please ensure that the screen is suspended fully in the water. You may need to adjust the float to achieve this

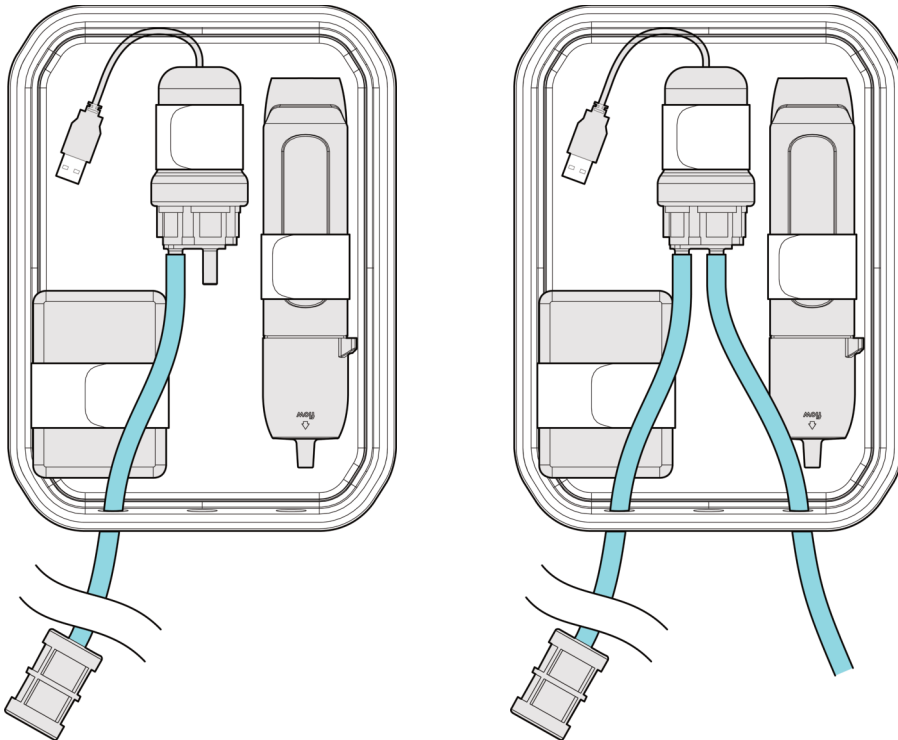

6. If using for drinking water, please ensure that the water source is potable
7. Place the loose end of the Long hose into your desired collection vessel
8. Plug Pump USB cable into the Solar Panel or Powerbank and enjoy!

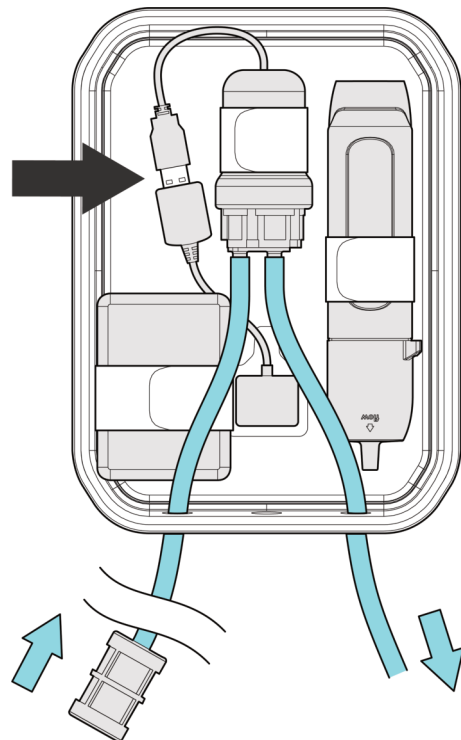
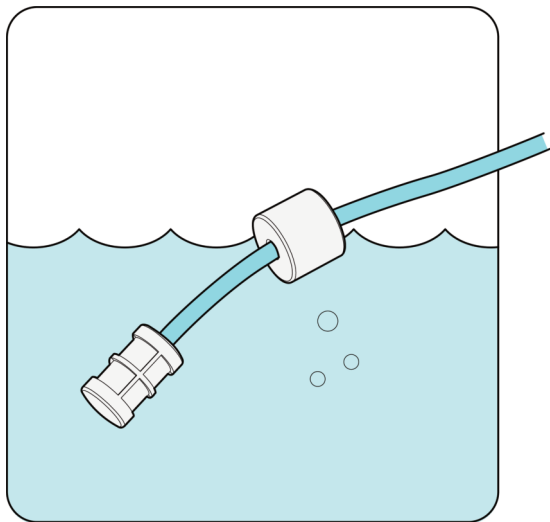

# Mode E

## Using the faucet / sink / shower

1. Follow Steps 1–6 in Mode C (pump and filter) or D (pump only). For the shower, we recommend not using prefiltered water and not having the filter in-line. This will provide the best flow rates.
2. Connect the loose end of the Long hose to the intake stem on the faucet housing
3. Ensure that the Faucet cable is connected to the Long Hose along its length with the small plastic connectors if desired.
4. Insert the faucet cable through the middle Port on the Storage Case.

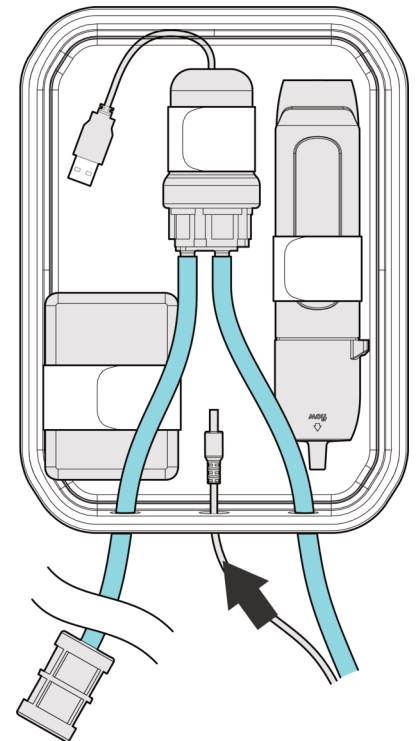
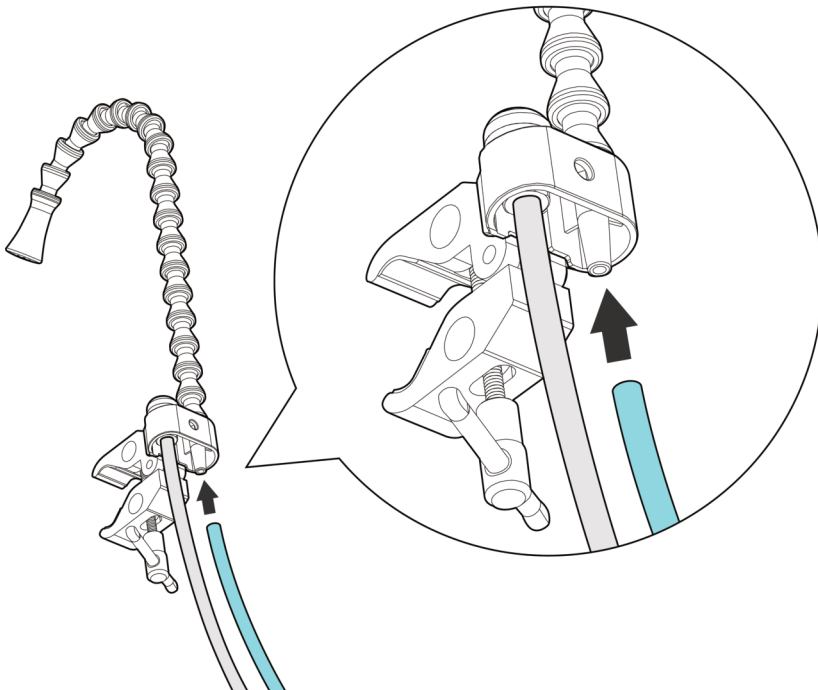

5. Locate the three-part cable split and connect the components to it as shown below.
6. Pop up the Sink basin and attach the faucet clamp to the sink, table, or other desired location.
7. Press the button next to the faucet spout to turn the water on / off. You may need to wait a few seconds on first use for the water to come out.
8. Enjoy! (Optional): use heated water: please refer to Mode F & G

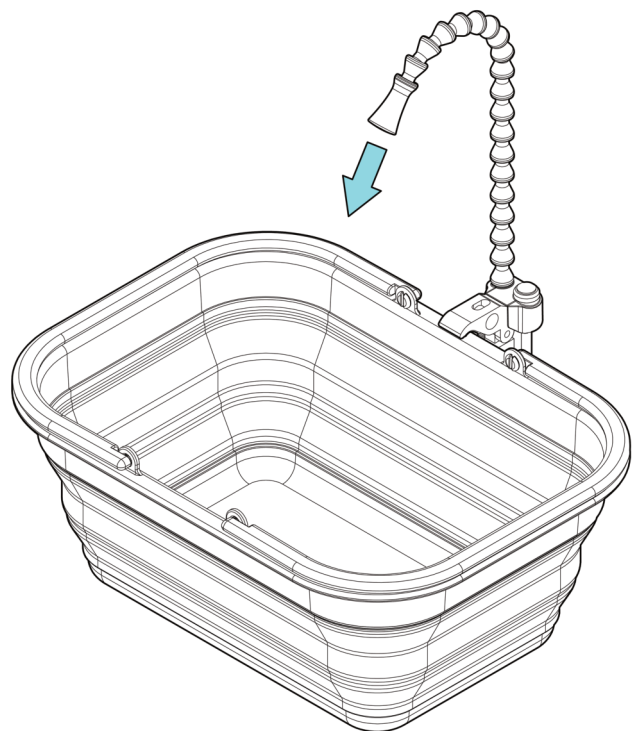
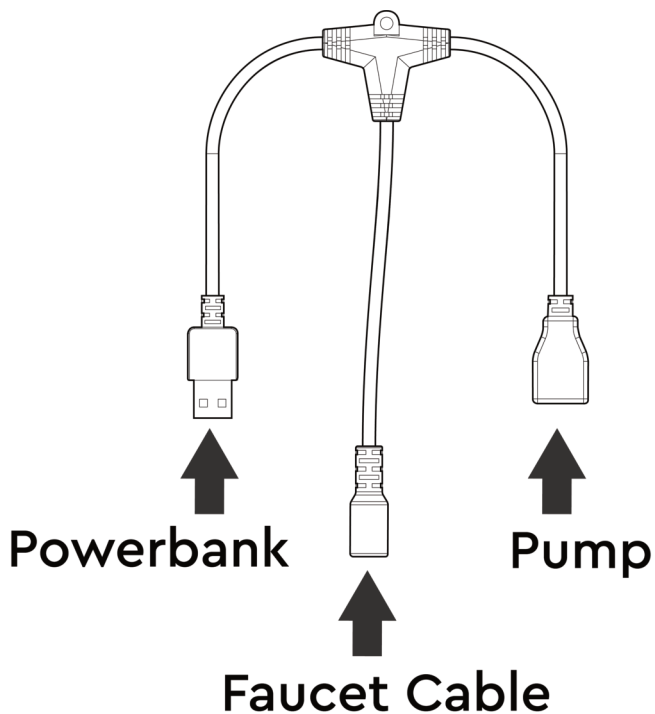

# Mode F

## Making hot water with the GoSun Fusion

1. Only use filtered or potable water (free of particulates which could clog the pump)
2. Locate GoSun Fusion and Vertical Tilt Leg Kit
3. Insert the Legs into the Bracket
4. Tilt the open end of the Fusion up, and insert the Bracket into the Fusion end as shown
5. Press the Bracket into the Fusion end as far as it goes, then lower the Fusion down onto the legs

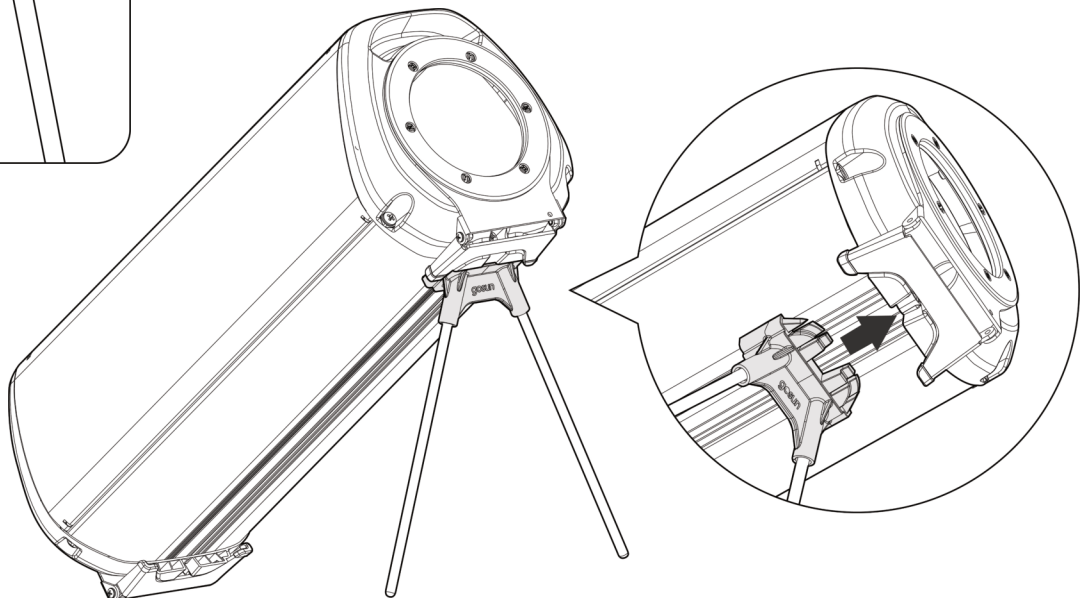
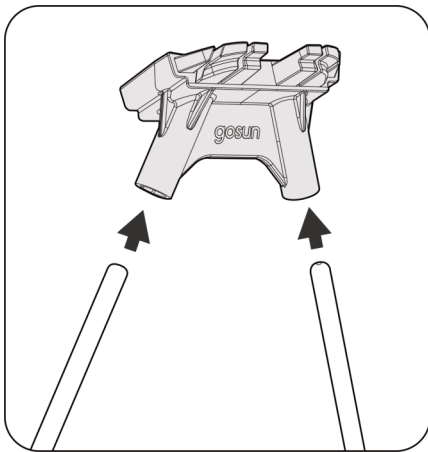



6. Position the Fusion facing the Sun and fill with water. Open the Fusion to the Sun, and close end with the Cap, letting the water heat up inside.
7. To pump the water with Flow, follow steps 1–5 in Mode D.
8. Take the Intake Screen off the of Intake hose and insert that end of the Intake hose through the Fusion Lid.
9. (Optional): Attach the Intake Screen back onto the end of the Intake hose to weight the end of the hose down.
10. To use the heated water with the Sink or Shower, follow steps 2–7 in Mode E.



### Caution

Do not let water exceed **120°F (40°C)** because that can scald skin and/or damage the pump. Use the GoSun Thermo or other thermometer to monitor.

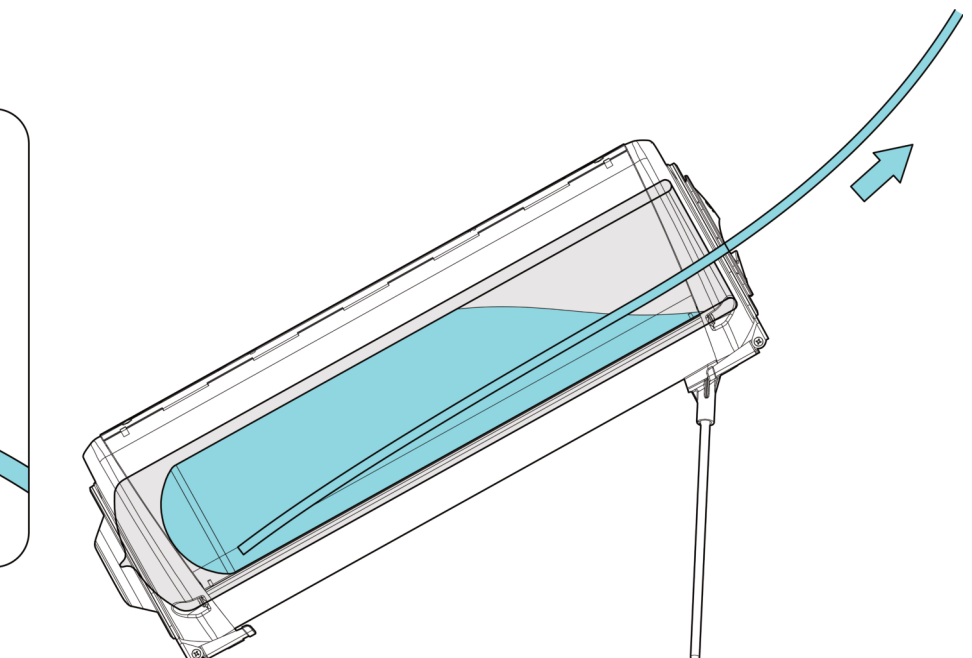
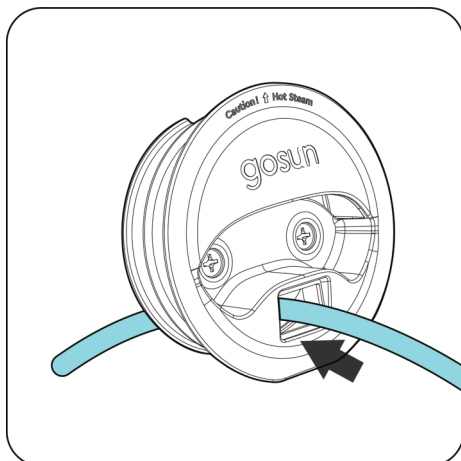

# Mode G

## Making hot water with the GoSun Fusion

1. Only use filtered or potable water (free of particulates which could clog the pump)
2. Locate the Submersible Heater and Large Powerbank
3. Place the Heater end of the Submersible Heater into your water source. Please ensure that the water vessel can safely hold heated water. (Optional – for more efficient heating, you can use the **GoSun Fusion** as a vessel. In that case please follow steps 1–5 in Mode F)

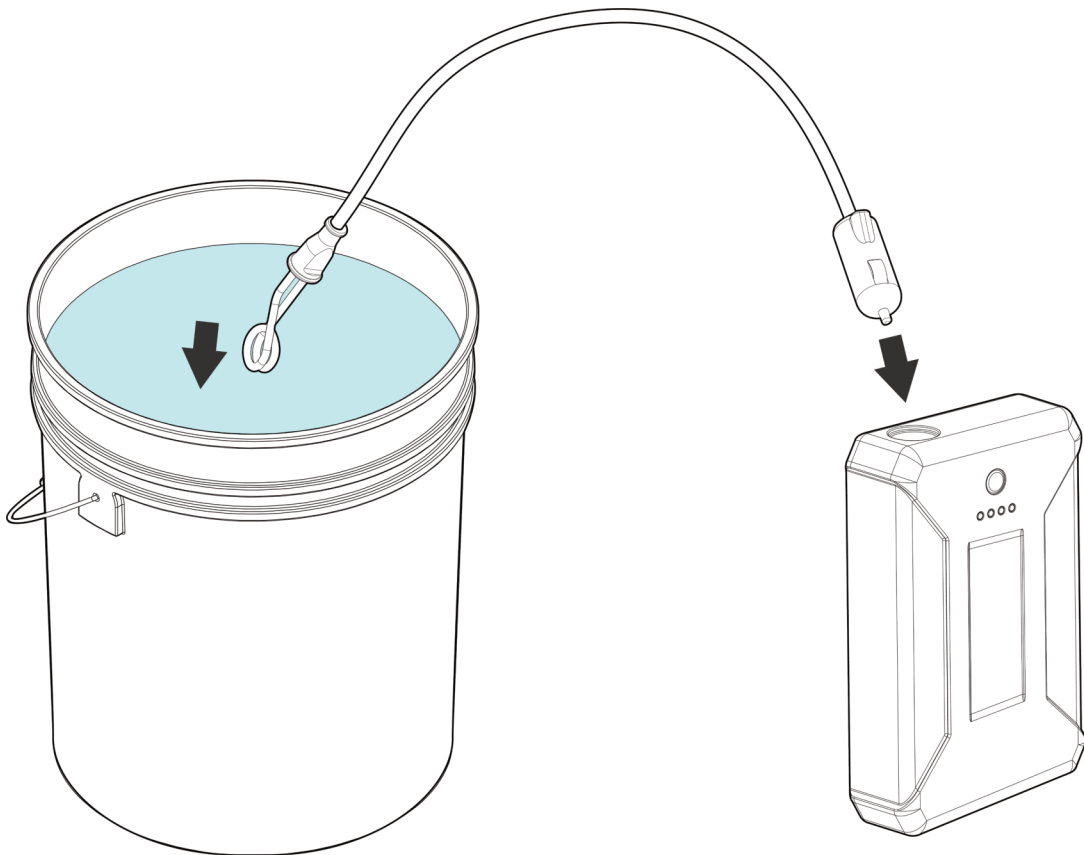

4. Plug the Submersible Heater into the Powerbank and turn the Powerbank on.
5. To pump the water with Flow, follow steps 1–5 in Mode D.
6. To use the heated water with the Sink or Shower, follow steps 2–7 in Mode E.



### Caution

Do not let water exceed **120 °F (40 °C)** because that can scald skin and/or damage the pump. Use the GoSun Thermo or other thermometer to monitor.

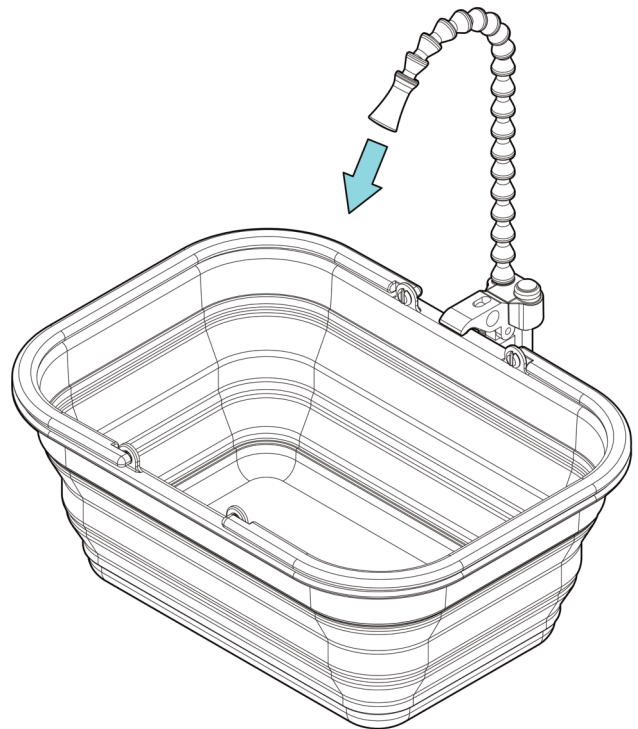
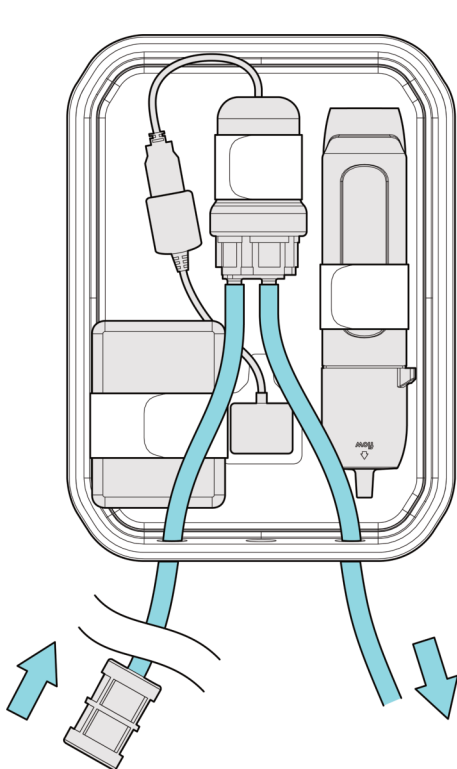

# Maintenance

## Filter cleaning and storage

### Short term storage

Perform these steps when the filter will not be used for 2–3 days or after filtering 100–200 gallons of water

1. Filter a small amount (1–2 cups) of water into a clean container for flushing your filter assembly. If performing maintenance inside, tap water can be used.
2. Remove the pump and filter from the storage case and disconnect all attached hoses.
3. Drain the water from all hoses and store in the case.
4. Connect the pump to the powerbank or solar panel and run for 10–20 seconds to remove any water left in the pump.
5. Disassemble the filter housing and remove the filter cartridge, then disassemble the filter cartridge. (the filter housing and cartridge may still contain water in them)
6. Flush the pleated alumina filter, and the polypropylene filter with clean water – run under tap water or gently stir the pleated filter in a cup of filtered water.\*

\* Do not handle the pleated alumina filter roughly, bend, or twist it, as you may physically compromise the filter element.

\* Do not brush the alumina filter, only flush with clean water using low pressure.

7. Check the polypropylene filter. If the polypropylene filter is persistently dirty, replace it with a fresh filter.
8. Reassemble the filter cartridge, then reassemble the filter housing with filter cartridge installed.

### **Long term storage**

Allow all three filter elements to air dry completely (this may take 2 days or more in some environments) before reassembly. Do not dry the filter in direct sunlight or in a heated enclosure, the UV rays from direct sunlight and excess heat can damage the filter materials.

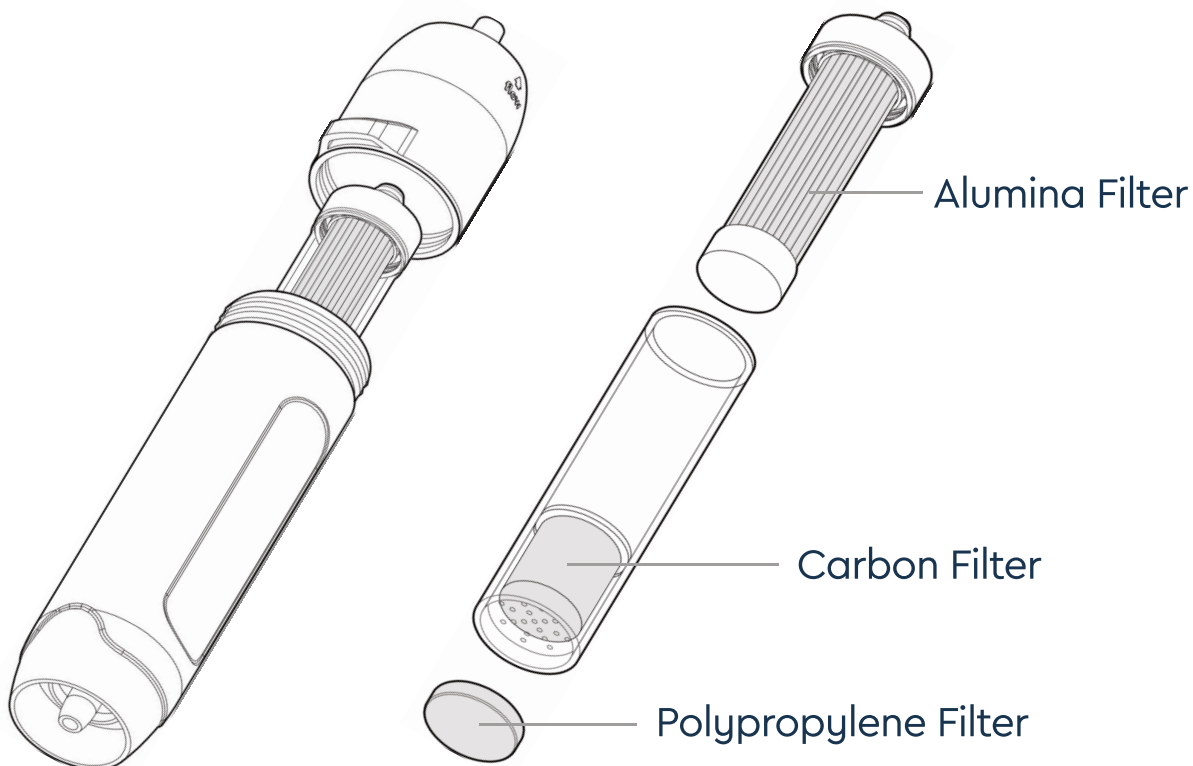

# Maintenance

## How to charge and use the powerbank

### Charge the Powerbank in several ways:

1. **Charge with any USB source:** to charge the powerbank with another USB source (a larger powerbank, wall charger, or other solar phone charger) simply connect the input of the power bank to the new charging source to start charging.
2. **Charge with solar panel:** to charge the power bank with solar, simply plug the charging cable into the power bank input and the solar panel output as shown below. Then, orient the solar panel at the Sun to power. The solar panel will perform best if it is directly facing the Sun.

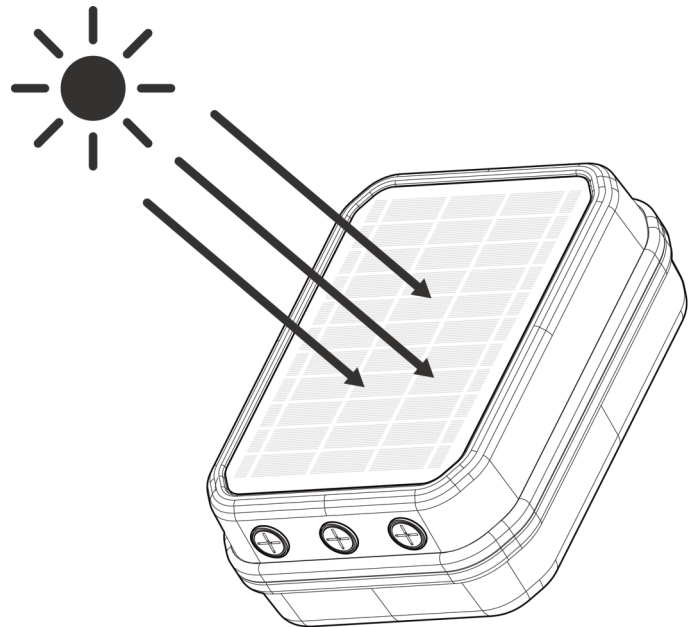
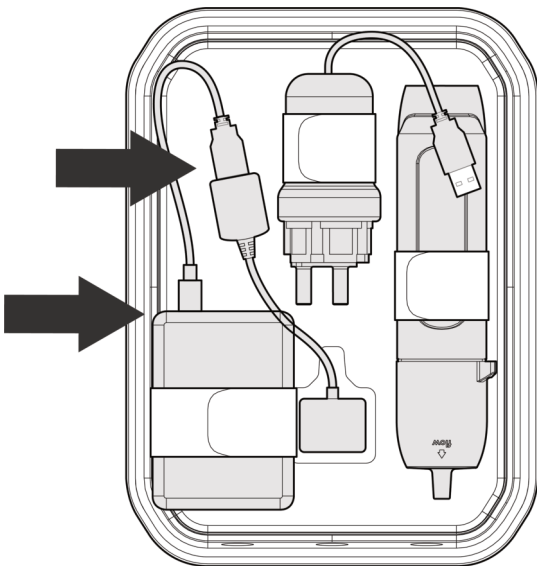

## Power the pump in several ways

1. **Power directly from the included solar panel:** Plug the pump's USB cable into the solar panel cable, and orient the solar panel at the Sun to power. The solar panel will perform best if it is directly facing the Sun.
2. **Power with the Powerbank:** Plug the pump's USB cable into the powerbank to run.
3. **Power with the Powerbank, while charging the solar panel:** If solar charging the powerbank, the Flow can still be used, but the flow will work at a reduced rate if in the shade. If the solar panel is not receiving enough sunlight for the Flow to function as desired, cover the solar panel or disconnect the powerbank from the solar panel to run fully off the powerbank.
4. **Power with any USB source:** Simply connect the pump cable to any USB power source such as a larger powerbank, wall charger, or other solar phone charger.

# Troubleshooting

Problem	Probable Cause
Water flow rate from the Flow is reduced, but the pump is still running fine.	3 stage filter may be clogged Intake filter may be clogged  Hose may be kinked
USB Pump seems to be running slowly, or is running rough.	Low light on solar panel  3 stage filter may be clogged Hose may be kinked
USB Pump is not running when switched on at the faucet	Wire harness connected incorrectly Powerbank stuck in sleep mode  Powerbank is depleted
Water coming out of filter doesn't look clean.	Filter physically damaged  Contaminate is not filterable (chemical content, artificial or natural dye, etc.)



## Solution

Please reference "Filter Replacement" on page 9

Clean the intake filter by flushing with clean water

Check all hoses for kinks and straighten as needed

---

Move panel into full sun, facing the sun as best as possible

Cover solar panel with opaque material

Turn case upside down to fully block light from solar panel

Please reference "Filter Replacement" on page 9

Check all hoses for kinks and straighten as needed

---

Check wire harness connections

Press the button on the powerbank to manually turn it on

Unplug the powerbank, wait 15 seconds, then reconnect

Charge the powerbank for at least 1 hour, then reconnect

---

Replace the 3 stage filter assembly

Find an alternate water source

Unplug the powerbank, wait 15 seconds, then reconnect

---

# Warranty

## Warranty Policy

GoSun Inc. extends this One-Year Limited Warranty to the original end-use purchaser of GoSun products\* or the person receiving a Product as a gift, provided that the GoSun Product was purchased from an Authorized Dealer as defined below. The Limited Warranty does not extend to any other person or transferee. Statutory or common law may provide additional rights or remedies that vary from state to state, and country to country, which are not affected by this Limited Warranty.

## Definitions

"Authorized Dealer" means any distributor, reseller or retailer that was duly authorized by GoSun at the time of the sale to sell authentic GoSun products in the jurisdiction where it sold the Product, and that sold the Product in new, unused condition in its original packaging.

"Fraud Misrepresentation" means misrepresenting any fact related to a warranty claim to GoSun, including the nature of the defect, whether the Product was purchased from an Authorized Dealer, and the authenticity of the Product. "Intended Use" means use of the Product (a) for food preparation, (b) for private (as opposed to commercial) purposes, (c) in conformity with all applicable local, state or federal law, code or regulations, (d) in accordance with GoSun recommendations and/or instructions in the materials and documentation that accompany the Product.

## Scope of One-Year Limited Warranty

GoSun provides a One-Year Limited Warranty against Manufacturing Defects. If a Product contained a Manufacturing Defect when it was purchased from an Authorized Dealer, GoSun, at its sole discretion, will (i) repair, (ii) replace, or (iii) provide a Warranty Credit for the Product on the GoSun online store. The amount of the Warranty Credit shall be equal to the purchase price of the Product paid to the Authorized Dealer. GoSun reserves the right to inspect any Product subject to a warranty claim to determine, at its sole discretion, whether the claimed defect is a Manufacturing Defect or otherwise.

# Need help?

 +1 888.868.6154

 [support@gosun.co](mailto:support@gosun.co)

 [gosun.co/help-center](https://gosun.co/help-center)



@gosun



Patent pending in USA & other countries.  
Copyright © 2021 GoSun Inc. All rights reserved

 +1 888.868.6154

 [support@gosun.co](mailto:support@gosun.co)