

Foldi Mini

Folding Treadmill

USER MANUAL

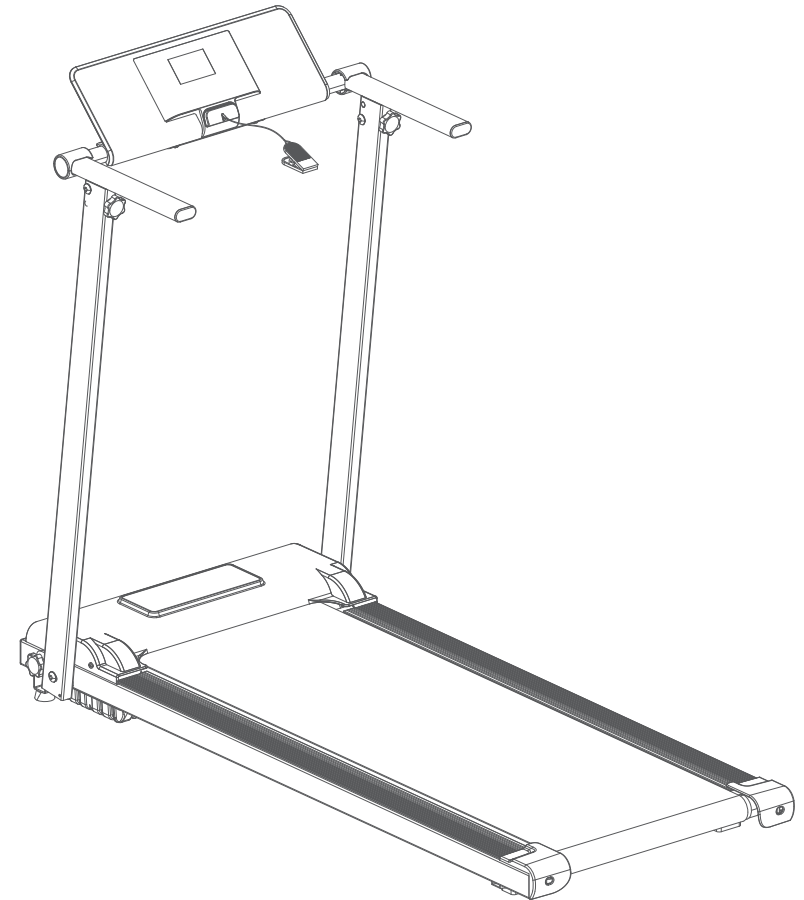

IMPORTANT: Read all instructions carefully before using this product. Retain this owner's manual for future reference.

The specifications of this product may vary from this photo, subject to change without notice.

Manufacturer: Shenzhen Yile Dynamic Technology Co., LTD.

Address: 1205-1206, Tianliao Building, Tangchang Road, Tanglang Community, Taoyuan Street, Nanshan District, Shenzhen, China

Version: V1.0



MADE IN CHINA



TABLE OF CONTENTS

02	CUSTOMER SERVICE
03	IMPORTANT SAFETY INSTRUCTIONS
05	PRODUCT AND ACCESSORIES
06	SPECIFICATION
07	PRODUCT INTRODUCTION
08	ASSEMBLY
12	OPERATION
15	CARE & MAINTENANCE
17	ERROR CODE
18	TROUBLESHOOTING
19	WARRANTY

1 CUSTOMER SERVICE

IMPORTANT: FOR UREVO ONLY

For damaged or defective product, questions, replacement parts or any other service support, please contact our customer service department by the below methods:

services@urevosports.com

Response Time: 24-48 hours

Emailing us with the **Order ID** will be the best method to receive a response during peak business hours.

Website: www.urevosports.com

US Support Hotline: (1)844-998-2473

Hours of Operation: Monday – Friday : 9 AM – 12 PM ; 1 PM – 6 PM (PST)

PLEASE DO NOT RETURN THIS PRODUCT WITHOUT ASKING OUR CUSTOMER SERVICE FIRST.

SCAN THIS QR CORD TO GET THE PRODUCT INSTALLATION OR MAINTENCE VIDEOS



2 IMPORTANT SAFETY INSTRUCTIONS

DANGER - To reduce the risk of electric shock:

1. Always unplug this treadmill from the electrical outlet immediately after using and before cleaning.

WARNING - To reduce the risk of burns, fire, electric shock, or injury to persons:

1. An treadmill should never be left unattended plugged in. Unplug from outlet when not in use, and before putting on or taking off parts.
2. Do not operate under blanket or pillow. Excessive heating can occur and cause fire, electric shock, or injury to persons.
3. Close supervision is necessary when this treadmill is used by, on, or near children, invalids, or disabled persons.
4. Use this treadmill only for its intended use as described in this manual. Do not use attachments not recommended by the manufacturer.
5. Never operate this treadmill if it has a damaged cord or plug, if it is not working properly, if it has been dropped or damaged, or dropped into water. Return the treadmill to a service center for examination and repair.
6. Do not carry this treadmill by supply cord or use cord as a handle.
7. Keep the cord away from heated surfaces.
8. Never operate the treadmill with the air openings blocked. Keep the air openings free of lint, hair, and the like.
9. Never drop or insert any object into any opening.
10. Do not use outdoors.
11. Do not operate where aerosol (spray) products are being used or where oxygen is being administered.
12. Caution - To reduce the risk of injury

from moving parts - Unplug before servicing.

13. Warning - To reduce the risk of Electric shock - Unplug before cleaning or servicing.
14. Warning - Risk of personal injury - Keep children under the age of 13 away from machine.
15. To disconnect, turn all controls to the position, then remove plug from outlet.
16. Connect this treadmill to a properly outlet only. See grounding instructions.
17. This treadmill is not intended for use by persons with reduces physical, sensory or mental capabilities, or lack of experience and knowledge, unless they have been given supervision or instruction concerning use of the treadmill by a person responsible for their safety. Keep children under the age of 13 away from this machine.
18. **The maximum weight capacity for this product is 265lbs/120kg. DO NOT EXCEED MAXIMUM WEIGHT CAPACITY.**

SAVE THESE INSTRUCTIONS

GROUNDING INSTRUCTIONS:

This product must be grounded. If it should malfunction or breakdown, grounding provides a path of least resistance for electric current to reduce the risk of electric and a grounding plug. The plug must be plugged into an appropriate outlet that is properly installed and grounded in accordance with all local codes and ordinances.

DANGER - Improper connection of the equipment-grounding conductor can result in a risk of electric shock. Check

with a qualified electrician or serviceman if you are in doubt as to whether the product is properly grounded. Do not modify the plug provided with the product - if it will not fit the outlet, have a proper outlet installed by a qualified electrician.

FCC STATEMENT :

This device complies with part 15 of the FCC rules.

Operation is subject to the following two conditions:

- (1) This device may not cause harmful interference, and
- (2) This device must accept any interference received, including interference that may cause undesired operation.
- (3) This device has been evaluated to meet general RF exposure requirement. The device can be used in portable exposure condition without restriction.

NOTE: This equipment has been tested and found to comply with the limits for a Class B digital device, pursuant to part 15 of the FCC Rules. These limits are designed to provide reasonable protection against harmful interference in a residential installation. This equipment generates, uses and can radiate radio frequency energy and, if not installed and used in accordance with the instructions, may cause harmful interference to radio communications. However, there is no guarantee that interference will not occur in a particular installation. If this equipment does cause harmful interference to radio or television reception, which can be determined by turning the equipment off and on, the user is encouraged to try to correct the interference by one or more of the following measures:

- Reorient or relocate the receiving antenna.
- Increase the separation between the equipment and receiver.
- Connect the equipment into an outlet on a circuit different from that to which

the receiver is connected.

— Consult the dealer or an experienced radio/TV technician for help.

This Class B digital apparatus complies with Canadian ICES-003.

Cet appareil numérique de la classe B est conforme à la norme NMB-003 du Canada.

3 PRODUCT AND ACCESSORIES

Treadmill

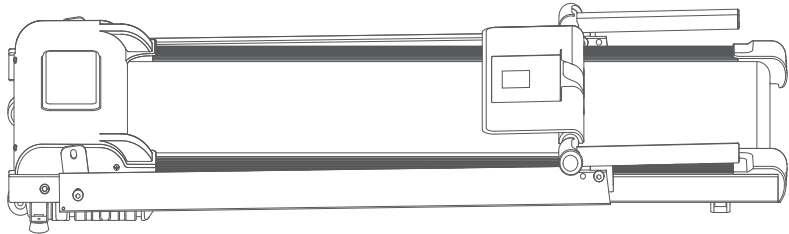

Accessories



6mm L-type
Hex Tool × 1



5mm L-type
Hex Tool × 1

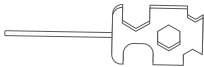

Multi-functional
Open-ended Wrench × 1

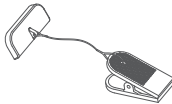

Safety Key × 1



Hexagon Knob A
(58mm) × 2



Hexagon Knob B
(38mm) × 2



Lubricating Oil × 1



User Manual

4 SPECIFICATION

Product configuration	Detailed parameters	Product configuration	Detailed parameters
Product dimension (Folded)	122 x 58 x 13 cm	Product dimension (Assembled)	122 x 60 x 103 cm
	48 x 22.8 x 5.1 inch		48 x 23.6 x 40.6 inch
Running Area	40 x 105 cm	Minimum speed	0.6 mph
	15.7 x 41.3 inch		
Gross weight	26.5 KG	Maximum speed	6.2 mph
	58.4 Lbs		
Net weight	22.6 KG	Rate voltage	110 - 120V ~
	49.8 Lbs	Peak horsepower	2.25 hp
Maximum load	120 KG	Rated power	550W
	265 Lbs	Suggested age	14-60 years old

5 PRODUCT INTRODUCTION

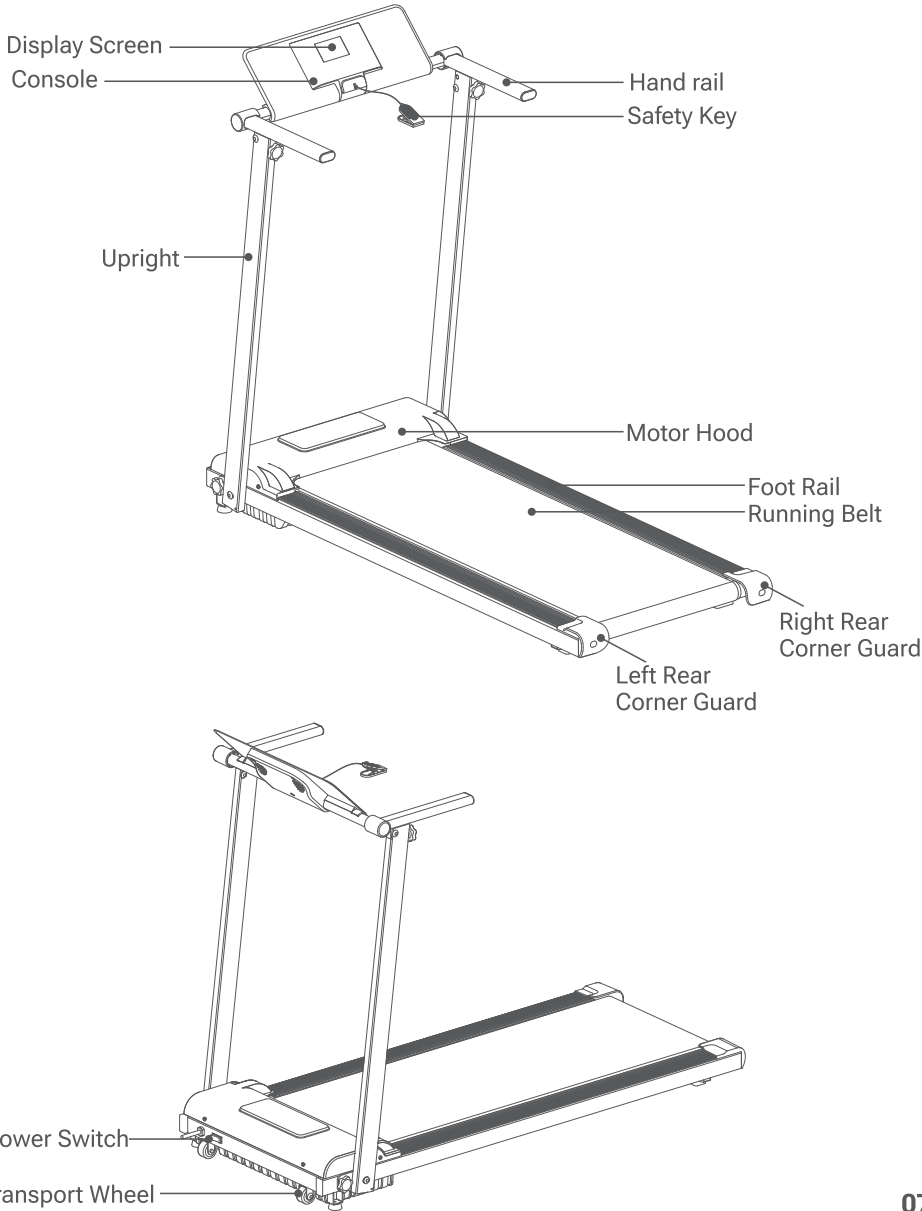

6 ASSEMBLY

Installation preparation

- For safety operation, please select a safe, dry, solid and spacious horizontal surface for installation;
- After receiving the product, remove all parts from the product package. Please carefully check whether the parts and tools are complete according to the packing list.

Installation instructions

- Before installation, please read and understand the important safety steps in the manual carefully.
- Before each installation step, collect the corresponding parts and tools needed;
- Please use the wrench in the tool kit. If there are no special instructions, tighten the bolt and nut to the right (clockwise) and loosen the bolt and nut to the left (counterclockwise).
- When two parts need to be connected, lift the product gently to align with the hole, so that the knob can easily be inserted in the hole.
- Some parts of the product are heavy. Please ensure that two people participate in the assembly, and do not lift heavy parts alone to avoid product or personal damage.

Installation steps

1. a. Lift the upright column to the end position (Fig 1).
b. Press the handrail as illustrated (Fig. 2).
c. Fold up console (Fig. 3).

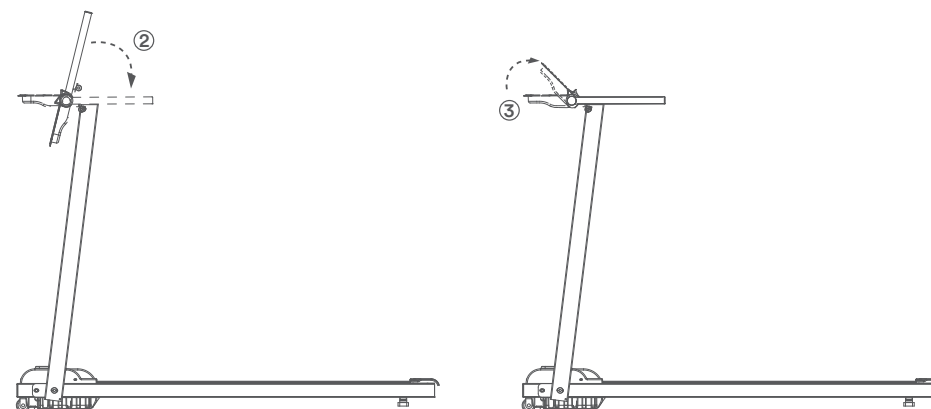
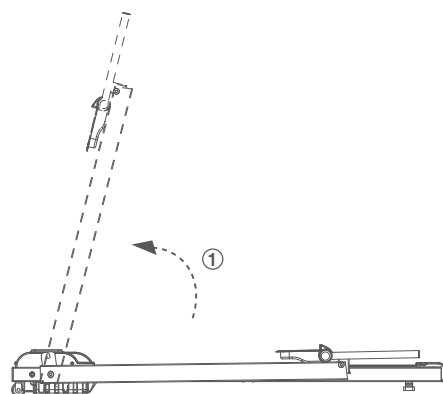

2. Hold the product upright columns, insert **hexagon knob A** and turn them clockwise till tighten ;

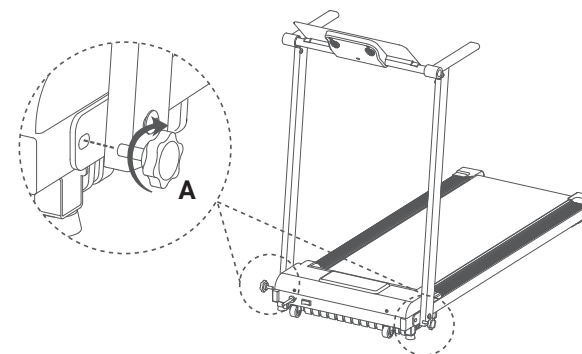

3. Repeat the above steps to tightly fix the handrail to the upright column with **hexagon knob B**.

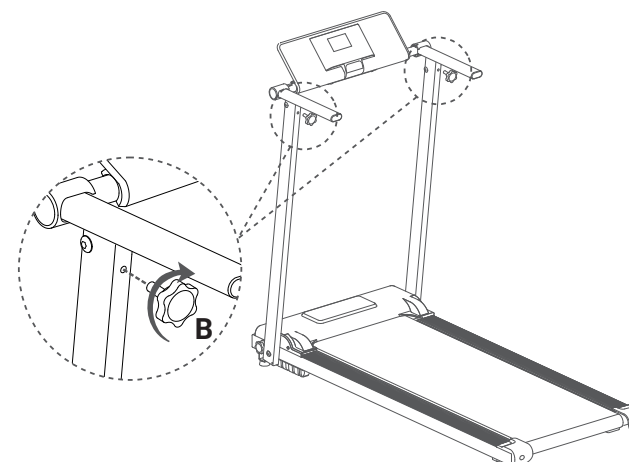

4. Attach the safety key to the yellow mark on the console.

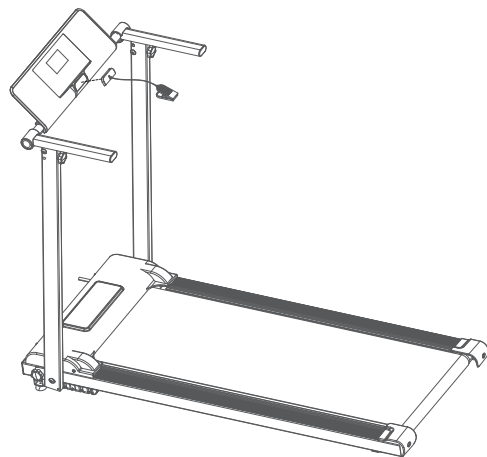

Note:

1. To prevent injury during assembly, please wear gloves and make sure there are two people assembling the product.
2. During product assembly, please pay attention to safety and avoid injury by moving parts.
3. To avoid injury, please keep away from bystanders and children during product assembly.
4. Do not use the product until it is completely assembled and checked.

Folding Steps

When the treadmill is not in use, it can be folded to save space.

1. Before folding, please turn off the power switch and unplug the power plug;

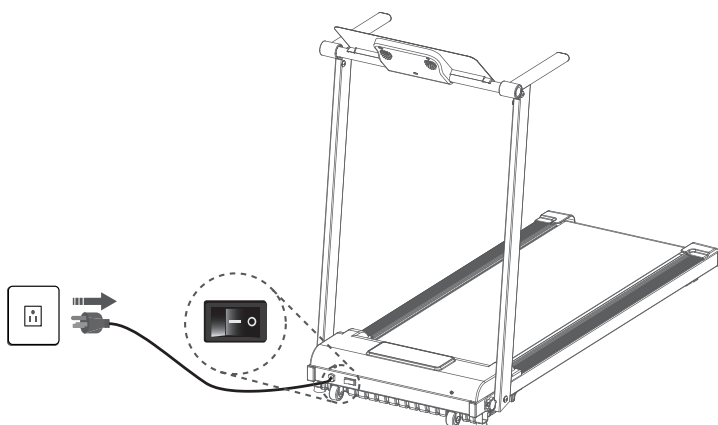

2. Unscrew the **hexagon knob A&B** counterclockwise and remove them, then fold the column and the console.

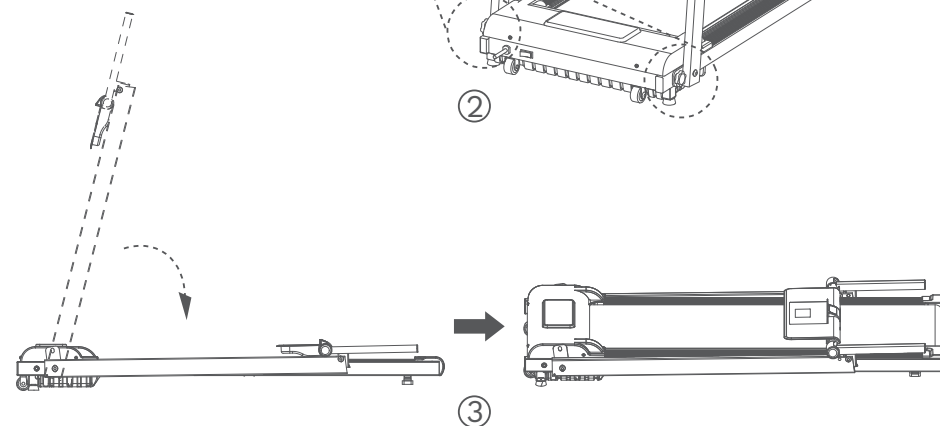
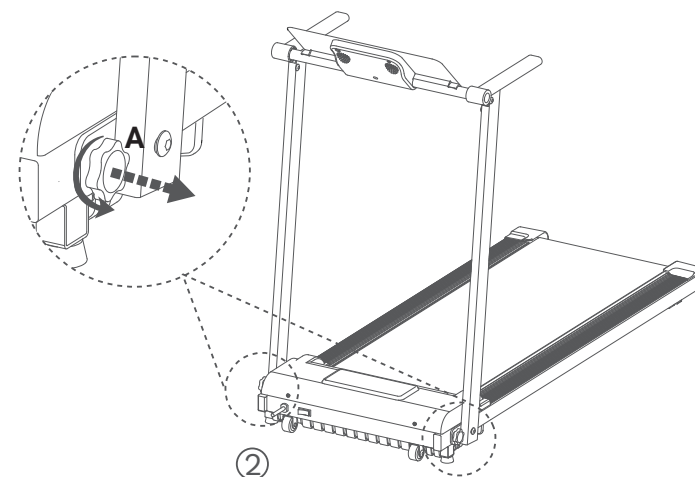
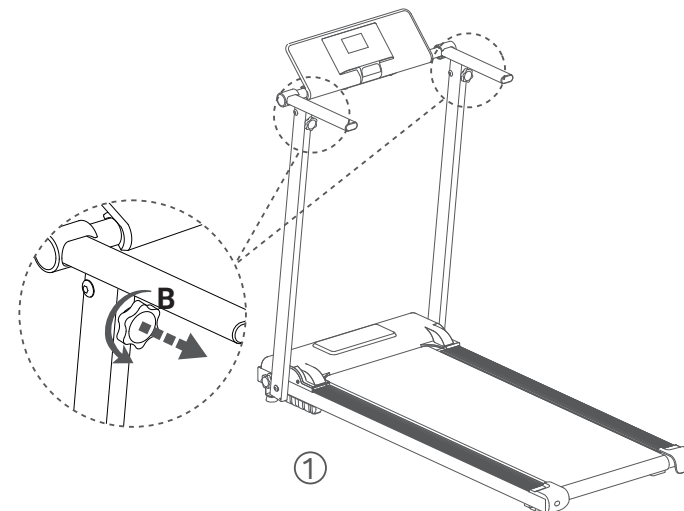

7 OPERATION

Console

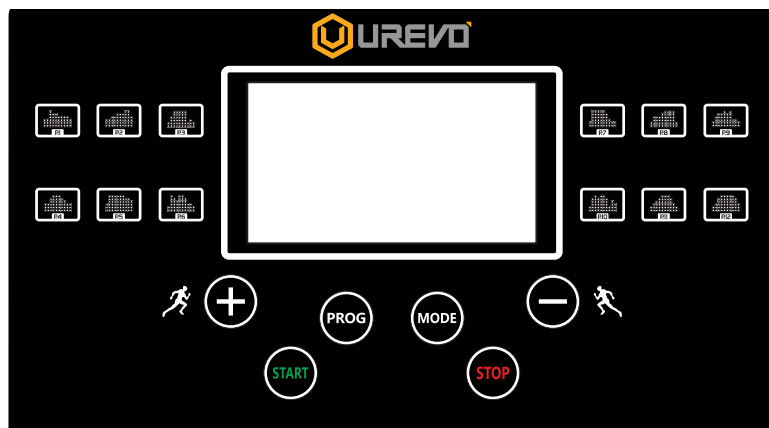

Key function

Key	Function
START	To start free run or program mode.
STOP	To stop tread belt or cancel program modes setting.
MODE	To customize workout challange goals (Ex: TIME-DIS.- CAL).
PROG.	To set and start a preset program : P1- P12 HIIT programs.
-	1: Speed control (Increase or Decrease) 2: Challange goal setting
+	

Getting started

Power the treadmill on by plugging it into an appropriate wall outlet, then turn on the power switch located at the front of the treadmill below the motor hood. Ensure that the safety key is installed, as the treadmill will not operate without it.

Quick-start operation

1. Attach the Safety key to enable the display (if not already on).
2. Press the Start key to begin belt movement. Adjust to the desired speed using the + and - keys.
3. To slow tread-belt press or hold the Speed - key to the desired speed.
4. To stop the tread-belt press the Stop key or pull away Safety key.

Mode operation

1. Make sure the machine is in the read mode, Press " Mode " key to customize challange goals (Sequence : TIME -DIS. - CAL)
2. Press + and - keys to change the default values if you'd like to customize.
3. Press the Start key to begin or Stop key to end of operation.

Programmable features

This Treadmill provides 12 HIIT programs (P1,P2,P3.....P12). Each program has its specific speed variations.

To Select and Start a Preset Program

1. Make sure the machine is in the read mode,. Press PROG key to choose desired program (P1,P2,.....P12), then press and release Start to begin the program with default values.
2. Each program will continue 30 minutes. This is the preset value. After every 3 minutes during the program, the Speed will be adjusted automatically, You can find details scheme table.
3. The running belt will come to a stop when the entire program is finished.

PROG.	SEG.	Setting time(10segments)									
		1	2	3	4	5	6	7	8	9	10
P1	Speed	3	3	6	5	5	4	4	4	4	3
P2	Speed	3	3	4	4	5	5	5	6	6	4
P3	Speed	2	4	6	6	6	6	6	2	3	2
P4	Speed	3	3	5	6	6	6	5	4	3	3
P5	Speed	3	6	6	6	6	6	6	5	5	4
P6	Speed	2	6	5	4	6	6	5	3	3	2
P7	Speed	2	6	6	6	6	6	5	3	2	2
P8	Speed	2	4	4	4	5	6	6	6	6	2
P9	Speed	2	4	5	5	6	5	6	3	3	2
P10	Speed	2	5	6	5	6	6	5	2	4	3
P11	Speed	2	3	4	5	6	6	6	5	3	2
P12	Speed	2	3	5	6	6	6	6	6	5	3

Standby Autonomy

Display will automatically turn off (Autonomy) in case No -operation duration over than 10 minutes in the ready mode. Display is capable to wake up by press any console keys.

Display Screen

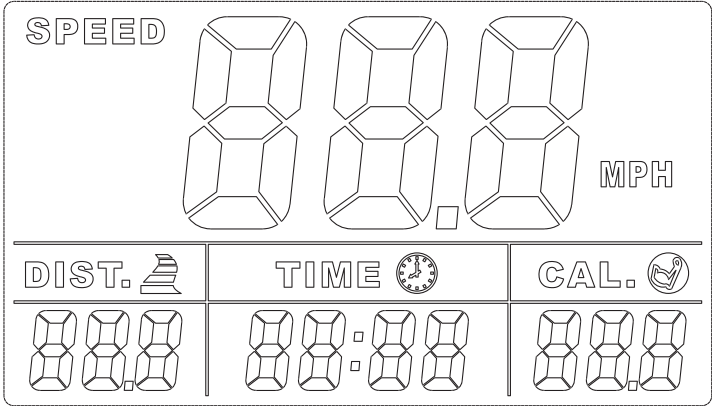

Name	Function
SPEED	1. The speed of the walking belt. 2. Error code show. 3. Program number show.
TIME	The elapsed time or the remain time of countdown.
DIS.	The distance that you have walked or run.
CAL.	The approximate number of calories you have burned.

Parameter display and setting range:

	Display range	Mode default value	Program default value	Setting range
Speed	0.6~6.2 MPH	-----	-----	0.6~6.2 MPH
Time	0:00~99:59	30:00	30:00	5:00~99:00
Distance	0~99.9MI	1.0	-----	1~99MI
Calories	0~999	50	-----	10~999

8 CARE & MAINTENANCE

Symptom : walk belt off centered or slips.

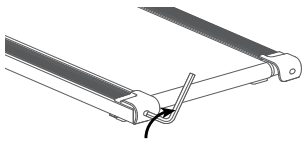

Figure 1

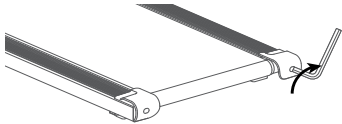

Figure 2

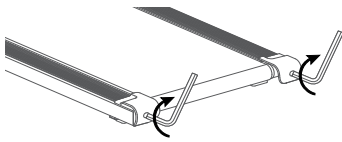

Figure.3

Centering walk belt process as follow :

- 1. Power off treadmill and unplug the power cord .
- 2. Manual centering process as follow:
 - If the walk belt has shifted to left, use the **5mm L-type** hex tool to turn the left idler roller screw clockwise **1/4** of a turn(refer to figure 1).
 - If the walk belt has shifted to right, use the **5mm L-type** hex tool to turn the right idler roller screw clockwise **1/4** of turn(refer to figure 2).
- 3. Treadmill **MUST** work 1-2mintutes. Repeat manual centering process untill the walk belt is centered.

Belt slip correcting process as follow :

- 1. Power off treadmill before operation.
- 2. Using the **5mm L-type** hex tool, turn both idler roller screws clockwise **1/2** of turn(refer to figure 3).
- 3. After corrected, please attempts to walking 1-2 minutes under 0.6mph speed setting. Repeat until the walk belt is properly tightened.

Note: The Tread-belt should not be adjusted too tightly, otherwise it will be damaged.

Attentions

- 1. To prevent any injury, don't place any debris around treadmill before maintenance process.
- 2. **MUST** use associated hex tool.
- 3. Take care at maintenance process.
Do not pinch fingers.

Belt lubrication process, follow instruction below to lubricate belt.

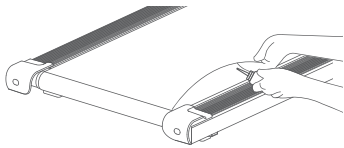

1. Power off appliance and unplug cord.
2. Using the hex tool, turn both idler roller screws counterclockwise till belt loosen and lifting easily.
Tips: please markdown hex tool rotating cycles when loosen belt, which use for adapting belt tension after lubrication process.
3. Lifting edges of belt and spraying lubrication oil at center of walk platform evenly. Not necessary to apply spray lubrication oil on entire walk platform.
4. Lubrication oil volume Per time of maintenance: 5-10mL.
Attention: it would causes of belt slip if spray too much.
5. Using the hex tool, turn the both idler screws clockwise as previous markdown number of turns untill walk belt tighten properly.
6. Power on appliance and workout for a few minutes, in order to spread lubrication oil to whole belt surface evenly.
Lubrication frequency: High recommend 125 Miles Per time.

Treadmill cleaning.

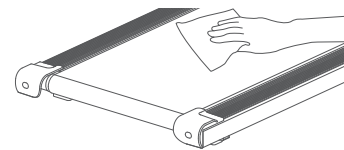

- 1.Power off treadmill and unplug power cord before cleaning.
- 2.Wipe and clean with damp cloth, Do not cleaning with acidic or caustic detergents.
- 3.Do not clean opposite of walk belt.
- 4.Its normal few black powders residual under treadmill after long working.

9 ERROR CODE

Error Code	Fault Analysis	Resolutions
E01	Safety key doesn't attached	1. Attached safety key on treadmill. 2. Inquires after sale service in case Safety key lost.
E02	Main PCBA malfunction	Please contact with after sales to inquire new controller for replacement.
E04	Communcation cable disconnected	Unscrew motor hood or console plane to verify terminal connection, please contact with after sales in case unsolved.
E05	Over current protection	1. Due to user over limit 120Kg. 2. Open to check any foreign objects blocked moving parts (such as : drive motor; Idler roller; driver roller, walking belt)
E06	Flame protection	1. Unscrew motor hood and verify motor terminals connection. 2. Power supply interrput due to connector loosen. 3. Please contact with after sales in case unsolved.
E07	Communcation interrupted	Please contact with after sales to inquire new signal cable for replacement
E08	Over loaded protection	1. Due to over limit 120Kg. 2. Tread belt lack lubricants. 3. Please contact with after sales in case unsolved.

Once error code happened, you MUST stop workout immediately, please contact with after sale service if problem CAN NOT be solved after restart.

10 TROUBLESHOOTING

Problem	Fault Analysis	Resolutions
No working	1. Power rock switch dysfunction. 2. Power supply interrupted. 3. Power cord damaged.	1. Replace new power rock switch if it doesn't light on. 2. Make sure that power cord is plugged into properly grounded outlet. 3. Replace new power cable.
Walking belt slips	Walking belt loosen	Tighten walking belt tension with 5mm L-type hex tool. (1/4 a turn both idler roller screw clockwise)
Friction noise	1. Walking belt off center 2. Others reasons	1. See details of walking belt tension chapter. 2. Contact with after sale service to diagnose and ask for proper solutions.

11 WARRANTY

MANUFACTURER'S LIMITED WARRANTY

UREVO warrants to the original purchaser that this product is free from defects in material and workmanship when used for the purpose intended, under the premise that it has been installed and operated in accordance with UREVO User Manual. UREVO's obligation under this warranty applies to the following:

COMPONENT LENGTH OF WARRANTY

Structural Frame 1 year For Home Use Only
All Other Components 90 days For Home Use Only

Exclusions from Warranty Coverage:

UREVO does not warrant against and is not responsible for, and no implied warranty shall be deemed to cover, any product failure, product malfunction, or damages attributable to:

1. Improper installation and/or failure to abide by UREVO's installation guidelines;
2. Use of this product beyond normal home use, or in an application for which it was not designed;
3. Cosmetic items such as scratches, dents or discolorations;
4. Damage caused by normal wear and tear, vandalism, accidents or by animals;
5. Any act of Nature (such as fire, flooding, snow, ice, hurricanes, earthquakes, lightning s or other natural disasters), environmental conditions (such as air pollution, mold, mildew, etc.), or staining from foreign substances (such as dirt, grease, oil, etc.);
6. Normal weathering due to exposure to sunlight, weather and atmosphere which can cause colored surfaces to among other things, flake, chalk, accumulate dirt or stains.
7. Improper operation, alteration, handling, storage, abuse or neglect of the products.

UREVO , using its sole discretion, will either repair or replace free of charge any part(s) proven to be defective under normal home use. Any repair or replacement shall provide no new warranty coverage, but shall retain only the remaining portion of the original product's warranty. This warranty is offered only to the original purchaser and is not transferable. Proof of original purchase is required.

When ordering replacement parts please have the following information ready:

1. Order Number
2. Description of Parts(Adding photos or videos would be helpful)
3. Part Number
4. Date of Purchase

