

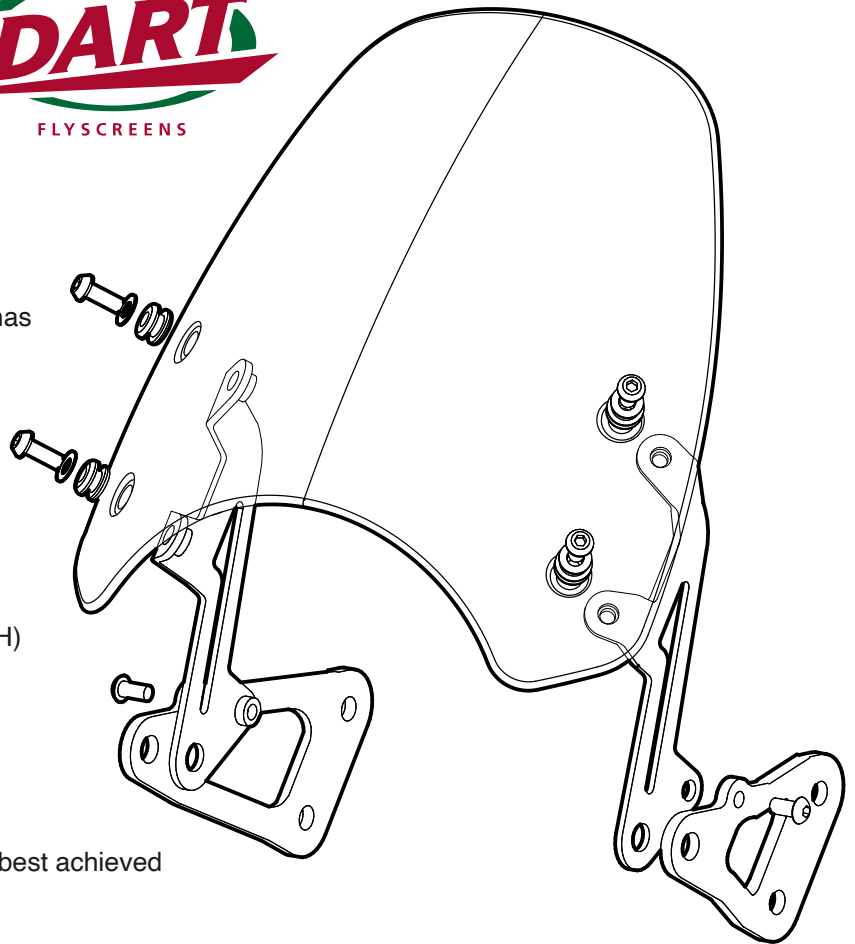

## Dart flyscreen fitting instructions HONDA CB1100EX/RS (2017-)

Thank you for purchasing a Dart flyscreen. It has been carefully designed and manufactured to suit a specific motorcycle model and by following these instructions you should encounter no problems with fitting. The kit should comprise the following:

- 1 x polycarbonate screen
- 4 x EPDM rubber grommets
- 2 x screen mounting brackets (LH & RH)
- 2 x stainless steel headlight brackets (LH & RH)
- 2 x M6 x 12mm hex head screws
- 4 x M6 x 10mm hex head screws
- 4 x custom hex head machine screws
- 4 x washers



- 1 Fit the grommets to the screen - this is best achieved from the back of the screen blade.
- 2 Fit the black screen brackets to the stainless headlight brackets and fit the 12mm screws to secure them. Do not tighten these at this stage.
- 3 Remove the front of the headlight. Unclip the indicator connectors (they are different colours - note which is right and which is left!). Turn the steering to the left and remove the right hand headlight bracket. You'll need to push the brake hose out of its clip to gain access to the screws.
- 4 Remove the indicator from the factory headlight bracket and fit it to the new bracket using the existing screw. Now fit the new RH bracket assembly to the bike using the M6 x 10mm cap head bolts. Tighten these fully and put the brake hose back in its clip.
- 5 Turn the steering to the right and repeat the operation for the LH screen bracket. Once this is done, fit the headlight bowl to the new brackets. Reconnect the indicators and make sure all the wiring is neatly out of the way at the back of the headlight bowl. Refit the headlight unit.
- 6 With both brackets fixed, hold the screen blade in position and loosely fit the four hexagon head machine screws with their washers, ensuring that they engage in the captive nuts on the brackets. Now gradually tighten all the screws evenly until they are seated on the brackets.
- 7 Adjust the headlight height. There is a notch on the headlight bracket which should correspond with a line on the bowl. This should set the headlight up for position but will need fine-tuning. and tighten the headlight screws.
- 8 Double check that everything is sufficiently tight and if so, fitting is now complete!

**MAINTENANCE:** No special maintenance is required. Do not use solvents to clean - just warm soapy water. Many proprietary glass cleaners are suitable for polycarbonate - check the label before trying.

**IMPORTANT NOTICE:** Whilst the screen provides a good level of impact protection, it is not warranted unbreakable. It is NOT a substitute for eye protection, which should be worn at all times while riding.