

# TRADITIONAL BIOETHANOL STOVE



BIO FIRES

www.biofires.com

tel. 020 7724 1919

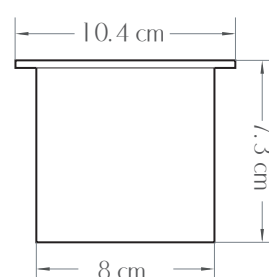
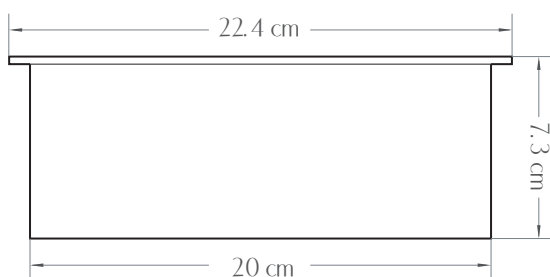
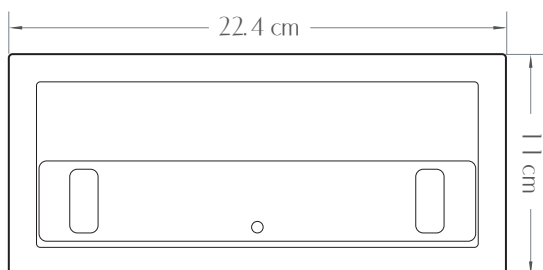
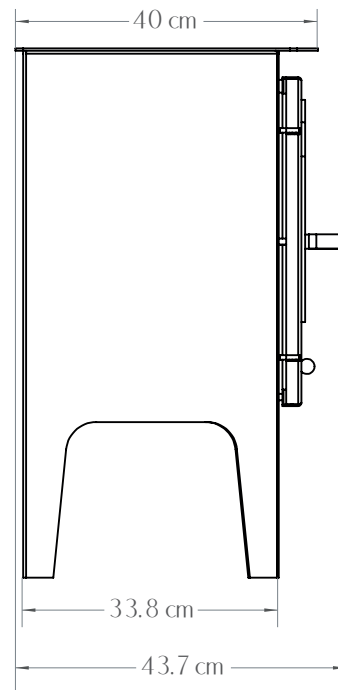
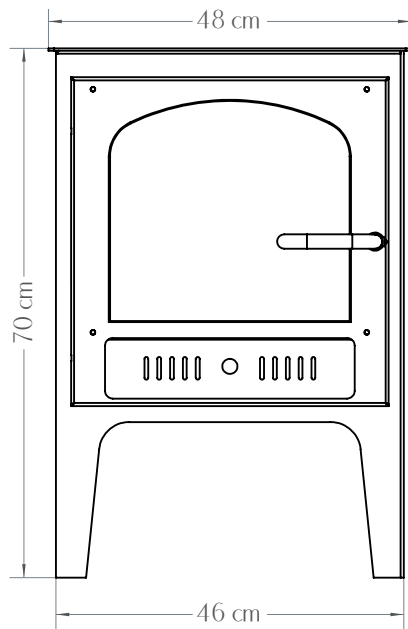

All measurements are approximate and are given for guidance purposes only.

This fire insert will produce real flame so all regular safety precautions and common sense should be employed. Not to be used with unprotected MDF. This unit can only be placed in fully fireproof surrounding, fireproof lined openings or old redundant fireplaces. Make sure your chimney is not blocked with any flammable materials. When used as a freestanding unit outside a fireplace opening place only against heat-resistant surfaces and walls; no wallpaper is suitable (if your wall is not heatproof line it with fireproof cement and optional fireproof paint).