

outdoor

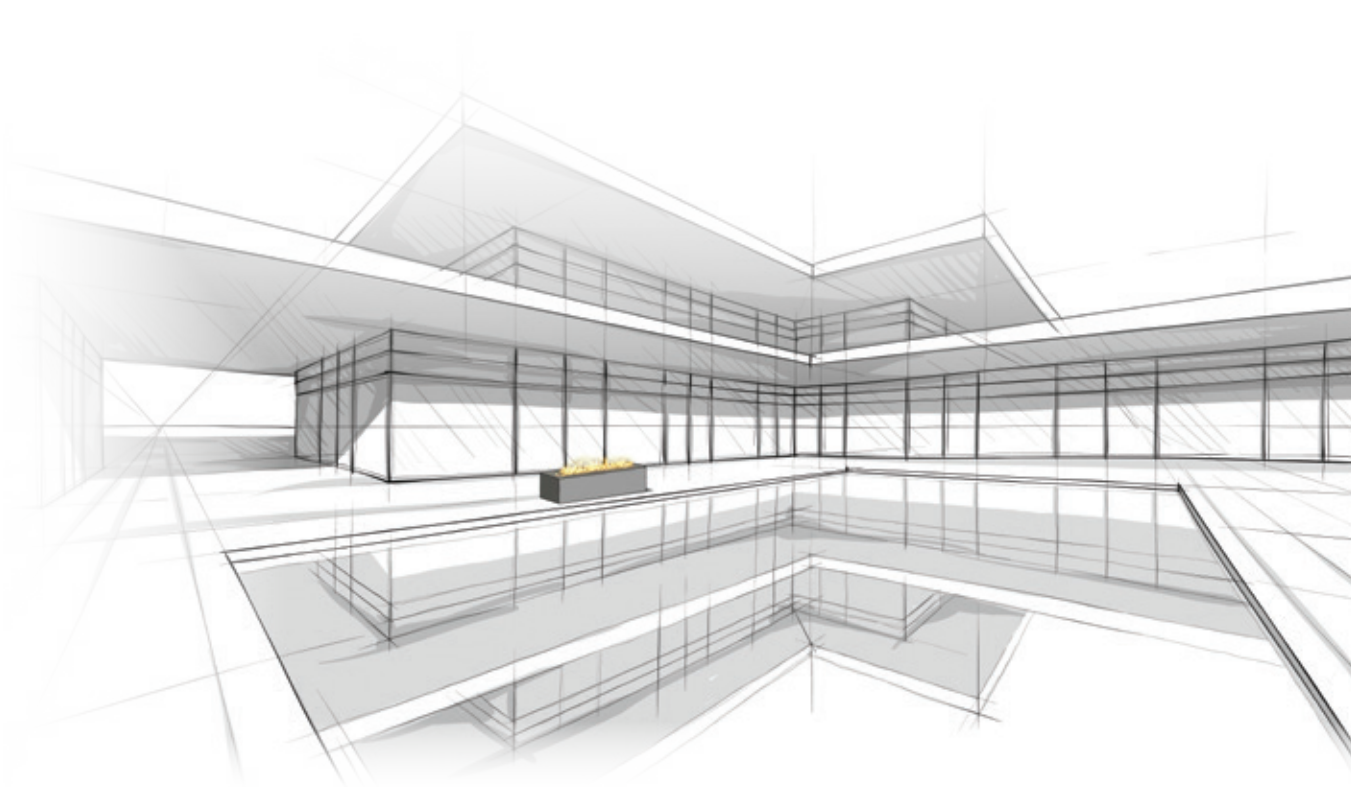

© PLANIKA | Ver. 04112016

www.PLANIKAfires.com

Galio Corten

outdoor

Galio Corten

Linear fire for outdoor use

Corten fireplace for commercial and residential spaces



FEATURES:

- For outdoor use
- No installation
- Flame height regulation
- Linear-shape burner
- LPG powered
- Safety sensor
- No electrical connection required
- Portable unit
- Intuitive control
- CE certified components



TECHNICAL DATA:

Net weight: 31 kg / 68 lbs

Heat output net: min.: 7 kW; max.: 12 kW min.: 23202; max.: 40263 BTU

Gas pressure: 37 mbar / 15 w.c.

Gas rate: min.: 0,5 kg/h; max.: 0,9 kg/h / min.: 1,2 lbs/h; max.: 2 lbs/h

Finish:

CASING: corten steel

GLASS SHIELD: tempered glass

BURNER: stainless steel

DIMENSIONS:

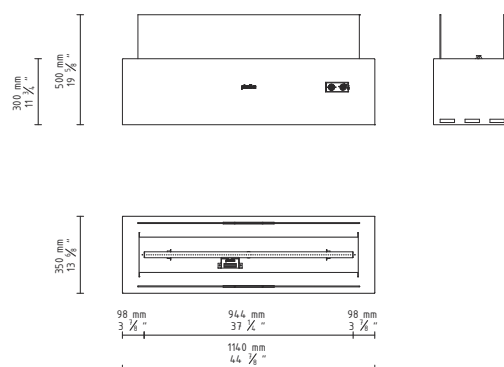

OUTDOOR INSTALLATION REQUIREMENTS:

