

How to Install Cordless Cellular Shade

Parts List

- A** Cordless Shade
- B** Mounting Brackets
- C** Handle
- D** Screws

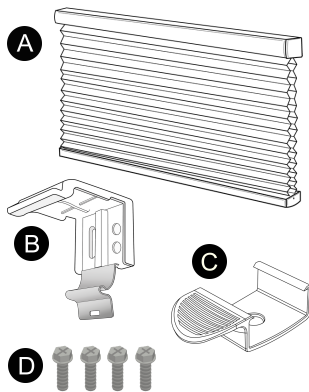

Bracket Chart

Shade Width	Brackets
Up to 42"	2
42" to 72"	3

Tools Needed

- Pencil or Marker
- Measuring Tape
- Screwdriver
- Level
- Power Drill
- Mounting Fasteners

Mounting Surface	Fastener
Drywall, Plaster	Wall Anchors, Expansion Bolts (Not Provided)
Metal	Sheet Metal Screws (Not Provided)
Wood	No. 6 Hex Head Screws

For Outside Mount

Mounting the Brackets

- Brackets (B) will be mounted to the wall above the window.
- Use a measuring tape to measure and mark the exact width of the shade.
- Hold brackets (B) 2" inside from markings. Use a pencil to mark the exact location of each screw.
- Brackets (B) must be mounted perfectly horizontal, so use a level to ensure markings are level. (If using a 3rd bracket, place the bracket in the exact center of outside marks)
- Use a 1/16" drill bit to slowly drill a hole for each screw location.
- Screw the brackets (B) into place. To ensure a secure mount, use wall anchors (provided).
- Continue to "Installing the Shade."

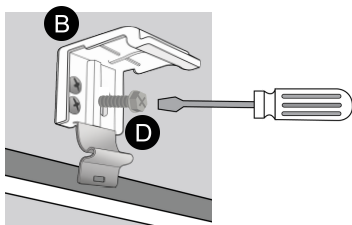
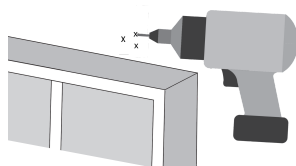
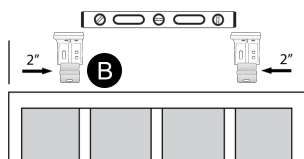
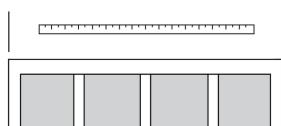

For Inside Mount

Mounting the Brackets

- Brackets (B) will be installed on the roof of your window frame.
- Hold the brackets (B) 2" from edge of window frame. Make sure brackets are positioned so there is no interference with cords and mechanisms inside the headrail (A).
- Mark the exact location of each screw with a pencil.
- Use a level to ensure markings are aligned and level across the width of the window. (If using a 3rd bracket (B), place the bracket in the exact center of other brackets.)
- Use a 1/16" drill bit to slowly drill a hole for each screw location.
- Screw brackets (B) into place. To ensure a secure mount, wall anchors (provided) may be needed.
- Continue to "Installing the Shade."

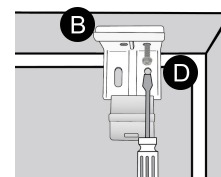
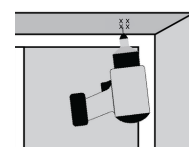
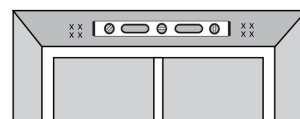
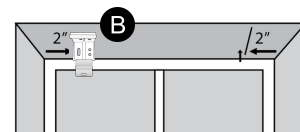

Installing the Shade

(Same for Outside and Inside Mount)

1. Lift the headrail (A) of shade up to bracket (B).
2. Rest the headrail's (A) groove onto front lip of bracket (B).
3. Push the headrail (A) back until it catches onto the back of the bracket (B). You'll hear an audible "click" when the headrail is securely in place.

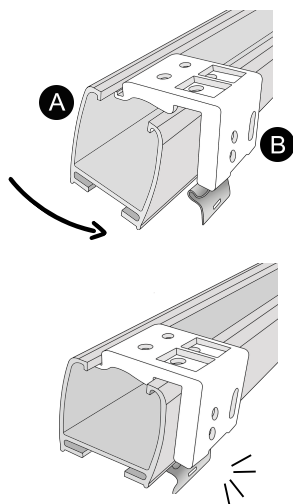

Removing the Shade

(Same for Outside and Inside Mount)

1. To remove, insert a screwdriver into the hole on the bracket's bottom tab.
2. Push tab back to release headrail.

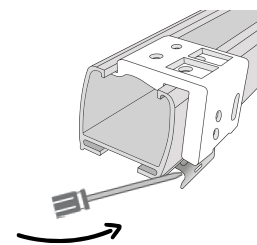

Attaching the Handle

1. Attach the handle (C) to the center of the bottom rail of the shade (A).
2. Check carefully to assure the handle is properly snapped into place.

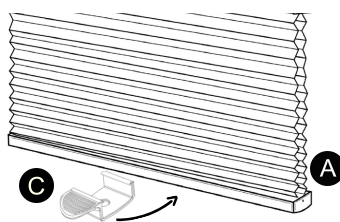

Operating the Shade

1. To raise your shade, simply pull the handle up to the desired location.
2. Pull handle down to lower shade.

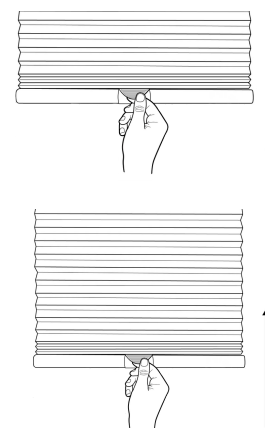

Cleaning and Maintenance

The vinyl headrail and bottom rail can be wiped clean with a damp sponge. To clean the shade fabric, use a feather duster or vacuum lightly using the soft brush attachment.

Warranty

For a period of one (1) year from the date of purchase, the manufacturer will replace this window covering with one of equal or superior value, if this window covering is found to be defective in material or workmanship. To obtain warranty service contact our customer service. This warranty does not cover damage of defects caused by or resulting from improper maintenance, negligent or improper use, abuse, misuse, neglect, accidents, act of God, alteration, commercial use, installation, removal or reinstallation. This warranty is restricted to normal consumer use within the United States and Canada.

MANUFACTURER WILL NOT BE LIABLE FOR INCIDENTAL OR CONSEQUENTIAL DAMAGES, SOME STATES DO NOT ALLOW THE EXCLUSION OR LIMITATION OF INCIDENTAL OR CONSEQUENTIAL DAMAGES, SO THE ABOVE LIMITATION OR EXCLUSION MAY NOT APPLY TO YOU. This warranty gives you specific legal rights, and you may also have other rights which vary from state to state.