

Installation Instructions for Genuine Urbano Windshield

SKU #: 0700-1040

NOTE: Make sure to install the rear view mirrors on your scooter prior to installing windshield.

Step 1: Check for all hardware

- 1 windshield
- 1 box of hardware



Step 2: Separate hardware

- Locate 2 rubber grommets, and both parts of the metal bushing. (4 sets total)



Step 3: Assemble Mounts to Windshield

- The metal bushing and one rubber grommet are placed on the front side of the windshield toward the front tire.

The windshield mount and one rubber grommet are placed on the back side of the windshield toward the rider.

Tighten the screw by hand for now.

- Repeat this process for the other 3 placements on windshield

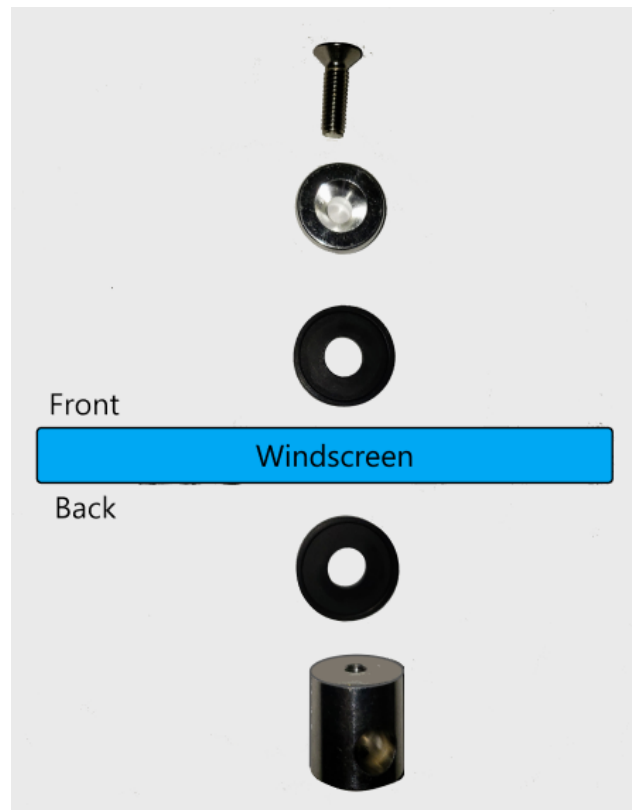

Step 4: Punch out perforated headset pieces

- Punch out the 2 windscreen mounting cutouts located under your headset. You can use a utility knife, razor blade, Dremel or fine blade screwdriver.
- Be careful not to damage the headset cover during the punchout removal process.



Step 5: Install receiving bolt with hardware

- Assemble the receiving bolt with the small lock washer at the top, collar, receiving bracket, flat washer, and then the mounting bolt at the bottom.
- Install receiving hardware onto handlebar. Leave loose for installing uprights.

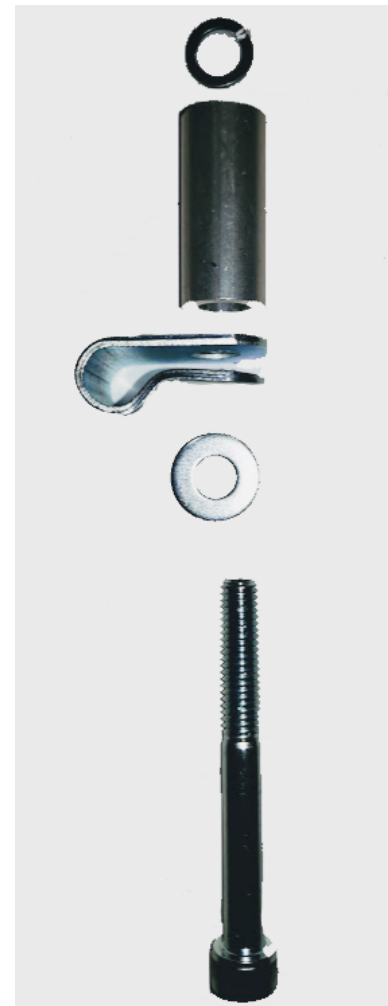

Step 6: Install Windshield Upright

- Screw 1 nut to each of the upright mounts and slide on 1 large lock washer.
- Slide upright mount into receiving bracket.
- Slide on 2nd lock washer, then thread second nut on the upright mount. Secure hand-tight.

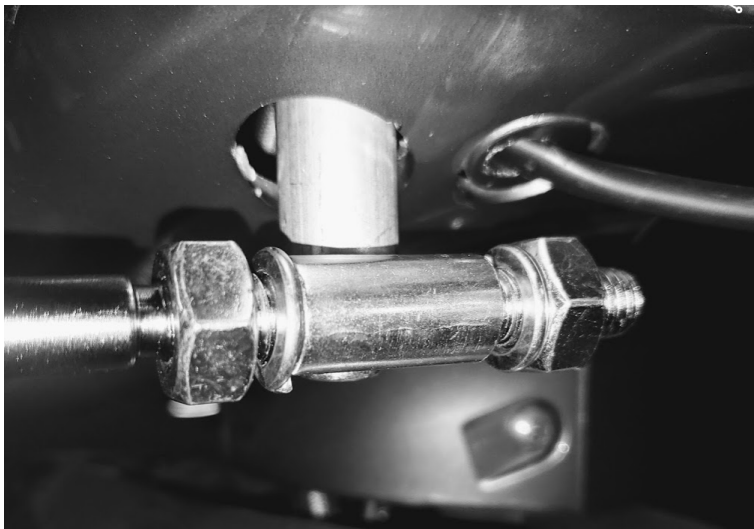
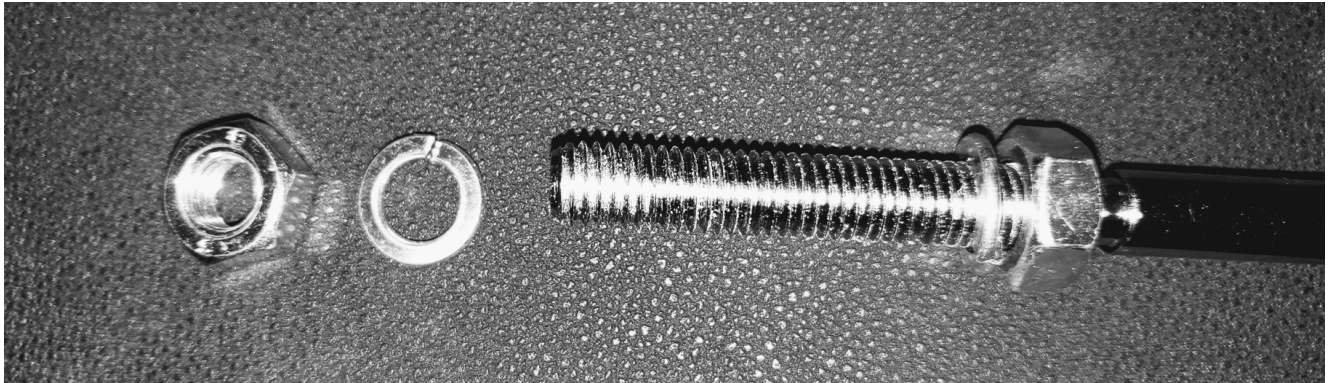

Step 7: slide windshield bushings onto upright mounts

- Loosen set screws located on the 4 windshield bushings.
- Slide windshield onto upright mounts.



- Adjust windshield forward, backward, up or down as needed using the space between the windsheild and the headlight as a reference to center.
- Tighten 4 set screws on upright mounts.
- Tighten ALL remaining mounting hardware.