

SCHOCK



A 517000EDM/A

B  517120EDM/A







LAIOS



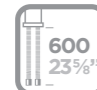







www.schock.de/en/easy-laios

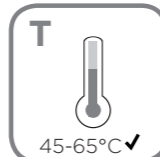
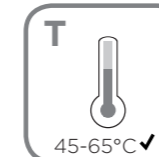

i **PRODUKTMERKMALE**
PRODUCT SPECIFICATIONS

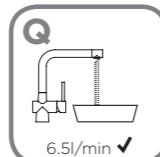
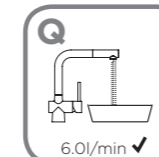
A 517000 EDM/A	B 517120 EDM/A	 600 23 5/8"	 600 23 5/8"	Anschluss Schlauchlänge Length of supply hoses
 1/2"	 1/2"	Gewindegröße Anschluss Schlauch Thread size of supply hose		
 360°	 360°	Schwenkbereich Swivel range		
 stop	Rückflussverhinderer Quarter turn valve			

A 517000 EDM/A	B 517120 EDM/A	 3 bar ✓	 3 bar ✓	Wasserdruck Water pressure
 1 ✓ max 5	 1 ✓ max 5			
 45-65°C ✓	 45-65°C ✓	Temperatur Temperature		
 °C ✓ max 90	 °C ✓ max 90			
 6.5l/min ✓	 6.0l/min ✓	Wasserdurchlaufmenge Water flow rate		
 l/min →	 l/min →			

! **SICHERHEITSHINWEISE**
SAFETY NOTES

SCHOCK

DEU	DIE GEWÄHRLEISTUNG VERFÄLLT BEI LAIENMONTAGE. SCHOCK EMPFIEHLT DIE VERWENDUNG DES GROBPARTIKELFILTERS SF-100 (629883). KEINEN CHLORREINIGER VERWENDEN.
ENG	THE WARRANTY IS VOIDED BY NON-PROFESSIONAL INSTALLATION. SCHOCK RECOMMENDS THE USE OF THE SF-100 (629883) COARSE PARTICLE FILTER. DO NOT USE CHLORINE-BASED CLEANING AGENTS.
ES	LA GARANTÍA CADUCA CUANDO EL MONTAJE NO ES REALIZADO POR PERSONAL ESPECIALIZADO. SCHOCK RECOMIENDA LA INSTALACIÓN DEL FILTRO CONTRA PARTÍCULAS GRUESAS SF-100 (629883). SE ADVIERTE NO UTILIZAR DETERGENTES QUE CONTENGAN CLORO.
TR	YETKİLİ KİŞİLERCE YAPILMAYAN MONTAJLARDA GARANTİ GEÇERSİZ SAYILACAKTIR. SCHOCK SF-100 (629883) KALIN PARÇACIK FİLTRESİNİ KULLANMANIZI ÖNERİR. ASLA KLORLU TEMİZLEYİCİLER KULLANMAYINIZ.
POL	GWARANCJA TRACI WAŻNOŚĆ W PRZYPADKU NIEWŁAŚCIWEGO MONTAŻU. SCHOCK ZALECA UŻYCIĘ ZAWORU KĄTOWEGO Z FILTREM SF-100 (629883). NIE STOSOWAĆ ŚRODKÓW NA BAZIE CHLORU.
RUS	ГАРАНТИЯ РАСПРОСТРАНЯЕТСЯ НА СМЕСИТЕЛИ УСТАНОВЛЕННЫЕ КВАЛИФИЦИРОВАННЫМ САНТЕХНИКОМ. SCHOCK РЕКОМЕНДУЕТ ИСПОЛЬЗОВАТЬ ФИЛЬТР ГРУБОЙ ОЧИСТКИ SF-100 (629883). НЕ ИСПОЛЬЗОВАТЬ ХЛОРСОДЕРЖАЩИЕ ЧИСТЯЩИЕ СРЕДСТВА.



WERKZEUGE TOOLS



19 mm
23 mm



INSTALLATION INSTALLATION

1

A 517000

Anschlusschläuche handfest anziehen

Hand - tighten supply hoses

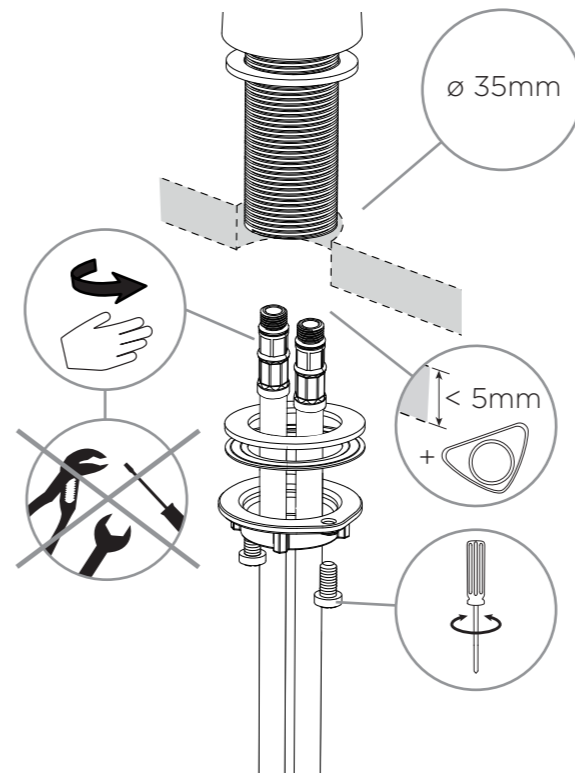

SCHOCK

1

B 517120

Anschlusschläuche handfest anziehen

Hand - tighten supply hoses

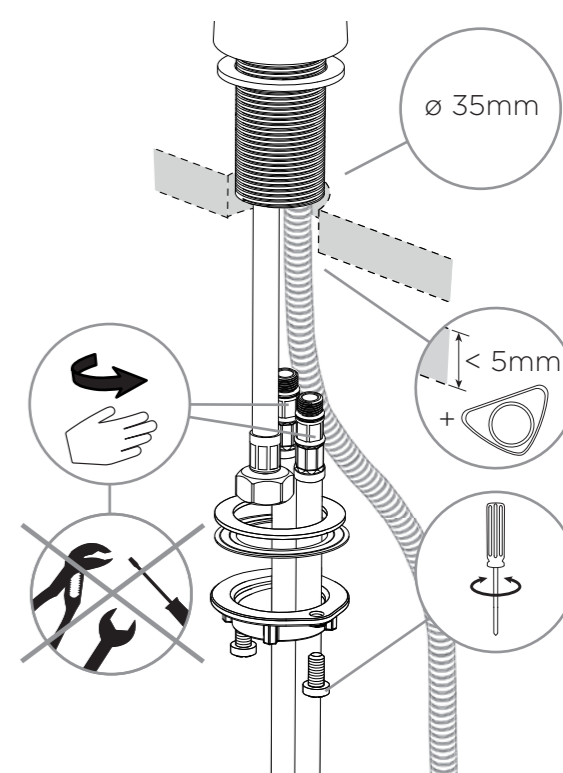



INSTALLATION INSTALLATION

2

Eckventile vor der Installation gründlich ausspülen
Flush piping system before installation of fitting thoroughly

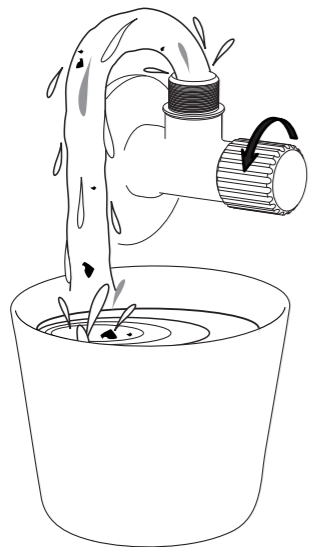

3

Anschlusschläuche an Eckventile anschrauben
Screw supply hoses onto angle valves

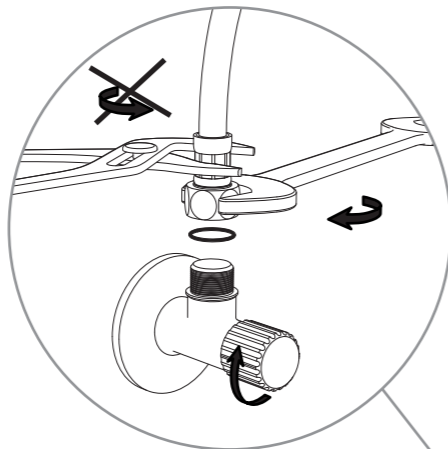

INSTALLATION INSTALLATION

4

B 517120

Fest anziehen
Tighten

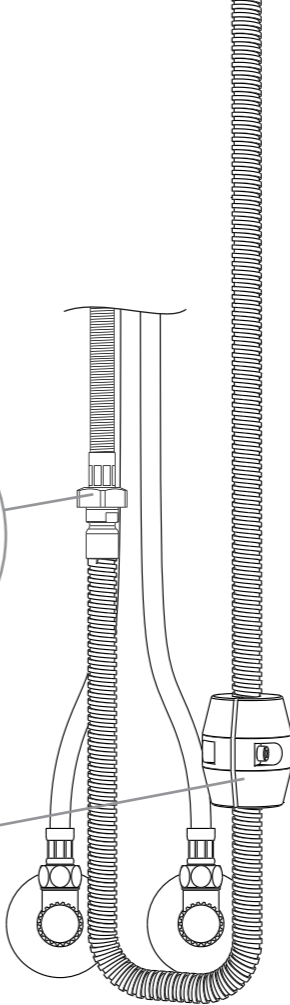
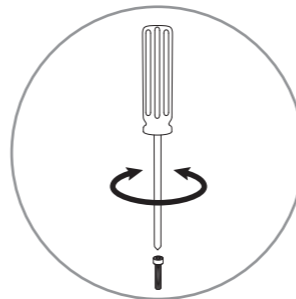
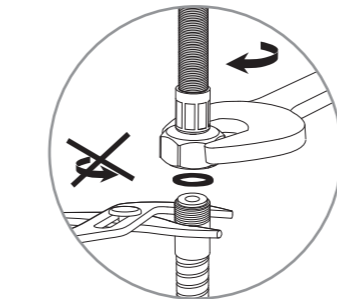

SCHOCK

5

Eckventile öffnen
Turn on water supplies and check connections for leaks

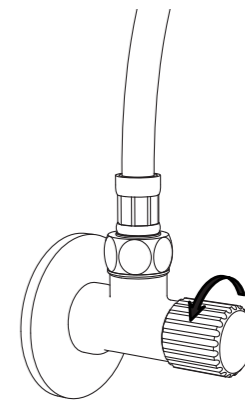



PFLEGEPRODUKTE
CARE PRODUCTS

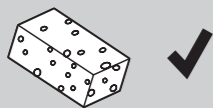

PFLEGEHINWEISE
CARE INSTRUCTIONS

1.

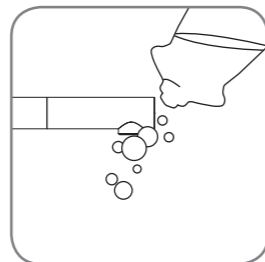

2.

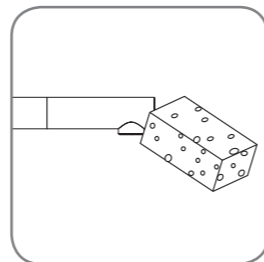

3.

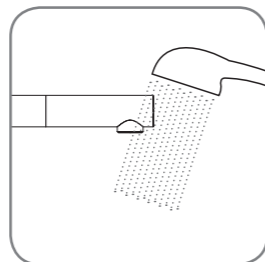

4.

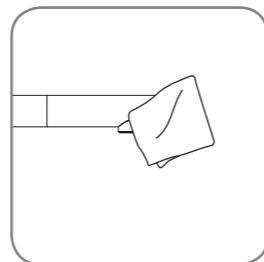

WERKZEUGE
TOOLS

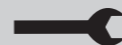

22 mm



PERLATORREINIGUNG
CLEANING THE AERATOR

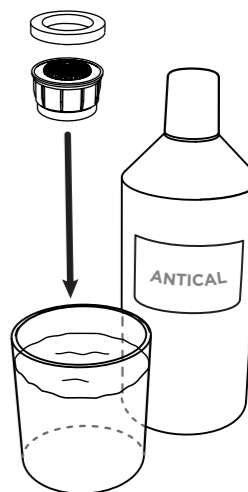
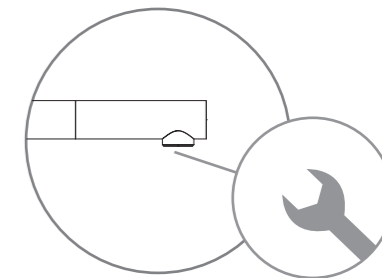

60 min



WERKZEUGE
TOOLS

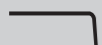

2,5 mm



30 mm



KARTUSCHENWECHSEL
CHANGING THE CARTRIDGE

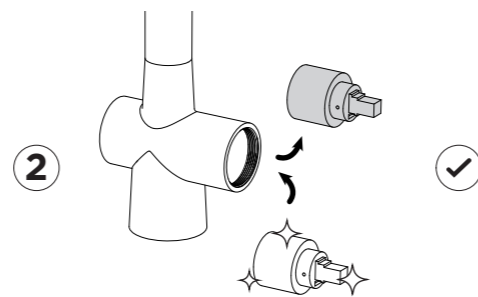
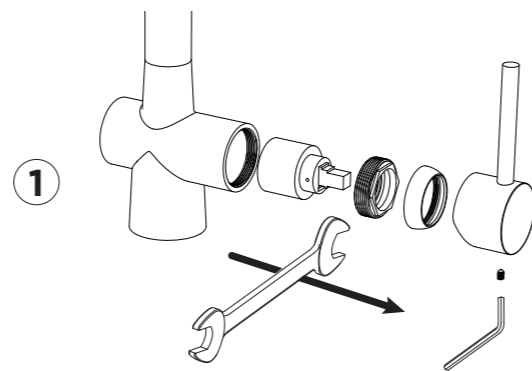

SCHOCK



WEBSHOP



WWW.SCHOCK.DE/SHOP



ERSATZTEILE
SPARE PARTS

① 628741/1

② 628740/2

③ 628740/3

④ 628740EDM

⑤ 628740/5

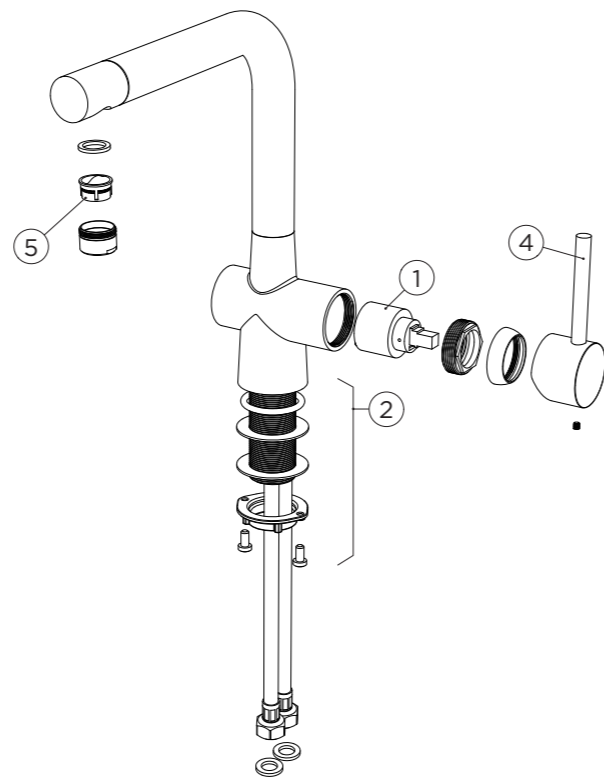
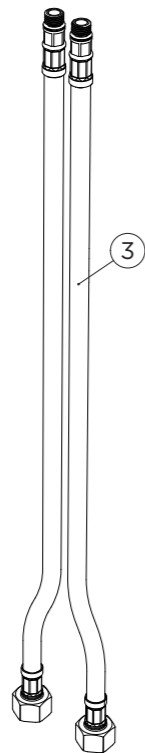

MASSE
MEASUREMENTS

Ⓐ 517000

SCHOCK

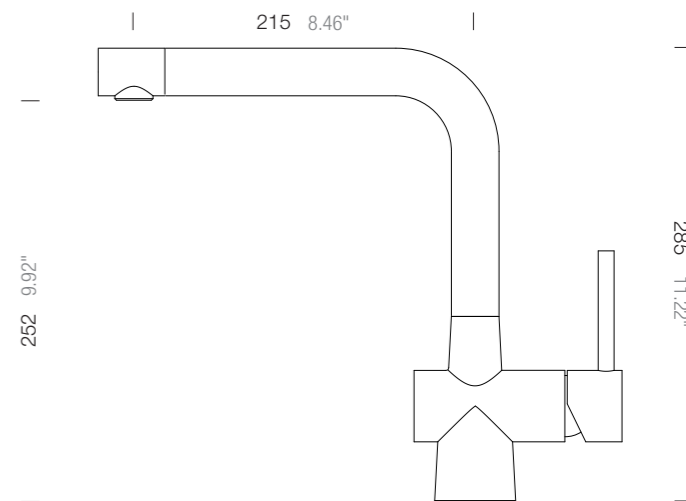

Lochbohrung \varnothing 35
Hole 1.37"



1 628741/1

2 628740/2

3 628740/3

4 628781EDM

5 628740/4

6 628741EDM

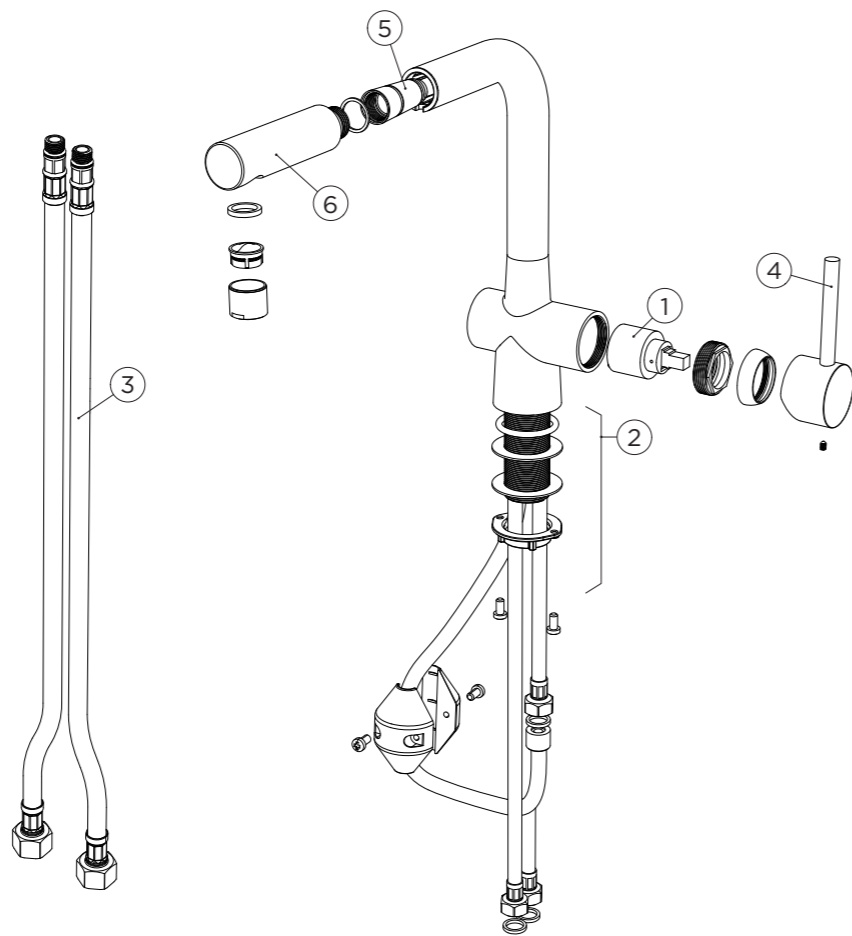

MASSE
MEASUREMENTS

B 517120

SCHOCK

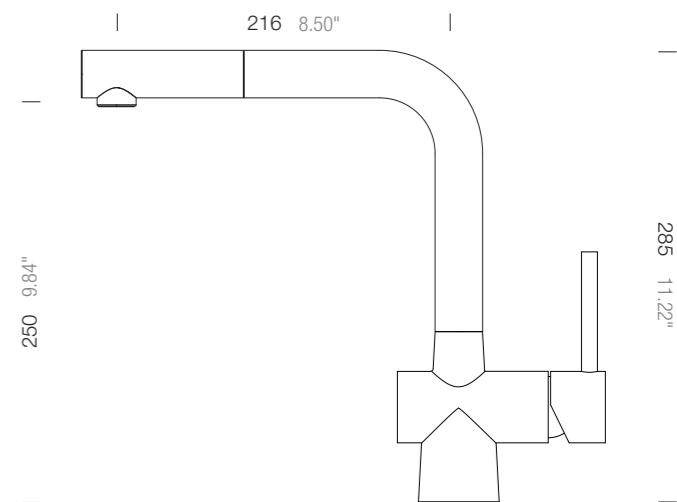

Lochbohrung \varnothing 35
Hole 1.37"



www.schock.de/en/service www.schock.de/en/shop

SCHOCK GmbH • Hofbauerstr. 1 • D-94209 Regen
Telefon: +49-9921-600-0 • Fax: +49-9921-600-253

Email: info@schock.de • www.schock.de