

Glydea® ULTRA 35

Technical Specifications

Motor part numbers

Glydea® ULTRA 35 RTS motor (with 10' cable and molded NEMA plug)	Part# 1003152
Glydea® ULTRA 35 DCT motor (with 10' cable and molded NEMA plug)	Part# 1003151
Glydea® ULTRA 35 Wired Motor (5' long without plug)	Part# 1003153

Features overview

	Glydea® ULTRA 35
Motor unit main features	
Soft start	✓
Manual operation	✓
Automatic limits on end stop	✓
Soft stop	✓
Intermediate position	✓
Touch motion with 2 sensitivity settings	✓
Adjustable limits	✓
Speed control & adjustment	✓
Control options	
Dry contact input via RJ12 Connector	✓
Dry contact individual, group and master control	✓
Radio Technology Somfy® RTS	✓
SDN RS485 digital technology (two-way communication)	✓
Zigbee® (two-way communication) (DCT only)	✓
Tandem alternative	✓
Sun control	✓
Timer control	✓
Installation and setting features	
Settings with buttons on motor unit	✓
Setting with 3 normally open dry contact switch	✓
LED indicators	✓
Motor unit direction change	✓
Factory reset	✓
Inverse (top mount) mounting	✓
Tracks/Drapery Types	
One-way opening	✓
Center opening	✓
Asymmetric	✓
Multiple	✓
Pinch pleat	✓
Ripplefold® with overlap arm	✓
Ripplefold® with butt arm	✓
Accordia®	✓

Motorized track main characteristics

	Glydea® ULTRA 35
Power Supply	120V AC 50/60 HZ
Amperage	0.8 A
Average linear speed	Silent Mode: 2.95 in./s (7.5 cm/s) Standard Mode: 4.95 in./s -7.86 in./s (12.5 cm/s-20 cm/s)
Power consumption	96W (standby <1W)
Power cable type	3-wire cable with molded NEMA plug 4-wire cable (wired version only)
Control connector type (Dry Contact)	RJ12
DCT control circuit voltage	3.3 VDC
Motor sound level	<38 dBA at silent mode
Certifications	c TUV us, CE
Track maximum length	32 ft. (9.7 m)
Maximum number of splices	2
Minimum bending radius	11.8 in. (30 cm)
Minimum curving radius	118 in. (300 cm)
Side opening max weight	77 lbs. 35 kg.
Center opening max weight	77 lbs. 35 kg.
Tandem alternative (see pages 23, 24, 26)	154 lbs./ 70 kgs. 64 ft./ 19.4 m

Motor dimensions

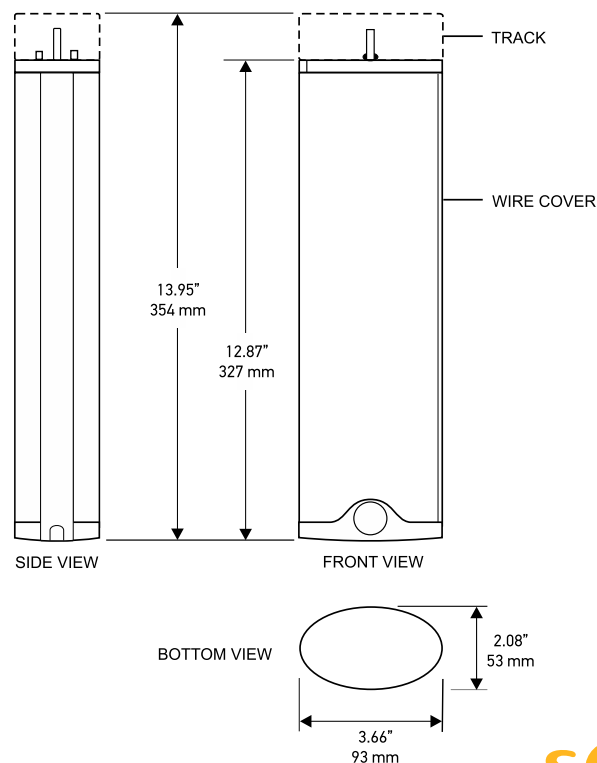

Glydea® ULTRA 60

Technical Specifications

Motor part numbers

Glydea® ULTRA 60 RTS motor (with 10' cable and molded NEMA plug)	Part# 1003159
Glydea® ULTRA 60 DCT motor (with 10' cable and molded NEMA plug)	Part# 1003158
Glydea® ULTRA 60 Wired motor (5' long without plug)	Part# 1003160

Features overview

Glydea® ULTRA 60	
Motor unit main features	
Soft start	✓
Manual operation	✓
Automatic limits on end stop	✓
Soft stop	✓
Intermediate position	✓
Touch motion with 2 sensitivity settings	✓
Adjustable limits	✓
Speed control & adjustment	✓
Control options	
Dry contact input via RJ12 Connector	✓
Dry contact individual, group and master control	✓
Radio Technology Somfy® RTS	✓
SDN RS485 digital technology (two-way communication)	✓
Zigbee® (two-way communication) (DCT only)	✓
Tandem alternative	✓
Sun control	✓
Timer control	✓
Installation and setting features	
Settings with buttons on motor unit	✓
Setting with 3 normally open dry contact switch	✓
LED indicators	✓
Motor unit direction change	✓
Factory reset	✓
Inverse (top mount) mounting	✓
Tracks/Drapery Types	
One-way opening	✓
Center opening	✓
Asymmetric	✓
Multiple	✓
Pinch pleat	✓
Ripplefold® with overlap arm	✓
Ripplefold® with butt arm	✓
Accordia®	✓

Motorized track main characteristics

Glydea® ULTRA 60	
Power Supply	120V AC 50/60 HZ
Amperage	0.8 A
Average linear speed	Silent Mode: 2.95 in./s (7.5 cm/s) Standard Mode: 4.95 in./s -7.86 in./s (12.5 cm/s-20 cm/s)
Power consumption	96W (standby <1W)
Power cable type	3-wire cable with molded NEMA plug 4-wire cable (wired version only)
Control connector type (Dry Contact)	RJ12
DCT control circuit voltage	3.3 VDC
Motor sound level	<38 dBA at silent mode
Certifications	c TUV us, CE
Track maximum length	36 ft. (10.9 m)
Maximum number of splices	2
Minimum bending radius	11.8 in. (30 cm)
Minimum curving radius	118 in. (300 cm)
Side opening max weight	132 lbs. 60 kg.
Center opening max weight	132 lbs. 60 kg.
Tandem alternative (see pages 23, 24, 26)	264 lbs./ 120 kgs. 72 ft./ 21.8 m

Motor dimensions

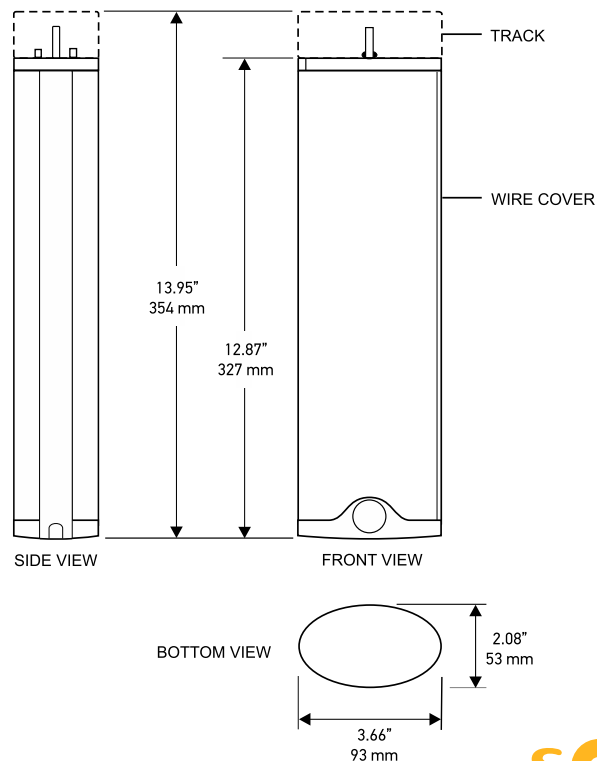

Drapery

Databook



Glydea® and Irismo™

Glydea® ULTRA 60 | Glydea® ULTRA 35 | Irismo™ 45 WireFree RTS | Irismo™ 35 Mini DC

Drapery Systems at a Glance

The difference is in the details.

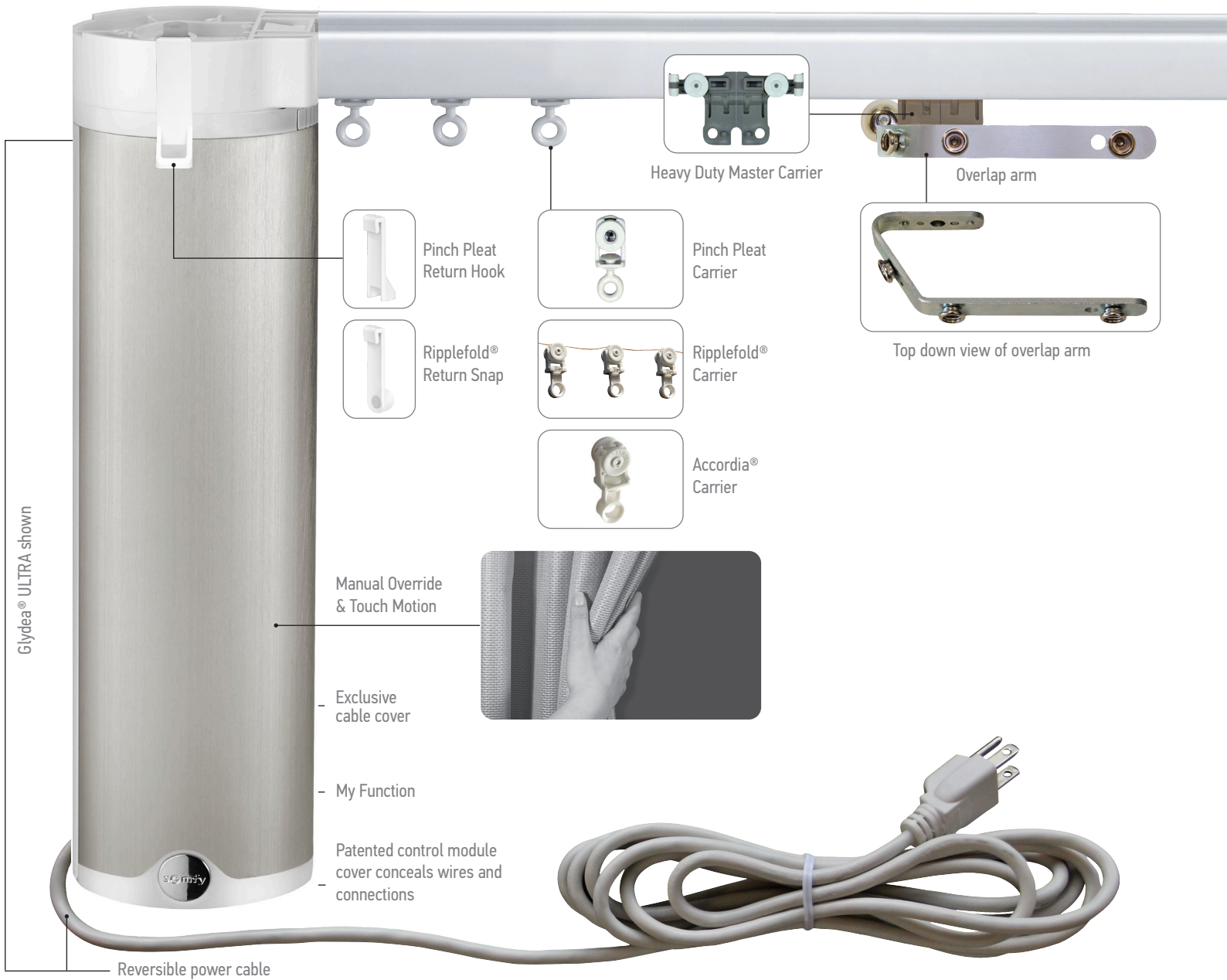

Track bending and curving options available

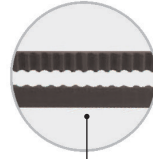

Straight arm

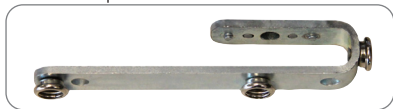

Top down view of straight arm



Easy installation with one-touch ceiling bracket



Swivel ceiling bracket minimizes light gap - recommended for curves



Adjustable wall mount bracket

Belt driven track

Interchangeable left or right side motor mounting option available with center opening track

Any Style, Any Technology

Pinch Pleat

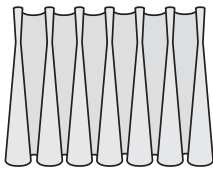

Ripplefold®

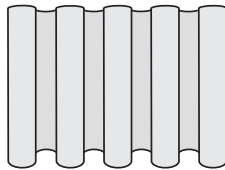

Accordia®

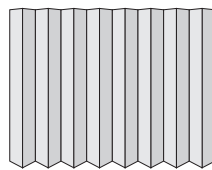

Built-in RTS, DCT and Wired technologies



Optional modules extend control to Zigbee, Z-wave and RS485



FEATURES OVERVIEW COMPARISON CHART

	WireFree 25.9V DC (Li-ion Rechargeable)	Low Voltage 24V DC	
	Irisimo™ 45 WireFree RTS	Irisimo™ 35 RTS	Irisimo™ 35 DCT
Motor unit main features			
Soft start	✓	✓	✓
Manual operation	✓	✓	✓
Automatic limits on end stop	✓	✓	✓
Soft stop	✓	✓	✓
Intermediate position	✓	✓	✓
Touch motion with 2 sensitivity settings	✓	✓	✓
Adjustable limits	✓	✓	✓
Speed control & adjustment	✓	✓	✓
Control options			
Dry contact input via RJ12 connector		✓	✓
Dry contact individual, group and master control		✓	✓
Radio Technology Somfy® RTS	✓	✓	
SDN RS485 digital technology (one-way communication)		✓	✓
Z-Wave® (one-way communication)		✓	✓
Zigbee® (one-way communication)		✓	✓
Tandem alternative	✓	✓	✓
Sun control	✓	✓	✓
Timer control	✓	✓	✓
Installation and setting features			
Settings with buttons on motor unit		✓	
Setting with normally open dry contact switch			✓
LED indicators	✓	✓	
Motor unit direction change	✓	✓	✓
Factory reset	✓	✓	✓
Inverse (top mount) mounting	✓	✓	✓
Audible sound Indicator	✓		
Tracks/Drapery Types			
One-way opening	✓	✓	✓
Center opening	✓	✓	✓
Asymmetric	✓	✓	✓
Multiple		✓	✓
Pinch pleat	✓	✓	✓
Ripplefold® with overlap arm	✓	✓	✓
Ripplefold® with butt arm	✓	✓	✓
Accordia®	✓	✓	✓

	Line Voltage 120V AC			
	Glydea® ULTRA 35		Glydea® ULTRA 60	
	DCT	RTS	DCT	RTS
Motor unit main features				
Soft start	✓	✓	✓	✓
Manual operation	✓	✓	✓	✓
Automatic limits on end stop	✓	✓	✓	✓
Soft stop	✓	✓	✓	✓
Intermediate position	✓	✓	✓	✓
Touch motion with 2 sensitivity settings	✓	✓	✓	✓
Adjustable limits	✓	✓	✓	✓
Speed control & adjustment	✓	✓	✓	✓
Control options				
Dry contact input via RJ12 connector	✓	✓	✓	✓
Dry contact individual, group and master control	✓	✓	✓	✓
Radio Technology Somfy® RTS		✓		✓
SDN RS485 digital technology (two-way communication)	✓	✓	✓	✓
Z-Wave® (one-way communication)				
Zigbee® (two-way communication)	✓		✓	
Tandem alternative	✓	✓	✓	✓
Sun control	✓	✓	✓	✓
Timer control	✓	✓	✓	✓
Installation and setting features				
Settings with buttons on motor unit	✓	✓	✓	✓
Setting with normally open dry contact switch	✓		✓	
LED indicators	✓	✓	✓	✓
Motor unit direction change	✓	✓	✓	✓
Factory reset	✓	✓	✓	✓
Inverse (top mount) mounting	✓	✓	✓	✓
Audible sound Indicator				
Tracks/Draperies Types				
One-way opening	✓	✓	✓	✓
Center opening	✓	✓	✓	✓
Asymmetric	✓	✓	✓	✓
Multiple	✓	✓	✓	✓
Pinch pleat	✓	✓	✓	✓
Ripplefold® with overlap arm	✓	✓	✓	✓
Ripplefold® with butt arm	✓	✓	✓	✓
Accordia®	✓	✓	✓	✓

Iriso™ 45 WireFree RTS

Technical Specifications

Motor part numbers

Iriso™ 45 WireFree RTS

Part# 1002353

Features overview

	Iriso™ 45 WireFree RTS
Motor unit main features	
Soft start	✓
Soft stop	✓
Manual operation	✓
Automatic limits on end stop	✓
Intermediate position	✓
Touch motion with 2 sensitivity settings	✓
Adjustable limits	✓
Speed control & adjustment	✓
Control options	
Radio Technology Somfy® RTS	✓
Tandem alternative	✓
Sun control	✓
Timer control	✓
Installation and setting features	
LED indicators	✓
Audible sound Indicator	✓
Motor unit direction change	✓
Factory reset/programming button	✓
Inverse mounting (top mount)	✓
Tracks/Draper Types	
One-way opening	✓
Center opening	✓
Asymmetric	✓
Pinch pleat	✓
Ripplefold® with overlap arm	✓
Ripplefold® with butt arm	✓
Accordia®	✓

Motorized track main characteristics

	Iriso™ 45 WireFree RTS
Power supply	25.9V DC
Average linear speed	4.9 in./s - 7.86 in./s 12.5 cm/s - 20 cm/s
Rechargeable (Li-ion) battery capacity	3200 mAh
Motor sound level	<44 dBA
Certifications	CE
Track maximum length	33 ft. (10 m)
Maximum number of splices	2
Minimum bending radius	11.8 in. (30 cm)
Minimum curving radius	118 in. (300 cm)
Side opening max weight	99 lbs. (45 kg)
Center opening max weight	99 lbs. (45 kg)
Tandem alternative (see pages 23, 24, 26)	198 lbs. (90 kg)

Motor dimensions

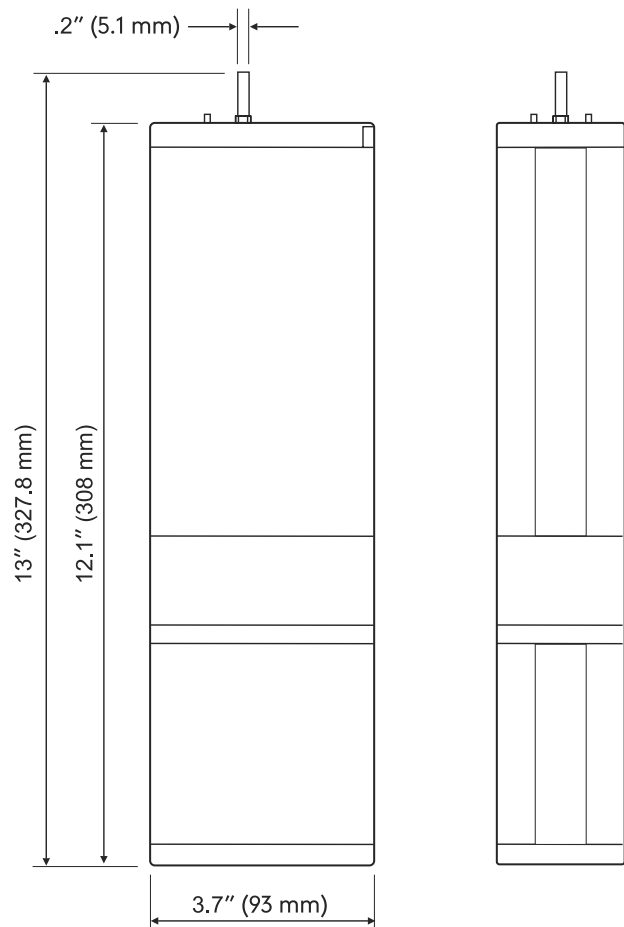

Irismo™ 35 Mini DC

Technical Specifications

Motor part numbers

Irismo™ 35 Mini DC RTS	Part# 1003004
Irismo™ 35 Mini DC DCT	Part# 1003003

Features overview

	Irismo™ 35 RTS	Irismo™ 35 DCT
Motor unit main features		
Soft start	✓	✓
Soft stop	✓	✓
Manual operation	✓	✓
Automatic limits on end stop	✓	✓
Intermediate position	✓	✓
Touch motion with 2 sensitivity settings	✓	✓
Adjustable limits	✓	✓
Speed control & adjustment	✓	✓
Control options		
Dry contact input via RJ12 connector	✓	✓
Radio Technology Somfy® RTS	✓	
Tandem alternative	✓	✓
SDN RS485 digital technology (one-way communication)	✓	✓
Z-Wave® (one-way communication)	✓	✓
Zigbee® (one-way communication)	✓	✓
Sun control	✓	✓
Timer control	✓	✓
Installation and setting features		
Setting with normally open dry contact switch	✓	✓
LED indicators	✓	✓
Motor unit direction change	✓	✓
Factory reset	✓	✓
Inverse mounting (top mount)	✓	✓
Tracks/Drapery Types		
One-way opening	✓	✓
Center opening	✓	✓
Asymmetric	✓	✓
Multiple	✓	✓
Pinch pleat	✓	✓
Ripplefold® with overlap arm	✓	✓
Ripplefold® with butt arm	✓	✓
Accordia®	✓	✓

Motorized track main characteristics

	Irismo™ 35 RTS	Irismo™ 35 DCT
Power Supply	24V DC	
Power adaptor amperage	2 A	
Average linear speed	4.9 in./s - 7.86 in./s 12.5 cm/s - 20 cm/s	
Power consumption	< 3 W (standby)	
Power adaptor cable length	13.2 ft. (4 m)	
Control connector type	RJ12	
DCT control circuit voltage	5V DC	
Motor sound level	<44 dBA	
Certifications	CE	
Track maximum length	32 ft. (9.7 m)	
Maximum number of splices	2	
Minimum bending radius	11.8 in. (30 cm)	
Minimum curving radius	118 in. (300 cm)	
Side opening max weight	77 lbs. (35 kg)	
Center opening max weight	77 lbs. (35 kg)	
Tandem alternative (see pages 23, 24, 26)	154 lbs. (70 kg)	

Motor dimensions

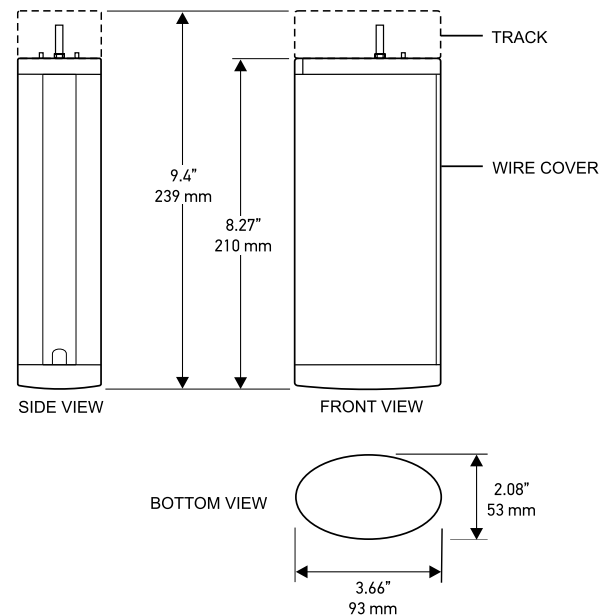

Glydea® ULTRA 35

Technical Specifications

Motor part numbers

Glydea® ULTRA 35 RTS motor (with 10' cable and molded NEMA plug)	Part# 1003152
Glydea® ULTRA 35 DCT motor (with 10' cable and molded NEMA plug)	Part# 1003151
Glydea® ULTRA 35 Wired Motor (5' long without plug)	Part# 1003153

Features overview

	Glydea® ULTRA 35
Motor unit main features	
Soft start	✓
Manual operation	✓
Automatic limits on end stop	✓
Soft stop	✓
Intermediate position	✓
Touch motion with 2 sensitivity settings	✓
Adjustable limits	✓
Speed control & adjustment	✓
Control options	
Dry contact input via RJ12 Connector	✓
Dry contact individual, group and master control	✓
Radio Technology Somfy® RTS	✓
SDN RS485 digital technology (two-way communication)	✓
Zigbee® (two-way communication) (DCT only)	✓
Tandem alternative	✓
Sun control	✓
Timer control	✓
Installation and setting features	
Settings with buttons on motor unit	✓
Setting with 3 normally open dry contact switch	✓
LED indicators	✓
Motor unit direction change	✓
Factory reset	✓
Inverse (top mount) mounting	✓
Tracks/Drapery Types	
One-way opening	✓
Center opening	✓
Asymmetric	✓
Multiple	✓
Pinch pleat	✓
Ripplefold® with overlap arm	✓
Ripplefold® with butt arm	✓
Accordia®	✓

Motorized track main characteristics

	Glydea® ULTRA 35
Power Supply	120V AC 50/60 HZ
Amperage	0.8 A
Average linear speed	Silent Mode: 2.95 in./s (7.5 cm/s) Standard Mode: 4.95 in./s -7.86 in./s (12.5 cm/s-20 cm/s)
Power consumption	96W (standby <1W)
Power cable type	3-wire cable with molded NEMA plug 4-wire cable (wired version only)
Control connector type (Dry Contact)	RJ12
DCT control circuit voltage	3.3 VDC
Motor sound level	<38 dBA at silent mode
Certifications	c TUV us, CE
Track maximum length	32 ft. (9.7 m)
Maximum number of splices	2
Minimum bending radius	11.8 in. (30 cm)
Minimum curving radius	118 in. (300 cm)
Side opening max weight	77 lbs. 35 kg.
Center opening max weight	77 lbs. 35 kg.
Tandem alternative (see pages 23, 24, 26)	154 lbs./ 70 kgs. 64 ft./ 19.4 m

Motor dimensions

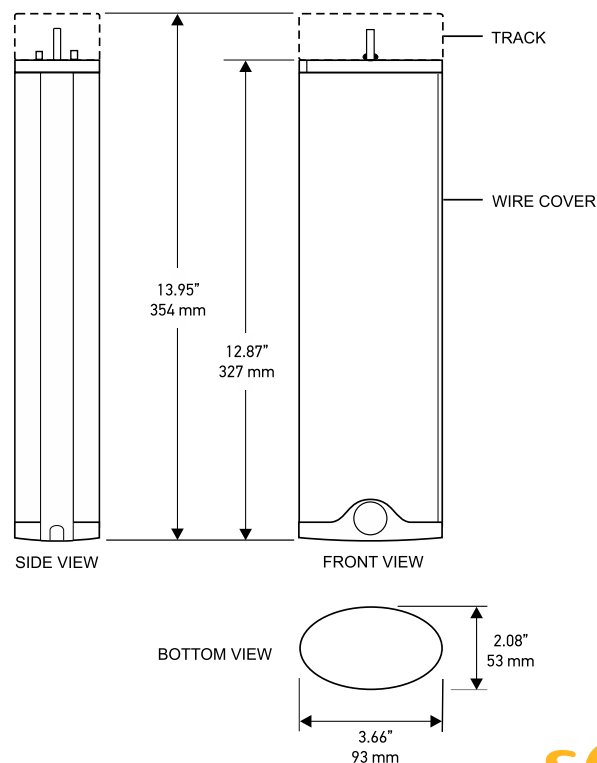

Glydea® ULTRA 60

Technical Specifications

Motor part numbers

Glydea® ULTRA 60 RTS motor (with 10' cable and molded NEMA plug)	Part# 1003159
Glydea® ULTRA 60 DCT motor (with 10' cable and molded NEMA plug)	Part# 1003158
Glydea® ULTRA 60 Wired motor (5' long without plug)	Part# 1003160

Features overview

Glydea® ULTRA 60	
Motor unit main features	
Soft start	✓
Manual operation	✓
Automatic limits on end stop	✓
Soft stop	✓
Intermediate position	✓
Touch motion with 2 sensitivity settings	✓
Adjustable limits	✓
Speed control & adjustment	✓
Control options	
Dry contact input via RJ12 Connector	✓
Dry contact individual, group and master control	✓
Radio Technology Somfy® RTS	✓
SDN RS485 digital technology (two-way communication)	✓
Zigbee® (two-way communication) (DCT only)	✓
Tandem alternative	✓
Sun control	✓
Timer control	✓
Installation and setting features	
Settings with buttons on motor unit	✓
Setting with 3 normally open dry contact switch	✓
LED indicators	✓
Motor unit direction change	✓
Factory reset	✓
Inverse (top mount) mounting	✓
Tracks/Drapery Types	
One-way opening	✓
Center opening	✓
Asymmetric	✓
Multiple	✓
Pinch pleat	✓
Ripplefold® with overlap arm	✓
Ripplefold® with butt arm	✓
Accordia®	✓

Motorized track main characteristics

Glydea® ULTRA 60	
Power Supply	120V AC 50/60 HZ
Amperage	0.8 A
Average linear speed	Silent Mode: 2.95 in./s (7.5 cm/s) Standard Mode: 4.95 in./s -7.86 in./s (12.5 cm/s-20 cm/s)
Power consumption	96W (standby <1W)
Power cable type	3-wire cable with molded NEMA plug 4-wire cable (wired version only)
Control connector type (Dry Contact)	RJ12
DCT control circuit voltage	3.3 VDC
Motor sound level	<38 dBA at silent mode
Certifications	c TUV us, CE
Track maximum length	36 ft. (10.9 m)
Maximum number of splices	2
Minimum bending radius	11.8 in. (30 cm)
Minimum curving radius	118 in. (300 cm)
Side opening max weight	132 lbs. 60 kg.
Center opening max weight	132 lbs. 60 kg.
Tandem alternative (see pages 23, 24, 26)	264 lbs./ 120 kgs. 72 ft./ 21.8 m

Motor dimensions

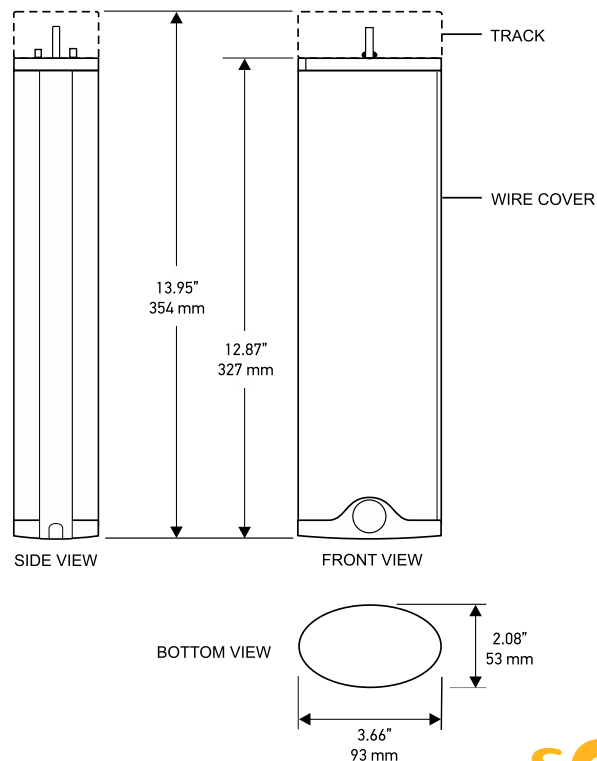

Irismo™ 35 Mini DC Drapery Motor, Integration and Power

IRISMO™ 35

Irismo™ 35 Mini DC



RTS 1003004
DCT 1003003

(24V DC power supply included)
(Optional 10 motor power panel available)

Please see pages 14 & 15 for wiring examples.
See below for power accessories.

CONTROL CARD ENCLOSURE FOR IRISMO™ 35

DC Control Card Enclosure



DC Control Card Enclosure
9021132

ENCLOSURE/CONTROL KITS

Z-Wave® Drapery
Control Enclosure Kit

1870280

Zigbee® Drapery
Control Enclosure Kit

1870281

SDN Irismo™ 35 24V Mini DC
Control Enclosure Kit
(includes cable for SDN & PoE)

1870282

INTEGRATION CONTROL MODULES FOR IRISMO™ 35 ONLY

Z-Wave®

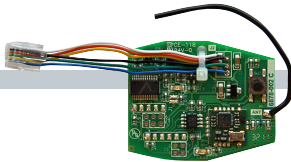

Easily integrates with
Z-Wave® systems using the
Z-Wave® plug-in module.

1870228

Zigbee®

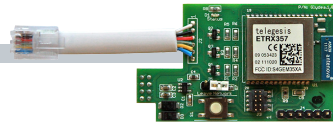

Easily integrates with Zigbee®
systems using the Zigbee®
plug-in module.

1870221

RS485

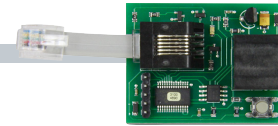

Easily integrates with Somfy
Digital Network™ systems using
the RS485 plug-in module.

1811129

POWER ACCESSORIES FOR IRISMO™ 35

Power Panel



SDN bus distribution component used to add
10 isolated motor ports and two isolated
device ports to an SDN bus segment.

1870259

PoE Gateway



Low voltage power distribution and network-connected
module that utilizes PoE (Power over Ethernet)
technology to power and control the Somfy 24V RS485
motorization offer for shades and draperies.

1860326

Drapery Adaptor for Power Over Ethernet (PoE) Gateway



4-pin Weidmuller Adaptor to connect
the SDN PoE Gateway to motors.

9025012

Irismo™ 45 and Glydea ULTRA® Drapery Motors, Integration and Power

IRISMO™ 45

Irismo™ 45 WireFree RTS



RTS 1002353

(Rechargeable Lithium-ion battery pack included)

Power Charger 1003080 &
Replacement Battery 9026476
(Sold Separately)

GLYDEA® ULTRA

Glydea® ULTRA 35 and Glydea® ULTRA 60



Glydea® ULTRA 35

RTS with 10' Plug	1003152
DCT with 10' Plug	1003151
Wired w/o Plug	1003153

Glydea® ULTRA 60

RTS with 10' Plug	1003159
DCT with 10' Plug	1003158
Wired w/o Plug	1003160

POWER ACCESSORIES FOR IRISMO™ 45

Plug-in Charger for Irismo™ 45



With 5 ft. cable - 20 AWG
1003080 (replaces 1002945)

Rechargeable Battery for Irismo™ 45



9026476 (replaces 9019741)

INTEGRATION CONTROL MODULES FOR GLYDEA® ULTRA RTS & DCT MOTORS

RS485 Two-Way Module

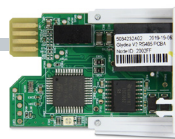

RS485 Two-way Module for
Glydea® ULTRA Motors

1870275

Drapery Motor Wiring Examples



RTS RADIO CONTROL

Individual control

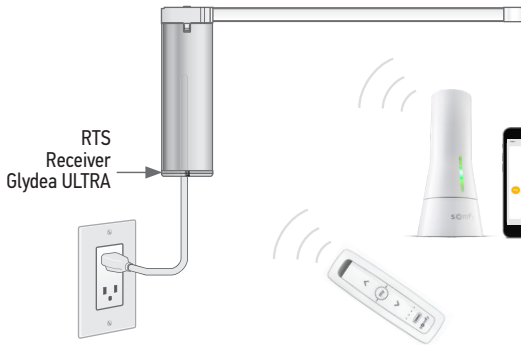

Group control

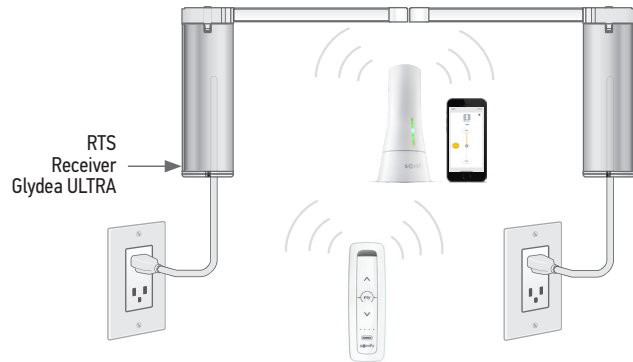

DRY CONTACT TECHNOLOGY (DCT) CONTROL

DRY CONTACT

The Dry Contact Control can be done through devices with 2 normally open contacts (open, close) or 3 normally open contacts (open, stop, close). For devices using 2 contacts, the stop command is achieved by closing the open and close contacts. For 3 devices, the stop can also be achieved with a specific stop button. Individual, group and master DCT controls can be achieved using a DCT Splitter and Diode boxes as shown below.

NUMBER OF DCT DRAPERLY MOTORS AND LENGTH OF CONTROL LIMITATIONS

WIRE CROSS-SECTION	MAXIMUM LENGTH OF CABLE	MAXIMUM NUMBER OF MOTORS
Cat5 or Equal	328 ft. (100 m)	10
0.75 mm ²	656 ft. (200 m)	20

Individual control

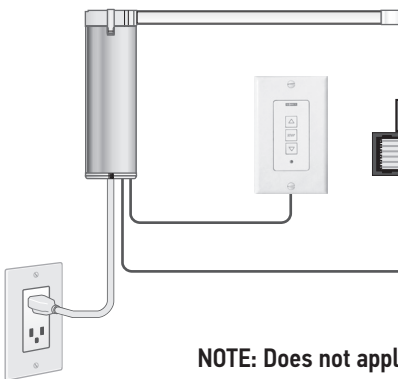

RJ12 SOCKET PIN OUT

For legacy motors

- 6) CW - CLOSE
- 5) STOP
- 4) +5V
- 3) GROUND COMMON
- 2) IR OUT
- 1) CCW - OPEN

For Glydea ULTRA

- 6) CW - CLOSE
- 5) STOP
- 4) NO USE
- 3) GROUND COMMON
- 2) NO USE
- 1) CCW-OPEN

Group control

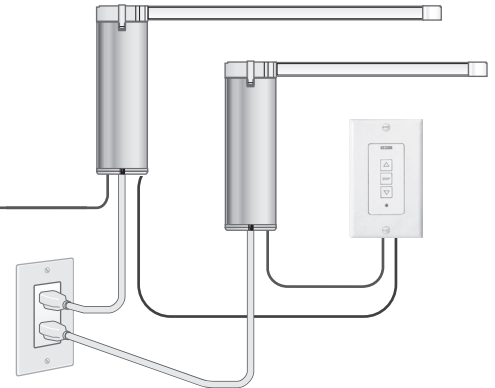

NOTE: Does not apply to Irismo™ 45 WireFree

WIRED CONTROL



Individual control

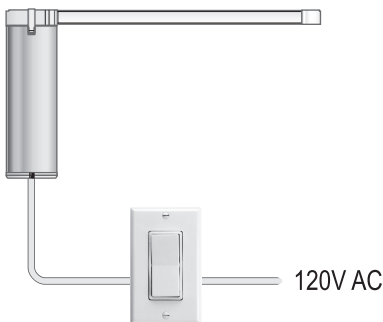

Brown	Dir1
Black	Dir2
Blue	Neutral
Green/Yellow	Ground

Group control

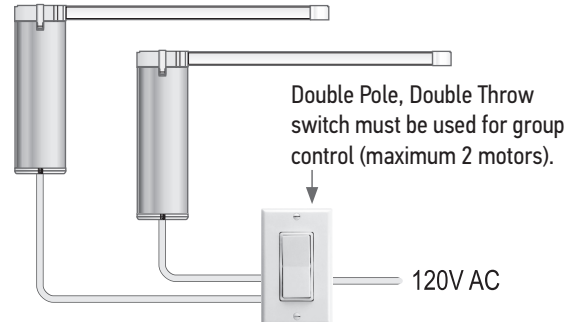

NOTE: Examples are for illustrative purposes. Additional components may be needed depending on your installation.
Applies to Glydea ULTRA range only.

Drapery Motor Wiring Examples



SOMFY DIGITAL NETWORK (SDN) WIRING EXAMPLES

Plug-in:

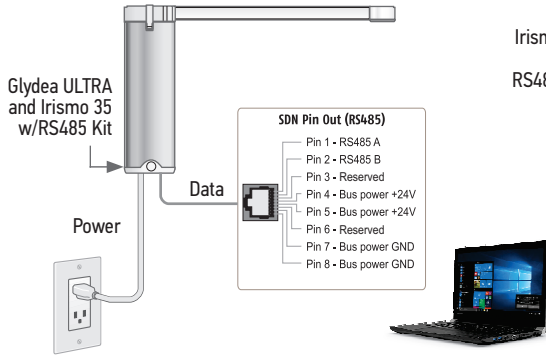

Power Panel:

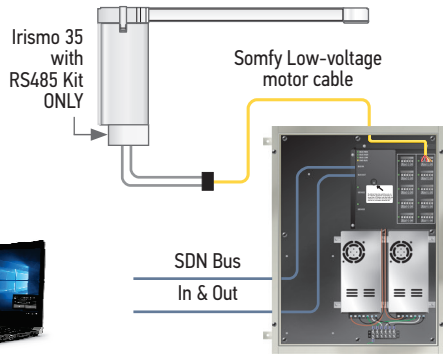

Power over Ethernet (PoE):

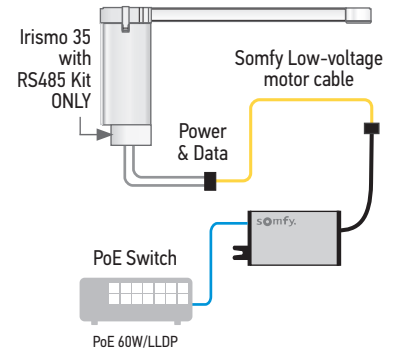

NOTES: Contact Somfy for additional details.

Z-WAVE® CONTROL



Individual control

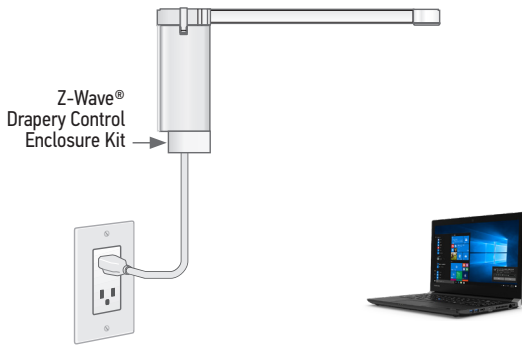

Group and individual control

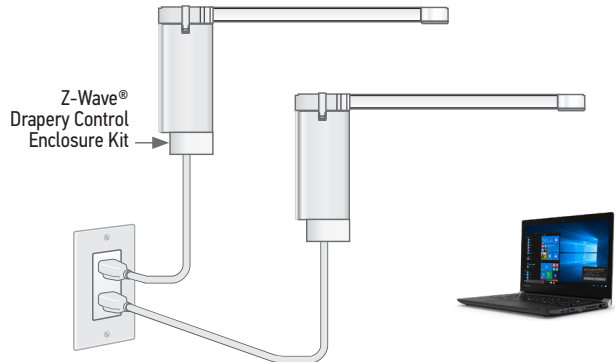

NOTES: Applies to Irismo 35 Mini DC only. Please see page 12 for more details.

ZIGBEE® CONTROL (IRISMO 35 MINI DC)



Group and individual control



NOTES: Examples are for illustrative purposes. Additional components may be needed depending on your installation. Does not apply to Irismo™ 45 WireFree. Not compatible with TaHoma.

Drapery Controls and Accessories

Learn more about controls and accessories at www.somfy.com/controls

RADIO TECHNOLOGY SOMFY® (RTS)



SITUO & TELIS HAND-HELD REMOTE COLLECTIONS



Situot® 1 RTS
Pure Single
Channel Remote
1870571



Situot® 5 RTS
Pure Five
Channel Remote
1870575



Situot® 1 RTS
Iron Single
Channel Remote
1870572



Situot® 5 RTS
Iron Five
Channel Remote
1870576



Situot® 1 RTS
Natural Single
Channel Remote
1870573



Situot® 5 RTS
Natural Five
Channel Remote
1870577



Situot® 1 RTS
Arctic Single
Channel Remote
1870574



Situot® 5 RTS
Arctic Five
Channel Remote
1870578



Situot® 5 RTS
Soliris Five
Channel Remote
1870579



Situot® 5 RTS
Variation Five
Channel Remote
1811612



Telis 16 Channel RTS
Pure Remote with
On-screen display
1811081



Telis 16 Channel RTS
Silver Remote with
On-screen display
1811082



Telis 1 Chronis RTS
Pure Timer with
On-screen display
1805237

DECOFLEX WIREFREE™ WALL SWITCHES



DecoFlex 1 Channel RTS
WireFree™ Wall Switch



DecoFlex 2 Channel RTS
WireFree™ Wall Switch



DecoFlex 3 Channel RTS
WireFree™ Wall Switch



DecoFlex 4 Channel RTS
WireFree™ Wall Switch



DecoFlex 5 Channel RTS
WireFree™ Wall Switch



Smoove® 1 RTS Pure



Smoove® 4 RTS Pure

- Wall Switches shown in white. Also available in black and ivory finishes.
- Shown assembled with printed channel buttons.
- Custom engraved buttons are also available.



Black



Ivory



Pure

Silver
Matte

Black

Light
Bamboo

Amber
Bamboo

Cherry

Walnut

- Battery-operated convenience
- Surface mounts with ease
- Frames available in 7 colors
- Double gang frame available (pure only)

TABLE TOP ACCESSORIES



DecoFlex WireFree™ RTS
Table Top Accessory Black
1811051*



DecoFlex WireFree™ RTS
Table Top Accessory Silver
1810972*



DecoFlex WireFree™ RTS
Table Top Accessory White
1811185*

*DecoFlex Switch sold separately from Table Top Accessory.

Drapery Controls and Accessories

Learn more about controls and accessories at www.somfy.com/controls

RADIO TECHNOLOGY SOMFY® (RTS)



WiFi TO RTS/ZIGBEE INTERFACE

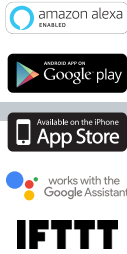

TaHoma Ethernet Adaptor
1870470

TaHoma® RTS/Zigbee
Smartphone & Tablet Interface
1811731

Control window coverings, awnings, screens and rolling shutters using your tablet, smartphone or voice. Create timed events, scenes and more. Integration-ready for third-party control.

16 CHANNEL INTERFACE



Universal RTS Interface 16-Channel
(Converts IR, RS232, RS485 to RTS)
1810872

RTS REPEATER



RTS Repeater
1810791

SOMFY DIGITAL NETWORK™ (SDN)



CONTROL4® TO DIGITAL MOTOR INTERFACE



Receives Zigbee transmissions and converts them to motor control commands.

1870533

SOMFY CONNECT™ LTI



Integrates Somfy RTS and SDN motorized applications with RadioRA® 2, HomeWorks® QS, GRAFIC Eye® QS, and Quantum® control systems.

1870210

SOMFY CONNECT™ UNIVERSAL AUTOMATION INTERFACE (UAI) PLUS



Commission and integrate Somfy-powered SDN solutions over IP.

1870272

SOMFY CONNECT™ BMS INTERFACE



Provides communication between building management systems and SDN motorized shading systems.

1870249

RS485 MODULE FOR IRISMO™ MOTORS (IRISMO DCT TO RS485 UPGRADE)



Converts SDN signals to control commands to operate wired Irismo™ motors.

1811129

RS485 (2-WAY) MODULE FOR GLYDEA® ULTRA MOTORS



Converts SDN signals to control commands to operate wired Glydea® ULTRA motors.

1870275

WIRED TECHNOLOGY



DECORATOR PADDLE SWITCH



Maintained White
1800374
Double Pole,
Double Throw
1800375



Maintained Ivory
1800373
Double Pole,
Double Throw
1800376

For use with Glydea ULTRA wired motors only

DCT (DRY CONTACT TECHNOLOGY)

DRY CONTACT

DRY CONTACT SWITCH



White
1800219



Ivory
1800220

LIMIT SETTING TOOL



For use with Glydea ULTRA & Irismo DCT
9014599

Requires item #9015443
8 ft. Cable with RJ12 Plug

DRAPERY TRACK SPLITTER

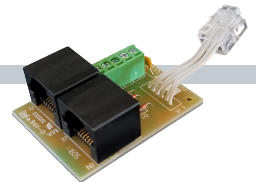







Splitter# 9015442
7 ft. Modular Cable# 9013346
25 ft. Modular Cable# 9013149

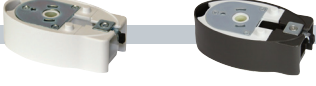





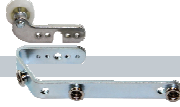

For group & individual control of
DCT drapery motors

Drapery Components







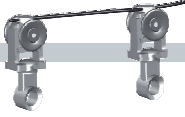
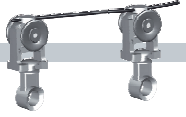
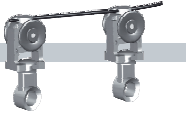

COMMON TRACK COMPONENTS

Small Drive Pulley (white & bronze)  1782318 1782861	Drive Pulley (white & bronze)  1780945 1782873	Pulley Cover (white & bronze)  1780898 1782868	Straight Rail Joint  1782316
Heavy Duty Master Carrier  1781344 Silent Master Carrier 1782922	High Performance 10mm Belt  198' per roll 1782084	Track (white & bronze)  96' per carton (6 pcs. x 16') 1780899 per ft. 228' per carton (12 pcs x 19') 9025133 per ft.	

RIPPLEFOLD® & ACCORDIA® TRACK COMPONENTS

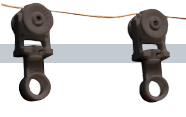
Straight Arm Kit  1782321 For use with center opening draperies.	Overlap Arm Kit  1782320 For use with one way and center opening draperies.	One Way Overlap Arm Kit  1780947 For use with tandem alternative straight arm.	Ripplefold® Butt Master Arms Kit  1780953 For use with center opening draperies only.	
One Way Ripplefold® Butt Arm Kit  1782319 For use with Ripplefold one way opening and double track tandem alternative.	Straight Arm Kit  1782662 For use with tandem butted tracks alternative draperies (to be used together).	Fixing Holder for Ripplefold Runner  9027657 For use with Ripplefold carriers. Attaches to the master carrier and 1st Ripplefold carrier.	90 Degree Drapery Motor Adaptor Plate  9027179 For use with Ripplefold draperies. Provides more aesthetic look.	Adjustable Ripplefold Arm Kit  9027045 For use with Ripplefold draperies. Provides more aesthetic look.

Ripplefold® and Accordia® Type Carriers

80% Fullness (White)  Carrier Spacing: 2 3/8" Qty. per roll: 500 1780903	100% Fullness (White)  Carrier Spacing: 2 1/8" Qty. per roll: 500 1780902	120% Fullness (White)  Carrier Spacing: 1 7/8" Qty. per roll: 500 1780901	Ripplefold Silent Runners 80% (White)  Carrier Spacing: 2 3/8" Qty. per roll: 250 9027592	Ripplefold Silent Runners 100% (White)  Carrier Spacing: 2 1/8" Qty. per roll: 250 9027593	Ripplefold Silent Runners 120% (White)  Carrier Spacing: 1 7/8" Qty. per roll: 250 9027594
80% Fullness (Bronze)  Carrier Spacing: 2 3/8" Qty. per roll: 500 1782872	100% Fullness (Bronze)  Carrier Spacing: 2 1/8" Qty. per roll: 500 1782871	120% Fullness (Bronze)  Carrier Spacing: 1 7/8" Qty. per roll: 500 1782870	Ripple Pendant Only  White 1780948	Ripple Return Snap  100 yd. roll: 1782301 Per yd. 1782542	Ripple Return Snap  White Bronze 1780905 1782863

Recommended for use with Somfy Ripple Snap Tape (ordered separately), but also adaptable to Kirsch and Graber snap tape. Accordia® type carrier consists of Pinch Pleat carrier and Ripplefold® pendant.

Drapery Components

PINCH PLEAT TRACK COMPONENTS

Straight Arm Kit

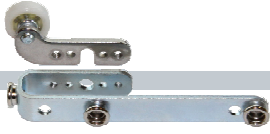

1782321

For use with center opening draperies.

Overlap Arm Kit

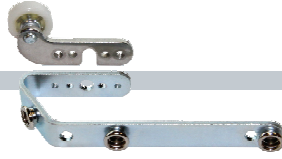

1782320

For use with one way and center opening draperies.

Pinch Pleat Return Hook



White
1780895



Bronze
1782862

Carrier



1781415
Silent Carrier (white only)
1782921



Bronze
1782869

One Way Overlap Arm Kit

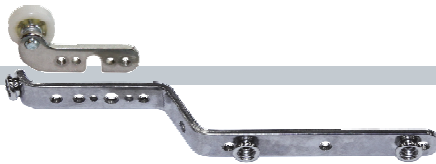

1780947

For use with one way opening draperies with pulley #1780945 & #1782873.

Straight Arm Kit



1782662

For use with tandem butted tracks alternative draperies (to be used with #1780947).

BRACKETS

One Touch Ceiling Bracket



1780907

Adjustable Wall Mount Bracket

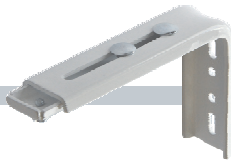

Projection 4.5" - 6"
1780909

Double Adjustable Wall Mount Bracket



Projection 8.75" - 10.25"
1780910

Swivel Ceiling Bracket



1780906



Bronze
1782865



Bronze
Projection 4.5" - 6"
1782866



Bronze
Projection 8.75" - 10.25"
1782867



Bronze
1782864

Adjustable Wall/Ceiling Mount Bracket Kit

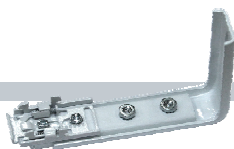

Projection 4.5" - 6"
1782054

Double Adjustable Wall/Ceiling Mount Bracket Kit

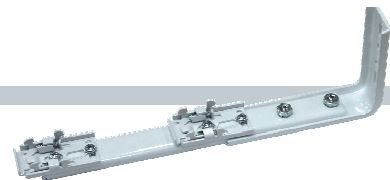

Projection 8.75" - 10.25"
1782053

Product Dimensional Specifications

CARRIER ARM DIMENSIONS

Overlap Arm - #1782320

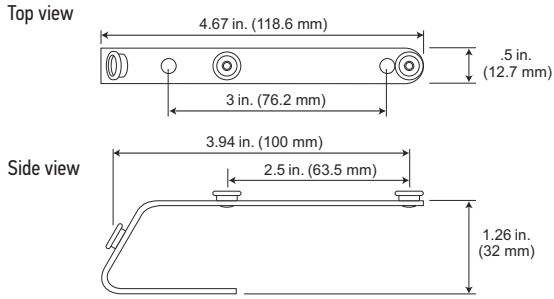

Overlap Arm - #1780947

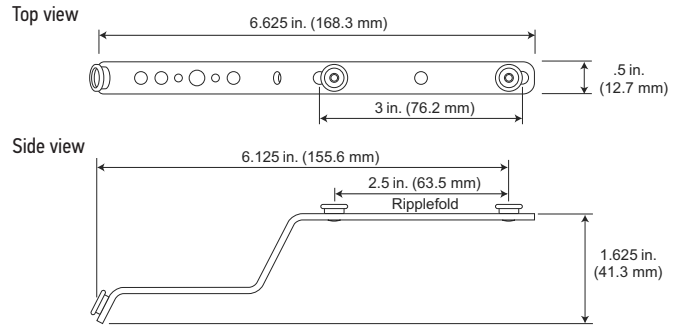

Straight Arm* - #1782321

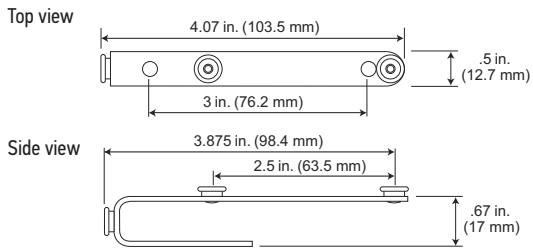

Straight Arm - #1782662

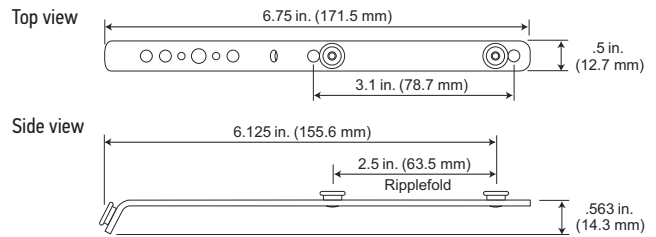

*For use with one-way opening with standard drive pulley.

One Way Butt Arm - #1782319

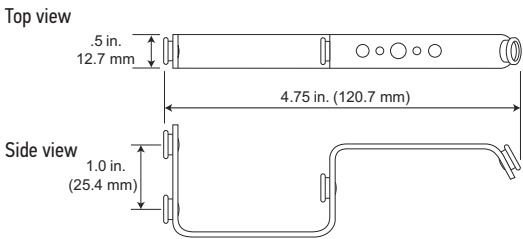

Adjustable Ripplefold Arm kit - #9027045

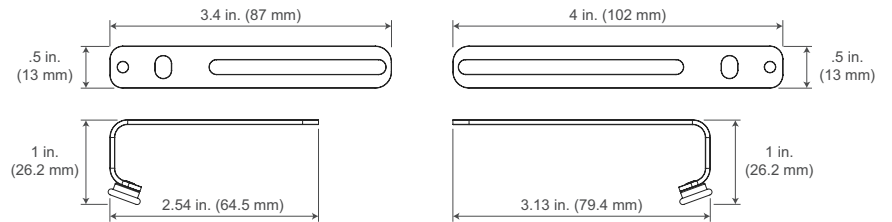

Butt Master Arm Center Opening - #1780953

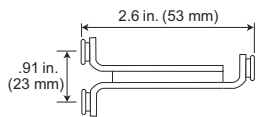

Fixing Holder For Ripplefold Runner - #9027657

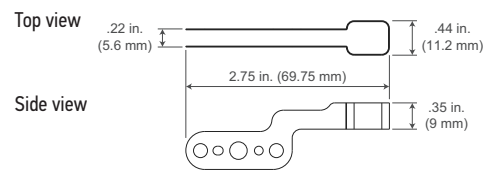

WALL BRACKET DIMENSIONS

Adjustable Wall Mount Bracket - #1780909 & 1782866

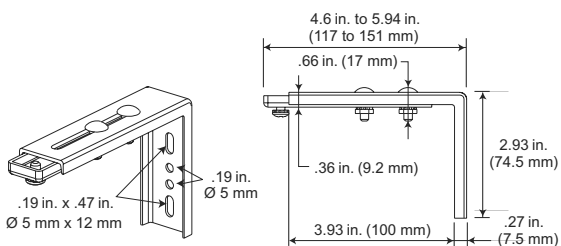

Double Adjustable Wall Mount Bracket - #1780910 & 1782867

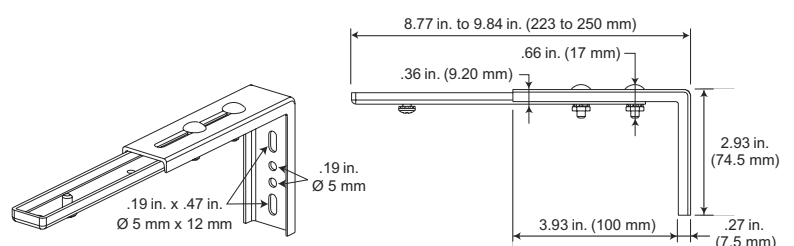

Product Dimensional Specifications

TRACK PROFILE

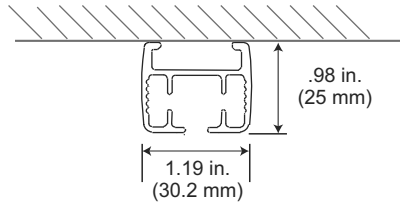

90 Degree Motor Plate - #9027179

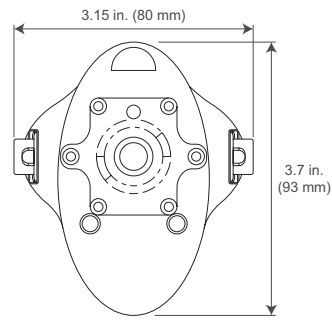

CEILING BRACKET DIMENSIONS

One Touch Ceiling Bracket - #1780907 & 1782865

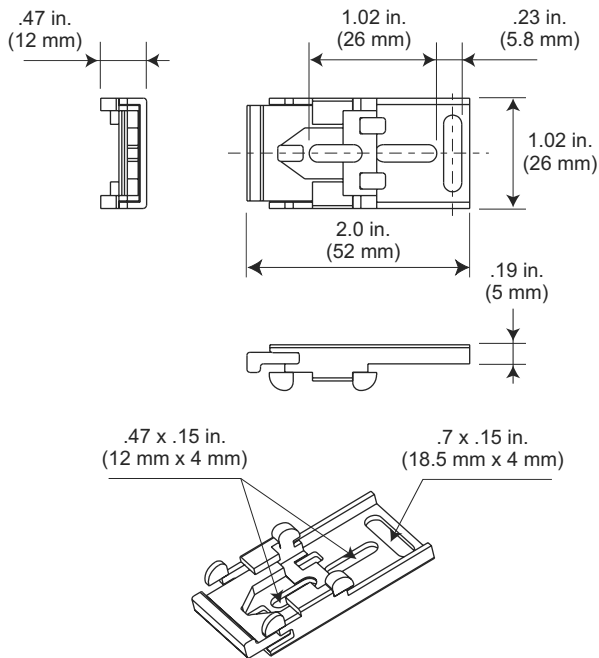

Carriers

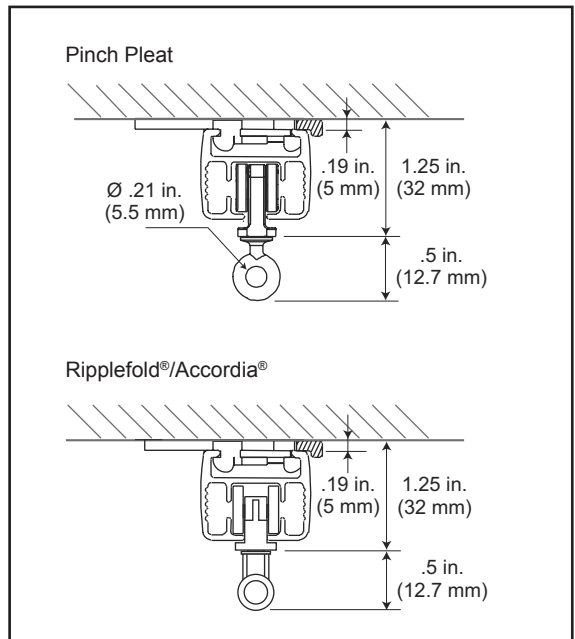

Swivel Ceiling Bracket - #1780906 & 1782864 (recommended for curved tracks)

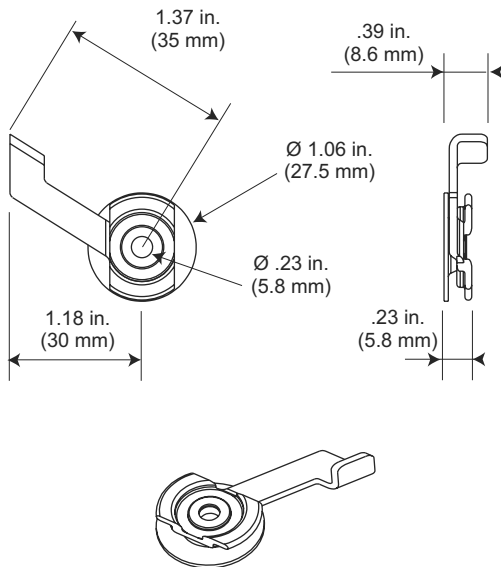

Carriers

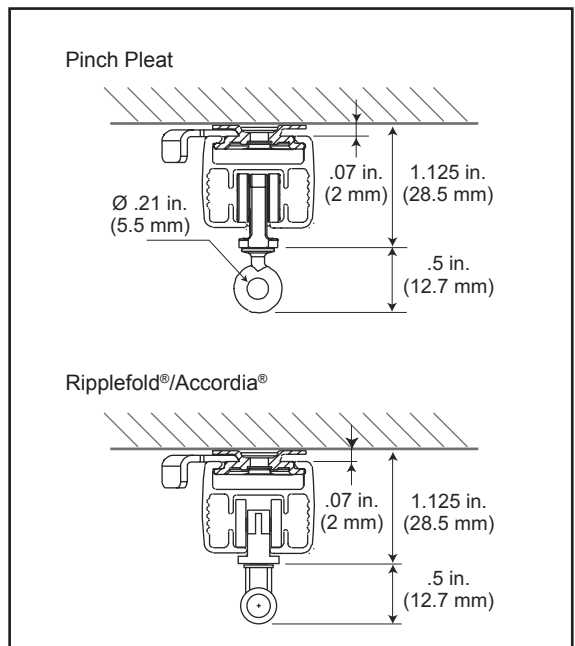

Track Configurations

RIPPLEFOLD® One Way Stacked

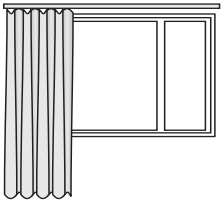

REQUIRED ARMS (1)



One Way Overlap Arm Kit
#1782320



REQUIRED ARMS (2)



One Way Butt Arm Kit
#1782319

Adjustable Ripplefold Arm Kit
#9027045

Bottom-up view of track and drape assembly

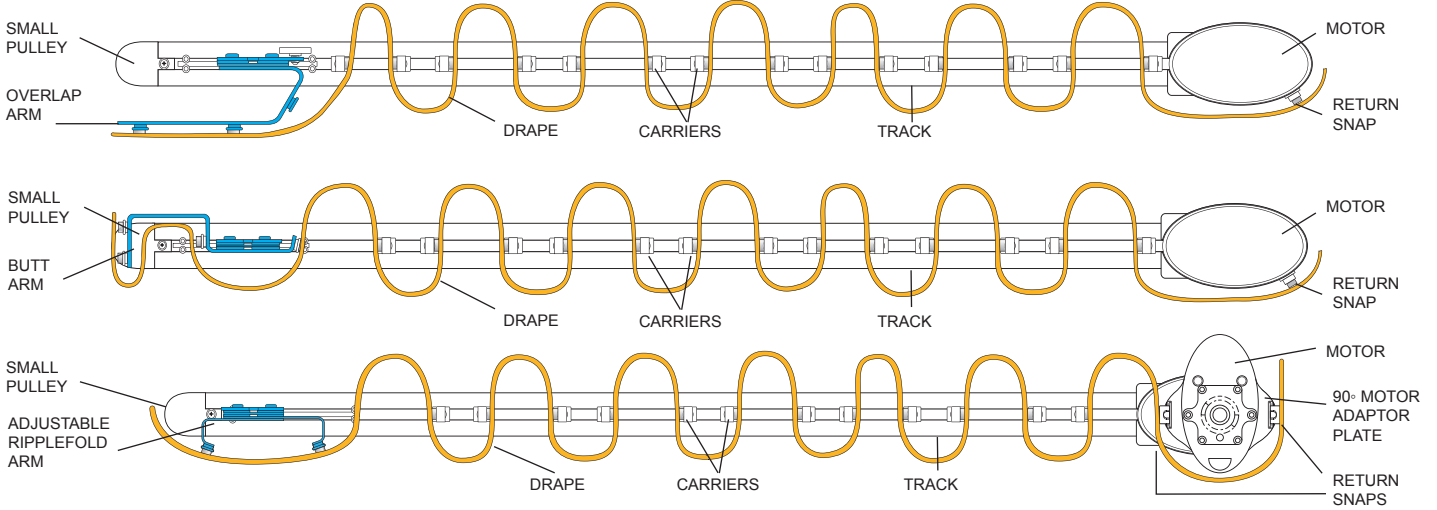

Center Opening

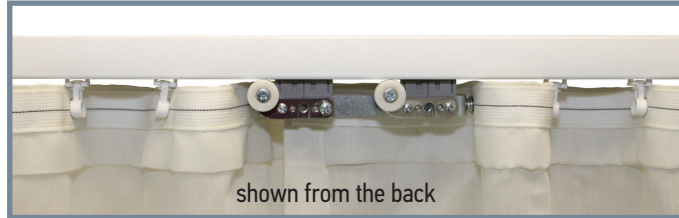
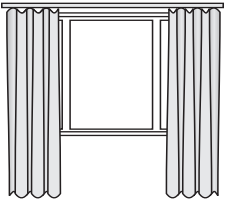

shown from the back

REQUIRED ARMS (1 each)

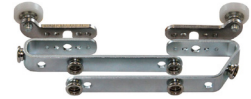

Straight Arm Kit - #1782321
&
Overlap Arm Kit - #1782320

Bottom-up view of track and drape assembly

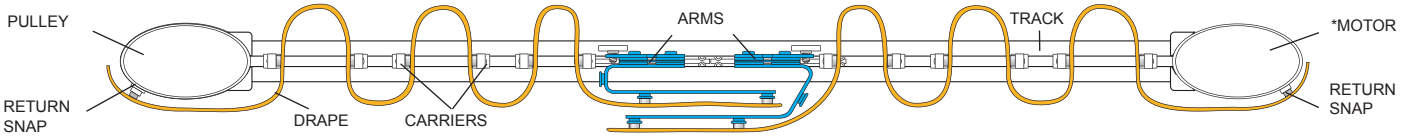

*Motor can be mounted on either side of track.

Center Opening with Butt Master Arms

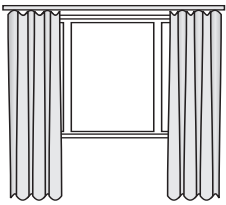

shown from the back

REQUIRED ARMS (2)



Butt Master Arms - #1780953

Bottom-up view of track and drape assembly

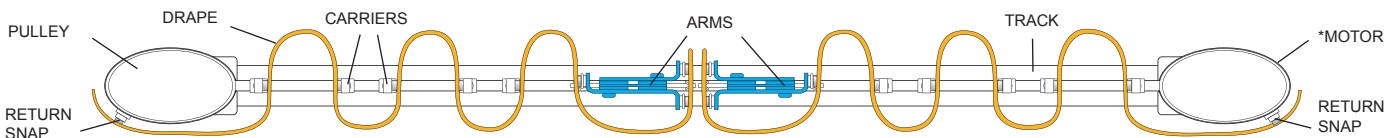

*Motor can be mounted on either side of track.

Track Configurations

PINCH PLEAT One Way Stacked

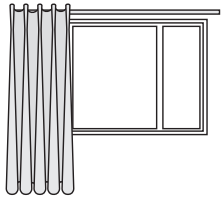

REQUIRED ARMS (1)

One Way Overlap Arm Kit - #1782320



Bottom-up view of track and drape assembly

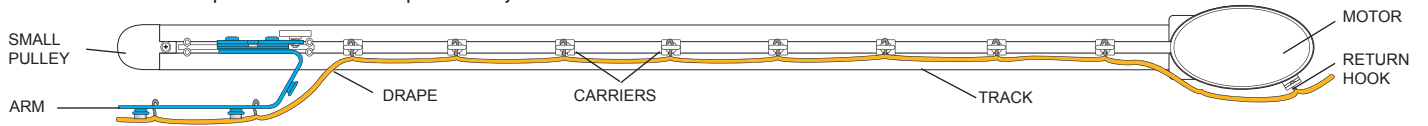

Center Opening

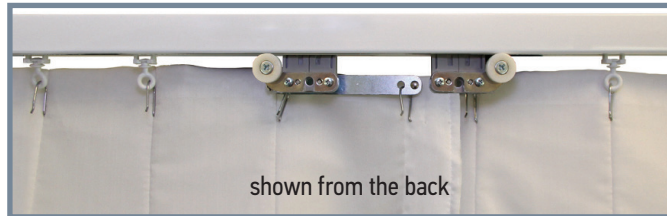
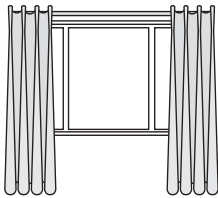

REQUIRED ARMS (1 each)

Straight Arm Kit - #1782321

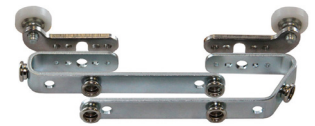

Overlap Arm Kit - #1782320

Bottom-up view of track and drape assembly

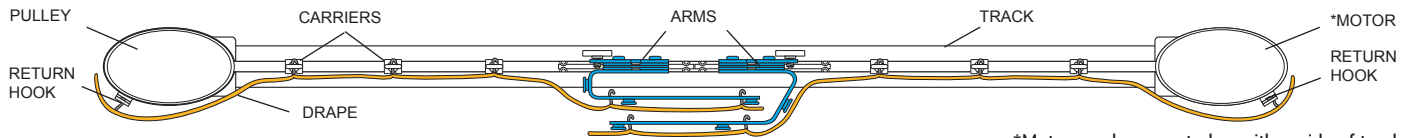

*Motor can be mounted on either side of track.

PINCH PLEAT AND RIPPLEFOLD® Two One Way Butted Tracks (tandem alternative)

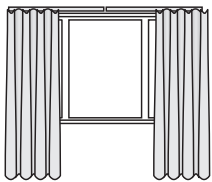

REQUIRED ARMS (2)

One Way Butt Arm Kit - #1782319



REQUIRED ARMS (2)

Straight Arm Kit - #1782662



Overlap Arm Kit - #1780947

Bottom-up view of track and drape assembly

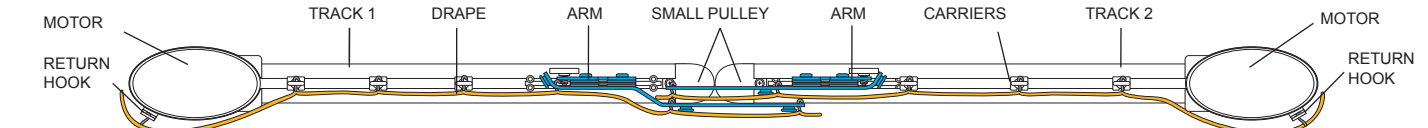
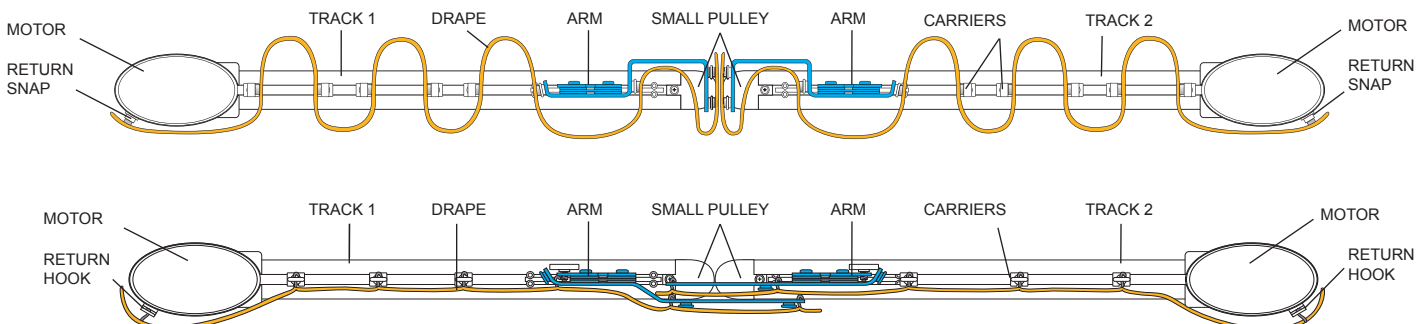

Technical Specifications

SELECTION CHARTS

*STACKING CHART - for reference only

Track Type	Glydea® 35e & Irismo™ 35 Mini DC			Irismo™ 45 WireFree RTS			Glydea® 60e		
	UP TO 10 FT.	UP TO 20 FT.	UP TO 32 FT.	UP TO 10 FT.	UP TO 20 FT.	UP TO 33 FT.	UP TO 10 FT.	UP TO 32 FT.	UP TO 36 FT.
A One Way	77 Lbs.			99 Lbs.			132 Lbs.		
B Center Opening	77 Lbs.			99 Lbs.			132 Lbs.		
C Asymetrical	77 Lbs.			99 Lbs.			132 Lbs.		
D One Way w/Bend R = 30 cm max (11.8")	77 Lbs.	55 Lbs.	44 Lbs.	99 Lbs.	99 Lbs.	77 Lbs.	100 Lbs.	100 Lbs.	77 Lbs.
E Center Opening w/Bend R = 30 cm max (11.8")	77 Lbs.	55 Lbs.	44 Lbs.	99 Lbs.	99 Lbs.	77 Lbs.	100 Lbs.	100 Lbs.	77 Lbs.
F One Way w/2 Bends R = 30 cm max (11.8")	33 Lbs.	22 Lbs.	-	77 Lbs.	66 Lbs.	44 Lbs.	77 Lbs.	55 Lbs.	-
G Center Opening w/2 Bends R = 30 cm max (11.8")	33 Lbs.	22 Lbs.	-	77 Lbs.	66 Lbs.	44 Lbs.	77 Lbs.	55 Lbs.	-
H One Way w/Continuous Curve R = 300 cm (118")	77 Lbs.	33 Lbs.	-	77 Lbs.	44 Lbs.	-	132 Lbs.	55 Lbs.	-
I Center Opening w/Continuous Curve R = 300 cm (118")	66 Lbs.	22 Lbs.	-	66 Lbs.	44 Lbs.	-	113 Lbs.	38 Lbs.	-

TRACK SIZES	RIPPLEFOLD® - inches carrier count - ()					
	ONE WAY 80%	ONE WAY 100%	ONE WAY 120%	CENTER OPENING 80%	CENTER OPENING 100%	CENTER OPENING 120%
	Butt Arm	Butt Arm	Butt Arm	Butt Arm	Butt Arm	Butt Arm
Up to 4 ft.	19.5 (20)	21.5 (24)	23.5 (28)	12.25 (20)	13.25 (24)	14.25 (28)
5 ft.	22 (25)	24.5 (30)	27 (35)	13.75 (26)	14.75 (30)	16.25 (36)
6 ft.	24.5 (30)	27.5 (36)	30.5 (42)	14.75 (30)	16.25 (36)	17.75 (42)
7 ft.	27 (35)	30.5 (42)	34 (49)	16.25 (36)	17.75 (42)	19.75 (50)
8 ft.	29.5 (40)	33.5 (48)	37.5 (56)	17.25 (40)	19.25 (48)	21.25 (56)
9 ft.	32 (45)	36.5 (54)	41 (63)	18.75 (46)	20.75 (54)	23.25 (64)
10 ft.	34.5 (50)	39.5 (60)	44.5 (70)	19.75 (50)	22.25 (60)	24.75 (70)
11 ft.	37 (55)	42.5 (66)	48 (77)	21.25 (56)	23.75 (66)	26.75 (78)
12 ft.	39.5 (60)	45.5 (72)	51.5 (84)	22.25 (60)	25.25 (72)	28.25 (84)
13 ft.	42 (65)	48.5 (78)	55 (91)	23.75 (66)	26.75 (78)	30.25 (92)
14 ft.	44.5 (70)	51.5 (84)	58.5 (98)	24.75 (70)	28.25 (84)	31.75 (98)
15 ft.	47 (75)	54.5 (90)	62 (105)	26.25 (76)	29.75 (90)	33.75 (106)
16 ft.	49.5 (80)	57.5 (96)	65.5 (112)	27.25 (80)	31.25 (96)	35.25 (112)
17 ft.	52 (85)	60.5 (102)	69 (119)	28.75 (86)	32.75 (102)	37.25 (120)
18 ft.	54.5 (90)	63.5 (108)	72.5 (126)	29.75 (90)	34.25 (108)	38.75 (126)
19 ft.	57 (95)	66.5 (114)	76 (133)	31.25 (96)	35.75 (114)	40.75 (134)
20 ft.	59.5 (100)	69.5 (120)	79.5 (140)	32.25 (100)	37.25 (120)	42.25 (140)
21 ft.	62 (105)	72.5 (126)	83 (147)	33.75 (106)	38.75 (126)	44.25 (148)
22 ft.	64.5 (110)	75.5 (132)	86.5 (154)	34.75 (110)	40.25 (132)	45.75 (154)
23 ft.	67 (115)	78.5 (138)	90 (161)	36.25 (116)	41.75 (138)	47.75 (162)
24 ft.	69.5 (120)	81.5 (144)	93.5 (168)	37.25 (120)	43.25 (144)	49.25 (168)
25 ft.	72 (125)	84.5 (150)	97 (175)	38.75 (126)	44.75 (150)	51.25 (176)
26 ft.	74.5 (130)	87.5 (156)	100.5 (182)	39.75 (130)	46.25 (156)	52.75 (182)
27 ft.	77 (135)	90.5 (162)	104 (189)	41.25 (136)	47.75 (162)	54.75 (190)
28 ft.	79.5 (140)	93.5 (168)	107.5 (196)	42.25 (140)	49.25 (168)	56.25 (196)
29 ft.	82 (145)	96.5 (174)	111 (203)	43.75 (146)	50.75 (174)	58.25 (204)
30 ft.	84.5 (150)	99.5 (180)	114.5 (210)	44.75 (150)	52.25 (180)	59.75 (210)
31 ft.	87 (155)	102.5 (186)	118 (217)	46.25 (156)	53.75 (186)	61.75 (218)
32 ft.	89.5 (160)	105.5 (192)	121.5 (224)	47.25 (160)	55.25 (192)	63.25 (224)
33 ft.	92 (165)	108.5 (198)	125 (231)	48.75 (166)	56.75 (198)	65.25 (232)
34 ft.	94.5 (170)	111.5 (204)	128.5 (238)	49.75 (170)	58.25 (204)	66.75 (238)
35 ft.	97 (175)	114.5 (210)	132 (245)	51.25 (176)	59.75 (210)	68.75 (246)
36 ft.	99.5 (180)	117.5 (216)	135.5 (252)	52.25 (180)	61.25 (216)	70.25 (252)

DUAL MOTOR TANDEM ALTERNATIVE (2 one way tracks)

Track Type		Irismo™ 45 WireFree RTS			Glydea® 60e			Glydea® 35e & Irismo™ 35 Mini DC		
		UP TO 10 FT.	UP TO 20 FT.	UP TO 33 FT.	UP TO 10 FT.	UP TO 32 FT.	UP TO 36 FT.	UP TO 10 FT.	UP TO 20 FT.	UP TO 32 FT.
J Center opening w/2 Straight	(1) Straight	99 Lbs.			132 Lbs.			77 Lbs.		
	(1) Straight	99 Lbs.			132 Lbs.			77 Lbs.		
K Center opening w/1 Bend	(1) 90° Bend	99 Lbs.	99 Lbs.	33 Lbs.	100 Lbs.	77 Lbs.	77 Lbs.	55 Lbs.	44 Lbs.	
	(1) Straight	99 Lbs.			132 Lbs.			77 Lbs.		
L Center opening w/2 Bends	(1) 90° Bend	99 Lbs.	99 Lbs.	77 Lbs.	100 Lbs.	77 Lbs.	77 Lbs.	55 Lbs.	44 Lbs.	
	(1) 90° Bend	99 Lbs.	99 Lbs.	77 Lbs.	100 Lbs.	77 Lbs.	77 Lbs.	55 Lbs.	44 Lbs.	
M Center opening w/2 Curves	(1) Curve	77 Lbs.	44 Lbs.	-	132 Lbs.	55 Lbs.	-	77 Lbs.	33 Lbs.	-
	(1) Curve	77 Lbs.	44 Lbs.	-	132 Lbs.	55 Lbs.	-	77 Lbs.	33 Lbs.	-

* Measurements do not consider drapery fabric and are calculated from end of pulley to front of master arm (shown here).

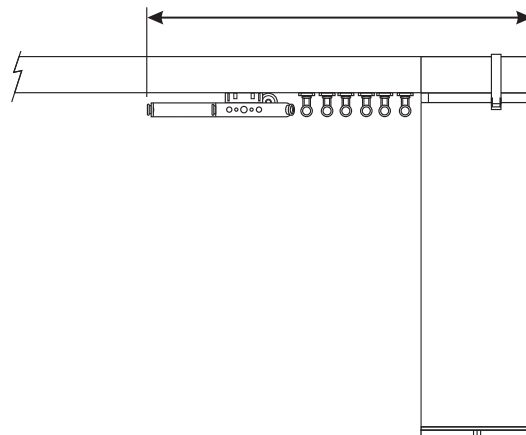

Technical Specifications

*STACKING CHART CONT'D - for reference only

TRACK SIZES	RIPPLEFOLD® - inches carrier count - ()									PINCH PLEAT - inches carrier count - ()		
	ONE WAY 80%	ONE WAY 100%	ONE WAY 120%	CENTER OPENING 80%		CENTER OPENING 100%		CENTER OPENING 120%		ONE WAY	CENTER OPENING	
	Overlap Arm	Overlap Arm	Overlap Arm	Overlap Arm	Straight Arm	Overlap Arm	Straight Arm	Overlap Arm	Straight Arm	Overlap Arm	Overlap Arm	Straight Arm
Up to 4 ft.	19.25 (20)	21.25 (24)	23.25 (28)	14 (10)	13.75 (10)	15 (12)	14.75 (12)	16.25 (14)	16 (14)	15.25 (12)	11.75 (6)	11.5 (6)
5 ft.	21.75 (25)	24.25 (30)	26.75 (35)	15.5 (13)	15.25 (13)	16.5 (15)	16.25 (15)	18.25 (18)	18 (18)	16.75 (15)	12.75 (8)	12.5 (8)
6 ft.	24.25 (30)	27.25 (36)	30.25 (42)	16.5 (15)	16.25 (15)	18 (18)	17.75 (18)	19.75 (21)	19.5 (21)	18.25 (18)	13.25 (9)	13 (9)
7 ft.	26.75 (35)	30.25 (42)	33.75 (49)	18 (18)	17.75 (18)	19.5 (21)	19.25 (21)	21.75 (25)	21.5 (25)	19.75 (21)	14.25 (11)	14 (11)
8 ft.	29.25 (40)	33.25 (48)	37.25 (56)	19 (20)	18.75 (20)	21 (24)	20.75 (24)	23.25 (28)	23 (28)	21.25 (24)	14.75 (12)	14.5 (12)
9 ft.	31.75 (45)	36.25 (54)	40.75 (63)	20.5 (23)	20.25 (23)	22.5 (26)	22.25 (26)	25.25 (32)	25 (32)	22.75 (27)	15.75 (14)	15.5 (14)
10 ft.	34.25 (50)	39.25 (60)	44.25 (70)	21.5 (25)	21.25 (25)	24 (30)	23.75 (30)	26.75 (35)	26.5 (35)	24.25 (30)	16.25 (15)	16 (15)
11 ft.	36.75 (55)	42.25 (66)	47.75 (77)	23 (28)	22.75 (28)	25.5 (33)	25.25 (33)	28.75 (39)	28.5 (39)	25.75 (33)	17.25 (17)	17 (17)
12 ft.	39.25 (60)	45.25 (72)	51.25 (84)	24 (30)	23.75 (30)	27 (36)	26.75 (36)	30.25 (42)	30 (42)	27.25 (36)	17.75 (18)	17.5 (18)
13 ft.	41.75 (65)	48.25 (78)	54.75 (91)	25.5 (33)	25.25 (33)	28.5 (39)	28.25 (39)	32.25 (46)	32 (46)	28.75 (39)	18.75 (20)	18.5 (20)
14 ft.	44.25 (70)	51.25 (84)	58.25 (98)	26.5 (35)	26.25 (35)	30 (42)	29.75 (42)	33.75 (49)	33.5 (49)	30.25 (42)	19.25 (21)	19 (21)
15 ft.	46.75 (75)	54.25 (90)	61.75 (105)	28 (38)	27.75 (38)	31.5 (45)	31.25 (45)	35.75 (53)	35.5 (53)	31.75 (45)	20.25 (23)	20 (23)
16 ft.	49.25 (80)	57.25 (96)	65.25 (112)	29 (40)	28.75 (40)	33 (48)	32.75 (48)	37.25 (56)	37 (56)	33.25 (48)	20.75 (24)	20.5 (24)
17 ft.	51.75 (85)	60.25 (102)	68.75 (119)	30.5 (43)	30.25 (43)	34.5 (51)	34.25 (51)	39.25 (60)	39 (60)	34.75 (51)	21.75 (26)	21.5 (26)
18 ft.	54.25 (90)	63.25 (108)	72.25 (126)	31.5 (45)	31.25 (45)	36 (54)	35.75 (54)	40.75 (63)	40.5 (63)	36.25 (54)	22.25 (27)	22 (27)
19 ft.	56.75 (95)	66.25 (114)	75.75 (133)	33 (48)	32.75 (48)	37.5 (57)	37.25 (57)	42.75 (67)	42.5 (67)	37.75 (57)	23.25 (29)	23 (29)
20 ft.	59.25 (100)	69.25 (120)	79.24 (140)	34 (50)	33.75 (50)	39 (60)	38.75 (60)	44.25 (70)	44 (70)	39.25 (60)	23.75 (30)	23.5 (30)
21 ft.	61.75 (105)	72.25 (126)	82.75 (147)	35.5 (53)	35.25 (53)	40.5 (63)	40.25 (63)	46.25 (74)	46 (74)	40.75 (63)	24.75 (32)	24.5 (32)
22 ft.	64.25 (110)	75.25 (132)	86.25 (154)	36.5 (55)	36.25 (55)	42 (66)	41.75 (66)	47.75 (77)	47.5 (77)	42.25 (66)	25.25 (33)	25 (33)
23 ft.	66.75 (115)	78.25 (138)	89.75 (161)	38 (58)	37.75 (58)	43.5 (69)	43.25 (69)	49.75 (81)	49.5 (81)	43.75 (69)	26.25 (35)	26 (35)
24 ft.	69.25 (120)	81.25 (144)	93.25 (168)	39 (60)	38.75 (60)	45 (72)	44.75 (72)	51.25 (84)	52 (84)	45.25 (72)	26.75 (36)	26.5 (36)
25 ft.	71.75 (125)	84.25 (150)	96.75 (175)	40.5 (63)	40.25 (63)	46.5 (75)	46.25 (75)	53.25 (88)	53 (88)	46.75 (75)	27.75 (38)	27.5 (38)
26 ft.	74.25 (130)	87.25 (156)	100.25 (182)	41.5 (65)	41.25 (65)	48 (78)	47.75 (78)	54.75 (91)	54.5 (91)	48.25 (78)	28.25 (39)	28 (39)
27 ft.	76.75 (135)	90.25 (162)	103.75 (189)	43 (68)	42.75 (68)	49.5 (81)	49.25 (81)	56.75 (95)	56.5 (95)	49.75 (81)	29.25 (41)	29 (41)
28 ft.	79.25 (140)	93.25 (168)	107.25 (196)	44 (70)	43.75 (70)	51 (84)	50.75 (84)	58.25 (98)	58 (98)	51.25 (84)	29.75 (42)	29.5 (42)
29 ft.	81.75 (145)	96.25 (174)	110.75 (203)	45.5 (73)	45.25 (73)	52.5 (87)	52.25 (87)	60.25 (102)	60 (102)	52.75 (87)	30.75 (44)	30.5 (44)
30 ft.	84.25 (150)	99.25 (180)	114.25 (210)	46.5 (75)	46.25 (75)	54 (90)	53.75 (90)	61.75 (105)	61.5 (105)	54.25 (90)	31.25 (45)	31 (45)
31 ft.	86.75 (155)	102.3 (186)	117.75 (217)	48 (78)	47.75 (78)	55.5 (93)	55.25 (93)	63.75 (108)	63.5 (108)	55.75 (93)	32.25 (47)	32 (47)
32 ft.	89.25 (160)	105.3 (192)	121.25 (224)	49 (80)	48.75 (80)	57 (96)	56.75 (96)	65.25 (112)	65 (112)	57.25 (96)	32.75 (48)	32.5 (48)
33 ft.	91.75 (165)	108.3 (198)	124.75 (231)	50.5 (83)	50.25 (83)	58.5 (99)	58.25 (99)	67.25 (116)	67 (116)	58.75 (99)	33.75 (50)	33.5 (50)
34 ft.	94.25 (170)	111.3 (204)	128.25 (238)	51.5 (85)	51.25 (85)	60 (102)	59.75 (102)	68.75 (118)	68.5 (118)	60.25 (102)	34.25 (51)	34 (51)
35 ft.	96.75 (175)	114.3 (210)	131.75 (245)	53 (86)	52.75 (86)	61.5 (105)	61.25 (105)	70.75 (123)	70.5 (123)	61.75 (105)	35.25 (53)	35 (53)
36 ft.	99.25 (180)	117.3 (216)	135.25 (252)	54 (90)	53.75 (90)	63 (108)	62.75 (108)	72.25 (126)	72 (126)	63.25 (108)	35.75 (54)	35.5 (54)