

'96-'00 1.6L SOHC VTEC HONDA FUEL RAIL INSTALLATION INSTRUCTIONS

Tools required:

- Metric socket set and ratchet (extension optional)
- 5/32", 1/4" Hex keys
- 3/4", 10mm, 17mm open end wrenches
- Pliers
- Torque wrench
- Blue Loctite 247

NOTE: BEFORE BEGINNING INSTALLATION OF THE MAXFLOW POWER RAIL, IT IS IMPERATIVE TO ENSURE THAT THE VEHICLE'S ENGINE IS COOL TO THE TOUCH, AND THE FUEL PRESSURE HAS BEEN PROPERLY RELIEVED.

1. Disconnect the negative (-) battery cable from the battery negative terminal.
2. Remove the fuel fill cap.
3. Using a 10mm socket and ratchet, remove the two bolts on top of the stock fuel rail securing the injector wiring harness. Remove the plastic harness from injector wiring loom.
4. Remove the sealing nut from the end of the fuel rail, and set aside.

NOTE: Place a rag or shop towel over the nut and slowly loosen.

Remove the fuel line and all sealing washers. *Note the installation order of the sealing washers.*

5. Disconnect the vacuum signal line from the top of the fuel regulator. Using a 10mm socket and ratchet, remove the bolts holding the fuel regulator to the fuel rail.
6. Disconnect the fuel injector connectors. Remove, and set aside, the retaining nuts on the backside of the fuel rail that are securing it to the intake manifold. Remove the fuel rail and injectors.
7. Following the diagram (see *Figure 1*), install the plug and fuel line/rail adapter onto the fuel rail as shown. *Note that the smallest of the three O-rings is to be used for the regulator adapter.* Use a small amount of clean engine oil to lubricate the O-rings before installation.
8. Install the mounting tabs and regulator adapter onto the fuel rail using the supplied fasteners. A small amount of Blue Loctite 247 is recommended on all fasteners.
9. Using the factory 6mm bolts, attach the regulator to the regulator adapter.
10. Lubricate the injector O-rings and seal rings (on the intake manifold) with clean engine oil. To prevent damage to the O-rings, install the injectors in the fuel rail first, then install the rail assembly into the intake manifold.
11. Install and properly torque retainer nuts to 12N/m (8.7lb/ft).

12. Install the fuel line, sealing washers and nut in the original configuration and torque to 22N/m (16lb/ft).
13. Connect the vacuum line and fuel hose to the fuel pressure regulator. Reconnect the battery and check to ensure all fittings are tight and all hoses are properly routed and connected.
14. Turn the ignition switch on, but do not operate the starter. After the fuel pump has run for approximately two seconds, the fuel pressure in the fuel line will rise. Repeat this two or three times, then check for any possible fuel leaks.

Torque specifications:

- Mounting tabs and fuel pressure regulator - 12N/m (8.7lb/ft)
- Banjo sealing nut - 22N/m (16lb/ft)



ENGINEERING, INC.

1650 PACIFIC AVENUE • CHANNEL ISLANDS, CA 93033-9901 • (805) 247-0226
FAX (805) 247-0669 • www.vortechsuperchargers.com • M-F 8:00 AM - 4:30 PM PST

HONDA FUEL RAIL ASSEMBLY DIAGRAM ('96-'00 1.6 SOHC VTEC)

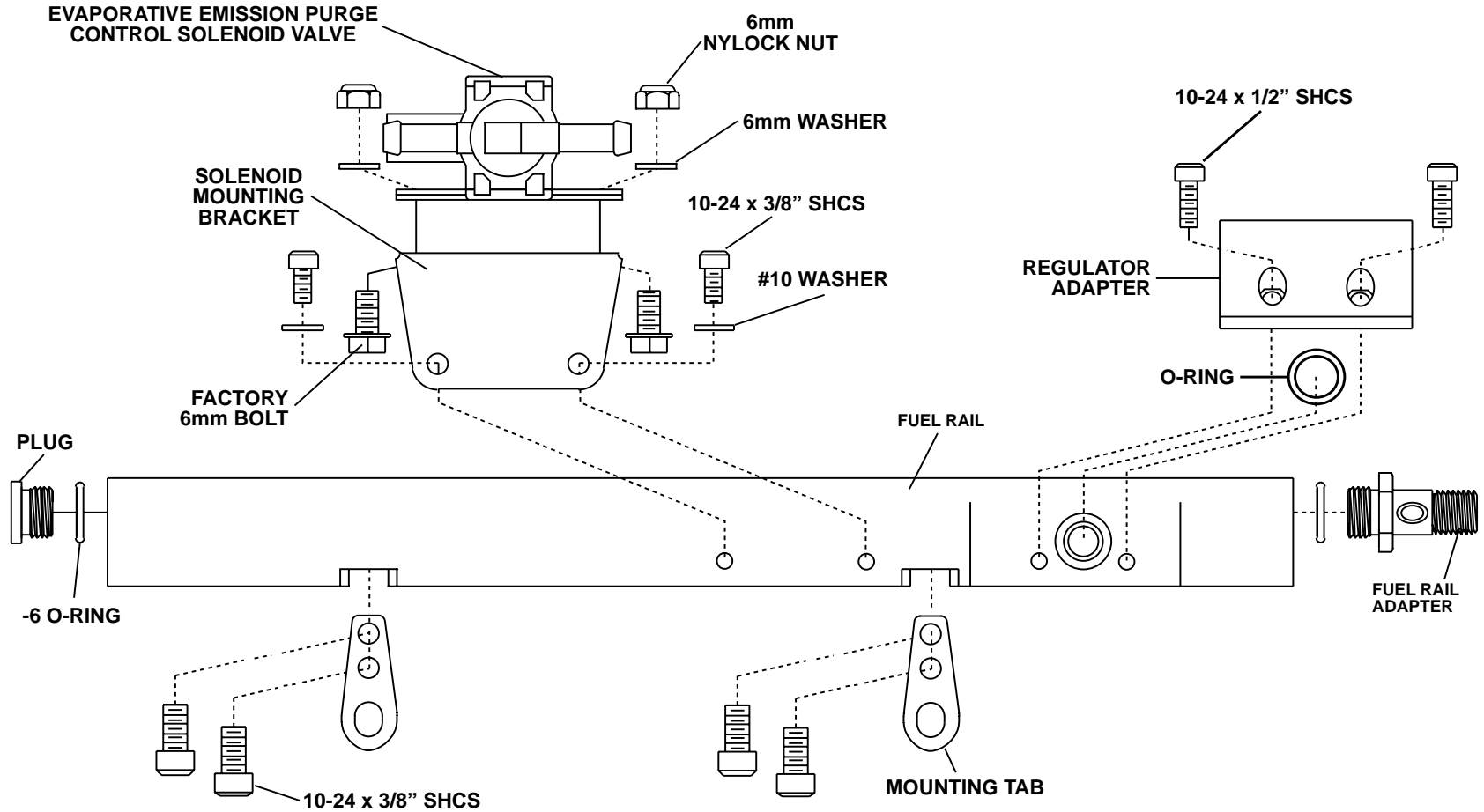

Figure 1