



NGALA
TRADING

WOVEN ZEBRA HIDE RECTANGLE MIRROR

Hand woven sustainably sourced Burchell's Zebra hide covers the frame of this beveled mirror, adding organic warmth to the classic proportions.

Due to the nature of the materials, no two mirrors are exactly alike. Can be hung horizontally or vertically.

MATERIALS AND CONSTRUCTION

Zebra hide
Wood composite
Bevelled mirror

*** Due to the use of natural materials, each piece is unique and will vary slightly from image shown ***

DIMENSIONS

25.5" x 38.5"

REFLECTION AREA

17.5" x 30.5"

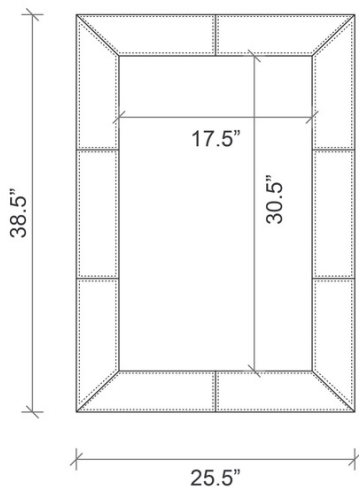

SHIPPING AND DELIVERY

- Durably wrapped and boxed
- Stock supported and available for immediate delivery
- Back-order / Special-order items available for domestic shipping 12-14 weeks from receipt of deposit
- Ships via FedEx Ground

NGALATRADING.COM

