



**NGALA**  
TRADING

## CREAM OSTRICH LEATHER RECTANGLE MIRROR

Sustainably sourced genuine ostrich leather covers the frame of this beveled mirror, adding organic warmth to the classic proportions. Top-stitching contributes artisanal allure.

Due to the nature of the materials, no two mirrors are exactly alike. Can be hung horizontally or vertically.

### MATERIALS AND CONSTRUCTION

Ostrich leather  
Wood composite  
Bevelled mirror

*\*\* Due to the use of natural materials, each piece is unique and will vary slightly from image shown \*\**

### DIMENSIONS

25.5" x 38.5"

### REFLECTION AREA

17.5" x 30.5"

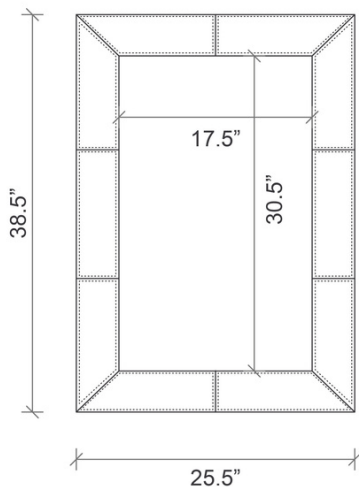

### SHIPPING AND DELIVERY

- Durably wrapped and boxed
- Stock supported and available for immediate delivery
- Back-order / Special-order items available for domestic shipping 12-14 weeks from receipt of deposit
- Ships via FedEx Ground

[NGALATRADING.COM](http://NGALATRADING.COM)

