

# Smart Remote

---

Remote control for GoPro



YOTTAFUN

## A. The Basics

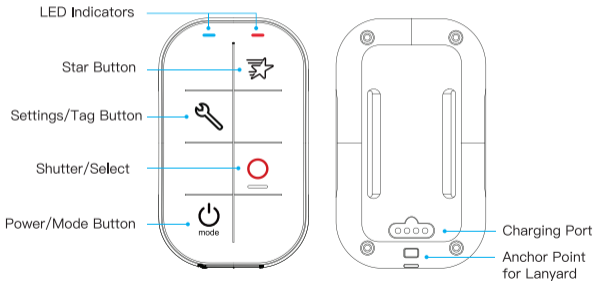

## B. Button Description

### ● Power/Mode Button



To power on: Press and hold the Power/Mode button for one second.

To power off: Press and hold the Power/Mode button for four seconds.

Press the Power/Mode button repeatedly to cycle through the modes. When the remote is connected to multiple cameras, only “Video” “Single” “Burst” and “Time lapse” modes are available.

### ● Settings/Tag Button



Press the Settings/Tag button, the cameras enter/exit GroPro Settings mode.

While recording the video, press the Settings/Tag button on the remote to add a Hilight Tag.(HERO4 and HERO Session cameras only)

- **Shutter/Select Button** 

Use the remote to capture video and photos with one camera or multiple cameras.  
Press the Shutter/Select button to Start/Stop recording.

- **Star Button** 

Set your preference mode to the “Star” button.  
Press the “Star” button, the camera will enter the user-specified mode.

## C. LED Indicators Description

- **Left**

- ★ Blue light blinking: the remote is not connected with the camera.
- ★ Blue light on: the remote is connected with the camera.



- ★ Red light on: Charging
- ★ Red light off: Charge completely

## ● Right

- Blue, Red and Green lights on: Correspond GoPro 3 modes  
Blinking: Recording in corresponding mode  
Blue, Red and Green lights are off at the same time and the remote is connected: GoPro is not available recording in current mode.
- ★ Blue light on: Video mode
- ★ Red light on: Photo mode
- ★ Green light on: Burst mode
- ★ Red and Green lights on at the same time: Time Lapse mode
- ★ Blue and Green lights on at the same time: Night Lapse mode
- ★ Red and blue lights flashing alternately: The power of the remote is low, the remote need to charge.
- ★ Blue, Red and Green lights on at the same time: Settings mode

## D. How to Pair Your Remote and GoPro

- Ensure that both camera and the remote are powered on.
- According to the GoPro user manual, set your GoPro into "Wi-Fi RC" pairing mode, both devices will start pairing. A checked box appears on the GoPro screen once the devices are paired, blue light on the left normally on.
- ★ While people around you are using the same remotes, enter settings mode, choose pair mode "Only in settings mode" and save, the remote will only pair with your GoPro in settings mode.

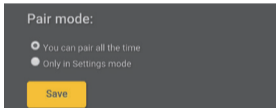

## E. Settings Mode

- Press and hold the Star button for four seconds, Blue light, Red light and Green light on the right turn on. The remote enters settings mode.

- Search Wi-Fi named “HERO-RC-XXXXXX” on your phone or PC. Connect it.
- Enter <http://10.71.79.1> or <http://gore.local> in Browser, get into Remote Options.
- Press and hold the Star button for four seconds, exit settings mode.

## F. How to Set up Star Button

- Enter settings mode, choose your preference mode from “Select a function for Star button”, click the “Save” button.

### Remote Options

#### Star Button

Select a function for Star button:

- Video
- Single Photo
- Burst
- Time Lapse
- Play Back\*
- Night Lapse\*
- Setup\*

\*The function unavailabe when control more than 2 cameras.

#### Pair mode:

- You can pair all the time
- Only in Settings mode

## G. Battery

- When the power of remote is lower than 10 %, red and blue lights on the right will flash alternately every five minutes.
- Check the battery in settings mode, “Battery Level” shows the battery percentage.

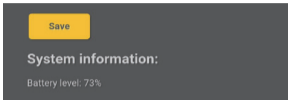

## H. How to Update the Firmware

- Download the new firmware file to you phone or PC from [yottafun.net](http://yottafun.net).
- Enter settings mode, click the “Update firmware” button.





- Select the firmware file, click the “Update” button. The remote will update and power off.

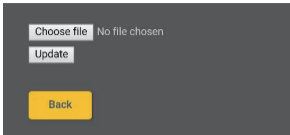

**Remark:**

Do not use the iPhone/iPad or other IOS devices to upgrade the firmware.



YOTTAFUN

Learn more about smart remote at  
[www.yottafun.net](http://www.yottafun.net)