

Wifi Smart Door Lock User Manual

www.okashasmart.com

二、 Function and operation

1. Initialization

Press and hold the setting button (the button on the panel) for 5S, then you will hear: **“Initialization successful”**
 Note: the password for initialization is: 123456, you can also open the door with any fingerprint.

2. Add administrator (you can add up to 3 administrators)

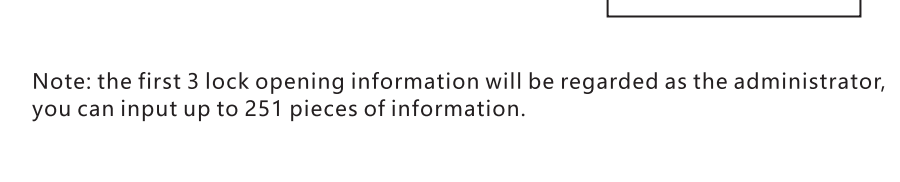

3. Add lock opening information

Method 1:

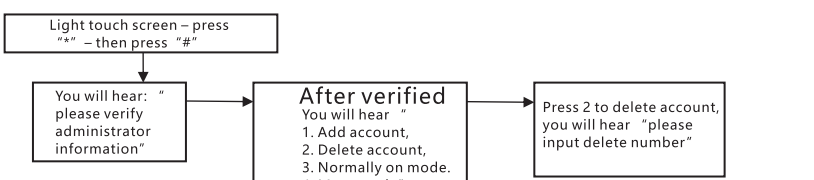

Note: the first 3 lock opening information will be regarded as the administrator, you can input up to 251 pieces of information.

4. Delete door opening information



5. Normally on mode

Method 1:

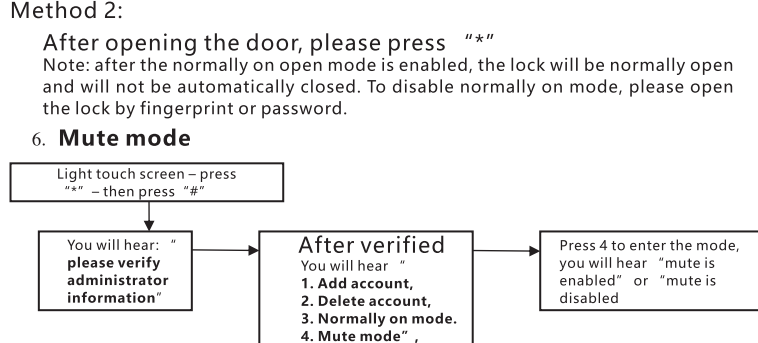

Method 2:

After opening the door, please press "*" Note: after the normally on open mode is enabled, the lock will be normally open and will not be automatically closed. To disable normally on mode, please open the lock by fingerprint or password.

6. Mute mode

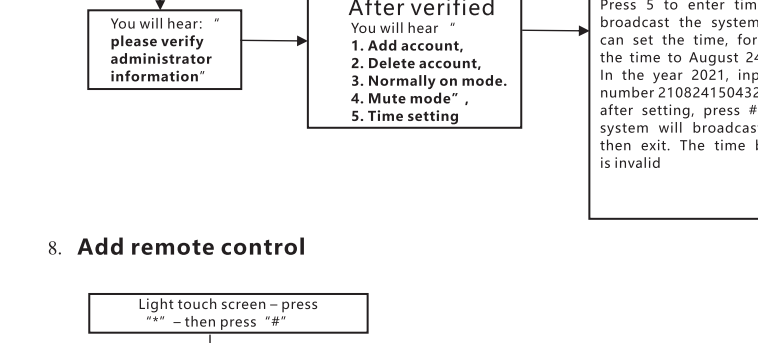

Note: after the mute mode is turned on, it's mute when unlocking.

7. Time setting

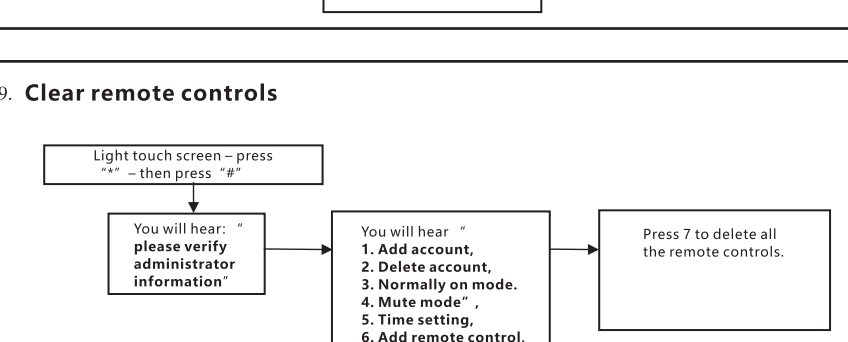

8. Add remote control

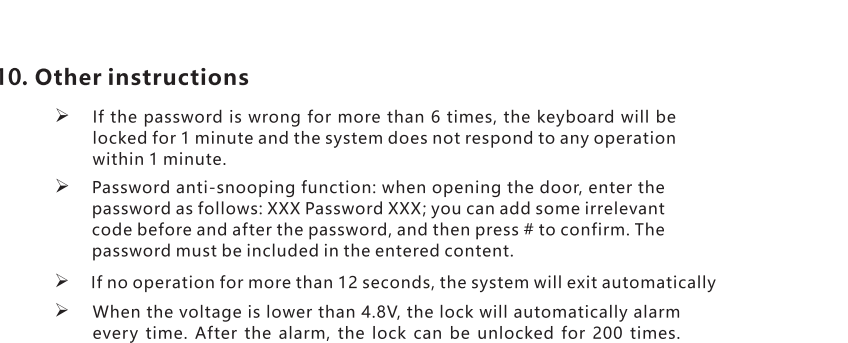

9. Clear remote controls

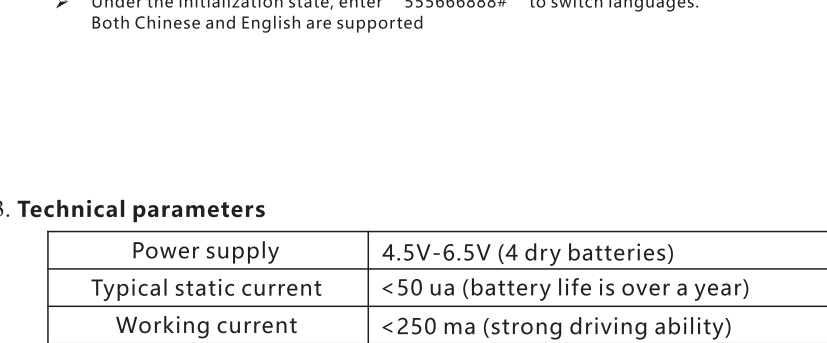

10. Other instructions

- > If the password is wrong for more than 6 times, the keyboard will be locked for 1 minute and the system does not respond to any operation within 1 minute.
- > Password anti-snooping function: when opening the door, enter the password as follows: XXX Password XXX; you can add some irrelevant code before and after the password, and then press # to confirm. The password must be included in the entered content.
- > If no operation for more than 12 seconds, the system will exit automatically
- > When the voltage is lower than 4.8V, the lock will automatically alarm every time. After the alarm, the lock can be unlocked for 200 times. After exceeding the number, it will be delayed when you open the lock, please replace the battery before exceeding the number.
- > Under the initialization state, enter "555666888#" to switch languages. Both Chinese and English are supported

3. Technical parameters

Power supply	4.5V-6.5V (4 dry batteries)
Typical static current	<50 ua (battery life is over a year)
Working current	<250 ma (strong driving ability)
Number of fingerprints	Totally 251 users (100 for fingerprint users, no limit for other users)
Number of cards	
Number of passwords	
Number of remote controls	20
Resolution ratio:	500DPI
FRR	≤0.15%
FAR	≤0.00004%
Working temperature:	-10℃~60℃
Relative humidity:	20% ~ 93%

三、 Select to breed

The Operation Instruction of Network Connection of Okasha Smart

The operations are as follows:

1. First, switch on cellular data network or connect to WIFI network. Then, download the app called "Okasha Smart" from the "app market". and open, register and log in it.
2. After login, click "my home". Click the plus sign at the upper right corner. Choose "Security Monitoring". Gate Lock(WIFI). Input the name and password of WIFI network(or mobile hotspot) and click "next step". Choose "Check keyboard lights flash" and click "next step".
3. Meanwhile, *+# Verify the identity of administrator to enter the menu interface of the gate lock and click "6" (Add network). At this time, there are two kinds of voice broadcasts: 1.Hotspot connection 2.Smart connection. The user can click "1" or "2" to choose corresponding connection type in accordance with the network mobile phone connects to.
- 4.Wait for the connection. If the user succeeds in the network connection, the user can see "Successfully added" in the app, and click "complete". In the meantime, there will be a tip which shows "Operation Success" from the gate lock. Otherwise, there will be a tip which shows "Operation failure".

Note:

1. Please register as "administrator" before the network connection;
2. After the network connection, "1" (or "2") and "*" on the device will keep bright, and Light "5" will be flashes at a 1-second interval at first. If the network connection fails after 45s, there will be a voice prompt "Please switch o Bluetooth of mobile phone", then Light "5" will be flashes at 0.5-second interval. If the device is connected to the router but not the cloud, Light "5" will flash rapidly at 150ms. This WIFI module is double module with WIFI an Bluetooth, where Bluetooth is used to distribute network, so the user ca switch on Bluetooth before adding networks.
3. When using the Gate lock, if the user succeeds in network connection, th blue light, which is a mood light, will flash twice to indicate that network connected (not in the model of adding networks).
4. For remote unlocking, input 9#, and the mobile app will receive the request information

Explore the whole new world of Smart Devices & Easy access to Smart Life

