



Instruction Manual

SMART WIFI BULB Multicolor



Works with:



Siri



alexa



Google Assistant



OKASHA
SMART APP

10W LED POWERED BY
OKASHA

NO.1

Download the Okasha Smart App from App Store or Google Play.

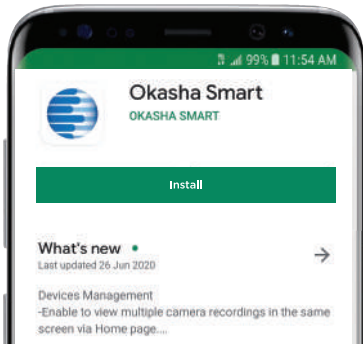
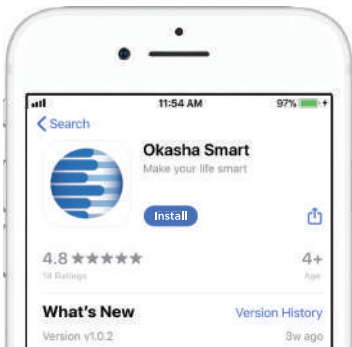

NO.2 Add New Device

To add your new device, open Okasha Smart App on <My Home> page, press <+> in the upper right corner and then <Lighting Devices>.

The Application offers two different procedures to add your new device: EZ and AP mode. Please use the default EZ mode. If it fails, please try again or use AP mode.

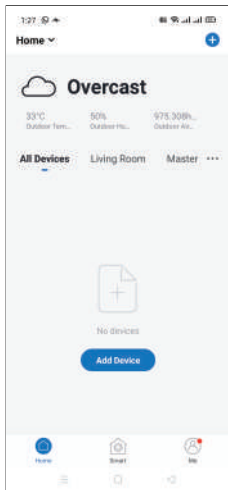

NO.3 Add New Device – EZ procedure

Make sure your new device is in EZ mode, otherwise reset it by switching on the device and, after 10 seconds, switching it off and then switching it on and off continuously until it starts blinking quickly.

After resetting the device:

1. Open mobile Bluetooth, then come out the pic.1.
2. Click <Go to add> to add device.
3. Enter the password of the WiFi network you are connected to and press <Next> to connect your new device (The WiFi network supported is 2.4Ghz) as show in pic.2.
4. Press <is fast blinking (0.5s/time)> . A Page will open as shown in pic.3.

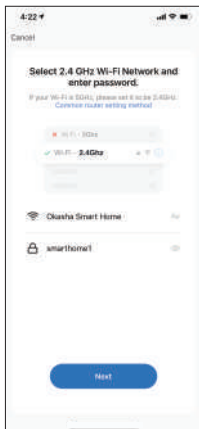

Pic.1



Pic.2

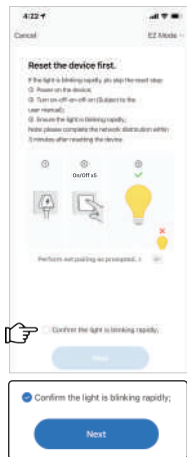

Pic.3

NO.4 Add New Device – EZ procedure

When connecting the device, you can see the connection status as shown in pic.4. Once connected, a page will open as shown in pic.5. Select the room of your home where the device is located and press <Done> to access the control page of your new device. Now your new device is ready to be controlled via the App, even remotely.

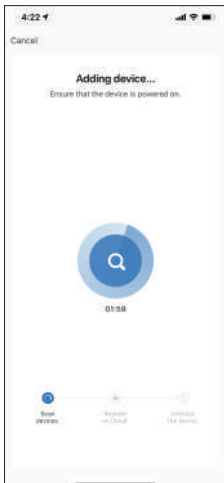

Pic.4

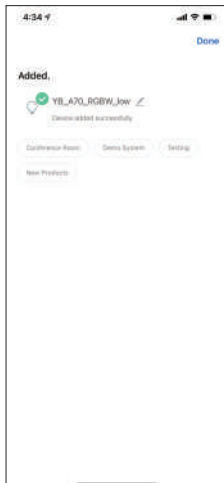

Pic.5

You can share your devices with your family and friends who has already downloaded Okasha Smart App and registered a new account.

The people you shared your devices with will be able to control them, but they will not be able to add new devices to your home or even delete devices with them shared.

You have two different ways to share your devices:

- A. Enter the page of your profile, press <Home Management> and <Shared devices> to enter the page where you can select the devices you want to share and then enter the mail address with which the user you want to share them with is registered in the Okasha Smart App.

If you want to delete sharing with a user, place your finger on the user's name, scroll to the left and press <Delete>.

- B. Enter the menu of the device you want to add, click <Shared Devices> and enter the email address with which the user you want to share them with is registered in the Okasha Smart App.

If you want to delete sharing with a user, place your finger on the user's name, scroll to the left and press <Delete>.

1) Can I group multiple Okasha Smart's devices together?

Yes, you can group multiple devices of the same type together, by room, location or however else you want. The same devices can be in multiple groups.

From your main devices list, press on one of the devices you want to group, press the menu button on the top right and click <Create Group>. You will then be able to choose which devices you would like to group together, confirm and name the new group and save.

Now, in the page of the devices' list, you will also find the new group just created. Each command given to the group will be executed simultaneously by all the devices belonging to that group.

2) How many devices can I control?

The App can control an unlimited amount of devices in an unlimited amount of locations.

Your router may have a limit of how many devices can be connected to one router.

3) The device appears offline or unreachable, what should I do?

Make sure your WIFI router is online and in range.

Make sure you have the latest Okasha Smart functionality by pressing <Check for firmware update> in your device settings.



Scan the QR code
to watch complete
configuration video

YouTube



Google Assistant

Scan the QR code for
configure the Smart bulb
with Google Assistant.

