

SPARK & BELL

Instruction Sheet

Thank you for purchasing our lights. All of our lights are designed and hand-made in the UK and are made to meet the requirements of UK and EU standards. When you're ready to install your light, make sure you hand the instructions to a qualified electrician. With that in mind please:

- Shut off the power before installing
- Do NOT exceed the wattage listed on the label
- These lights are for INDOOR USE ONLY
- Always make sure any surface close to the bulb is at least 30mm away to prevent fire hazard
- Ensure fixings are appropriate for the mounting surface
- Screws provided may not be suitable

Parts Included:

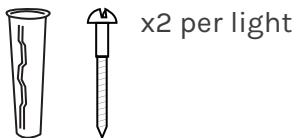

You will need:

- Electric Drill
- Screwdriver

Extra Notes:

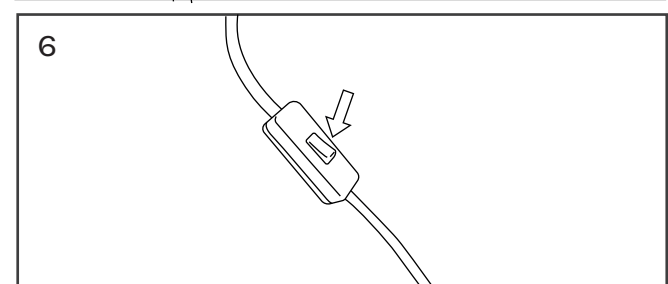
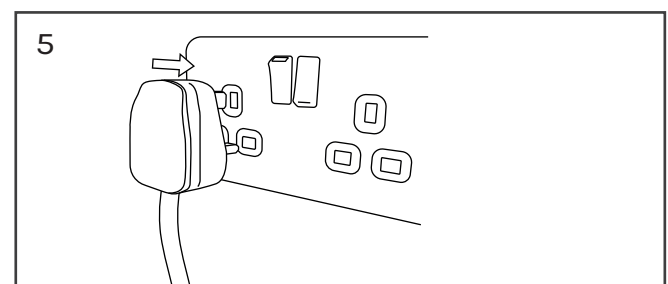
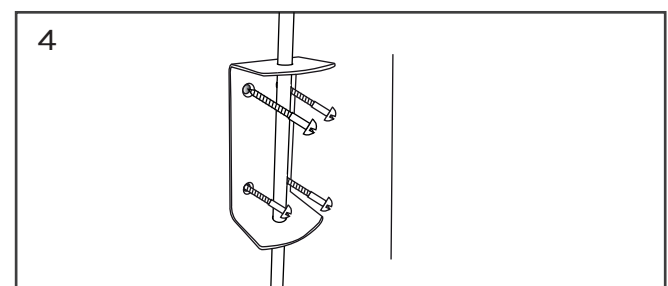
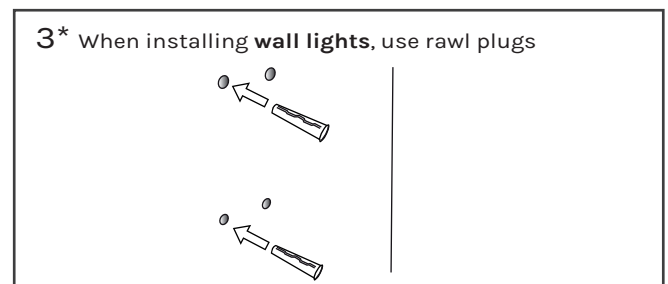
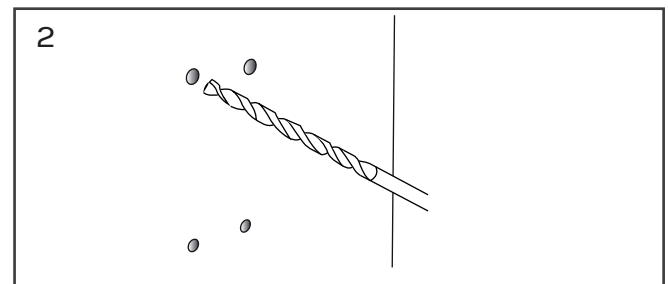
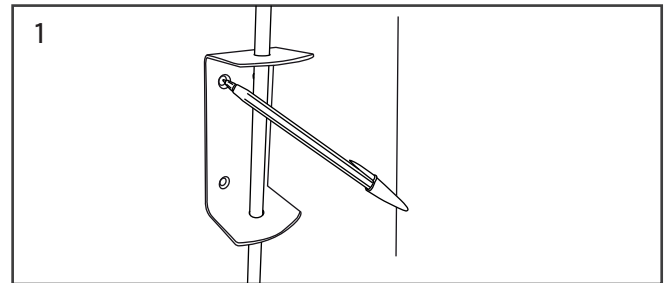

Contact us

- ☎ 01273 230566
- 📷 @sparkandbell
- 🌐 sparkandbell.com
- ✉ contact@sparkandbell.com