

SPARK & BELL

Instruction Sheet

Thank you for purchasing our lights. All of our lights are designed and hand-made in the UK and are made to meet the requirements of UK and EU standards. When you're ready to install your light, make sure you hand the instructions to a qualified electrician. With that in mind please:

- Shut off the power before installing
- Do NOT exceed the wattage listed on the label
- These lights are for INDOOR USE ONLY
- Always make sure any surface close to the bulb is at least 30mm away to prevent fire hazard
- Ensure fixings are appropriate for the mounting surface
- Screws provided may not be suitable

Parts Included:

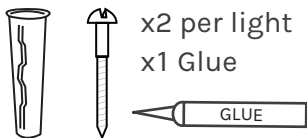

You will need:

- Electric Drill
- Screwdriver

Before installing your light please:

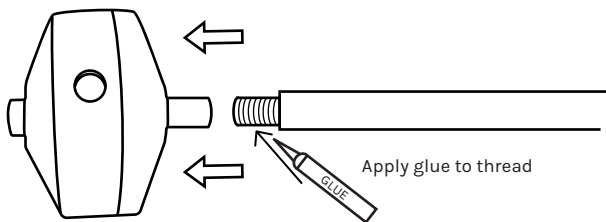

Make sure to attach the stem to the main body by first threading the cable through the stem and then screwing together to securely attach using glue provided. Apply the glue to the thread shown in diagram above.

Contact us

- ☎ 01273 230566
- 📷 @sparkandbell
- 🌐 sparkandbell.com
- ✉ contact@sparkandbell.com

