

# Installation Instructions

## CEILING LIGHTS

IP20  
Rated

### IMPORTANT

It is essential that your lights are fitted by a qualified electrician - please ensure the following instructions are followed, and retain for reference. Install in accordance with current building and electrical regulations.

### WARNING

- Always disconnect the mains power before installation.
- Do not exceed the bulb wattage on the label.
- For INDOOR USE ONLY.
- Always make sure any surface close to the bulb is at least 30mm away to prevent fire hazard.
- Ensure fixings are appropriate for the mounting surface - screws provided may not be suitable.

### Included:

- Screws (2 per light)
- Gloves

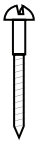

### Required:

- Electric Drill
- Screwdriver

### How to mount your ceiling light:

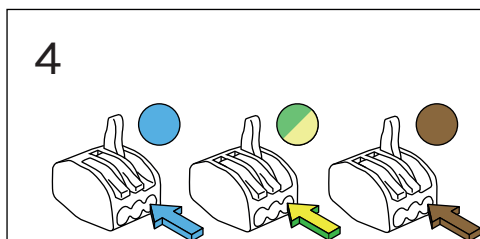
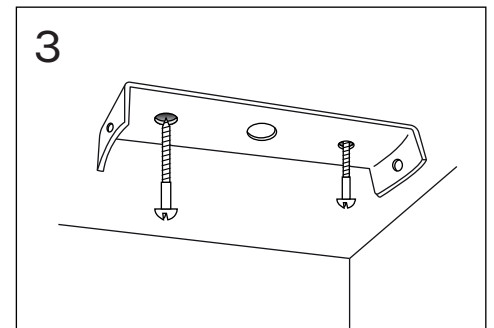
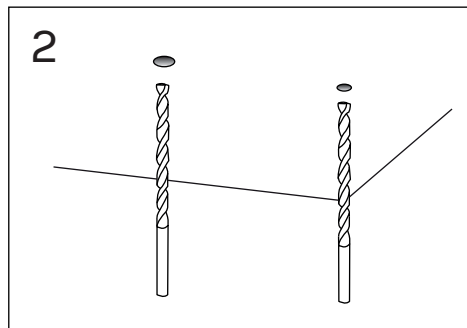
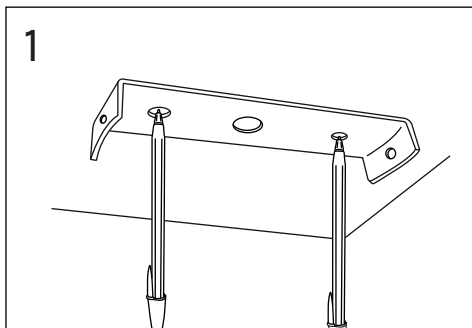

Ensure all wires are fully inserted into connectors and secured by firmly pressing down the locking clip.

Ensure all wires of the same colour are inserted into the same clip, and there are no loose copper strands.

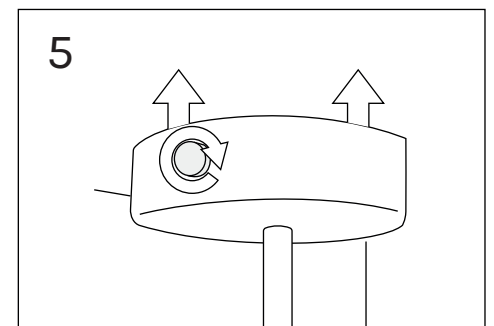

### Contact Us

 [sparkandbell.com](http://sparkandbell.com)

 01273 230566

 [contact@sparkandbell.com](mailto:contact@sparkandbell.com)

 @sparkandbell

Spark & Bell, Ground Floor, Victoria House, Vale Road, Portslade, BN41 1GG

