



QUICK-START GUIDE

CORE Family™ 0.1 Micron Water Filtration System

The Vivoblu CORE Family™ Water Filtration System turns any freshwater source into clean and safe drinking water for you and your family.



Before using your filter, scan this QR code or visit www.vivobluservices.com/manual for set-up videos, and important use and safety information.

1-866-VIVOBLU

HOW DOES IT WORK?

Vivoblu filters contain thousands of hollow fiber membranes, which each have thousands of microscopic pores measuring just 0.1 micron across. That's nearly 1000x smaller than one grain of fine sand and about 30x smaller than bacteria. These tiny pores allow clean water to flow through while blocking out the dirt, microorganisms and contaminants that cause waterborne illnesses.

Removes 99.9+% Bacteria, Protozoa & Cysts, including:

- Cholera
- E.Coli
- Botulism
- Typhoid
- Salmonella
- Amoebic Dysentery
- Streptococcus
- Coliform Bacteria
- Giardia
- Cryptosporidium
- Cyclospora

Removes 100% Microplastics
Removes Viruses > 0.1 micron, including the virus that causes COVID-19

HOW DO I USE IT?

1. Set up your system according to one of the configurations to the right (or scan the QR code to watch a video about how to configure your system).

2. Your filter works like a sponge and must absorb water before it starts to flow. Hold your filter underwater and shake it for 20 seconds to release air bubbles and speed up water absorption.

3. In a container installation, continue holding the filter at the bottom of the container with the tap in the open position until water begins to flow. For direct suction or siphon usage, initiate flow by sucking on the outflow tube or tap.

4. Discard the first liter of filtered water. This water is safe to drink but will have a sour stale taste resulting from long-term filter storage.

5. If using frequently (once a week or more), keep your filter wet between uses! If your filter completely dries out, perform the priming process in Steps 1-4 again before using.

** Do not use the CORE Family™ filter with seawater or brackish water, water from mining operations, water near large agricultural operations, or water contaminated with chemicals, radioactive materials or particles smaller than .1 μm.*

CONFIGURATIONS & PARTS



1
CORE Filter



2
Short Tube



3
Long Tube



4
Wingnut

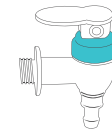

5
Main Tap

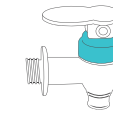

6
Second Tap

Double Container System

Utilize all components to create a stacked container system with dirty water on top and filtered water on bottom.

Parts: 1, 2, 3, 4, 5, 6

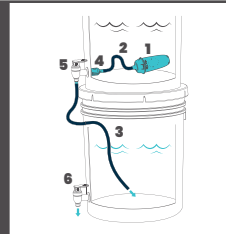

Single Container System

Install in any single food-safe container such as a bucket, tub, or barrel. Draw water directly from tap or attach tube* for added flexibility and flow. For deeper containers use long tube (3) inside.

Parts: 1, 2, 3, 4, 5

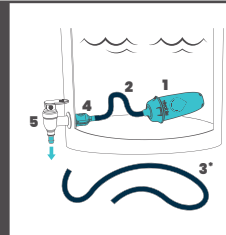

Watertight Bag

For use on-the-go, install in a Vivoblu® watertight, food-safe bag. Connect long or short tube to filter as needed. Second tube can be attached to tap for increased flow rate.

Parts: 1, 2 or 3, 4, 5

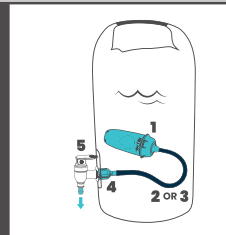

Continuous Siphon

Submerge filter in dirty water and drape tube over container. Suck tube to start flow. Collect clean water in lower container. Outflow end of tube must be lower than filter. Raise tube to stop flow.

Parts: 1, 3

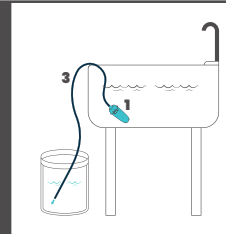

Tap-Controlled Siphon

Use in the same manner as continuous siphon, but install wingnut nozzle and tap to filter tube for controlled flow.

Parts: 1, 3, 4, 5

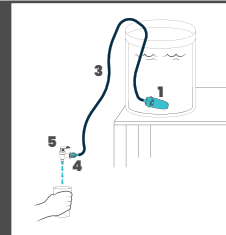

Directly from Source

Submerge filter in freshwater source and drink directly from tube.

Parts: 1, 3

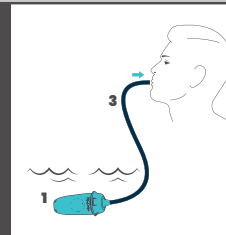

HOW DO I CLEAN IT?

Clean your filter once per week or when you notice the flow of clean water has diminished. Cleaning is done directly in the dirty water source and by hand without any tools using the following steps:

1. Twist off the top shield to expose the inner filter core. Do not unscrew the filter cartridge from the filter base or disconnect tubing from the filter; this can cause contamination!

2. Shake, swish or rinse the filter vigorously in the dirty water for 20 seconds or until the filter fibers become visibly clean. This process shakes away any particles that may be blocking the tiny pores of your filter and slowing down the flow rate.

3. Twist the top shield back onto the base and continue using the filter normally.

CAN I TRUST IT?

Vivoblu water filters have been scientifically tested by independent certified laboratories to meet or exceed the US EPA & NSF/ANSI 53 and 58 drinking water standard for the removal of protozoan (cysts), and the US EPA & NSF/ANSI P231 drinking water standard for the removal of bacteria and parasites, including the prevention of cholera, botulism, typhoid, amoebic dysentery and all coliform bacteria-related illnesses.