

INSTRUCTION MANUAL

SPECIFICATION

Wi-Fi Smart Power Strip
 3 Power sockets + 1USB-C +3 USB-A
 Rated Parameter: 2500W 10A 250V-
 Input: 100-250V 50/60Hz 10A(Max)
 PD Output: 5V=3A, 9V=3A, 12V=2.5A, 15V=2A,
 20V=1.5A 30W [Max]
 QC Output: 5V=3A, 9V=2A, 12V=1.5A 18W(Max)
 Auto-ID Output: 5V=2.4A Total Power: 30W Max
 WiFi Frequency: 2.4GHz Color: White and Grey
 Size: 177.46X112 X 30.2mm

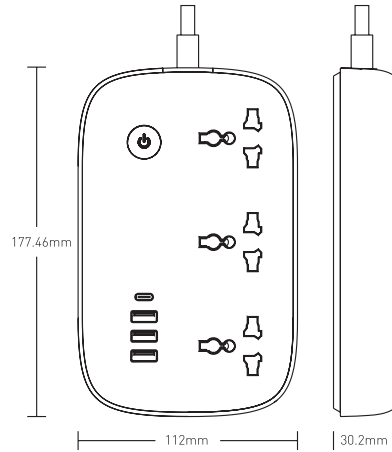

FEATURES

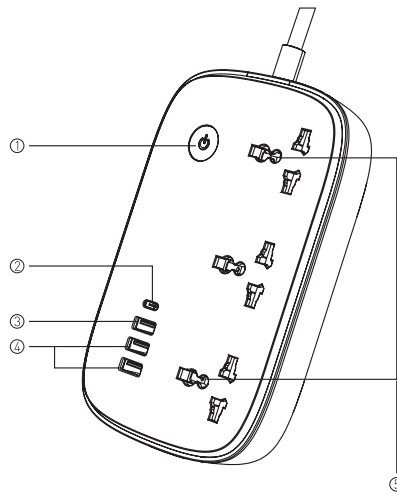

- ① Master switch button
- ② PD port
- ③ QC3.0 port
- ④ Auto-ID port
- ⑤ Power sockets

FEATURES

- The product can be linked with other smart devices through the smart WiFi App.
- Three AC jacks and USB ports can be independently controlled.
- Remote control: One APP controls all kinds of electrical appliances in the home, remote control anytime, anywhere.
- Timing setting: scene timing, such as water heater, night light, fish tank, mosquito coil, charging protection, heater, etc.
- Power-off memory: Set through the "memory function" button on the APP. After the socket is powered off and restarted, the state before the power off will be maintained.
- Network disconnection memory: local timing function, set the timing when the network is connected, it can still be executed effectively after the network is disconnected.

INSTALL THE SMART WI-FI APP

Smart WiFi App controls the actual use operation:

Download the "iSmart Home" App on your mobile phone, which can be downloaded for free in all major app stores, and install it directly after the download is successful. (Scan the code to download the App)



ADD DEVICE

1. After installation, register an account and log in to the interface at the same time;

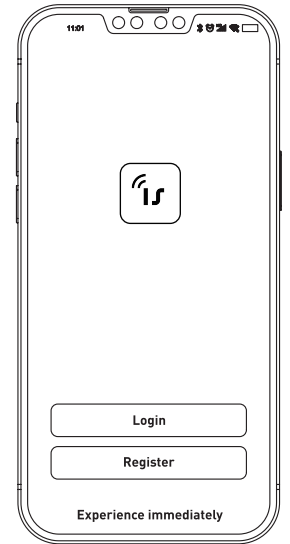

ADD DEVICE

2. When the login is successful, long press the button for 5-8 seconds, the LED light will turn on, the red light will flash cyclically. Before the WiFi connection is successful, it will turn on the red light, and the white light will turn on after the WiFi connection is successful. Open the App at this time, click on the ADD SYMBOL "+" in the upper right corner, the device name of Wifi-Socket will automatically pop up (The Bluetooth function of the mobile phone is turned on, click "Add", click "Next", complete, and connect to the Wi-Fi network (the mobile Wi-Fi must be in the connection state).

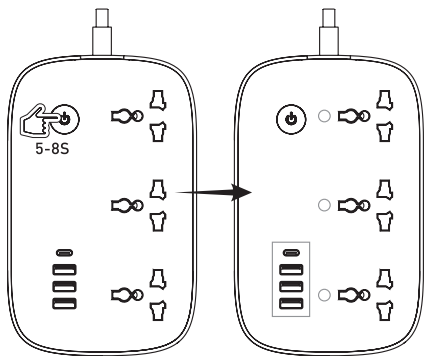

White light will turn on

3. The "Add Device Found" page is displayed.

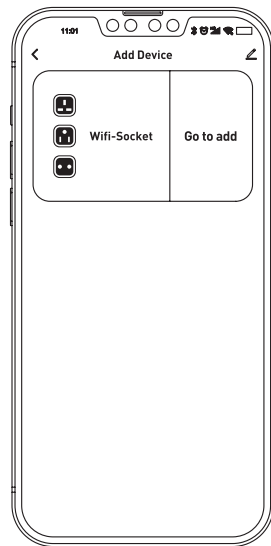

4. After the addition is successful, you can perform remote control socket switch, timing, power-on status settings and other functions on the App.

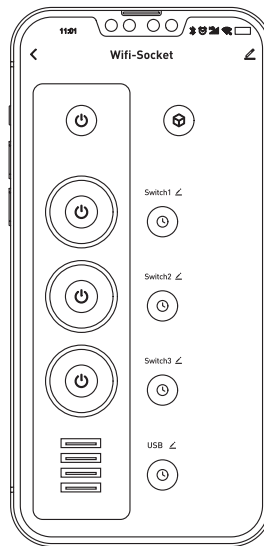

• The socket is successfully connected to the device, and the APP displays "The socket is turned on".

FUNCTION DESCRIPTION

Even if the WiFi of the mobile phone is turned off, it can be controlled remotely through data flow. (Note: The WiFi socket must be connected to the Internet)

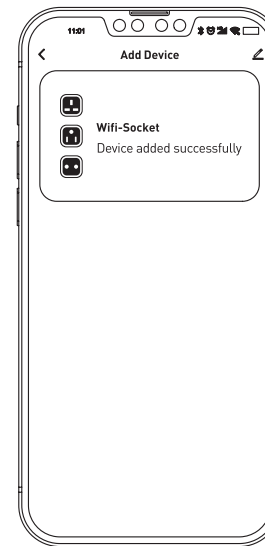

• The socket is connected to the Internet successfully, the APP page displays "Device added successfully".

Attention

- Please do not disassemble, modify short-circuit products, otherwise it will cause electric shock, fire or electrical damage;
- This product is an electronic product, please avoid violently hitting, bumping or dropping the product;
- It is strictly forbidden to expose to excessive heat, cold or humidity. The best use environment temperature of the product is -10°C-40°C;
- Please place it in a safe place out of reach of children to prevent danger;
- Please use it for electrical products that have passed the national EMC certification to avoid potential safety hazards;
- The memory mode or turning on the timing function should use the equipment with automatic protection function, or the device without automatic protection function can be used under artificial control.

