

# TRH2027

## 15-channel LCD Remote

### Instructions

Version: T1

#### Button Commands

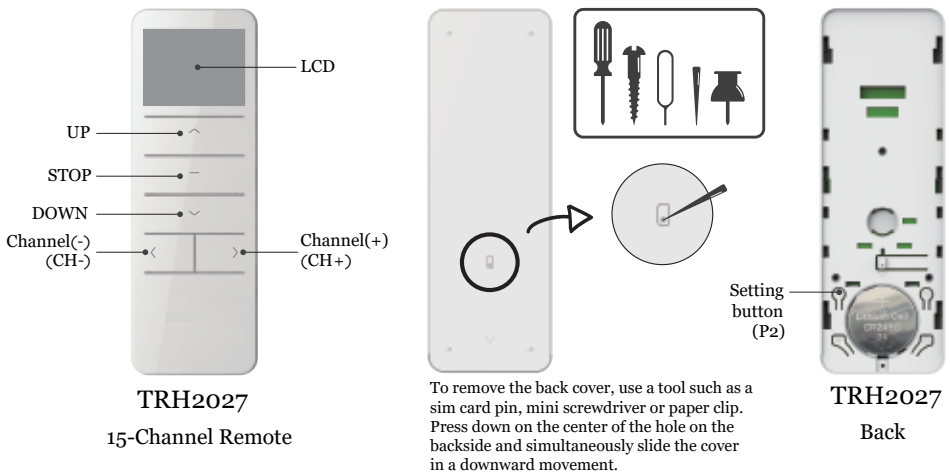

#### Technical specification

|   |                           |   |
|---|---------------------------|---|
| Battery: 3V (CR2450)                              | Battery life: >2 years    | Radio frequency: 433.05~434.79MHz   |
| Working temperature: -10°C ~ 50°C<br>-4°F ~ 122°F | Transmitting power: 10 mW | Radio range: 200 meters outdoor, 35 meters indoor<br>220 yards outdoor, 38 yards indoor |

#### Warning

- Do not expose the remote to excessive moisture or water
- Do not strike or use excessive force on the remote
- If the remotes range is decreasing the battery may need to be replaced
- Only use CR2450 batteries in device
- If the voltage is less than 2.6V the remote will show a low voltage indicator
- Under uni-directional operating mode, pressing any button for more than 20s will stop radio signal transmission
- Under bi-directional operating mode, pressing any button for more than 5s will stop radio signal transmission
- Failure to follow these warnings may result in injury or render the remote inoperable
- Always dispose of batteries properly

## Adjusting Number Of Channels

This remote can be set to have up to 15 channels. The factory default on the remote is set to all 15 channels. The steps to adjust the number of channels are as follows:

Step 1: Briefly press < and > buttons simultaneously, the remote will display "C"

Step 2: Press < and > buttons simultaneously for at least 2 seconds, the remote will display "15"

Step 3: Using the < and > arrows select the number of channels required

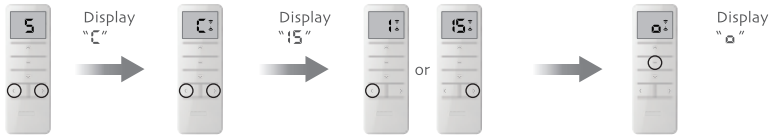

## Switching Between Uni-Directional and Bi-Directional Modes

Note: The factory default mode is Bi-directional

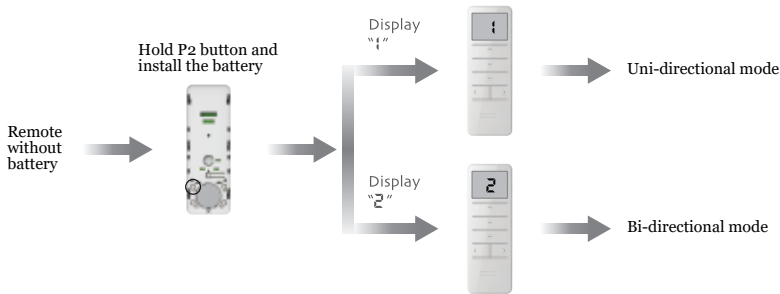

## Locking/Unlocking Programming Function on Remotes

Locking of remotes is used to prevent accidental changes to the pre-set positions of the motor such as open and closed positions as well as preferred stop positions. Once all programming is complete for the remote and motor it is recommended that the programming function be locked to avoid unintentional changes. Please note that locking the remote only locks motor functions, functions on the remote such as increasing channels can still be performed.

### Locking Remote Programming

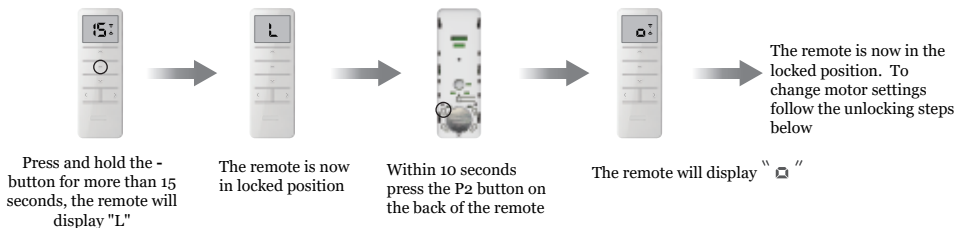

### Unlocking Remote Programming

